

AUG 14 1985

7

()NOT FOR PUBLICATION

SEP 20 1985

SOUTH CAROLINA INVENTORY FORM FOR HISTORIC DISTRICTS AND
INDIVIDUAL PROPERTIES IN A MULTIPLE PROPERTY SUBMISSION

NAME OF MULTIPLE PROPERTY SUBMISSION: City of Orangeburg Multiple
Resource Area

PREFERRED NAME OF PROPERTY: Williams Chapel A.M.E. Church

HISTORIC NAME OF PROPERTY: Same

COMMON NAME OF PROPERTY: Same

LOCATION: 1908 Glover Street

CLASSIFICATION: Building

OWNER: c/o The Rev. Allen Parrott
Williams Chapel A.M.E. Church
1908 Glover Street
Orangeburg, SC

DESCRIPTION

Constructed between ca. 1915 and ca. 1925, Williams Chapel A.M.E. Church is a one-story, gable-roofed, brick church with a full basement, and a meeting house plan. The facade (northwest elevation) has all stretcher bond brickwork; the sides (northeast and southwest elevations) and rear (southeast elevation) have common bond brickwork. The facade features two towers (the left tower larger than the right) with pyramidal metal shingle roofs. Both towers have corbeled battlements with pyramidal tops. Fenestration in the right tower is single, stained glass, Gothic-arched windows and small louvered Gothic vents. The left tower has double stained glass, Gothic windows and large Gothic louvered vents. There is a double-door entrance with a modern door and sidelights on the facade. The double-door entrance is set in a Gothic-arched surround and is topped by a Gothic stained glass transom and a dentil course. A large stained glass window set in a round-arched brick pattern with radiating voussoirs sits above the entrance. Topping this are three Gothic arched louvered attic vents, set above a decorative brick course with recessed square brick patterns. On the left (northeast) elevation there is a large projecting bay (with a parapeted gable) near the rear. There is also a small parapet gable on the right elevation. Side elevations have brick pilasters with corbeled tops and lancet stained glass windows between pilasters. The basement level has pointed arch windows with mazed glass; the foundation is stuccoed. A modern metal shed roof covers the entrance leading into the basement on the

right elevation. The front doors give access to a two-story narthex. Staircases on each side lead to the nave and balcony. Small lancet windows with stained and leaded glass illuminate the stair halls. Rose windows are displayed at the front and rear of the interior. The nave is a large, rectangular area with an exposed beam ceiling with the beams covered in paneling. The walls are plaster with modern paneling beneath a chairrail. Door and window surrounds are simple throughout. The floors are carpeted. A balcony supported by slender oak columns with Ionic capitals encompasses the entire area except for the chancel. The balcony wall is sheathed in narrow beaded board with recessed lattice strips; a modern metal railing tops the balcony wall. The balcony features narrow beaded board beneath a chairrail. The chancel is a recessed semi-elliptical area with a pulpit, altar furnishings, baptismal font, choir loft, and a pipe organ which is housed by a pointed, arched opening. Single doors flank the altar area on the main floor and balcony. Modern chandeliers and light fixtures have been added. There are three sections of curved oak pews which have Gothic arches carved in the pew ends.

SIGNIFICANCE

AREAS OF SIGNIFICANCE: Architecture, Black History

LEVEL OF SIGNIFICANCE: L (for office only)

SUMMARY OF SIGNIFICANCE

Williams Chapel A.M.E. Church is an elegant essay in Gothic Revival architecture. Its picturesque massing and distinctive detailing attest to the talents of its architect, Miller F. Whittaker, and to the ability of builder, I.J. Minger.(1) Whittaker, who prepared plans for the building in 1915, was director of the department of mechanical arts at South Carolina State College and was also the first black architect practicing in South Carolina.

Construction of the building began ca. 1915, but it was not completed until ca. 1925 due to financial difficulties. The congregation is said to have been organized in 1873, and until ca. 1919 worshiped in a frame building which sat to the northeast of the present building.(2)

ACREAGE: Approximately .6 acres

VERBAL BOUNDARY DESCRIPTION: The boundary of the Williams Chapel A.M.E. Church nomination is shown as the bold black line on the accompanying map entitled, "Williams Chapel A.M.E. Church." The map was copied from Orangeburg County Tax Map No. 21 and is drawn at a scale of 200 feet to the inch. The nominated property includes the church building and its immediate setting, which includes a portion of the adjacent parking lot.

FOOTNOTES

(1) Commemorative plaque in Williams Chapel A.M.E. Church.

(2) Sanborn Map Company, Orangeburg, 1915, 1922, 1931,; Interview with Dr. Barbara Jenkins, Orangeburg, SC, 1984; Sixtieth Session, Central South Carolina Annual Conference of the African Methodist Church (Orangeburg, SC: n.p., 1983); W.P.A., "Survey of State and Local Historical Records."

QUAD NAME: Orangeburg South

QUAD SCALE: 1:24000

UTM REFERENCE POINT: 17/512980/3705000

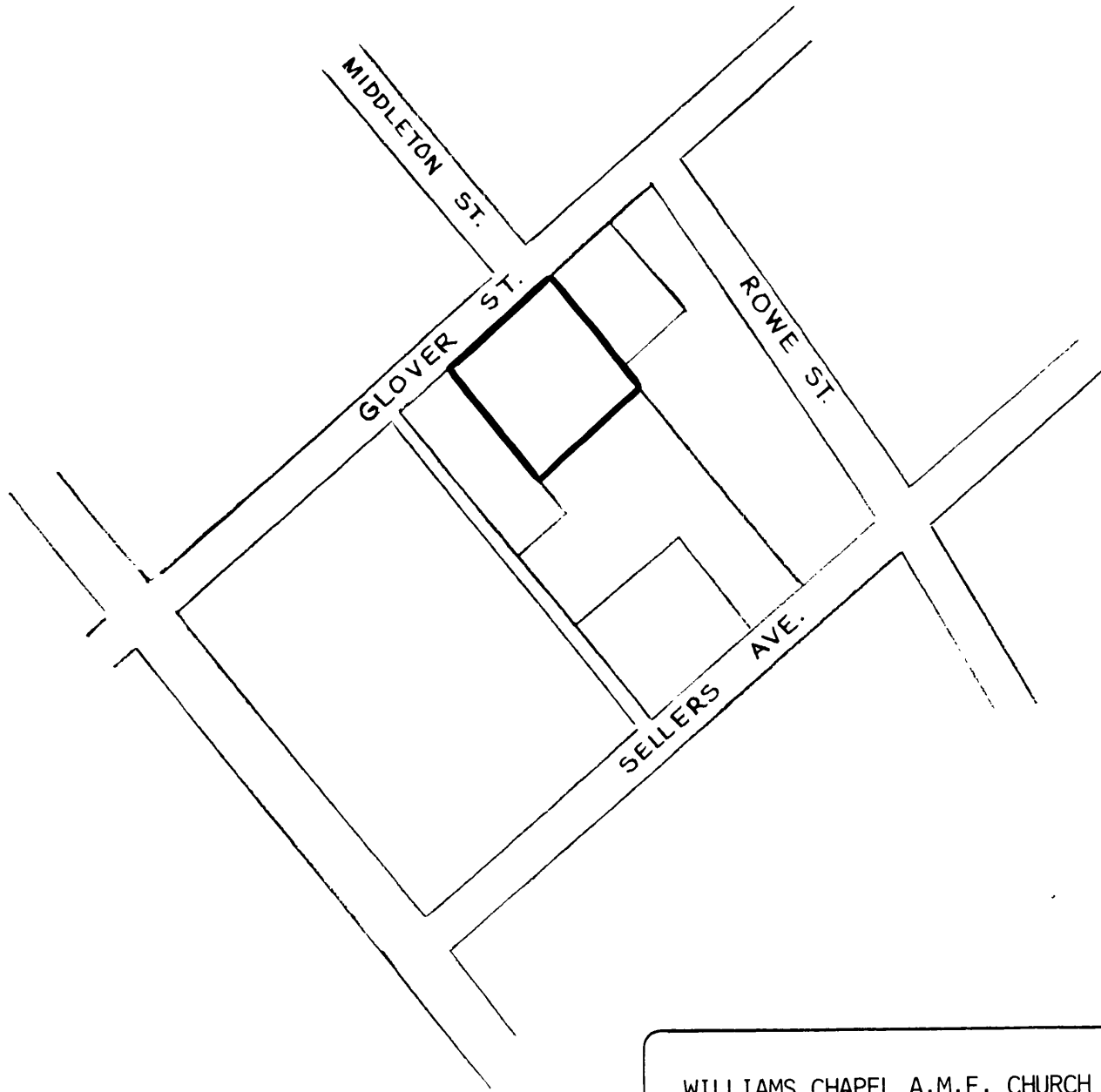

WILLIAMS CHAPEL A.M.E. CHURCH
SCALE 1" = 200'