

BALCONY PLAN

SCALE 1/4" = 1'-0"

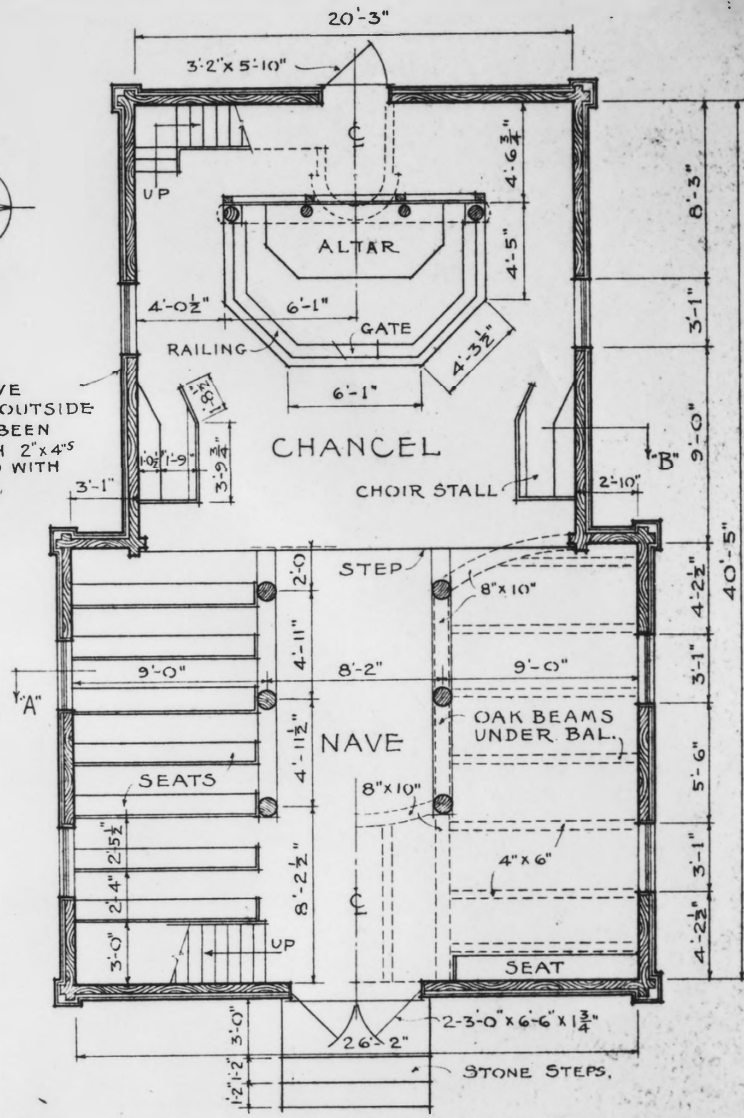

MAIN FLOOR PLAN

NOTES:

EXTERIOR WALLS CONSTRUCTED OF RED OAK LOGS-ADZED AND HAND PLANED TO THICKNESS OF APPROXIMATELY 6". WOOD FLOORS THRU OUT.

TO PRESERVE STRUCTURE, OUTSIDE WALLS HAVE BEEN FURRED WITH 2"x4'-5" AND COVERED WITH CLAPBOARDS.

KEY TO MATERIALS

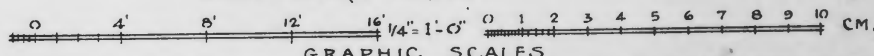
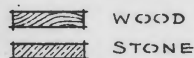

E.D. CORWIN - DEL.

U.S. DEPARTMENT OF THE INTERIOR
OFFICE OF NATIONAL PARKS, BUILDINGS, AND RESERVATIONS
BRANCH OF PLANS AND DESIGN

LOG CHAPEL.

ST. PAUL MINN.

SURVEY NO.
29-24

HISTORIC AMERICAN
BUILDINGS SURVEY
SHEET 1 OF 3 SHEETS

INDEX NO.

Form No. 10-301a
(7/72)UNITED STATES DEPARTMENT OF THE INTERIOR
NATIONAL PARK SERVICENATIONAL REGISTER OF HISTORIC PLACES
PROPERTY PHOTOGRAPH FORM*(Type all entries - attach to or enclose with photograph)*

STATE	
Minnesota	
COUNTY	
Ramsey	
FOR NPS USE ONLY	
ENTRY NUMBER	DATE
MAY 12 1975	

SEE INSTRUCTIONS

1. NAME			
COMMON:		Muskego Church	
AND/OR HISTORIC:		Muskego Church	
2. LOCATION			
STREET AND NUMBER:			
2375 Como Avenue West			
CITY OR TOWN:			
St. Paul			
STATE:	CODE	COUNTY:	CODE
Minnesota	22	Ramsey	123
3. PHOTO REFERENCE			
PHOTO CREDIT: Eugene D. Becker			
DATE OF PHOTO: October 1974			
NEGATIVE FILED AT:			
Minnesota Historical Society, 690 Cedar Street, St. Paul, Minnesota 55101			
4. IDENTIFICATION			
DESCRIBE VIEW, DIRECTION, ETC.			
Sheet 1 of 3 sheets of Survey No. 29-24, Historic American Buildings Survey, 1934, U.S. Dept. of Interior. Log Chapel - St. Paul, Minnesota			

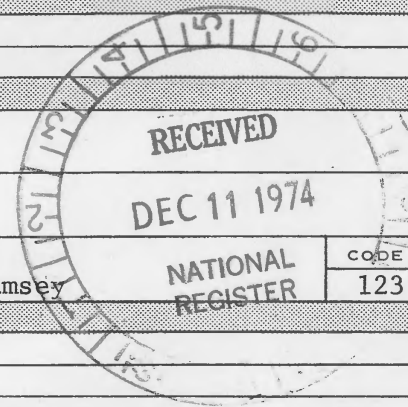

NOTE: NORTH ELEVATION SAME.

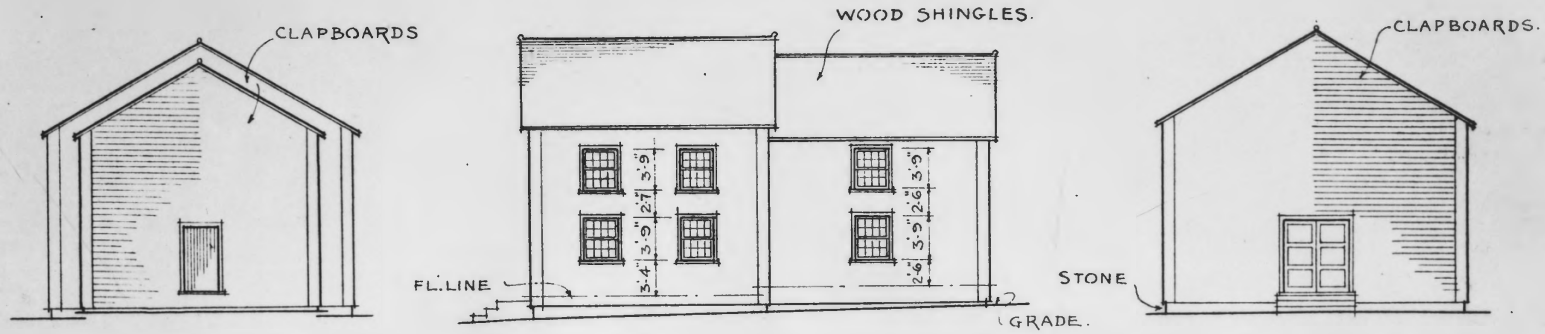

EAST ELEV. SCALE $\frac{1}{8}'' = 1'-0''$ SOUTH ELEVATION SCALE $\frac{1}{8}'' = 1'-0''$ WEST (FRONT) ELEV.

NOTE: TO PRESERVE STRUCTURE, EXTERIOR LOG WALLS HAVE BEEN FURRED WITH 2×4 'S AND COVERED WITH CLAPBOARDS. ENDS OF LOGS AT CORNERS OF BUILDING HAVE BEEN BOXED IN. ORIGINAL DOORS AND WINDOWS HAVE BEEN REPLACED.

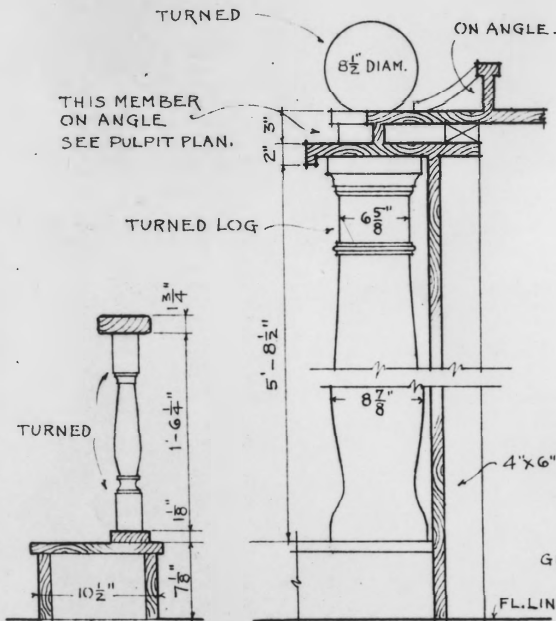

SEC THRU ALTAR RAIL.

SEC "A-A" SCALE $\frac{1}{2}'' = 1'-0''$

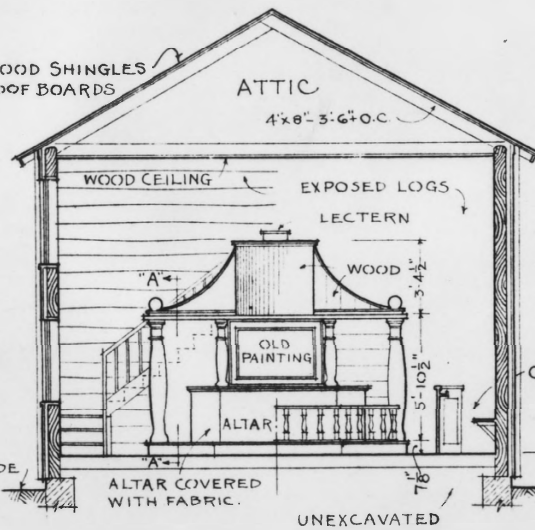

SECTION THRU CHANCEL TOWARD ALTAR SCALE $\frac{1}{4}'' = 1'-0''$

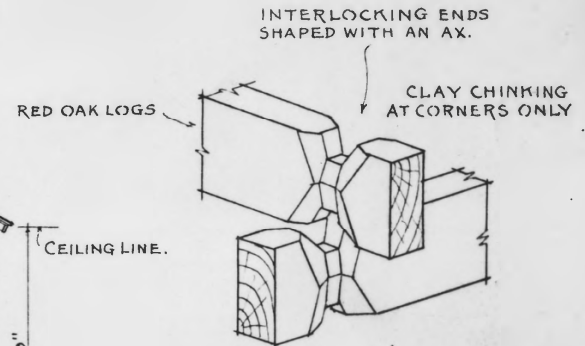

ISOMETRIC VIEW SHOWING METHOD OF INTERLOCKING LOGS AT CORNERS OF BUILDING.

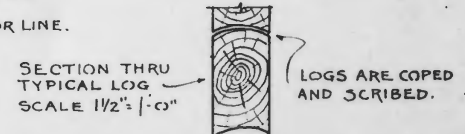

SECTION THRU TYPICAL LOG SCALE $\frac{1}{2}'' = 1'-0''$

LOGS ARE COPED AND SCRIBED.

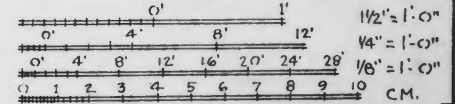

GRAPHIC SCALES.

E. D. CORWIN - DEL.

U.S. DEPARTMENT OF THE INTERIOR
OFFICE OF NATIONAL PARKS, BUILDINGS, AND RESERVATIONS
BRANCH OF PLANS AND DESIGN

LOG CHAPEL.

NAME OF STRUCTURE

ST. PAUL MINN.

SURVEY NO.
29-24

HISTORIC AMERICAN
BUILDINGS SURVEY
SHEET 2 OF 3 SHEETS

INDEX NO.

Form No. 10-301a
(7/72)UNITED STATES DEPARTMENT OF THE INTERIOR
NATIONAL PARK SERVICENATIONAL REGISTER OF HISTORIC PLACES
PROPERTY PHOTOGRAPH FORM

(Type all entries - attach to or enclose with photograph)

STATE	
Minnesota	
COUNTY	
Ramsey	
FOR NPS USE ONLY	
ENTRY NUMBER	DATE
100Y 12 1975	

SEE INSTRUCTIONS

1. NAME			
COMMON:	Muskego Church		
AND/OR HISTORIC:	Muskego Church		
2. LOCATION			
STREET AND NUMBER:			
2375 Como Avenue West			
CITY OR TOWN:			
St. Paul			
STATE:	CODE	COUNTY:	CODE
Minnesota	22	Ramsey	123
3. PHOTO REFERENCE			
PHOTO CREDIT:	Eugene D. Becker		
DATE OF PHOTO:	October 1974		
NEGATIVE FILED AT:			
Minnesota Historical Society, 690 Cedar Street, St. Paul, Minnesota 55101			
4. IDENTIFICATION			
DESCRIBE VIEW, DIRECTION, ETC.			
Sheet 2 of 3 sheets of Survey No. 29-24, Historic American Buildings Survey, 1934, U.S. Dept. of Interior. Log Chapel - St. Paul, Minnesota			

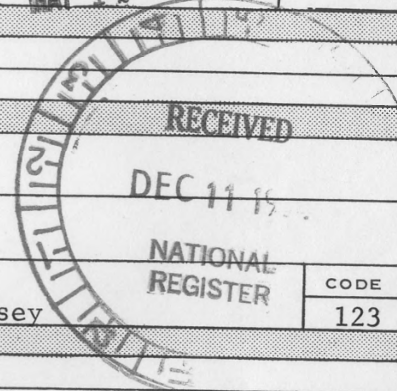

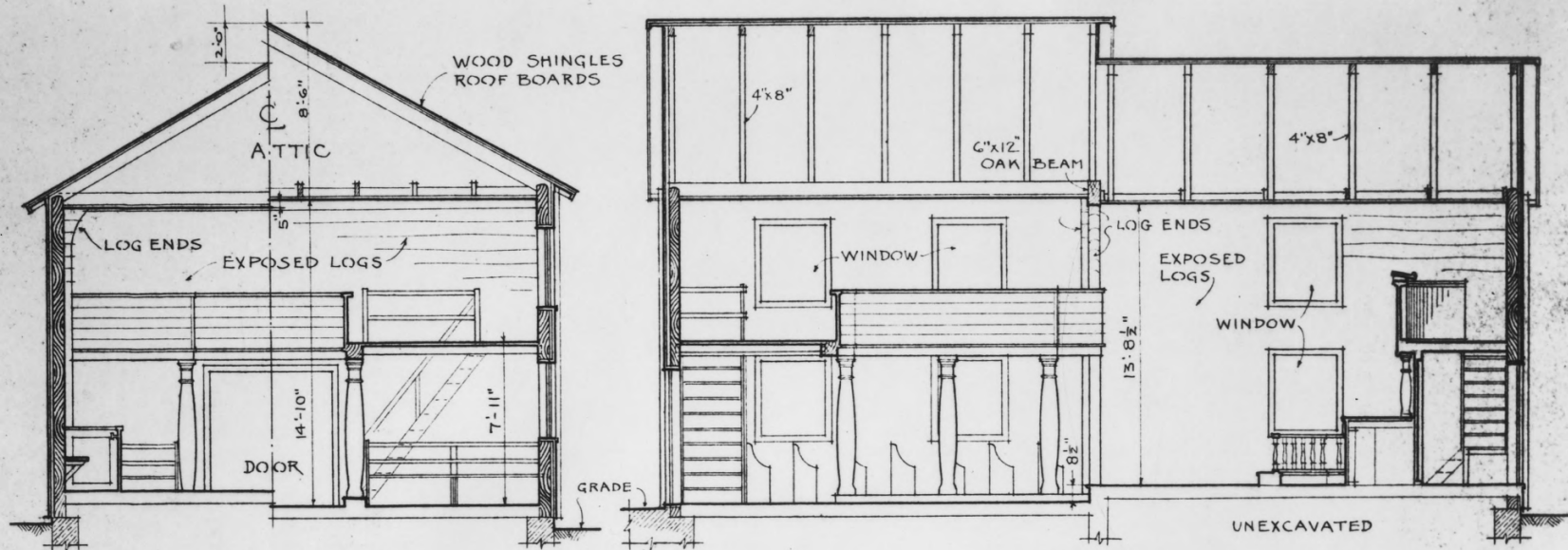

SECTION ON LINE - "A-B" SCALE $\frac{1}{4}'' = 1'-0''$ LONGITUDINAL SECTION ON \odot OF BLDG.

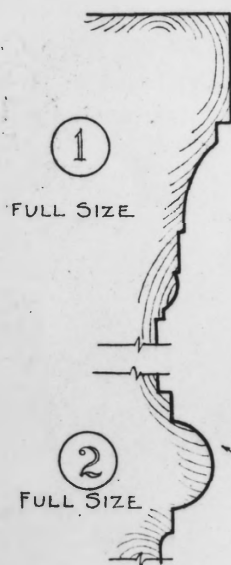

BACK AND SEAT
HOUSED INTO END

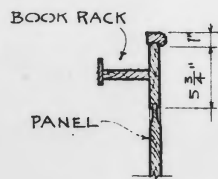

FRONT OF CHOIR STALL
SCALE $\frac{1}{2}'' = 1'-0''$

FL. LINE

NOTE:
POSTS TURNED FROM
BLACK WALNUT LOGS.
DIAM. AT NECK $7\frac{3}{4}''$.
GREATEST DIAM. $10\frac{1}{2}''$

E.D. CORWIN - DEL.

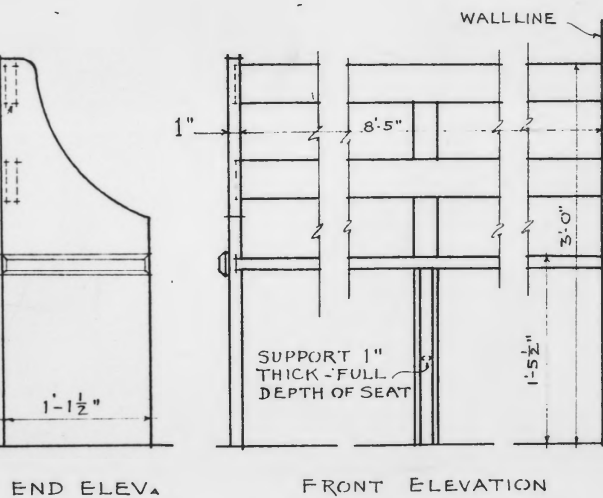

END ELEV.

FRONT ELEVATION

DETAIL OF SEATS IN NAVE

SCALE $\frac{1}{2}'' = 1'-0''$

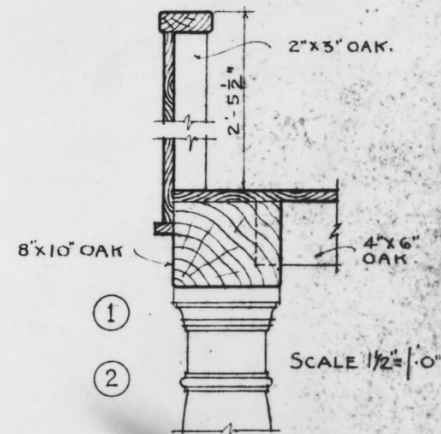

SEC. THRU BAL. RAIL

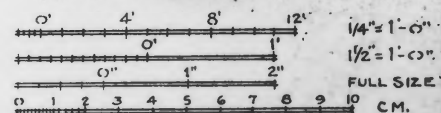

GRAPHIC SCALES

Form No. 10-301a
(7/72)UNITED STATES DEPARTMENT OF THE INTERIOR
NATIONAL PARK SERVICENATIONAL REGISTER OF HISTORIC PLACES
PROPERTY PHOTOGRAPH FORM*(Type all entries - attach to or enclose with photograph)*

STATE	
Minnesota	
COUNTY	
Ramsey	
FOR NPS USE ONLY	
ENTRY NUMBER	DATE
	MAY 12 1975

SEE INSTRUCTIONS

1. NAME			
COMMON:		Muskego Church	
AND/OR HISTORIC:		Muskego Church	
2. LOCATION			
STREET AND NUMBER:			
2375 Como Avenue West			
CITY OR TOWN:			
St. Paul			
STATE:	CODE	COUNTY:	CODE
Minnesota	22	Ramsey	123
3. PHOTO REFERENCE			
PHOTO CREDIT:		Eugene D. Becker	
DATE OF PHOTO:		October 1974	
NEGATIVE FILED AT:		Minnesota Historical Society, 690 Cedar Street, St. Paul, Minnesota 55101	
4. IDENTIFICATION			
DESCRIBE VIEW, DIRECTION, ETC.			
Sheet 3 of 3 sheets of Survey No. 29-24, Historic American Buildings Survey, 1934, U.S. Dept. of Interior. Log Chapel - St. Paul, Minnesota			

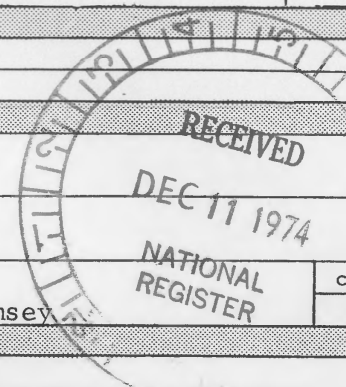



Form No. 10-301a
(7/72)UNITED STATES DEPARTMENT OF THE INTERIOR
NATIONAL PARK SERVICENATIONAL REGISTER OF HISTORIC PLACES
PROPERTY PHOTOGRAPH FORM*(Type all entries - attach to or enclose with photograph)*

STATE Minnesota	
COUNTY Ramsey	
FOR NPS USE ONLY	
ENTRY NUMBER	DATE

SEE INSTRUCTIONS

1. NAME			
COMMON:		Muskego Church	
AND/OR HISTORIC:		Muskego Church	
2. LOCATION			
STREET AND NUMBER:			
2375 Como Avenue West			
CITY OR TOWN:			
St. Paul			
STATE:	CODE	COUNTY:	CODE
Minnesota	22	Ramsey	123
3. PHOTO REFERENCE			
PHOTO CREDIT:		Eugene D. Becker	
DATE OF PHOTO:		March 1961	
NEGATIVE FILED AT:		Minnesota Historical Society, 690 Cedar Street, St. Paul, Minnesota 55101	
4. IDENTIFICATION			
DESCRIBE VIEW, DIRECTION, ETC.			
Direction - looking west			
View - the main room, which includes the gallery, main entrance and pews. Photographed from the pulpit.			
#1034			

☆ U.S. GOVERNMENT PRINTING OFFICE: 1973-729-152/1446 III-1

PROPERTY OF THE NATIONAL REGISTER

#1034



Form No. 10-301a
(7/72)

UNITED STATES DEPARTMENT OF THE INTERIOR
NATIONAL PARK SERVICE

**NATIONAL REGISTER OF HISTORIC PLACES
PROPERTY PHOTOGRAPH FORM**

(Type all entries - attach to or enclose with photograph)

STATE Minnesota	
COUNTY Ramsey	
FOR NPS USE ONLY	
ENTRY NUMBER	DATE
	MAY 12 1975

SEE INSTRUCTIONS

1. NAME			
COMMON: Muskego Church		AND/OR HISTORIC: Muskego Church	
2. LOCATION			
STREET AND NUMBER: 2375 Como Avenue West			
CITY OR TOWN: St. Paul			
STATE: Minnesota	CODE 22	COUNTY: Ramsey	CODE 128
3. PHOTO REFERENCE			
PHOTO CREDIT: Eugene D. Becker			
DATE OF PHOTO: March 1963			
NEGATIVE FILED AT: Minnesota Historical Society, 690 Cedar Street, St. Paul, Minnesota 55101			
4. IDENTIFICATION			
DESCRIBE VIEW, DIRECTION, ETC. Direction - looking east View - interior of the chancel which includes pulpit and altar. Photographed from beneath the gallery in the main room.			
# 2034			

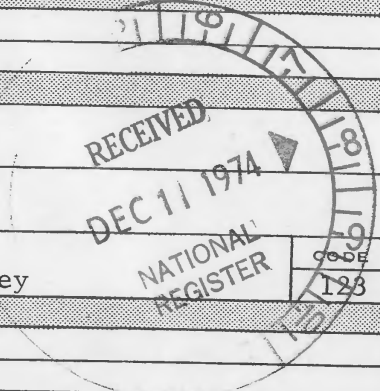

☆ U.S. GOVERNMENT PRINTING OFFICE: 1973-729-152/1446 III-1

PROPERTY OF THE NATIONAL REGISTER

2034



**NATIONAL REGISTER OF HISTORIC PLACES
PROPERTY PHOTOGRAPH FORM**

(Type all entries - attach to or enclose with photograph)

STATE Minnesota	
COUNTY Ramsey	
FOR NPS USE ONLY	
ENTRY NUMBER	DATE
MAY 12 1974	

SEE INSTRUCTIONS

1. NAME			
COMMON: Muskego Church		AND/OR HISTORIC: Muskego Church	
2. LOCATION			
STREET AND NUMBER: 2375 Como Avenue West			
CITY OR TOWN: St. Paul			
STATE: Minnesota	CODE 22	COUNTY: Ramsey	CODE 123
3. PHOTO REFERENCE			
PHOTO CREDIT: Minneapolis Tribune			
DATE OF PHOTO: March 1973			
NEGATIVE FILED AT: Minneapolis Tribune, 425 Portland Avenue, Minneapolis, Minnesota 55415			
4. IDENTIFICATION			
DESCRIBE VIEW, DIRECTION, ETC. Direction - looking east View - the interior of the chancel photographed from the gallery in the main room. #3024			

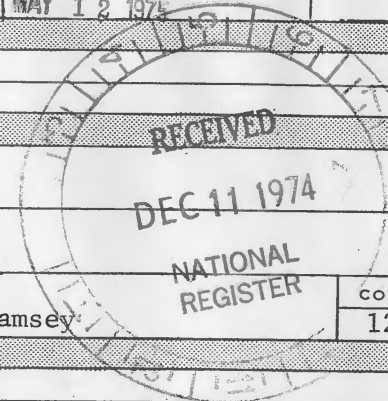

MUST CREDIT
MINNEAPOLIS TRIBUNE

PROPERTY OF THE NATIONAL REGISTER

#3024

THIS PICTURE CANNOT BE USED
ON TELEVISION WITHOUT THE
EXPRESS WRITTEN PERMISSION OF
THE EDITOR OF THE MINNEAPOLIS
TRIBUNE.



THIS PICTURE CANNOT BE USED

Form No. 10-301a
(7/72)

UNITED STATES DEPARTMENT OF THE INTERIOR
NATIONAL PARK SERVICE

**NATIONAL REGISTER OF HISTORIC PLACES
PROPERTY PHOTOGRAPH FORM**

(Type all entries - attach to or enclose with photograph)

STATE	
Minnesota	
COUNTY	
Ramsey	
FOR NPS USE ONLY	
ENTRY NUMBER	DATE
	MAY 12 1974

SEE INSTRUCTIONS

1. NAME			
COMMON:	Muskego Church		
AND/OR HISTORIC:	Muskego Church		
2. LOCATION			
STREET AND NUMBER:			
2375 Como Avenue West			
CITY OR TOWN:			
St. Paul			
STATE:		CODE	COUNTY:
Minnesota		22	Ramsey
3. PHOTO REFERENCE			
PHOTO CREDIT: Minneapolis Tribune			
DATE OF PHOTO: March 1973			
NEGATIVE FILED AT:			
Minnesota Historical Society, 690 Cedar Street, St. Paul, Minnesota 55101			
4. IDENTIFICATION			
DESCRIBE VIEW, DIRECTION, ETC.			
Direction - looking south			
View - the north elevation of the main room and chancel to the rear			
#4034			

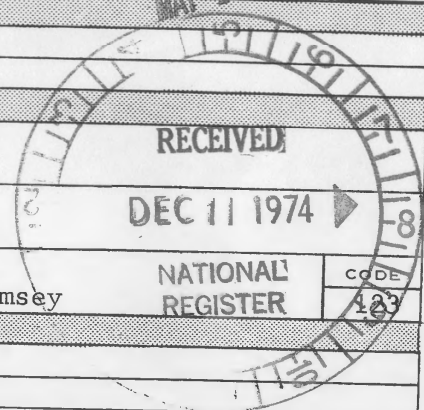

PHOTO CREDIT

PHOTO CREDIT

☆ U.S. GOVERNMENT PRINTING OFFICE: 1973-729-152/1446 III-1

PROPERTY OF THE NATIONAL REGISTER

#4034