

United States Department of the Interior
National Park Service

RECEIVED

JUN 2 1993

NATIONAL REGISTER OF HISTORIC PLACES
REGISTRATION FORM

NATIONAL
REGISTER

1. Name of Property

historic name: Wilcox, Albert Spencer, Beach House

other name/site number: _____

2. Location

street & number: Weke Road

not for publication:

city/town: Hanalei

vicinity: _____

state: HI

county: Kauai

code: 007

zip code: 96714

3. Classification

Ownership of Property: private

Category of Property: building

Number of Resources within Property:

Contributing	Noncontributing	
<u>5</u>	<u>0</u>	buildings
		sites
<u>4</u>		structures
		objects
<u>9</u>	<u>0</u>	Total

Number of contributing resources previously listed in the National Register: 0

Name of related multiple property listing: NA

=====
4. State/Federal Agency Certification
=====

As the designated authority under the National Historic Preservation Act of 1986, as amended, I hereby certify that this x nomination _____ request for determination of eligibility meets the documentation standards for registering properties in the National Register of Historic Places and meets the procedural and professional requirements set forth in 36 CFR Part 60. In my opinion, the property x meets _____ does not meet the National Register Criteria. _____ See continuation sheet.

John P. Keppeler
Signature of certifying official 6.21.93
Date

State Historic Preservation Officer, Department of Land and Natural Resources
State or Federal agency and bureau

In my opinion, the property _____ meets _____ does not meet the National Register criteria. _____ See continuation sheet.

Signature of commenting or other official Date

State or Federal agency and bureau

=====
5. National Park Service Certification
=====

I, hereby certify that this property is:

- X entered in the National Register Antonio de Bee 7/30/93
_____ See continuation sheet.
- _____ determined eligible for the
National Register _____
- _____ See continuation sheet.
- _____ determined not eligible for the
National Register _____
- _____ removed from the National Register _____
- _____ other (explain): _____

for Signature of Keeper Date
of Action

=====

6. Function or Use

=====

Historic: Domestic Sub: single dwelling

Current : Domestic Sub: single dwelling

=====

7. Description

=====

Architectural Classification:

other

Other Description: Folk Victorian

Materials: foundation wood roof metal

walls wood other NA

Describe present and historic physical appearance. X See continuation sheet.

The A.S. Wilcox beach house sits on a large landscaped parcel of land on the mauka (mountain) side of Weke Road. The spacious grounds are characterized by an expansive lawn landscaped with coconut, ironwood, and lauhala trees. The rear of the historic residential portion of this property is delineated by two inland fish ponds. The one to the north is brackish and appears on maps as early as 1838; the one to the south is fresh water, heavily silted, and dates from the 1930s. The house has an unobstructed view of Hanalei Bay, as the beachfront property on the makai (ocean) side of the road is undeveloped. These beachfront lots are included within the nomination because they contribute to the open space traditionally associated with the Wilcox beach house and its recreational use.

A number of buildings and structures are located on the property. These include the main house, three garages, a boathouse, two servants' quarters, a gardener's residence, and a caretaker's cottage.

The main house is a rambling single story building. The numerous rooms are connected by a roofed lanai. The house has shiplap siding and a gable roof with a hip roof over the lanai. The house consists of a living/dining room with a lateral wing with bedrooms to the left. A separate kitchen is to the rear. The kitchen includes four rooms: a butler's pantry, a pantry, a kitchen, and cook's quarters. Also located at the rear of the house, opposite the kitchen, is an additional bedroom and sitting room wing. This wing has a rear enclosed lanai. Originally this was a separate structure on the property. It was moved and joined to the main house in the 1930s. All windows are two over two, double hung sash and the rooms have tongue and groove ceilings.

United States Department of the Interior
National Park Service

NATIONAL REGISTER OF HISTORIC PLACES
CONTINUATION SHEET

Section number 7

A.S. Wilcox Beach House Page 1

=====

The lanai roof is supported by chamfered posts and a frieze. Gingerbread brackets provide embellishment. A balustrade of 1x1 rails frames the lanai. Concrete steps lead up to the lanai on the front and side of the living/dining room, at the rear courtyard, and on the far side of the bedroom wing. A single hinged door provides rear access to the living room. Three sets of double sliding doors provide primary access to the living /dining room. The sliding doors have three bottom panels and two panes of glass and are surmounted by a two light transom. The living/dining room has a coffered eleven foot ceiling and a four foot tongue and groove wainscot. Two chandeliers provide illumination. Two sets of built in mirrors are located above the waincot and between the sets of double hung windows on the Haena side of the room. The five bedrooms in the main house all have three panel doors with a Queen Anne window and retain their original hardware.

A garage is located behind the main house. The gable roofed boathouse also sits at the rear of the rproperty on the pond. An ironwood hedge runs makai from the boathouse to the road. Additional cottages and garages are located behind this hedge. All these buildings are modest wood frame structures which have been sand painted.

There have been no major alterations or additions to this beach house complex.

=====
8. Statement of Significance
=====

Certifying official has considered the significance of this property in relation to other properties: statewide.

Applicable National Register Criteria: A,B,C

Criteria Considerations (Exceptions) : NA

Areas of Significance: architecture
social history

Period(s) of Significance: 1896-1940 _____

Significant Dates : _____

Significant Person(s): Albert Spencer Wilcox

Cultural Affiliation: NA _____

Architect/Builder: Unknown

State significance of property, and justify criteria, criteria considerations, and areas and periods of significance noted above.
X See continuation sheet.

The Albert Spencer Wilcox beach house is significant as an example of a turn-of-the-century seasonal residence on Kauai and as a house associated with Albert Spencer Wilcox.

The A. S. Wilcox beach house is architecturally significant as a good, surviving example of a late nineteenth/early twentieth century house in Hawaii. Its rambling design and separation of social, cooking and sleeping functions into detached rooms connected by a lanai is typical of the period. This house and the Gay residence (Hawaii and National Register of Historic Places) are the only known turn-of-the-century houses on Kauai to retain such a feature. The use of shiplap siding, tongue and groove walls and ceiling, paneled doors, and the quality of workmanship reflect the period of construction. The orientation to the outdoors and the living space provide by the lanais, as well as the numerous windows and openings for light and ventilation, attest to the builder's understanding of the location and the type of lifestyle enjoyed in Hawaii. The house is also representative of the growth and changes within the Wilcox family; the house incorporates additions which provided more space for the growing family.

United States Department of the Interior
National Park Service

NATIONAL REGISTER OF HISTORIC PLACES
CONTINUATION SHEET

Section number 8

A.S. Wilcox Beach House 1

=====

The house is also significant for its associations with the development of Hanalei as a recreational retreat. It is the earliest known beach house to be constructed on Hanalei Bay. Other substantial beach houses were constructed by Mabel Wilcox, Dr. Harl, the Baldwins, Fayes, Sloggetts, and Sanborns in the early twentieth century. The A.S. Wilcox house remains the largest and most prominent of the historic beach houses which surround the bay. A self-contained estate, the property was capable of sustaining itself with its fish, ducks and gardens.

The A.S. Wilcox beach house is also significant for its associations with Albert Spencer Wilcox. A son of Abner and Lucy Wilcox, Albert was born in Hilo on May 25, 1844. His missionary parents soon moved to Waialua, Oahu, and from there to Waioli on Kauai. It was in Waioli that he grew up. Albert Wilcox was educated at Punahou and then entered the sugar industry at Waipa. Later he moved to Hanamaulu, where for many years (1877-1898) he managed that section of Lihue plantation. After his marriage to Mrs. Emma Napoleon Mahelona in 1898 he moved to Kilohana, devoting his time to raising livestock. He owned much of the land in Princeville and Hanalei, having unsuccessfully tried to bring this area under sugar cultivation. He successfully established a sugar plantation in Kealia and one of the most prominent people of his time in Hawaii. He served as president of C. Brewer and sat as a director on the boards of Kekaha Sugar Company, Waianae Sugar Company, the Home Insurance Company, and the Inter Island Steam Navigation Company. In addition, he served as a member of the Kingdom of Hawaii's House of Representatives for two years (1891-1892). He died on Kauai on July 7, 1919.

The beach house remains in the family's possession.

=====

9. Major Bibliographical References

=====

Wilcox, Carol. Kauai Album. Lihue: 1981.

Land and Community Associates. The Prospect form this Hill, The Hanalei Cultural Landscape Survey. 1986.

Hawaiian Mission Children's Society Annual Report. 1920.

Men of Hawaii. Vol. 1. Honolulu: 1917.

Previous documentation on file (NPS):

- preliminary determination of individual listing (36 CFR 67) has been requested.
- previously listed in the National Register
- previously determined eligible by the National Register
- designated a National Historic Landmark
- recorded by Historic American Buildings Survey # _____
- recorded by Historic American Engineering Record # _____

Primary Location of Additional Data:

- State historic preservation office
- Other state agency
- Federal agency
- Local government
- University
- Other -- Specify Repository: _____

=====

10. Geographical Data

=====

Acreage of Property: 22 acres

UTM References: Zone Easting Northing Zone Easting Northing

A	04	<u>448790</u>	<u>2456720</u>	B	04	<u>448760</u>	<u>2456580</u>
C	04	<u>448800</u>	<u>2456460</u>	D	04	<u>448760</u>	<u>2456400</u>
E	04	<u>448660</u>	<u>2456360</u>	F	04	<u>448540</u>	<u>2456400</u>
G	04	<u>448550</u>	<u>2456470</u>	H	04	<u>448440</u>	<u>2456480</u>
I	04	<u>448460</u>	<u>2456600</u>	J	04	<u>448560</u>	<u>2456590</u>
K	04	<u>448570</u>	<u>2456720</u>				

See continuation sheet.

Verbal Boundary Description: See continuation sheet.

This nomination includes all the property owned by Patricia Sheehan in 1987 as described by Tax Map Keys 5-5-1: 18, 19, 20 21 and the portion of 5-5-1:02 as indicated by the red line on the attached map.

Boundary Justification: See continuation sheet.

This boundary encompasses all the property historically associated with the recreational aspects of the A.S. Wilcox beach house.

=====
11. Form Prepared By
=====

Name/Title: Patricia Sheehan

Organization: NA

Date: May 27, 1991

Street & Number: PO Box 81

Telephone: 808-826-6354

City or Town: Hanalei

State: HI ZIP: 96714

Approved by: Id. 21 App. 1180
P.K. & J.L.C. Nov. 1936.

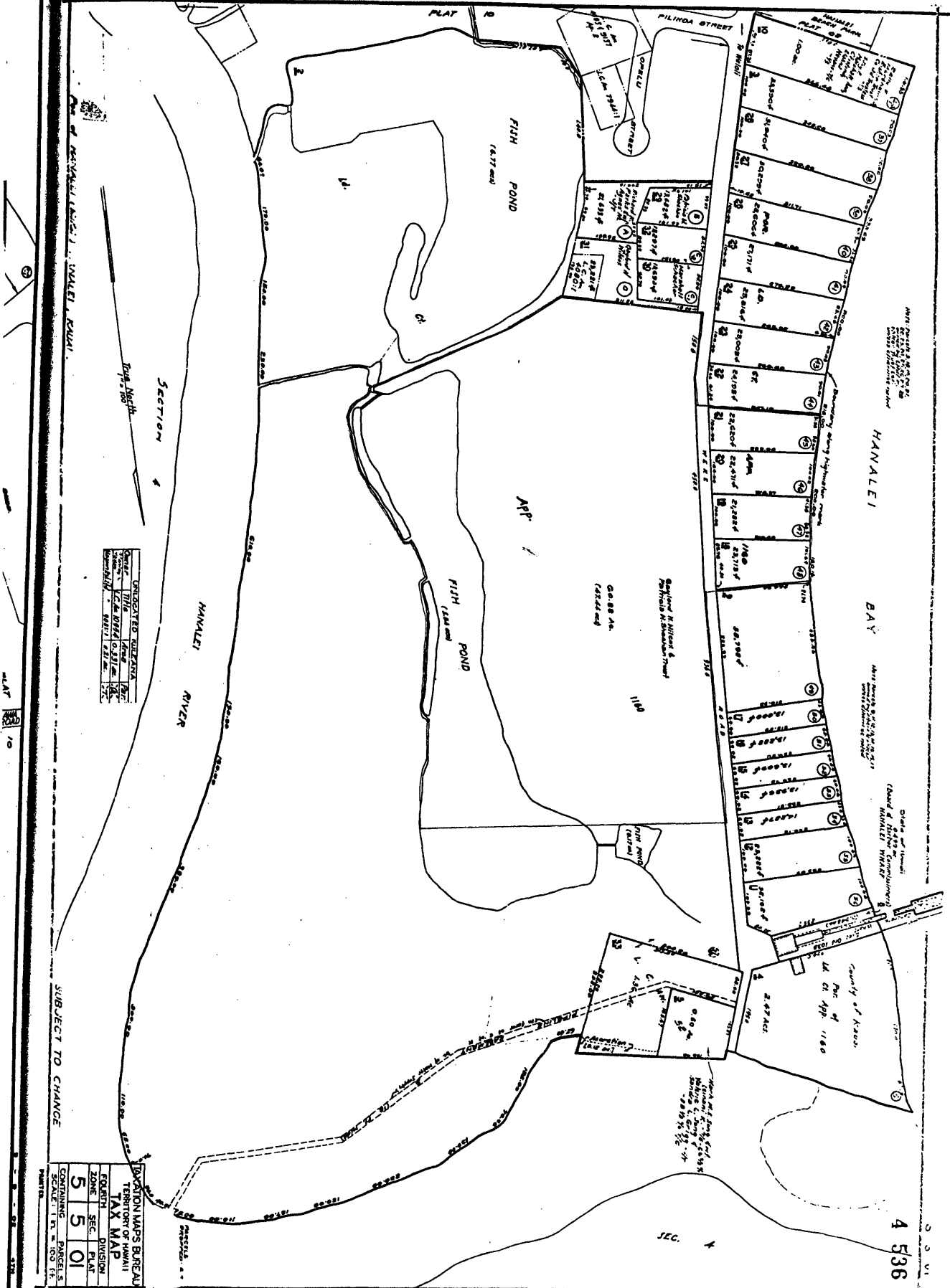

UNREGISTERED CERTAINLY

Owner	Id. 21 App. 1180
Recorder	Id. 21 App. 1180
Approved	Id. 21 App. 1180
Registered	Id. 21 App. 1180

SUBJECT TO CHANGE

TERMINATIONS BUREAU
 HONOLULU, HAWAII
 TAX MAP

ZONE	5
SEC.	5
DIVISION	01

CONTAINING PARCELS
 SCALE 1 IN. = 100 FT.
 PARTS