

STATE OF LOUISIANA, DEPARTMENT OF CULTURE,
RECREATION AND TOURISM: Division of
Archaeology and Historic Preservation,
P. O. Box 44247, Baton Rouge, La. 70804.
Phone (504) 389-5086
#6 on map

(Photo here)

I.
Parish Rienville
Municipality Gibsland
U.S.G.S. Quad _____
Township _____ Range _____ Section _____
Type of Property Church
Name (common) Mt. Lebanon Baptist Church
Name (historic) Same
Address Highway 154 (Mt. Lebanon Road),
vicinity of Gibsland
Present Owner Mt. Lebanon Baptist Church
Address Rt. 2
Gibsland, Louisiana
Date or period of construction 1857

- II.
1. Good to excellent local example of a building type x.
 2. Average example _____
 3. Poor example _____

III. Physical description of property and historical significance

Description: Large, square, pedimented frame church with pilasters at the corners and large square head windows. Front lancet windows, tower and interior beaver board paneling added in the early 20th century. Old pews remain complete with bar to separate men and women. Original structure is hewn. Adjacent modern school building excluded from boundaries.

Significance: This is a good representative example of the simple frame Greek Revival country churches which were built in many parts of the country during the 1840's and 50's. Although there have been modifications, the original building is still distinguishable. The modifications are typical of their own period and have acquired architectural value in their own right.

(over)

IV.
Recorded by Jonathan Fricker
Date June 1979
For _____ Nomination of
Architectural Resources of Mt. Lebanon

V. Sources consulted See item 9 on
Nomination form

INSTRUCTIONS

1. Please write your description and statement of significance to augment, not duplicate the photograph.
2. If you checked one of the boxes in Item 2 indicating that the Property is a good, fair, or poor example of a local type, please justify your choice.
3. Please describe or mention any notable or distinguishing features (i.e. decorative details, oddities or unusual characteristics).
4. Please mention briefly how the property is historically significant on the National, State or local level.

(cont'd)

On this site in 1848 the Louisiana Baptist Convention was organized. The present building was constructed in 1857. In 1874, the first Baptist Women's missionary Society was organized here.

6 Mt. Lebanon Baptist Church

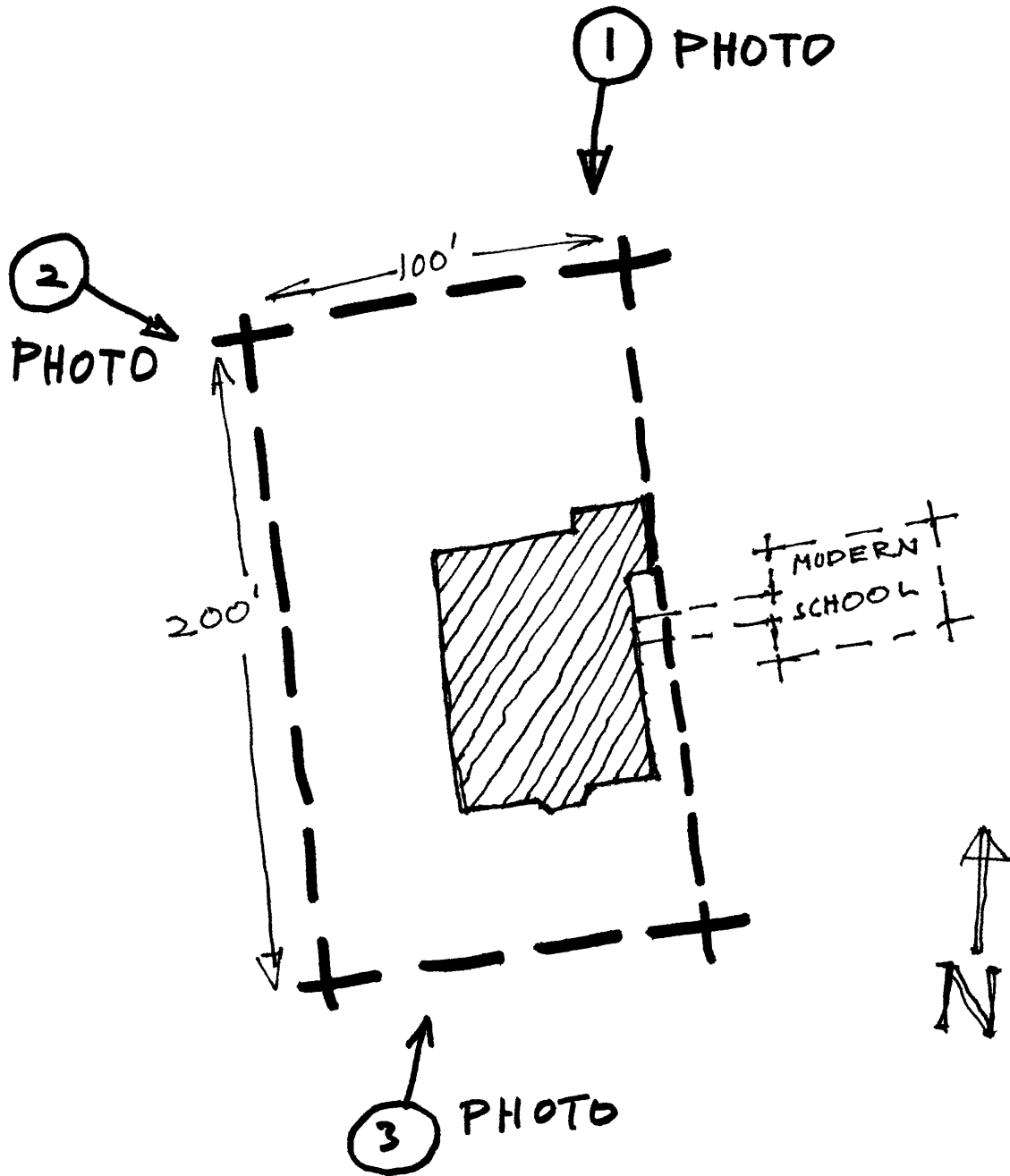

Approx 1/2 Acre

