

KENTUCKY HISTORIC RESOURCES INVENTORY

Js-153

1. Historic Name (s) <u>William C. Lowry house</u>		22. ADD/County <u>Bluegrass/Jessamine</u> <input type="checkbox"/> <input type="checkbox"/> <input type="checkbox"/>	
Original Owner <u>William C. Lowry</u>		23. Zoning Classification <u>Magisterial District</u>	
Present Name <u>Greenwood Farm</u>		24. U.S.G. S. Quadrant (15'/75') <u>Nicholasville</u>	
3. Owner's Name <u>Mrs. Alice Headley Chandler</u>		25. UTM Reference <u>16</u> <u>710080</u> <u>4200680</u> Zone Easting Northing	
4. Owner's Address <u>Bowmans Mill Pike, Lexington</u>		26. Prehistoric Site Historic Site <u>Building</u> Object Structure	
5. Location <u>W. side Rt. 68; 1/2 mile north of Rt. 169</u>		27. District Yes <input type="checkbox"/> No <input checked="" type="checkbox"/> Name:	
6. Open to Public Yes <input type="checkbox"/> No <input checked="" type="checkbox"/>	7. Visible from road Yes <input checked="" type="checkbox"/> No <input type="checkbox"/>	28. Significance Evaluation <u>National Register</u>	
9. Local Contact/Organization		29. Status National Landmark <input type="checkbox"/> National Register <input type="checkbox"/> Landmark Certificate <input type="checkbox"/> Kentucky Survey <input checked="" type="checkbox"/> <u>11/18/71</u> Local Landmark <input type="checkbox"/> HABS/HAER <input type="checkbox"/>	
10. Site Plan with North Arrow		30. Theme Primary <u>architecture</u> Secondary _____ Other _____	
11. Architect		31. Endangered Yes <input type="checkbox"/> No <input checked="" type="checkbox"/>	
12. Builder		32. ATTACH PHOTO	
13. Date <u>1st 1/4 19th century</u>		Roll No. <u>55</u>	
14. Style <u>Federal</u> <input type="checkbox"/> <input type="checkbox"/>		Picture No. _____	
15. Original Use <u>house</u>		Direction _____	
16. Present Use <u>house</u>		33. Tape No. _____ Negative No. _____	
17. Condition <input type="checkbox"/> <input type="checkbox"/> Interior _____ Exterior <u>good</u>		34. Prepared by: <u>NCP - KTG</u>	
18. Description <u>See Attached Sheet</u>		35. Organization <u>KHC</u>	
19. History <u>1877 atlas - Mrs. Neal 1871 Will Simpson purchased property from George Goods, who purchased property from William C. Lowry in 1861; Lowry owned prior to 1815.</u>		36. Date <u>summer 1977</u>	
20. Significance <u>Architecture: this house is a particularly good example of local Federal styling, featuring an unusual entrance portico, built of molded brick rather than wood, and a facade of six bays rather than the usual four or five.</u>		37. Revision Dates _____ 38. Staff Review _____	
21. Source of Information <u>1971 survey form.</u>			

KENTUCKY HISTORIC RESOURCE INVENTORY SUPPLEMENT
BOUNDARY AND LOCATION INFORMATION

Historic Property Name 1st C. Leary house Site # JK153
Multiple Resource/Thematic Nomination Title Jessamine Co

U.T.M. Coordinates - List multiple UTM's if property is ten or more acres.

A. 16 710 230 4200 650 D. 16 710 050 4200 940
B. 16 710 030 4200 490 E. _____
C. 16 709 780 4200 670 F. _____

Verbal Boundary Description _____ Acreage 26 acres

Site enclosed by A-B-C-D as shown
A-B is with US68, B-C is with an old fence
row, D-A is with a private road.

Sketch of Site Plan (Showing outbuildings, structures, landscape features and the site boundary as described above.)

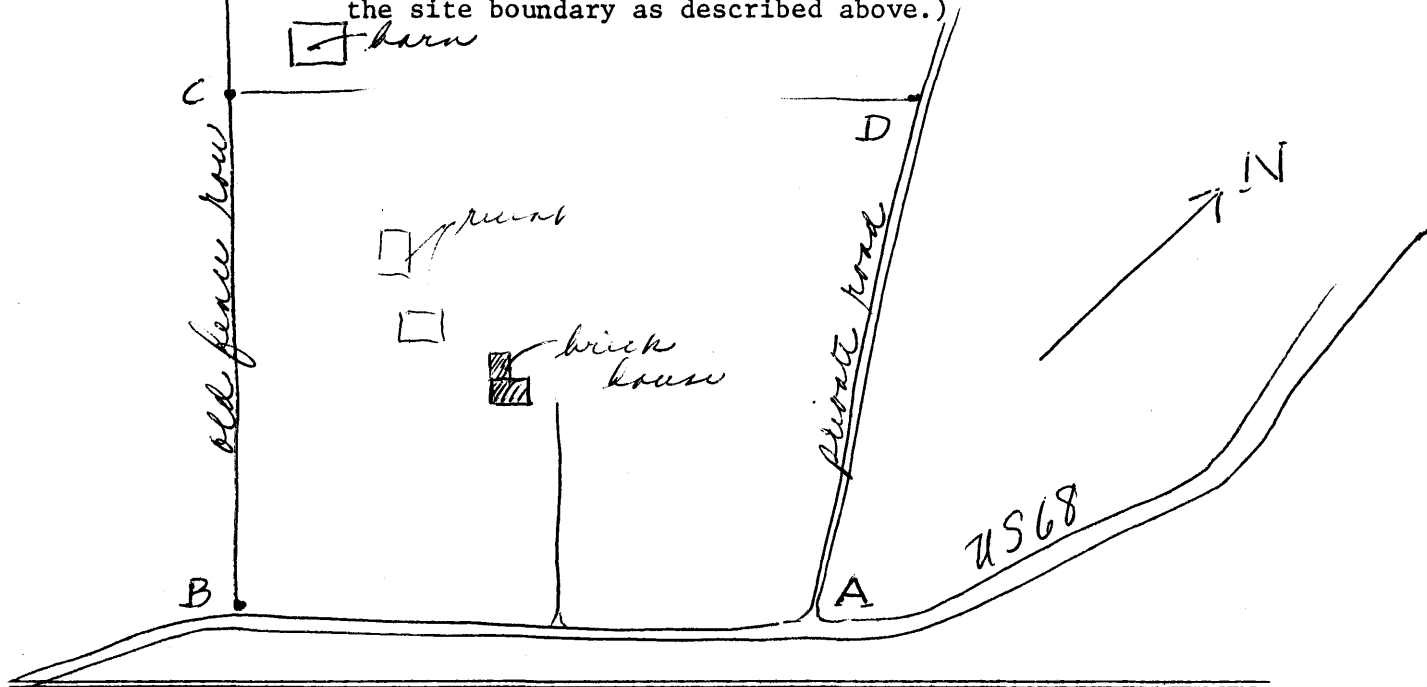

Official Courthouse Property Reference: