

**United States Department of the Interior  
Heritage Conservation and Recreation Service**

**National Register of Historic Places  
Inventory—Nomination Form**

See instructions in *How to Complete National Register Forms*  
Type all entries—complete applicable sections

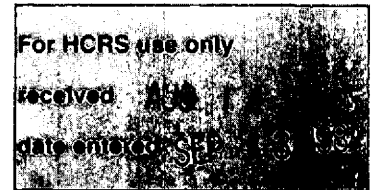

**1. Name**

historic Kaese Mill

and/or common Kaese Mill

**2. Location**

street & number Fish-Hatchery Road, N of Accident n/a not for publication

city, town Accident X vicinity of Sixth congressional district

state Maryland code 24 county Garrett code 023

**3. Classification**

Category	Ownership	Status	Present Use
<input type="checkbox"/> district	<input type="checkbox"/> public	<input type="checkbox"/> occupied	<input type="checkbox"/> agriculture
<input checked="" type="checkbox"/> building(s)	<input checked="" type="checkbox"/> private	<input checked="" type="checkbox"/> unoccupied	<input checked="" type="checkbox"/> commercial
<input type="checkbox"/> structure	<input type="checkbox"/> both	<input type="checkbox"/> work in progress	<input type="checkbox"/> educational
<input type="checkbox"/> site	<b>Public Acquisition</b>	<b>Accessible</b>	<input type="checkbox"/> entertainment
<input type="checkbox"/> object	<input type="checkbox"/> in process	<input type="checkbox"/> yes: restricted	<input type="checkbox"/> government
	<input type="checkbox"/> being considered	<input type="checkbox"/> yes: unrestricted	<input type="checkbox"/> industrial
	<input checked="" type="checkbox"/> not applicable	<input checked="" type="checkbox"/> no	<input type="checkbox"/> military
			<input type="checkbox"/> museum
			<input type="checkbox"/> park
			<input type="checkbox"/> private residence
			<input type="checkbox"/> religious
			<input type="checkbox"/> scientific
			<input type="checkbox"/> transportation
			<input type="checkbox"/> other:

**4. Owner of Property**

name Honorable Clifford and Mrs. Nellie Friend

street & number Route 2, Box 105

city, town Accident X vicinity of Maryland state 21520

**5. Location of Legal Description**

courthouse, registry of deeds, etc. Garrett County Courthouse

street & number Third and Alder Streets

city, town Oakland state Maryland 21550

**6. Representation in Existing Surveys**

title Coal Basin Historic Sites Survey  
Maryland Historical Trust has this property been determined eligible?  yes  no

date 1982  federal  state  county  local

depository for survey records Maryland Historical Trust, 21 State Circle

city, town Annapolis state Maryland 21401

# 7. Description

G-II-B-024

<b>Condition</b>		<b>Check one</b>	<b>Check one</b>	
<input type="checkbox"/> excellent	<input type="checkbox"/> deteriorated	<input checked="" type="checkbox"/> unaltered	<input checked="" type="checkbox"/> original site	
<input checked="" type="checkbox"/> good	<input type="checkbox"/> ruins	<input type="checkbox"/> altered	<input type="checkbox"/> moved	date <u>n/a</u>
<input type="checkbox"/> fair	<input type="checkbox"/> unexposed			

## Describe the present and original (if known) physical appearance

### Number of Resources

Contributing	Noncontributing
<u>1</u>	<u>0</u> buildings
<u>0</u>	<u>0</u> sites
<u>0</u>	<u>0</u> structures
<u>0</u>	<u>0</u> objects
<u>1</u>	<u>0</u> Total

Number of previously listed  
National Register properties: 0

Original and historic functions  
and uses: commercial, industrial

### DESCRIPTION SUMMARY:

Kaese Mill, constructed in 1868, is a two and one half story frame water powered grist mill located on the south side of Fish Hatchery Road near Accident in Garrett County, Maryland. It is powered by a twenty horsepower iron overshot wheel manufactured by the Fitz Water Wheel Company of Hanover, Pennsylvania. The wheel is sixteen feet in diameter and is located on the south elevation. The mill rests on a concrete and stone foundation and is three bays wide and four bays deep. Entrances are located on the north and west elevations and the windows all have 6/6 sash. The walls are covered with weatherboard siding and the steeply pitched gable roof with standing seam metal. A mill race runs from Bear Creek, east of the mill, under Fish Hatchery Road and directs water into a wooden flume which begins three hundred feet east of the mill. The flume was once supported by a wooden frame; this has been replaced with a fieldstone base. The mill, still occasionally used by the present owner to grind buckwheat, retains nearly all of its late nineteenth and early twentieth century equipment, including the French-made stone burrs with straight furrows, steel rollers, sifters, bolting reels, grain hoppers and a balance scale. In fact the Kaese Mill is virtually unchanged either on the exterior or in the interior and is in good condition and still functional. Only those parts of the machinery or exterior which were worn out were repaired or replaced.

**United States Department of the Interior  
Heritage Conservation and Recreation Service**

G-II-B-024

**National Register of Historic Places  
Inventory—Nomination Form**

Continuation sheet Kaese Mill Item number 7 Page 1  
Garrett County, Maryland

GENERAL DESCRIPTION:

Kaese Mill, built by the German immigrant miller Henry August Kaese in 1868, is a two and one half story frame water-powered grist mill located on Bear Creek, north of Accident in Garrett County, Maryland. The mill stands on the south side of Fish Hatchery Road near the junction with Collier Road in a rural and heavily wooded area.

The mill rests on a concrete and stone foundation which replaces the original foundation damaged by a W.P.A. road crew in the 1930s. The two and one half story frame building is three bays wide and four bays deep and faces north on Fish Hatchery Road. The walls are covered with unpainted weatherboard siding and the steeply pitched gable roof with standing seam metal. The windows all have 6/6 sash, although a few have been boarded up or knocked out. There is a large central opening on each story of the front facade through which grain and other supplies were hoisted by the mechanism located at the top gable. Entrances are located on the north and west elevations.

Kaese Mill is powered by a twenty horsepower iron overshot wheel manufactured by the Fitz Water Wheel Company of Hanover, Pennsylvania. This rim-leverage wheel, now kept uncovered, is a c. 1900 replacement of the original wooden wheel installed in 1868. The original cogs, wheels and mechanisms of the wheel were all wooden, but have been replaced by iron ones.

A mill race runs from Bear Creek, east of the mill, under Fish Hatchery Road and directs water into a wooden flume which begins three hundred feet east of the mill. The head race was originally supported on two wooden posts at the wheel but later had to be replaced on dry laid stones. The head is created naturally by the flow and direction of the Creek - no dam was necessary. There was no race built and the water simply flowed through a shallow ditch back out to the creek.

The mill itself is still operational, although now run only occasionally by the present owner to grind buckwheat. Much of the late nineteenth and early twentieth century machinery and milling equipment still remains, including the French-made stone burrs with straight furrows, steel roller mill, sifters, a gyrator, a bolting reel, grain chutes, hoppers and a balance scale. Several of the pieces of machinery still have the manufacturers' names on them. For example, the gyrator has the words "This Gyrator built by the Wolf Co., Chambersburg, Pa., Patented December 21, 1857," inscribed on its base and there is an inscription "American Bolting Reel" on the bolter.

The machinery is in good to excellent condition and has been only slightly altered since the turn of the 20th century. There has been some damage to the more fragile portions, however, i.e. squirrels have eaten some of the canvas chutes and the Japanese silk screening in the sifter is torn on some of the plates. The large rubber belts now used are replacements of the older worn out leather ones.

See Continuation Sheet No. 2

**United States Department of the Interior  
Heritage Conservation and Recreation Service**

**National Register of Historic Places  
Inventory—Nomination Form**

Continuation sheet      Kaese Mill  
Garrett County, Maryland      Item number      7      Page      2

---

GENERAL DESCRIPTION (continued)

The lumber used in the construction of Kaese Mill was sawn at a small water-powered saw mill located near the original mill pond approximately halfway between the present mill and Bear Creek. No above-ground remains of the saw are still standing, however.

# 8. Significance

G-II-B-024

Period	Areas of Significance—Check and justify below			
<input type="checkbox"/> prehistoric	<input type="checkbox"/> archeology-prehistoric	<input type="checkbox"/> community planning	<input type="checkbox"/> landscape architecture	<input type="checkbox"/> religion
<input type="checkbox"/> 1400-1499	<input type="checkbox"/> archeology-historic	<input type="checkbox"/> conservation	<input type="checkbox"/> law	<input type="checkbox"/> science
<input type="checkbox"/> 1500-1599	<input type="checkbox"/> agriculture	<input type="checkbox"/> economics	<input type="checkbox"/> literature	<input type="checkbox"/> sculpture
<input type="checkbox"/> 1600-1699	<input checked="" type="checkbox"/> architecture	<input type="checkbox"/> education	<input type="checkbox"/> military	<input type="checkbox"/> social/ humanitarian
<input type="checkbox"/> 1700-1799	<input type="checkbox"/> art	<input checked="" type="checkbox"/> engineering	<input type="checkbox"/> music	<input type="checkbox"/> theater
<input checked="" type="checkbox"/> 1800-1899	<input checked="" type="checkbox"/> commerce	<input type="checkbox"/> exploration/settlement	<input type="checkbox"/> philosophy	<input type="checkbox"/> transportation
<input type="checkbox"/> 1900-	<input type="checkbox"/> communications	<input checked="" type="checkbox"/> industry	<input type="checkbox"/> politics/government	<input type="checkbox"/> other (specify)
		<input type="checkbox"/> invention		

**Specific dates** 1868 **Builder/Architect** Henry August Kaese, Sr.

### Statement of Significance (in one paragraph)

Applicable Criteria: A, C  
Applicable Exceptions: none  
Level of Significance for Evaluation: state

### SIGNIFICANCE SUMMARY:

The Kaese Mill near Accident in Garrett County is the only fully operational water powered grist mill in Maryland.

It is unaltered, in good operating condition and displays a virtual museum of mill machinery inside. It was built in 1868 by Henry August Kaese, Sr., an immigrant miller from Germany who settled in Garrett County shortly after the Civil War. Kaese Mill, like many of the other flour and grist mills which once stood throughout Garrett County, was once an important economic and trading center. Many of these mills were also centers of social and political life in their immediate areas by virtue of the fact that they served as U. S. Post Offices. Kaese Mill alternated this honor for many years with the Engles Mill which once stood nearby, depending on which political party was in power. The mill is still operated by descendants of Henry Kaese.

# 9. Major Bibliographical References

G-II-B-024

- McGrain, John W., Jr. The Molinography of Maryland. 1971. Unpublished manuscript on file at the Maryland Historical Trust.
- Schlosnagle, Stephen. Garrett County: A History of Maryland's Tableland. (Parson's W. Va.: McClain Printing Co., 1978).

# 10. Geographical Data

Acreeage of nominated property Approximately 7 acres

Quadrangle name Accident, Maryland

Quadrangle scale 1:24,000

### UMT References

A 

1	7
---	---

6	4	6	6	1	0
---	---	---	---	---	---

4	3	9	0	0	3	0
---	---	---	---	---	---	---

  
Zone Easting Northing

B 

1	7
---	---

6	4	6	0	5	0
---	---	---	---	---	---

4	3	9	0	0	8	0
---	---	---	---	---	---	---

  
Zone Easting Northing

C 

1	7
---	---

6	4	5	6	8	0
---	---	---	---	---	---

4	3	9	0	3	7	0
---	---	---	---	---	---	---

D 

--	--

--	--	--	--	--	--

--	--	--	--	--	--	--

E 

--	--

--	--	--	--	--	--

--	--	--	--	--	--	--

F 

--	--

--	--	--	--	--	--

--	--	--	--	--	--	--

G 

--	--

--	--	--	--	--	--

--	--	--	--	--	--	--

H 

--	--

--	--	--	--	--	--

--	--	--	--	--	--	--

### Verbal boundary description and justification

See Continuation Sheet No. 4.

### List all states and counties for properties overlapping state or county boundaries

state	n/a	code	county	code
-------	-----	------	--------	------

state	code	county	code
-------	------	--------	------

# 11. Form Prepared By

name/title Geoffrey Henry with contributions by Donna Ware

organization Maryland Historical Trust date 1984

street & number 21 State Circle telephone (301) 269-2438

city or town Annapolis state Maryland 21401

# 12. State Historic Preservation Officer Certification

The evaluated significance of this property within the state is:

national  state  local

As the designated State Historic Preservation Officer for the National Historic Preservation Act of 1966 (Public Law 89-665), I hereby nominate this property for inclusion in the National Register and certify that it has been evaluated according to the criteria and procedures set forth by the Heritage Conservation and Recreation Service.

State Historic Preservation Officer signature *JAW Ah* 8-8-84

title STATE HISTORIC PRESERVATION OFFICER date

For HCRS use only	
I hereby certify that this property is included in the National Register	
<u><i>J. Allover Byers</i></u> Keeper of the National Register	Entered in the National Register date <u>9-13-84</u>
Attest:	date
Chief of Registration	

**United States Department of the Interior  
Heritage Conservation and Recreation Service**

**National Register of Historic Places  
Inventory—Nomination Form**

Continuation sheet Kaese Mill Garrett County, Maryland Item number 8 Page 3

HISTORY AND SUPPORT:

The Kaese Mill near Accident in Garrett County is significant as the only fully operational water-powered grist mill in Maryland as well as one of the oldest mills of any kind in the state. Although there are several functioning grist mills still standing in Maryland, such as Wye Mill in Talbot County, Stanton's Mill in Garrett County, Rockland Mills in Baltimore County and others, these have either been converted to other forms of power or are presently used as museums. Kaese Mill is therefore an important example of a commercial enterprise once very common in Garrett County and Maryland.

Probably the earliest mill built in what is now Garrett County was Vrooman's (Froman's) Mill which was erected near the mouth of Mill Run in 1774. Vrooman's Mill, the first of two flour mills, eight sawmills, and one woolen factory to be built in the nineteenth century on Mill Run, featured an overshot water wheel and a mechanical blower for winnowing. Gristmills were built throughout the nineteenth century in such rural communities as Swanton, Grantsville and Selbysport and formed the basis of such towns as Kitzmiller and Oakland, the future county seat. Of these nearly two dozen mills, only the Kaese Mill and Stanton's Mill near Grantsville (listed in the National Register) still stand.

Early nineteenth century Garrett County gristmills served vital functions in self-subsistent agrarian frontier communities. The traffic they generated often provided virtually the only contact isolated farmers had with the outside world and were sometimes constructed through an agreement with small groups of farmers who considered the convenient siting of a mill a practical necessity. Due to the scarcity of money the millers of the early nineteenth century in Garrett County customarily retained a portion of grain from each bushel brought in as a standard "toll" for their services. Mills were therefore an important part of the barter economy of early nineteenth century Garrett County.

Mills were also centers of community activities. Not only were they meeting places for the exchange of news, but they also served as area trading posts for bartered goods. For many years, Kaese's Mill and nearby Engle's Mill competed both commercially and politically. Both communities served as U. S. Post Offices, but the location changed depending on which party was in office: Kaese Mill when the Democrats were in power and Engle's Mill when the Republicans held office.

Henry August Kaese, the founder of Kaese Mill, was an immigrant German miller who moved to Western Maryland with his wife in the 1850s. Before settling in the Accident vicinity, he operated grist mills in West Virginia and at Borden Shaft, in Allegany County, Maryland. For a few years he worked at the aforementioned Engle's Mill before building his own mill and home on newly cleared farmland.

**United States Department of the Interior  
Heritage Conservation and Recreation Service**

**National Register of Historic Places  
Inventory—Nomination Form**

Kaese Mill

Continuation sheet Garrett County, Maryland

Item number 8 and 10

Page 4

HISTORY AND SUPPORT (continued)

A sawmill was first built on the flood plain just below the mill to supply the lumber for the construction of the grist mill. While the grist mill was under construction Kaese lived in a small house which now stands in back of the present owner's home. When the gristmill was completed a larger frame house was constructed about where the driveway now exists. When the present owners built their home they razed the old house.

Although the mill is now only operated infrequently by Senator Friend, Kaese Mill in its heyday once employed between five and six men on two shifts working both day and night. Unlike most other gristmills still standing in the state, it is privately owned and not operated as a museum.

10. VERBAL BOUNDARY DESCRIPTION:

Boundaries are depicted on the attached plat, and are defined by Fish Hatchery Road on the north and east, Maryland Route 219 on the west, and Bear Creek on the south.

BOUNDARY JUSTIFICATION:

The nominated property, approximately 7 acres, encompasses the resource within its immediate setting and maintains its historic orientation to Bear Creek and Fish Hatchery Road.



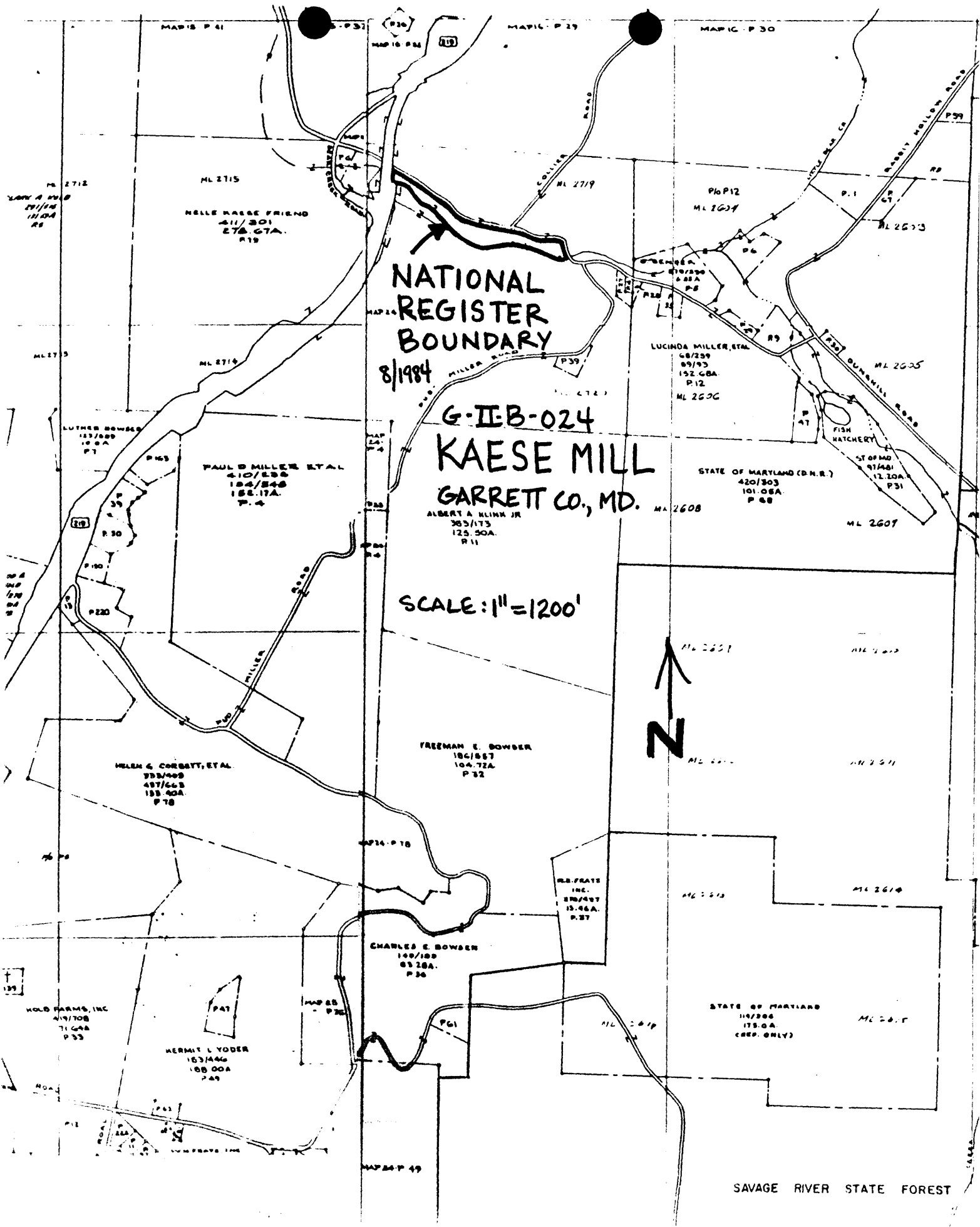

**NATIONAL REGISTER BOUNDARY**

8/1984

**G-II-B-024  
KAESE MILL  
GARRETT CO., MD.**

SCALE: 1" = 1200'

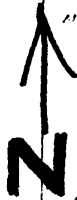

Savage River State Forest

BASE MAP CONSTRUCTED

MAP 15 P 41

MAP 16 P 29

MAP 17 P 30

ML 2712  
LARRY A. WOOD  
211/201  
121.00A  
P 8

ML 2715  
NELLE KAESSE FRIEND  
411/301  
278.07A.  
P 19

P10P12  
ML 2624

ML 2623

ML 2713

ML 2714

ML 2719

ML 2625

LUTHER BOWSER  
127/000  
10.00A  
P 7

PAUL MILLER ETAL  
410/200  
184/240  
158.17A.  
P. 4

LUCINDA MILLER, ETAL  
68/299  
89/93  
152.00A.  
P. 12  
ML 2620C

STATE OF MARYLAND (D.N.R.)  
420/303  
101.00A.  
P. 88

STATE OF MARYLAND (D.N.R.)  
91/481  
12.20A.  
P. 31

ALBERT A. KLING JR.  
383/173  
125.50A.  
P. 11

ML 2608

ML 2607

SCALE: 1" = 1200'

ML 2601

ML 2602

HELEN G. CORBETT, ETAL.  
938/000  
497/663  
153.00A.  
P. 78

FREEMAN E. BOWSER  
104/887  
104.72A.  
P. 32

ML 2611

ML 2610

GR. FRATE  
INC.  
820/497  
15.46A.  
P. 27

ML 2613

ML 2614

CHARLES E. BOWSER  
100/100  
83.20A.  
P. 30

ML 2619

STATE OF MARYLAND  
119/206  
175.00A.  
CRSP. ONLY

ML 2615

WOLD FARMS, INC.  
419/708  
71.00A  
P. 33

HERMIT L. YODER  
163/446  
100.00A  
P. 49

MAP 25 P 28

MAP 24 P 49

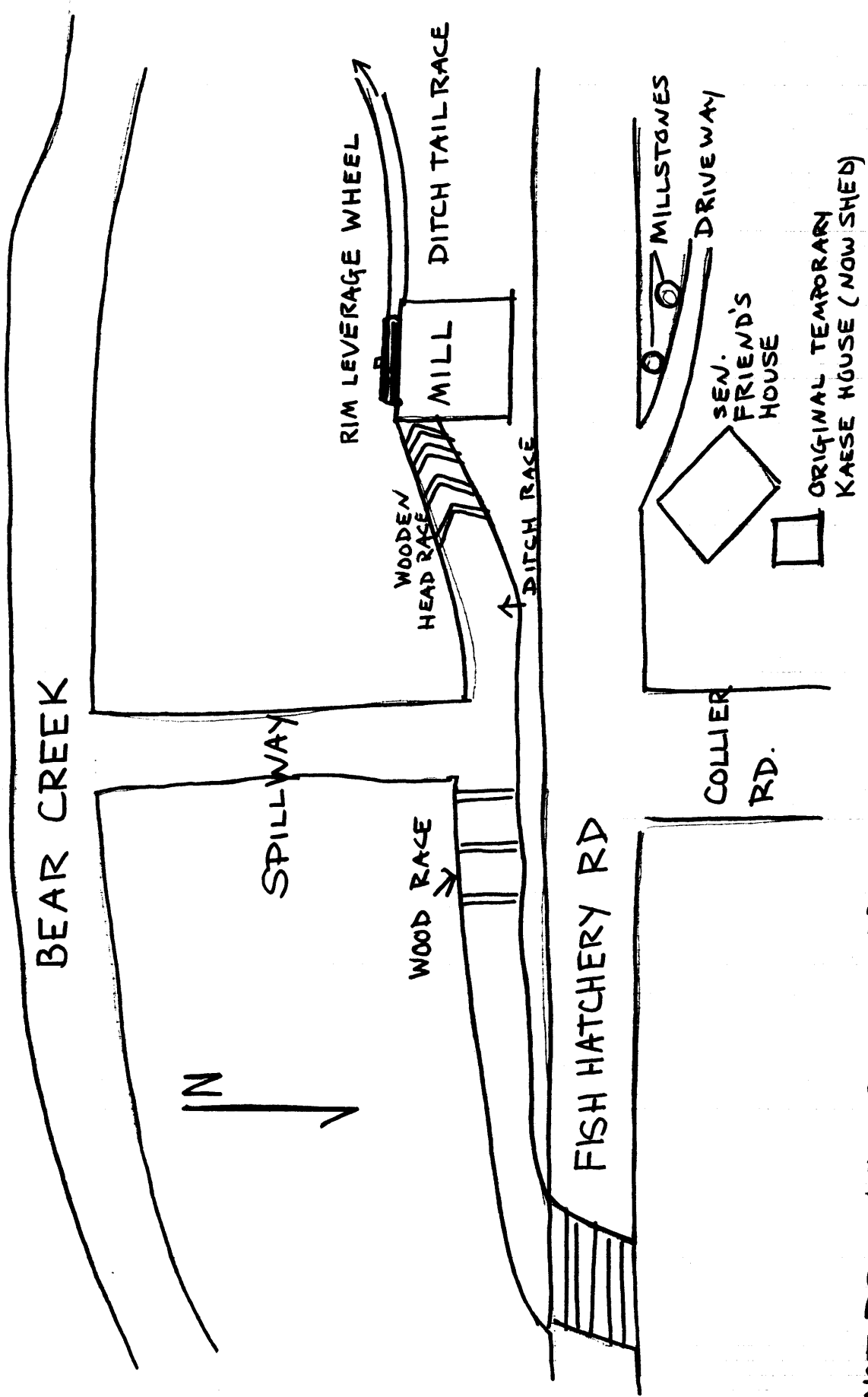

NOT DRAWN TO SCALE GBH / 84

G-11-B-024

KAESE GRISTMILL, ACCIDENT VIC. GARRETT CO, MD.