

United States Department of the Interior
National Park Service

National Register of Historic Places Inventory—Nomination Form

For NPS use only
received **AUG 25 1983**
date entered **SEP 22 1983**

See instructions in *How to Complete National Register Forms*
Type all entries—complete applicable sections

1. Name

historic Beauregard Parish Courthouse

and/or common Same

2. Location

street & number First Street 1st St. N/A not for publication

city, town DeRidder N/A vicinity of

state LA code 22 x parish Beauregard x county code 011

3. Classification

Category	Ownership	Status	Present Use
<input type="checkbox"/> district	<input checked="" type="checkbox"/> public	<input checked="" type="checkbox"/> occupied	<input type="checkbox"/> agriculture
<input checked="" type="checkbox"/> building(s)	<input type="checkbox"/> private	<input type="checkbox"/> unoccupied	<input type="checkbox"/> commercial
<input type="checkbox"/> structure	<input type="checkbox"/> both	<input type="checkbox"/> work in progress	<input type="checkbox"/> educational
<input type="checkbox"/> site	Public Acquisition	Accessible	<input type="checkbox"/> entertainment
<input type="checkbox"/> object	<u>N/A</u> in process	<input checked="" type="checkbox"/> yes: restricted	<input checked="" type="checkbox"/> government
	<u>N/A</u> being considered	<input type="checkbox"/> yes: unrestricted	<input type="checkbox"/> industrial
		<input type="checkbox"/> no	<input type="checkbox"/> military
			<input type="checkbox"/> museum
			<input type="checkbox"/> park
			<input type="checkbox"/> private residence
			<input type="checkbox"/> religious
			<input type="checkbox"/> scientific
			<input type="checkbox"/> transportation
			<input type="checkbox"/> other:

4. Owner of Property

name Beauregard Parish Police Jury

street & number P. O. Box 310

city, town DeRidder N/A vicinity of state LA 70634

5. Location of Legal Description

courthouse, registry of deeds, etc. Beauregard Parish Courthouse

street & number First Street (no specific address) P. O. Box 310

city, town DeRidder state LA 70634

6. Representation in Existing Surveys

title LA Historic Sites Survey has this property been determined eligible? yes no

date 1983 federal state county local

depository for survey records LA State Historic Preservation Office

city, town Baton Rouge state LA

7. Description

Condition		Check one	Check one	
<input type="checkbox"/> excellent	<input type="checkbox"/> deteriorated	<input type="checkbox"/> unaltered	<input checked="" type="checkbox"/> original site	
<input checked="" type="checkbox"/> good	<input type="checkbox"/> ruins	<input checked="" type="checkbox"/> altered	<input type="checkbox"/> moved	date <u>N/A</u>
<input type="checkbox"/> fair	<input type="checkbox"/> unexposed			

Describe the present and original (if known) physical appearance

The Beauregard Parish Courthouse (1914) is a three-story brick Beaux Arts style building located on a landscaped square near the old DeRidder central business district. The courthouse has been somewhat altered since construction, but it retains its National Register eligibility.

The building consists of a three-story main block with a pair of two-story side wings, all of which is set on an English basement. Each of the two main elevations has a massive two-story coupled Ionic columnar loggia which is approached via flights of granite steps. Each loggia is surmounted by an oversized parapet which contains the third story of the main block. This parapet is surmounted by a second inner parapet which in turn is surmounted by a high drum and a square dome. Overall, the courthouse reaches a height of six stories at the apex of the dome. Each of the side wings has a secondary wing protruding from the end. This yields a total of six receding planes which make up each of the main fronts of the courthouse. The columns and all of the trim are of white glazed terra cotta.

The courthouse is entered through an octagonal lobby with axial corridors which run to the ends of the building. The courtroom is a two-story space which occupies the second and third stories of the main block. At one time the dome and lantern were part of the courtroom space, but in 1960 the courtroom ceiling was lowered, thus obscuring the upper part of the room.

The only other major change in the building has been the modernizing of some of the offices.

Assessment of Integrity:

Despite these interior changes, the courthouse still retains its architectural integrity. Its status as a landmark is entirely dependent upon its exterior, which remains intact. The exterior embodies all of the Beaux Arts characteristics which establish the courthouse as an example of that style. These include the coupled colossal columns, the elaborate symmetrical massing, the use of receding planes in the facade composition, and the relative profusion of classical details.

8. Significance

Period	Areas of Significance—Check and justify below			
<input type="checkbox"/> prehistoric	<input type="checkbox"/> archeology-prehistoric	<input type="checkbox"/> community planning	<input type="checkbox"/> landscape architecture	<input type="checkbox"/> religion
<input type="checkbox"/> 1400-1499	<input type="checkbox"/> archeology-historic	<input type="checkbox"/> conservation	<input type="checkbox"/> law	<input type="checkbox"/> science
<input type="checkbox"/> 1500-1599	<input type="checkbox"/> agriculture	<input type="checkbox"/> economics	<input type="checkbox"/> literature	<input type="checkbox"/> sculpture
<input type="checkbox"/> 1600-1699	<input checked="" type="checkbox"/> architecture	<input type="checkbox"/> education	<input type="checkbox"/> military	<input type="checkbox"/> social/
<input type="checkbox"/> 1700-1799	<input type="checkbox"/> art	<input type="checkbox"/> engineering	<input type="checkbox"/> music	<input type="checkbox"/> humanitarian
<input type="checkbox"/> 1800-1899	<input type="checkbox"/> commerce	<input type="checkbox"/> exploration/settlement	<input type="checkbox"/> philosophy	<input type="checkbox"/> theater
<input checked="" type="checkbox"/> 1900-	<input type="checkbox"/> communications	<input type="checkbox"/> industry	<input type="checkbox"/> politics/government	<input type="checkbox"/> transportation
		<input type="checkbox"/> invention		<input type="checkbox"/> other (specify)

Specific dates 1914 **Builder/Architect** Architects: Stevens and Nelson, New Orleans

Statement of Significance (in one paragraph) Criterion C

The Beauregard Parish Courthouse is locally significant in the area of architecture as the architectural landmark of Beauregard Parish. Its opulent Beaux Arts design is in sharp contrast to the fairly ordinary early-twentieth century one and two story commercial buildings and frame residences which make up the bulk of the parish's patrimony. It is easily Beauregard Parish's largest fifty plus year old building, as well as the only example of a domed structure with classical details. It is also the only building in the parish with colossal order columns. All in all, the courthouse reflects the prevailing neo-classical tendencies of early-twentieth century America more than any other of the parish's historic structures.

Historical Note:

Beauregard Parish was created in 1912 and the present building is the parish's first and only courthouse.

9. Major Bibliographical References

Brasseaux, Carl A., Conrad, Glenn R., and Robinson, R. Warren, The Courthouses of Louisiana. Lafayette, LA: Center for Louisiana Studies, University of Southwestern Louisiana, 1977.

10. Geographical Data

Acreeage of nominated property approximately 1 acre

Quadrangle name DeRidder, LA

Quadrangle scale 1:62,500

UTM References

A

1	5	4	7	2	5	5	0	3	4	1	2	4	0	0
Zone	Easting				Northing									

B

Zone	Easting				Northing									

C

Zone	Easting				Northing									

D

Zone	Easting				Northing									

E

Zone	Easting				Northing									

F

Zone	Easting				Northing									

G

Zone	Easting				Northing									

H

Zone	Easting				Northing									

Verbal boundary description and justification

Please refer to attached sketch map.

List all states and counties for properties overlapping state or county boundaries

state N/A code county code

state code county code

11. Form Prepared By

name/title National Register Staff ASSISTED BY LU HANCOCK
Division of Historic Preservation 1312A Blankenship Dr.
organization State of Louisiana date July 1983 DeRidder, LA 70634
P. O. Box 44247 telephone (504) 342-6682
Baton Rouge state LA 70804

12. State Historic Preservation Officer Certification

The evaluated significance of this property within the state is:

national state local

As the designated State Historic Preservation Officer for the National Historic Preservation Act of 1966 (Public Law 89-665), I hereby nominate this property for inclusion in the National Register and certify that it has been evaluated according to the criteria and procedures set forth by the National Park Service.

State Historic Preservation Officer signature

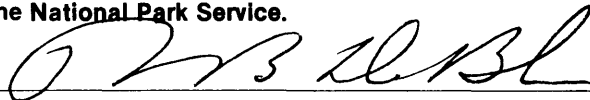

Robert B. DeBlieux date August 15, 1983

title State Historic Preservation Officer

For NPS use only

I hereby certify that this property is included in the National Register

Entered in the
National Register

date 9/22/83

[Signature]
Keeper of the National Register

Attest:

date

Chief of Registration

THE WESTERN
BOUNDARY PARALLELS
THE WEST ELEVATION
OF THE BUILDING AT
A DISTANCE OF 5'
AS SHOWN.

↔ 5' : refers to
distance between
west wall +
boundary

--- boundary line

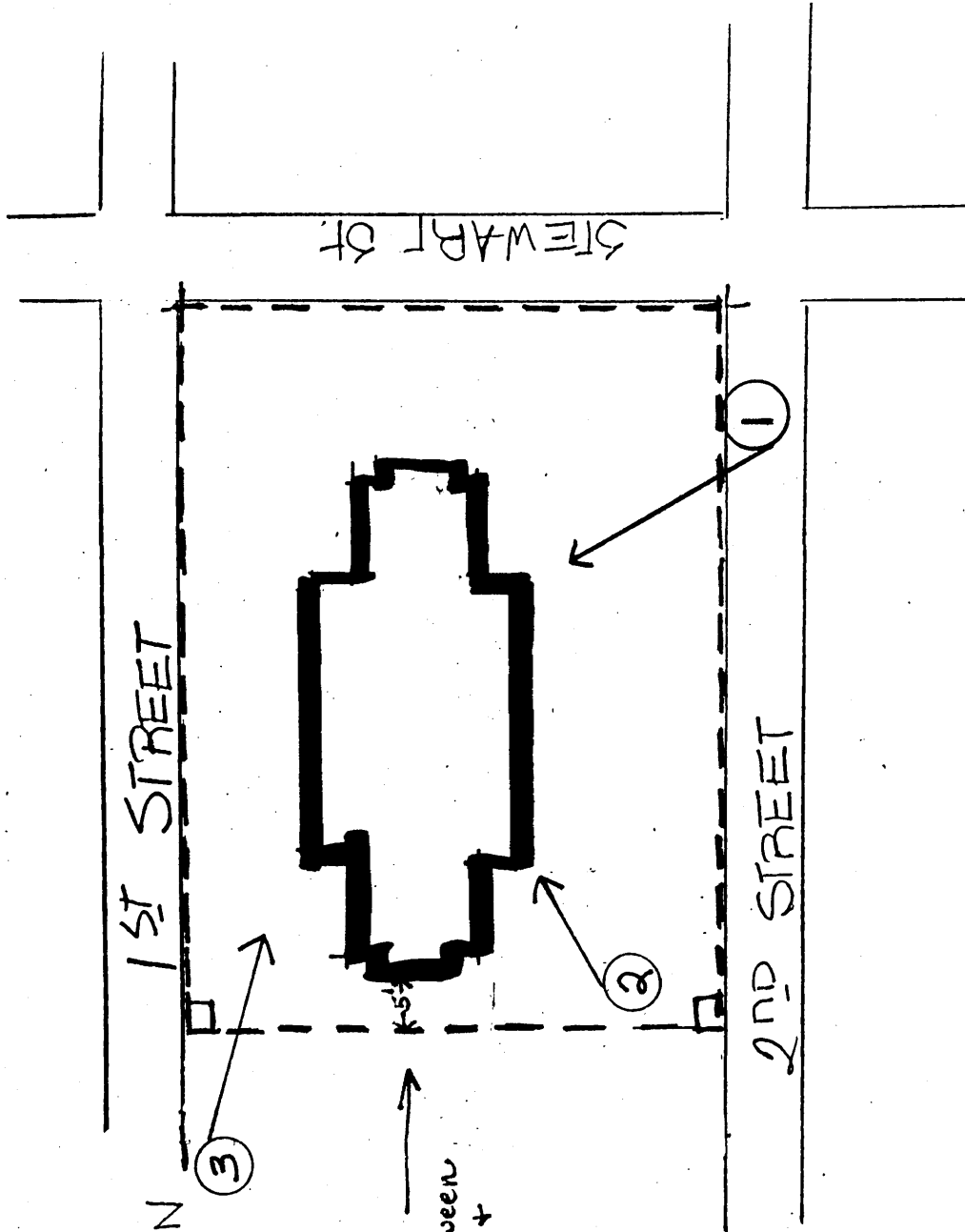

BEAUREGARD PARISH
COURTHOUSE, DE RIDDER

