

DEC 29 1988

3354

KENTUCKY HISTORIC RESOURCES
Individual Inventory Form

Resource # Mer-90
Mercer County

1. Name of Resource: Bonta House

2. Original Owner: A. B. Bonta

3. Other Names: Highland Home

4. Prehistoric Site Building Object
Historic Site Structure Other

5. Location: West side of US 127 between James Lane and Adams Lane

6. Owner's Name: Dr. Bacon R. Moore III [P]

7. Owner's Address: Danville Road
Harrodsburg, Kentucky 40330

8. Evaluation: National Register [N]

9. Recognition & Date:
Nat.Landmark _____ Local Landmark _____
Nat.Register _____ HABS/HAER _____
Highway Marker _____ KY Inventory 1970/1981
KY Landmark Certificate 1974

10. N.R.Status & Date:

11. N.R.Group:
District Name: []
Mult.Resource Area: Mercer County []
Thematic Name: []

12. Historical Theme:
Primary: Architecture [030]
Secondary: []
Other: []

13. Statement of Significance:
See Attached.

16. Date: Original Building 1881 [5]
Addition []

17. Style: Italianate [42]
[]

18. Architect/Builder: Unknown

19. No. of Stories: Two [2.0]

20. Original Floor Plan: T-plan [TP]

21. Single Pile Double Pile N.A.

22. Roof Form & Material: Original _____
Low hip/asbestos Not Original X

23. Structural Material: Brick [B]

24. Exterior Material: Brick :common bond [B]
[]

25. Foundation Material: Stone [S]

26. Major Alterations: None
Moved/Rebuilt Other modification
Additions of porch floors

27. Special Features: None

28. Outbuildings: Garage/non-contributing []

29. Original Function: Single family dwelling [01A]

30. Present Use: Single family dwelling [01A]

31. Condition: Good [G]

32. Endangered: Yes _____
No X

33. Attach Photos:
Roll: Photo Nos: No. of Slides:
12 9-14



14. History: KHC form: 1981, Clay Lancaster

15. Source of historical information and/or contact person:

34. Prepared by: F. Keightly and H. Powell

35. Organization: Landmark Association

36. Date: 1986

37. New Survey _____ Resurvey X

KENTUCKY HISTORIC RESOURCES
Individual Inventory Form

Resource # Me -90

38. UTM Point of Primary Building:	Zone	Easting	Northing	39. G.I.S. Mod.	[]
Quadrant: <u>Danville</u>	<u>16</u>	<u>692260</u>	<u>4176760</u>	40. Coordi.Accuracy	[]

41. UTM Points of Boundary (for N. R. eligible sites only):

A.	--	-----	-----	D.	--	-----	-----
B.	--	-----	-----	E.	--	-----	-----
C.	--	-----	-----	F.	--	-----	-----

42. Total Acreage in Present Property: 43. Acreage included in proposed N.R. boundary:

44. Site Plan (and boundary description and justification for N.R. sites):

See attached

45. Description and House Plan:

The Bonta House is a two-story brick residence built in the Italianate style. The original front facade is three bay. The right bay projects in the manner of a T-plan, creating space for a one-story porch which covers the remaining window and door on the front facade. The porch was executed with an arcade motif. Windows are elongated and segmentally arched with stone lintels instead of hood moldings. The low hip roof overhangs the eaves and is supported by brackets. A polygonal bay window projects from the downstairs parlor. The house has a stone foundation. The porch on the rear of the house has been enclosed for a garage. There are also two non-contributing metal sheds used for storage near the rear of the house. See the boundary description for location and size of these, as well as that of the ice house ruins.



KENTUCKY HISTORIC RESOURCE INVENTORY SUPPLEMENT
BOUNDARY AND LOCATION INFORMATION

Historic Property Name Bonta House Site # Me-90
Multiple Resource/Thematic Nomination Title MERCER COUNTY MRA

U.T.M. Coordinates - List multiple UTM's if property is ten or more acres.

A. _____ D. _____
B. _____ E. _____
C. _____ F. _____

Verbal Boundary Description Acreage 1.31

From the northeast corner of the house, 75 feet east and 200 feet north is the point of beginning. Then 200 feet west to a point; then 305 feet south to a point; then 175 feet east to a point; then 305 feet north to the point of beginning.

Sketch of Site Plan (Showing outbuildings, structures, landscape features and the site boundary as described above.)

* POINT OF BEGINNING

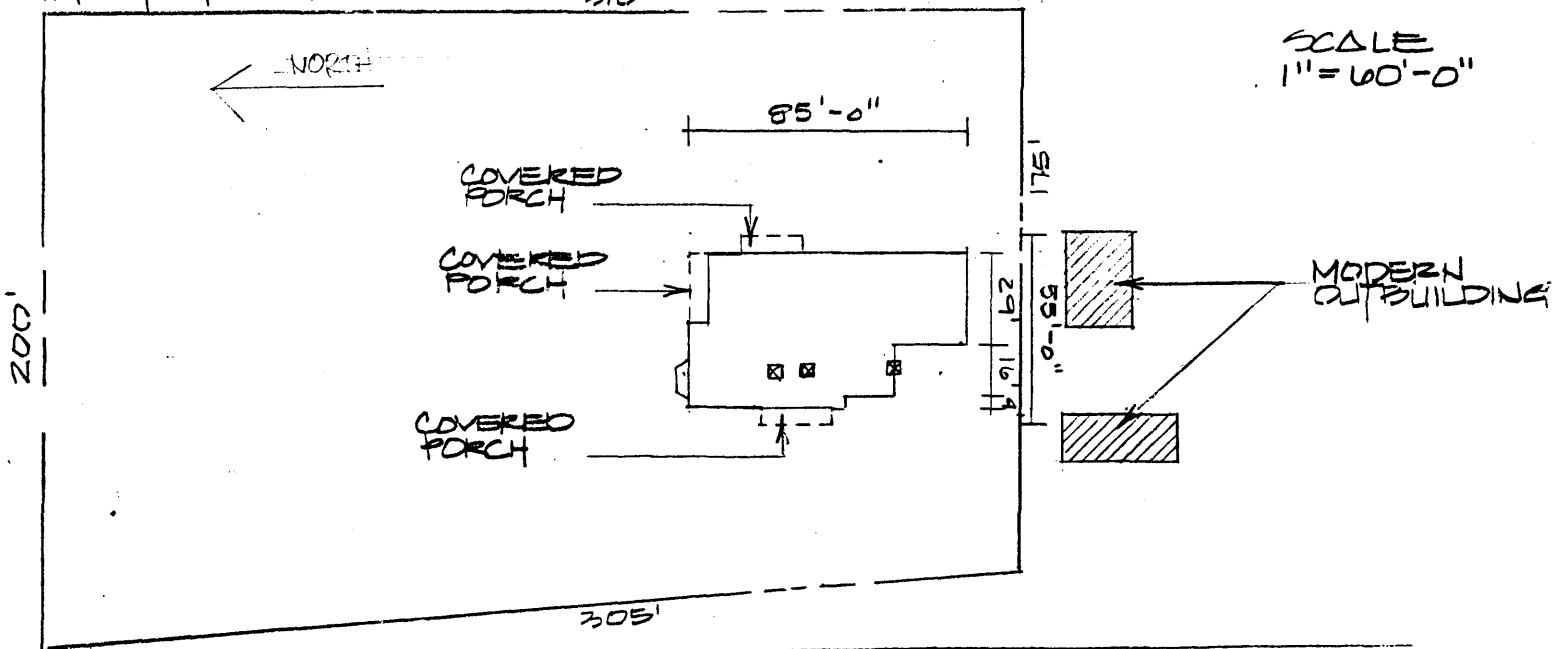

Official Courthouse Property Reference:

Continuation Sheet: Me-90 A.B. Bonta House

Significance Statement

The A. B. Bonta House is significant under Criterion C as an example of how the late nineteenth century builders in Mercer County used the T-plan to achieve the multi-planed effects popular for Victorian styles on a national level. The Bonta House also demonstrates the use of Italianate-style detailing on a domestic structure with the elongated windows capped by hood moldings, wide eaves with brackets as well as local access to pattern-book detailing in the porch friezes.

Verbal Boundary Justification

The boundary was chosen arbitrarily to provide a minimal setting for the house. The outbuildings were excluded because they are of recent construction and are non-contributing.

The boundary includes one contributing building.