

United States Department of the Interior National Park Service
NATIONAL REGISTER OF HISTORIC PLACES REGISTRATION
FORM

1. Name of Property

historic name: Rosemont Historic District

other name/site number: _____

2. Location

street & number: Tennessee, Illinois, Georgia, Kentucky Aves.

not for publication: N/A

city/town: Martinsburg

vicinity: _____

state: WV

county: Berkeley

code: 003

zip code: 25401

3. State/Federal Agency Certification

As the designated authority under the National Historic preservation Act, as amended, I hereby certify that this nomination request for determination of eligibility meets the documentation standards for registering properties in the National Register of Historic Places and meets the procedural and professional requirements set forth in 36 CFR Part 60. In my opinion, the property meets does not meet the National Register Criteria. I recommend that this property be considered significant nationally statewide locally. (See continuation sheet.)

Susan M. Perce
Signature of Certifying Official

10/29/02
Date

State or Federal Agency and Bureau

Date

In my opinion, the property meets does not meet the National Register criteria (See continuation sheet for additional comments.)

Signature of Certifying Official/Title

Date

State or Federal Agency and Bureau

Date

Rosemont Historic District _____

Berkeley _____ WV _____

Name of Property

County and State

4. National Park Service Certification

I, hereby certify that this property is:

Signature of Keeper

Date of Action

entered in the National Register

____ See continuation sheet

____ determined eligible for the National Register

____ See continuation sheet

____ determined not eligible for the National Register _____

____ removed from the National Register _____

____ other (explain): _____

[Handwritten Signature]
[Handwritten Signature: Charles A. Bell] 12/12/02

5. Classification

Ownership of Property:

(Check as many boxes as apply)

Category of property

(Check only one box)

private

____ public-local

____ public-State

____ public-Federal

____ building(s)

district

____ site

____ structure

____ object

Number of Resources within Property

(Do not include previously listed resources in the count.)

Contributing
167 _____

Noncontributing
2 _____ buildings

_____ sites

_____ structures

_____ objects

2 _____ TOTAL

Name of related multiple property listing N/A

(Enter "N/A" if property is not part of a multiple property listing.)

Number of contributing resources previously in the listed National Register 0

Rosemont Historic District

Berkeley WV

Name of Property

County and State

6. Function or Use

Historic Functions

Domestic: Single Dwelling

Domestic: Multiple Dwelling

Domestic: Secondary Structure

Commercial: Business

Current Functions

Domestic: Single Dwelling

Domestic: Multiple Dwelling

Domestic: Secondary Structure

Commercial: Business

7. Description

Architectural Classification

Late Victorian: Queen Anne. Late 19th and 20th Century Revivals: Colonial Revival; Tudor Revival. Late 19th and 20th Century American: Bungalow/Craftsman; Other

Materials

Foundation Stone, brick, concrete block

Walls Wood, Brick, Concrete, Stucco

Roof Slate, Asphalt, Composition Shingle

Other

Narrative Description

(See continuation on sheets.)

8. Statement of Significance

Applicable National Register Criteria

(Mark "X" in one or more boxes for the criteria qualifying the property for National Register listing.)

A Property is associated with events that have made a significant contribution to the broad patterns of our history.

B Property is associated with the lives of persons significant in our past.

C Property embodies the distinctive characteristics of a type, period, or method of construction or represents the work of a master, or possesses high artistic values, or represents a significant and distinguishable entity whose components lack individual distinction.

D Property has yielded or is likely to yield, information important in prehistory or history.

Rosemont Historic District _____

Berkeley _____ WV _____

Name of Property

County and State

Criteria Considerations

(Mark "X" in all the boxes that apply.)

Property is:

_____ **A** owned by a religious institution or used for religious purposes.

_____ **B** removed from its original location.

_____ **C** a birthplace or grave.

_____ **D** a cemetery.

_____ **E** a reconstructed building, object, or structure.

_____ **F** a commemorative property.

_____ **G** less than 50 years of age or achieved significance within the past 50 years.

Areas of Significance

Community Planning and Development

Architecture

Period of Significance

1910-1952

Significant Dates

1910

Significant Person

(Complete if criterion B is marked above)

N/A

Cultural Affiliation

N/A

Architect/Builder

Compton, M.L.; Westenhaver, Charles; Tharpe, Bernard (builders)

Narrative Statement of Significance

(See continuation sheets.)

See continuation sheets

Rosemont Historic District _____ Berkeley _____ WV _____
Name of Property County and State

9. Major Bibliographical References

Bibliographical

(Cite the books, articles, and other sources used in preparing this form on one or more continuation sheets.)

Previous documentation on file (NPS):

- _____ preliminary determination of individual listing (36 CFR 67) has been requested.
_____ previously listed in the National Register
_____ previously determined eligible by the National Register
_____ designated a National Historic Landmark
_____ recorded by Historic American Buildings Survey # _____
_____ recorded by Historic American Engineering Record # _____

Primary location of additional data:

- _____ State Historic Preservation Office
_____ Other State Agency
_____ Federal Agency
_____ Local government
_____ University
 Other

Name of Repository Berkeley County Historic Landmarks Commission _____

10. Geographical Data

Acree of Property 24.46 acres _____

UTM References (Place additional UTM references on a continuation sheet.)

Quad Map Name: Martinsburg _____

A _____	B _____
Zone Easting Northing	Zone Easting Northing
C _____	D _____
Zone Easting Northing	Zone Easting Northing

see continuation sheet

Verbal Boundary Description

(See continuation sheet.)

Boundary Justification

(See continuation sheet.)

Rosemont Historic District _____ Berkeley _____ WV _____

Name of Property

County and State

11. Form Prepared By

Name/Title: Geoffrey B. Henry and Jared N. Tuk, Architectural Historians

Organization: GAI Consultants, Inc. Date: July 12, 2002

Street & Number: 3412 Chesterfield Avenue Telephone: 304-926-8100

City or Town: Charleston State: WV Zip: 25304

Property Owner

(Complete this item at the request of SHPO or FPO.)

Name: Various Owners, see Section 7

Street & Number: Various Telephone: _____

City or Town: Martinsburg State: WV Zip: 25401

ARCHITECTURAL DESCRIPTION

Location and Boundaries

The Rosemont Historic District is located within the corporate limits of the City of Martinsburg, county seat of Berkeley County, West Virginia. Martinsburg and Berkeley County are located in the eastern panhandle region of West Virginia, approximately 10 miles south of the Maryland/West Virginia state line, and approximately 10 miles north of the Virginia/West Virginia state line.

The Rosemont Historic District is an urban district containing 12 partial or whole city blocks, comprising approximately 44 acres. The district is bounded on the north by the rear lot lines of the south side of West King Street; on the east by the west side of Porter Avenue; on the south by the south side of West Stephen Street; and on the west by a line running north from the intersection of the rear lot lines of the east side of Georgia Avenue and West Stephen Street, running north to the southeast corner of lot number 61, then running west to the southwest corner of lot number 60, then running north to the southwest corner of lot number 75, then running west to the east side of Alabama Avenue, then running north to the intersection of Alabama Avenue and West King Street.

In addition, the Rosemont Historic District adjoins and is bounded on the north and east by the Boom Town Historic District. The Boomtown Historic District is listed in the National Register of Historic Places as part of the Berkeley County Multiple Resource Area.

The Rosemont Historic District contains 167 contributing resources and 2 non-contributing resources. The contributing resources are distributed as follows: 1 contributing resource and 2 non-contributing resources on Alabama Avenue, 11 contributing resources on Georgia Avenue, 34 contributing resources on Illinois Avenue, 23 contributing resources on South Kentucky Avenue, 27 contributing resources on Rosemont Avenue, 12 contributing resources on Porter Avenue, 28 contributing resources on John Street, and 3 contributing resources on Stephen Street. The two non-contributing resources post-date the 1910-1952 period of significance.

Street Plan

The Rosemont Historic District is a residential neighborhood laid out in 1910 by the Roush-Bowers Real Estate Company of Martinsburg. The street plan consists of a uniform grid pattern on moderately hilly topography. The topography slopes downward from west to east, with its lowest point at the east end of the district. The street plan contains two east-west running streets (West John and West Stephen Streets), six north-south running avenues (South Alabama, South Georgia, South Tennessee, South Kentucky, South Illinois, and South Rosemont Avenue), and Porter Avenue, which runs at a 45 degree angle at the east end of the district. The streets and avenues are 60 feet wide. Most lots measure 40 feet wide and 144 feet long. The east and west sides of

Illinois and Kentucky Avenues contain several 30-foot-wide lots. The back sides of all lots are serviced by 10-foot-wide north-south running alleys (mostly unpaved).

Architectural Characteristics

The architecture of the Rosemont Historic District consists of detached and single-family houses, duplex housing, and multi-unit apartments. The buildings face the street and have uniform setbacks, although the setback lengths vary from block to block. Lots are demarcated by stone or concrete walls, hedges, or curbs along the front, and on the sides by driveways, walls, vegetation, or changes in elevation.

Building materials include wood frame (108 resources), brick or brick veneer (47 resources), and concrete block (12 resources). Frame buildings either retain their original cladding of weatherboard or German siding, or have been altered with aluminum or vinyl siding, asbestos or asphalt shingles, or covered with stucco. Brick buildings use either red or yellow brick, often trimmed with wood or concrete. Concrete block buildings have either smooth or rusticated finishes. Many frame and brick houses in the district possess rusticated concrete block foundations. Roof materials include metal, slate, asphalt roll, asbestos shingle, and composition shingle.

Buildings in the Rosemont Historic District encompass several architectural styles popular during the neighborhood's most intense period of development between 1910 and 1935. These include the American Four Square, Bungalow/Craftsman, Colonial Revival, Dutch Colonial, English Cottage, Tudor Revival, and Cape Cod. Vernacular buildings, which exhibit no identifiable stylistic features, are also well represented in the Rosemont Historic District.

The Rosemont Historic District retains its original street plan, scale, and feeling and maintains a high degree of overall architectural integrity. Individual buildings in the district have been altered by the addition of later siding, by enclosing or altering original porches, and by the replacement of original window sash and doors.

ARCHITECTURAL DESCRIPTION BY STREET (alphabetical by street)

Alabama Avenue contains one contributing resource, a frame Bungalow-style dwelling and two non-contributing resources.

Georgia Avenue. The 200 block of this street contains both detached houses and duplexes, either 1½ or 2 stories high. Most are frame or brick, with one example of concrete block construction. Styles represented include Bungalow and American Four Square, as well as vernacular dwellings.

Illinois Avenue. The 200 block of Illinois Avenue consists of mostly 2 ½-story detached houses and duplexes, with frame and brick construction predominating. Many buildings

on this block have retained their original slate roofs. The predominant style is the American Four Square style; these houses feature one- or three-bay, hip-roofed front porches. The houses at 225 and 226 Illinois Avenue have wrap-around porches. The 300 block presents a uniform streetscape of 1½- and 2½-story frame, brick, and concrete block houses in the American Four Square, Bungalow, vernacular Tudor, and frame vernacular modes.

John Street. Most houses on this street are concentrated in the 700 and 800 blocks, near the east end of the district. On the south side of the 700 block are tightly spaced 2- and 2½-story brick and frame houses in the American Four Square style. Several frame vernacular houses on this side of the street have gable-end facades. Porches have either hipped or gable roofs. Houses on the north side are equally divided between detached houses, most of which are vernacular Queen Anne-style frame houses, and duplexes, which are frame vernacular dwellings with gable-end facades and gable-roofed front porches. The 800 block consists of three 2-story frame duplexes. The district's sole commercial building, a 1-story concrete block structure, is located at 907 John Street.

Kentucky Avenue. Buildings on the west side of the 300 block of Kentucky Avenue stand on a short bluff. The 1½- and 2½-story houses on this block are nearly uniformly frame, with only two brick houses present. There are several duplexes, particularly on the west side. They feature hipped roofs with hip-roofed front porches. A row of six nearly identical frame houses stands on narrow 30-foot lots at 316-322 Kentucky Avenue. They are 2-story, 2-bay gable-roofed frame houses with gable-end façades. The duplexes at 329-337 Kentucky Avenue have polygonal bays with Craftsman-style colored window panes in the upper sash. The houses at 334-336 Kentucky Avenue are the sole Bungalow-style residences on this block.

Rosemont Avenue. The 200 block of Rosemont Avenue contains several larger houses in the Dutch Colonial, Craftsman, Colonial Revival, and American Four Square styles. Houses are brick, frame or stuccoed and are between 1 ½- and 2 ½-stories high. There are also two duplexes on this block. The 300 block contains a diverse mix of 1½- and 2½-story frame, brick houses as well as six concrete block houses. The duplex at 305-307 Rosemont Avenue features a porch with fluted concrete columns with carved Corinthian capitals.

Tennessee Avenue. The 200 block of Tennessee Avenue contains a diverse collection of 1-, 1½-, 2-, and 2½-story frame, brick, and stuccoed detached residences and duplexes. Styles represented include Queen Anne, American Four Square, Bungalow and Ranch, as well as numerous frame vernacular dwellings. The 300 block contains both detached and duplex residences, as well as a 2½-story four-unit dwelling at 324-328 Tennessee Avenue. Buildings are frame, brick and concrete block, and include examples of the American Four Square, Bungalow and English Cottage styles. Four ranch-style houses from the 1950s are located at 324-328 Tennessee Avenue.

United States Department of the Interior-National Park Service
National Register of Historic Places Continuation Sheet
 Section Number 7 Page 4

Rosemont Historic District
Berkeley County, West Virginia

Porter Avenue contains single-family detached houses, duplexes, and multi-unit dwellings, either brick or frame, and mostly vernacular in style. They feature either hipped or gable roofs.

INVENTORY OF THE ROSEMONT HISTORIC DISTRICT (includes ID number keyed to map, address, architectural style, date of construction, contributing status, and architectural description)

ID #	Address	Style	Date of Construction	Contributing Status	Architectural Description
00001	204 S Alabama Avenue	Bungalow	1910	Contributing Building	This 1 1/2-story, 2-bay, frame house has a gable roof that overhangs on the front to shelter a porch with tapered posts and a half-wall. The house is trimmed with exposed rafter ends. There is a central shed-roofed dormer window on the front elevation. Windows have 6/1 double-hung sash.
	206 Alabama Avenue	Modern	1983	Non-Contributing Building	This 1-story frame building is 4-bays wide and has a gable roof. The house is covered with vinyl siding.
	208 Alabama Avenue	Modern	1983	Non-Contributing Building	This 1-story frame building is 4-bays wide and has a gable roof. The house is covered with vinyl siding.
00002	201 S Georgia Avenue	American Four Square	1910	Contributing Building	This 2 1/2-story, 2-bay, hip-roofed frame house has a 1-story, 2-bay, hip-roofed front porch with tapered piers and a half-wall. The house is trimmed with wide eaves. There is a central hip-roofed dormer window on the front elevation. Windows have 1/1 double-hung sash. There is an additional polygonal bay window.
00003	207 S Georgia Avenue	American Four Square	1910	Contributing Building	This 2 1/2-story, 2-bay, hip-roofed frame house has a 1-story, 2-bay, hip-roofed front porch with tapered piers on brick bases. The house is trimmed with wide eaves. There is a central hip-roofed dormer window on the front elevation. Windows have 3/1 double-hung sash. There is an additional polygonal bay window.
00004	214 S Georgia Avenue	Bungalow	1910	Contributing Building	This 1 1/2-story, 2-bay, brick house has a gable roof that overhangs on the front to shelter a porch with brick piers and a brick half-wall. The house is trimmed with exposed rafter ends and knee braces. There is a central gable-roofed dormer window on the front elevation. Windows have 3/1 double-hung sash.
00005	216-218 S Georgia Avenue	Vernacular	1910	Contributing Building	This 2-story, 4-bay, gable-roofed frame duplex has a gable-end facade and a 1-story, 4-bay front porch with paired posts and shingled half-wall. The house is trimmed with a cornice with gable end returns. Windows have 3/1 double-hung sash and are paired on the front elevation.
00006	220 S Georgia Avenue	Bungalow	1910	Contributing Building	This 1 1/2-story, 3-bay brick house has a hipped roof that overhangs on the front to shelter a porch with tapered posts, brick piers, and a brick half-wall. There is a central hip-roofed dormer window on the front elevation. Windows have 3/1 double-hung sash.
00007	202-204 S Georgia Avenue	Vernacular	1910	Contributing Building	This 2-story, 4-bay, gable-roofed frame duplex has a gable-end facade and a 1-story, 4-bay, hip-roofed front porch with tapered posts. Windows have 1/1 double-hung sash.

United States Department of the Interior-National Park Service
National Register of Historic Places Continuation Sheet
Section Number 7 Page 5

Rosemont Historic District
Berkeley County, West Virginia

ID #	Address	Style	Date of Construction	Contributing Status	Architectural Description
00008	206 S Georgia Avenue	Vernacular	1910	Contributing Building	This 2-story, 3-bay, gable-roofed frame house has a side gable facade and a 1-story, 1-bay front porch with metal posts. Windows have 6/6 double-hung sash.
00009	213-215 S Georgia Avenue	Vernacular	1910	Contributing Building	This 2-story, 4-bay, gable-roofed frame duplex has a gable-end facade and a 1-story, 4-bay, hip-roofed front porch with Tuscan columns and a balustrade. Windows have 1/1 double-hung sash. The house is trimmed with a cornice with gable end returns.
00010	217 S Georgia Avenue	American Four Square	1910	Contributing Building	This 2 1/2-story, 2-bay, hip-roofed house is built of concrete block and has a 1-story, 2-bay, hip-roofed front porch with a concrete half wall and wooden columns with Ionic capitals. The house is trimmed with wide eaves. There is a central hip-roofed dormer window on the front elevation. Windows have 1/1 double-hung sash with cement sills and lintels.
00011	301 S Georgia Avenue	Colonial Revival	1910	Contributing Building	This 1 1/2-story, 3-bay, gable-roofed frame house has a side gable facade and a 1-story, 1-bay front portico with paired posts. The house is trimmed with a cornice with gable end returns. Windows have 6/6 double-hung sash and there are two gable-roofed dormer windows on the front.
00012	300 S Georgia Avenue	Colonial Revival	1910	Contributing Building	This 1 1/2-story, 3-bay, gable-roofed brick house has a side gable facade and a 1-story, 1-bay front portico with metal posts. The house is trimmed with a brick cornice.
00013	225 S Illinois Avenue	Vernacular	1910	Contributing Building	This 2-story, 2-bay, gable-roofed frame house has a gable-end facade and a 1-story, 2-bay hip-roofed front porch with turned posts and shingled half-wall.
00014	227 S Illinois Avenue	Vernacular	1910	Contributing Building	This 2-story, 2-bay, gable-roofed frame house has a gable-end facade and a 1-story, 2-bay hip-roofed front porch with tapered posts on brick piers and brick half-wall. Windows have 1/1 double-hung sash.
00015	229 S Illinois Avenue	American Four Square	1910	Contributing Building	This 2 1/2-story, 2-bay, hip-roofed house built of rusticated concrete block has a 1-story, 2-bay, hip-roofed front porch with fluted Ionic columns and a concrete block half-wall. The house is trimmed with wide eaves and concrete block quoins There is a central hip-roofed dormer window on the front elevation.
00016	231 S Illinois Avenue	American Four Square	1910	Contributing Building	This 2 1/2-story, 2-bay, hip-roofed brick house has a 1-story, 2-bay, hip-roofed front porch with tapered piers on brick bases. The house is trimmed with wide eaves.
00017	239 S Illinois Avenue	American Four Square	1910	Contributing Building	This 2 1/2-story, 2-bay, hip-roofed frame house has a 1-story, 2-bay, hip-roofed front porch with tapered piers and a cross gable. The house is trimmed with wide eaves. There is a central hip-roofed dormer window on the front elevation. Windows have 1/1 and 2/2 double-hung sash.
00018	301 S Illinois Avenue	Vernacular	1910	Contributing Building	This 1 1/2-story, 3-bay, brick house is built on an L plan and has a gable roof that overhangs on the front to shelter a porch with tapered posts, brick pilasters, and a brick half-wall. There is a shed-roofed dormer window on the front elevation. There is an entrance ell with steeply pitched gable roof and an arched opening. Windows have 6/6 double-hung sashes.

United States Department of the Interior-National Park Service
National Register of Historic Places Continuation Sheet
Section Number 7 Page 6

Rosemont Historic District
Berkeley County, West Virginia

ID #	Address	Style	Date of Construction	Contributing Status	Architectural Description
00019	303 S Illinois Avenue	American Four Square	1910	Contributing Building	This 2 1/2-story, 2-bay, hip-roofed house has a 1-story, 2-bay, hip-roofed front porch with tapered posts and a half-wall. The house is trimmed with wide eaves. There is a central hip-roofed dormer window on the front elevation. Windows have 1/1 double-hung sash with cement sills and lintels and are evenly spaced on the front elevation.
00020	307 S Illinois Avenue	Bungalow	1910	Contributing Building	This 1 1/2-story, 2-bay, frame house has a gable roof that overhangs on the front to shelter a porch with tapered posts, brick piers, and a wooden half-wall. The house is trimmed with exposed rafter ends.
00021	309 S Illinois Avenue	Vernacular	1910	Contributing Building	This 2-story, 2-bay, gable-roofed frame house has a gable-end facade and a 1-story, 1-bay front porch with metal posts. Windows have 1/1 double-hung sash.
00022	311 S Illinois Avenue	American Four Square	1910	Contributing Building	This 2 1/2-story, 2-bay, hip-roofed frame house has a 1-story, 3-bay, hip-roofed front porch with square posts and a balustrade. The house is trimmed with wide eaves and corner boards. There is a central hip-roofed dormer window on the front elevation. Windows have 1/1 double-hung sash. There is an additional polygonal bay window.
00023	313 S Illinois Avenue	American Four Square	1910	Contributing Building	This 2 1/2-story, 2-bay, hip-roofed frame house has a 1-story, 3-bay, hip-roofed front porch with square posts and a balustrade. The house is trimmed with wide eaves and corner boards. There is a central hip-roofed dormer window on the front elevation. Windows have 1/1 double-hung sash.
00024	315 S Illinois Avenue	American Four Square	1910	Contributing Building	This 2 1/2-story, 2-bay, hip-roofed frame house has a 1-story, 3-bay, hip-roofed front porch with square posts and a balustrade. The house is trimmed with wide eaves and corner boards. There is a central hip-roofed dormer window on the front elevation. Windows have 1/1 double-hung sash.
00025	317 S Illinois Avenue	American Four Square	1910	Contributing Building	This 2 1/2-story, 2-bay, hip-roofed frame house has a 1-story, 3-bay, hip-roofed front porch with square posts and a balustrade. The house is trimmed with wide eaves and corner boards. There is a central hip-roofed dormer window on the front elevation. Windows have 1/1 double-hung sash. There is an additional polygonal bay window.
00026	319 S Illinois Avenue	Bungalow	1910	Contributing Building	This 1 1/2-story, 6-bay, brick house has a gable roof that overhangs on the front to shelter an enclosed porch. There is a central gable-roofed dormer window on the front elevation. Windows have 3/1 double-hung sash. There is a tall brick chimney stack on the south gable end.
00027	321 S Illinois Avenue	Vernacular	1910	Contributing Building	This 2-story, 3-bay, gable-roofed frame house has a side-gable facade and a 1-story, 3-bay, shed-roofed front porch with tapered posts and shingled half-wall. Windows have 1/1 double-hung sash on the first story, 6/1 on the second story.
00028	323 S Illinois Avenue	Colonial Revival	1910	Contributing Building	This 2-story, 3-bay, gable-roofed brick house has a side-gable facade and a 1-story, 1-bay, gable-roofed front portico with arched opening, thin columns, and a balustrade. Windows have 6/6 double-hung sashes.

United States Department of the Interior-National Park Service
National Register of Historic Places Continuation Sheet
Section Number 7 Page 7

Rosemont Historic District
Berkeley County, West Virginia

ID #	Address	Style	Date of Construction	Contributing Status	Architectural Description
00029	324 S Illinois Avenue	Vernacular	1910	Contributing Building	This 1-story, 3-bay, gable-roofed house has a side-gable facade and a gable-end exterior brick chimney. Windows have 1/1 double-hung sash with paneled shutters.
00030	322 S Illinois Avenue	Vernacular	1910	Contributing Building	This 1-story, 3-bay, gable-roofed house has a side-gable facade covered with brick veneer. Windows have 1/1 double-hung sash; there are also sliding windows and a large picture window on the front of the house.
00031	320 S Illinois Avenue	American Four Square	1910	Contributing Building	This 2 1/2-story, 2-bay, hip-roofed frame house has a 1-story, 3-bay, hip-roofed front porch with square posts. The house is trimmed with wide eaves and corner boards. There is a central hip-roofed dormer window on the front elevation. Windows have 6/6 and 1/1 double-hung sash. There is a diamond-shaped window on the side elevation.
00032	318 S Illinois Avenue	American Four Square	1910	Contributing Building	This 2 1/2-story, 2-bay, hip-roofed frame house has a 1-story, 3-bay, hip-roofed front porch with Tuscan columns. The house is trimmed with wide eaves and corner boards. There is a central hip-roofed dormer window on the front elevation. Windows have 1/1 double-hung sash with molded frames and shutters on the front elevation.
00033	316 S Illinois Avenue	American Four Square	1910	Contributing Building	This 2 1/2-story, 2-bay, hip-roofed frame house has had its front porch removed. There is a central hip-roofed dormer window on the front elevation. Windows have 1/1 double-hung sash with molded frames and shutters on the front elevation. There is a diamond-shaped window on the side elevation.
00034	314 S Illinois Avenue	American Four Square	1910	Contributing Building	This 2 1/2-story, 2-bay, hip-roofed frame house has a 1-story, 3-bay, hip-roofed front porch with Tuscan columns, presently enclosed. The house is trimmed with wide eaves and corner boards. There is a central hip-roofed dormer window on the front elevation. Windows have 1/1 double-hung sash with shutters on the front elevation. There is an octagonal window on the side elevation.
00035	312 S Illinois Avenue	American Four Square	1910	Contributing Building	This 2 1/2-story, 2-bay, hip-roofed frame house has a 1-story, 3-bay, hip-roofed front porch with Tuscan columns. The house is trimmed with wide eaves and corner boards. There is a central hip-roofed dormer window on the front elevation. Windows have 1/1 double-hung sash with shutters on the front elevation.
00036	310 S Illinois Avenue	American Four Square	1910	Contributing Building	This 2 1/2-story, 2-bay, hip-roofed frame house has a 1-story, 3-bay, hip-roofed front porch with Tuscan columns. The house is trimmed with wide eaves. There is a central hip-roofed dormer window on the front elevation. Windows have 1/1 double-hung sash. There is a diamond-shaped window on the side elevation.
00037	308 S Illinois Avenue	American Four Square	1910	Contributing Building	This 2 1/2-story, 2-bay, hip-roofed frame house has a 1-story, 1-bay, hip-roofed front portico with Tuscan columns and a balustrade. The house is trimmed with wide eaves. There is a central hip-roofed dormer window on the front elevation. Windows have 1/1 double-hung sash. There is a diamond-shaped window on the north elevation.

United States Department of the Interior-National Park Service
National Register of Historic Places Continuation Sheet
Section Number 7 Page 8

Rosemont Historic District
Berkeley County, West Virginia

ID #	Address	Style	Date of Construction	Contributing Status	Architectural Description
00038	306 S Illinois Avenue	American Four Square	1910	Contributing Building	This 2 1/2-story, 2-bay, hip-roofed frame house has a 1-story, 2-bay, hip-roofed front porch with Tuscan columns. The house is trimmed with wide eaves. There is a central hip-roofed dormer window on the front elevation. Windows have 1/1 double-hung sash. There is a diamond-shaped window on the south elevation.
00039	304 S Illinois Avenue	Vernacular	1910	Contributing Building	This 2-story, 2-bay, gable-roofed frame house has a gable-end facade and a 1-story, 2-bay front porch with turned posts. The house is trimmed with a cornice with gable end returns. Windows have 1/1 double-hung sash.
00040	302 S Illinois Avenue	American Four Square	1910	Contributing Building	This 2 1/2-story, 2-bay, hip-roofed frame house has a 1-story, 3-bay, hip-roofed front porch with Tuscan columns. The house is trimmed with wide eaves and corner boards. There is a central hip-roofed dormer window on the front elevation. Windows have 1/1 double-hung sash with molded frames and shutters on the front elevation. There is a diamond-shaped window on the side elevation. There is an entrance on the street facade as well as a rear entrance.
00041	236 S Illinois Avenue	American Four Square	1910	Contributing Building	This 2 1/2-story, 2-bay, hip-roofed, brick house is a variant of the American Four Square style and is built on an L plan. The house has a 1-story, hip-roofed wraparound porch with a cross gable, and tapered posts on a brick half-wall. The house is trimmed with wide, bracketed eaves. There is a central hip-roofed dormer window on the front elevation. Windows have 4/1 double-hung sash with concrete lintels.
00042	232-234 S Illinois Avenue	American Four Square	1910	Contributing Building	This 2 1/2-story, 4-bay, hip-roofed, frame duplex has a 1-story, 4-bay, hip-roofed front porch with Tuscan columns. The house is trimmed with wide eaves and corner boards. There is a central hip-roofed dormer window on the front elevation. Windows have 1/1 double-hung sash.
00043	230 S Illinois Avenue	American Four Square	1910	Contributing Building	This 2 1/2-story, 2-bay, hip-roofed, frame house has a 1-story, 1-bay, hip-roofed front portico with metal posts. The house is trimmed with wide eaves and corner boards. There is a central hip-roofed dormer window on the front elevation. Windows have 1/1 double-hung sash.
00044	224-226 S Illinois Avenue	American Four Square	1910	Contributing Building	This 2 1/2-story, 4-bay, hip-roofed, frame duplex has a 1-story, 4-bay, hip-roofed front porch with metal posts. The house is trimmed with wide eaves and corner boards. There is a central hip-roofed dormer window on the front elevation. Windows have 1/1 double-hung sash. There is a diamond shaped window on thee north and south elevations.
00045	222 S Illinois Avenue	American Four Square	1910	Contributing Building	This 2 1/2-story, 2-bay, hip-roofed, frame house has a 1-story, 1-bay, hip-roofed front portico with Tuscan columns. The house is trimmed with wide eaves and corner boards. There is a central hip-roofed dormer window on the front elevation. Windows have 1/1 double-hung sash.

United States Department of the Interior-National Park Service
National Register of Historic Places Continuation Sheet
Section Number 7 Page 9

Rosemont Historic District
Berkeley County, West Virginia

ID #	Address	Style	Date of Construction	Contributing Status	Architectural Description
00046	213 S Tennessee Avenue	Vernacular	1910	Contributing Building	This 2-story, 3-bay, gable-roofed, brick house has a gable end facade. The brick is laid in 8-course common bond. The house is trimmed with a cornice with gable-end returns. Windows have 2/1 double-hung sash with segmental arched heads.
00047	215 S Tennessee Avenue	Vernacular	1910	Contributing Building	This 2-story, 2-bay, gable-roofed, brick house has a gable-end facade. The brick is laid in 8-course common bond. The house is trimmed with a cornice with gable-end returns. There is a 1-story, 2-bay porch with turned posts on the front elevation. Windows have 1/1 double-hung sash, most with brick jack arches.
00048	217 S Tennessee Avenue	Vernacular	1910	Contributing Building	This 2-story, 2-bay, gable-roofed, brick house has a gable-end facade. The house is trimmed with a cornice with gable-end returns. There is a 1-story, 3-bay porch with brick posts on the front elevation. Windows have 1/1 double-hung sash, with a diamond pane upper sash, most with brick jack arches. There is an off-center entrance with rectangular transom on the street facade. The attic on the gable end has fish-scale shingles.
00049	219 S Tennessee Avenue	Vernacular Queen Anne	1910	Contributing Building	This 2 1/2-story, 2-bay, hip-roofed, frame house has a 1-story, 1-bay, hip-roofed front porch with turned posts. There is a 2-story polygonal bay on the front. The pedimented gable end is shingled and has an arched window. The house is trimmed with wide eaves and corner boards.
00050	223-225 S Tennessee Avenue	American Four Square	1910	Contributing Building	This 2 1/2-story, 4-bay, deck-on-hip-roofed, frame duplex has a 1-story, 1-bay, gable-roofed front portico with metal posts. The house is trimmed with wide eaves and corner boards. There is a central hip-roofed dormer window with tapered sides on the front elevation. Windows have 9/1 and 8/1 double-hung sashes and there is an arched window on the south.
00051	229-231 S Tennessee Avenue	American Four Square	1910	Contributing Building	This 2 1/2-story, 4-bay, deck-on-hip-roofed, frame duplex has a 1-story, 3-bay, hip-roofed front portico with metal posts. The house is trimmed with wide eaves and corner boards. There is a central hip-roofed dormer window with tapered sides and diamond panes on the front elevation. Windows have 9/1 and 8/1 double-hung sashes and there is an arched window on the south.
00052	1004 W John Street	American Four Square	1910	Contributing Building	This 2 1/2-story, 2-bay, hip-roofed frame house has a 1-story, 3-bay, hip-roofed front porch with Tuscan columns. The house is trimmed with wide eaves and corner boards. There is a central hip-roofed dormer window on the front elevation. Windows have 1/1 double-hung sash with shutters on the front elevation.
00053	303 S Tennessee Avenue	Vernacular	1910	Contributing Building	This 2-story, 2-bay, gable-roofed frame house has a gable-end facade and a 1-story, 1-bay front porch with metal posts. Windows have 1/1 double-hung sash.
00054	305 S Tennessee Avenue	American Four Square	1910	Contributing Building	This 2 1/2-story, 2-bay, hip-roofed, frame house has a 1-story, 1-bay, hip-roofed front portico with metal posts. The house is trimmed with wide eaves and corner boards. There is a central hip-roofed dormer window on the front elevation. Windows have 1/1 double-hung sash.

United States Department of the Interior-National Park Service
National Register of Historic Places Continuation Sheet
Section Number 7 Page 10

Rosemont Historic District
Berkeley County, West Virginia

ID #	Address	Style	Date of Construction	Contributing Status	Architectural Description
00055	307-309 S Tennessee Avenue	Vernacular	1910	Contributing Building	This 2 1/2-story, 2-bay, hip-roofed, frame house has a 1-story, 1-bay, hip-roofed front porch with turned posts. There is a 2-story polygonal bay on the front. The pedimented gable end is shingled and has an arched window. The house is trimmed with wide eaves and corner boards.
00056	311 S Tennessee Avenue	Vernacular	1910	Contributing Building	This 2-story, 2-bay, gable-roofed frame house has a gable-end facade and a 1-story, 1-bay front porch with metal posts. Windows have 1/1 double-hung sash.
00057	317-323 S Tennessee Avenue	Vernacular	1910	Contributing Building	This 2 1/2-story, 8-bay, gable-roofed, brick row house has four attached units. The house is trimmed with a brick cornice at the front corners. There is a 1-story, gable-roofed portico with plain posts and metal railings for each unit. Windows have 6/6 double-hung sash. There are four gable-roofed dormers along the front elevation.
00058	325 S Tennessee Avenue	Vernacular	1910	Contributing Building	This 1 1/2-story, 3-bay, gable-roofed, frame house has a 1-story, flat-roofed portico with metal posts and metal railings. Windows have 6/6 double-hung sash and are paired on the facade. There are two gable-roofed dormers along the front elevation.
00059	327 S Tennessee Avenue	Vernacular	1910	Contributing Building	This 1-story, 3-bay, gable-roofed, brick house has a central cross gable and a metal awning over the central entrance. There are brick steps with metal railings in front. Windows have 1/1 double-hung sash and brick jack arches. There is a brick chimney at the north gable end.
00060	331 S Tennessee Avenue	American Four Square	1927	Contributing Building	This 2-story, 2-bay, hip-roofed house has a hip-roofed dormer on the front elevation. The house has quoins formed by blocks of a lighter color. The hip-roofed porch is enclosed and has rusticated concrete block pilasters and 1/1 double-hung sash windows. There is a smooth concrete water table around the house, as well as smooth concrete lintels and sills on the windows. The windows have 1/1 sash throughout. The central brick chimney has a corbeled cap.
00061	330 S Tennessee Avenue	Vernacular/ Ranch	1940	Contributing Building	This 1-story, 2-bay, hip-roofed, brick house has a projecting ell on the northwest corner. There are cement and brick steps with metal railings in front. Windows have 1/1 double-hung sash as well as a picture window in front. There is a brick chimney at the north gable end.
00062	328 S Tennessee Avenue	Vernacular	1910	Contributing Building	This 1-story, 3-bay, hip-roofed, brick house has cement and brick steps with metal railings in front. The entrance is topped by a metal awning. There are 1/1 double-hung sash windows as well as two picture windows in front. There is a brick chimney at the east.
00063	326 S Tennessee Avenue	Vernacular	1910	Contributing Building	This 1-story, 3-bay, hip-roofed, frame house has a 1-story, 1-bay gable-roofed portico with slender columns. There are 1/1 double-hung sash windows as well as two picture windows in front. There is a brick chimney at the east.
00064	324 S Tennessee Avenue	Vernacular	1910	Contributing Building	This 1-story, 3-bay, gable-roofed, frame house has a 1-story, 1-bay gable-roofed porch consisting of a metal awning with metal porch posts and railings. There are 1/1 double-hung sash windows as well as two picture windows in front. There is a partially exposed brick chimney at the south gable end.

United States Department of the Interior-National Park Service
National Register of Historic Places Continuation Sheet
Section Number 7 Page 11

Rosemont Historic District
Berkeley County, West Virginia

ID #	Address	Style	Date of Construction	Contributing Status	Architectural Description
00065	320-322 S Tennessee Avenue	Vernacular	1910	Contributing Building	This 2-story, 4-bay, gable-roofed frame duplex has a gable-end facade with a shingle-sided attic level. There is a 1-story, 4-bay, hip-roofed front porch with paired posts and shingled half-wall. The house is trimmed with a cornice with gable end returns. Windows have 3/1 double-hung sash and are paired on the front elevation.
00066	316-318 S Tennessee Avenue	American Four Square	1910	Contributing Building	This 2 1/2-story, 4-bay, hip-roofed, frame duplex has a 1-story, 4-bay, hip-roofed front porch with Tuscan columns. The house is trimmed with wide eaves and corner boards. There is a hip-roofed central dormer on the front elevation. Windows have 3/1 double-hung sash and are paired on the facade.
00067	312-314 S Tennessee Avenue	American Four Square	1910	Contributing Building	This 2 1/2-story, 4-bay, hip-roofed, frame duplex has a 1-story, 4-bay, hip-roofed front porch with Tuscan columns. The house is trimmed with wide eaves and corner boards. There is a hip-roofed central dormer on the front elevation. Windows have 3/1 and 1/1 double-hung sashes and are paired on the facade.
00068	310 S Tennessee Avenue	American Four Square	1910	Contributing Building	This 2 1/2-story, 2-bay, hip-roofed, frame duplex has a 1-story, 2-bay, hip-roofed front porch with Tuscan columns and a balustrade. The house is trimmed with wide eaves and corner boards. There is a hip-roofed central dormer on the front elevation. Windows have 1/1 double-hung sash.
00069	302 S Tennessee Avenue	Vernacular	1910	Contributing Building	This 2-story, 2-bay, gable-roofed frame house has a gable-end facade and a 1-story, 1-bay front porch with metal posts. Windows have 1/1 double-hung sash.
00070	300 S Tennessee Avenue	Vernacular/ Tudor	1935	Contributing Building	This house is located in an urban setting in Martinsburg characterized by small rectangular or square lots, a uniform grid pattern of intersecting streets, rear alleys, paved sidewalks, and front-facing houses. This lot is situated at the intersection of South Tennessee Avenue and West John Street and is bounded on two sides by a stone wall.
00071	230 S Tennessee Avenue	Vernacular/ Queen Anne	1935	Contributing Building	This 2-story, 3-bay, gable-roofed, brick house has a 2-story polygonal tower with a patterned slate roof and ball finial centered on the front. There are 1/1 double-hung sash windows throughout. The wrap around porch has a hipped roof supported by brick posts. The tower is covered with stucco. A polygonal bay projects from the south side of the house and is topped by slate shingles.
00072	228 S Tennessee Avenue	American Four Square	1935	Contributing Building	This 2-story, 2-bay, pyramidal-roofed, frame house has 2 hip-roofed dormers, located on the west and south elevations. The hip-roofed porch is supported by wooden posts on concrete bases. Most of the windows in the house are 1/1 double-hung sash, and some have a lozenge pattern in the upper sash.
00073	226 S Tennessee Avenue	Vernacular	1940	Contributing Building	This 1-story, 3-bay, gable-roofed, brick house has a side gable roof with a shed roof porch. The brick is laid in stretcher bond. The porch is supported by modern iron scrolled posts. The windows are 6/1 double-hung sash, and the openings have soldier bond jack arches and header bond sills.

United States Department of the Interior-National Park Service
National Register of Historic Places Continuation Sheet
Section Number 7 Page 12

Rosemont Historic District
Berkeley County, West Virginia

ID #	Address	Style	Date of Construction	Contributing Status	Architectural Description
00074	224 S Tennessee Avenue	Vernacular Tudor	1938	Contributing Building	This 1.5-story, 2-bay, gable-roofed, brick house has a side gable roof with a 1.5-story cross gable. The brick is laid in stretcher bond, with soldier bond trim and jack arches. The porch is screened with a wooden frame. The first-story front window is 8/1 double-hung sash, and 6/1 windows are elsewhere, with the exception of the arched window on the front elevation. The window openings have soldier bond jack arches and header bond sills.
00075	222 S Tennessee Avenue	Vernacular Tudor	1940	Contributing Building	This 1.5-story, 3-bay, gable-roofed, brick house has a side gable roof with a 1.5-story cross gable. The brick is laid in stretcher bond, with soldier bond trim and jack arches. The porch is enclosed and has wooden pilasters. The windows are 3/1 double-hung sash throughout, and the first story windows have shutters on the front elevation. The window openings have soldier bond jack arches and header bond sills. The gable ends are clad in weatherboard.
00076	223 S Rosemont Avenue	Bungalow	1925	Contributing Building	This 1.5-story, 3-bay, gable-roofed, frame house has a side gable roof with a cross-gabled dormer on the front elevation. The eaves on this house are bracketed, and the rafter tails project beyond the eaves on the front dormer. The porch is partially enclosed and has shingled posts and a brick half wall. The windows are double-hung sash throughout, with diamond-paned upper sashes and molded wood surrounds.
00077	225 S Rosemont Avenue	American Four Square	1920	Contributing Building	This 2-story, 2-bay, pyramidal-roofed, frame house has a hip-roofed dormer with paired 4-light windows on the front elevation. The wide eaves on this house are bracketed. The hip-roofed porch has paired wooden posts. The front door has 4-light sidelights. The windows are 4/1 double-hung sash throughout, and are paired on the second story of the front elevation.
00078	227-229 S Rosemont Avenue	Vernacular	1920	Contributing Building	This 2.5-story, 4-bay, gable-roofed, frame duplex house has a gable front roof with molded cornice. The shed-roofed porch is supported by wooden posts. The entrance doors are separated by two sets of paired 1/1 double-hung sash windows. The remaining windows are 1/1 double hung sash throughout and are paired on the front elevation.
00079	231-233 S Rosemont Avenue	Vernacular	1920	Contributing Building	This 2.5-story, 4-bay, gable-roofed, frame duplex house has a gable front roof with molded cornice. The hip-roofed porch is supported by molded wooden posts. The Craftsman-style entrance doors are separated by two sets of paired 1/1 double-hung sash windows, and each door has shutters. The remaining windows are 1/1 double hung sash throughout and are paired and have shutters on the front elevation.
00080	237 S Rosemont Avenue	American Four Square	1919	Contributing Building	This 2.5-story, 2-bay, pyramidal-roofed, brick house has hip-roofed dormers with paired 6-light fixed sash windows. The hip-roofed porch has a pedimented section above the entry with returns. The porch is supported by Tuscan columns and has Tuscan pilasters and a wooden balustrade. The windows are mostly 8/1 double hung sash with the first story front window containing a lozenge pattern. The windows have brick jack arches.

United States Department of the Interior-National Park Service
National Register of Historic Places Continuation Sheet
Section Number 7 Page 13

Rosemont Historic District
Berkeley County, West Virginia

ID #	Address	Style	Date of Construction	Contributing Status	Architectural Description
00081	909 W. John Street	Vernacular	Circa 1930	Contributing Building	This 1-story, 3-bay, commercial building has a shallow shed roof covered by corrugated metal. The building is constructed on concrete block on the east, west, and south elevations, and beveled cinder block on the north elevation. There is a small hip-roofed porch overhang on the front of the building, covering a central door and two single-light picture windows. A wooden sign board and light are at the top of the building. There is an interior brick chimney with a corbeled cap.
00082	301 S. Rosemont Avenue	Vernacular Tudor	1938	Contributing Building	This 1.5-story, 5-bay, gable-roofed brick house has a side gabled roof with a shed-roofed attic story and a steeply pitched cross gable, which projects from the front of the house. The brick is stretcher bond, with jack arches and header bond sills. The windows are 6/1 and 1/1 double-hung sashes with molded surrounds. The attic story is clad with aluminum siding, and the northeast corner is clad in vinyl. There is fanlight arch woodwork over and fluted pilasters flanking the door. There is an interior brick chimney with a corbeled cap.
00083	303 S. Rosemont Avenue	American Four Square	1920	Contributing Building	This 2-story, 2-bay, pyramidal-roofed, frame house has a hip-roofed dormer with paired 4-light windows on the front elevation. The wide eaves on this house are bracketed. The hip-roofed porch has paired wooden posts. The front door has 4-light sidelights. The windows are 4/1 double-hung sash throughout, and are paired on the second story of the front elevation.
00084	305-307 S. Rosemont Avenue	American Four Square	1925	Contributing Building	This 2-story, 4-bay, pyramidal-roofed duplex house has shed-roofed dormers on the east, north, and south elevations. There is a projecting polygonal bay on the first story of the front elevation. The windows are 1/1 double-hung sash with molded surrounds, and are paired on the front elevation. The windows have smooth concrete lintels and sills. The two porticos on the front are pedimented with returns, and are supported by fluted concrete columns on rusticated concrete block bases with Corinthian capitals.
00085	309 S. Rosemont Avenue	Vernacular	Circa 1950	Contributing Building	This 2-story, 2-bay, gable-roofed house has a shed-roofed porch supported by wood posts. The windows are 1/1 double-hung sash with shutters. There is a projecting polygonal bay window on the front elevation.
00086	315-317 S. Rosemont Avenue	American Four Square	1926	Contributing Building	This 2-story, 4-bay, pyramidal-roofed duplex house has a hip-roofed dormer on the front elevation. The hip-roofed porch is supported by tapered wood posts on rusticated concrete block bases, with cement coping and rusticated concrete block half wall. The windows are 1/1 double-hung sash with smooth concrete lintels and sills
00087	319 S. Rosemont Avenue	Vernacular	1930	Contributing Building	This 2-story, 2-bay, gable-roofed frame house has a side gabled roof with a 2-story cross gable and a gable front porch roof. The porch roof is supported by decorative iron posts with an iron balustrade. There is a wall dormer on the front elevation. The windows are 6/6 and 4/4 double-hung sash, as well as multi-light fixed sash. The house has an exterior brick chimney with a corbeled cap.

United States Department of the Interior-National Park Service
National Register of Historic Places Continuation Sheet
Section Number 7 Page 14

Rosemont Historic District
Berkeley County, West Virginia

ID #	Address	Style	Date of Construction	Contributing Status	Architectural Description
00088	321-323 S. Rosemont Avenue	Vernacular	1920	Contributing Building	This 2.5-story, 4-bay, gable-roofed frame duplex house has a gable front roof. The gable front porch roof has returns and is supported by tapered wooden posts. The windows are 2/2 and 1/1 double-hung sashes with wooden surrounds. The two halves of the front porch are separated by a wooden balustrade.
00089	325 S. Rosemont Avenue	Vernacular Queen Anne	1927	Contributing Building	This 2-story, 3-bay, gable-roofed house has a side-gabled roof with returns and a cross-gabled rear ell. There is a 2-story polygonal tower on the front elevation. It has a pedimented roof with fishscale shingles in the gable end. The hip-roofed porch is supported by paired wooden posts and has a wooden half wall clad in fishscale shingles. The door has 4-light sidelights. The windows are 1/1 double-hung sash and 6-light fixed sash with wooden surrounds. There is a corbeled brick chimney Contributing Building on the south elevation.
00090	327-329 S. Rosemont Avenue	Bungalow	1920	Contributing Building	This 1.5-story, 3-bay, gable-roofed frame house has a side-gabled roof with an overhang that forms the front porch. The porch roof is supported by brick posts with a brick half wall. The front door is a Craftsman-style door. There is a large shed-roofed dormer on the front elevation. The windows throughout are 1/1 double-hung sash and are often paired. The eaves are bracketed.
00091	331-333 S. Rosemont Avenue	Vernacular	1920	Contributing Building	This 2-story, 4-bay, gable-roofed frame duplex house has a gable front roof with returns. There is a molded cornice and German siding in the gable ends. The gable front porch has returns and is supported by tapered wooden posts. The two halves of the house are separated at the porch by a wooden half wall. The windows are 1/1 double-hung sash throughout, and have molded surrounds. There is a louvered vent in the gable end. The shed-roofed rear porch is enclosed. There is a central brick chimney.
00092	330 S. Rosemont Avenue	Vernacular	1942	Contributing Building	This 1.5-story, 5-bay, gable-roofed brick house has a side gabled roof with a shed-roofed attic story and a steeply pitched cross gable, which projects from the front of the house. The brick is stretcher bond, with jack arches and header bond sills. The windows are 6/1 and 1/1 double-hung sashes with molded surrounds.
00093	326-328 S. Rosemont Avenue	American Four Square	1920	Contributing Building	This 2-story, 2-bay, pyramidal-roofed, frame house has a hip-roofed dormer with paired 4-light windows on the front elevation. The wide eaves on this house are bracketed. The hip-roofed porch has paired wooden posts. The front door has 4-light sidelights. The windows are 4/1 double-hung sash throughout, and are paired on the second story of the front elevation.
00094	318-320, 320 1/2 S. Rosemont Avenue	Vernacular	1930	Contributing Building	This 2.5-story, 4-bay, gable-roofed brick house has a gable front roof with bracketed eaves. The hip-roofed front porch is supported by brick posts on brick bases, with cement joints and coping. The 1/1 double-hung sash windows have smooth concrete lintels and sills.

United States Department of the Interior-National Park Service
National Register of Historic Places Continuation Sheet
Section Number 7 Page 15

Rosemont Historic District
Berkeley County, West Virginia

ID #	Address	Style	Date of Construction	Contributing Status	Architectural Description
00095	314-316 S. Rosemont Avenue	Vernacular	1930	Contributing Building	This 2.5-story, 4-bay, gable-roofed brick house has a gable front roof with bracketed eaves. The hip-roofed front porch is supported by brick posts on brick bases, with cement joints and coping. The 1/1 double-hung sash windows have smooth concrete lintels and sills.
00096	312 1/2 S. Rosemont Avenue	Vernacular	1950	Contributing Building	This 2-story, 3-bay, gable-roofed brick house has a gable front roof. The shed-roofed front porch is enclosed and has a brick half wall. The windows are 3/1 double-hung sash, and have shutters on the front elevation. There is a shed-roofed rear addition, clad in aluminum. The center brick chimney has a corbeled cap.
00097	310-312 S. Rosemont Avenue	American Four Square	1930	Contributing Building	This 2-story, 4-bay, pyramidal-roofed duplex house has a hip-roofed dormer on the front elevation. The porch has a hipped roof, and is supported by concrete block posts on concrete block bases with a concrete block half wall and cement coping. The windows are 1/1 double-hung sash and are often paired. Quoins are formed by block of a different color. Smooth cement forms the lintels and sills of windows and Craftsman doors. There is a 2-story rear porch with wooden posts and wooden balustrade.
00098	306-308 S. Rosemont Avenue	American Four Square	1928	Contributing Building	This 2-story, 4-bay, pyramidal-roofed duplex house has a hip-roofed dormer on the front elevation. The porch has a hipped roof, and is supported by concrete block posts on concrete block bases with a concrete block half wall and cement coping. The windows are 1/1 double-hung sash and are often paired. Quoins are formed by block of a different color. Smooth cement forms the lintels and sills of windows and Craftsman doors. There is a 2-story rear porch with wooden posts and wooden balustrade.
00099	304 S. Rosemont Avenue	Vernacular	1950	Contributing Building	This 1-story, 3-bay, hip-roofed frame house has a hip-roofed dormer on the front elevation. The dormer is clad with shingles. The roof extends to form the porch roof, which is supported by wood posts on brick bases. There is an iron balustrade on the porch. The windows are 1/1 double-hung sash with wooden surrounds. There is an interior brick chimney.
00100	300 S. Rosemont Avenue	Vernacular/ Bungalow	1922	Contributing Building	This 1-story, 3-bay, hip-roofed frame house has a hip-roofed dormer on the front elevation. The dormer is clad with shingles. The roof extends to form the porch roof, which is supported by wood posts on brick bases. There is an iron balustrade on the porch. The windows are 1/1 double-hung sash with wooden surrounds. There is an interior brick chimney.
00101	228 S. Rosemont Avenue	Vernacular/ Ranch	Circa 1950	Contributing Building	This 1-story, 4-bay, gable-roofed house has a shallow pitched roof. Formstone comprises the lower half of exterior materials. There is a 1-story wing of smaller scale on the south end of the house. The windows are either 1/1 sash or picture windows with casement sides.
00102	226 S. Rosemont Avenue	Dutch Colonial	1930	Contributing Building	This 1-story, 3-bay, frame house has a gambrel roof with shed-roofed dormers. The shed-roofed porch is screened and has pilasters. The door is an 8-light door. The windows are 8/8 double-hung sash and 9-light casements. There are fanlight windows at the gable ends. The rafter tails are exposed.

United States Department of the Interior-National Park Service
National Register of Historic Places Continuation Sheet
Section Number 7 Page 16

Rosemont Historic District
Berkeley County, West Virginia

ID #	Address	Style	Date of Construction	Contributing Status	Architectural Description
00103	224 S. Rosemont Avenue	Vernacular/ Cape Cod	1950	Contributing Building	This 1.5-story, 5-bay, gable-roofed brick house has a side gable roof with three gable front dormers. These dormers are sided with aluminum. There is a dentil cornice on the front elevation. The windows are 6/6 double-hung sash with wood shutters and header bond sills on the first story. The recessed door is accessed via the brick stoop, and there is a dentil cornice over the door
00104	816 West John Street	Vernacular	1945	Contributing Building	This 1.5-story, 3-bay, hip-roofed brick house has a hip-roofed front dormer, which is sided with vinyl and has paired 6-light casement windows. The brick is laid in stretcher bond with soldier bond lintels and trim. There is a cross-gabled projecting bay on the west elevation of the house. The windows in the house are 8/8 and 3/1 double-hung sashes, and are often paired. The sills are header bond brick. The windows all have aluminum awnings.
00105	808-810 West John Street	Vernacular/ American Four Square	1920	Contributing Building	This 2.5-story, 4-bay, hip-roofed frame duplex house has a hip-roofed front dormer, which has four single-light fixed sash windows. The hip-roofed porch is supported by tapered wooden posts with a vinyl-clad half wall. The windows are 3/1 double-hung sash throughout (often paired), with the exception of the two 9-light polygonal bay windows on the first story of the front elevation.
00106	804-806 West John Street	Vernacular	1920	Contributing Building	This 2.5-story, 4-bay, hip-roofed frame duplex house has a hip-roofed front dormer, which has four single-light fixed sash windows. The hip-roofed porch is supported by tapered wooden posts with a vinyl-clad half wall. The windows are 3/1 double-hung sash throughout (often paired), with the exception of the two 9-light polygonal bay windows on the first story of the front elevation.
00107	800-802 West John Street	Vernacular	1920	Contributing Building	This 2.5-story, 4-bay, hip-roofed frame duplex house has a hip-roofed front dormer, which has four single-light fixed sash windows. The hip-roofed porch is supported by tapered wooden posts with a vinyl-clad half wall. The windows are 3/1 double-hung sash throughout (often paired), with the exception of the two 9-light polygonal bay windows on the first story of the front elevation.
00108	215 S. Kentucky Avenue	Vernacular	Circa 1920	Contributing Building	This 2-story, 2-bay, gable-roofed frame house has a gable front roof with a box cornice and returns. The hip-roofed porch is supported by wood posts with a modern wood half wall. The windows throughout are 1/1 double-hung sash with wood surrounds. There is a 2-story, shed-roofed wing on the rear of the house.
00109	217 S. Kentucky Avenue	Vernacular	1920	Contributing Building	This 2-story, 2-bay, gable-roofed frame house has a gable front roof with a box cornice and returns. The hip-roofed porch is supported by wood posts with a modern wood half wall. The windows throughout are 1/1 double-hung sash with wood surrounds. There is a 2-story, shed-roofed wing on the rear of the house.
00110	219 S. Kentucky Avenue	Vernacular	1920	Contributing Building	This 2-story, 2-bay, gable-roofed frame house has a gable front roof with a box cornice and returns. The hip-roofed porch is supported by wood posts with a modern wood half wall. The windows throughout are 1/1 double-hung sash with wood surrounds. There is a 2-story, shed-roofed wing on the rear of the house.

United States Department of the Interior-National Park Service
National Register of Historic Places Continuation Sheet
Section Number 7 Page 17

Rosemont Historic District
Berkeley County, West Virginia

ID #	Address	Style	Date of Construction	Contributing Status	Architectural Description
00111	301-303 S. Kentucky Avenue	Vernacular	1920	Contributing Building	This 2-story, 4-bay, gable-roofed frame house has a gable front roof with a box cornice and returns. The hip-roofed porch is supported by paired wood posts with a half wall clad in German siding. The windows are 1/1 double-hung sash, and are often paired, with the exception of the 4-light fixed sash windows in the gable end. The first story windows on the front elevation are picture windows. There is a 2-story, gable-roofed porch with turned wood posts and wooden balustrade on the rear of the house. The brick interior chimney has a corbeled cap.
00112	305 S. Kentucky Avenue	Vernacular/ Craftsman	1920	Contributing Building	This 2-story, 2-bay, gable-roofed frame house has a gable front roof with a box cornice and returns. The hip-roofed porch is supported by wood posts with a modern wood half wall. The windows throughout are 1/1 double-hung sash with wood surrounds. There is a 2-story, shed-roofed wing on the rear of the house.
00113	315 S. Kentucky Avenue	American Four Square	1910	Contributing Building	This 2-story, 2-bay, pyramidal-roofed, frame house has a hip-roofed dormer with paired 4-light windows on the front elevation. The wide eaves on this house are bracketed. The hip-roofed porch has paired wooden posts. The front door has 4-light sidelights. The windows are 4/1 double-hung sash throughout, and are paired on the second story of the front elevation.
00114	317 S. Kentucky Avenue	Vernacular	1923	Contributing Building	This 2.5-story, 2-bay, gable-roofed frame house has a gable front roof with a box cornice and returns. The hip-roofed porch is supported by turned wood posts with a wooden balustrade. There is a 2-story, hip-roofed porch on the rear of the house and a 1-story, gable-roofed ell on the north elevation of the house.
00115	319 S. Kentucky Avenue	Vernacular	1910	Contributing Building	This 2.5-story, 2-bay, gable-roofed frame house has a gable front roof with a box cornice and returns. The hip-roofed porch is supported by turned wood posts with a wooden balustrade. There is a 2-story, hip-roofed porch on the rear of the house and a 1-story, gable-roofed ell on the north elevation of the house. The windows throughout are 1/1 double-hung sash with shutters.
00116	323-325 S. Kentucky Avenue	Colonial Revival	1910	Contributing Building	This 2.5-story, 4-bay, hip-roofed house has two hip-roofed dormers sided with slate. One has a 9-light fixed sash window, and the second an empty window opening. The roof has a belvedere, which is flanked front and back by two corbeled brick chimneys. There are also a box cornice and cornerboards. There are two projecting polygonal bays on the first story, each with 6/1 double-hung sash windows and a variation of a Queen Anne sash centered. The remaining windows are paired 6/1 double-hung sashes with wood surrounds. The hip-roofed porch is supported by Tuscan columns, and transoms top the doors.

United States Department of the Interior-National Park Service
National Register of Historic Places Continuation Sheet
Section Number 7 Page 18

Rosemont Historic District
Berkeley County, West Virginia

ID #	Address	Style	Date of Construction	Contributing Status	Architectural Description
00117	329-331 S. Kentucky Avenue	Colonial Revival	1910	Contributing Building	This 2.5-story, 4-bay, hip-roofed house has two hip-roofed dormers sided with slate. One has a 9-light fixed sash window, and the second an empty window opening. The roof has a belvedere, which is flanked front and back by two corbeled brick chimneys. There are also a box cornice and cornerboards. There are two projecting polygonal bays on the first story, each with 6/1 double-hung sash windows and a variation of a Queen Anne sash centered. The remaining windows are paired 6/1 double-hung sashes with wood surrounds. The hip-roofed porch is supported by Tuscan columns, and transoms top the doors.
00118	335-337 S. Kentucky Avenue	Colonial Revival	1910	Contributing Building	This 2.5-story, 4-bay, hip-roofed house has two hip-roofed dormers sided with slate. One has a 9-light fixed sash window, and the second an empty window opening. The roof has a belvedere, which is flanked front and back by two corbeled brick chimneys. There are also a box cornice and cornerboards. There are two projecting polygonal bays on the first story, each with 6/1 double-hung sash windows and a variation of a Queen Anne sash centered. The remaining windows are paired 6/1 double-hung sashes with wood surrounds. The hip-roofed porch is supported by Tuscan columns. Transoms top the doors.
00119	345 S. Kentucky Avenue	Vernacular	1925	Contributing Building	This 2-story, 4-bay, gable-roofed frame house has a gable front roof with 1-story, cross-gabled ell to the north. The 2-story, hip-roofed porch has turned wood posts on the second story and plain wood posts on the first story. There is also wooden balustrade on the second story.
00120	340 S. Kentucky Avenue	Vernacular	1925	Contributing Building	This 2-story, 2-bay, gable front frame house has gable returns. The hip-roofed porch is supported by wooden Tuscan columns on concrete bases with a wooden half wall. The windows are 1/1 double-hung sash with shutters on the front elevation.
00121	338 S. Kentucky Avenue	Vernacular	1930	Contributing Building	This 2.5-story, 2-bay, gable-roofed frame house has a side-gabled roof with a cross gable front and rear, all with returns. The hip-roofed porch is supported by iron posts with an iron half wall. The windows are modern 1/1 double-hung sash and are paired on the second story of the front elevation.
00122	336 S. Kentucky Avenue	Vernacular/ Craftsman	1931	Contributing Building	This 1.5-story, 3-bay, hip-roofed brick house has a hip-roofed dormer on the front elevation and a shed-roofed dormer on the south elevation. The hip-roofed dormer has two window openings which are covered by an aluminum awning. The roof extends to form the front porch, which is supported by tapered wood posts on brick bases with a brick half wall and cement coping. The windows are 3/1 Mission style throughout, and are paired.
00123	334 S. Kentucky Avenue	Bungalow	1938	Contributing Building	This 1.5-story, 2-bay, gable-roofed frame house has a gable front dormer with exposed rafter tails on the front elevation and a shed-roofed dormer on the rear elevation. The roof extends to form the front porch, and is supported by iron posts on rusticated concrete block bases with a rusticated concrete block half wall topped by cement coping. The windows are 3/1 double-hung sash, and are grouped in threes.

United States Department of the Interior-National Park Service
National Register of Historic Places Continuation Sheet
Section Number 7 Page 19

Rosemont Historic District
Berkeley County, West Virginia

ID #	Address	Style	Date of Construction	Contributing Status	Architectural Description
00124	330 S. Kentucky Avenue	Vernacular	1920	Contributing Building	This 2-story, 2-bay, gable front frame house has gable returns. The hip-roofed porch is supported by wooden Tuscan columns on concrete bases with a wooden half wall. The windows are 1/1 double-hung sash with shutters on the front elevation
00125	326 S. Kentucky Avenue	Vernacular	1920	Contributing Building	This 2-story, 2-bay, gable front frame house has gable returns. The hip-roofed porch is supported by wooden Tuscan columns on concrete bases with a wooden half wall. The windows are 1/1 double-hung sash with shutters on the front elevation
00126	322 S. Kentucky Avenue	Vernacular	1920	Contributing Building	This 2-story, 2-bay, gable front frame house has gable returns. The hip-roofed porch is supported by wooden Tuscan columns on concrete bases with a wooden half wall. The windows are 1/1 double-hung sash with shutters on the front elevation
00127	320 S. Kentucky Avenue	Vernacular	1920	Contributing Building	This 2-story, 2-bay, gable front frame house has gable returns. The hip-roofed porch is supported by wooden Tuscan columns on concrete bases with a wooden half wall. The windows are 1/1 double-hung sash with shutters on the front elevation
00128	318 S. Kentucky Avenue	Vernacular	1920	Contributing Building	This 2-story, 2-bay, gable front frame house has gable returns. The hip-roofed porch is supported by wooden Tuscan columns on concrete bases with a wooden half wall. The windows are 1/1 double-hung sash with shutters on the front elevation
00129	310 S. Kentucky Avenue	Vernacular	1920	Contributing Building	This 2-story, 2-bay, gable front frame house has gable returns. The hip-roofed porch is supported by wooden Tuscan columns on concrete bases with a wooden half wall. The windows are 1/1 double-hung sash with shutters on the front elevation
00130	306-308 S. Kentucky Avenue	Vernacular	1920	Contributing Building	This 2.5-story, 4-bay, hip-roofed frame duplex house has a hip-roofed front dormer, which has four single-light fixed sash windows. The hip-roofed porch is supported by tapered wooden posts with a vinyl-clad half wall. The windows are 3/1 double-hung sash throughout (often paired), with the exception of the two 9-light polygonal bay windows on the first story of the front elevation.
00131	738-740 W. John Street	Vernacular	1920	Contributing Building	This 2.5-story, 4-bay, gable-roofed frame duplex house has a pedimented gable front roof with a box cornice. The gable front porch has returns, and is supported by wood Tuscan columns on brick bases with a wooden half wall. The windows are modern 1/1 double-hung sash and are paired on the first story and the attic story of the front elevation. There are shutters flanking the front doors and the second story windows on the front elevation.
00132	734-736 W. John Street	Vernacular	Circa 1920	Contributing Building	This 2.5-story, 4-bay, gable-roofed frame duplex house has a pedimented gable front roof with a box cornice. The gable front porch has returns, and is supported by wood Tuscan columns on brick bases with a wooden half wall. The windows are modern 1/1 double-hung sash and are paired on the first story and the attic story of the front elevation.

United States Department of the Interior-National Park Service
National Register of Historic Places Continuation Sheet
Section Number 7 Page 20

Rosemont Historic District
Berkeley County, West Virginia

ID #	Address	Style	Date of Construction	Contributing Status	Architectural Description
00133	730-732 W. John Street	Vernacular	1920	Contributing Building	This 2.5-story, 4-bay, gable-roofed frame duplex house has a pedimented gable front roof with a box cornice. The gable front porch is supported by wood Tuscan columns on brick bases with a wooden half wall. The windows are modern 1/1 double-hung sash and are paired on the first story and the attic story of the front elevation.
00134	728 W. John Street	Queen Anne Vernacular	1920	Contributing Building	This 2-story, 2-bay, hip-roofed frame house has a projecting gable front 2-story polygonal bay that features scallop shingle siding in the gable, gable returns, and pilasters. There is also a second-story projecting polygonal bay on the east elevation with pilasters. The windows are 1/1 double-hung sash throughout with wood surrounds.
00135	724 W. John Street	Vernacular	1920	Contributing Building	This 2-story, 2-bay, hip-roofed frame house has a pedimented gable front dormer with bracketed eaves, clad in wood siding. The modern 1/1 double-hung sash windows are contained in projecting bays, which are sided with wood. There is a modern porch on the west elevation of the house.
00136	720 W. John Street	Queen Anne Vernacular	Circa 1910	Contributing Building	This 2-story, 2-bay, hip-roofed frame house has a projecting gable front 2-story polygonal bay that features scallop shingle siding in the gable, gable returns, and pilasters. There is also a second-story projecting polygonal bay on the east elevation with pilasters. The windows are 1/1 double-hung sash throughout with wood surrounds.
00137	718 W. John Street	Queen Anne Vernacular	1920	Contributing Building	This 2-story, 2-bay, hip-roofed frame house has a projecting gable front 2-story polygonal bay that features scallop shingle siding in the gable, gable returns, and pilasters. There is also a second-story projecting polygonal bay on the east elevation with pilasters. The windows are 1/1 double-hung sash throughout with wood surrounds.
00138	714 W. John Street	Vernacular	1925	Contributing Building	This 2-story, 2-bay, hip-roofed frame house has a pedimented gable front dormer with bracketed eaves, clad in wood siding. The modern 1/1 double-hung sash windows are contained in projecting bays, which are sided with wood. There is a modern porch on the west elevation of the house.
00139	712 W. John Street	Vernacular	1916	Contributing Building	This 2-story, 2-bay, gable-roofed frame house has a side gable roof with a central cross gable. The hip-roofed porch is supported by Tuscan columns with a turned wood balustrade. The windows are 1/1 double-hung sash with molded drip caps and sills, and with shutters on the front elevation. The door has a rectangular transom.
00140	708 W. John Street	Vernacular	1920	Contributing Building	This 2-story, 2-bay, hip-roofed frame house has a pedimented gable front dormer with bracketed eaves, clad in wood siding. The modern 1/1 double-hung sash windows are contained in projecting bays, which are sided with wood. There is a modern porch on the west elevation of the house.

United States Department of the Interior-National Park Service
National Register of Historic Places Continuation Sheet
Section Number 7 Page 21

Rosemont Historic District
Berkeley County, West Virginia

ID #	Address	Style	Date of Construction	Contributing Status	Architectural Description
00141	706 W. John Street	Vernacular	1930	Contributing Building	This 2-story, 2-bay, gable-roofed frame house has a side gable roof with a central cross gable. The hip-roofed porch is supported by Tuscan columns with a turned wood balustrade. The windows are 1/1 double-hung sash with molded drip caps and sills, and with shutters on the front elevation. The door has a rectangular transom.
00142	733-735 W. John Street	Vernacular	1930	Contributing Building	This 2.5-story, 4-bay, gable-roofed frame duplex house has a pedimented gable front roof with a box cornice. The gable front porch has returns, and is supported by wood Tuscan columns on brick bases with a wooden half wall. The windows are modern 1/1 double-hung sash and are paired on the first story and the attic story of the front elevation. There are shutters flanking the front doors and the second story windows on the front elevation.
00143	731 W. John Street	Vernacular	1935	Contributing Building	This 2-story, 2-bay, gable-roofed frame house has a gable front roof with cornice returns. The hip-roofed porch is enclosed and has 1/1 double-hung sash windows above a vinyl-clad half wall.
00144	729 W. John Street	Vernacular	1930	Contributing Building	This 2-story, 2-bay, gable-roofed frame house has a gable front roof with cornice returns. The gable front porch is enclosed and has 1/1 double-hung sash windows. The remaining windows are also 1/1 double-hung sash. There is a 1-story, shed-roofed rear wing.
00145	727 W. John Street	Vernacular	1936	Contributing Building	This 2-story, 2-bay, gable-roofed frame house has a gable front roof with cornice returns. The gable front porch is enclosed and has 1/1 double-hung sash windows. The remaining windows are also 1/1 double-hung sash. There is a 1-story, shed-roofed rear wing.
00146	723 W. John Street	Vernacular/ Colonial Revival	1930	Contributing Building	This 2-story, 2-bay, gable-roofed frame house has a side gable roof with a box cornice and cornice returns. There is a hip-roofed dormer on the front elevation which is sided with slate. The hip-roofed porch is supported by Tuscan columns with a wooden balustrade.
00147	721 W. John Street	Vernacular	1925	Contributing Building	This 2-story, 2-bay, gable-roofed frame house has a gable front roof with cornice returns. The gable front porch is enclosed and has 1/1 double-hung sash windows. The remaining windows are also 1/1 double-hung sash. There is a 1-story, shed-roofed rear wing.
00148	719 W. John Street	Vernacular/ Craftsman	1930	Contributing Building	This 2-story, 2-bay, gable-roofed frame house has a gable front roof with fishscale shingles in the gable end and exposed rafter tails. The gable front porch is supported by tapered wood posts on brick bases with cement coping. There is also a wood balustrade on the porch.
00149	717 W. John Street	American Four Square	1930	Contributing Building	This 2-story, 2-bay, pyramidal-roofed, frame house has a hip-roofed dormer with paired 4-light windows on the front elevation. The wide eaves on this house are bracketed. The hip-roofed porch has paired wooden posts. The front door has 4-light sidelights. The windows are 4/1 double-hung sash throughout, and are paired on the second story of the front elevation.

United States Department of the Interior-National Park Service
National Register of Historic Places Continuation Sheet
Section Number 7 Page 22

Rosemont Historic District
Berkeley County, West Virginia

ID #	Address	Style	Date of Construction	Contributing Status	Architectural Description
00150	715 W. John Street	American Four Square	1930	Contributing Building	This 2-story, 2-bay, hip-roofed frame house has a hip-roofed dormer with paired fixed-sash windows on the front elevation. The hip-roofed porch is supported by Tuscan columns. The windows have 1/1 double-hung sash with molded drip caps and sills. There is a diamond-shaped fixed sash window on the east elevation.
00151	713 W. John Street	American Four Square	1925	Contributing Building	This 2-story, 2-bay, hip-roofed house has a plain cornice and a hip-roofed dormer on the front elevation. The hip-roofed porch is supported by Tuscan columns with a wood balustrade. There is a projecting polygonal bay on the front elevation. The windows are 1/1 double-hung sash.
00152	711 W. John Street	Vernacular	1930	Contributing Building	This 2-story, 2-bay, gable-roofed brick house has a gable front roof with a box cornice and cornice returns. The gable front porch is enclosed and has 1/1 double-hung sash windows and wood Tuscan pilasters on brick bases with cement coping. The porch is sided with weatherboard.
00153	229-231 S. Porter Avenue	Vernacular	1920	Contributing Building	This 2-story, 4-bay, hip-roofed frame duplex house has a plain cornice and a hip-roofed porch supported by wood posts with wood railing. The windows throughout are 1/1 double-hung sash and are paired on the first story of the front elevation. There is a 1-story, shed-roofed rear porch supported by wood posts.
00154	233-235 S. Porter Avenue	Vernacular/ American Four Square	Circa 1920	Contributing Building	This 2-story, 2-bay, hip-roofed frame house has a hip-roofed dormer with paired fixed-sash windows on the front elevation. The hip-roofed porch is supported by Tuscan columns. The windows have 1/1 double-hung sash with molded drip caps and sills. There is a diamond-shaped fixed sash window on the east elevation.
00155	301 S. Porter Avenue	Queen Anne Vernacular	1930	Contributing Building	This 2-story, 2-bay, hip-roofed frame house has a gable front cross gable, which tops a projecting polygonal bay on the front elevation. There is also a shed-roofed dormer on the south elevation. The hip-roofed porch is supported by Tuscan columns with a wood half wall. There is a 1-story, shed-roofed wing on the rear of the house.
00156	303 S. Porter Avenue	Vernacular	1930	Contributing Building	This 2-story, 2-bay, gable-roofed frame house has a gable front roof with cat slide lines but filled with a modern roof surface. There is a 2-story, cross-gabled rear ell, as well as a 2-story, shed-roofed rear wing. The modern 1/1 double-hung sash windows have aluminum awnings on the front elevation, and wood drip caps and sills throughout.
00157	305 S. Porter Avenue	Craftsman	1930	Contributing Building	This 1-story, 3-bay, hip-roofed frame house has a hip-roofed dormer on the front elevation. The roof extends to form the front porch, which is supported by metal posts on brick bases with a wood half wall with wood coping. The windows are 6/1 double-hung sash with molded surrounds, drip caps, and sills.

United States Department of the Interior-National Park Service
National Register of Historic Places Continuation Sheet
Section Number 7 Page 23

Rosemont Historic District
Berkeley County, West Virginia

ID #	Address	Style	Date of Construction	Contributing Status	Architectural Description
00158	307 S. Porter Avenue	Bungalow	1930	Contributing Building	This 1.5-story, 3-bay, gable-roofed brick house has a side gable roof with a gable front dormer on the front elevation. The roof extends to form the porch roof, which is supported by tapered wood posts on beveled concrete block bases. The rafter tails of the roof are exposed. There is also a beveled concrete block half wall with cement coping. The front door has a rectangular transom. The windows are 6/1 and 1/1 double-hung sashes with cement lintels and sills.
00159	315 S. Porter Avenue	Vernacular/ Craftsman	1928	Contributing Building	This 2-story, 3-bay, hip-roofed house has a shallow roof with shallow shed-roofed dormers on the north and east elevations. The gable front porch has cornice returns, and is supported by tapered posts with a half wall topped by cement coping. The windows are paired 1/1 double-hung sash, with the exception of the grouped fixed sash windows on the front elevation and the paired fixed sash windows in the dormers.
00160	317 S. Porter Avenue	American Four Square	1920	Contributing Building	This 2-story, 2-bay, pyramidal-roofed, frame house has a hip-roofed dormer with paired 4-light windows on the front elevation. The wide eaves on this house are bracketed. The hip-roofed porch has paired wooden posts. The front door has 4-light sidelights. The windows are 4/1 double-hung sash throughout, and are paired on the second story of the front elevation.
00161	319 S. Porter Avenue	Vernacular	1943	Contributing Building	This 2-story, 2-bay, gable-roofed house has a side-gable roof. The hip-roofed porch is supported by corbeled brick posts on brick bases with a brick half wall. The windows have 6/6 double-hung sash with brick sills. There is a 1-story, shed-roofed porch on the rear of the house.
00162	321-323 S. Porter Avenue	Vernacular	1920	Contributing Building	This 2-story, 4-bay, gable-front frame duplex house has cornice returns. The gable front porch also has cornice returns and is supported by tapered wood posts on brick bases. The windows have 1/1 double-hung sash, and are paired in the first story and attic story of the front elevation.
00163	325-327 S. Porter Avenue	Vernacular	1920	Contributing Building	This 2-story, 4-bay, gable-front frame duplex house (now an apartment building) has cornice returns. The 2-story gable front porch is supported by wood posts with a wood balustrade. The windows have 6/1 double-hung sash, and are paired in the first story of the front elevation.
00164	329-331 S. Porter Avenue	Vernacular	1920	Contributing Building	This 2-story, 4-bay, gable-front frame duplex house has cornice returns. The gable front porch also has cornice returns and is supported by tapered wood posts on brick bases. The windows have 1/1 double-hung sash, and are paired in the first story and attic story of the front elevation.
00165	710 W. Stephen Street	American Four Square	1920	Contributing Building	This 2-story, 2-bay, pyramidal-roofed, frame house has a hip-roofed dormer with paired 4-light windows on the front elevation. The wide eaves on this house are bracketed. The hip-roofed porch has paired wooden posts. The front door has 4-light sidelights. The windows are 4/1 double-hung sash throughout, and are paired on the second story of the front elevation.

United States Department of the Interior-National Park Service
 National Register of Historic Places Continuation Sheet
 Section Number 7 Page 24

Rosemont Historic District
 Berkeley County, West Virginia

ID #	Address	Style	Date of Construction	Contributing Status	Architectural Description
00166	714 W. Stephen Street	American Four Square	1920	Contributing Building	This 2-story, 2-bay, hip-roofed frame house has a hip-roofed dormer with paired fixed-sash windows on the front elevation. The hip-roofed porch is supported by Tuscan columns. The windows have 1/1 double-hung sash with molded drip caps and sills. There is a diamond-shaped fixed sash window on the east elevation.
00167	805 W. Stephen Street	Vernacular	1930	Contributing Building	This 1 1/2-story, 3-bay, gable-roofed frame house has a clipped side gable roof with cornice returns. The gable front porch has an arched ceiling and cornice returns. The windows have 3/1 double-hung sash, with shutters on the front elevation. The door is flanked by smaller 3/1 double-hung sash windows.

Statement of Significance

The Rosemont Historic District is significant under Criterion A on the local level in the area of community planning and development, with the period of significance being 1910. The "Rosemont Addition to the City of Martinsburg" was platted and subdivided by the Roush-Bowers Real Estate Company on 26 May 1910. The company was formed to purchase and develop a residential subdivision located adjacent to the newly constructed Kilbourn Knitting Mill, one of Martinsburg's premier industrial enterprises in the early 1900s. The Kilbourn Mill, along with several large industries lured to Martinsburg after 1891 by the Martinsburg Mining Manufacturing & Improvement Company (MMM&I), created enormous demand for housing in the west end of Martinsburg. The Roush-Bowers Real Estate Company marketed the Rosemont subdivision to workers at the Kilbourn Mill, who built single-family and duplex housing. Steady population growth in Rosemont resulted in the area being nearly fully developed by 1931.

The Rosemont Historic District is significant under Criterion C for architecture on the local level, with the period of significance being 1910-1952. The district contains intact vernacular examples of architectural styles popular during the 1910-1935 period, including the Queen Anne, American Four Square, and Bungalow styles. Several builders and contractors such as M.L. Compton, James Westenhaver, and Charles Walton were residents of Rosemont in the 1910s and 1920s and may have built houses in the neighborhood. The district also contains isolated examples of architectural styles popular in the 1935-1952 period, such as the Tudor revival, Dutch Colonial, Colonial revival, and English Cottage styles.

Criterion A

Berkeley County was established in 1772, with its new county seat on the property of Major General Adam Stephen, who laid out 269 lots on 130 acres along Tuscarora Creek. The town was named Martinsburg after Thomas Bryan Martin, a nephew of the proprietary owner, Lord Fairfax (BCHLC 1995:1).

Martinsburg grew quickly during the early nineteenth century as a center for milling and manufacturing. Transportation played a pivotal role in the economic development of Martinsburg in the antebellum years. In 1831, the Winchester & Potomac Railroad was chartered and soon provided a valuable north-south conduit for the Shenandoah Valley's agricultural products (Wood 2001:1). In 1839, the Baltimore & Ohio (B&O) Railroad began construction of an extension of its main line west of Harper's Ferry, Virginia. The rapid influx of railroad workers created a pressing demand for additional housing outside the town's original limits.

The B&O reached Martinsburg in 1842, providing an efficient means for transporting the town's flour and grain products. Martinsburg's population continued to grow as a result

of new manufacturing jobs and by 1860 its population was larger than the combined populations of the nearby towns of Charlestown, Harper's Ferry, and Shepherdstown (Doherty 1972: 134).

Martinsburg's strategic position along the B&O main line made it an important prize during the Civil War and the town was attacked and occupied by both sides several times. The B&O roundhouse and shops were destroyed in 1861, but were rebuilt after the war, stimulating further growth of Martinsburg's industries (Wood 1980:8-2). Several municipal improvements in the 1870s, such as the construction of a water works and the formation of a gas company, provided the basis for an upsurge in development (Wood 2001: 1).

The west side of Martinsburg increased greatly in value after 1890, due to the economic and population expansion of the city. The Cumberland Valley (CV) Railroad extended its line from West Race Street in Martinsburg to Winchester Va. in 1890 and established a new station at 535 W. King Street (Wood 2001:1). The Martinsburg Mining, Manufacturing & Improvement (MMM&I) Co., founded the same year, purchased a large tract of land near the station and laid off residential building lots (Doherty 1972: 261). Several textile companies, among them the Kilbourn Knitting Company, located to Martinsburg that year and the MMM&I Co. capitalized on the urgent need for worker's housing. They held their first sale of residential lots in 1891 (Wood 2001: 1).

One of the principal landholding families in the west side of Martinsburg was the Roush family. Conrad Roush owned land on both sides of the Hampshire Grade (present-day West King Street). His land was inherited by grandsons George and Charles Roush, who bought additional land in 1889 (Berkeley Deed Book 97: 128). The Roush brothers then sold part of the land they owned on the south side of Hampshire Grade to George M. Bowers and the Martinsburg Realty Co. (The brick Roush home on West King Street and 5 acres was deeded back to George S. Roush). Bowers, one of the leading businessmen of Martinsburg and a prominent Republican politician, also was a director of the CV Railroad, indicating the close connections among the railroad, manufacturing, and real estate activity in Martinsburg during this period.

On 3 January 1910 George S. Roush and Anna E., his wife, George M. Bowers and Bessie C. Bowers, his wife, deeded 115 acres to the newly formed Roush-Bowers Real Estate Company (Wood 2001: 1). Ownership in the company was as follows: George Roush, half; George Bowers, one-quarter; the Martinsburg Realty Co., one-quarter.

On 26 May 1910, the Roush-Bowers Real Estate Company registered "Rosemont-An Addition to the City of Martinsburg, West Virginia." The subdivision consisted of 17 full or partial city blocks, divided into 30' or 40'-foot wide lots, all of which were 144' long. Narrow alleys served the back ends of the properties. The subdivision as laid out on a grid pattern, with the exception of Porter Avenue which runs at a 45-degree angle, parallel to the CV railroad tracks to the east. The subdivision was bounded by West King

Street, Porter Avenue, South Street, and Alabama Avenue. Immediately to the east was the giant Kilbourn Knitting Company plant.

Construction of single-family, detached houses commenced soon afterwards and continued through the 1920s and 1930s. Tax records indicate that 75 of the houses in Rosemont were built between 1910 and 1920. Development occurred first in the east side of Rosemont and quickly spread west. By the early 1920s, Georgia and Alabama Avenues on the west were laid out and developed. Tax records indicate that 58 houses were built between 1920 and 1930 in Rosemont.

Although many of the new area's residents were employed at the Kilbourn Mill, there is no evidence that the company built housing for its workers. Generally, the area's more modest houses were concentrated in the east; there are several houses built on narrow 30-foot-wide lots along Kentucky Avenue. Numerous duplex and multi-family buildings also were built to house the many new residents of the area.

US Population Census Schedules for Martinsburg in 1920 indicate that most Rosemont residents worked at the nearby knitting and hosiery mills, such as the Kilbourn Mill and the Interwoven Company plant. (US Census Bureau 1920). Along Tennessee Avenue, for example, whole families like the Osborne, Snyder, McCloy, and Rutherford families were employed at the Kilbourn Mill. A majority of residents along Kentucky Avenue and West John Street also worked for the mill. A few residents also worked for the CV railroad at their freight yards in Martinsburg.

The late 1910s and 1920s were the decades of Rosemont's most intense development. Sanborn maps of Martinsburg from 1931 show that most of the Rosemont district was fully developed by that date, with detached, duplex, and multi-unit housing (Sanborn Map Company 1931). According to city directories from the 1930s and 1940s, turnover was frequent; most families resided at a particular address for no more than three or four years (RL Polk Company 1931, 1932, 1934 and 1939). The Rosemont area continued in popularity during the 1940s and 1950s, with the few remaining residential building lots bought and developed with small, one-story brick Ranch-style houses during this period.

Criterion C

Rosemont was first developed during the 1910s and development continued into the 1950s. Although the Roush-Bowers Real Estate Company established minimum building sizes, lot locations, and a minimum building value, owners were otherwise free to build in whatever style or material they could afford. The historic buildings in Rosemont encompass a narrow range of vernacular architectural styles popular during the first five decades of the twentieth century.

Most prevalent are frame vernacular houses, usually with weatherboard or German siding. Most of these are 2- or 2 ½-stories tall, with either a side gable or gable-end roof

and a 1-story front porch. Decorative details on the exterior were few, mostly confined to porch columns and attic trim. Frame vernacular houses primarily date from the first two decades (1910-1930) of Rosemont's development.

Six examples of vernacular Queen Anne-style houses are found throughout the district. These houses date from the earliest period of development and were not built after 1920. This style is characterized by one- and two-story polygonal bays, a gable roof, Palladian windows, narrow window sash, and wrap-around porches. A notable brick example of this style is found at 230 South Tennessee Street. A simpler frame variant is seen at 720 West John Street.

Forty-nine examples of the American Four Square style built in frame, brick, and concrete block are found throughout the Rosemont Historic District. The style, popular in the 1910s, 1920s, and early 1930s, is characterized by a hipped roof with hipped dormer window, a two bay-wide-elevation, and a hip-roofed front porch. The style was used for both single-family and duplex houses in the district. Frame examples of this style are found at 225 South Rosemont Avenue and 808-810 West John Street. Several brick examples of this style are found along the 700 block of West John Street; one such house is 715 West John Street.

Fourteen Bungalow-style houses are also found within the district. Features of this style, popular in the 1920s and 1930s, include a low-pitched roof overhanging on the front to form a porch, a hipped or gable-roof dormer, bracketed eaves, and an exterior chimney. The house at 223 South Rosemont Avenue possesses most of the essential features of this style.

Isolated examples of the Dutch Colonial, vernacular Tudor Revival, Colonial Revival, Cape Cod, English Cottage, and Ranch styles are found in the Rosemont district. Although nationally popular, the Ranch and Cape Cod styles were usually built in the 1940s and 1950s, by which time Rosemont was nearly completely developed.

Several blocks of duplex housing are found along both sides of Kentucky Avenue in the Rosemont Historic District. They date from between 1915 and 1925 and were constructed for workers at the nearby Kilbourn Knitting Mill. They are two stories tall, with a gable-front roof, hip-roofed front porch, and shed-roofed rear porch. Although vernacular, they often possess some Colonial Revival-style architectural features, such as the duplex at 301-303 South Kentucky Avenue. Duplexes are located at many other locations in the district.

No architects are known to have designed buildings in the Rosemont Historic District. City directories from the 1913-1928 period list several builders and contractors who were residents of the neighborhood. These individuals presumably built their own houses, and may have built other houses in the Rosemont district. Builder M.L. Compton resided at 217 Illinois Avenue by 1913, the only yellow-brick house in the district. He is known to

have built several houses on West King Street, west of Porter Avenue. Other builders/contractors include builder James Westenhaver, who lived at 301 Rosemont Avenue, and Charles Walton, a concrete contractor, who lived in a large brick house at 234 Illinois Avenue.

REFERENCES

- Berkeley County Land Records. On file at Berkeley County Courthouse,
Martinsburg, West Virginia.
- Berkeley County Tax Records. On file at Berkeley County Courthouse,
Martinsburg, West Virginia.
- Berkeley County Will Books. On file at Berkeley County Courthouse,
Martinsburg, West Virginia.
- Berkeley County Historic Landmarks Commission (BCHLC)
1995 *Driving Guide-Historic Districts and Properties of Berkeley County*
Martinsburg, West Virginia).
- Doherty, William Thomas
1972 *Berkeley County, U.S.A.* McLain Printing Company. Parsons, West Virginia.
- West Virginia Division of Culture and History-Historic Preservation Unit
1991 *Guidelines for Phase I Surveys, Phase II Testing, Phase III Mitigation, and*
Cultural Resource Reports. Charleston, West Virginia.
1995 *Historic Structures Surveys.* Charleston, West Virginia.
- Wood, Don C.
1980 *Downtown Martinsburg Historic District-National Register Nomination.*
Martinsburg, WV.
1980 *Historic Resources of Berkeley County-Multiple Resource Nomination.*
Martinsburg, WV.
1980 *Industries of Berkeley County-National Register Nomination.* Martinsburg, WV
1980 *B&O Railroad and Related Industries Historic District-Multiple Resource*
Nomination. Martinsburg, WV.
2001 "History of the Rosemont Area."

UTM REFERENCES

A-	Zone 18	243504E	4371826N
B-	Zone 18	243534E	4371813N
C-	Zone 18	243526E	4371806N
D-	Zone 18	244004E	4371580N
E-	Zone 18	243999E	4371564N
F-	Zone 18	244135E	4371499N
G-	Zone 18	244122E	4371476N
H-	Zone 18	244016E	4371380N
I-	Zone 18	243576E	4371594N
J-	Zone 18	243621E	4371684N
K-	Zone 18	243475E	4371754N

VERBAL BOUNDARY DESCRIPTION

The Rosemont Historic District is shown as the solid black line on the "Rosemont-Addition to the City of Martinsburg, West Virginia" recorded on 26 May 1910 in Berkeley County Plat Book A. The Rosemont Historic District is bounded on the north by the rear lot lines of the south side of West King Street; on the east by the west side of Porter Avenue; on the south by the north side of West Stephen Street; and on the west by a line running north from the intersection of the rear lot lines of the east side of Georgia Avenue and West Stephen Street, running north to the southeast corner of lot number 61, then running west to the southwest corner of lot number 2, at the east side of Alabama Avenue, then running north to the northwest corner of lot number 69, situated at the rear lot lines of the south side of West King Street.

In addition, the Rosemont Historic District adjoins and is bounded on the north and east by the Boom Town Historic District.

BOUNDARY JUSTIFICATION

The boundaries of the Rosemont Historic District include most of the land platted and subdivided in 1910 by the Roush-Bowers Real Estate Company and include the greatest concentration of 1910-1952 contributing resources. The north and east boundaries adjoin the Boomtown Historic District. The south and west boundaries were drawn to exclude non-contributing, post-1952 residences and several large vacant lots.

**Rosemont Historic District
Martinsburg, Berkeley County, West Virginia
March 2002**

Geoffrey B. Henry, Photographer

**Negatives held at West Virginia Division of Culture and History/State Historic
Preservation Office, Charleston, West Virginia**

Photo 1/10	220-218-216-214 S Georgia Avenue. Camera facing northwest.
Photo 2/10	217 S Georgia Avenue. Camera facing northeast.
Photo 3/10	231-229 S Illinois Avenue. Camera facing northwest.
Photo 4/10	301-303-305-307- S Illinois Avenue. Camera facing south.
Photo 5/10	230 S Tennessee Avenue. Camera facing east.
Photo 6/10	331 S Tennessee Avenue. Camera facing west.
Photo 7/10	316 S Tennessee Avenue. Camera facing east.
Photo 8/10	301-303 S Kentucky Avenue. Camera facing southwest.
Photo 9/10	730-732-734-736-738-740 W John Street. Camera facing northwest.
Photo 10/10	716-718 W John Street. Camera facing northwest.

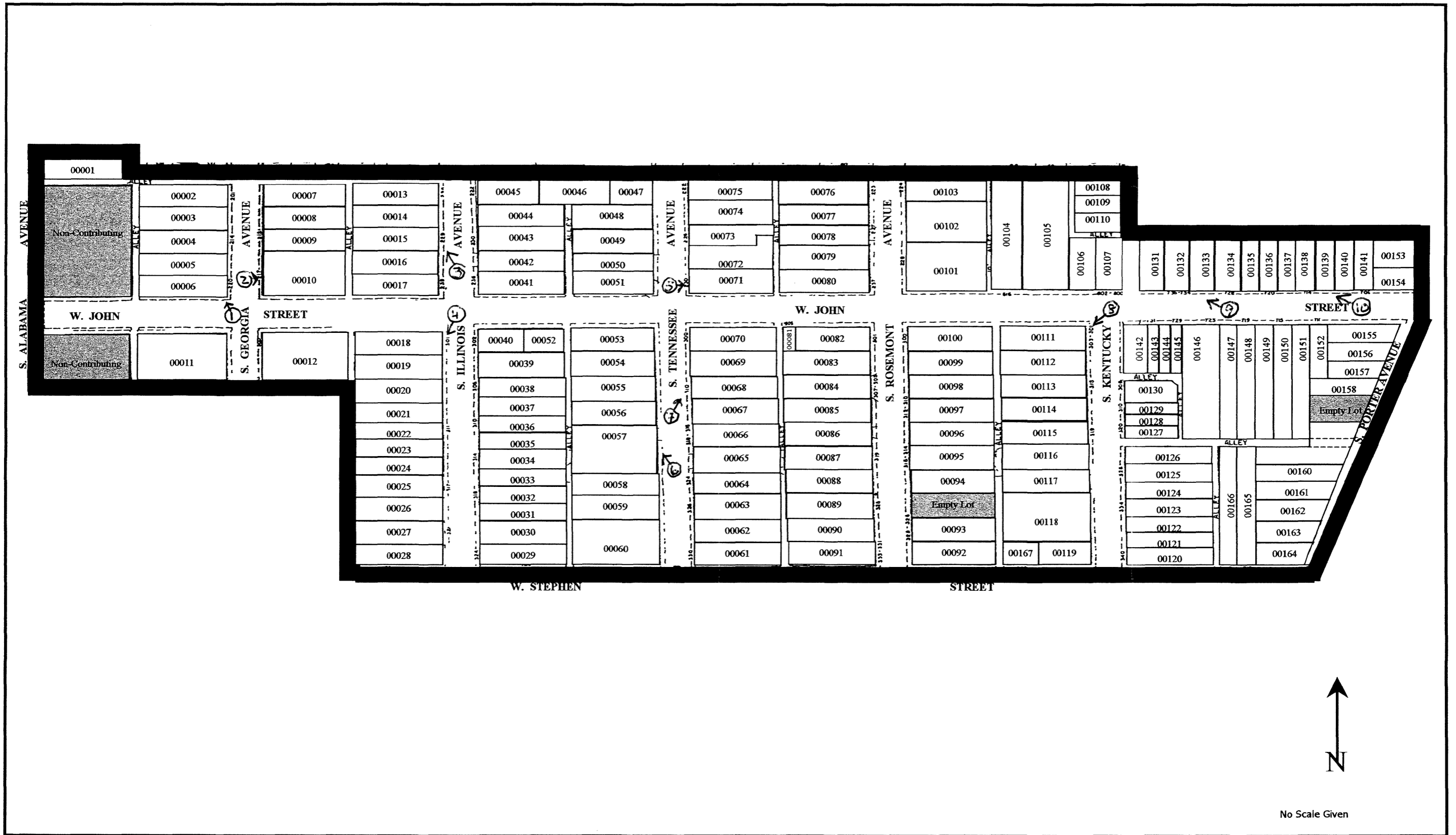

Figure
Historic Resources Distribution In the Rosemont Historic District, Martinsburg,
Berkeley County, West Virginia