

United States Department of the Interior
National Park Service

National Register of Historic Places
Inventory—Nomination Form

For NPS use only

received

MAR 1 1983

date entered

See instructions in *How to Complete National Register Forms*
Type all entries—complete applicable sections

1. Name

historic McNeely House

and/or common same

2. Location

street & number Main Street between 3rd and 4th Streets N/A not for publication

city, town Colfax N/A vicinity of

state LA code 22 county Grant Parish code 043

3. Classification

Category	Ownership	Status	Present Use
<input type="checkbox"/> district	<input type="checkbox"/> public	<input checked="" type="checkbox"/> occupied	<input type="checkbox"/> agriculture
<input checked="" type="checkbox"/> building(s)	<input checked="" type="checkbox"/> private	<input type="checkbox"/> unoccupied	<input type="checkbox"/> commercial
<input type="checkbox"/> structure	<input type="checkbox"/> both	<input type="checkbox"/> work in progress	<input type="checkbox"/> educational
<input type="checkbox"/> site	Public Acquisition	Accessible	<input checked="" type="checkbox"/> private residence
<input type="checkbox"/> object	N/A in process	<input checked="" type="checkbox"/> yes: restricted	<input type="checkbox"/> entertainment
	N/A being considered	<input type="checkbox"/> yes: unrestricted	<input type="checkbox"/> government
		<input type="checkbox"/> no	<input type="checkbox"/> industrial
			<input type="checkbox"/> military
			<input type="checkbox"/> museum
			<input type="checkbox"/> park
			<input type="checkbox"/> religious
			<input type="checkbox"/> scientific
			<input type="checkbox"/> transportation
			<input type="checkbox"/> other:

4. Owner of Property

name Frances McNeely Bowers CONTINUED

street & number P. O. Box 282

city, town Colfax N/A vicinity of state LA 71417

5. Location of Legal Description

courthouse, registry of deeds, etc. Grant Parish Courthouse

street & number Courthouse Building (no specific street or mailing address)

city, town Colfax state LA 71417

6. Representation in Existing Surveys

title LA Historic Sites Survey has this property been determined eligible? yes no

date 1981 federal state county local

depository for survey records LA State Historic Preservation Office

city, town Baton Rouge state LA

7. Description

Condition		Check one	Check one
<input type="checkbox"/> excellent	<input type="checkbox"/> deteriorated	<input type="checkbox"/> unaltered	<input checked="" type="checkbox"/> original site
<input checked="" type="checkbox"/> good	<input type="checkbox"/> ruins	<input checked="" type="checkbox"/> altered	<input type="checkbox"/> moved date <u>N/A</u>
<input type="checkbox"/> fair	<input type="checkbox"/> unexposed		

Describe the present and original (if known) physical appearance

The McNeely House (1883-85) is a two-story brick and frame belated Creole structure located three blocks from the Red River levee in Colfax. Despite a few changes, the house retains its architectural integrity.

The house began in 1883 as a greatly enlarged Creole cottage with two major rooms upstairs and down, a large central chimney, a pair of cabinets on each floor, and a full front gallery. At that time the only way to reach the upstairs was via a pair of staircases set at the ends of the front gallery.

Stylistically the house is mainly characterized by late-nineteenth century Renaissance Revival elements. There are, however, two major exceptions. One is the mantels which are more or less standard Greek Revival aedicule motifs. The other is the upper gallery columns. These are solid posts with square molded tops with the upper two-thirds turned in a Doric shape. Columns of this type were common in Creole plantation houses of the early-nineteenth century, but were well out of fashion by the Civil War. Late-nineteenth century stylistic elements include the heavy, corbelled, brick lower gallery posts; the bracketed cornice; the pedimented fenestration on the upper gallery; and the painted ceiling in the upstairs parlor with its elaborate design of geometrical shapes and foliage.

In 1893 a pair of small side wings were added, one of which lengthened the front facade. The gallery was extended to cover the addition in the Queen Anne Revival manner with a curving gallery terminus. The other addition was a bedroom set within a semi-octagonal bay under a gable. This addition has the most elaborate woodwork in the house with barge boards, imbricated shingles, multiple brackets, and a pair of lancet arches.

In the twentieth century a small rear wing was added, the rear gallery was glazed in, and an interior staircase was installed.

Assessment of Integrity:

In the opinion of the State Historic Preservation Office, the aforementioned changes should be regarded as minor. In any case, they have not affected the basic form and plan of the house, its size, or its painted ceilings, which are the basis of its significance.

**United States Department of the Interior
Heritage Conservation and Recreation Service**

**National Register of Historic Places
Inventory—Nomination Form**



Continuation sheet McNeely House

Item number 4

Page 2

4. Owner of Property (Continued)

T. L. McNeely, Jr., M.D.
Medical Center Building (806 North Ave. K)
Crowley, LA 70526

8. Significance

Period	Areas of Significance—Check and justify below			
<input type="checkbox"/> prehistoric	<input type="checkbox"/> archeology-prehistoric	<input type="checkbox"/> community planning	<input type="checkbox"/> landscape architecture	<input type="checkbox"/> religion
<input type="checkbox"/> 1400-1499	<input type="checkbox"/> archeology-historic	<input type="checkbox"/> conservation	<input type="checkbox"/> law	<input type="checkbox"/> science
<input type="checkbox"/> 1500-1599	<input type="checkbox"/> agriculture	<input type="checkbox"/> economics	<input type="checkbox"/> literature	<input type="checkbox"/> sculpture
<input type="checkbox"/> 1600-1699	<input checked="" type="checkbox"/> architecture	<input type="checkbox"/> education	<input type="checkbox"/> military	<input type="checkbox"/> social/
<input type="checkbox"/> 1700-1799	<input checked="" type="checkbox"/> art	<input type="checkbox"/> engineering	<input type="checkbox"/> music	<input type="checkbox"/> humanitarian
<input checked="" type="checkbox"/> 1800-1899	<input type="checkbox"/> commerce	<input type="checkbox"/> exploration/settlement	<input type="checkbox"/> philosophy	<input type="checkbox"/> theater
<input type="checkbox"/> 1900-	<input type="checkbox"/> communications	<input type="checkbox"/> industry	<input type="checkbox"/> politics/government	<input type="checkbox"/> transportation
		<input type="checkbox"/> invention		<input type="checkbox"/> other (specify)

Specific dates 1883-85;1893

Builder/Architect Builder: John Hodges McNeely

Statement of Significance (in one paragraph) Criterion C

The McNeely House is locally significant in the areas of art and architecture within the context of the parish seat of Colfax. It is the largest house in the town and stands therefore as an architectural landmark within that context. When it was being built, contemporaneous newspaper accounts hailed it as the town's finest residence. Its decoratively painted Renaissance Revival ceilings are particularly noteworthy. Although ceilings of this type appeared in some of Louisiana's grander late-nineteenth century residences, the McNeely House has the only ones in Colfax. Finally, the Creole two-story galleried house was something of a standard model for larger country houses in Louisiana from the colonial period until as late as c.1880. The McNeely House is the only example of this in Colfax.

It should also be noted that the McNeely House is an essentially French house type in a parish which is largely characterized by Anglo-Saxon settlement. The house is believed to have been patterned after the Kate Chopin House (N.R.), which is across the Red River in Natchitoches Parish, an area noted for its French influenced architecture.

9. Major Bibliographical References

Colfax Chronicle, September 1, 1883; February 9, August 16, 1884; May 23, June 6, 13, July 18, 1885; June 17, 1893.

10. Geographical Data

Acreeage of nominated property @ .17 acre

Quadrangle name Colfax, LA

Quadrangle scale 1=62500

UTM References

A

1	5	5	2	7	3	5	0	3	4	8	6	2	7	5
Zone			Easting					Northing						

B

Zone			Easting					Northing						

C

Zone			Easting					Northing						

D

Zone			Easting					Northing						

E

Zone			Easting					Northing						

F

Zone			Easting					Northing						

G

Zone			Easting					Northing						

H

Zone			Easting					Northing						

Verbal boundary description and justification

Please refer to attached sketch map.

List all states and counties for properties overlapping state or county boundaries

state N/A code county code

state code county code

11. Form Prepared By

name/title National Register Staff ASSISTED BY OWNERS (ITEM 4)

organization Division of Historic Preservation

organization State of Louisiana date June 1981

street & number P.O. Box 44247 telephone 504-342-6682

city or town Baton Rouge state LA 70804

12. State Historic Preservation Officer Certification

The evaluated significance of this property within the state is:

national state local

As the designated State Historic Preservation Officer for the National Historic Preservation Act of 1966 (Public Law 89-665), I hereby nominate this property for inclusion in the National Register and certify that it has been evaluated according to the criteria and procedures set forth by the National Park Service.

State Historic Preservation Officer signature 

Robert B. DeBlieux

title State Historic Preservation Officer date February 23, 1983

For NPS use only

I hereby certify that this property is included in the National Register

Entered in the
National Register

date 3/31/83

Keeper of the National Register

Attest:

date

Chief of Registration

McNEELY HOUSE

COLFAX, LOUISIANA

NOTE:
HOUSE FACADES PARALLEL
STREETS.

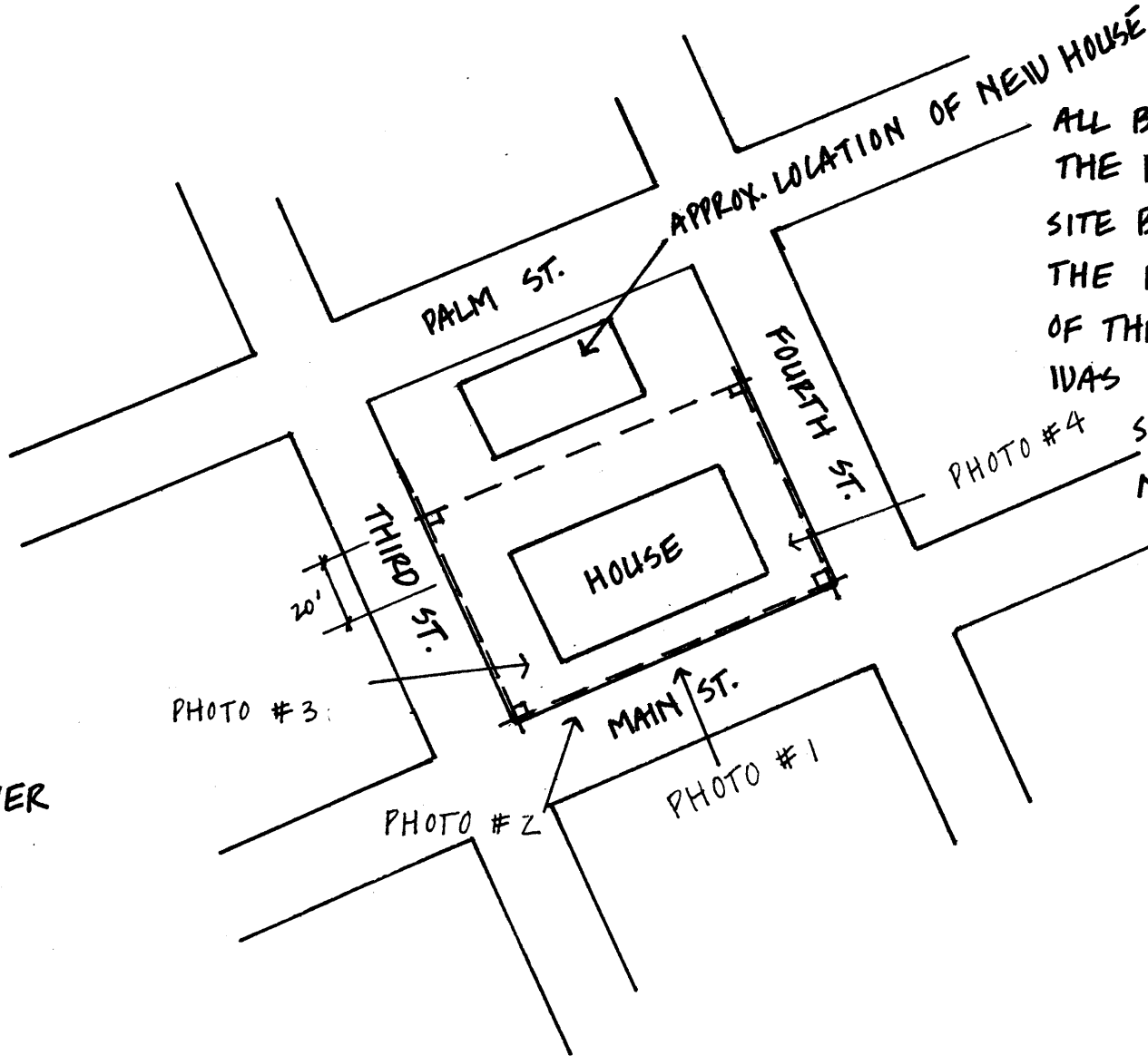

ALL BOUNDARIES PARALLEL
THE BLDG. FACADE $\frac{1}{2}$ BLOCK.
SITE BOUNDARIES ENCOMPASS
THE BLOCK, WITH THE EXCEPTION
OF THE REAR BOUNDARY, WHICH
WAS DRAWN AT THE DISTANCE
SHOWN TO EXCLUDE THE
NEW HOUSE.

N
↑

SCALE 1" = 50' APPROX.

TO RED RIVER
←