

Iowa Site Inventory

Office of Historic Preservation
Iowa State Historical Department
East 12th & Grand Avenue
Des Moines, Iowa 50319

Site Number 67
District Name _____
Map Reference # 67

Identification

- Site Name William Haner Polygonal Barn
- Village/Town/City Pisgah vic. Township Allen County Harrison
- Street Address _____ County L-16
- Legal Location _____

Urban:	<u>81 N</u>	<u>43 W</u>	<u>14</u>	<u>SE 1/4 of SE 1/4</u>
Rural:	subdivision township	block range	parcel section	subparcel 1/4 section of 1/4 section
- UTM Location: zone 15 easting 265,480 northing 4,633,490; Acreage less than one acre
- Owner(s) Name Lester Haner
- Owner(s) Address R. R. #2 Moorhead Iowa 51558
(Street address) (City) (State) (Zip)
- Use: Present Gen'l purpose barn Original Purebred Hereford cattle barn

Description

- Date of Construction 1912 Architect/Builder William B. Haner, original owner
Comstock Construction, Omaha
- Building Type:

<input type="checkbox"/> single-family dwelling	<input type="checkbox"/> industrial	<input type="checkbox"/> other institutional	<input type="checkbox"/> religious
<input type="checkbox"/> multiple-family dwelling	<input type="checkbox"/> educational	<input type="checkbox"/> public	<input checked="" type="checkbox"/> agricultural
<input type="checkbox"/> commercial			
- Exterior Walls: clapboard stone brick board and batten shingles stucco
 other _____
- Structural System: wood frame with interlocking joints wood frame with light members (balloon frame)
 masonry load-bearing walls iron frame steel frame with curtain walls reinforced concrete
 other _____
- Condition: excellent good fair deteriorated
- Integrity: original site moved—if so, when? _____
Notes on alterations, additions (with dates and architect, if known) and any other notable features of building and site:
See reverse side.
- Related Outbuildings and Property: barn other farm structures carriage house garage privy
 other _____
- Is the building endangered? no yes—if so, why? _____
- Surroundings of the building: open land woodland scattered outbuildings densely built-up commercial
 industrial residential other _____

18. Map

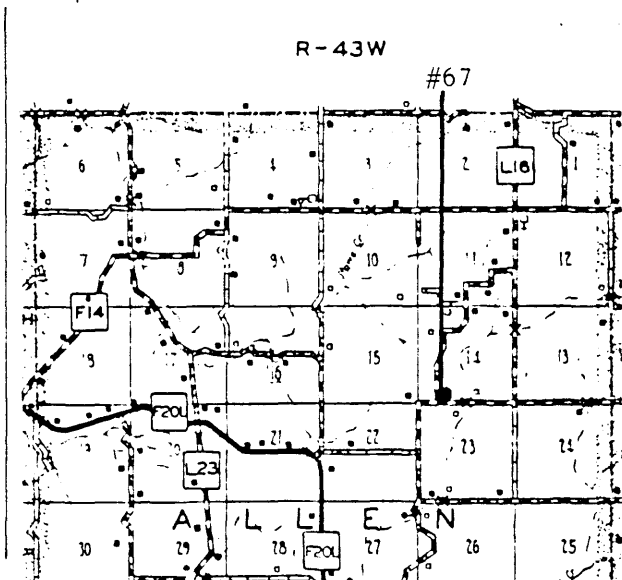

CPE-41965
273-0228

19. Photo

Roll 633 Frame 32 View _____

VBD: A circle 74' in diameter, based on center point of barn, includes barn and attached shed.

MAY 27 1986

Significance

(Indicate sources of information for all statements)

20. Architectural significance

- a. Key structure/individually may qualify for the National Register
- b. Contributing structure
- c. Not eligible/intrusion

N/A

Continuation of 14. Integrity.

54' diameter. 12 sides - 14' on a side. 50' high. Metal roof replaced by wood shingles in 1951. 12 sided gambrel roof with gable dormer on south side. Circular interior. Hay loft extends 16' in from wall. Center open to roof. Part of lumber salvaged from Olympis Church.

21. Historical Significance

Theme(s) Special Function; Cattle type.

- a. Key structure/individually may qualify for the National Register
- b. Contributing structure
- c. Not eligible/intrusion

This barn was originally built to shelter purebred Herefords and horses and as of 1979 was still used for cattle, as well as for hogs and to store grain. Cattle barns are generally characterized by an open floor plan, which is the case with this barn. The construction, in the early 20th century, of special function barns represented an important experimental shift in the traditional use of the barn.

22. Sources (for primary and secondary sources, give complete facts of publication: author, title, place of publication, date, etc.):

Lester Haner, RR 2, Moorhead, IA 51558
Dwight I. Mills, Harrison County Liaison Officer, RR 1, Dunlap, IA 51529
Soike, Lowell J. Without Right Angles. Des Moines, Iowa: Iowa State Historical Department, Office of Historic Preservation, 1983.

Prepared by _____ Date _____
Address _____ Telephone _____
Organization _____

For Office of Historic Preservation Use Only

<p>1. Office Information Sources on this Property</p> <ul style="list-style-type: none"><input type="checkbox"/> County Resource File<input type="checkbox"/> Windshield Survey<input type="checkbox"/> National Register<input type="checkbox"/> Grants-In-Aid: _____<input type="checkbox"/> Determination of Eligibility <p>2. Subject Traces</p> <ul style="list-style-type: none">a. _____b. _____c. _____d. _____e. _____	<p><input type="checkbox"/> Review and Compliance Project:</p> <p>_____</p> <p><input type="checkbox"/> Other _____</p> <p><input type="checkbox"/> Other _____</p> <p><input type="checkbox"/> Other _____</p> <p>3. Photo Images _____</p> <p>_____</p> <p>_____</p> <p>_____</p> <p>_____</p>
---	--