

UNITED STATES DEPARTMENT OF THE INTERIOR
NATIONAL PARK SERVICE

FOR NPS USE ONLY

RECEIVED OCT 16 1979 MAR 13 1980
DATE ENTERED

NATIONAL REGISTER OF HISTORIC PLACES
INVENTORY -- NOMINATION FORM

SEE INSTRUCTIONS IN HOW TO COMPLETE NATIONAL REGISTER FORMS
TYPE ALL ENTRIES -- COMPLETE APPLICABLE SECTIONS

1 NAME

HISTORIC
Cottonwood Community Center
AND/OR COMMON

2 LOCATION *NW of Stillwater*

STREET & NUMBER
4 miles west and 2 miles north of city
CITY, TOWN
Stillwater *ms.* VICINITY OF
STATE
Oklahoma CODE 40 COUNTY Payne CODE 119
CONGRESSIONAL DISTRICT 006
NOT FOR PUBLICATION

3 CLASSIFICATION

CATEGORY	OWNERSHIP	STATUS	PRESENT USE
<input type="checkbox"/> DISTRICT	<input checked="" type="checkbox"/> PUBLIC	<input type="checkbox"/> OCCUPIED	<input type="checkbox"/> AGRICULTURE <input type="checkbox"/> MUSEUM
<input checked="" type="checkbox"/> BUILDING(S)	<input type="checkbox"/> PRIVATE	<input checked="" type="checkbox"/> UNOCCUPIED	<input type="checkbox"/> COMMERCIAL <input type="checkbox"/> PARK
<input type="checkbox"/> STRUCTURE	<input type="checkbox"/> BOTH	<input type="checkbox"/> WORK IN PROGRESS	<input type="checkbox"/> EDUCATIONAL <input type="checkbox"/> PRIVATE RESIDENCE
<input type="checkbox"/> SITE	PUBLIC ACQUISITION	ACCESSIBLE	<input checked="" type="checkbox"/> ENTERTAINMENT <input type="checkbox"/> RELIGIOUS
<input type="checkbox"/> OBJECT	<input type="checkbox"/> IN PROCESS	<input type="checkbox"/> YES: RESTRICTED	<input type="checkbox"/> GOVERNMENT <input type="checkbox"/> SCIENTIFIC
	<input type="checkbox"/> BEING CONSIDERED	<input checked="" type="checkbox"/> YES: UNRESTRICTED	<input type="checkbox"/> INDUSTRIAL <input type="checkbox"/> TRANSPORTATION
		<input type="checkbox"/> NO	<input type="checkbox"/> MILITARY <input type="checkbox"/> OTHER:

4 OWNER OF PROPERTY

NAME
Stillwater School District
STREET & NUMBER

CITY, TOWN
Stillwater VICINITY OF STATE
OK

5 LOCATION OF LEGAL DESCRIPTION

COURTHOUSE, REGISTRY OF DEEDS, ETC.
Payne County Courthouse

STREET & NUMBER
Sixth and Husband

CITY, TOWN
Stillwater STATE
OK

6 REPRESENTATION IN EXISTING SURVEYS

TITLE
Oklahoma Comprehensive Survey

DATE
1978
 FEDERAL STATE COUNTY LOCAL

DEPOSITORY FOR SURVEY RECORDS
Oklahoma Historical Society Preservation Office

CITY, TOWN
Oklahoma City STATE
OK

7 DESCRIPTION

CONDITION		CHECK ONE	CHECK ONE
<input checked="" type="checkbox"/> EXCELLENT	<input type="checkbox"/> DETERIORATED	<input type="checkbox"/> UNALTERED	<input type="checkbox"/> ORIGINAL SITE
<input type="checkbox"/> GOOD	<input type="checkbox"/> RUINS	<input checked="" type="checkbox"/> ALTERED	<input checked="" type="checkbox"/> MOVED
<input type="checkbox"/> FAIR	<input type="checkbox"/> UNEXPOSED		DATE <u>1957</u>

DESCRIBE THE PRESENT AND ORIGINAL (IF KNOWN) PHYSICAL APPEARANCE

Situated northwest of Stillwater, one mile east of Lake Carl Blackwell, the Cottonwood Community Center is a one-story rectangular building constructed of hand-cut cottonwood. Twenty feet wide by forty-three feet long, it has four long narrow sash windows on the east and west sides and an exterior door on the south wall. The north wall has an added enclosed lean-to with an exterior door and one small sash window on the east and west walls. The building is exclusive of any trim and is classified as a clapboard structure with a one gable roof spanning from south to north.

The interior has its original wall material but the walls have been paneled over. A few original benches exist and the wooden floor is intact. During World War II, the interior was partitioned into two rooms for school purposes and an enclosed lean-to was added. The partition was removed about 1957.

The exterior has been altered by new roof shingles, metal grates on the windows, and fairly new (the last 20 years) clapboard siding added over the original siding.

Exterior structures include two outside toilets dating back to the early 1900s. These are located 20 feet north of the main building. There is also playground equipment on the east side of the building consisting of a merry-go-round, swings, a slide, and high bars.

8 SIGNIFICANCE

PERIOD	AREAS OF SIGNIFICANCE -- CHECK AND JUSTIFY BELOW				
<input type="checkbox"/> PREHISTORIC	<input type="checkbox"/> ARCHEOLOGY-PREHISTORIC	<input type="checkbox"/> COMMUNITY PLANNING	<input type="checkbox"/> LANDSCAPE ARCHITECTURE	<input checked="" type="checkbox"/> RELIGION	
<input type="checkbox"/> 1400-1499	<input type="checkbox"/> ARCHEOLOGY-HISTORIC	<input type="checkbox"/> CONSERVATION	<input type="checkbox"/> LAW	<input type="checkbox"/> SCIENCE	
<input type="checkbox"/> 1500-1599	<input type="checkbox"/> AGRICULTURE	<input type="checkbox"/> ECONOMICS	<input type="checkbox"/> LITERATURE	<input type="checkbox"/> SCULPTURE	
<input type="checkbox"/> 1600-1699	<input checked="" type="checkbox"/> ARCHITECTURE	<input checked="" type="checkbox"/> EDUCATION	<input type="checkbox"/> MILITARY	<input type="checkbox"/> SOCIAL/HUMANITARIAN	
<input type="checkbox"/> 1700-1799	<input type="checkbox"/> ART	<input type="checkbox"/> ENGINEERING	<input type="checkbox"/> MUSIC	<input type="checkbox"/> THEATER	
<input checked="" type="checkbox"/> 1800-1899	<input type="checkbox"/> COMMERCE	<input checked="" type="checkbox"/> EXPLORATION/SETTLEMENT	<input type="checkbox"/> PHILOSOPHY	<input type="checkbox"/> TRANSPORTATION	
<input type="checkbox"/> 1900-	<input type="checkbox"/> COMMUNICATIONS	<input type="checkbox"/> INDUSTRY	<input type="checkbox"/> POLITICS/GOVERNMENT	<input type="checkbox"/> OTHER (SPECIFY)	
		<input type="checkbox"/> INVENTION			

SPECIFIC DATES Ca. or C 1889-present BUILDER/ARCHITECT

STATEMENT OF SIGNIFICANCE

The Cottonwood Community Center, built about 1889, is significant for its historic associations with the development of Stillwater's rural agricultural community. The Center is indicative of school house architecture that was popular in the late 1800s and early 1900s in the Stillwater community. Of the four remaining one-room school structures in the Stillwater area, only Cottonwood has been in continuous use from the time it was built to the present. It has been, and continues to be, an important focus of life for the rural community west of the town.

The Cottonwood Community Center was originally built as a school by local homesteaders on the property of Jesse Pierce. It was named Cottonwood because there was an abundance of cottonwood from which the Center was constructed. It was used as a school during the week and as a church on weekends by the local residents, including the Swarts, Meeks, Sharps, Hasketts, Huffs, Randolfs, Harringtons and Paynes, all important families in the area's early history.

In 1907 the Pierce family decreed that if Cottonwood was not used as a school, the building must be off their land or torn down. The residents raised \$400 to be used in moving Cottonwood from the west side of the section line to the east side. The Swarts sold them one acre (\$50) for the new location. The building is now used for community functions, fund raisings for the building, and social gatherings. The building itself belongs to the School District of Stillwater but the community residents do maintenance and repair. The land belongs to a corporation of community residents, and the building is still considered by them to be an important locus of community life.

9 MAJOR BIBLIOGRAPHICAL REFERENCES

- Interview, Mrs. C. P. Weathers, Stillwater, OK, April 25, 1978.
- Interview, Gerald and Velma Bilyeu, Stillwater, OK, April 26, 1978.
- Interview, Fern Payne, Stillwater, OK, April 26, 1978.
- Berlin B. Chapman. The Founding of Stillwater. (Oklahoma City: Times Journal Publishing Co. 1948)

UTM NOT VERIFIED

10 GEOGRAPHICAL DATA

ACREAGE OF NOMINATED PROPERTY under one acre

QUADRANGLE NAME Lake Carl Balckwell

QUADRANGLE SCALE 7.5'

UTM REFERENCES

A 1,4 6,6,5 7,2,5 4,0 0,1 4,2,0

B
 ZONE EASTING NORTHING

C

D

E

F

G

H

VERBAL BOUNDARY DESCRIPTION

Within SE 1/4, of the SE 1/4 of the SE 1/4 of the SE 1/4 of Sec 1.
 T 19N R2E

LIST ALL STATES AND COUNTIES FOR PROPERTIES OVERLAPPING STATE OR COUNTY BOUNDARIES

STATE	CODE	COUNTY	CODE

11 FORM PREPARED BY

NAME / TITLE

Tina Biehler Edited by Kent Ruth and Dr. Annetta Cheek

ORGANIZATION

Oklahoma Historic Preservation

DATE

10/78

STREET & NUMBER

Oklahoma State University History Department

TELEPHONE

405/624-6949

CITY OR TOWN

Stillwater

STATE

OK

12 STATE HISTORIC PRESERVATION OFFICER CERTIFICATION

THE EVALUATED SIGNIFICANCE OF THIS PROPERTY WITHIN THE STATE IS:

NATIONAL

STATE

LOCAL

As the designated State Historic Preservation Officer for the National Historic Preservation Act of 1966 (Public Law 89-665), I hereby nominate this property for inclusion in the National Register and certify that it has been evaluated according to the criteria and procedures set forth by the National Park Service.

STATE HISTORIC PRESERVATION OFFICER SIGNATURE

H. Glenn Jordan

TITLE

DATE

10/10/79

FOR NPS USE ONLY

I HEREBY CERTIFY THAT THIS PROPERTY IS INCLUDED IN THE NATIONAL REGISTER

W. Ray Luce
 KEEPER OF THE NATIONAL REGISTER
 ATTEST: *Beth Groves*
 CHIEF OF REGISTRATION

DATE

3/13/80

DATE

3/10/80

FHR-8-300A
(11/78)

UNITED STATES DEPARTMENT OF THE INTERIOR
HERITAGE CONSERVATION AND RECREATION SERVICE

**NATIONAL REGISTER OF HISTORIC PLACES
INVENTORY -- NOMINATION FORM**

FOR HCRS USE ONLY
RECEIVED FEB 15 1980
DATE ENTERED MAR 13 1980

Cottonwood Community
CONTINUATION SHEET Center, Oklahoma ITEM NUMBER 10 PAGE 1

VERBAL BOUNDARY DESCRIPTION

Within SW 1/4, of the SW 1/4 of the SW 1/4 of the SW 1/4 of Section 1,
T19N R1E, an area 125' E to W by 150' N to S (see map).

LUTTONWOOD COMMUNITY CENTER - 1980

PASTURE LAND

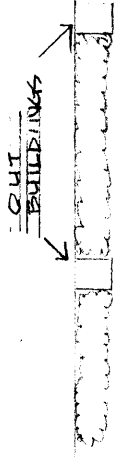

COMMUNITY BUILDING

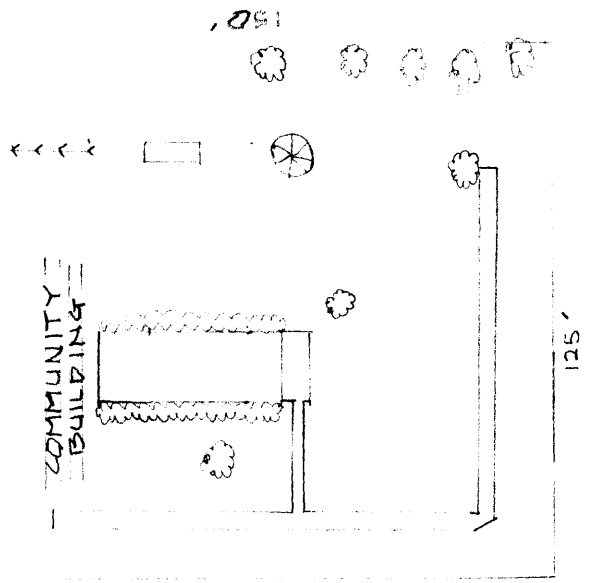

PASTURE LAND



TO HWY 51

FEB 15 1980