

DEC 28 1988

3297

KENTUCKY HISTORIC RESOURCES  
Individual Inventory Form

Resource # Be-362  
Boone County

1. Name of Resource: Early house

2. Original Owner: Unknown

3. Other Names: None

4. Prehistoric Site Building X Object  
Historic Site Structure Other

5. Location: 2970 First Street, Petersburg

6. Owner's Name: Robert Smith (Virginia Smith) [ ]

7. Owner's Address: 2970 First Street  
Petersburg, KY 41084

8. Evaluation: National Register [ ]

9. Recognition & Date:  
Nat.Landmark \_\_\_\_\_ Local Landmark \_\_\_\_\_  
Nat.Register \_\_\_\_\_ HABS/HAER \_\_\_\_\_  
Highway Marker \_\_\_\_\_ KY Inventory 1987  
KY Landmark Certificate \_\_\_\_\_

10. N.R.Status & Date: \_\_\_\_\_

11. N.R.Group:  
District Name: [ ]  
Mult.Resource Area: Boone County [ ]  
Thematic Name: [ ]

12. Historical Theme:  
Primary: Architecture [ ]  
Secondary: [ ]  
Other: [ ]

13. Statement of Significance:  
This property is significant under criterion C as a good example of a rare surviving house type, the saddlebag house, significant to Boone County in the period 1795-1845. This type consists of two pens, usually of the same dimensions, typically square, on either side of a masonry chimney.  
(Continued) [ ]

14. History:  
The 1883 atlas indicated the house, complete with all, was the residence of Mrs. Early.

16. Date:  
Original Building c. 1820s-1830s [ ]  
Addition [ ]

17. Style: late Federal [ ]  
[ ]

18. Architect/Builder: unknown

19. No. of Stories: 1 1/2 [ ]

20. Original Floor Plan: saddlebag [ ]

21. Single Pile X Double Pile N.A.

22. Roof Form & Material: Original X  
gable/st. sm. tin Not Original

23. Structural Material: wood frame [ ]

24. Exterior Material: weatherboard [ ]

25. Foundation Material: fieldstone [ ]

26. Major Alterations: None  
Moved/Rebuilt Other X  
Additions X portion of ell

27. Special Features: central chimney

28. Outbuildings: none [ ]

29. Original Function: dwelling [ ]

30. Present Use: dwelling [ ]

31. Condition: good [ ]

32. Endangered: Yes  
No X

33. Attach Photos:  
Roll: \_\_\_\_\_ Photo Nos: \_\_\_\_\_ No. of Slides: 1-7

15. Source of historical information and/or contact person: 1883 Atlas

34. Prepared by: Kenneth T. Gibbs

35. Organization: Boone Co.Hist.Pres.Rev. Brd.

36. Date: September 1986

37. New Survey X Resurvey \_\_\_\_\_

KENTUCKY HISTORIC RESOURCES  
Individual Inventory Form

Resource # Be-362

38. UTM Point of Primary Building: Zone Easting Northing 39. G.I.S. Mod. [ ]  
 Quadrant: Lawrenceburg 16 684725 4326465 40. Coordi.Accuracy [ ]

41. UTM Points of Boundary (for N. R. eligible sites only):

A. ----- D. -----  
 B. ----- E. -----  
 C. ----- F. -----

42. Total Acreage in Present Property: 0.27 43. Acreage included in proposed N.R. boundary: 0.27

44. Site Plan (and boundary description and justification for N.R. sites):

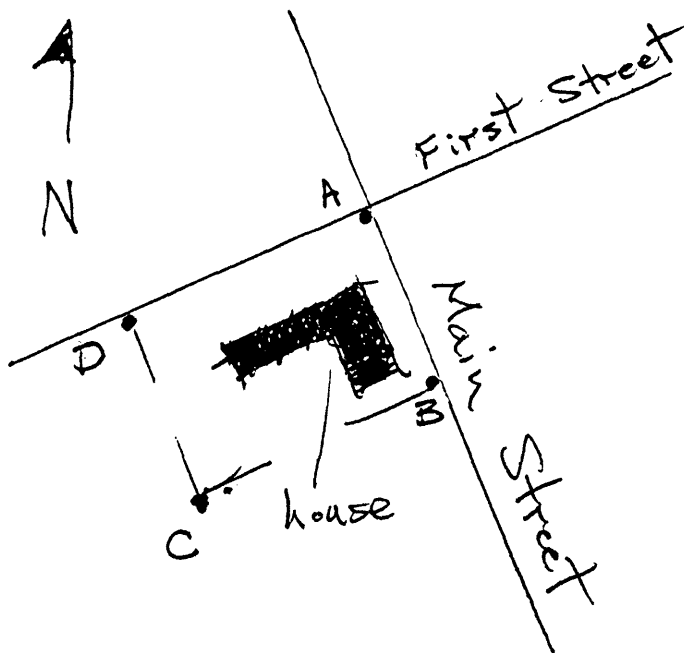

The nominated property occupies the east 85' of city lots 17 and 19 and is roughly 140' x 85' in size. The boundary includes the parts of the city lots historically associated with the property that are currently under one ownership with the house.

Contributing: 1 building

45. Description and House Plan:

The 1½-story main block, facing northeast, has an unusual form in the county, the saddlebag form. The staircase to the upper half-story rises between the two chimney-breasts, the flues, presumably, joining above the staircase. The front door, a dual-leaf door with a four-light transom, leads to a small vestibule with doors to the two main rooms. The door is centrally located in the facade, but the windows are slightly asymmetrically arranged. The windows in the facade have 12/12 lights. The back room of the ell, a kitchen with a 6/6 light window, may be an original room, but the connector is a later enclosure of an open hyphen. The small block on the left end of the building is a shed-roofed addition. The upper windows in the gable-ends seem original, but the lower window in the righthand (northwest) gable-end is a mid-20th century insertion.

Much of the woodwork of the exterior and interior has the profile of early Greek Revival moldings, including the exterior cornice and frieze board. Both of the mantels in the main block combine shelf-and-frame and pilastered designs, with slender, crude pilasters and shallow shelves.

---

13. Statement of Significance: (Continued)

---

Saddlebag houses in Kentucky were built of stone, log or wood frame, invariably gable-roofed, and coincided roughly with the federal stylistic period, 1790s through the 1840s. This property is one of only two saddlebag houses identified in Boone County, the other being constructed of logs and lacking integrity. Among house types with two-room plans, the clear preference of Boone County builders, as in the rest of Kentucky, based on the numbers of surviving resources, was for the double-pen type, the dogtrot type, or the single rectangular pen divided into two rooms. In addition, this property is unusual in that it was built of frame rather than log construction, by far the most common construction method among surviving examples of the type in Kentucky during the period.

DEC 28 1988

3297

KENTUCKY HISTORIC RESOURCES  
Individual Inventory Form

Resource # Be-362  
Boone County

1. Name of Resource: Early house

2. Original Owner: Unknown

3. Other Names: None

4. Prehistoric Site Building X Object  
Historic Site Structure Other

5. Location: 2970 First Street, Petersburg

6. Owner's Name: Robert Smith (Virginia Smith) [ ]

7. Owner's Address: 2970 First Street  
Petersburg, KY 41084

8. Evaluation: National Register [ ]

9. Recognition & Date:  
Nat.Landmark \_\_\_\_\_ Local Landmark \_\_\_\_\_  
Nat.Register \_\_\_\_\_ HABS/HAER \_\_\_\_\_  
Highway Marker \_\_\_\_\_ KY Inventory 1987 \_\_\_\_\_  
KY Landmark Certificate \_\_\_\_\_

10. N.R.Status & Date:

11. N.R.Group:  
District Name: [ ]  
Mult.Resource Area: Boone County [ ]  
Thematic Name: [ ]

12. Historical Theme:  
Primary: Architecture [ ]  
Secondary: [ ]  
Other: [ ]

13. Statement of Significance:  
This property is significant under criterion C as a good example of a rare surviving house type, the saddlebag house, significant to Boone County in the period 1795-1845. This type consists of two pens, usually of the same dimensions, typically square, on either side of a masonry chimney.  
(Continued) [ ]

16. Date: Original Building c. 1820s-1830s [ ]  
Addition [ ]

17. Style: late Federal [ ]  
[ ]

18. Architect/Builder: unknown

19. No. of Stories: 1 1/2 [ ]

20. Original Floor Plan: saddlebag [ ]

21. Single Pile X Double Pile N.A.

22. Roof Form & Material: Original X  
gable/st. sm. tin Not Original

23. Structural Material: wood frame [ ]

24. Exterior Material: weatherboard [ ]

25. Foundation Material: fieldstone [ ]

26. Major Alterations: None  
Moved/Rebuilt Other X  
Additions X portion of ell

27. Special Features: central chimney

28. Outbuildings: none [ ]

29. Original Function: dwelling [ ]

30. Present Use: dwelling [ ]

31. Condition: good [ ]

32. Endangered: Yes  
No X

33. Attach Photos:  
Roll: Photo Nos: No. of Slides:  
16 1-7

14. History:  
The 1883 atlas indicated the house, complete with ell, was the residence of Mrs. Early.

15. Source of historical information and/or contact person: 1883 Atlas

34. Prepared by: Kenneth T. Gibbs  
35. Organization: Boone Co.Hist.Pres.Rev. Brd.  
36. Date: September 1986  
37. New Survey X Resurvey

KENTUCKY HISTORIC RESOURCES  
 Individual Inventory Form

Resource # Be-362

38. UTM Point of Primary Building: Zone Easting Northing 39. G.I.S. Mod. [ ]  
 Quadrant: Lawrenceburg 16 684725 4326465 40. Coordi.Accuracy [ ]

41. UTM Points of Boundary (for N. R. eligible sites only):

A.	-----	D.	-----
B.	-----	E.	-----
C.	-----	F.	-----

42. Total Acreage in Present Property: 0.27 43. Acreage included in proposed N.R. boundary: 0.27

44. Site Plan (and boundary description and justification for N.R. sites):

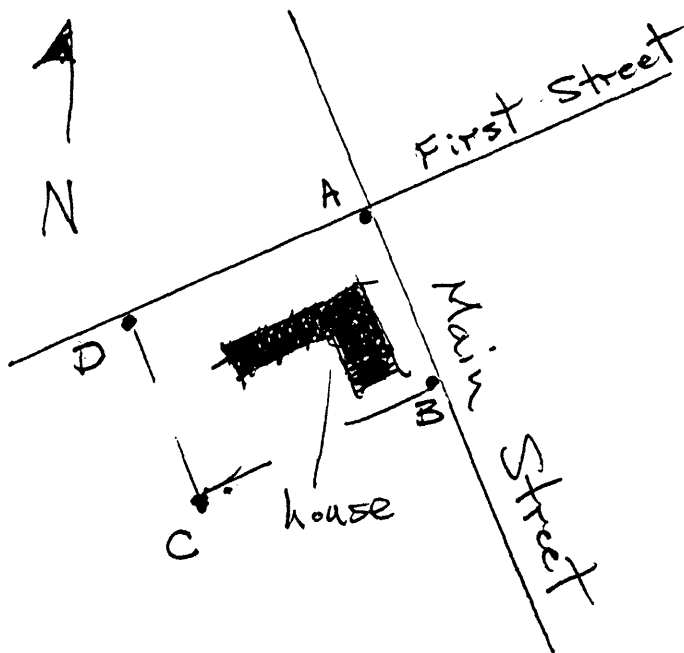

The nominated property occupies the east 85' of city lots 17 and 19 and is roughly 140' x 85' in size. The boundary includes the parts of the city lots historically associated with the property that are currently under one ownership with the house.

Contributing: 1 building

45. Description and House Plan:

The 1½-story main block, facing northeast, has an unusual form in the county, the saddlebag form. The staircase to the upper half-story rises between the two chimney-breasts, the flues, presumably, joining above the staircase. The front door, a dual-leaf door with a four-light transom, leads to a small vestibule with doors to the two main rooms. The door is centrally located in the facade, but the windows are slightly asymmetrically arranged. The windows in the facade have 12/12 lights. The back room of the ell, a kitchen with a 6/6 light window, may be an original room, but the connector is a later enclosure of an open hyphen. The small block on the left end of the building is a shed-roofed addition. The upper windows in the gable-ends seem original, but the lower window in the righthand (northwest) gable-end is a mid-20th century insertion.

Much of the woodwork of the exterior and interior has the profile of early Greek Revival moldings, including the exterior cornice and frieze board. Both of the mantels in the main block combine shelf-and-frame and pilastered designs, with slender, crude pilasters and shallow shelves.

---

13. Statement of Significance: (Continued)

---

Saddlebag houses in Kentucky were built of stone, log or wood frame, invariably gable-roofed, and coincided roughly with the federal stylistic period, 1790s through the 1840s. This property is one of only two saddlebag houses identified in Boone County, the other being constructed of logs and lacking integrity. Among house types with two-room plans, the clear preference of Boone County builders, as in the rest of Kentucky, based on the numbers of surviving resources, was for the double-pen type, the dogtrot type, or the single rectangular pen divided into two rooms. In addition, this property is unusual in that it was built of frame rather than log construction, by far the most common construction method among surviving examples of the type in Kentucky during the period.