

UNITED STATES DEPARTMENT OF THE INTERIOR
NATIONAL PARK SERVICE

FOR NPS USE ONLY

RECEIVED JUL 8 1976

DATE ENTERED JUL 8 1977

NATIONAL REGISTER OF HISTORIC PLACES
INVENTORY -- NOMINATION FORM

SEE INSTRUCTIONS IN HOW TO COMPLETE NATIONAL REGISTER FORMS
TYPE ALL ENTRIES -- COMPLETE APPLICABLE SECTIONS

1 NAME

HISTORIC

Thomas Wynne House

AND/OR COMMON

Old Russell Place

2 LOCATION

STREET & NUMBER

N of Lilburn on U.S. 29

Jackson

Between U.S. 29 Hwy. and old U.S. 29, just east of Creek

CITY, TOWN

NOT FOR PUBLICATION

CONGRESSIONAL DISTRICT

Lilburn

VICINITY OF

9th

STATE

CODE

COUNTY

CODE

Georgia

13

Gwinnett

135

3 CLASSIFICATION

CATEGORY

OWNERSHIP

STATUS

PRESENT USE

__DISTRICT

__PUBLIC

__OCCUPIED

__AGRICULTURE

__MUSEUM

BUILDING(S)

PRIVATE

UNOCCUPIED

__COMMERCIAL

__PARK

__STRUCTURE

__BOTH

__WORK IN PROGRESS

__EDUCATIONAL

__PRIVATE RESIDENCE

__SITE

PUBLIC ACQUISITION

ACCESSIBLE

__ENTERTAINMENT

__RELIGIOUS

__OBJECT

__IN PROCESS

__YES: RESTRICTED

__GOVERNMENT

__SCIENTIFIC

__BEING CONSIDERED

YES: UNRESTRICTED

__INDUSTRIAL

__TRANSPORTATION

__NO

__MILITARY

OTHER: not in use

4 OWNER OF PROPERTY

NAME

Mr. John R. Frasier

STREET & NUMBER

3979 A-Lawrenceville Road

CITY, TOWN

STATE

Tucker

VICINITY OF

Georgia

5 LOCATION OF LEGAL DESCRIPTION

COURTHOUSE,
REGISTRY OF DEEDS, ETC.

Gwinnett County Court House

STREET & NUMBER

CITY, TOWN

STATE

Lawrenceville

Georgia

6 REPRESENTATION IN EXISTING SURVEYS

TITLE

None

DATE

__FEDERAL __STATE __COUNTY __LOCAL

DEPOSITORY FOR
SURVEY RECORDS

CITY, TOWN

STATE

7 DESCRIPTION

CONDITION		CHECK ONE	CHECK ONE
<input type="checkbox"/> EXCELLENT	<input checked="" type="checkbox"/> DETERIORATED	<input type="checkbox"/> UNALTERED	<input checked="" type="checkbox"/> ORIGINAL SITE
<input type="checkbox"/> GOOD	<input type="checkbox"/> RUINS	<input checked="" type="checkbox"/> ALTERED	<input type="checkbox"/> MOVED DATE _____
<input type="checkbox"/> FAIR	<input type="checkbox"/> UNEXPOSED		

DESCRIBE THE PRESENT AND ORIGINAL (IF KNOWN) PHYSICAL APPEARANCE

The Thomas Wynne House, located between U.S. Hwy. 29 and Old U.S. Hwy 29 east of Jackson Creek near Lilburn, dates from the early 1820's. Oral tradition suggests that Thomas Wynne built this plantation plain style house with later Greek Revival and Victorian additions, shortly after he and his family moved to Gwinnett County from South Carolina.

What is exactly the original portion of the Wynne House is unknown, however, a break in the foundation system as well as corresponding breaks in the flooring within the house suggest the house was constructed in at least two different stages.

Presently the house is a typical plantation plain style house, a two room central hall house with exterior end chimneys of American bond, and a shed jigsaw embellished front porch. The center gable on the front facade with its diamond patterned louvered vent is echoed in the rear one-story kitchen.

The windows of the three bay northern, or front facade are simply framed six over six lights, and are slightly off axis. In proportion, the windows of the second story are smaller and apparently earlier than the larger windows of the first floor.

The front porch is supported by four square Tuscan columns and two Tuscan pilasters are set flush against the front of the house. Also, the end cover boards appear as Tuscan pilasters which rise uninterrupted to the top of the second floor. The doorway with its trabeated transom and sidelights is framed by the center columns.

The eastern and western facades of the original Wynne House are almost identical with their boxed cornice and returns. The only deviation is the amount of buttressing of the chimneys.

A southwestern view of the house reveals the L-shaped shed porch which visually unites the plantation plain portion which originally would have had two-three bays, with the added kitchen which blocked off the eastern bay.

Upon entering the Wynne House access to the second floor is gained by the straight staircase in the central hallway. The two main rooms downstairs contain end fireplaces, wide horizontal paneling and floor boards. There are three rooms off the central hall of the second floor, the western portion being one large room with an end fireplace, while the eastern portion has been divided into two small rooms with no fireplace. Originally there was probably no fireplace because the chimney is removed slightly from the wall on the exterior to reveal original beaded weatherboarding. The partitions with their vertical paneling were added at a later date, which leads one to realize that other interior floor plans could have existed, possibly two rooms upstairs and two rooms downstairs.

The two downstairs mantels with their Tuscan pilasters and curved frieze, plus the dog-eared molding of the windows and doors reflect Greek Revival influence and were probably c.1850 additions. The mantel in the eastern room is capped by a pediment, the western one is not. The western upstairs fireplace opening has a segmental arch and appears to date at least in the early 1820's.

UNITED STATES DEPARTMENT OF THE INTERIOR
NATIONAL PARK SERVICE

**NATIONAL REGISTER OF HISTORIC PLACES
INVENTORY -- NOMINATION FORM**

FOR NPS USE ONLY		
RECEIVED	JUL 8	1976
DATE ENTERED	JUL 8	1977

CONTINUATION SHEET Description ITEM NUMBER 7 PAGE 2

Description

In the western parlor there are remnants of two layers of wall paper, a beige leafy pattern over a solid blue.

Few doors remain in the Wynne House, one to the west parlor is four panels (two large above two small), and one to an added closet which resembles the three batten doors of the second floor. Most of the locks are of the swivel-bolt type and sometimes with peg pulls.

The second floor west room has exposed beams and wide paneling. The mantelpiece is non-existent, however, three square panels on the wide frieze suggest c.1810-20 type mantel. Through the southeastern room one may gain access onto the loft over the kitchen.

The alterations in the Wynne House seem to correspond to three major periods c.1848, c.1866, c.1878. The original structure may have been converted to plantation plain as late as c.1848. In c.1866 the downstairs mantelpieces and molding could have been added. The kitchen gables, boxed cornices and returns of the east and west facades, the present porches, and the partitions were added around 1878. These changes would have conformed to the more modern trend of the Victorian style.

None of the original outbuilding have survived. By oral tradition it is known that a wash house existed at the creek behind the house. In the Wynne family cemetery, located the other side of U.S. Hwy 29, Thomas Wynne, his wife and three of their children are buried. A highway and commercial intrusions prevent this area from being nominated together with the Wynne House. Though deteriorating and overgrown, one can see evidence of past landscaping in the cottonwood beside the front porch, the cedar, crepe myrtle and a row of daffodils in the backyard.

Significance Item Number 8 Page 2

Presently the house is in a deteriorating condition, but as such has come to the attention of several local residents and plans have been suggested for its restoration as a local meeting place.

Major Bibliographical References Item Number 9 Page 2

- Norton, Nancy, Personal Inspection, April 2, 1976
- Norton, Nancy, Personal Inspection, April 7, 1976
- Sawyer, Janis, Personal Interview, April 1, 1976
- Tax Digest, Gwinnett 1872-1875 (parts) 1875 (parts) 1880-1883

8 SIGNIFICANCE

PERIOD	AREAS OF SIGNIFICANCE -- CHECK AND JUSTIFY BELOW			
<input type="checkbox"/> PREHISTORIC	<input type="checkbox"/> ARCHEOLOGY-PREHISTORIC	<input type="checkbox"/> COMMUNITY PLANNING	<input type="checkbox"/> LANDSCAPE ARCHITECTURE	<input type="checkbox"/> RELIGION
<input type="checkbox"/> 1400-1499	<input type="checkbox"/> ARCHEOLOGY-HISTORIC	<input type="checkbox"/> CONSERVATION	<input type="checkbox"/> LAW	<input type="checkbox"/> SCIENCE
<input type="checkbox"/> 1500-1599	<input type="checkbox"/> AGRICULTURE	<input type="checkbox"/> ECONOMICS	<input type="checkbox"/> LITERATURE	<input type="checkbox"/> SCULPTURE
<input type="checkbox"/> 1600-1699	<input checked="" type="checkbox"/> ARCHITECTURE	<input type="checkbox"/> EDUCATION	<input type="checkbox"/> MILITARY	<input type="checkbox"/> SOCIAL/HUMANITARIAN
<input type="checkbox"/> 1700-1799	<input type="checkbox"/> ART	<input type="checkbox"/> ENGINEERING	<input type="checkbox"/> MUSIC	<input type="checkbox"/> THEATER
<input checked="" type="checkbox"/> 1800-1899	<input type="checkbox"/> COMMERCE	<input type="checkbox"/> EXPLORATION/SETTLEMENT	<input type="checkbox"/> PHILOSOPHY	<input type="checkbox"/> TRANSPORTATION
<input type="checkbox"/> 1900-	<input type="checkbox"/> COMMUNICATIONS	<input type="checkbox"/> INDUSTRY	<input type="checkbox"/> POLITICS/GOVERNMENT	<input checked="" type="checkbox"/> OTHER (SPECIFY) History
		<input type="checkbox"/> INVENTION		

SPECIFIC DATES c.1826

BUILDER/ARCHITECT

STATEMENT OF SIGNIFICANCE

The significance of the Thomas Wynn House, c.1820 is its importance to the local community as a part of their early history as well as its being a prime example of a plantation plain structure to which additions including Greek Revival and Victorian were made as tastes changed.

The structure is thought to have been constructed c.1820-26, when Thomas Wynne and his family moved to Gwinnett County from South Carolina. The segmental arched opening of the fireplace which is rarely found later than the early 1820's supports this earlier date.

Thomas Wynne and his wife Mary P. Wynne (Benson) left their home in Greenville District, South Carolina with seven children under twelve years of age. Originally the Wynne Plantation was approximately 500-600 acres, according to a Wynne descendant (Mrs. Harriet Boozer). Mary P. Wynne was also, entitled to 130 additional acres because her husband was a veteran of the war of 1812. This land was probably in Alabama because most of the land in Georgia had been taken. According to Gwinnett County Tax Digest when Robert Reed inherited the land he retained the 250 acres on which the home stood. Mary Prince Benson Wynne's father Thomas Benson served in the Revolutionary War and her great grandfather was a member of the Virginia House of Burgesses.

Before Thomas Wynne's death in 1839, seven more Wynne children were born. At Thomas' death Mary P. Wynne ran the plantation with the help of her children. In 1847, her son Robert Reed Wynne and his bride, Martha Ann Russell moved in. One could logically believe that the structure was of the plantation plain style at this time. Changes in houses were often made with family growth, deaths and transitions in ownership. Mary P. Wynne died in 1886. The addition of Greek Revival mantelpieces and moldings could have been made at this time. According to Gwinnett County Tax Digests Robert Reed's wealth steadily increased in 1875 the aggregate value of his whole property was \$2915, therefore changes and additions in the house were favored. In 1878 Robert Reed Wynne and family moved to College Park, Georgia and sold the house and property to a younger brother of Martha Ann, his wife, Nathan Russell. Sometime between 1878 and the early 1900's the kitchen, gables, boxed cornice and returns on the east and west facades, the present porches, and partitions were added. These additions followed the Victorian mode of architecture. The rise in Nathan Russell's wealth would also, support this idea. According to the Gwinnett County Tax Digest of 1883 he owned five-eighths pieces of silver, watches or jewelry which represented certain degree of luxury. At Nathan's death the property was divided up. George Allen Russell, one of his sons inherited the property on which the homeplace stood, and lived there until his death. His surviving wife Mary, remained in the house until her death in January of 1971 at 97 years of age.

9 MAJOR BIBLIOGRAPHICAL REFERENCES

Boozer, Mrs. Harriet, application to D.A.R.
 Flanigan, J.C., History of Gwinnett County
 Gwinnett Daily News, Local Focus, Wednesday, September 3, 1975-1B
 Kelley, Dr. D.C., personal interview, April 2, 1976
 Macgregor, Elizabeth, survey file; personal inspection, March 1976.
 Norton, Nancy, Personal Inspection, April 1, 1976

10 GEOGRAPHICAL DATA

ACREAGE OF NOMINATED PROPERTY 3.7 acres

UTM REFERENCES

A	16	7614610	3754470	B			
	ZONE	EASTING	NORTHING		ZONE	EASTING	NORTHING
C				D			

VERBAL BOUNDARY DESCRIPTION

The northwestern corner of the boundary of the Wynne House site is located at the intersection of Old Hwy. 29 and U.S. Hwy. 29. From this point the boundary runs for approximately 180' at which point Old Hwy. 29 turns east. The boundary then runs east for approximately 810' at which point a wire and post fence runs southwest for approximately 541' and ends back at U.S. Hwy 29. From there the boundary runs west for approximately 541' until it joins the beginning point.

LIST ALL STATES AND COUNTIES FOR PROPERTIES OVERLAPPING STATE OR COUNTY BOUNDARIES

STATE	CODE	COUNTY	CODE
STATE	CODE	COUNTY	CODE

11 FORM PREPARED BY

NAME / TITLE

Nancy Norton Intern (Elizabeth Z. Macgregor, Architectural Historian, Consultant)

ORGANIZATION

Historic Preservation Section, Dept. of Natural Resources DATE April 16, 1976

STREET & NUMBER

270 Washington Street, S.W., Room 703-C

TELEPHONE

(404) 656-2840

CITY OR TOWN

Atlanta

STATE

Georgia

12 STATE HISTORIC PRESERVATION OFFICER CERTIFICATION

THE EVALUATED SIGNIFICANCE OF THIS PROPERTY WITHIN THE STATE IS:

NATIONAL

STATE

LOCAL

As the designated State Historic Preservation Officer for the National Historic Preservation Act of 1966 (Public Law 89-665), I hereby nominate this property for inclusion in the National Register and certify that it has been evaluated according to the criteria and procedures set forth by the National Park Service

STATE HISTORIC PRESERVATION OFFICER SIGNATURE

David M. Sherman
 DAVID M. SHERMAN

DATE

7-2-76

TITLE

Chief, Historic Preservation Section

FOR NPS USE ONLY

I HEREBY CERTIFY THAT THIS PROPERTY IS INCLUDED IN THE NATIONAL REGISTER

DATE

7/8/77

DIRECTOR, OFFICE OF ARCHEOLOGY AND HISTORIC PRESERVATION

ATTEST

DATE

6.14.77

KEEPER OF THE NATIONAL REGISTER

UNITED STATES DEPARTMENT OF THE INTERIOR
NATIONAL PARK SERVICE

**NATIONAL REGISTER OF HISTORIC PLACES
INVENTORY -- NOMINATION FORM**

FOR NPS USE ONLY		
RECEIVED	JUL 8	1976
DATE ENTERED	JUL 8	1977

CONTINUATION SHEET Photographs ITEM NUMBER PAGE

Thomas Wynne House - Gwinnett County

Photographs by: David J. Kaminsky

Date: March, 1976

1. North (front) facade.
2. East facade.
3. Southeast portion of house.
4. Mantelpiece - northwest room, first floor.
5. Fireplace - northwest room, second floor.
6. Hallway, first floor, looking northwest.
7. Second floor hallway.

Thomas Wynne House
Gwinnett County
Lilburn, Ga.

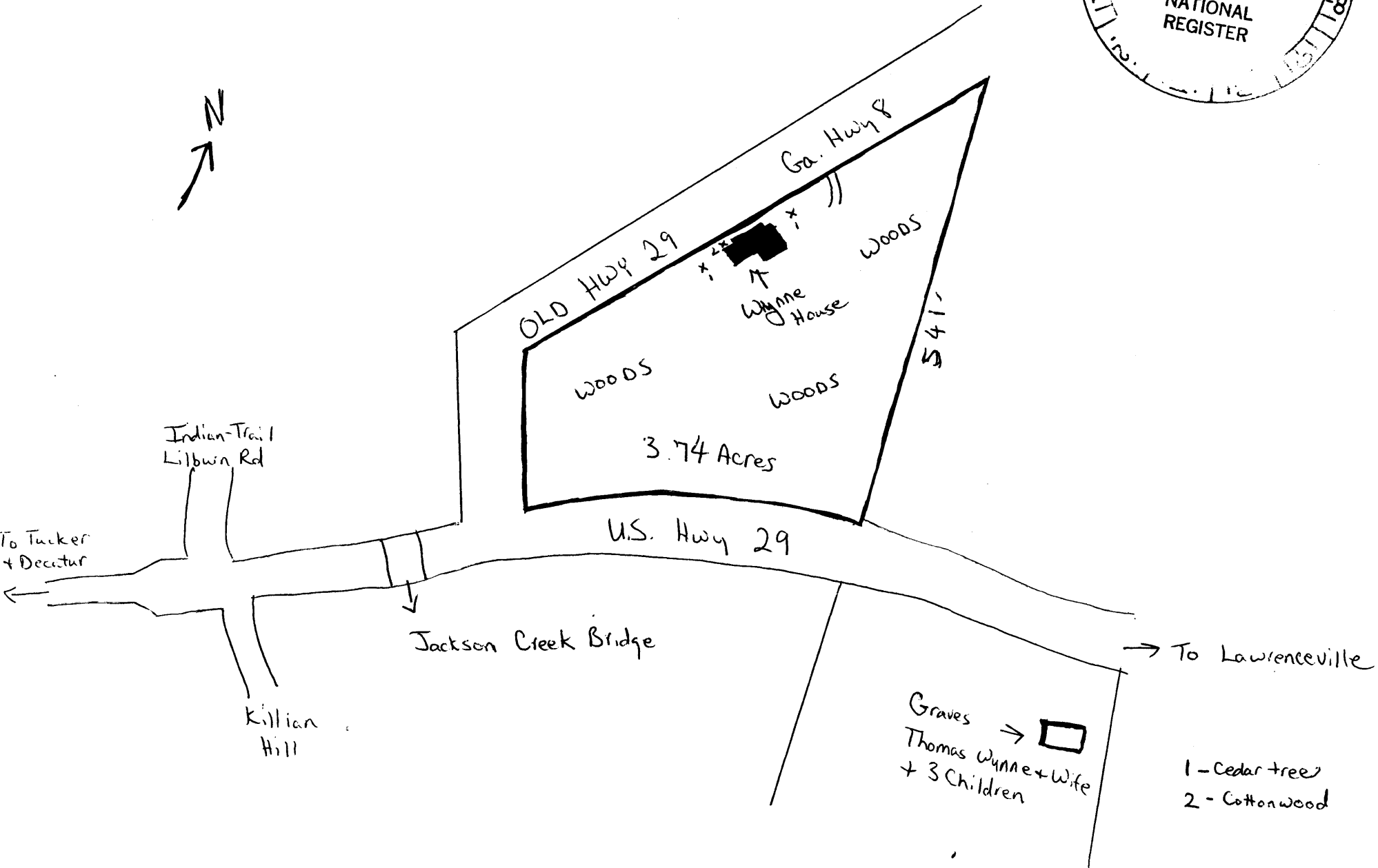
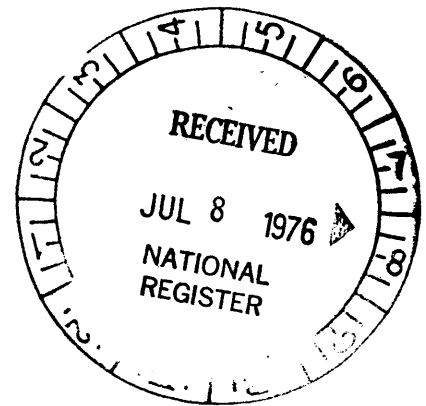

UNITED STATES DEPARTMENT OF THE INTERIOR
NATIONAL PARK SERVICE

**NATIONAL REGISTER OF HISTORIC PLACES
PROPERTY MAP FORM**

FOR NPS USE ONLY	
RECEIVED	JUL 8 1976
DATE ENTERED	JUL 8 1977

SEE INSTRUCTIONS IN *HOW TO COMPLETE NATIONAL REGISTER FORMS*
TYPE ALL ENTRIES --| ENCLOSE WITH MAP

1 NAME

HISTORIC Thomas Wynne House

AND/OR COMMON

Old Russell Place

2 LOCATION

CITY, TOWN Lilburn

VICINITY OF Gwinnett

COUNTY

Georgia

STATE

3 MAP REFERENCE

SOURCE Nancy Norton

SCALE Not to Scale

DATE April, 1976

REQUIREMENTS

TO BE INCLUDED ON ALL MAPS

1. PROPERTY BOUNDARIES
2. NORTH ARROW
3. UTM REFERENCES