

KENTUCKY HISTORIC RESOURCES INVENTORY

Site No. Tm-27

1. Historic Name(s) Yeager General Store		22. ADD/County N. Ky/Tm <span style="float:right">1 1 2</span>	
Original Owner		23. U.S.G.S. Quadrant (15'/75') Bethlehem <span style="float:right">G.I.S. Mod. [ ] [ ] [ ]</span>	
2. Present Name		24. UTM Reference 1, 6   6, 3, 8, 7, 8, 0   4, 2, 7, 0, 1, 2, 0 Zone Easting Northing	
3. Location Barebone Road, in Wise's Landing		25. Coordinate Accuracy <span style="float:right">[ ]</span>	
4. Owner's Name Mrs. Betty Jo Raush		26. Prehistoric Site Historic Site <u>Building</u> <span style="float:right">Object Structure Other</span>	
5. Owner's Address Route 1, Meadow Lane, Conestoga, Pa. 17516		27. National Register District Name: Historic Resources of Trimble County <span style="float:right">[ ] [ ] [ ]</span>	
6. Open to Public Yes ___ No <u>X</u>	7. Visible from road Yes <u>X</u> No ___	8. Ownership Private <input checked="" type="checkbox"/> Local <input type="checkbox"/> State <input type="checkbox"/> Federal <input type="checkbox"/>	28. Significance Evaluation N.R. <span style="float:right">[ D ]</span>
9. Local Contact/Organization		29. Status <span style="float:right">Date</span> National Landmark <input type="checkbox"/> National Register <input type="checkbox"/> Landmark Certificate <input type="checkbox"/> Kentucky Survey <input type="checkbox"/> Local Landmark <input type="checkbox"/> HABS/HAER <input type="checkbox"/>	
10. Site Plan with North Arrow		30. Historic Theme Primary <u>Commerce</u> <span style="float:right">[ E ]</span> Secondary <u>Architecture</u> <span style="float:right">[ C ]</span> Other <input type="checkbox"/>	
11. Architect		31. Endangered Yes ___ No <u>  </u>	
12. Builder		32. Preservation Project Status <span style="float:right">[ ]</span>	
13. Date Ca: 1911 A. <u>6</u> B. <input type="checkbox"/>		Actual Cost in \$1,000s <span style="float:right">[ ] [ ] [ ] [ ]</span>	
14. Style A. Vernacular <input checked="" type="checkbox"/> B. <input type="checkbox"/>		33. ATTACH PHOTO	
15. Original Use General Store <input checked="" type="checkbox"/>			
16. Present use Vacant			
17. Condition Good <input checked="" type="checkbox"/>		34. Prepared by: Wm. Gus Johnson Sr. Historian & Photographer	
18. Description Two-story frame bldg. 5-bay with entrance in center and side bays. Windows 2/2 pane with architrave trim. 3-bay on sides. Facade enhanced by 6 diamond shaped l-pane windows; 1 over each side		35. Organization Kentucky Heritage Council	
19. History Second general store on same site.		36. Date Fall 1982	
20. Significance Commerce: The building is a well-preserved example of general stores found in small rural communities. It is the only remaining general (over)		37. Revision Dates	
21. Source of information		38. Staff Review	

(Continue on Back)

20. store in the small community of Wise's Landing, one of two river towns on the Ohio River in the county.

KENTUCKY HISTORIC RESOURCE INVENTORY SUPPLEMENT  
BOUNDARY AND LOCATION INFORMATION

Historic Property Name Yeager General Store Site # Tm-27

Multiple Resource/Thematic Nomination Title Historic Resources of Trimble County

U.T.M. Coordinates - List multiple UTM's if property is ten or more acres.

A. 16 638780 4270120 D. \_\_\_\_\_

B. \_\_\_\_\_ E. \_\_\_\_\_

C. \_\_\_\_\_ F. \_\_\_\_\_

Verbal Boundary Description \_\_\_\_\_ Acreage .33

Beginning at a point on the south side of Barebone Road, proceed 67' in a south eastward direction; thence 150' in a south westward direction; thence 67' in a north westward direction; and thence 150' in a north eastward direction along Barebone Road to the starting point.

Sketch of Site Plan (Showing outbuildings, structures, landscape features and the site boundary as described above.)

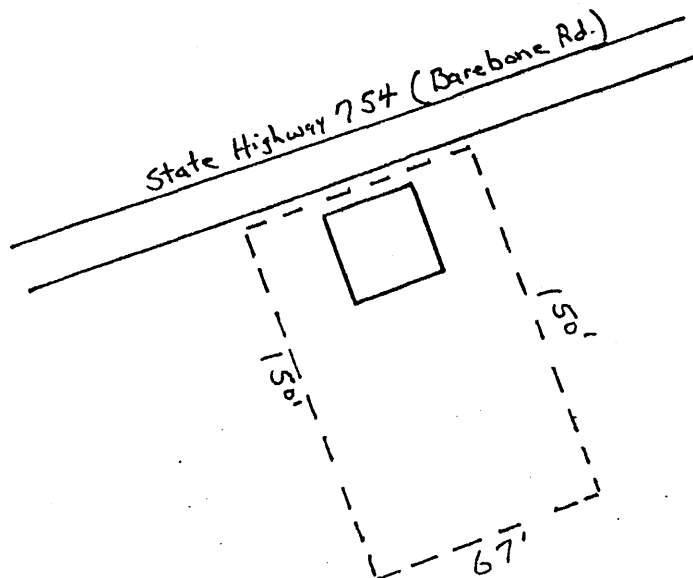

Not to scale

Official Courthouse Property Reference: