

United States Department of the Interior
National Park Service

National Register of Historic Places Continuation Sheet

Section number _____ Page _____

SUPPLEMENTARY LISTING RECORD

NRIS Reference Number: 91000157 Date Listed: 3/6/91

<u>North Bend Ranger Station</u>	<u>King</u>	<u>WA</u>
Property Name	County	State

USDA Forest Service Administrative Buildings in OR and WA Built
by the CCC
Multiple Name

 This property is listed in the National Register of Historic
 Places in accordance with the attached nomination documentation
 subject to the following exceptions, exclusions, or amendments,
 notwithstanding the National Park Service certification included
 in the nomination documentation.

<i>for</i> <u><i>Austin Lee</i></u>	<u>3/6/91</u>
Signature of the Keeper	Date of Action

=====
Amended Items in Nomination:

Statement of Significance: The check next to Criteria
Consideration G should be deleted. The Period of Significance
should be amended to read: 1933-41.

This information was confirmed with Evan DeBloois, Preservation
Officer, Forest Service.

DISTRIBUTION:

National Register property file
Nominating Authority (without nomination attachment)

United States Department of the Interior
National Park Service

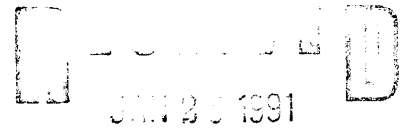

**NATIONAL REGISTER OF HISTORIC PLACES
REGISTRATION FORM**

**NATIONAL
REGISTER**

This form is for use in nominating or requesting determinations of eligibility for individual properties or districts. See instructions in "Guidelines for Completing National Register Forms" (National Register Bulletin 16). Complete each item by marking "x" in the appropriate box or by entering the requested information. If an item does not apply to the property being documented, enter "N/A" for "not applicable". For functions, styles, materials, and areas of significance, enter only the categories and subcategories listed in the instructions. For additional space use continuation sheets (Form 10-900a). Type all entries.

1. Name of Property

historic name NORTH BEND RANGER STATION

other names/site number N/A

2. Location

street & number 42404 SE North Bend Way /NA/not for publication

city, town North Bend /NA/vicinity

state Washington code WA county King code 033 zip code 98045

3. Classification

Ownership of Property	Category of Property	Number of Resources within Property	
		Contributing	Noncontributing
<input type="checkbox"/> private	<input type="checkbox"/> building(s)		
<input type="checkbox"/> public-local	<input checked="" type="checkbox"/> district	<u>9</u>	<u>8</u> buildings
<input type="checkbox"/> public-State	<input type="checkbox"/> site		<u>0</u> sites
<input checked="" type="checkbox"/> public-Federal	<input type="checkbox"/> structure	<u>1</u>	<u>0</u> structures
	<input type="checkbox"/> object		<u>0</u> objects
		<u>10</u>	<u>8</u> Total

Name of related multiple property listing:

USDA Forest Service Administrative Buildings in the States of Ore. and Wa. Built by the Civilian Conservation Corps

Number of contributing resources previously listed in the National Register 0

4. State/Federal Agency Certification

As the designated authority under the National Historic Preservation Act of 1966, as amended, I hereby certify that this nomination request for determination of eligibility meets the documentation standards for registering properties in the National Register of Historic Places and meets the procedural and professional requirements set forth in 36 CFR Part 60. In my opinion, the property meets does not meet the National Register criteria. See continuation sheet.

Edward J. DeBoer
Signature of certifying official

1-8-91
Date

USDA Forest Service
State or Federal agency and bureau

In my opinion, the property meets does not meet the National Register criteria. See continuation sheet.

James L. [Signature]
Signature of commenting or other official

10/11/90
Date

Office of Archaeology and Historic Preservation
State or Federal agency and bureau

5. National Park Service Certification

I, hereby, certify that this property is:

entered in the National Register.

See continuation sheet.

determined eligible for the National Register.

See continuation sheet.

determined not eligible for the National Register.

removed from the National Register.

other, (explain:)

Autawiethe Lee

3/6/91

Signature of the Keeper

Date of Action

6. Function or Use

Historic Functions (enter categories from instructions)

GOVERNMENT/government office

Current Functions (enter categories from instructions)

GOVERNMENT/government office

7. Description

Architectural Classification (enter categories from instructions)

OTHER: Rustic architecture of USDA Forest Service in the Pacific Northwest Region

Materials enter categories from instructions)

foundation CONCRETE
walls WOOD/weatherboard

roof WOOD/shakes

other lava rubble, vertical board & batten, metal

Describe present and historic physical appearance.

North Bend Ranger Station

Recreation Office #2032: 1936; 28' x 55'6"; T-shaped, 1 story, wood frame, poured concrete foundation, split-shake medium gable roof with gabled hip on north, center cross-gable projecting on east facade, hip roof section abuts north gable end. Single coursed, squared-rubble masonry chimney, centered, main ridgeline. Horizontal clapboard exterior, vertical boards, battens every other board on all gable ends and gablets. Six-over-six double-hung sashes, singly and in combinations with mullions. Main entrance off-center on east facade, porch formed by extension of gabled hip, supported by large squared timber post, slender, slightly curving brackets affixed; Porch platform of coursed-rubble masonry, flagstone surface, open, two straight steps. Single, well-defined pine tree cutout centered on gablet above main entry. Building #2032 was formerly used by the Protective Assistant; residence now adapted to administrative use. Hip roof section abutting north gable end was on attached garage. Modifications include replacement of two-leaf vertical board doors with bearing wall clad with horizontal clapboard, with aluminum casement window centered on east elevation. Windows either introduced or replaced (aluminum casements) on north and west garage elevations.

X See continuation sheet

United States Department of the Interior
National Park Service

**NATIONAL REGISTER OF HISTORIC PLACES
CONTINUATION SHEET**

North Bend Ranger Station

Section number 7 Page 1

Equipment Repair Shop #2130: 1936; T-shaped, 1 story wood frame, poured concrete foundations, wood-shingled gabled hip roof, projecting center gable on north (rear) elevation, large gabled dormer, unlighted, center south slope of roof. Horizontal clapboard exterior, end boards, vertical boards, battens every board on west gablet and north-facing center gable end. Nine-light sashes, singly and in combinations of eight with mullions and four surmounted by four six-light sashes with mullions. Six bays in length, six large vertical-lift doors interspaced on south (main) facade. No decoration. Overhead lift doors replace original 2-leaf folding doors within unaltered structural opening. A series of photographs taken between 1936 and 1937 show that a 3-bay shop was constructed on the western half of the site in 1936, a second shop of similar design was added immediately to the east in 1937, and the two buildings were joined in 1938. The gabled dormer in the south slope of the roof marks the area enclosed to join the two buildings.

Fire Office #2033: 1937; 29' x 38'; Rectangular, 1 story, wood frame, poured concrete foundation, wood-shingled gabled hip roof with projecting gabled porch offset on north (main) facade supported by heavy squared-timber posts with short slender curving brackets affixed. Horizontal clapboard exterior, vertical boards, battens every other board on gablets and porch pediment. Nine-light sashes singly and in combinations with mullions. Main entry is flanked by nine-light sashes and surmounted by three six-light sashes. Large vertical decoration. Two-leaf vertical board doors on north (main) facade enclosed by bearing wall clad with horizontal 1 x 12 beveled siding. A 9-over-9 double-hung sash window has been introduced on north facade, offset to left. On the west elevation, an elevated leading door was enclosed by horizontal 1 x 12 beveled siding, and a nine-light single-sash window introduced, offset to left. The impact of these structural modifications is minimized by careful reference to overall rustic design characteristics and material continuity with other buildings in group.

Warehouse #2230: 1936; 50' x 80'; Rectangular 1-1/2 story, wood frame, poured concrete foundation, wood-shingled gabled hip roof, two large gabled dormers on both east and west slopes of roof, part of east (front) wall recessed to cover plank and timber loading dock; roof supported by five heavy squared-timber posts having short, slender curving brackets affixed. Horizontal clapboard exterior, and boards, vertical boards and battens on gablets and dormers. Nine-light sash windows in combination with mullions. Two-leaf hinged doors extending to height of ground story level, centered on south gable end. No decoration. Parachute practice platform recently installed on north gable end, with no significant structural alteration.

Crew House #2034: 1936; Irregular, 1 story, wood-frame, poured concrete foundation, rubble veneer, wood-shingled medium gable roof, gabled hip on east, projecting cross gables offset to right, small porch gable projects, offset to right on north (rear) elevation, center rear roof slope extends between projecting cross gable and porch gable to cover open flagstone platform. Horizontal clapboard exterior, vertical boards, battens every other board on all gable ends, pediments and gablets.

United States Department of the Interior
National Park Service

**NATIONAL REGISTER OF HISTORIC PLACES
CONTINUATION SHEET**

North Bend Ranger Station
Section number 7 Page 2

Crew House #2034, continued: Six-over-six double-hung sashes, singly and paired with mullions. Main entry, off-center to right on south (main) facade; entry recessed at corner of projecting cross gable, supported by by squared timber posts with short curving brackets, porch platform of coursed rubble masonry, flagstone surface, open, two straight stone steps. Rear porch and roof extension supported by squared timber posts with short curving brackets. Single graceful tree logo cutout centered on rear porch pediment. Louvered vents at gable peaks and on gablets. No obvious structural additions or material modifications. Carpenter Shop #2231: 1936; Rectangular; 1 story, wood frame, poured concrete foundation, wood shingled medium gabled hip roof, gable-roofed dormers offset to right and left on front (west) and rear (east) slopes of roof. Horizontal clapboard exteriors, vertical boards, battens on gablets and dormer cheeks and pediments. Nine-light sash in combinations with mullions. Six bays in length. As built, two-leaf folding doors enclosed each bay on both front and rear elevations, providing drive-through access. Subsequent changes include replacement of folding doors with overhead lift doors on four bays on front (west) facade, and two bays on rear (east) elevation. Remaining bays are enclosed with bearing walls clad with 1 x 12 beveled siding as per original specifications for exteriors. While enclosure of major structural openings is a noticeable change, the effect is minimized through use of walls with beveled siding that convey a material and design continuity with other substantial buildings in complex.

Residence #1031, garage #1531: Irregular, 1-1/2 story, wood frame, poured concrete foundation with rubble veneer, wood-shingled medium hipped gable roof, projecting gable offset to right on south (main) facade, gable dormer on north slope of roof, random rubble masonry interior chimney, center south slope of roof, to left of front projecting gable; attached wood-frame garage with wood-shingled medium gable roof abuts east elevation of house. Exteriors are horizontal clapboard (1 x 12 beveled siding) with vertical boards, battens every other board on all gablet and gable ends. Garage exterior is horizontal clapboards, vertical board and batten on gable end. Vertical board doors enclose east gable end. Windows are six-over-six double-hung sash singly and in pairs with mullions. Main entry is centered on south-facing facade, recessed in corner of front projecting gable. Porch is supported by heavy squared-timber posts with short, curved, flush brackets; open flagstone platform is accessed by three straight stone steps. Double-hung sash is west-facing gablet and north-facing gable dormer have been replaced with aluminum casement windows, of smaller dimensions, in horizontal placement. Main facade is unimpaired.

Residence #1030, garage #1530: Irregular, 1-1/2 story, wood frame, poured concrete foundation with rubble veneer, wood-shingled medium hipped-gable roof, projecting gable offset to left on south (main) facade, random rubble masonry interior chimney, center south slope of roof, to right of front projecting gable; attached wood frame garage with wood-shingled medium gable roof abuts west elevation of house. Exteriors are horizontal clapboard (1 x 12 beveled siding) with vertical boards, battens every other board on all gablet and gable ends. Garage exterior is horizontal clapboards, vertical board and batten on gable end. Vertical board doors enclose west gable

United States Department of the Interior
National Park Service

**NATIONAL REGISTER OF HISTORIC PLACES
CONTINUATION SHEET**

North Bend Ranger Station
Section number 7 Page 3

Residence #1030, garage #1530, continued: end. Windows are six-over-six double-hung sash, singly and in pairs with mullions. Main entry is centered on south-facing facade, recessed in corner of front projecting gable. Porch is supported by heavy squared-timber posts with short, curved, flush brackets; open flagstone platform is accessed by three straight stone steps. No decoration. No obvious exterior modifications. Building plan is similar but not identical to a reversal of Residence #1030's plan.

Storage Building #2630: 1935; Rectangular, 1 story, wood frame, medium gable roof. All exterior wall and roof materials are corrugated sheet metal. Four bays in length, two eastern-most bays are open.

Fence: 1936; Rough-hewn wood rails and large wood posts, rough-cut irregularly-coursed masonry piers with beveled tops at gates and corners. Two segments with an aggregate length of approximately 500 feet. One segment flanks west entrance of compound, and includes two-leaf iron gate. Second segment flanks driveway to Residences 1030 and 1031 and includes two-leaf iron gate for vehicles, lamps, and single-leaf iron gates for sidewalks.

Non-contributing buildings: Eight buildings constructed between 1960 and 1985. Include office (#2031), gas & oil building (#2531), warehouse/cooler (#2331), radio shop (#2132), and four trailers.

8. Statement of Significance

Certifying official has considered the significance of this property in relation to other properties:

nationally statewide locally

Applicable National Register Criteria A B C D

Criteria Considerations (Exceptions) A B C D E F G N/A

Areas of Significance (enter categories from instructions)	Period of Significance	Significant Dates
POLITICS/GOVERNMENT	1933-1942	1936-1938
CONSERVATION	"	"
ARCHITECTURE	"	"

	Cultural Affiliation
	N/A

Significant Person	Architect/Builder
N/A	Regional Office Architectural Group: Linn A. Forrest, Howard L. Gifford, Ward Gano, James Pollock, Emmett U. Blanchfield

State significance of property, and justify criteria, criteria considerations, and areas and periods of significance noted above.

The North Bend Ranger Station typifies the construction projects undertaken by the Civilian Conservation Corps and signifies the aid to the local community provided by the emergency work-relief program through employment of youth and experienced craftsmen, purchase of building materials and camp supplies, and personal expenditures of enrollees. The property represents the Forest Service's presence in the locality, as the headquarters for field operation, and denotes, via the physical facilities required to carry out the agency's expanding responsibilities, the critical transition in the Service's development from custodial superintendence to extensive resource management. The North Bend Ranger Station exemplifies the rustic architectural idiom developed by the Forest Service, Pacific Northwest Region, to impart Forest Service identity and to represent its purposes and ideals, and signifies the agency's particular interpretation of a singular expression of early twentieth century American architectural thought. Possessing very high qualities of design and execution, the Ranger Station is an excellent example of an architectural location invested with special aesthetic and associative values by the agency that created it.

The North Bend Ranger Station manifests the principles of comprehensive site planning initiated by the Forest Service during the Depression, through spatial arrangement, functional organization, architectural unity from complimentary building materials and forms, and landscaping to integrate the building site and complex, and signifies an important advance in administrative site development.

N/A See continuation sheet

9. Major Bibliographical References

X See continuation sheet.

Previous documentation on file (NPS):

- preliminary determination of individual listing (36 CFR 67) has been requested.
- previously listed in the National Register
- previously determined eligible by the National Register
- designated a National Historic Landmark
- recorded by Historic American Buildings Survey # _____
- recorded by Historic American Engineering Record # _____

Primary location of additional data:

- State hist. preservation office
- Other State agency
- Federal agency
- Local government
- University
- Other

Specify repository:

USDA Forest Service, Regional Office
Pacific Northwest Region, Recreation
Unit

10. Geographical Data

Acreage of property 7.9

UTM References

A |1|0| |5|9|2|4|9|0| |5|2|6|0|1|0|0|
Zone Easting Northing

B | | | | | | | | | | | | | | | | |
Zone Easting Northing

C | | | | | | | | | | | | | | | | |
Zone Easting Northing

D | | | | | | | | | | | | | | | | |
Zone Easting Northing

N/A See continuation sheet

Verbal Boundary Description

X See continuation sheet

Boundary Justification The boundaries are drawn to include those buildings and spaces that describe the Forest Service administrative use of the site. The area encompassed is that tract acquired by the United States for administrative purposes under the provisions of the Act of March 3, 1925 (43 STAT. 1132, 16 USC 555). Thus, the boundaries of the site are legally established.

N/A See continuation sheet

11. Form Prepared By

name/title E. Gail Throop, Historian

organization USDA Forest Service, R-6

date 1/15/86

street & number 319 SW Pine, P.O. Box 3623

telephone (503)-326-3644

city or town Portland

state OR zip code 97208

United States Department of the Interior
National Park Service

**NATIONAL REGISTER OF HISTORIC PLACES
CONTINUATION SHEET**

North Bend Ranger Station
Section number 9 Page 1

1935-1941 Building Plans and Specifications, Unit of Engineering Files, USDA Forest Service, Regional Office, Portland, Oregon. Microfilm

Administrative Site Plans, Unit of Recreation Files, USDA Forest Service, Regional Office, Portland, Oregon. Microfilm.

Photograph Collections, Office of Information and Unit of Recreation Files, USDA Forest Service, Regional Office, Portland, Oregon.

Photograph Collections, Unit of Recreation Files, USDA Forest Service, Mt. Baker-Snoqualmie National Forest, Seattle, Washington.

Property and Building Maintenance Records; Administrative Site Plans, USDA Forest Service, Mt. Baker-Snoqualmie National Forest, Seattle, Washington

United States Department of the Interior
National Park Service

**NATIONAL REGISTER OF HISTORIC PLACES
CONTINUATION SHEET**

North Bend Ranger Station
Section number 10 Page 1

Verbal Boundary Description:

A portion of that portion of the SW 1/4 of Section 10, Township 23 North, Range 8 East, Willamette Meridian, lying north of King County road no. 301 and east of the county road known as the Charles Thresher, et. al. road described as follows:

Beginning at the point of intersection of the north right-of-way line of county road no. 301, and the east right-of-way line of the Charles Thresher et. al. road, thence southeasterly along the north line of county road no. 301 for a distance of 437.43 feet, thence N. 34^o 45' E. 556.67 feet, thence N. 55^o 15' W. 816.71 feet, more or less, to a point on the east right-of-way line of the Charles Thresher et. al. road; thence southerly along said east right-of-way line of said Charles Thresher et. al. road for a distance of 673.55 feet, more or less, to the point of beginning.

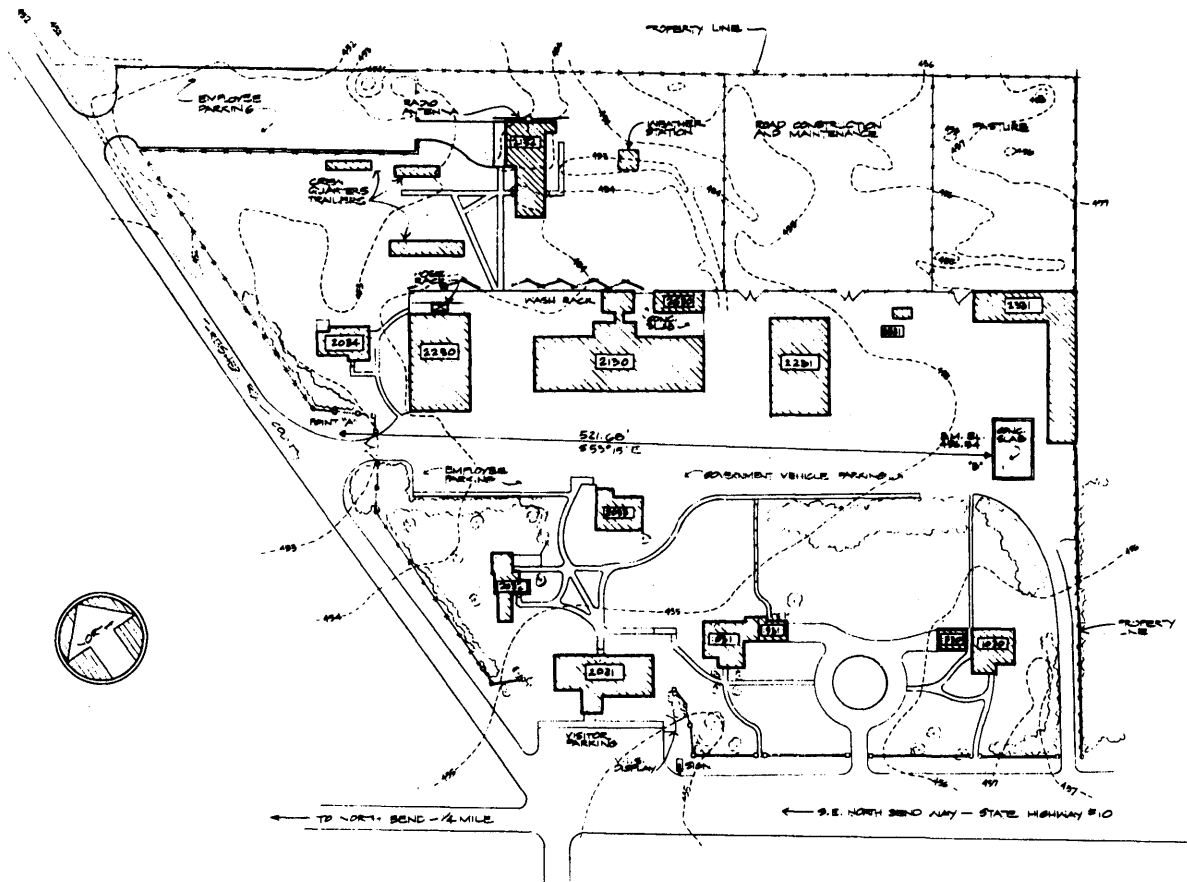

BUILDING LEGEND		
BUILD NO.	DESCRIPTION	PLAN NO.
2030	RESIDENCE	67
2031	RESIDENCE	
2090	GARAGE	
2091	GARAGE	
2092	OFFICE	
2093	OFFICE	
2094	OFFICE - CONFERENCE ROOM	
2190	AUTOMOTIVE SHOP	
2192	COMMUNICATION SHOP	
2230	FIRE WAREHOUSE	
2231	CARPENTER SHOP	
2232	EQUIPMENT STORAGE & TREE COOLER	
2233	GAS & OIL BUILDING	
2234	STORAGE BUILDING	
2235	CREW QUARTERS - TRAILER	
2236	CREW QUARTERS - TRAILER	

SYMBOLS

- EXISTING CENTER AND BOUNDARY
- SURVEY POINT
- WIRE FENCE
- WOOD FENCE
- EXISTING TREE
- BUILDING AND NUMBER
- WOOD FENCE

SCALE: 1"=30'-0"

U.S. DEPARTMENT OF AGRICULTURE FOREST SERVICE		NORTH BEND RANGER STATION	
MT. BAKER-SNOQUALMIE NATIONAL FOREST			
THE PACIFIC NORTHWEST REGION			
DESIGNED	DATE	CHECKED	DATE
BY <i>J.B. Beck</i>	6/24/52	DATE	
TITLE <i>Beck</i>	DATE	DATE	
REVIEWED	DATE	DATE	
		S.T.B. SURVEY PLAT	
		SBC. 0 2.88, T. 23N, WM	
SHT	OF	SHT	OF
	3		3