

PH0021687

Form 10-300  
(July 1969)

UNITED STATES DEPARTMENT OF THE INTERIOR  
NATIONAL PARK SERVICE

### NATIONAL REGISTER OF HISTORIC PLACES INVENTORY - NOMINATION FORM

(Type all entries - complete applicable sections)

STATE: Delaware	
COUNTY: New Castle	
FOR NPS USE ONLY	
ENTRY NUMBER 73.1.16.0001	DATE 1/4/73

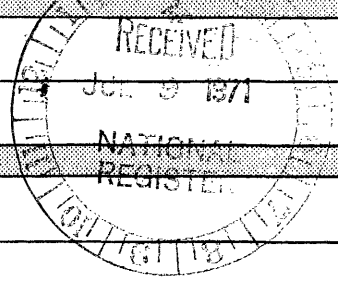

#### 1. NAME

COMMON:  
 Rotheram Mill House

AND/OR HISTORIC:  
Harmony Mills

#### 2. LOCATION

STREET AND NUMBER:  
318 Harmony Road

CITY OR TOWN:  
Newark

STATE: Delaware      CODE: 10      COUNTY: New Castle      CODE: 003

#### 3. CLASSIFICATION

CATEGORY (Check One)	OWNERSHIP	STATUS	ACCESSIBLE TO THE PUBLIC
<input type="checkbox"/> District <input checked="" type="checkbox"/> Building <input type="checkbox"/> Site <input type="checkbox"/> Structure <input type="checkbox"/> Object	<input type="checkbox"/> Public <input checked="" type="checkbox"/> Private <input type="checkbox"/> Both	Public Acquisition: <input type="checkbox"/> In Process <input type="checkbox"/> Being Considered	<input type="checkbox"/> Occupied <input type="checkbox"/> Unoccupied <input checked="" type="checkbox"/> Preservation work in progress

PRESENT USE (Check One or More as Appropriate)

<input type="checkbox"/> Agricultural	<input type="checkbox"/> Government	<input type="checkbox"/> Park	<input type="checkbox"/> Transportation	<input type="checkbox"/> Comments
<input type="checkbox"/> Commercial	<input type="checkbox"/> Industrial	<input checked="" type="checkbox"/> Private Residence	<input type="checkbox"/> Other (Specify)	_____
<input type="checkbox"/> Educational	<input type="checkbox"/> Military	<input type="checkbox"/> Religious	_____	_____
<input type="checkbox"/> Entertainment	<input type="checkbox"/> Museum	<input type="checkbox"/> Scientific	_____	_____

#### 4. OWNER OF PROPERTY

OWNER'S NAME:  
Robert J. Hunn

STREET AND NUMBER:  
318 Harmony Road

CITY OR TOWN: Newark      STATE: Delaware      CODE: 10

#### 5. LOCATION OF LEGAL DESCRIPTION

COURTHOUSE, REGISTRY OF DEEDS, ETC:  
Office of Recorder of Deeds

STREET AND NUMBER:  
New Castle County Court House, Rodney Square

CITY OR TOWN: Wilmington      STATE: Delaware      CODE: 10

#### 6. REPRESENTATION IN EXISTING SURVEYS

TITLE OF SURVEY:  
Delaware Heritage Buildings and Areas in New Castle County

DATE OF SURVEY: N.D.       Federal       State       County       Local

DEPOSITORY FOR SURVEY RECORDS:  
Hall of Records

STREET AND NUMBER:  
\_\_\_\_\_

CITY OR TOWN: Dover      STATE: Delaware      CODE: 10

SEE INSTRUCTIONS

STATE: \_\_\_\_\_

COUNTY: \_\_\_\_\_

ENTRY NUMBER: 73.1.16.0001

DATE: 1/4/73

FOR NPS USE ONLY

7. DESCRIPTION

CONDITION	(Check One)					
	<input type="checkbox"/> Excellent	<input checked="" type="checkbox"/> Good	<input checked="" type="checkbox"/> Fair	<input type="checkbox"/> Deteriorated	<input type="checkbox"/> Ruins	<input type="checkbox"/> Unexposed
	(Check One)			(Check One)		
	<input checked="" type="checkbox"/> Altered	<input type="checkbox"/> Unaltered	<input type="checkbox"/> Moved	<input checked="" type="checkbox"/> Original Site		

DESCRIBE THE PRESENT AND ORIGINAL (if known) PHYSICAL APPEARANCE

The deed of 1795 indicates that the original house was built about 1740. Internal architectural evident indicates that it was a storey-and-a-half gambrel-roof brick structure of five bays built on a central hall plan with two large rooms on the ground floor, one on either side. There appear to have been two side doors also, one into each room. Balancing windows on the ground floor on the other side of the fireplaces show, but their date is uncertain. Two small windows on the second storey completed each side. The front was three-course Flemish bond with black headers; the side was irregularly laid English bond, and the back was three-courses thick of common bond.

The record of the New Castle County Orphan's Court indicates a stone kitchen adjoining in poor repair in 1775. Since the stone kitchen is built against the second storey walls, the change to the present appearance must have taken place in two stages early in the period between 1740 and 1775. The roof was raised to a full 3-bay second storey with attic. The new second storey front was again Flemish bond, but no black headers. A brick ledge indicates that the eaves were converted to pent eaves. The back hall door was modified to accomodate a fine staircase, quite similar to that in the Gunning Bedford house in New Castle. The sagging joists in the hall were levelled by adding strips across them and the floor boards in the hall now run with the joists. The side doors were converted to windows. All side windows except the small ones in the attic were later bricked in, presumably to avoid payment of window tax. The fireplace piers on each end are free standing within the outer walls and may have been modified to accomodate the weight occasioned by the greater height. Cupboards appear in the fireplace masonry on either end on the ground floor. There were fireplaces at each end of the house on each floor. Two more appear in the kitchen wing making six in all. The remains of an oven can be seen in the kitchen wall beside the fireplace and there are three flues in the chimney in the kitchen wing. The upstairs room to the East of the main building was divided leaving the smaller room without a fireplace. All these changes presumably were made at different times during the 1740-1775 period.

An interesting feature of the house is the pay-master's drawer under the front window nearest the grist mill (now a ruined foundation) through which Joseph Rotheram transacted business with the customers of his mills. The miller lived in a log cabin, now vanished. What is probably the foundation of the saw mill has been found near the remains of the dam on the White Clay Creek.

Sometime in the latter half of the nineteenth century the house was "modernized". Windows were changed to two-over-two. Fireplaces were bricked up and stoves added. Some downstairs

SEE INSTRUCTIONS

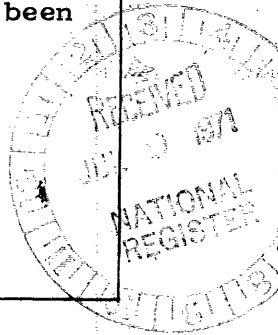

**6. SIGNIFICANCE**

PERIOD (Check One or More as Appropriate)

<input type="checkbox"/> Pre-Columbian	<input type="checkbox"/> 16th Century	<input checked="" type="checkbox"/> 18th Century	<input type="checkbox"/> 20th Century
<input type="checkbox"/> 15th Century	<input type="checkbox"/> 17th Century	<input type="checkbox"/> 19th Century	

SPECIFIC DATE(S) (If Applicable and Known) 1740

AREAS OF SIGNIFICANCE (Check One or More as Appropriate)

<input type="checkbox"/> Aboriginal	<input type="checkbox"/> Education	<input type="checkbox"/> Political	<input type="checkbox"/> Urban Planning
<input type="checkbox"/> Prehistoric	<input type="checkbox"/> Engineering	<input type="checkbox"/> Religion/Philosophy	<input type="checkbox"/> Other (Specify)
<input checked="" type="checkbox"/> Historic	<input type="checkbox"/> Industry	<input type="checkbox"/> Science	
<input type="checkbox"/> Agriculture	<input type="checkbox"/> Invention	<input type="checkbox"/> Sculpture	
<input checked="" type="checkbox"/> Architecture	<input type="checkbox"/> Landscape Architecture	<input type="checkbox"/> Social/Humanitarian	
<input type="checkbox"/> Art	<input type="checkbox"/> Literature	<input type="checkbox"/> Theater	
<input type="checkbox"/> Commerce	<input type="checkbox"/> Military	<input type="checkbox"/> Transportation	
<input type="checkbox"/> Communications	<input type="checkbox"/> Music		
<input type="checkbox"/> Conservation			

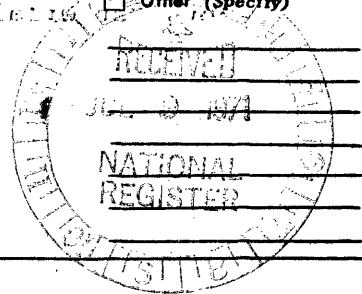

STATEMENT OF SIGNIFICANCE

SEE INSTRUCTIONS

Rotheram Mill House was built in 1740 by Joseph Rotheram on a site already occupied by a sawmill and a grist mill. The house was occupied by James Price and his descendents from 1802 until 1886.

Joseph Rotheram's daughter, Abigail, married Joseph England, II, proprietor of the next mill upstream on White Clay Creek, now known as Red Mill. Their daughter, Sarah, became the wife of Captain Robert Kirkwood of Revolutionary War fame.

The house was the home of James Price and his wife, Margaret Tatnall (widow of Edward Starr) who were married in 1802. Their four children were born there. James Price was born at Stoneton Farm, Kent County, Maryland. He was a prosperous planter and miller and was the first president of the Union Bank of Delaware in 1839. In 1838 he was the second president of the Philadelphia, Wilmington and Baltimore Railway, now the Penn-Central Railroad. He was also great-great grandson of Colonel John Hyland of "Harmony Hall," Cecil County, Maryland. From this he renamed the "Rotheram Mill" on White Clay Creek to "Harmony Mills." The railroad station, recently burned, became Harmony Station.

Margaret Tatnall Price's father was Joseph Tatnall. He is called the most distinguished man in Wilmington, by Elizabeth Montgomery in her book, Reminiscences. He alone ground flour for Washington's army at the time of Valley Forge. Eminently successful as a miller and in the shipping business, he entertained George Washington, the Marquis de Lafayette and General Anthony Wayne. In 1795 he was the first president of the Bank of Delaware. In 1798 he presented the town clock to Wilmington's old Town Hall and the large bell to the town.

(Compiled from information supplied by Mr. Joseph C. McCune of Pittsburgh, Pennsylvania, a Rotheram descendent, and Mrs. Harry Clark Boden of Newark, Delaware, a Price descendent.)

RECEIVED JUL 9 1971 NATIONAL REGISTER

**9. MAJOR BIBLIOGRAPHICAL REFERENCES**

Scharf and Westcott's History of Delaware, page 939.  
 Montgomery, Elizabeth, Reminiscences.  
 Massey, G. V., Ancestry of Elizabeth DuPont Bayard.  
 Records of Wilmington Friends' Meeting.

**10. GEOGRAPHICAL DATA**

LATITUDE AND LONGITUDE COORDINATES DEFINING A RECTANGLE LOCATING THE PROPERTY			O R	LATITUDE AND LONGITUDE COORDINATES DEFINING THE CENTER POINT OF A PROPERTY OF LESS THAN TEN ACRES		
CORNER	LATITUDE	LONGITUDE		LATITUDE	LONGITUDE	
	Degrees Minutes Seconds	Degrees Minutes Seconds		Degrees Minutes Seconds	Degrees Minutes Seconds	
NW	° ' "	° ' "		39° 41' 48"	75° 41' 41"	
NE	° ' "	° ' "				
SE	° ' "	° ' "				
SW	° ' "	° ' "				

APPROXIMATE ACREAGE OF NOMINATED PROPERTY: 4

LIST ALL STATES AND COUNTIES FOR PROPERTIES OVERLAPPING STATE OR COUNTY BOUNDARIES

STATE:	CODE	COUNTY	CODE



**11. FORM PREPARED BY**

NAME AND TITLE:  
**Robert Hunn**

ORGANIZATION: \_\_\_\_\_ DATE: **April 20, 1971**

STREET AND NUMBER:  
**318 Harmony Road**

CITY OR TOWN: **Newark** STATE: **Delaware** 19711 CODE: **10**

**12. STATE LIAISON OFFICER CERTIFICATION**

**NATIONAL REGISTER VERIFICATION**

As the designated State Liaison Officer for the National Historic Preservation Act of 1966 (Public Law 89-665), I hereby nominate this property for inclusion in the National Register and certify that it has been evaluated according to the criteria and procedures set forth by the National Park Service. The recommended level of significance of this nomination is:

National  State  Local

Name: *Lea Melker*  
 Title: Historic Registrar, State Liaison Officer

Date: July 1, 1971

I hereby certify that this property is included in the National Register.

*Ernest A. Connally*  
 Chief, Office of Archeology and Historic Preservation

**JAN 4 1972**  
 Date: \_\_\_\_\_

ATTEST:  
*William J. Strout*  
 Keeper of The National Register

Date: **JAN 3 1972**

SEE INSTRUCTIONS

NATIONAL REGISTER OF HISTORIC PLACES  
INVENTORY - NOMINATION FORM

(Continuation Sheet)

STATE Delaware	
COUNTY New Castle	
FOR NPS USE ONLY	
ENTRY NUMBER 12.1.10.0001	DATE 1/4/72

(Number all entries)

7. DESCRIPTION (cont'd.)

mantles were changed to slate. Door hardware was changed to porcelain knobs and cast iron hinges. The chair rail was removed. A gable was added to the center front of the roof and low slanting pillared porches added front and back. The roof burned and was replaced about 1930.

Except for the addition of heat, light and plumbing, the house remained essentially unchanged until purchased as a Victorian farm house in 1961. Its true nature was then discovered and restoration to the pre-1775 period has been in progress for the last ten years with careful attention to each detail. Restoration to the 1740 original is architecturally impractical.

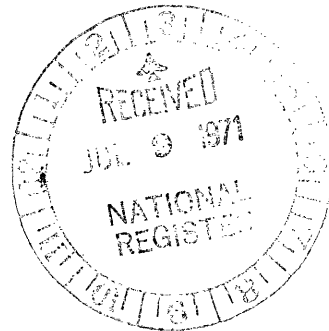

**NATIONAL REGISTER OF HISTORIC PLACES  
INVENTORY - NOMINATION FORM**

(Continuation Sheet)

STATE Delaware	
COUNTY New Castle	
FOR NPS USE ONLY	
ENTRY NUMBER	DATE
72.1.10.0001	1/4/72

(Number all entries)

9. MAJOR BIBLIOGRAPHICAL REFERENCES (cont'd.)

Records of New Castle County Orphan's Court, Wilmington, July 19, 1774, re: Joseph Rotheram.

Beers, D. G., Atlas of the State of Delaware, (Pomeroy & Beers, Philadelphia, 1868), page 25.

Liber P-Z, folios 140-144, New Castle County Deeds, Hall of Records, Dover, Delaware.

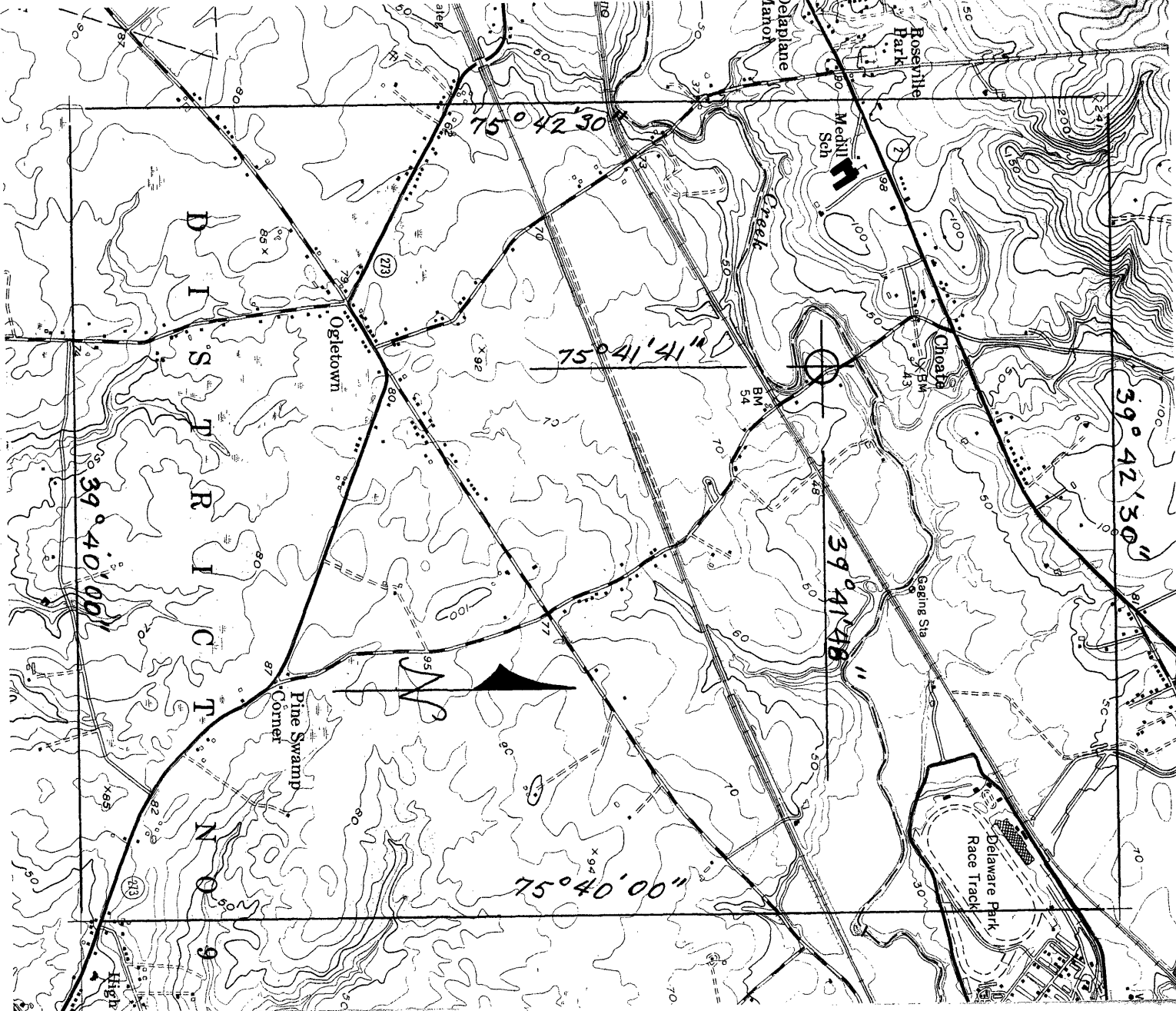

Form 10-301  
(July 1969)

UNITED STATES DEPARTMENT OF THE INTERIOR  
NATIONAL PARK SERVICE

**NATIONAL REGISTER OF HISTORIC PLACES  
PROPERTY MAP FORM**

(Type all entries - attach to or enclose with map)

STATE <b>Delaware</b>	
COUNTY <b>New Castle</b>	
FOR NPS USE ONLY	
ENTRY NUMBER <b>72-110-0001</b>	DATE <b>7/14/73</b>

SEE INSTRUCTIONS

<b>1. NAME</b>			
COMMON: <b>Rotheram Mill House</b>			
AND/OR HISTORIC: <b>Harmony Mills</b>			
<b>2. LOCATION</b>			
STREET AND NUMBER: <b>318 Harmony Road</b>			
CITY OR TOWN: <b>Newark</b>			
STATE: <b>Delaware</b>	CODE <b>10</b>	COUNTY: <b>New Castle</b>	CODE <b>003</b>
<b>3. MAP REFERENCE</b>			
SOURCE: <b>USGS Newark East Quadrangle, 7.5 minute series</b>			
SCALE: <b>1:24,000</b>			
DATE: <b>1953</b>			
<b>4. REQUIREMENTS</b>			
TO BE INCLUDED ON ALL MAPS			
1. Property boundaries where required.			

