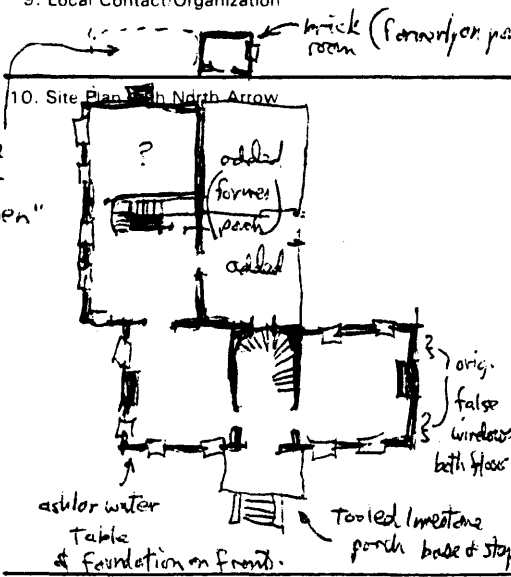

KENTUCKY HISTORIC RESOURCES INVENTORY

1. Historic Name(s) <b>Simmstown</b> Original Owner <b>William Simpson</b>		22. ADD/County <b>Lincoln Trail/Washington</b> <input type="text" value="115"/>	
2. Present Name <b>same</b>		23. U.S.G.S. Quadrant (15'/75') <b>Springfield</b> G.I.S. Mod. <input type="text"/>	
3. Location <b>5 mi. s. of Springfield on Rinetown-Simmstown Rd.</b>		24. UTM Reference <b>16 660100 4166620</b> Zone Easting Northing	
4. Owner's Name <b>James A Dixon</b>		25. Coordinate Accuracy <input type="text"/>	
5. Owner's Address <b>Rt. 3, Lebanon, Ky.</b>		26. Prehistoric Site Object Historic Site Structure <b>Building</b> Other	
6. Open to Public <input checked="" type="checkbox"/> Yes <input type="checkbox"/> No	7. Visible from road <input checked="" type="checkbox"/> Yes <input type="checkbox"/> No	8. Ownership <input checked="" type="checkbox"/> Private <input type="checkbox"/> Local <input type="checkbox"/> State <input type="checkbox"/> Federal	
9. Local Contact/Organization		27. National Register District Name: <b>N/A</b>	
10. Site Plan with North Arrow 		28. Significance Evaluation <b>NR</b> <input type="text" value="N"/>	
11. Architect <b>unknown</b>		29. Status <input type="text"/> Date National Landmark <input type="text"/> National Register <input type="text"/> Landmark Certificate <input type="text"/> Kentucky Survey <input type="text"/> Local Landmark <input type="text"/> HABS/HAER <input type="text"/>	
12. Builder <b>unknown</b>		30. Historic Theme <b>Architecture</b> <input type="text" value="C"/>	
13. Date <b>1840</b> A. <input type="text" value="3"/> B. <input type="text"/>		31. Endangered Yes <input type="text"/> No <input checked="" type="text"/>	
14. Style <b>Italianate</b> <input type="text" value="E"/> A. <input type="text"/> B. <input type="text"/>		32. Preservation Project Status <b>N/A</b> <input type="text"/>	
15. Original Use <b>sing. fam. res.</b> <input type="text" value="A"/>		Actual Cost in \$1,000s <input type="text"/>	
16. Present Use <b>dwelling</b>		33. ATTACH PHOTO	
17. Condition <b>good</b> <input type="text" value="B"/>		Roll No. _____ Picture No. _____ Direction _____	
18. Description <b>A single-pile two-story brick dwelling with hipped roof and five-bays on the principal (south) facade. Stone foundation. Floor-length windows on each floor with 6/6 sash. Wood lintels. Tripartite window over door, which has bracketed hood with arched head. Bracketted cornice, two-story ell with enclosed (1960) porch. Curved stair, plaster cornices, dentillated cornices over doors, or interior.</b>		34. Prepared by: <b>G. Worsham</b>	
19. History <b>House said to have been built by William Simpson in 1838, but finished by John Simm II, who acquired to place in 1865, and may be responsible for most of the finish details, which seem to date from later than 1850. Simms divided his 2400 a. "plantation" in 1898 between his five children.</b>		35. Organization <b>Gibson Worsham Architect</b>	
20. Significance <b>This property is significant under criterion C. It is a well-preserved example of the center-passage ho., one of several with traditional plans and Italianate details just SE of Springfield.</b>		36. Date <b>4/85</b>	
21. Source of Information <b>Mrs. E.O. Kelly Jr. (former owner)</b>		37. Revision Dates <b>1/87</b>	
		38. Staff Review	

KENTUCKY HISTORIC RESOURCE INVENTORY SUPPLEMENT  
BOUNDARY AND LOCATION INFORMATION

Historic Property Name Simmstown Site # WS-31

Multiple Resource/Thematic Nomination Title Washington County Multiple Resource Area

U.T.M. Coordinates - List multiple UTMs if property is ten or more acres.

A. 16 660100 4166620 D. \_\_\_\_\_  
 B. \_\_\_\_\_ E. \_\_\_\_\_  
 C. \_\_\_\_\_ F. \_\_\_\_\_

Verbal Boundary Description Acreage 4 acres

Beginning at point A on the north side of the Simmstown-Rineltown Road where the private drive meets the road, north 600 feet following the east side of the drive to point B, thence west 300 feet in a line 20 feet north of the north wall of the house to point C, thence south 600 feet to point D on the north side of the Simmstown-Rineltown Road, thence 300 feet east with the north side of said road to the point of origin. The boundaries were chosen to encompass the house and its domestic-related space. The property contains one contributing building and one noncontributing outbuilding.

Sketch of Site Plan (Showing outbuildings, structures, landscape features and the site boundary as described above.)

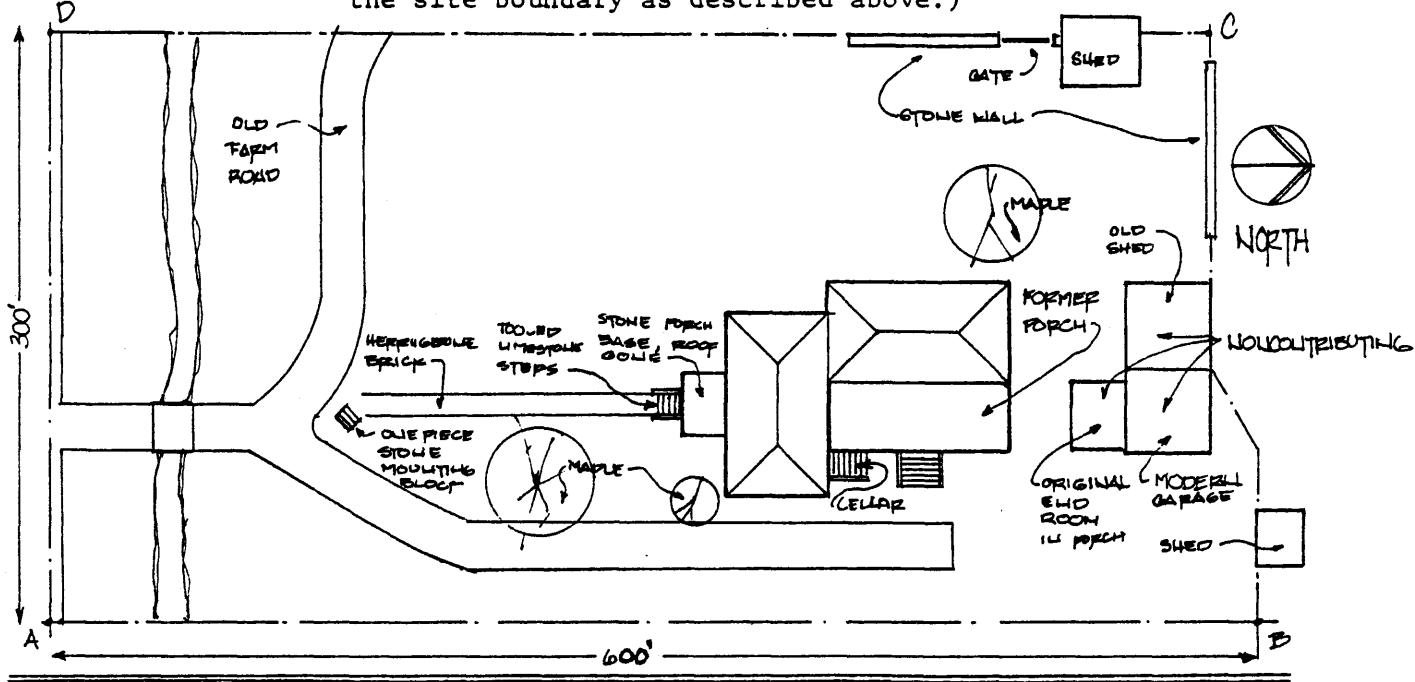

Official Courthouse Property Reference:

Washington County Courthouse, Springfield, Kentucky