

United States Department of the Interior
National Park Service

National Register of Historic Places
Registration Form

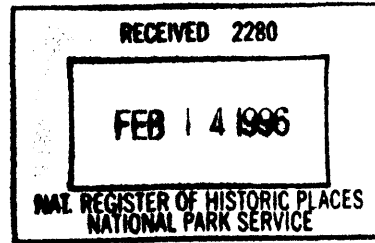

This form is for use in nominating or requesting determinations for individual properties and districts. See instructions in How to Complete the National Register of Historic Places Registration Form (National Register Bulletin 16A). Complete each item by marking "x" in the appropriate box or by entering the information requested. If any item does not apply to the property being documented, enter "N/A" for "not applicable." For functions, architectural classification, materials, and areas of significance, enter only categories and subcategories from the instructions. Place additional entries and narrative items on continuation sheets (NPS Form 10-900a). Use a typewriter, word processor, or computer, to complete all items.

1. Name of Property

historic name Clayton Public Schools Historic District
other names/site number Clayton Public Schools--Campus No. 1

2. Location

street & number Four blocks in SE Clayton centered at 6th and Cedar Streets not for publication
city or town Clayton vicinity
state New Mexico code NM county Union code 059 zip code 88415

3. State/Federal Agency Certification

As the designated authority under the National Historic Preservation Act of 1986, as amended, I hereby certify that this nomination request for determination of eligibility meets the documentation standards for registering properties in the National Register of Historic Places and meets the procedural and professional requirements set forth in 36 CFR Part 60. In my opinion, the property meets does not meet the National Register Criteria. I recommend that this property be considered significant nationally statewide locally. (See continuation sheet for additional comments.)

[Signature] _____ Date 2/7/96
Signature of certifying official/Title
New Mexico SHPO
State or Federal agency and bureau

In my opinion, the property meets does not meet the National Register criteria. (See continuation sheet for additional comments.)

Signature of certifying official/Title Date

State or Federal agency and bureau

4. National Park Service Certification

I hereby certify that the property is:
 entered in the National Register. See continuation sheet.
 determined eligible for the National Register. See continuation sheet.
 determined not eligible for the National Register.
 removed from the National Register.
 other, (explain.) _____

Signature of the Keeper Edson H. Beall Date of Action 3/15/96
Entered in the National Register

Clayton Public Schools Historic District

Union, NM

Name of Property

County and State

5. Classification

Ownership of Property

(Check as many boxes as apply)

- private
- public-local
- public-State
- public-Federal

Category of Property

(Check only one box)

- building(s)
- district
- site
- structure
- object

Number of Resources within Property

(Do not include previously listed resources in the count.)

Contributing	Noncontributing	
7	2	buildings
4	0	sites
4	0	structures
0	0	objects
15	2	Total

Name of related multiple property listing

in (Enter "N/A" if property is not part of a multiple property listing.)

Hist. & Arch. Resources of the New Deal: NM

Number of contributing resources previously listed the National Register

0

6. Function or Use

Historic Functions

(Enter categories from instructions)

Recreation and culture/football stadium

Education/school

Landscape/plaza

Current Functions

(Enter categories from instructions)

Recreation and culture/ football stadium

Education/school

Landscape/plaza

7. Description

Architectural Classification

(Enter categories from instructions)

Spanish-Pueblo Revival

Materials

(Enter categories from instructions)

foundation concrete

walls stucco,

roof metal, asphalt

other stone

Narrative Description

(Describe the historic and current condition of the property on one or more continuation sheets.)

Clayton Public Schools Historic District
Name of Property

Union, NM
County and State

8. Statement of Significance

Applicable National Register Criteria

(Mark "x" in one or more boxes for the criteria qualifying the property for National Register listing)

- A** Property is associated with events that have made a significant contribution to the broad patterns of our history.
- B** Property is associated with the lives of persons significant in our past.
- C** Property embodies the distinctive characteristics of a type, period, or method of construction or represents the work of a master, or possesses high artistic values, or represents a significant and distinguishable entity whose components lack individual distinction.
- D** Property has yielded, or is likely to yield information important in prehistory or history.

Criteria Considerations

(Mark "x" in the boxes that apply.)
Property is:

- A** owned by a religious institution or used for religious purposes.
- B** removed from its original location.
- C** a birthplace or grave.
- D** a cemetery.
- E** a reconstructed building, object, or structure.
- F** a commemorative property.
- G** less than 50 years of achieved significance within the past 50 years.

Narrative Statement of Significance

(Explain the significance of the property on one or more continuation sheets.)

9. Major Bibliographical References

Bibliography

(Cite the books, articles, and other sources used in preparing this form on one or more continuation sheets.)

Previous documentation on file (NPS):

- preliminary determination of individual listing (36 CFR 67) has been requested.
- previously listed in the National Register
- previously determined eligible by the National Register
- designated a National Historic Landmark
- recorded by Historic American Buildings Survey
Record # _____
- recorded by Historic American Engineering
Record # _____

Areas of Significance

(Enter categories from instructions)

- social history
- entertainment/recreation
- architecture
- landscape architecture
- education
- _____
- _____
- _____

Period of Significance

1935-1943

Significant Dates

1935, 1941

Significant Person

(Complete if Criterion B is marked above)

Cultural Affiliation

Architect/Builder

Willard C. Krugerr

Primary location of additional data:

- State Historic Preservation Office
- Other State agency
- Federal agency
- Local government
- University
- Other

Name of repository:

Clayton Public Schools Historic District

Union, NM

Name of Property

County and State

10. Geographical Data

Acreage of Property 7

UTM References

(Place additional UTM references on a continuation sheet)

- 1. 113 663260 4035370 3. 113 663460 4035220
2. 113 663370 4035400 4. 113 663360 4035170

See continuation sheet.

Verbal Boundary Description

(Describe the boundaries of the property on a continuation sheet.)

Boundary Justification

(Explain why the boundaries were selected on a continuation sheet.)

11. Form Prepared By

name/title David Kammer, Ph.D
organization contract historian date Sept. 30, 1995
street & number 521 Aliso Dr. NE telephone (505) 266-0586
city or town Albuquerque state NM zip code 87108

Additional Documentation

Submit the following items with the completed form:

Continuation Sheets

Maps

- A USGS map (7.5 or 15 minute series) indicating the property's location.
A Sketch map for historic district and properties having large acreage or numerous resources.

Photographs

Representative black and white photographs of the property.

Additional items

(Check with the SHPO or FPO for any additional items)

Property Owner

(Complete this item at the request of the SHPO or FPO.)

name
street & number telephone
city or town state zip code

Paperwork Reduction Act Statement: This information is being collected for applications to the National Register of Historic Places to nominate properties for listing or determine eligibility for listing, to list properties, and to amend existing listings. Response to this request is required to obtain a benefit in accordance with the National Historic Preservation Act, as amended (16 U.S.C. 470 et seq.).

Estimated Burden Statement: Public reporting burden for this form is estimated to average 18.1 hours per response including the time for reviewing instructions, gathering and maintaining data, and completing and reviewing the form. Direct comments regarding this burden estimate or any aspect of this form to the Chief, Administrative Services Division, National Park Service, P.O. Box 37127, Washington, DC 20013-7127; and the Office of Management and Budget, Paperwork Reductions Project (1024-0018), Washington, DC 20503.

**United States Department of the Interior
National Park Service**

**National Register of Historic Places
Continuation Sheet**

Section number 7 Page 1

Clayton Public Schools Historic District
Union County, NM

Description

The Clayton Schools Historic District is a complex consisting of seven contributing and two non-contributing buildings, four contributing sites and four contributing structures set within two two-block parcels cater-cornered along S. Sixth Street in southeastern Clayton. The northwestern parcel, enclosed by a sandstone wall, is the academic complex and consists of five contributing and one non-contributing buildings, three contributing sites, and a contributing structure. All of the contributing buildings are built on concrete foundations, are one to three stories high, have flat metal or asphalt roofs, with the exception of the barrel vault central portion of Huff Gymnasium, and employ elements of the Spanish-Pueblo Revival Style. The southeastern parcel is Huff Stadium and consists of an athletic complex enclosed by a sandstone wall. The stadium includes two contributing and one non-contributing buildings, three contributing structures and one contributing site. Set in a tree-lined residential neighborhood with wide streets, the district appears as a unified entity sharing a common period of construction, design, and use of materials and workmanship. The district is in excellent condition and conveys a strong sense of its association with school construction projects undertaken by the New Deal in New Mexico.

Northwest Parcel

Although the various buildings and structures within the district were constructed under a series of separate WPA projects extending from 1935 to 1941, they appear as part of a well-planned building program. Three principle buildings, the high school, the former junior high school and Huff Gymnasium face on a common plaza landscaped with Siberian elms and stone walkways. A corbelled wood archway at the plaza entry notes that the complex was designed by Willard C. Kruger, New Mexico's WPA architect.

United States Department of the Interior
National Park Service

National Register of Historic Places
Continuation Sheet

Section number 7 Page 2

Clayton Public Schools Historic District
Union County, NM

Description (continued)

Contributing Buildings

Junior High School Building (01, P-2)

Directly across the plaza from the entry is the former junior high school. The only three-story building as well as the only building constructed prior to the WPA (1922), it was converted from its original Beaux Artes brick facade to a Spanish-Pueblo facade as a WPA project in 1939. Stepped beneath its brown stucco cement symmetrical facade is a portal extending the length of the building. The portal includes many of the style's characterizing elements including exposed roof beams, or vigas, log support posts with corbels, and roof drains, or canales.

High School and Administrative Building (02, P-3)

Flanking the plaza on the north is the high school consisting of one and two story portions marked by setbacks, a continuous parapet, and numerous decorative elements including portals with vigas, corbels and canales. Through a series of WPA projects beginning in 1938, the building beginning grew incrementally, assuming the rectilinear plan it now has with an interior patio located between the south wing housing the classrooms and the north wing housing the cafeteria. The building's walls are stone with a beige stucco cement coating. Single and paired 9/9 double-hung windows with concrete sills predominate, with a group of five windows framed by wood posts and corbels illuminating the stairwell, containing a WPA mural, that leads to the second floor library and science labs. Entries consist of double wood doors with transoms.

Perpendicular to the building's exterior are a series of walls serving as screens to create small patios and walkways leading to the building's various entries. Of particular note is the Clayton Board of Education Office located on the east side of the building and marked by an exterior chimney. The interior has a exposed vigas with a tongue and groove ceiling, a cobblestone fireplace with a Spanish Colonial Style wood mantel and fire screen. As in the library, the furniture and carved wooden door

United States Department of the Interior
National Park Service

National Register of Historic Places
Continuation Sheet

Section number 7 Page 3

Clayton Public Schools Historic District
Union County, NM

Description (continued)

are the products of WPA carpentry projects.

While the interior of the building has received periodic refurbishing, the exterior is little changed. The portal on the south side has been enclosed to create a student lounge.

Huff Gymnasium (03, P-5)

Flanking the plaza on the south is Huff Gymnasium, a rectilinear, one-story auditorium/gymnasium with stepped, adjoining classrooms and an entry foyer. Completed in 1937, The building has a reinforced concrete skeleton with dried adobe brick walls coated with stucco cement. The portal at the gym's entry, enclosed shortly after the completion of the building, has projecting vigas, canales draining from its parapet, and corbels and a recessed entry with a double door and transom topped by a wood lintel. Single and grouped windows with concrete sills are 9/9 and 4/4 double-hung. Classrooms housing the home economics department and containing many original furnishings made through WPA projects extend along the east side of the building, and a swimming pool, added after the original project, is located at the southwest corner. Housed in a room located at the northwest corner of the building is the school's WPA Museum, containing numerous paintings done by WPA artists, furniture, light fixtures, rugs, and ceramics all made by students and relief workers under various New Deal projects.

Art Building (04, P-7)

Facing 6th Street along the east side of the complex is the Art, formerly Mechanics, Building. Built in 1941, this one-story building shares many of the Spanish-Pueblo Revival Style details present in the larger buildings. It has battered upper walls with parapets and wood canales and a flat roof. The entry consists of a double wood door with large hinges and a herringbone design on the interior side. The entry is protected by a flat wood hood supported by vigas.

Vocational Agricultural Building (05, P-6)

Facing 6th Street along the east side of the complex is the

**United States Department of the Interior
National Park Service**

**National Register of Historic Places
Continuation Sheet**

Section number 7 Page 4

Clayton Public Schools Historic District
Union County, NM

Description (continued)

Vocational Agriculture Building (1938), a one-story building that shares many of the Spanish-Pueblo Revival Style details present in the larger buildings. It has battered upper walls with parapets and wood canales and a flat roof. The entry is recessed and framed by corbels. Light fixtures made by WPA workers flank the entry.

Non-Contributing Building

Cornwall Music Building (06)

The Cornwall Music Building located at the southwest corner of the complex was constructed in the 1960s and is a non-contributing building.

Contributing Sites and Structures

Tennis Courts (07)

At the southeast corner of the parcel are three concrete surfaced tennis courts completed as part of a landscape project around 1940. Although they have received periodic maintenance and elms now line them to the south and east, the courts, with their setting and location unchanged, contribute to the feeling of the complex as a WPA school project.

Central Plaza (08, P-1)

With landscaping that began in 1938, the central plaza is a rectangular courtyard formed by the three main buildings of the complex and the enclosing wall to the west. Siberian elms, planted before and during the WPA projects, form a canopy over the entire plaza. Wood benches dispersed along flagstone walkways create a frontier pastoral landscape favored in many of the state's New Deal landscape projects and enhance the feeling that the complex is also a product of the New Deal.

High School Patio (09, P-4)

The incremental additions to the high school building funded by various WPA projects resulted in an enclosed courtyard or patio planned in 1938 and completed in 1940. Accessible from the

**United States Department of the Interior
National Park Service**

**National Register of Historic Places
Continuation Sheet**

Section number 7 Page 5

Clayton Public Schools Historic District
Union County, NM

Description (continued)

building's various wings, the patio is overlaid with locally quarried stone set in concrete. Several evergreens line the patio, and a flowerbed and rustic wood benches punctuate the expanse.

Enclosing Wall (10, P-1)

Surrounding the two block complex, with periodic breaks for driveways and pedestrian entrances is a rough-coursed sandstone ashlar wall completed in 1941. Approximately forty inches high and twelve inches thick, the wall rests on an earthen footing and consists of rough-chipped sandstone and mortar. The principle entry is located on Fifth Street where the wall completes the enclosure of the central plaza created by the high school, the former junior high school, and Huff Gymnasium. An archway with tapered stone piers and a corbelled wood arch and double wrought iron gates leads into the plaza.

Southeast Parcel

The southeastern parcel consists of Huff Stadium. Contributing properties include the surrounding wall, the football field, the two grandstands and two buildings, a field house and a storage shed.

Contributing Buildings

Field House (11, P-8)

The field house, located to the north of the east grandstand has rough-coursed sandstone walls. The once-flat roof has been pitched with a corrugated metal sheeting, and a porch with a pitched roof has been added at the entry. Paired windows are 1/1 double-hung with concrete sills, and the door is metal.

Storage Shed (12)

Located at the south end of the football field below the grade of the field, the storage shed has a hipped shingle roof with boxed eaves. Completed by 1941, the building has rough-coursed sandstone walls. The windows have been filled with

**United States Department of the Interior
National Park Service**

**National Register of Historic Places
Continuation Sheet**

Section number 7 Page 6

Clayton Public Schools Historic District
Union County, NM

Description (continued)

concrete. A metal overhead door at the east end has a concrete frame.

Non-Contributing Building

Concession Stand (13)

The post-war concrete block concession stand is a non-contributing building.

Contributing Sites and Structures

Football Field (14, P-8)

Located at the center of the stadium, the football field rests on an elevated grade created, in part, by the stone chippings deposited by the crews facing the stones for the walls and school buildings. The field was begun in 1939 and completed in 1940.

Enclosing Wall (15)

Surrounding Huff Stadium is a rough-coursed sandstone ashlar and mortar wall approximately eight feet high and fifteen inches thick. Constructed during 1939 and 1940, it has periodic support piers. Entries vary in size and materials and include a welded steelbar gate, a chainlink gate and wooden gates.

East and West Grandstands (16 and 17; P-8, P-9)

The grandstand consists of two similar units of reinforced concrete bleachers with ten tiers of seating. Completed in 1940, the grandstands are modeled after the grandstands constructed under a WPA project in Roswell, New Mexico. Each grandstand has a central entry way, and each has enclosed storage areas with boarded windows located beneath the seating. The rear walls of the grandstands have a pebble-dash stucco cement coating, and the front walls consist of rough-coursed ashlar walls approximately forty inches high. A small pressbox with a stucco coating rests above the central entry of the west grandstand. Alterations to the grandstands are minimal and include the addition of plastic covers to the concrete seating tiers.

**United States Department of the Interior
National Park Service**

**National Register of Historic Places
Continuation Sheet**

Section number 8 Page 7

Clayton Public Schools Historic District
Union County, NM

Statement of Significance

The Clayton School Historic District was constructed through a series of WPA projects that began in 1935 and continued through 1941. Under the leadership of Clayton's Superintendent of Schools, Raymond Huff, the community sought to overcome the depression and unemployment that gripped the area by applying for numerous WPA projects designed to improve the town's school system will supplying many of the county's 10,000 residents with work relief. Beginning with the construction of Huff Gymnasium, funded in 1935, and continuing through the completion of the school's mechanical shops, Clayton secured a new educational and athletic complex by applying for and receiving a succession of WPA building projects. These projects provided the community with a modern school complex as well as a gymnasium/auditorium and a football stadium. This succession of projects also enabled thousands of Union County residents eligible for work relief to find at least several months of work. The district is thus eligible under Criterion A for its association with Clayton's social history, education, and entertainment/recreation during the New Deal. The district is also eligible under Criterion C in the categories of architecture and landscape architecture as a good example of the plans, methods of construction, materials and workmanship New Deal projects employed in carrying out school, recreational facility, and landscape architecture projects in New Mexico.

Union County, located in the northeast corner of New Mexico, was the portion of the state most severely affected by the drought that devastated the southern High Plains from 1932-1937. Between 1920 and 1940, the county's population fell from 13,000 to less than 10,000. Those who remained found little work as farm and ranch values declined and chronic grasshopper infestations destroyed much of the vegetation that remained. In 1935, Raymond Huff, the superintendent of Clayton schools and member of the State Board of Education, turned to the New Deal's new work relief program, the WPA, as a way of solving some of the county's unemployment as well as improving Clayton's outmoded schools. Applying for funds to build a gymnasium/auditorium that would serve both the school and the larger community, Huff emphasized

**United States Department of the Interior
National Park Service**

**National Register of Historic Places
Continuation Sheet**

Section number 8 Page 8

Clayton Public Schools Historic District
Union County, NM

Statement of Significance

that "more than merely providing work for some of our citizens," the building program would show citizens that Union County could become a "land of opportunity."

To fulfill this goal, Huff determined that the construction projects would be based on local people using local materials and building and crafts skills to complete each project. After the town passed a school bond issue, Willard C. Kruger, New Mexico's WPA architect prepared the plans for the gym and subsequently for all of the other buildings, including the renovation of the former high school to which he added a Spanish-Pueblo Revival Style veneer to conform to the rest of the complex. Kruger's plans incorporated Huff's dictum that the projects use local materials and emphasize local building practices. In undertaking the construction of eight large buildings, the renovation of another, and the construction and landscaping of a four-block complex, Huff hired only four skilled workers--a building superintendent, an electrician, a plumber, and a concrete finisher.

Over a six year period several thousand of the county's residents worked at one time or another on the school projects. They made adobes, dressed rock quarried from nearby sandstone outcroppings and hewed logs cut in the Carson National Forest; they also poured concrete foundations, installed reinforced concrete frames, and then applied their local building materials to complete the structures. Much of the preparation for the ashlar sandstone was carried out in the plaza area where workers chipped stones, hauling the chips in their wagons to the athletic field. As one of the final projects, in 1940 the plaza was landscaped with additional trees and flagstone walkways to unify the main buildings of the complex. While construction moved ahead, students working under National Youth Administration (NYA) programs constructed furniture, tanned leather, wove rugs, made ceramic pottery and forged hinges and lighting fixtures for use throughout the complex.

In November, 1935, Governor Clyde Tingley went to Clayton to

**United States Department of the Interior
National Park Service**

**National Register of Historic Places
Continuation Sheet**

Section number 8, 9, 10 Page 9

Clayton Public Schools Historic District
Union County, NM

Statement of Significance

dedicate the gymnasium/auditorium, the first of the buildings to be completed. Donating \$100 to the school for the purchase of a stage curtain, Tingley declared, "This building will stand forever as a monument to the people of Union County whose interest and efforts have provided a place where young and old alike can meet for social, educational and recreational purposes." Sixty years later the Clayton school district continues to fulfill his prophesy. The community is proud of its historic complex, having set aside a room in the Huff Gymnasium as a WPA museum.

Bibliography

Clayton News. Various issues, 1933-1941.

Kirby, Bill, former Clayton High School principal. Interview with David Kammer, March, 1995.

Riordan, Margarite. "Dust Bowl School." New Mexico School Review. May, 1948.

Geographical Data

UTM References:

5.	13	663480	4035370	7.	13	663680	4035010
6.	13	663580	4035260	8.	13	663570	4034960

Verbal Boundary Description

The northwest parcel consists of Blocks 1546 and 1547 of the Clayton Original Addition. The southeast parcel consists of Blocks 12 and 13 of the Miller Charleston Addition.

Boundary Justification

The nominated property includes the two parcels historically associated with New Deal projects that constructed Clayton's school complex but excludes city sidewalks and easements.

NW Parcel

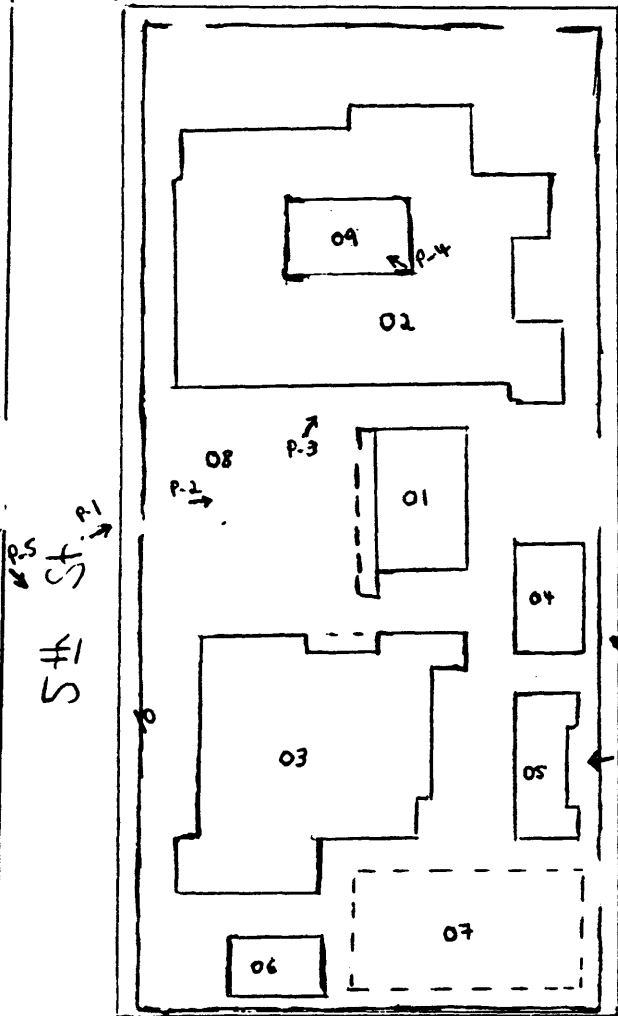

Oak St.



Clayton Public Schools
Historic District

Contributing Buildings

- 01 Jr High School Bldg.
- 02 High School
- 03 Huff Gymnasium
- 04 Vocation-Agricultural Bldg.
- 05 Art Bldg.
- 11 Field House
- 12 Storage Shed

Pine St.

Non-Contributing Buildings

- 06 Cornwall Music Bldg.
- 13 Concession Bldg.

Contributing Sites

- 07 Tennis Courts
- 08 Plaza
- 09 Patio
- 14 Football Field

Contributing Structures

- 10 NW Parcel enclosing wall
- 15 SE Parcel enclosing wall
- 16 E. Grandstand
- 17 W. Grandstand

1 inch = approx. 160 ft.

Cedar St.

SE Parcel

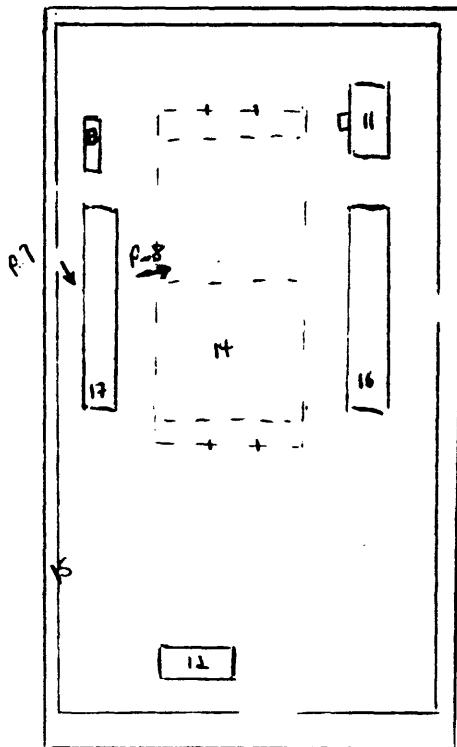

7th St.

Locust St.