

United States Department of the Interior  
National Park Service

National Register of Historic Places  
Inventory—Nomination Form

For NPS use only

received

AUG 9 1984

date entered

SEP 7 1984

See instructions in *How to Complete National Register Forms*

Type all entries—complete applicable sections

1. Name

historic Idaho State University Neighborhood Historic District

and/or common N/A

2. Location

street & number Roughly bounded by ~~East Carter and East Center streets~~, the alley between South Sixth and South Fifth streets, and the alley between ~~South Eighth and South Ninth streets~~ N/A not for publication

city, town Pocatello N/A vicinity of

state Idaho code 016 county Bannock code 005

3. Classification

Category	Ownership	Status	Present Use
<input checked="" type="checkbox"/> district	<input type="checkbox"/> public	<input checked="" type="checkbox"/> occupied	<input type="checkbox"/> agriculture
<input type="checkbox"/> building(s)	<input type="checkbox"/> private	<input type="checkbox"/> unoccupied	<input checked="" type="checkbox"/> commercial
<input type="checkbox"/> structure	<input checked="" type="checkbox"/> both	<input type="checkbox"/> work in progress	<input type="checkbox"/> educational
<input type="checkbox"/> site	<b>Public Acquisition</b>	<b>Accessible</b>	<input type="checkbox"/> entertainment
<input type="checkbox"/> object	N/A in process	<input type="checkbox"/> yes: restricted	<input type="checkbox"/> government
	N/A being considered	<input checked="" type="checkbox"/> yes: unrestricted	<input type="checkbox"/> industrial
		<input type="checkbox"/> no	<input type="checkbox"/> military
			<input type="checkbox"/> museum
			<input checked="" type="checkbox"/> park
			<input checked="" type="checkbox"/> private residence
			<input type="checkbox"/> religious
			<input type="checkbox"/> scientific
			<input type="checkbox"/> transportation
			<input type="checkbox"/> other:

4. Owner of Property

name Multiple ownership

street & number N/A

city, town N/A N/A vicinity of state N/A

5. Location of Legal Description

courthouse, registry of deeds, etc. Bannock County Courthouse

street & number East Center Street

city, town Pocatello state Idaho 83201

6. Representation in Existing Surveys

title Idaho State Historic Sites Inventory has this property been determined eligible?  yes  no

date 1982  federal  state  county  local

depository for survey records Idaho State Historical Society

city, town Boise state Idaho

## 7. Description

<u>X</u> excellent	<input type="checkbox"/> deteriorated	<u>X</u> unaltered	<u>X</u> original site	
<u>X</u> good	<input type="checkbox"/> ruins	<u>X</u> altered	N/A	date <u>N/A</u>
<u>X</u> fair	<input type="checkbox"/> unexposed			

### Describe the present and original (if known) physical appearance

The Idaho State University Neighborhood Historic District is a residential area of twelve full blocks and parts of thirteen blocks. Roughly bounded by East Carter and East Center streets, the alley between South Sixth and South Fifth streets, and the alley between South Eighth and South Ninth streets, the district lies north of the Idaho State University campus and south of Pocatello's east side commercial district. The area is quite level, but a few blocks south and east of the district there are steep hills. The district streetscape achieved its current appearance by about 1942. Streets are relatively narrow (60 feet wide) and they are laid out in a grid pattern. Along them, houses are set back behind parking strips planted with mature deciduous shade trees, concrete sidewalks, and front lawns, usually level and often retaining their original plantings of hardy shrubs and trees. The majority of district houses face out along the numbered streets, between four and eight to a block. Along the named streets, a few houses occupy the interior of lots; many of these represent infill during the later development of the district. Behind most of the houses and set along the alleys are automobile garages dating from the late 1910's and sometimes later. There are also a few sheds in the backyards of the district. While most of the district conforms to a consistent setback from the street and lot sidelines, it is not unusual to see a district house set close to or even looking out on an alley. Thus, the district is more densely settled than are most Idaho residential neighborhoods. Adding to the density of settlement are a few apartment buildings. The district also has two neighborhood grocery stores on Eighth Street, one church, and the one-block Caldwell Park, which is planted with mature spruce and fir trees and a variety of deciduous shade trees. Caldwell Park is the one major open space in the district.

The district is characterized by a variety of residential styles scattered throughout the neighborhood. From about 1900 to 1915 houses were built with reference to the Queen Anne, Colonial Revival, Prairie, and bungalow styles. The Colonial Revival style was by far the most common, and the other three styles appear most often as influences in primarily Colonial buildings. Between 1915 and 1929 the Colonial Revival, bungalow, and Prairie styles were equally popular, and fully realized renditions of the latter two styles were built. Between 1929 and 1942 the Colonial Revival style continued its popularity, and a substantial number of houses were executed in that style scattered throughout the district, filling in lots that had been vacant. Dominating this period of infill building, however, was the English Cottage or Tudoresque style. Two other period revival styles, the Mission and Pueblo, and the Moderne style are represented in one or two examples built during the pre-World War II era.

In spite of its stylistic eclecticism, the district has a coherent streetscape that is the product of consistency in scale, massing, proportions, materials, and siting. About three-quarters of the district houses are frame, and the remaining quarter are brick, with the exception of seven houses built of stucco in combination with frame or brick and one concrete block house. Only a few of the houses are more than one and one-half stories, and no building in the district rises above two and one-half stories. Predominantly small scale and gable-roofed, most

## 8. Significance

Period	Areas of Significance—Check and justify below			
<input type="checkbox"/> prehistoric	<input type="checkbox"/> archeology-prehistoric	<input type="checkbox"/> community planning	<input type="checkbox"/> landscape architecture	<input type="checkbox"/> religion
<input type="checkbox"/> 1400–1499	<input type="checkbox"/> archeology-historic	<input type="checkbox"/> conservation	<input type="checkbox"/> law	<input type="checkbox"/> science
<input type="checkbox"/> 1500–1599	<input type="checkbox"/> agriculture	<input type="checkbox"/> economics	<input type="checkbox"/> literature	<input type="checkbox"/> sculpture
<input type="checkbox"/> 1600–1699	<input checked="" type="checkbox"/> architecture	<input type="checkbox"/> education	<input type="checkbox"/> military	<input type="checkbox"/> social/ humanitarian
<input type="checkbox"/> 1700–1799	<input type="checkbox"/> art	<input type="checkbox"/> engineering	<input type="checkbox"/> music	<input type="checkbox"/> theater
<input type="checkbox"/> 1800–1899	<input type="checkbox"/> commerce	<input checked="" type="checkbox"/> exploration/settlement	<input type="checkbox"/> philosophy	<input type="checkbox"/> transportation
<input checked="" type="checkbox"/> 1900–	<input type="checkbox"/> communications	<input type="checkbox"/> industry	<input type="checkbox"/> politics/government	<input type="checkbox"/> other (specify)
		<input type="checkbox"/> invention		

**Specific dates** ca. 1900–ca. 1942      **Builder/Architect** N/A

**Statement of Significance (in one paragraph)**

The Idaho State University Neighborhood Historic District is significant as an area representing city expansion and architectural styles and types popular during the period 1900 through 1942. The district is the city's least altered residential area from the first half of this century. Its buildings and streets retain a feeling of the period through the preservation of street and sidewalk patterns; building materials, color, ornamentation, massing, and proportions; and original or early plantings. The district is associated with an important period of growth for Pocatello after the opening of reservation lands, a period in which the city grew into a major transportation, industrial, and educational center for the southeast Idaho region.

# 9. Major Bibliographical References

See continuation sheet

# 10. Geographical Data

Acreeage of nominated property about 51 acres

Quadrangle name Pocatello South

Quadrangle scale 7.5 minute

### UTM References

A	<u>12</u>	<u>382970</u>	<u>4746580</u>
	Zone	Easting	Northing

B	<u>12</u>	<u>382600</u>	<u>4746280</u>
	Zone	Easting	Northing

C	<u>12</u>	<u>382180</u>	<u>4746820</u>
	Zone	Easting	Northing

D	<u>12</u>	<u>382530</u>	<u>4747120</u>
	Zone	Easting	Northing

E			
	Zone	Easting	Northing

F			
	Zone	Easting	Northing

G			
	Zone	Easting	Northing

H			
	Zone	Easting	Northing

### Verbal boundary description and justification

See continuation sheet.

### List all states and counties for properties overlapping state or county boundaries

state	<u>N/A</u>	code	<u>N/A</u>	county	<u>N/A</u>	code	<u>N/A</u>
-------	------------	------	------------	--------	------------	------	------------

state	<u>N/A</u>	code	<u>N/A</u>	county	<u>N/A</u>	code	<u>N/A</u>
-------	------------	------	------------	--------	------------	------	------------

# 11. Form Prepared By

name/title Jennifer Eastman Attebery, State Architectural Historian

organization Idaho State Historical Society date June 4, 1984

street & number 610 North Julia Davis Drive telephone (208) 334-3861

city or town Boise state Idaho 83702-7695

# 12. State Historic Preservation Officer Certification

The evaluated significance of this property within the state is:

national  state  local

As the designated State Historic Preservation Officer for the National Historic Preservation Act of 1966 (Public Law 89-665), I hereby nominate this property for inclusion in the National Register and certify that it has been evaluated according to the criteria and procedures set forth by the National Park Service.

State Historic Preservation Officer signature Merle Wells

title State Historic Preservation Officer date 28 July 1984

### For NPS use only

I hereby certify that this property is included in the National Register

Entered in the National Register

for Melvyn Byer  
Keeper of the National Register

date 9-7-84

Attest:

date

Chief of Registration

**United States Department of the Interior  
National Park Service**

**National Register of Historic Places  
Inventory—Nomination Form**

For NPS use only

received

date entered

Idaho State University Neighborhood Historic District  
Continuation sheet

Item number 7

Page 1

of the houses, whatever their style, have standard size double-hung sash windows. The high frequency of brick buildings in the district, especially as used in the Colonial, Prairie, and English cottage styles, is another unifying feature. Although styles are clearly expressed, much of the architecture is modern and unelaborate. The district does include a few outstanding buildings (see sites 28, 38, 40, 42, 79, 81, 125, 128, 129, 132, 133, 137, 181, 186, 192, 193, 198, 203, 243, 248, 250, and 252) that are individually significant as excellent examples of their style, as locally rare examples of a style, or as examples of excellent workmanship and design.

Buildings have been assessed as contributory to the district primarily on the basis of their age and their degree of alteration. Buildings constructed after about 1942 are few. By that time the last of the Colonial Revival and English cottage houses were built and few vacant lots remained in the neighborhood. In addition, construction slackened with the beginning of World War II. Consequently, the few post-World War II houses in the district were built several years later and clearly represent the post-war housing industry dominated by the Ranch style. These buildings should eventually be assessed in relationship to their counterparts elsewhere in Pocatello, where whole neighborhoods of brick or frame Ranch houses were built in the late 1940's and 1950's.

The most frequent alteration to district buildings is re-siding with aluminum or stucco. In most cases residing a building was seen to render it non-contributory because the new siding obscured or caused the removal of defining features of building's style. With the Queen Anne style, in which surface texture itself is a defining feature, re-siding always affects the building's status. With other styles re-siding affects the building's status when it involves the removal or covering of window moldings, brackets, eave treatments, porch ornamentation, and so forth. In some cases, however, aluminum re-siding covers only a building's clapboard siding, and those buildings have been considered contributory.

Other alterations to district buildings include changes in the placement and types of windows, enclosure of porches, side or rear additions, and reroofing. For the most part the last two changes do not affect the status of a building, especially if additions are small and located on a lesser facade and if roofing materials are compatible with other original materials. Changes in fenestration were considered quite serious if windows on major facades were relocated or reglazed, and if the majority of a building's original windows had been lost. Some porch enclosures are compatible in materials and scale and leave a building's other major features intact.

The district's many garages are remarkably intact. Small, frame buildings with gable roofs and double doors set in one end wall, they generally retain their original siding and window and door openings, if any. A few were built with a distinctive notched and pedimented parapet above the usual double doors.

**United States Department of the Interior  
National Park Service**

**National Register of Historic Places  
Inventory—Nomination Form**

For NPS use only

received

date entered

Idaho State University Neighborhood Historic District  
Continuation sheet

Item number 7

Page 2

The Idaho State University neighborhood had little or no settlement before 1902, when the Academy of Idaho (later Idaho State University) was built at the end of Seventh Avenue on Carter. The academy site was chosen partly because it had the advantage of being outside the existing residential and business areas. Early photographs show the new academy building (no longer extant) surrounded by sagebrush. Before the building could go up, Seventh Avenue required grading. By 1906 at least scattered settlement had occurred. That year the city council voted against putting sidewalks along Lewis Street between Second and Ninth, its reason being that only five houses were present along the seven-block stretch. At the same time, the council approved crosswalks connecting Fourth and fifth streets near the Presbyterian Church (no longer extant). A photograph taken of Seventh Avenue in about 1906 shows scattered houses along dirt roads, young trees planted in parking strips, sidewalks running in front of a few properties, and the academy building centered at the end of the avenue. According to Robert L. Wrigley, "even by 1910 the houses in this section were widely spaced with large areas of open country" (Wrigley, p. 94) The earliest Sanborn fire insurance map depicting the district was published in 1915. By that time the area surrounding the academy had a good density of frame dwellings and a few brick buildings, nearly all of them one story. By 1921 the area was densely developed, and by 1948 residential development had filled in the available lots in the district and spread beyond it east to Fourteenth Avenue and south to Terry Street. In 1942 Wrigley characterized the district as "the largest area of fine residences in Pocatello. Although one finds a number of second and third class residences scattered here and there the great majority of houses in this section are very attractive with beautiful surroundings." (Wrigley, p. 31)

The district is bounded on the north and west by commercial development. On the south it is bounded by the Idaho State University campus, whose buildings presently represent the university's major period of expansion from the mid-1940's through the early 1960's. The east boundary of the district is drawn to exclude houses built later than the district's developmental period and to exclude largely altered buildings and streetscapes dominated by a high percentage of altered non-contributory or merely compatible buildings, which become more frequent east of the district. Boundaries are drawn to extend east and west along the named side-streets where there are contributory buildings or streetscapes. Nearly all of the district buildings retain their original use, the major reuse being the remodeling of houses into apartments. The two neighborhood stores in the district were stores within the district's period of significance, one being an early remodeling of a residence (the Woods Grocery) and the other having been built as a grocery designed in a compatible residential style (the Cottage Food Store). Very few buildings have been lost from the district, but many have been remodeled in various ways, fortunately leaving most of them still contributory to the district (see the discussion of alterations, above). Over the past few years Pocatellans have shown an increased interest in restoring their historic buildings. Currently an historic preservation ordinance is before the city council, and a citywide survey of historic buildings that will be a basis for preservation components in the city's comprehensive plan is being conducted.

**United States Department of the Interior  
National Park Service**

**National Register of Historic Places  
Inventory—Nomination Form**

For NPS use only

received

date entered

Idaho State University Neighborhood Historic District  
Continuation sheet

Item number 8

Page 1

The establishment of a state academy at Pocatello in 1901 spurred the development of a major residential district on the east side of the city contiguous to the academy location. Apparently the area was uninhabited until the academy began, previous residential settlement being confined chiefly to west of the railroad tracks. Merrill Beal describes the journey from the center of town (only about ten blocks distance) to campus "over the board walk that crossed the tracks, [past] the Pacific Hotel and the Tupper House, thence into the intervening area of sage brush and sand to the Academy" (Beal, p. 10) The district grew, slowly at first and then more rapidly through the 1910's and 1920's, to become the city's most prestigious neighborhood. Many of the town leaders, including businessmen, doctors, lawyers, and professors at the new institution, built substantial and stylish homes in the vicinity of the academy after its founding. In particular, Seventh Avenue acquired a number of the larger and more elaborate houses, a tree-lined streetscape that culminated in a view of the first academy building (named Swanson Hall, no longer extant), located where Seventh Avenue terminates at Carter Street. As discussed in part 7 of this nomination, by 1942 the district was formed as we see it now. Nearly all of the available lots were full, and a brief lull in building activity occurred during World War II. By the end of the war, the Colonial Revival and English Cottage styles had run their course; the few additional houses built in the neighborhood represent post-war tract housing ideas and are non-contributory.

The district grew up during four decades of major development for the city of Pocatello. Established as a railroad junction in 1882, the town was isolated and limited in its expansion by the surrounding Shoshoni-Bannock reservation until parts of the reservation were relinquished to white settlement in 1889 and 1900. During the years from 1900 to about 1942 the downtown area grew into a substantial commercial center for southeast Idaho, focused around the Oregon Short Line (Union Pacific) railroad shops, freight and passenger depots, and the nearby wholesale warehouse district. The state academy became a branch of the University of Idaho, serving the southeast Idaho region, and later a university in its own right. The town established itself as a permanent settlement, replicating along Midwestern patterns a grid of paved streets running parallel to the railroad tracks that split the city east and west, a concentrated commercial core of brick business blocks, and irrigated residential areas.

The Idaho State University neighborhood represents Pocatello settlement during the first half of the twentieth century as a major area of residential development during the period. In comparison with the other period neighborhoods in Pocatello, the area has the greatest concentration of unaltered buildings and the least altered and most elaborate representatives of the various popular styles. The district conveys a sense of its period through the presence of original plantings and through the siting of buildings, as well as through the presence of unaltered houses. In addition, most of the non-contributory houses are compatible with contributory buildings in scale, material, and color, making the streetscape a coherent one.

**United States Department of the Interior  
National Park Service**

**National Register of Historic Places  
Inventory—Nomination Form**

For NPS use only

received

date entered

Idaho State University Neighborhood Historic District  
Continuation sheet

Item number 8

Page 2

Southeastern Idaho has a high percentage of Idaho's Prairie-style houses. The Pocatello district provides an excellent range of examples in brick and frame that would support a study of the Prairie style in Idaho. In other ways as well, the district is an excellent representative of architectural trends in its region. The Colonial Revival style is dominant until quite late in the period, the bungalow is an important mode for the rapid construction of middle-class housing, and the English cottage is an important style for infill building during the Depression years. Not surprisingly, building in Pocatello slackened in the 1930's, but in contrast with many agriculturally based Idaho towns, industrially based Pocatello's construction did not slacken greatly during the 1920's.

As detailed in part 7 of this nomination, district boundaries are drawn to include the resources representing the period 1900 to 1942 and to exclude contiguous areas of more highly altered residential buildings, more recent residential buildings, commercial buildings, and the Idaho State University campus.



**United States Department of the Interior  
National Park Service**

**National Register of Historic Places  
Inventory—Nomination Form**

Idaho State University Neighborhood Historic District  
Continuation sheet

Item number 9

For NPS use only

received

date entered

Page 1

MAJOR BIBLIOGRAPHICAL REFERENCES:

Armstrong, David T. "The Servel Home." Unpublished manuscript in the collection of the Idaho State University President. Ca. 1970.

Beal, Merrill D. History of Idaho State College. 1952.

Gittins, H. Leigh. Pocatello Portrait: the Early Years, 1878 to 1928. Pocatello: The University Press of Idaho, 1983.

Idaho State Historical Society photograph collection. Boise.

Polk City Directories, 1929, 1930-31, 1932-33, 1936-37, 1938-39, 1940-41, 1942, 1946, 1949, 1953, 1955, 1956, 1957.

Sanborn Fire Insurance Maps, September 1892, April 1900, September 1907, July 1915, May 1921 with June 1948 corrections.

Swanson, Merwin R. "Pocatello's Business Community and the New Deal." Idaho Yesterdays, Volume 21 (Fall 1977), pp. 9-15.

Wrigley, Robert L. Jr., "The Occupational Structure of Pocatello, Idaho." Ph.D. Dissertation, University of Chicago, 1942.

**United States Department of the Interior  
National Park Service**

**National Register of Historic Places  
Inventory—Nomination Form**

Idaho State University Neighborhood Historic District  
Continuation sheet

Item number 10

For NPS use only

received

date entered

Page 1

VERBAL BOUNDARY DESCRIPTION:

The nomination includes the following parcels in the Original Pocatello Townsite: blocks 182, 204, 205, 206, 207, 208, 236, 237, 238, 239, and 240; block 150, lots 11-20; block 151, lots 11 and 12; block 179, lots 11-20; block 181, lots 9-20; block 263, lots 1-10; block 264, lots 1-10; block 265, lots 1-10; block 266, lots 9 and 10; block 1787, lots 13-20, and the west 69 to 84 feet of lots 11 and 12; block 178, lots 19 and 20 and the west 50 feet of lots 11 and 12 and the west 50 feet and south 20 feet of lot 13; block 180, lots 11-20 and the west 70 feet of lots 9 and 10; block 183, the west 50 feet of the east 100 feet of lots 1, 2, and 3; and block 262, lots 1-10 and 18-20 and the east 70 feet of lots 11 and 12.



## ISU Neighborhood Historic District Inventory:

	# in district nomination	address	materials and number of stories	style	date or period	historic use or name	status
<u>Block 177, cont.</u>	11	144 Eighth	1-story frame	Colonial Revival/ Prairie	ca. 1910-1915	residence	contributory
	12	"				garage assoc. with 11	contributory
	13	156 Eighth	1-1/2 story brick	Colonial Revival	ca. 1910-1915	residence	contributory
<u>Block 266</u>	14	632 Bonneville	1-story frame	Colonial Revival	ca. 1910-1915	residence	contributory
	15	"			ca. 1915-1921	residence	contributory
	16	247 Sixth	2-story frame	Colonial Revival	ca. 1910-1915	residence	contributory
<u>Block 236</u>	17	725/727 Lewis	1-story frame	bungalow/	ca. 1921-1929	residence	contributory
	18	208 Sixth	1-story frame	bungalow	ca. 1921-1929	residence	contributory
	19	216 Sixth	1-story frame	bungalow	ca. 1910-1915	residence	contributory
	20	"			ca. 1915-1921	garage assoc. with 19	contributory
	21	222 Sixth	1-story frame	bungalow	ca. 1915-1921	residence	contributory
	22	"				garage assoc. with 21	

## ISU Neighborhood Historic District Inventory:

	# in district nomination	address	materials and number of stories	style	date or period	historic use or name	status
<u>Block 236, cont.</u>							
	23	238-1/2 Sixth	1-story frame		ca. 1910-1915	residence	contributory
	24	238 Sixth	1-story frame		ca. 1910-1915	residence	compatible
	25	244 Sixth	1/1/2 story frame	English Cottage	ca. 1915, 1930s alter- ations	residence	compatible
	26	256 Sixth	1-1/2 story frame	bungalow	ca. 1915-1921	residence	significant
	27	"				garage assoc. with 26	contributory
	28	209 Seventh	2-story frame	Queen Anne/ Colonial Revival	ca. 1900-1915	residence	significant
	29	209-1/2 Seventh	1-1/2 story frame	Colonial Revival	ca. 1920's	unknown	contributory
	30	227 Seventh	1-1/2 story frame	Colonial Revival	ca. 1910-1915	residence	contributory
	31	"			ca. 1915-1921 ca. 1915-1948	garage assoc. with 30	contributory
	32	237 Seventh	2-story frame	Colonial Revival	ca. 1910-1915	residence	contributory
	33	"				garage assoc. with 32	contributory
	34	"				garage assoc. with 32	contributory
	35	245/249 Seventh	1-story frame	English Cottage		duplex	contributory

## ISU Neighborhood Historic District Inventory:

	# in district nomination	address	materials and number of stories	style	date or period	historic use or name	status
<u>Block 236 cont.</u>	36	245/249 Seventh				garage assoc. with 35	contributory
	37	255 Seventh	1-story frame	English Cottage	ca. 1932-1937	residence Hilliard House	contributory
<u>Block 208</u>	38	202 Seventh	1-1/2 story	Gothic Revival	1927	First Presby- terian Church	significant
	39	230 Seventh	1-story frame	Colonial Revival/ Prairie	ca. 1929-1931	residence	contributory
	40	242 Seventh	2-story brick	Federal Revival	ca. 1936-1939	residence Pond House	significant
	41	"				garage assoc. with 40	non- contributory
	42	252 Seventh	2-story brick	Colonial Revival/ Italianate	ca. 1900-1915	residence	significant
	43	824 Bonneville	1-story brick	Colonial Revival/ bungalow	ca. 1921-1929	residence	contributory
	44	209 Eighth	1-1/2 story stucco	Colonial Revival	ca. 1910-1915	residence	compatible
	45	219 Eighth	1-1/2 story brick	bungalow	ca. 1929-1931	residence Elliott House	contributory
	46	231 Eighth	2-story frame	Colonial Revival	ca. 1940-1942	residence Eisenberg House	contributory
	47	243 Eighth	1-story brick	bungalow/ Prairie	ca. 1929-1931	residence Gough House	contributory
	48	848 Bonneville	1-story brick	ranch	ca. 1956-1957	residence Humphries House	compatible

ISU Neighborhood Historic District Inventory:

	# in district nomination	address	materials and number of stories	style	date or period	historic use or name	status
<u>Block 178</u>	49	208 Eighth	1-story frame	Colonial Revival/ Prairie	ca. 1910-1915	residence	contributory
	50	906 Bonneville	1-story frame	Colonial Revival	ca. 1921-1929	residence	contributory
	51	"				garage assoc. with 50	contributory
<u>Block 265</u>	52	305 Sixth	1-story frame	Colonial Revival	ca. 1910-1915	residence	contributory
	53	315 Sixth	1-story frame	Colonial Revival	ca. 1910-1915	residence	contributory
	54	325 Sixth	1-story frame	Colonial Revival	ca. 1910-1915	residence	contributory
	55	337 Sixth	1-1/2 story frame	bungalow	ca. 1910-1915	residence	contributory
	56	341 Sixth	1-story frame	Colonial Revival	ca. 1910-1915	residence	contributory
	57				ca. 1915-1921	garage assoc. with 56	contributory
	58	353 Sixth	1-1/2 story brick	Colonial Revival/ Prairie	ca. 1921-1929	residence	contributory
	59	636 Whitman	1-1/2 story brick	English Cottage	ca. 1921-1929	residence	contributory
<u>Block 237</u>	60	721 Bonneville	1-story brick		ca. 1915-1921	residence	contributory
	61	705 Bonneville	1-story stucco		ca. 1900-1915	residence	contributory
	62	318 Sixth	1-story frame	bungalow	ca. 1921-1929	residence	compatible

## ISU Neighborhood Historic District Inventory:

	# in district nomination	address	materials and number of stories	style	date or period	historic use or name	status
<u>Block 237</u> (continued)	63	318 Sixth				garage assoc. with 62	contributory
	64	318 1/2 Sixth	1-story frame	bungalow	ca. 1930-1933	residence	contributory
	65	330 Sixth	1-1/2 story frame	Colonial Revival/ Prairie	ca. 1910-1915	residence	contributory
	66	"			ca. 1915-1921	garage assoc. with 65	contributory
	67	334 Sixth	1-story frame	Colonial Revival	ca. 1910-1915	residence	contributory
	68	"			ca. 1915-1921	garage assoc. with 67	compatible
	69	340 Sixth	1-story frame	Colonial Revival	ca. 1910-1915	residence	contributory
	70	"			ca. 1915-1921	garage assoc. with 69	compatible
	71	352 Sixth	1-story frame	Colonial Revival	ca. 1910-1915	residence	contributory
	72	356 Sixth	1-1/2 story frame	Colonial Revival	ca. 1910-1915	residence	contributory
	73	"			ca. 1915-1921	garage assoc. with 72	contributory
	74	722 Whitman	2-story frame & brick	Mission	ca. 1921-1929	residence	contributory
	75	305 Seventh	1-1/2 story frame	Colonial Revival	ca. 1938-1941	residence Anderegg House	contributory
	76	315-1/2 Seventh	1-story frame	Colonial Revival	ca. 1930's- early 1940's	residence	contributory
	77	315 Seventh	1-story frame	Queen Anne /Colonial Revival	ca. 1900-1915	residence	compatible



## ISU Neighborhood Historic District Inventory:

	# in district nomination	address	materials and number of stories	style	date or period	historic use or name	status
<u>Block 237 (continued)</u>							
	78	325 Seventh	1-story brick	Moderne/ Ranch	ca. 1949-1953	residence MacKenzie House	compatible
	79	341 Seventh	2-1/1 story brick	Federal Revival	ca. 1915-1921	residence Xavier Servel House	significant
<u>Block 207</u>							
	80	821 Bonneville	1-story concrete block	Colonial Revival	ca. 1910-1915	residence	contributory
	81	306 Seventh	1-1/2 story frame	Queen Anne/ Colonial Revival	ca. 1900-1915	residence	significant
	82	306 1/2 Seventh	1-story frame		ca. 1900-1915	residence	contributory
	83	320 Seventh	1-story brick	Moderne	ca. 1949-1953	residence Roberts House	contributory
	84	332 Seventh	1-1/2 brick and stocco	Colonial Revival/ Prairie	ca. 1921-1929	residence	contributory
	85	344 Seventh	1-story brick	English Cottage	ca. 1932-1937	residence	contributory
	86	"				garage assoc. with 85	contributory
	87	354 Seventh	1-1/2 story brick	Mission/ Prairie	ca. 1915	residence	contributory
	88	"			ca. 1915-1921	garage assoc. with 87	contributory
	89	311 Eighth	1-1/2 story frame	Colonial/ English Cottage	ca. 1936-1939	residence Brydon House	contributory
	90	319 Eighth	1-story frame	bungalow	ca. 1921-1929	residence	compatible
	91	"				garage assoc. with 90	compatible

## ISU Neighborhood Historic District Inventory:

	# in district nomination	address	materials and number of stories	style	date or period	historic use or name	status
<u>Block 207 (continued)</u>							
	92	333 Eighth	1-story brick	Ranch	ca. 1960	residence	compatible
	93	345 Eighth	2-story frame	Colonial Revival	ca. 1915-1921	residence	contributory
	94	355 Eighth	1-1/2-story frame	Colonial Revival	ca. 1910-1915	residence	contributory
<u>Block 179</u>							
	95	302 Eighth	1-story frame		ca. 1915-1921	residence	compatible
	95	302 Eighth	1-story frame		ca. 1921-1929	residence	contributory
	97	316 Eighth	1-story frame	bungalow	ca. 1921-1929	residence	compatible
	98	324 Eighth	1-story frame	Colonial Revival	ca. 1910-1915	residence	contributory
	99	336 Eighth	1-story frame	Colonial Revival	ca. 1910-1915	residence	contributory
	100	"	1-story frame	Colonial Revival	ca. 1921-1948	garage assoc. with 99	contributory
	101	340 Eighth	1-story frame		ca. 1910-1915	residence	compatible
	102	"			ca. 1915-1921	outbuilding assoc. with 101	contributory
	103	352 Eighth	1-1/2 story frame	Colonial Revival/ bungalow	ca. 1910-1915	residence	contributory
	104					garage assoc. with 103	contributory
	105	356 Eighth	1-story frame	Colonial Revival	ca. 1910-1915	residence	contributory
	106	"			1915 1921	garage assoc. with 105	contributory

## ISU Neighborhood Historic District Inventory:

	# in district nomination	address	materials and number of stories	style	date or period	historic use or name	status
<u>Block 264</u>	107	633 Whitman	1-story frame	bungalow	ca. 1910-1915	residence	contributory
	108	405 Sixth	1-1/2 story frame	bungalow	ca. 1910-1915	residence	contributory
	109	411 Sixth	1-1/2 story frame	Colonial Revival	ca. 1910-1915	residence	contributory
	110	"			ca. 1915-1921	garage assoc. with 109	contributory
	111	415 Sixth	1-story brick	bungalow	ca. 1915-1921	residence Hyde House	contributory
	112	423 Sixth	1-story brick	Mission/ Prairie	ca. 1929-1931	residence Roberts House	contributory
	113	431 Sixth	1-1/2 story frame	Colonial Revival	ca. 1900-1915	residence	contributory
	114	453 Sixth	1-story frame	Colonial Revival/ Prairie	ca. 1910-1915	residence	contributory
	115	"			ca. 1915-1921	garage assoc. with 114	contributory
<u>Block 238</u>	116	406 Sixth	1-story brick	bungalow	ca. 1915-1921	residence	contributory
	117	"			ca. 1915-1921	garage assoc. with 116	contributory
	118	420 Sixth	2-story brick		ca. 1921-1929	Aloha Apartments	contributory
	119	440 Sixth	1-1/2 story brick	bungalow/ Prairie	ca. 1910-1915	residence	contributory
	120				ca. 1915	garage assoc. with 119	contributory
	121	442 Sixth	1-story frame	Colonial Revival	ca. 1910-1915	residence	contributory

## ISU Neighborhood Historic District Inventory:

# in district nomination	address	materials and number of stories	style	date or period	historic use or name	status
<u>Block 238 (continued)</u>						
122	442 Sixth				garage assoc. with 121	contributory
123	452 Sixth	2-story frame	Colonial Revival	ca. 1910-1915	residence	contributory
124	"	1-story concrete block		ca. 1915-1921	garage assoc. with 123	contributory
125	405 Seventh	1-1/2 story frame	Dutch Colonial Revival	ca. 1910-1915	residence	significant
126	"	1-story frame		ca. 1915	garage assoc. with 125	contributory
127	415 Seventh	1-story brick	Bungalow/ Prairie	ca. 1921-1929	residence	contributory
128	425 Seventh	1-1/2 story brick	Colonial Revival/ Prairie	ca. 1921-1929	residence	significant
129	435 Seventh	1-1/2 story brick	Colonial Revival	ca. 1921-1929	residence	significant
130	449 Seventh	2-1/2 story brick & frame	Colonial Revival	ca. 1910-1915	residence	contributory
131	736 Benton	1-1/2 story frame	Colonial Revival	ca. 1910-1915	residence	contributory
<u>Block 206</u>						
132	406 Seventh	1-story brick	Colonial/ Prairie	ca. 1921-1929	residence	significant
133	424 Seventh	2-1/2 story frame	Colonial Revival	ca. 1910-1915	residence	significant
134	"	1-story frame		ca. 1915-1921	garage assoc. with 133	contributory

## ISU Neighborhood Historic District Inventory:

	# in district nomination	address	materials and number of stories	style	date or period	historic use or name	status
<u>Block 206 (continued)</u>							
	135	444 Seventh	1-story brick	English Cottage/ Ranch	ca. 1946-1948	residence Chase House	compatible
	137	488 Seventh	2-1/2-story brick	Colonial Revival	ca. 1900-1915	residence Gittens House	significant
	138	"			ca. 1915-1921	garage assoc. with 137	contributory
	139	855 Whitman	1-story frame	Colonial/ Ranch	ca. 1938-1941	residence Peterson House	contributory
	140	"				garage assoc. with 139	contributory
	141	417 Eighth	1-story brick	bungalow/ Prairie	ca. 1921-1929	residence	contributory
	142	425 Eighth	1-story frame		ca. 1921-1929	residence	compatible
	143	"			ca. 1915-1921	outbuilding assoc. w/142	compatible
	144	435 Eighth	1-story frame	English Cottage	ca. 1930-1933	residence Cacavas House	compatible
	145	447/445 Eighth	1-story brick	English Cottage	ca. 1936-1939	residence duplex	contributory
	146	"	1-story frame			garage assoc. with 145	contributory
	147	455 Eighth	1-story brick	bungalow/ Prairie	ca. 1921-1929	residence	contributory
<u>Block 180</u>							
	148	923/919 Whitman	2-story frame	English Cottage	ca. 1936-1939	apartments	contributory
	149	406 Eighth	1-story frame	English Cottage	ca. 1932-1937	residence Fereday House	contributory

## ISU Neighborhood Historic District Inventory:

	# in district nomination	address	materials and number of stories	style	date or period	historic use or name	status
<u>Block 180 (continued)</u>							
	150	420 Eighth	1-story frame	English Cottage	ca. 1932-1937	residence Lyons House	contributory
	151	"				garage assoc. with 150	contributory
	152	426 Eighth	1-story frame	English Cottage	ca. 1932-1937	residence Amundsen House	contributory
	153					garage assoc. with 152	contributory
	154	430 Eighth	1-1/2 story frame	bungalow	ca. 1910-1915	residence	compatible
	155	"	1-story frame		ca. 1915	garage assoc. with 154	contributory
	156	456 Eighth	1-1/2 story brick	English Cottage	ca. 1921-1929	residence	contributory
	157	936/938 Benton	1-story frame	Colonial Revival	ca. 1940-1942	duplex	contributory
<u>Block 263</u>							
	158	635 Benton	1-1/2 story frame	bungalow	ca. 1910-1915	residence	compatible
	159	505 Sixth	1-1/2 story frame	bungalow	ca. 1910-1915	residence	contributory
	160	519 Sixth	1-1/2 story frame	English Cottage	early 1940s	residence Rush House	contributory
	161	523 Sixth	1-1/2 story frame	bungalow	ca. 1921-1929	residence	contributory
	162	545 Sixth	1-1/2 story frame	bungalow	ca. 1915	residence	contributory
	163	"			ca. 1915	garage assoc. with 162	contributory
	164	551 Sixth	1-1/2 story frame	bungalow	ca. 1917	residence	contributory
	165	"				outbuilding assoc. w/164	contributory

## ISU Neighborhood Historic District Inventory:

	# in district nomination	address	materials and number of stories	style	date or period	historic use or name	status
<u>Block 180 (continued)</u>							
	166	551 Sixth	1-story frame		ca. 1915-1921	garage assoc. with 164 (southerly of 2 outbuildings)	contributory
	167	555/553 Sixth	2-story concrete block and stucco	Moderne	ca. 1938-1941	apartments	contributory
	168	530 Halliday	1-1/2 story frame	Colonial Revival	ca. 1932-1937	residence	compatible
<u>Block 239</u>							
	169	745 Benton	1-story frame	bungalow	ca. 1910-1915	residence	contributory
	170	"	1-story frame			garage assoc. with 169	contributory
	171	506 Sixth	1-1/2 story frame	bungalow	ca. 1915-1921	residence	contributory
	172	"	1-story frame		ca. 1915-1921	garage assoc. with 171	compatible
	173	518 Sixth	1-story frame	Colonial Revival	ca. 1910-1915	residence	contributory
	174	524 Sixth	1-1/2 story frame	bungalow	1915-1921	residence	compatible
	175	534 Sixth	1-story frame	Prairie	ca. 1910-1915	residence	compatible
	176	546/544 Sixth	1-story frame		ca. 1921-1929	residence	compatible
	177	542 Sixth	1-story frame		ca. 1932-1937	residence	contributory
	178	556 Sixth	1-1/2 story frame	bungalow	ca. 1915-1921	residence	contributory
	179	734 Halliday	1-story frame	Colonial Revival	ca. 1921-1929	residence	contributory
	180	755/753 Benton	1-story frame	bungalow/ Prairie	ca. 1921-1929	duplex	contributory
	182	509 Seventh	1-1/2 story frame	Colonial Revival/ bungalow	ca. 1910-1915	residence	significant

## ISU Neighborhood Historic District Inventory:

	# in district nomination	address	materials and number of stories	style	date or period	historic use or name	status
<u>Block 239 (continued)</u>							
	182	517 Seventh	1-1/2 story frame	Colonial Revival/ Prairie	ca. 1910-1915	residence	significant
	183	"	1-story frame		ca. 1915-1921	outbuilding assoc. w/182	contributory
	184	529 Seventh	1-1/2 story frame	Colonial Revival/ Prairie	ca. 1910-1915	residence	compatible
	185	541 Seventh	1-story frame	Colonial Revival	ca. 1910-1915	residence	compatible
	186	555 Seventh	2-story brick	Spanish Colonial/ Prairie	ca. 1921-1929	residence Peterson House	significant
<u>Block 205</u>							
	187	506 Seventh	2-story frame	Colonial Revival	ca. 1929-1931	residence Stratford House	contributory
	188	520 Seventh	1-1/2 story frame	Queen Anne/ Colonial Revival	ca. 1900-1915	residence	compatible
	189	"	1-story frame			garage assoc. with 188	contributory
	190	540 Seventh	1-1/2 story frame	bungalow	ca. 1915	residence	contributory
	191	"	1-story frame		ca. 1915-1921	garage assoc. with 190	contributory
	192	544 Seventh	2-1/2 story brick	Colonial Revival	ca. 1921-1929	residence McDonald House	significant
	193	554 Seventh	2-1/2 story brick vener overtrave	Colonial Revival	ca. 1915-1921	residence Hood House	significant
	194	"	1-story frame		ca. 1915-1921	garage assoc. with 193	significant



## ISU Neighborhood Historic District Inventory:

	# in district nomination	address	materials and number of stories	style	date or period	historic use or name	status
<u>Block 205 (continued)</u>							
	195	835 Benton	1-1/2 story frame		ca. 1949-1953	residence Harris House	compatible
	196	505 Eighth	1-1/2 story frame	English Cottage	ca. 1936-1939	residence Deaton House	compatible
	197	515 Eighth	1-story frame	bungalow	ca. 1921-1929	residence	compatible
	198	523 Eighth	1-1/2 story brick	Prairie	ca. 1921-1929	residence	significant
	199	"	1-story frame			garage assoc. with 198	contributory
	200	535 Eighth	1-story frame	Colonial Revival	ca. 1915-1921	residence	contributory
	201	541 Eighth	1-1/2 story frame	Queen Anne/ Colonial Revival	ca. 1900-1915	residence	compatible
	202	"	1-story frame		ca. 1915-1921	garage assoc. with 201	compatible
	203	553 Eighth	1-story brick	Colonial Revival/ Prairie	ca. 1921-1929	residence	significant
	204	"	1-story frame			garage assoc. with 203	compatible
<u>Block 181</u>							
	205	923 Benton	1-1/2 story frame	English Cottage	ca. 1932-1937	residence Vedeler House	contributory
	206	"	1-story frame			garage assoc. with 205	contributory
	207	504 Eighth	1-story frame	Colonial Revival/ bungalow	ca. 1915-1921	residence	contributory
	208	516 Eighth	1-story frame	bungalow	ca. 1910-1915	residence	compatible

## ISU Neighborhood Historic District Inventory:

	# in district nomination	address	materials and number of stories	style	date or period	historic use or name	status
<b>Block 181 (continued)</b>							
	209	516 Eighth	1-story frame			garage assoc. with 208	contributory
	210	526 Eighth	1-story brick	English Cottage	ca. 1929-1931	residence McLean House	contributory
	211	540 Eighth	1-story frame	Colonial Revival	ca. 1915-1921	residence	contributory
	212	546 Eighth	2-story frame		rear section ca. 1900-1915 front (grocery) ca. 1929-1933	residence/ Robt. G. Woods Grocery	contributory
	213	"	2-story frame rear frame, adobe filled			garage assoc. with 212	contributory
	214	906 Halliday	1-story frame	bungalow	ca. 1921-1929	residence	contributory
	215	"	1-story frame			garage assoc. with 214	contributory
	216	916 Halliday	1-story frame	bungalow	ca. 1921-1929	residence	contributory
	217	926 Halliday	1-story frame			residence	compatible
	218	"	1-story frame			garage assoc. with 217	compatible
	219	559 Ninth	1-story frame	bungalow	ca. 1910-1921	residence	contributory
	220	"	1-story frame			garage assoc. with 219	contributory
	221	934 Halliday	1-story frame		ca. 1921	residence	contributory
<b>Block 151</b>	222	550 Ninth	1-story brick	English Cottage	ca. 1932-1937	residence	contributory
<b>Block 262</b>	223	625/627 Halliday	1-1/2 story frame	bungalow	ca. 1938-1941	apartments	contributory

## ISU Neighborhood Historic District Inventory:

	# in district nomination	address	materials and number of stories	style	date or period	historic use or name	status
<u>Block 262 (continued)</u>							
	224	626 Carter	1-1/2 story frame	bungalow	ca. 1938-1941	residence	contributory
	225	"	1-story frame			garage assoc. with 224	contributory
	226	635 Halliday	1-1/2 story frame	bungalow/ Colonial Revival	ca. 1915-1921	residence	contributory
	227		1-story frame			garage	contributory
	228		1-story frame			garage	contributory
	229	605 Sixth	1-1/2 story frame	bungalow	ca. 1915-1921	residence	compatible
	230	615 Sixth	2-story frame	bungalow	ca. 1915-1921	residence	contributory
	231	623 Sixth	2-story frame	bungalow	ca. 1915-1921	residence Bond House	contributory
	232	"	1-story frame		ca. 1915-1921	garage assoc. with 231	contributory
	233	635 Sixth	1-1/2 story frame	bungalow	ca. 1921-1929	residence	contributory
	234	643 Sixth	1-story frame	English Cottage	ca. 1921-1929	residence	compatible
	235	"	1-story frame			garage assoc. with 234	contributory
	236	655 Sixth	2-story frame and stucco	Colonial	ca. 1915-1921	residence	contributory
	237	636 Carter	1-1/2 story frame and stucco	Colonial Revival/ bungalow	ca. 1929-1931	residence Ames house	contributory
	238	"	1-story frame			garage assoc. with 237	contributory
Block 240 24	239	735 Halliday	2-story brick	Colonial	ca. 1929-1931	Vickrey Apartments	contributory

## ISU Neighborhood Historic District Inventory:

	# in district nomination	address	materials and number of stories	style	date or period	historic use or name	status
<u>Block 240 (continued)</u>							
	240	606 Sixth	1-1/2 story brick	English Cottage	ca. 1929-1931	residence Vickrey House	contributory
	241	622 Sixth	1-story brick	Prairie	ca. 1915-1921	residence	contributory
	242	624 Sixth	1-story frame	bungalow	ca. 1915-1921	residence	contributory
	243	632 Sixth	1-1/2 story concrete block	Colonial Revival/ Prairie	ca. 1910-1915	residence	significant
	244	"	1-story concrete block		ca. 1915	garage assoc. with 243	contributory
	245	648 Sixth	1-1/2 story frame	bungalow	ca. 1907-1915	residence	contributory
	246	605 Seventh	1-1/2 story brick	Prairie	ca. 1915	residence	contributory
	247	"	1-story brick		ca. 1915	garage assoc. with 246	contributory
	248	631 Seventh	1-story frame	Colonial Revival	ca. 1921-1929	residence	contributory
	249	635 Seventh	1-story frame	bungalow/ Prairie	ca. 1915-1921	residence	significant
	250	655 Seventh	2-story brick	Prairie	ca. 1915-1921	residence	significant
	251	"	1-story brick		ca. 1915-1921	garage assoc. with 250	contributory
<u>Block 204</u>							
	252	606 Seventh	1-1/2 story brick	Colonial Revival	ca. 1900-1915	residence	significant
	253	630 Seventh	1-1/2 story frame	Colonial Revival/ Prairie	ca. 1910-1915	residence	contributory
	254	"				garage assoc. with 253	contributory

## ISU Neighborhood Historic District Inventory:

	# in district nomination	address	materials and number of stories	style	date or period	historic use or name	status
<u>Block 204 (continued)</u>							
	255	638 Seventh	2-story frame	Colonial Revival	ca. 1936-1939	residence Moyle House	contributory
	256	654 Seventh	1-story frame	Colonial Revival/ bungalow	ca. 1915-1921	residence Paradise House	compatible
	257	831 Halliday	1-story frame	bungalow	ca. 1910-1915	residence	compatible
	258	"	1-story frame		ca. 1910-1915	outbuilding assoc. w/257	contributory
	259	833 Halliday	1-story frame		ca. 1910-1915	residence	contributory
	260	835 Halliday	1-story frame	Colonial Revival	ca. 1910-1915	residence	compatible
	261	"				outbuilding assoc. w/260	contributory
	262	635 Eighth	1-story frame	Colonial Revival/ bungalow	ca. 1910-1915	residence	contributory
	263	"				outbuilding assoc. w/262	contributory
	264	645 Eighth	1-story frame		ca. 1910-1915	residence	compatible
	265	856 Carter	2-story brick	bungalow	ca. 1915-1921	residence	contributory
	266	836 Carter	2-story brick vener over frame	bungalow	ca. 1907-1915	residence	contributory
	267	"	1-story frame	bungalow	ca. 1915-1921	residence	contributory
<u>Block 182</u>							
	268	925 Halliday	1-story brick		ca. 1932-1937	duplex	contributory
	269	604 Eighth	1-story brick	English Cottage	ca. 1932-1937	cottage food store	contributory

## ISU Neighborhood Historic District Inventory:

	# in district nomination	address	materials and number of stories	style	date or period	historic use or name	status
<u>Block 182 (continued)</u>							
	270	620 Eighth	1-1/2 story frame	Colonial Revival/ Prairie	ca. 1915-1921	residence	contributory
	271	"	1-story frame			garage assoc. with 271	contributory
	272	622 Eighth	1-story brick	Colonial/ bungalow	ca. 1915-1921	residence	contributory
	273	"	1-story brick		ca. 1915-1921	garage assoc. with 272	contributory
	274	640 Eighth	1-story frame	Colonial Revival/ bungalow	ca. 1921-1929	residence	contributory
	275	"	1-story frame			garage assoc. with 274	contributory
	276	648/650 Eighth	1-story frame	Colonial Revival	ca. 1921-1929	residence	compatible
	277	656 Eighth	1-story frame	Colonial	ca. 1921-1929	residence	compatible
	278	926 Carter	1-story frame	bungalow	ca. 1921-1929	residence	compatible
	279	937 Halliday	1-story frame		ca. 1921-1929	residence	contributory
	280	947 Halliday	1-story frame		ca. 1921-1929	residence	compatible
	281	957 Halliday	1-story frame		ca. 1921-1929	residence	non-contributory
	282	623 Ninth	1-story frame		ca. 1910-1921	residence	contributory
	283	627 Ninth	1-story frame	bungalow	ca. 1921-1929	residence	contributory
	284	631 Ninth	1-1/2 story brick	English Cottage	ca. 1932-1937	residence Halladay House	contributory
	285	600 block Ninth	1-story frame			garage	contributory
	286	600 block Ninth	1-story frame			garage	contributory

## ISU Neighborhood Historic District Inventory:

	# in district nomination	address	materials and number of stories	style	date or period	historic use or name	status
<u>Block 182 (continued)</u>							
	287	643 Ninth	1 story frame		ca. 1932-1937	residence	contributory
	288	645 Ninth	1-1/2 story frame	English Cottage	ca. 1932-1937	residence Kellogg House	contributory
	289	958 Carter	1-story brick	Prairie/ bungalow	ca. 1921-1929	residence	contributory
	290	"	1-story brick			residence	contributory
	291	944 Carter	1-story frame and stucco	Pueblo	ca. 1921-1929	residence	contributory
<u>Block 150</u>							
	292	602 Ninth	1-story frame	bungalow	ca. 1910-1921	residence	contributory
	293	616 Ninth	1-story frame	bungalow	ca. 1910-1921	residence	contributory
	294	628 Ninth	1-story frame	bungalow	ca. 1910-1921	residence	contributory
	295	632 Ninth	1-story frame	bungalow	ca. 1910-1921	residence	contributory

# IDAHO STATE UNIVERSITY NEIGHBORHOOD HISTORIC DISTRICT POCATELLO, IDAHO

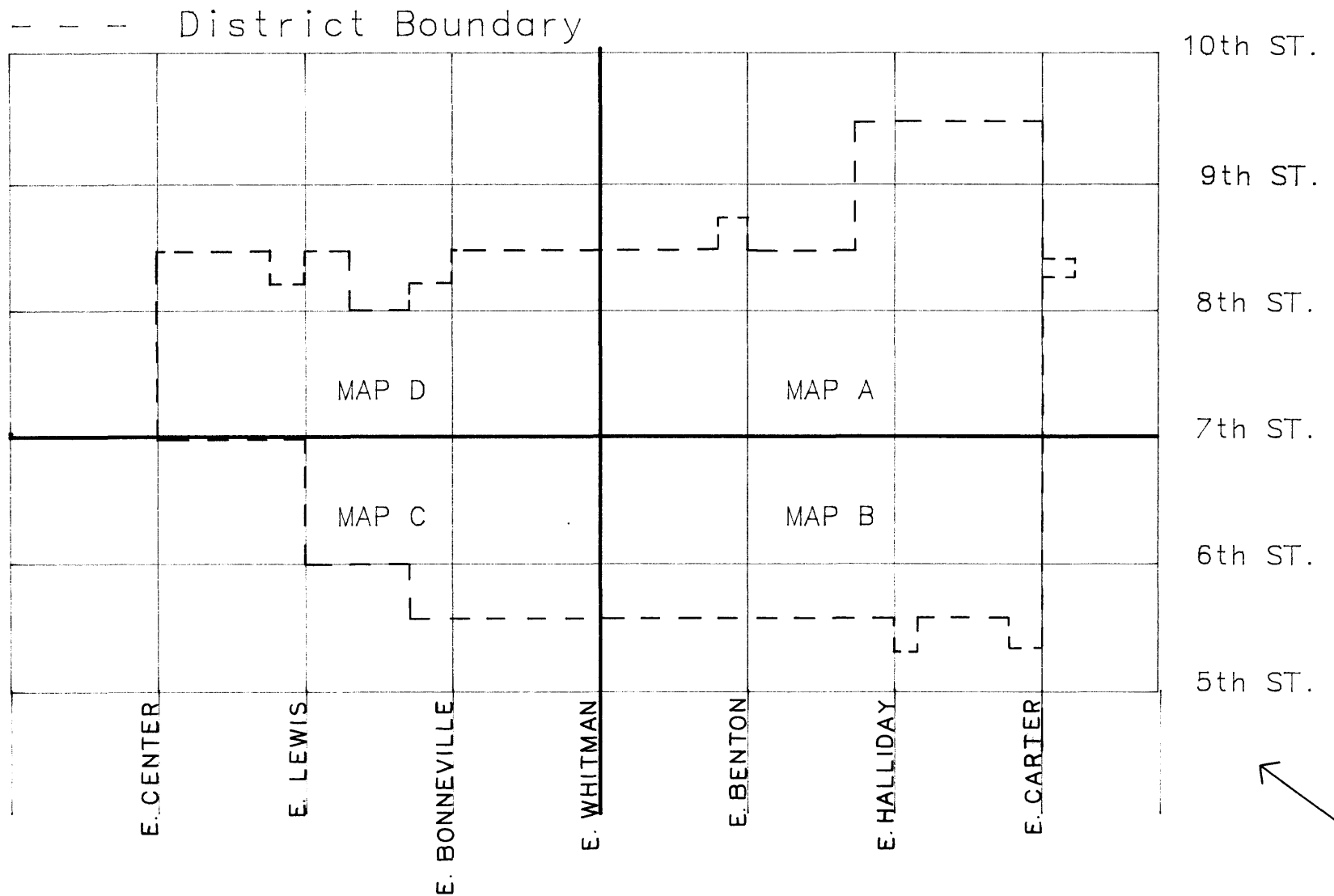



IDAHO STATE UNIVERSITY  
 NEIGHBORHOOD  
 HISTORIC DISTRICT  
 POCATELLO, IDAHO  
 MAP A

- - DISTRICT BOUNDARY
- CONTRIBUTORY
- ▨ COMPATIBLE
- ▩ NON-COMPATIBLE

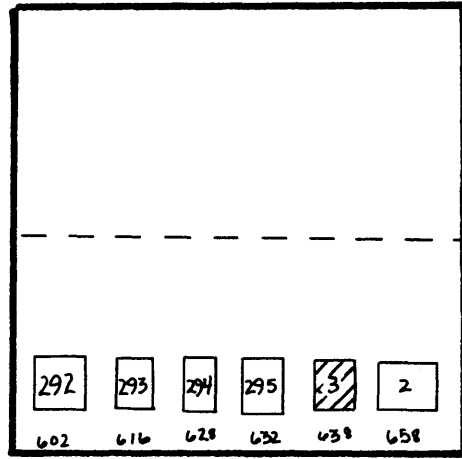
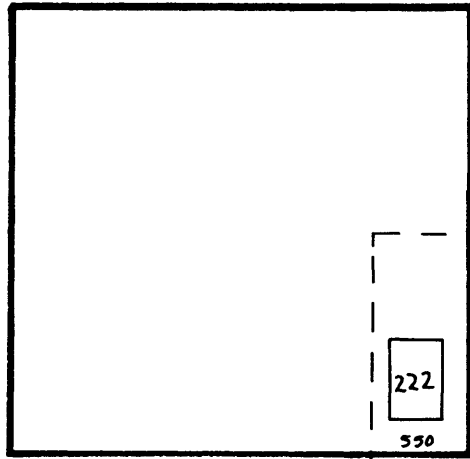
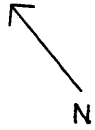

9th ST.

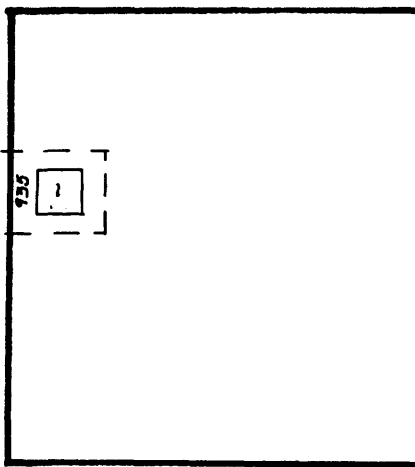
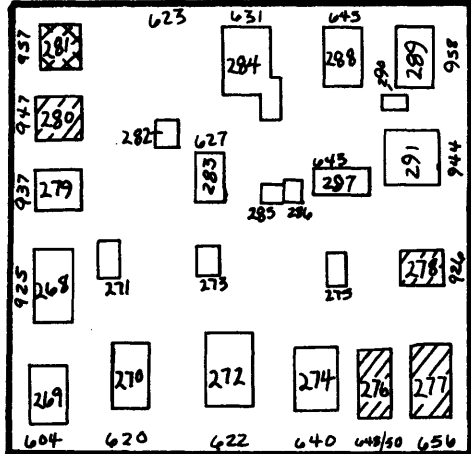
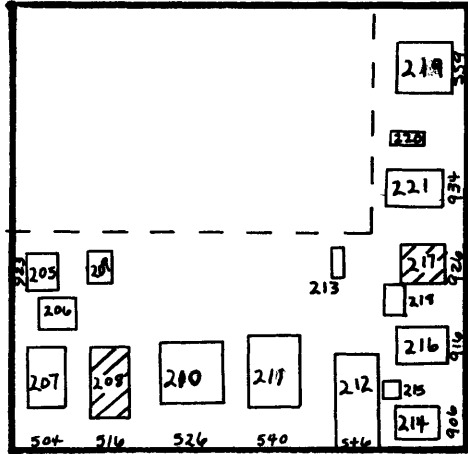
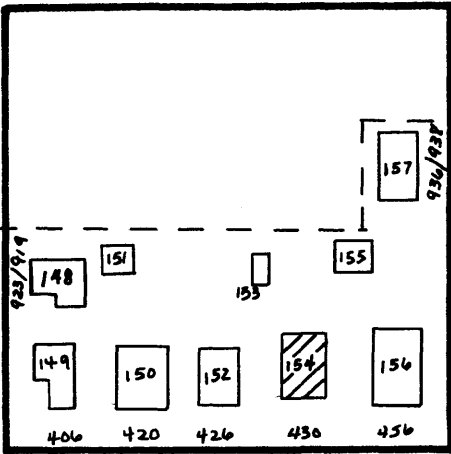

8th ST.

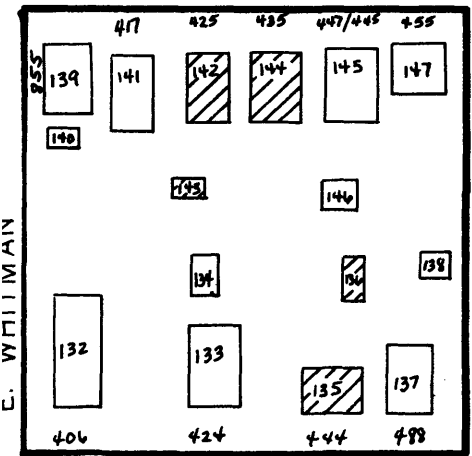

E. BENTON

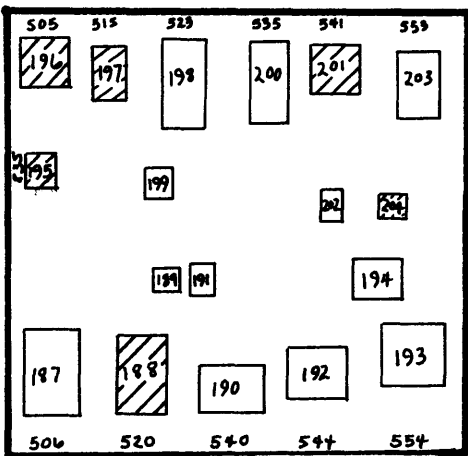

E. HALLIDAY

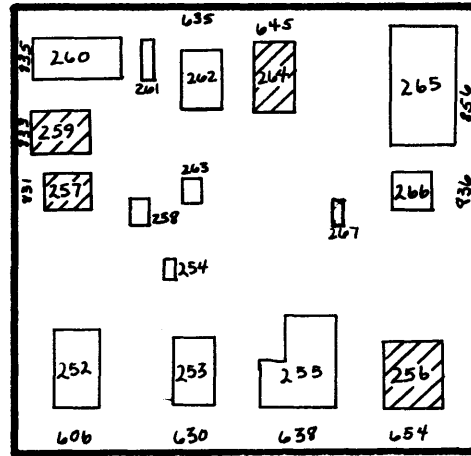

E. CARTER

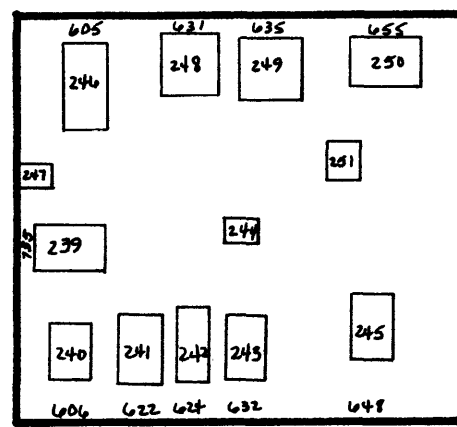
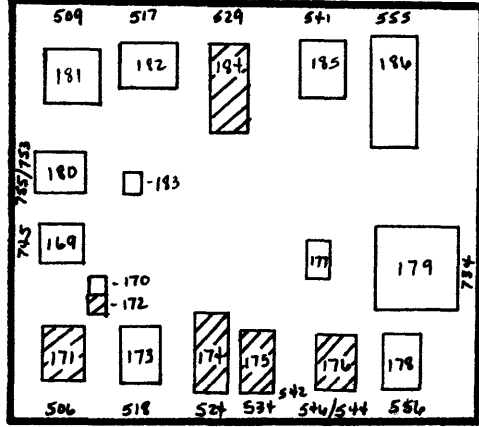
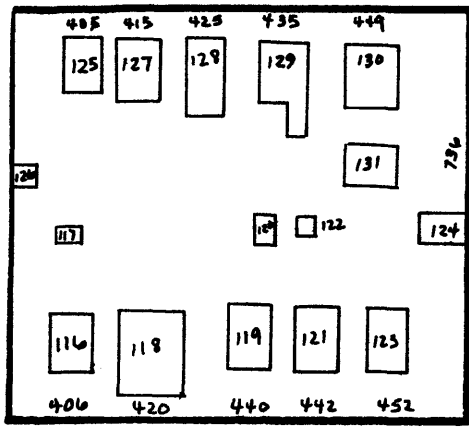

6th ST.

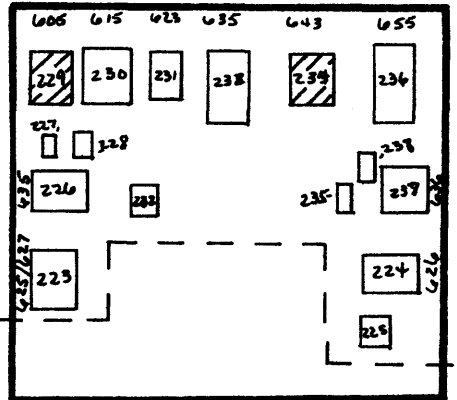
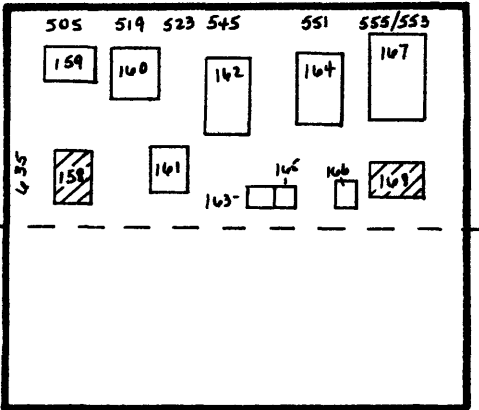
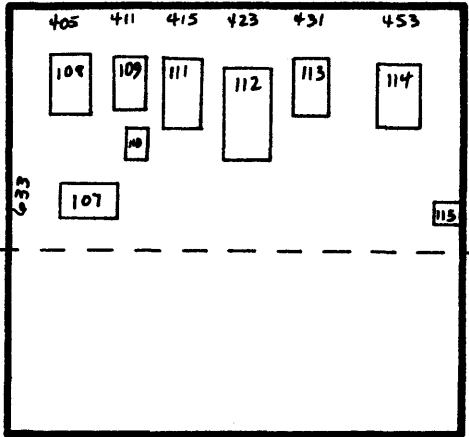

IDAHO STATE UNIVERSITY  
NEIGHBORHOOD HISTORIC DISTRICT  
POCATELLO, IDAHO  
MAP B

- DISTRICT BOUNDARY
- CONTRIBUTORY
- ▨ COMPATIBLE
- ⊠ NON-COMPATIBLE

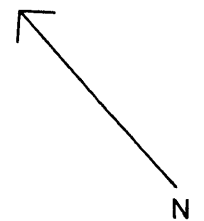

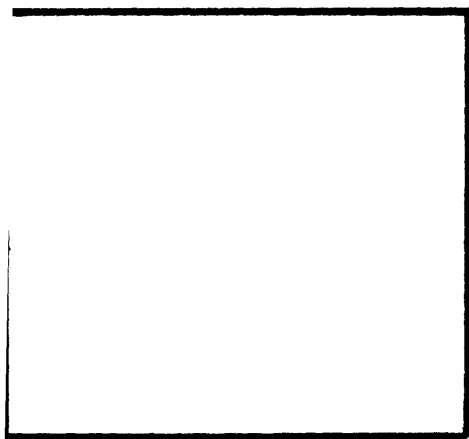

E. LEWIS

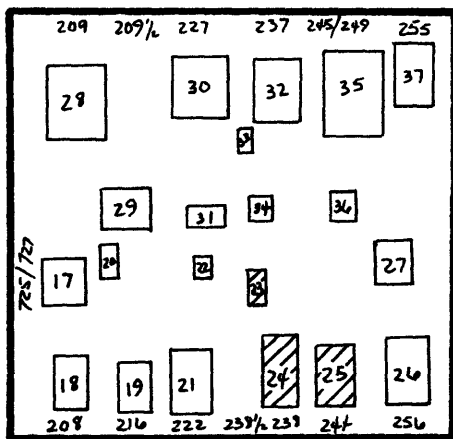

E. BONNEVILLE

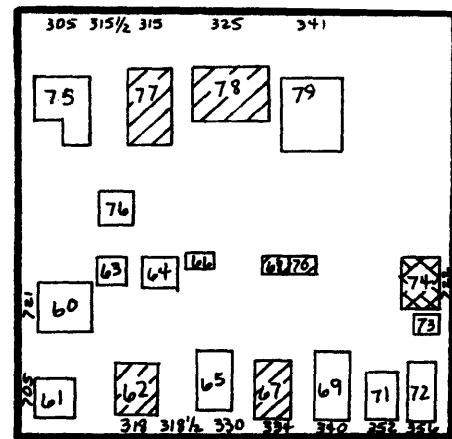

6th ST.

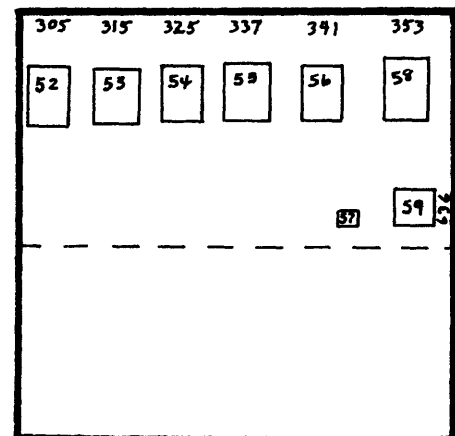
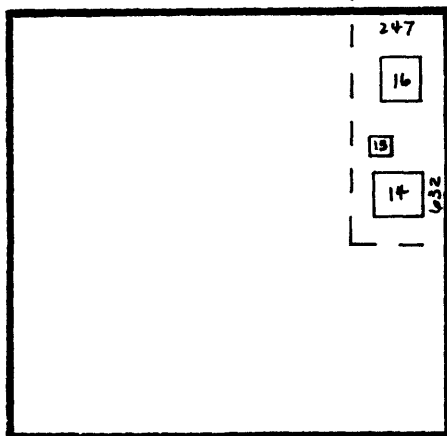

5th ST.

IDAHO STATE UNIVERSITY  
NEIGHBORHOOD HISTORIC DISTRICT  
POCATELLO, IDAHO  
MAP C

- - - DISTRICT BOUNDARY
- CONTRIBUTORY
- ▨ COMPATIBLE
- ▩ NON-COMPATIBLE



IDAHO STATE UNIVERSITY  
 NEIGHBORHOOD HISTORIC DISTRICT  
 POCA TELLO, IDAHO  
 MAP D

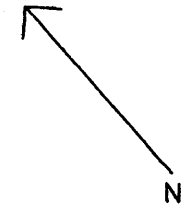

- - DISTRICT BOUNDARY
- CONTRIBUTORY
- ▨ COMPATIBLE
- ▩ NON-COMPATIBLE

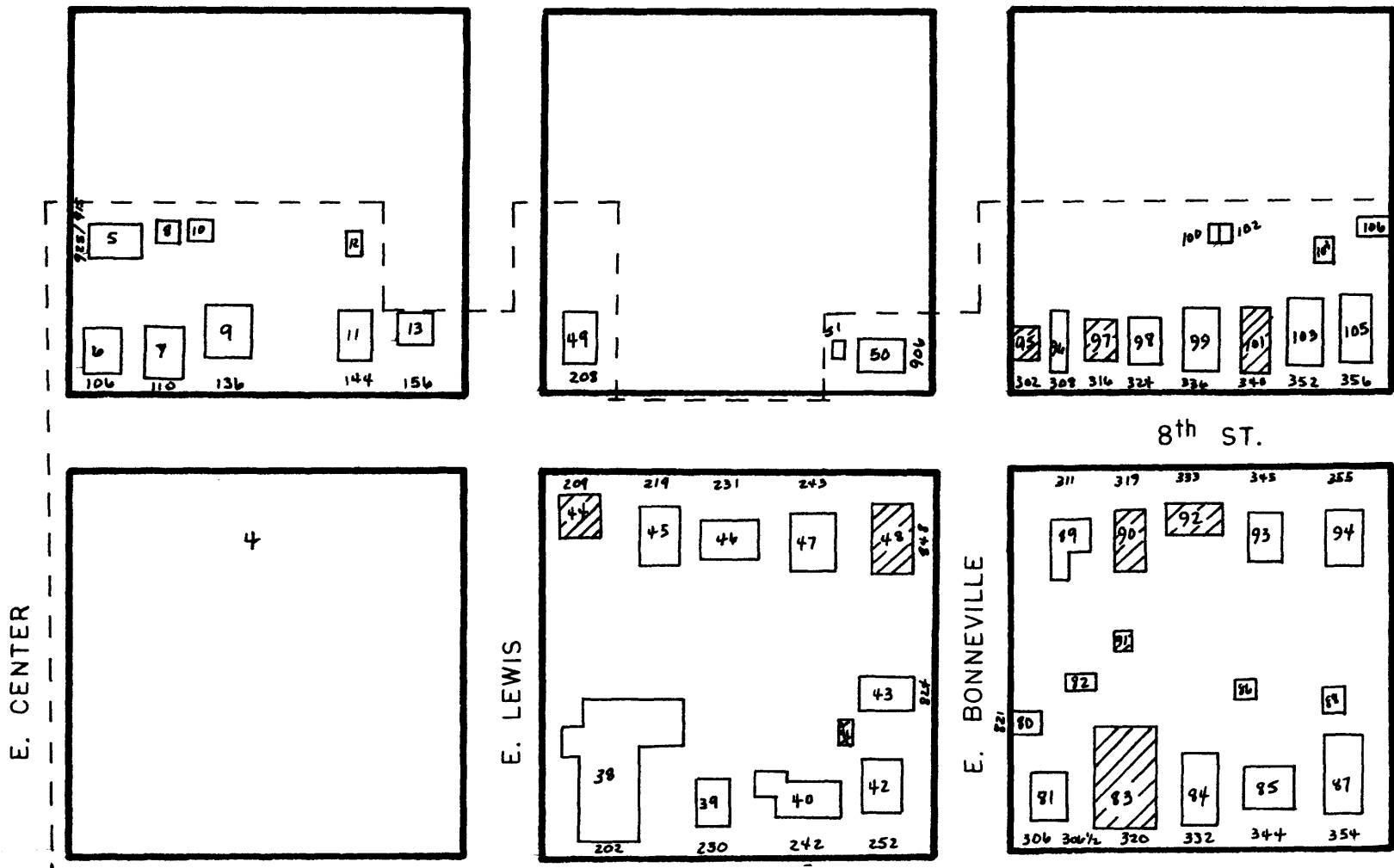

ISU Neighborhood Historic District Inventory:

# in survey	# in district nomination	address	materials and number of stories	style	date or period	historic use or name	status
Block 183							
	1	935 E Carter	1-1/2 story frame	bungalow	ca. 1910-1921	residence	contributory
Block 150							
	2	638 S Ninth	1-story frame	bungalow	ca. 1910-1921	residence	compatible
	3	658 S Ninth	1-1/2 story frame	bungalow	ca. 1910-1921	residence	contributory
Block 209							
	4				ca. 1921-1929	Caldwell Park	contributory
Block 177							
	5	925/915 E Center	1-story frame	Colonial Revival	ca. 1921-1929	residence	contributory
	6	106 S Eighth	1-story frame	Colonial Revival/ Bungalow	ca. 1921-1929	Garrett house	contributory
	7	110 S Eighth	1-story frame	"	ca. 1921-1929	"	contributory
	8	"				garage assoc. with 7	contributory
	9	136 S Eighth	1-1/2 story brick	English Cottage	ca. 1930-1934	residence Garrett house	contributory
	10	"				garage assoc. with 9	contributory

## ISU Neighborhood Historic District Inventory:

# in survey	# in district nomination	address	materials and number of stories	style	date or period	historic use or name	status
Block 177, cont.							
	11	144 S Eighth	1-story frame	Colonial Revival/ Prairie	ca. 1910-1915	residence	contributory
	12	"				garage assoc. with 11	contributory
	13	156 S Eighth	1-1/2 story brick	Colonial Revival	ca. 1910-1915	residence	contributory
Block 266							
	14	632 E Bonneville	1-story frame	Colonial Revival	ca. 1910-1915	residence	contributory
	15	"			ca. 1915-1921	residence	contributory
	16	247 S Sixth	2-story frame	Colonial Revival	ca. 1910-1915	residence	contributory
Block 236							
	17	725/727 E Lewis	1-story frame	bungalow/	ca. 1921-1929	residence	contributory
	18	208 S Sixth	1-story frame	bungalow	ca. 1921-1929	residence	contributory
	19	216 S Sixth	1-story frame	bungalow	ca. 1910-1915	residence	contributory
	20	"			ca. 1915-1921	garage assoc. with 19	contributory
	21	222 S Sixth	1-story frame	bungalow	ca. 1915-1921	residence	contributory
	22	"				garage assoc. with 21	

ISU Neighborhood Historic District Inventory:

# in survey	# in district nomination	address	materials and number of stories	style	date or period	historic use or name	status
Block 236, cont.							
	23	238/1/2 S Sixth	1-story frame		ca. 1910-1915	residence	contributory
	24	238 S Sixth	1-story frame		ca. 1910-1915	residence	compatible
	25	244 S Sixth	1/1/2 story frame	English Cottage	ca. 1915, 1930s alterations	residence	compatible
	26	256 S Sixth	1-1/2 story frame	bungalow	ca. 1915-1921	residence	significant
	27	"				garage assoc. with 26	contributory
	28	209 S Seventh	2-story frame	Queen Anne/ Colonial Revival	ca. 1900-1915	residence	significant
	29	209-1/2 S Seventh	1-1/2 story frame	Colonial Revival	ca. 1920's	unknown	contributory
	30	227 S Seventh	1-1/2 story frame	Colonial Revival	ca. 1910-1915	residence	contributory
	31	"			ca. 1915	garage assoc. with 30	contributory
	32	237 S Seventh	2-story frame	Colonial Revival	ca. 1910-1915	residence	contributory
	33	"				garage assoc. with 32	contributory
	34	"				garage assoc. with 32	contributory
	35	245/249 S Seventh	1-story frame	English Cottage		duplex	contributory

## ISU Neighborhood Historic District Inventory:

# in survey	# in district nomination	address	materials and number of stories	style	date or period	historic use or name	status
Block 236 cont.							
	36	245/249 S Seventh				garage assoc. with 35	contributory
	37	255 S Seventh	1-story frame	English Cottage	ca. 1932-1934	residence Hilliard House	contributory
Block 208							
	38	202 S Seventh	1-1/2 story	Gothic Revival	1927	First Presbyterian Church	significant
	39	230 S Seventh	1-story frame	Colonial Revival/Prairie	ca. 1929-1931	residence	contributory
	40	242 S Seventh	2-story brick	Federal Revival	ca. 1936-1939	residence Pond House	compatible
	41	"				garage assoc. with 40	non-contributory
	42	252 S Seventh	2-story brick	Colonial Revival/Italianate	ca. 1900-1915	residence	significant
	43	824 E Bonnevillie	1-story brick	Colonial Revival/bungalow	ca. 1921-1929	residence	contributory
	44	209 S Eighth	1-1/2 story stucco	Colonial Revival	ca. 1910-1915	residence	compatible
	45	219 S Eighth	1-1/2 story brick	bungalow	ca. 1929-1931	residence Elliott House	contributory
	46	231 S Eighth	2-story frame	Colonial Revival	ca. 1940-1942	residence Eisenberg House	compatible
	47	243 S Eighth	1-story brick	bungalow/Prairie	ca. 1929-1931	residence Gough House	contributory
	48	848 S Bonnevillie	1-story brick	ranch	ca. 1956-1957	residence Humphries House	compatible



ISU Neighborhood Historic District Inventory:

# in survey	# in district nomination	address	materials and number of stories	style	date or period	historic use or name	status
Block 178	49	208 S Eighth	1-story frame	Colonial Revival/ Prairie	ca. 1910-1915	residence	contributory
	50	906 E Bonneville	1-story frame	Colonial Revival	ca. 1921-1929	residence	contributory
	51	"				garage assoc. with 50	contributory
Block 265	52	305 S Sixth	1-story frame	Colonial Revival	ca. 1910-1915	residence	contributory
	53	315 S Sixth	1-story frame	Colonial Revival	ca. 1910-1915	residence	contributory
	54	325 S Sixth	1-story frame	Colonial Revival	ca. 1910-1915	residence	contributory
	55	337 S Sixth	1-1/2 story frame	bungalow	ca. 1910-1915	residence	contributory
	56	341 S Sixth	1-story frame	Colonial Revival	ca. 1910-1915	residence	contributory
	57				ca. 1915-1921	garage assoc. with 56	contributory
	58	353 S Sixth	1-1/2 story brick	Colonial Revival/ Prairie	ca. 1921-1929	residence	contributory
	59	636 E Whitman	1-1/2 story brick	English Cottage	ca. 1921-1929	residence	contributory
Block 237	60	721 E Bonneville	1-story brick		ca. 1915-1921	residence	contributory
	61	705 E Bonneville	1-story stucco		ca. 1900-1915	residence	contributory
	62	318 S Sixth	1-story frame	bungalow	ca. 1921-1929	residence	compatible

## ISU Neighborhood Historic District Inventory:

# in survey	# in district nomination	address	materials and number of stories	style	date or period	historic use or name	status
Block 237 (continued)							
	63	318 S Sixth				garage assoc. with 62	contributory
	64	318-1/2 S Sixth	1-story frame	bungalow	ca. 1930-1933	residence	contributory
	65	330 S Sixth	1-1/2 story frame	Colonial Revival/ Prairie	ca. 1910-1915	residence	contributory
	66	"			ca. 1915-1921	garage assoc. with 65	contributory
	67	334 S Sixth	1-story frame	Colonial Revival	ca. 1910-1915	residence	contributory
	68	"			ca. 1915-1921	garage assoc. with 67	compatible
	69	340 S Sixth	1-story frame	Colonial Revival	ca. 1910-1915	residence	contributory
	70	"			ca. 1915-1921	garage assoc. with 69	compatible
	71	352 S Sixth	1-story frame	Colonial Revival	ca. 1910-1915	residence	contributory
	72	356 S Sixth	1-1/2 story frame	Colonial Revival	ca. 1910-1915	residence	contributory
	73	"			ca. 1915-1921	garage assoc. with 72	contributory
	74	722 E Whitman	2-story frame & brick	Mission	ca. 1921-1929	residence	contributory
	75	305 S Seventh	1-1/2 story frame	Colonial Revival	ca. 1938-1941	residence Anderegg House	compatible
	76	315-1/2 S Seventh	1-story frame	Colonial Revival	ca. 1936-1942	residence	compatible
	77	315 S Seventh	1-story frame	Queen Anne /Col. Revival	ca. 1900-1915	residence	compatible

## ISU Neighborhood Historic District Inventory:

# in survey	# in district nomination	address	materials and number of stories	style	date or period	historic use or name	status
Block 237 (continued)							
	78	325 S Seventh	1-story brick	Moderne/ Ranch	ca. 1949-1953	residence MacKenzie House	compatible
	79	341 S Seventh	2-1/1 story brick	Federal Revival	ca. 1915-1921	residence Xavier Servel House	significant
Block 207							
	80	821 E Bonneville	1-story concrete block	Colonial Revival	ca. 1910-1915	residence	contributory
	81	306 S Seventh	1-1/2 story frame	Queen Anne/ Colonial Revival	ca. 1900-1915	residence	significant
	82	306-1/2 S Seventh	1-story frame		ca. 1900-1915	residence	contributory
	83	320 S Seventh	1-story brick	Moderne	ca. 1949-1953	residence Roberts House	compatible
	84	332 S Seventh	1-1/2 brick and stucco	Colonial Revival/ Prairie	ca. 1921-1929	residence	contributory
	85	344 S Seventh	1-story brick	English Cottage	ca. 1932-1934	residence	contributory
	86	"				garage assoc. with 85	contributory
	87	354 S Seventh	1-1/2 story brick	Mission/ Prairie	ca. 1915	residence	contributory
	88	"			ca. 1915-1921	garage assoc. with 87	contributory
	89	311 S Eighth	1-1/2 story frame	Colonial/ English Cottage	ca. 1936-1939	residence Brydon House	compatible
	90	319 S Eighth	1-story frame	bungalow	ca. 1921-1929	residence	compatible
	91	"				garage assoc. with 90	compatible

ISU Neighborhood Historic District Inventory:

# in survey	# in district nomination	address	materials and number of stories	style	date or period	historic use or name	status
Block 207 (continued)							
	92	333 S Eighth	1-story brick	Ranch	ca. 1960	residence	compatible
	93	345 S Eighth	2-story frame	Colonial Revival	ca. 1915-1921	residence	contributory
	94	355 S Eighth	1-1/2-story frame	Colonial Revival	ca. 1910-1915	residence	contributory
Block 179							
	95	302 S Eighth	1-story frame		ca. 1915-1921	residence	compatible
	95	302 S Eighth	1-story frame		ca. 1921-1929	residence	contributory
	97	316 S Eighth	1-story frame	bungalow	ca. 1921-1929	residence	compatible
	98	324 S Eighth	1-story frame	Colonial Revival	ca. 1910-1915	residence	contributory
	99	336 S Eighth	1-story frame	Colonial Revival	ca. 1910-1915	residence	contributory
	100	"	1-story frame	Colonial Revival	ca. 1921	garage assoc. with 99	contributory
	101	340 S Eighth	1-story frame		ca. 1910-1915	residence	compatible
	102	"			ca. 1915-1921	outbuilding assoc. with 101	contributory
	103	352 S Eighth	1-1/2 story frame	Colonial Revival/ bungalow	ca. 1910-1915	residence	contributory
	104					garage assoc. with 103	contributory
	105	356 S Eighth	1-story frame	Colonial Revival	ca. 1910-1915	residence	contributory
	106	"			1915 1921	garage assoc. with 105	contributory

## ISU Neighborhood Historic District Inventory:

# in survey	# in district nomination	address	materials and number of stories	style	date or period	historic use or name	status
Block 264	107	633 E Whitman	1-story frame	bungalow	ca. 1910-1915	residence	contributory
	108	405 S Sixth	1-1/2 story frame	bungalow	ca. 1910-1915	residence	contributory
	109	411 S Sixth	1-1/2 story frame	Colonial Revival	ca. 1910-1915	residence	contributory
	110	"			ca. 1915-1921	garage assoc. with 109	contributory
	111	415 S Sixth	1-story brick	bungalow	ca. 1915-1921	residence Hyde House	contributory
	112	423 S Sixth	1-story brick	Mission/Prairie	ca. 1929-1931	residence Roberts House	contributory
	113	431 S Sixth	1-1/2 story frame	Colonial Revival	ca. 1900-1915	residence	contributory
	114	453 S Sixth	1-story frame	Colonial Revival/Prairie	ca. 1910-1915	residence	contributory
	115	"			ca. 1915-1921	garage assoc. with 114	contributory
Block 238	116	406 S Sixth	1-story brick	bungalow	ca. 1915-1921	residence	contributory
	117	"			ca. 1915-1921	garage assoc. with 116	contributory
	118	420 S Sixth	2-story brick		ca. 1921-1929	Aloha Apartments	contributory
	119	440 S Sixth	1-1/2 story brick	bungalow/Prairie	ca. 1910-1915	residence	contributory
	120				ca. 1915	garage assoc. with 119	contributory
	121	442 S Sixth	1-story frame	Colonial Revival	ca. 1910-1915	residence	contributory

## ISU Neighborhood Historic District Inventory:

# in survey	# in district nomination	address	materials and number of stories	style	date or period	historic use or name	status
Block 238 (continued)							
	122	442 S Sixth				garage assoc. with 121	contributory
	123	452 S Sixth	2-story frame	Colonial Revival	ca. 1910-1915	residence	contributory
	124	"	1-story concrete block		ca. 1915-1921	garage assoc. with 123	contributory
	125	405 S Seventh	1-1/2 story frame	Dutch Colonial Revival	ca. 1910-1915	residence	significant
	126	"	1-story frame		ca. 1915	garage assoc. with 125	contributory
	127	415 S Seventh	1-story brick	Bungalow/Prairie	ca. 1921-1929	residence	contributory
	128	425 S Seventh	1-1/2 story brick	Colonial Revival/Prairie	ca. 1921-1929	residence	significant
	129	435 S Seventh	1-1/2 story brick	Colonial Revival	ca. 1921-1929	residence	significant
	130	449 S Seventh	2-1/2 story brick & frame	Colonial Revival	ca. 1910-1915	residence	contributory
	131	736 E Benton	1-1/2 story frame	Colonial Revival	ca. 1910-1915	residence	contributory
Block 206							
	132	406 S Seventh	1-story brick	Colonial/Prairie	ca. 1921-1929	residence	significant
	133	424 S Seventh	2-1/2 story frame	Colonial Revival	ca. 1910-1915	residence	significant
	134	"	1-story frame		ca. 1915-1921	garage assoc. with 133	contributory

## ISU Neighborhood Historic District Inventory:

# in survey	# in district nomination	address	materials and number of stories	style	date or period	historic use or name	status
Block 206 (continued)							
	135	444 S Seventh	1-story brick	English Cottage/ Ranch	ca. 1946-1948	residence Chase House	compatible
	137	488 S Seventh	2-1/2-story brick	Colonial Revival	ca. 1900-1915	residence Gittens House	significant
	138	"			ca. 1915-1921	garage assoc. with 137	contributory
	139	855 E Whitman	1-story frame	Colonial/ Ranch	ca. 1938-1941	residence Peterson House	compatible
	140	"				garage assoc. with 139	contributory
	141	417 S Eighth	1-story brick	bungalow/ Prairie	ca. 1921-1929	residence	contributory
	142	425 S Eighth	1-story frame		ca. 1921-1929	residence	compatible
	143	"			ca. 1915-1921	outbuilding assoc. w/142	compatible
	144	435 S Eighth	1-story frame	English Cottage	ca. 1930-1933	residence Cacavas House	compatible
	145	447/445 S Eighth	1-story brick	English Cottage	ca. 1934	residence duplex	contributory
	146	"	1-story frame			garage assoc. with 145	contributory
	147	455 S Eighth	1-story brick	bungalow/ Prairie	ca. 1921-1929	residence	contributory
Block 180							
	148	923/919 E Whitman	2-story frame	English Cottage	ca. 1936-1939	apartments	contributory
	149	406 S Eighth	1-story frame	English Cottage	ca. 1932-1934	residence Fereday House	contributory

## ISU Neighborhood Historic District Inventory:

# in survey	# in district nomination	address	materials and number of stories	style	date or period	historic use or name	status
Block 180 (continued)							
	150	420 S Eighth	1-story frame	English Cottage	ca. 1932-1934	residence Lyons House	contributory
	151	"				garage assoc. with 150	contributory
	152	426 S Eighth	1-story frame	English Cottage	ca. 1932-1934	residence Amundsen House	contributory
	153					garage assoc. with 152	contributory
	154	430 S Eighth	1-1/2 story frame	bungalow	ca. 1910-1915	residence	compatible
	155	"	1-story frame		ca. 1915	garage assoc. with 154	contributory
	156	456 S Eighth	1-1/2 story brick	English Cottage	ca. 1921-1929	residence	contributory
	157	936/938 E Benton	1-story frame	Colonial Revival	ca. 1940-1942	duplex	compatible
Block 263							
	158	635 E Benton	1-1/2 story frame	bungalow	ca. 1910-1915	residence	compatible
	159	505 S Sixth	1-1/2 story frame	bungalow	ca. 1910-1915	residence	contributory
	160	519 S Sixth	1-1/2 story frame	English Cottage	ca. 1940-1942	residence Rush House	compatible
	161	523 S Sixth	1-1/2 story frame	bungalow	ca. 1921-1929	residence	contributory
	162	545 S Sixth	1-1/2 story frame	bungalow	ca. 1915	residence	contributory
	163	"			ca. 1915	garage assoc. with 162	contributory
	164	551 S Sixth	1-1/2 story frame	bungalow	ca. 1917	residence	contributory
	165	"				outbuilding assoc. w/164	contributory



## ISU Neighborhood Historic District Inventory:

# in survey	# in district nomination	address	materials and number of stories	style	date or period	historic use or name	status
Block 180 (continued)							
	166	551 S Sixth	1-story frame		ca. 1915-1921	garage assoc. with 164 (southerly of 2 outbuildings)	contributory
	167	555/553 S Sixth	2-story concrete block and stucco	Moderne	ca. 1938-1941	apartments	compatible
	168	530 E Halliday	1-1/2 story frame	Colonial Revival	ca. 1936-1937	residence	compatible
Block 239							
	169	745 E Benton	1-story frame	bungalow	ca. 1910-1915	residence	contributory
	170	"	1-story frame			garage assoc. with 169	contributory
	171	506 S Sixth	1-1/2 story frame	bungalow	ca. 1915-1921	residence	contributory
	172	"	1-story frame		ca. 1915-1921	garage assoc. with 171	compatible
	173	518 S Sixth	1-story frame	Colonial Revival	ca. 1910-1915	residence	contributory
	174	524 S Sixth	1-1/2 story frame	bungalow	1915-1921	residence	compatible
	175	534 S Sixth	1-story frame	Prairie	ca. 1910-1915	residence	compatible
	176	546/544 S Sixth	1-story frame		ca. 1921-1929	residence	compatible
	177	542 S Sixth	1-story frame		ca. 1932-1934	residence	contributory
	178	556 S Sixth	1-1/2 story frame	bungalow	ca. 1915-1921	residence	contributory
	179	734 E Halliday	1-story frame	Colonial Revival	ca. 1921-1929	residence	contributory
	180	755/753 E Benton	1-story frame	bungalow/ Prairie	ca. 1921-1929	duplex	contributory
	181	509 S Seventh	1-1/2 story frame	Colonial Revival/ bungalow	ca. 1910-1915	residence	significant

ISU Neighborhood Historic District Inventory:

# in survey	# in district nomination	address	materials and number of stories	style	date or period	historic use or name	status
Block 239 (continued)							
	182	517 S Seventh	1-1/2 story frame	Colonial Revival/ Prairie	ca. 1910-1915	residence	significant
	183	"	1-story frame		ca. 1915-1921	outbuilding assoc. w/182	contributory
	184	529 S Seventh	1-1/2 story frame	Colonial Revival/ Prairie	ca. 1910-1915	residence	compatible
	185	541 S Seventh	1-story frame	Colonial Revival	ca. 1910-1915	residence	compatible
	186	555 S Seventh	2-story brick	Spanish Colonial/ Prairie	ca. 1921-1929	residence Peterson House	significant
Block 205							
	187	506 S Seventh	2-story frame	Colonial Revival	ca. 1929-1931	residence Stratford House	contributory
	188	520 S Seventh	1-1/2 story frame	Queen Anne/ Colonial Revival	ca. 1900-1915	residence	compatible
	189	"	1-story frame			garage assoc. with 188	contributory
	190	540 S Seventh	1-1/2 story frame	bungalow	ca. 1915	residence	contributory
	191	"	1-story frame		ca. 1915-1921	garage assoc. with 190	contributory
	192	544 S Seventh	2-1/2 story brick	Colonial Revival	ca. 1921-1929	residence McDonald House	significant
	193	554 S Seventh	2-1/2 story brick vener overtrave	Colonial Revival	ca. 1915-1921	residence Hood House	significant
	194	"	1-story frame		ca. 1915-1921	garage assoc. with 193	significant

## ISU Neighborhood Historic District Inventory:

# in district nomination	address	materials and number of stories	style	date or period	historic use or name	status
Block 205 (continued)						
195	835 E Benton	1-1/2 story frame		ca. 1949-1953	residence Harris House	compatible
196	505 S Eighth	1-1/2 story frame	English Cottage	ca. 1936-1939	residence Deaton House	compatible
197	515 S Eighth	1-story frame	bungalow	ca. 1921-1929	residence	compatible
198	523 S Eighth	1-1/2 story brick	Prairie	ca. 1921-1929	residence	significant
199	"	1-story frame			garage assoc. with 198	contributory
200	535 S Eighth	1-story frame	Colonial Revival	ca. 1915-1921	residence	contributory
201	541 S Eighth	1-1/2 story frame	Queen Anne/ Colonial Revival	ca. 1900-1915	residence	compatible
202	"	1-story frame		ca. 1915-1921	garage assoc. with 201	compatible
203	553 S Eighth	1-story brick	Colonial Revival/ Prairie	ca. 1921-1929	residence	significant
204	"	1-story frame			garage assoc. with 203	compatible
Block 181						
205	923 E Benton	1-1/2 story frame	English Cottage	ca. 1932-1934	residence Vedeler House	contributory
206	"	1-story frame			garage assoc. with 205	contributory
207	504 S Eighth	1-story frame	Colonial Revival/ bungalow	ca. 1915-1921	residence	contributory
208	516 S Eighth	1-story frame	bungalow	ca. 1910-1915	residence	compatible

## ISU Neighborhood Historic District Inventory:

	# in district nomination	address	materials and number of stories	style	date or period	historic use or name	status
Block 181 (continued)	209	516 S Eighth	1-story frame			garage assoc. with 208	contributory
	210	526 S Eighth	1-story brick	English Cottage	ca. 1929-1931	residence McLean House	contributory
	211	540 S Eighth	1-story frame	Colonial Revival	ca. 1915-1921	residence	contributory
	212	546 S Eighth	2-story frame		rear section ca. 1900-1915 front (grocery) ca. 1929-1933	residence/ Robt. G. Woods Grocery	contributory
	213	"	2-story frame rear frame, adobe filled			garage assoc. with 212	contributory
	214	906 E Halliday	1-story frame	bungalow	ca. 1921-1929	residence	contributory
	215	"	1-story frame			garage assoc. with 214	contributory
	216	916 E Halliday	1-story frame	bungalow	ca. 1921-1929	residence	contributory
	217	926 E Halliday	1-story frame			residence	compatible
	218	"	1-story frame			garage assoc. with 217	compatible
	219	559 S Ninth	1-story frame	bungalow	ca. 1910-1921	residence	contributory
	220	"	1-story frame			garage assoc. with 219	contributory
	221	934 E Halliday	1-story frame		ca. 1921	residence	contributory
Block 151	222	550 S Ninth	1-story brick	English Cottage	ca. 1932-1934	residence	contributory
Block 262	223	625/627 E Halliday	1-1/2 story frame	bungalow	ca. 1938-1941	apartments	compatible

## ISU Neighborhood Historic District Inventory:

	# in district nomination	address	materials and number of stories	style	date or period	historic use or name	status
Block 262 (continued)	224	626 E Carter	1-1/2 story frame	bungalow	ca. 1938-1941	residence	compatible
	225	"	1-story frame			garage assoc. with 224	compatible
	226	635 E Halliday	1-1/2 story frame	bungalow/ Colonial Revival	ca. 1915-1921	residence	contributory
	227		1-story frame			garage	contributory
	228		1-story frame			garage	contributory
	229	605 S Sixth	1-1/2 story frame	bungalow	ca. 1915-1921	residence	compatible
	230	615 S Sixth	2-story frame	bungalow	ca. 1915-1921	residence	contributory
	231	623 S Sixth	2-story frame	bungalow	ca. 1915-1921	residence Bond House	contributory
	232	"	1-story frame		ca. 1915-1921	garage assoc. with 231	contributory
	233	635 S Sixth	1-1/2 story frame	bungalow	ca. 1921-1929	residence	contributory
	234	643 S Sixth	1-story frame	English Cottage	ca. 1921-1929	residence	compatible
	235	"	1-story frame			garage assoc. with 234	contributory
	236	655 S Sixth	2-story frame and stucco	Colonial	ca. 1915-1921	residence	contributory
	237	636 E Carter	1-1/2 story frame and stucco	Colonial Revival/ bungalow	ca. 1929-1931	residence Ames house	contributory
	238	"	1-story frame			garage assoc. with 237	contributory
Block 240	239	735 E Halliday	2-story brick	Colonial	ca. 1929-1931	Vickrey Apartments	contributory

## ISU Neighborhood Historic District Inventory:

	# in district nomination	address	materials and number of stories	style	date or period	historic use or name	status
Block 240 (continued)							
	240	606 S Sixth	1-1/2 story brick	English Cottage	ca. 1929-1931	residence Vickrey House	contributory
	241	622 S Sixth	1-story brick	Prairie	ca. 1915-1921	residence	contributory
	242	624 S Sixth	1-story frame	bungalow	ca. 1915-1921	residence	contributory
	243	632 S Sixth	1-1/2 story concrete block	Colonial Revival/ Prairie	ca. 1910-1915	residence	significant
	244	"	1-story concrete block		ca. 1915	garage assoc. with 243	contributory
	245	648 S Sixth	1-1/2 story frame	bungalow	ca. 1907-1915	residence	contributory
	246	605 S Seventh	1-1/2 story brick	Prairie	ca. 1915	residence	contributory
	247	"	1-story brick		ca. 1915	garage assoc. with 246	contributory
	248	631 S Seventh	1-story frame	Colonial Revival	ca. 1921-1929	residence	contributory
	249	635 S Seventh	1-story frame	bungalow/ Prairie	ca. 1915-1921	residence	significant
	250	655 S Seventh	2-story brick	Prairie	ca. 1915-1921	residence	significant
	251	"	1-story brick		ca. 1915-1921	garage assoc. with 250	contributory
Block 204							
	252	606 S Seventh	1-1/2 story brick	Colonial Revival	ca. 1900-1915	residence	significant
	253	630 S Seventh	1-1/2 story frame	Colonial Revival/ Prairie	ca. 1910-1915	residence	contributory
	254	"				garage assoc. with 253	contributory

ISU Neighborhood Historic District Inventory:

	# in district nomination	address	materials and number of stories	style	date or period	historic use or name	status
Block 204 (continued)							
	255	638 S Seventh	2-story frame	Colonial Revival	ca. 1936-1939	residence Moyle House	compatible
	256	654 S Seventh	1-story frame	Colonial Revival/ bungalow	ca. 1915-1921	residence Paradice House	contributory
	257	831 E Halliday	1-story frame	bungalow	ca. 1910-1915	residence	compatible
	258	"	1-story frame		ca. 1910-1915	outbuilding assoc. w/257	contributory
	259	833 E Halliday	1-story frame		ca. 1910-1915	residence	contributory
	260	835 E Halliday	1-story frame	Colonial Revival	ca. 1910-1915	residence	compatible
	261	"				outbuilding assoc. w/260	contributory
	262	635 S Eighth	1-story frame	Colonial Revival/ bungalow	ca. 1910-1915	residence	contributory
	263	"				outbuilding assoc. w/262	contributory
	264	645 S Eighth	1-story frame		ca. 1910-1915	residence	compatible
	265	856 S Carter	2-story brick	bungalow	ca. 1915-1921	residence	contributory
	266	836 S Carter	2-story brick vener over frame	bungalow	ca. 1907-1915	residence	contributory
	267	"	1-story frame	bungalow	ca. 1915-1921	residence	contributory
Block 182							
	268	925 E Halliday	1-story brick		ca. 1932-1934	duplex	contributory
	269	604 S Eighth	1-story brick	English Cottage	ca. 1936-1937	cottage food store	compatible

## ISU Neighborhood Historic District Inventory:

	# in district nomination	address	materials and number of stories	style	date or period	historic use or name	status
Block 182 (continued)							
	270	620 S Eighth	1-1/2 story frame	Colonial Revival/ Prairie	ca. 1915-1921	residence	contributory
	271	"	1-story frame			garage assoc. with 271	contributory
	272	622 S Eighth	1-story brick	Colonial/ bungalow	ca. 1915-1921	residence	contributory
	273	"	1-story brick		ca. 1915-1921	garage assoc. with 272	contributory
	274	640 S Eighth	1-story frame	Colonial Revival/ bungalow	ca. 1921-1929	residence	contributory
	275	"	1-story frame			garage assoc. with 274	contributory
	276	648/650 S Eighth	1-story frame	Colonial Revival	ca. 1921-1929	residence	compatible
	277	656 S Eighth	1-story frame	Colonial	ca. 1921-1929	residence	compatible
	278	926 E Carter	1-story frame	bungalow	ca. 1921-1929	residence	compatible
	279	937 E Halliday	1-story frame		ca. 1921-1929	residence	contributory
	280	947 E Halliday	1-story frame		ca. 1921-1929	residence	compatible
	281	957 E Halliday	1-story frame		ca. 1921-1929	residence	non-contributory
	282	623 S Ninth	1-story frame		ca. 1910-1921	residence	contributory
	283	627 S Ninth	1-story frame	bungalow	ca. 1921-1929	residence	contributory
	284	631 S Ninth	1-1/2 story brick	English Cottage	ca. 1932-1934	residence Halladay House	contributory
	285	600 block S Ninth	1-story frame			garage	contributory
	286	600 block S Ninth	1-story frame			garage	contributory



## ISU Neighborhood Historic District Inventory:

	# in district nomination	address	materials and number of stories	style	date or period	historic use or name	status
Block 182 (continued)	287	643 S Ninth	1 story frame		ca. 1932-1934	residence	contributory
	288	645 S Ninth	1-1/2 story frame	English Cottage	ca. 1932-1934	residence Kellogg House	contributory
	289	958 E Carter	1-story brick	Prairie/ bungalow	ca. 1921-1929	residence	contributory
	290	"	1-story brick			residence	contributory
	291	944 E Carter	1-story frame and stucco	Pueblo	ca. 1921-1929	residence	contributory
Block 150	292	602 S Ninth	1-story frame	bungalow	ca. 1910-1921	residence	contributory
	293	616 S Ninth	1-story frame	bungalow	ca. 1910-1921	residence	contributory
	294	628 S Ninth	1-story frame	bungalow	ca. 1910-1921	residence	contributory
	295	632 S Ninth	1-story frame	bungalow	ca. 1910-1921	residence	contributory

Nomination: IDAHO STATE UNIVERSITY NEIGHBORHOOD HISTORIC DISTRICT

22 Sites less than fifty years old

<u>Building</u>	<u>Site Number</u>	<u>Date Built</u>	<u>Continuation Sheet No.</u>
242 S Seventh (significant)	40	ca. 1936-39	Item 7, page 6
231 S Eighth (contributory)	46	ca. 1940-42	page 6
848 E Bonneville (compatible)	48	ca. 1956-57	page 6
305 S Seventh (contributory)	75	ca. 1938-41	page 8
315 1/2 S Seventh (contributory)	76	ca. 1936-42	page 8
325 S Seventh (compatible)	78	ca. 1949-53	page 9
320 S Seventh (contributory)	83	ca. 1949-53	page 9
311 S Eighth (contributory)	89	ca. 1936-39	page 9
333 S Eighth (compatible)	92	ca. 1960	page 10
444 S Seventh (compatible)	135	ca. 1946-48	page 13
855 E Whitman (contributory)	139	ca. 1938-41	page 13
923/919 E Whitman (contributory)	148	ca. 1936-39	page 13
936/938 E Benton (contributory)	157	ca. 1940-42	page 14
519 S Sixth (contributory)	160	ca. 1940-42	page 14
555/553 S Sixth (contributory)	167	ca. 1938-41	page 15
530 E Halliday (contributory)	168	ca. 1936-37	page 15
835 E Benton (contributory)	195	ca. 1949-53	page 17
505 S Eighth (compatible)	196	ca. 1936-39	page 17
625/627 E Halliday (contributory)	223	ca. 1938-41	page 18
626 E. Carter (contributory)	224	ca. 1938-41	page 19
638 E Seventh (contributory)	255	ca. 1936-39	page 21
604 S Eighth (contributory)	269	ca. 1936-37	page 21

↑  
 Earlier identifications are noted here: one evaluated as significant and 16 evaluated as compatible have been listed in this revised inventory as compatible, along with numbers 48, 78, 92, 135, and 196 that remain unchanged.