

(Photo here)

I. #3 on map

Parish Bienville
Municipality Gibsland
U.S.G.S. Quad _____
Township _____ Range _____ Section _____
Type of Property Residence
Name (common) Smith House
Name (historic) Jones House
Address Highway 154 (Mt. Lebanon Road),
Vicinity of Gibsland
Present Owner Mr. & Mrs. Carol Smith
Address Rt. 2
Gibsland, Louisiana
Date or period of construction ca. 1840

II.

1. Good to excellent local example of a building type x.
2. Average example _____
3. Poor example _____

III. Physical description of property and historical significance

Description: Originally a log dog trot house, the building acquired its present clapboard siding and transom side-lit dog trot enclosure in about 1870. Interior paneled over but two of the original mantels survive. Present house consists of central hall double parlors and an extended rear wing.

Significance: This five-bay, central hall plan house, with plain pillars and a transom side-lighted front door, is a typical example of the simplest version of the Greek Revival when it was applied to residences in Louisiana.

Dates from about 1840. Builder unknown. From about 1900 to about 1930 it was the residence of State Senator John P. Jones, who was an important political leader in the
(over)

IV.

Recorded by Jonathan Fricker
Date June 1979
For _____ Nomination of
Architectural Resources of Mt. Lebanon

V. Sources consulted See item 9
on Nomination form

INSTRUCTIONS

1. Please write your description and statement of significance to augment, not duplicate the photograph.
2. If you checked one of the boxes in Item 2 indicating that the Property is a good, fair, or poor example of a local type, please justify your choice.
3. Please describe or mention any notable or distinguishing features (i.e. decorative details, oddities or unusual characteristics).
4. Please mention briefly how the property is historically significant on the National, State or local level.

(cont'd)

area. Mrs. Jones was related to the Egan and Colbert families who were pioneers in the area.

③

SMITH HOUSE

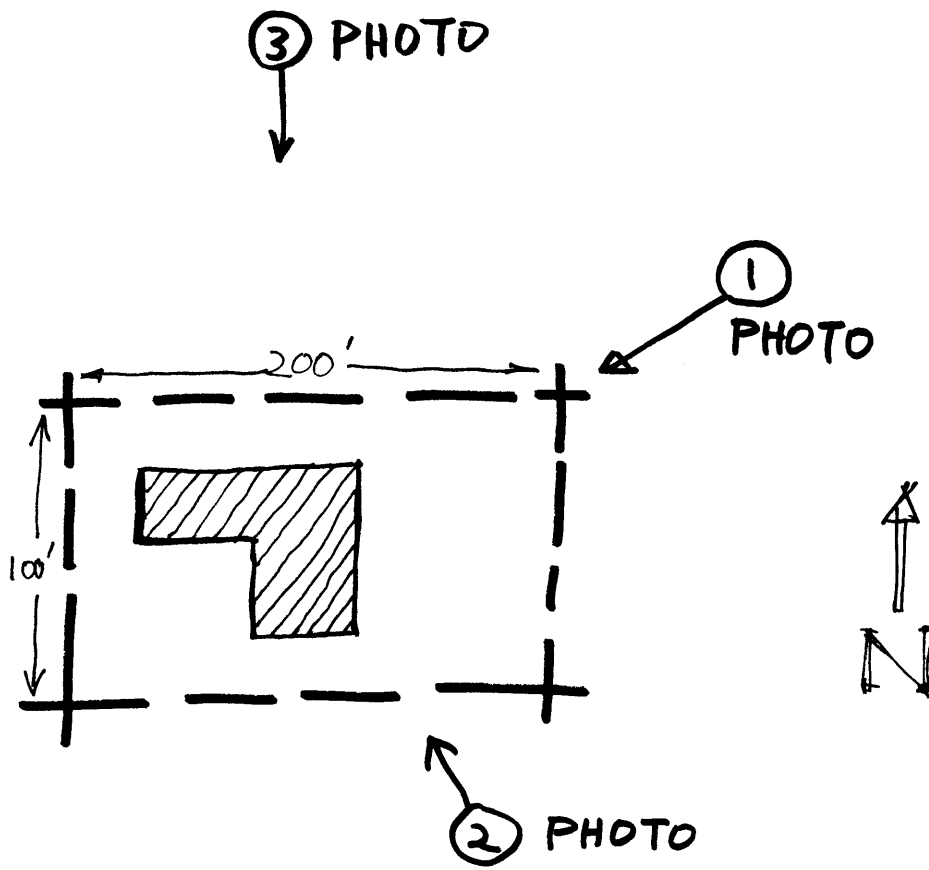

Approx 1/2 Acre

