

FORM A - AREA

MASSACHUSETTS HISTORICAL COMMISSION
 294 Washington Street, Boston, MA. 02108

Form numbers in this area	Area letter
H-20-8/9/20	519

Photo (3x3" or 3x5")
 Staple to left side of form

Photo number MP-9-13/19/31/28
26/27

Town Fall River, Mass.

Name of area (if any) Sanford Spinning Co.

Globe Mills Avenue

General date or period 1887-1920

Sketch map. Draw a general map of the area indicating properties within it. Number each property for which individual inventory forms have been completed. Label streets (including route numbers, if any) and indicate north. (Attach a separate sheet if space here is not sufficient)

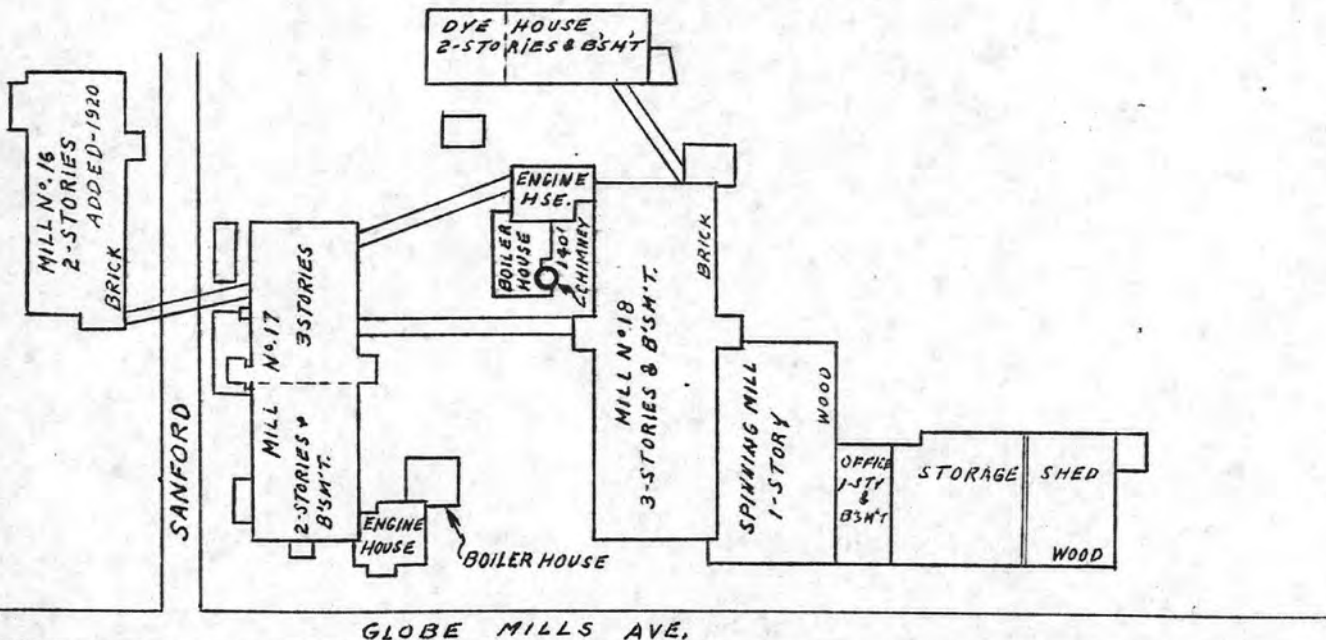

Recorded by Vielmetti/Pereira/Fox

Organization FROHP

Date 2/18/81

ARCHITECTURAL SIGNIFICANCE of area. (Describe physical setting, general character, and architecturally significant structures).

Sanford Spinning is a complex of large, low-scale late 19th and early 20th century brick mill buildings spread out over a large parcel. The mill is located in the southern "Globe Village" section close to the Taunton River and Old Colony Railroad line. Use of brick for mills in this area was common because they were economical to ship by water. Although the complex has no central focus, it is unified in material and in the use of standard features such as wide bracketed cornices, arched windows and arched T-cross 6/18 sash. The first mill (referred to as #17) of 1887 is 2 stories with attached engine and boiler houses and was constructed for the Globe Yarn Mill. It measures 100' X 355'. In 1892, Sanford Spinning built a 3-story mill (#18) measuring 315' X 100' with an attached engine house and boiler house as well as a separate 2-story dye house for finishing and dyeing the yarn. A third mill (#16) of two stories was added in 1920. The present complex also includes a one-story wooden addition for spinning, offices and storage and a 140' mill chimney.

HISTORICAL SIGNIFICANCE of area. (Explain development of area, what caused it, and how it affected community; be specific).

The Sanford Spinning Company was organized in 1891 for the manufacture of colored and fancy yarns. By that date it was profitable to produce yarn as a sole product because the spinning departments of the mills could not meet the demand. Arnold Sanford, the founder and first president, was experienced in this specialty, having served as treasurer of the Globe Yarn Mills. The company was capitalized at \$400,000 and the first officers also included Arthur H. Mason, treasurer. The firm constructed its first mill in 1892 adjacent to the Globe Yarn Mill #3. An 1893 advertisement gave the spindle capacity as 30,000 and noted that the company manufactured "novelty yarns" and specialized in "superior qualities of hosiery yarns from American and Egyptian cottons." In 1899 both Sanford Spinning and Globe Yarn Mills merged with the New England Cotton Yarn Company. In 1920 a third mill was erected on the property. In 1923, ownership was transferred to the American Cotton Fabric Co. of New Jersey and later to the Firestone Cotton Mills. The buildings are presently used for light industry. The Sanford Spinning Company is a handsome brick complex of late 19th and early 20th century industrial buildings which represent an important late 19th century secondary textile industry - the production of novelty yarns, as such it meets Criteria A and C of the National Register individually.

BIBLIOGRAPHY and/or REFERENCES

- Phillips' History of Fall River, p. 130-131
- 1893 Fall River City Directory
- 1920 Corporate Millyard Plans

United States Department of the Interior
National Park Service

National Register of Historic Places
Inventory—Nomination Form

For NPS use only
received 1/5/83
date entered

Continuation sheet

Item number

Page 8 of 10

Multiple Resource Area
Thematic Group

Name Fall River Multiple Resource Area
State MA

Nomination/Type of Review

Date/Signature

- | | | | |
|---|-------------------------------------|------------|----------------------------|
| 71. Read, Nathan, House | Substantive Review | Keeper | 2/16/83 <i>[Signature]</i> |
| | | Attest | _____ |
| 72. Ruggles Park | Entered in the
National Register | for Keeper | 2/16/83 <i>[Signature]</i> |
| | | Attest | _____ |
| 73. Sagamore Mill No. 2 | Entered in the
National Register | for Keeper | 2/16/83 <i>[Signature]</i> |
| | | Attest | _____ |
| 74. Sagamore Mills #1 and #3 | Entered in the
National Register | for Keeper | 2/16/83 <i>[Signature]</i> |
| | | Attest | _____ |
| 75. Sanford Spinning Co. | Entered in the
National Register | for Keeper | 2/16/83 <i>[Signature]</i> |
| | | Attest | _____ |
| 76. Santo Christo Church | Entered in the
National Register | for Keeper | 2/16/83 <i>[Signature]</i> |
| | | Attest | _____ |
| 77. Seaconnet Mills | Entered in the
National Register | for Keeper | 2/16/83 <i>[Signature]</i> |
| | | Attest | _____ |
| 78. Smith, John Mace, House | Entered in the
National Register | for Keeper | 2/16/83 <i>[Signature]</i> |
| | | Attest | _____ |
| 79. St. Anne's Church and Parish
Complex | Entered in the
National Register | for Keeper | 2/16/83 <i>[Signature]</i> |
| | | Attest | _____ |
| 80. St. Joseph's Church | Entered in the
National Register | for Keeper | 2/16/83 <i>[Signature]</i> |
| | | Attest | _____ |

United States Department of the Interior
National Park Service

Sanford Spinning Co. (Fall River MRA)
Bristol County
MASSACHUSETTS

Working No. 115/83-15
Fed. Reg. Date: 2-7-84
Date Due: 2/3/83 - 2/19/83
Action: ACCEPT 2/16/83
Entered in the RETURN
National Register REJECT
Federal Agency: _____

- resubmission
- nomination by person or local government
- owner objection
- appeal

Substantive Review: sample request appeal NR decision

Reviewer's comments:

Recom./Criteria _____
Reviewer _____
Discipline _____
Date _____
see continuation sheet

Nomination returned for: technical corrections cited below
 substantive reasons discussed below

1. Name

2. Location

3. Classification

Category	Ownership	Status	Present Use
	Public Acquisition	Accessible	

4. Owner of Property

5. Location of Legal Description

6. Representation in Existing Surveys

has this property been determined eligible? yes no

7. Description

Condition		Check one	Check one
<input type="checkbox"/> excellent	<input type="checkbox"/> deteriorated	<input type="checkbox"/> unaltered	<input type="checkbox"/> original site
<input type="checkbox"/> good	<input type="checkbox"/> ruins	<input type="checkbox"/> altered	<input type="checkbox"/> moved date _____
<input type="checkbox"/> fair	<input type="checkbox"/> unexposed		

Describe the present and original (if known) physical appearance

- summary paragraph
- completeness
- clarity
- alterations/integrity
- dates
- boundary selection

8. Significance

Period _____ Areas of Significance—Check and justify below

Specific dates _____ Builder/Architect _____

Statement of Significance (in one paragraph)

- _____ summary paragraph
- _____ completeness
- _____ clarity
- _____ applicable criteria
- _____ justification of areas checked
- _____ relating significance to the resource
- _____ context
- _____ relationship of integrity to significance
- _____ justification of exception
- _____ other

9. Major Bibliographical References

10. Geographical Data

Acres of nominated property _____

Quadrangle name _____

UNIT References _____

Verbal boundary description and justification _____

11. Form Prepared By

12. State Historic Preservation Officer Certification

The evaluated significance of this property within the state is:

_____ national _____ state _____ local

State Historic Preservation Officer signature _____

title _____ date _____

13. Other

- _____ Maps
- _____ Photographs
- _____ Other

Questions concerning this nomination may be directed to _____

Signed _____ Date _____ Phone: 202 272 - 3504

Comments for any item may be continued on an attached sheet



Fall River MRA, Mo

MP-9-27

Sanford Spinning

s/c view of Mill #17.

+ Mill office



Fall River MRA, Ma

MP-9-19

Sanford Spinning

SW view Dye House

NATIONAL ROOFING CO.

National



Fall River MRA, Me

MP-9-13

Sanford Spinning
n/c view Storage
Bldg.



Fall River MRA, Ma

MP-9-26

Sanford Spinning

looking south, Mill #17



GUNDY TRUCKS
AND TRAILERS, INC.
WILMINGTON, DEL.

Fall River MHA, Ma

MP-9-28

Sanford Spinning
Mill #18



Fall River MRA, Ma

MP-9-31

Sanford Spinning

Mill # 18 (east view)

Please refer to the map in the
Multiple Property Cover Sheet
for this property

Multiple Property Cover Sheet Reference Number: 64000279