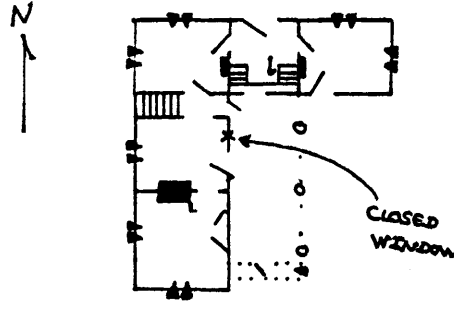

KENTUCKY HISTORIC RESOURCES INVENTORY

1. Historic Name(s) <b>Levi J. Smith House</b>		22. ADD/County <b>Lincoln Trail/Wash. 1115</b>	
Original Owner <b>Levi J. Smith</b>		23. U.S.G.S. Quadrant (15'/75') <b>St. Catherine</b> G.I.S. Mod. <input type="checkbox"/>	
2. Present Name		24. UTM Reference <b>16 654220 4173690</b>	
3. Location <b>1 mi. W. of Springfield, S. side Hwy 150</b>		Zone Easting Northing	
4. Owner's Name <b>Rogers Adams</b>		25. Coordinate Accuracy <input type="checkbox"/>	
5. Owner's Address <b>Rt. 2, Springfield, Ky. 40069</b>		26. Prehistoric Site Object Historic Site Structure <b>Building</b> Other	
6. Open to Public Yes <input type="checkbox"/> No <input checked="" type="checkbox"/>	7. Visible from road Yes <input checked="" type="checkbox"/> No <input type="checkbox"/>	8. Ownership Private <input checked="" type="checkbox"/> Local <input type="checkbox"/> State <input type="checkbox"/> Federal <input type="checkbox"/>	
9. Local Contact/Organization		27. National Register District Name: <b>N/A</b>	
10. Site Plan with North Arrow 		28. Significance Evaluation <b>NR</b> <input checked="" type="checkbox"/>	
11. Architect <b>unknown</b>		29. Status National Landmark <input type="checkbox"/> Date _____ National Register <input type="checkbox"/> _____ Landmark Certificate <input type="checkbox"/> _____ Kentucky Survey <input type="checkbox"/> _____ Local Landmark <input type="checkbox"/> _____ HABS/HAER <input type="checkbox"/> _____	
12. Builder <b>unknown</b>		30. Historic Theme Primary <b>Architecture</b> <input checked="" type="checkbox"/> Secondary <input type="checkbox"/> Other <input type="checkbox"/>	
13. Date <b>1851-1875</b> A. <input checked="" type="checkbox"/> B. <input type="checkbox"/>		31. Endangered Yes <input type="checkbox"/> No <input checked="" type="checkbox"/>	
14. Style A. <b>Gothic Rev.</b> <input checked="" type="checkbox"/> B. <input type="checkbox"/>		32. Preservation Project Status <b>N/A</b> <input type="checkbox"/>	
15. Original Use <b>Sing. fam. res.</b> <input checked="" type="checkbox"/>		Actual Cost in \$1,000s <input type="checkbox"/>	
16. Present use <b>Under repair</b>		33. ATTACH PHOTO	
17. Condition <b>Poor</b> <input checked="" type="checkbox"/>		Roll No. <b>12</b> Picture No. <b>22A-31A</b> Direction _____	
18. Description <b>3 bay, 1 1/2 story, frame, w/central gable; decorative porch and bargeboard pressed tin roof; central entrance pilastered; limestone foundation; internal brick chimneys w/a hip or flare and corbeled top; INTERIOR: central hall w/open string dog-leg stair decorated w/simple (over)</b> <small>(Continue on Back)</small>		34. Prepared by: <b>Joe DeSpain</b>	
19. History <b>Levi J. Smith began acquiring the property on which this house sits from the Literary Society of St. Catherine's of Sienna. The land was acquired in 5 tracts. Smith died in 1872 leaving everything to his only (over)</b>		35. Organization <b>Green Co. Hist. Soc., Inc.</b>	
20. Significance <b>Most substantial and developed example of Gothic Revival in Washington Co. This property is significant under</b>		36. Date <b>Jan., 1983</b>	
21. Source of Information <b>SEE OVER</b>		37. Revision Dates <b>1/87</b> 38. Staff Review	
<b>criterion C.</b>			

DESCRIPTION: (cont.) brackets; transomed and sidelighted central entrance; rounded window openings cover sidelights and windows in central door; sidelights are decorated by painting then scraping the paint as in WS-18. Mantles in all rooms similar to pilastered Greek Rev. except the mantle in the front eastern first floor. It is decorated like a mantle in Simmstown(WS-31). Pronounced architrave on windows and doors. Double window aprons downstairs. Octagonal columns on the eastern side of the ell belie an open porch which is presently enclosed. A frame and latticed springhouse sits to the southwest of the house. A circular above-ground water tank is located five feet behind the ell. It is non-contributing.

HISTORY: (cont.) daughter, Priscilla Florida Smith. Priscilla married twice, first to John O. Anderson who died leaving one son. Her second marriage was to C. C. McGill by whom she had three children. Priscilla died 16 August 1894, and a suit was later filed to settle the estate (See WC Circuit Bundle 1412). As a result of the suit, J. W. Tucker acquired the property in 1903. He sold to Dr. E. L. McIntire in 1912, who sold to Ben D. Clements in 1919. The administrators of B. D. Clements' estate sold to the present owners.

SOURCE OF INFORMATION; WC DEEDS 105/64; 62/607; 57/349  
 WC Commissioner's Deeds 3/52  
 WC Circuit Court Bundle 1412

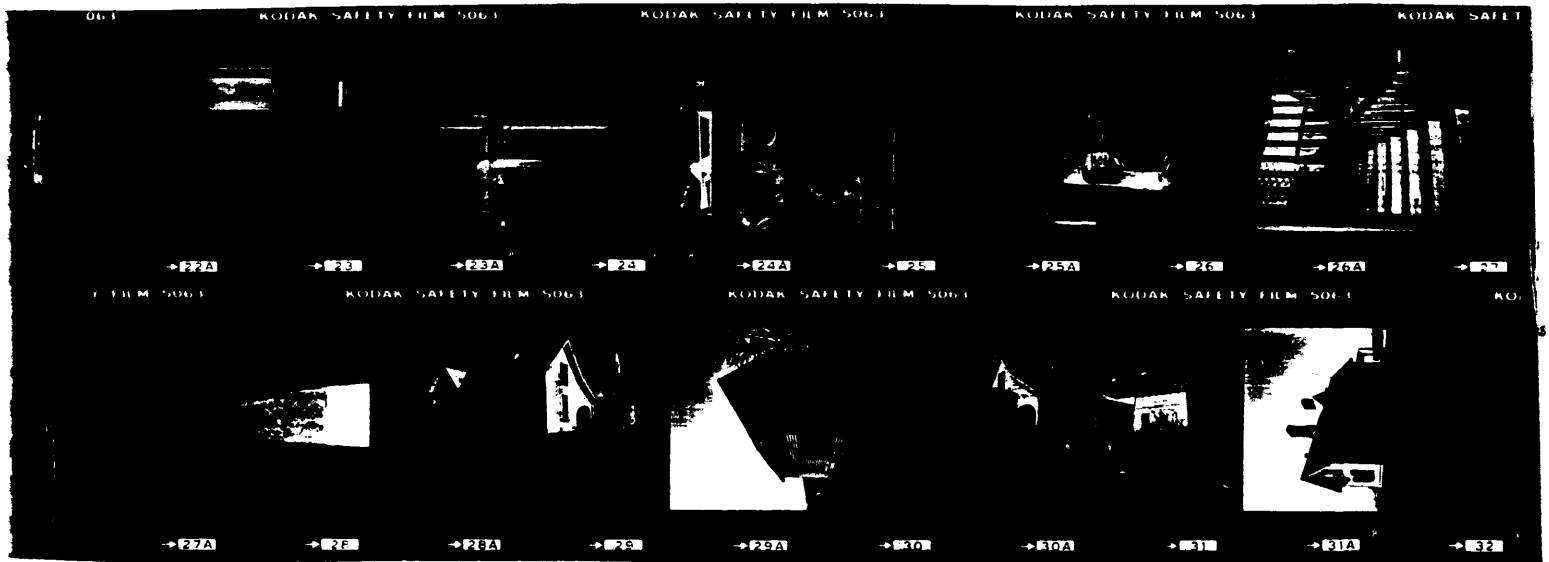

KENTUCKY HISTORIC RESOURCE INVENTORY SUPPLEMENT  
BOUNDARY AND LOCATION INFORMATION

Historic Property Name Levi J. Smith House Site # WS - 45

Multiple Resource/Thematic Nomination Title Washington County Multiple Resource Area

U.T.M. Coordinates - List multiple UTMs if property is ten or more acres.

A. 16      654220      4173690      D. \_\_\_\_\_  
 B. \_\_\_\_\_      E. \_\_\_\_\_  
 C. \_\_\_\_\_      F. \_\_\_\_\_

Verbal Boundary Description      Acreage less than 1 acre

Beginning at point A where fence line meets U.S 150, south 250 feet along fence to point B where fence aligns with drive, following west edge of drive to intersection at point C with U.S 150, west 25' with US150 to point of origin. The boundaries were drawn to include the house and domestic-related space as defined by fence, drive, and road. A contributing frame springhouse is included.

The nominated area includes two contributing buildings and one non-contributing structure.

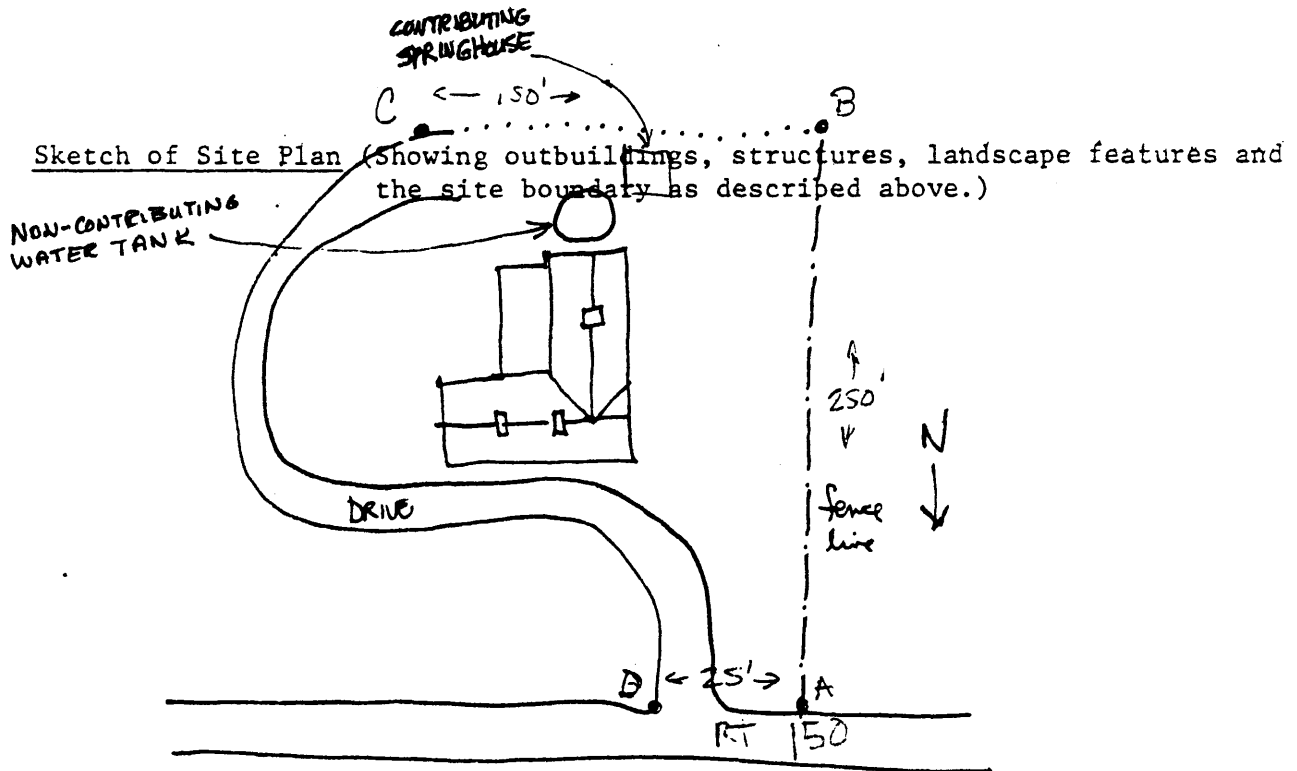

Official Courthouse Property Reference:

Washington County Courthouse, Springfield, Kentucky