

Site No.

1. Historic Name(s) William Lindsey House
 Original Owner William Lindsey
 2. Present Name
 220 W. Seminary Street
 3. Location
 220 W. Seminary Street
 4. Owner's Name
 I.J. Goodrich
 5. Owner's Address
 220 W. Seminary, Owenton, Kentucky 40359
 6. Open to Public Yes No
 7. Ownership Private Local State Federal

28. ADD/County NKADD/Owen 094
 29. U.S.G.S. Quadrant (15'/75') Owenton G.I.S. Mod.
 30. UTM Reference 16 688340 4267340
 Zone Easting Northing
 31. Coordinate Accuracy

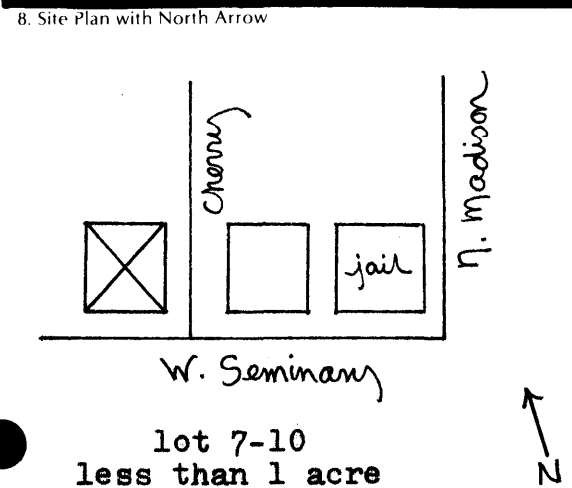

9. Architect/Builder
 10. Date c. 1880 A. B.
 11. Style eclectic
 A. eclectic B.
 12. Original Use residence
 13. Present Use residence
 14. Condition good
 15. Stories, No. of single story

32. Prehistoric Site Object Structure Other
 Historic Site Building
 33. National Register District Name:
 34. Significance of Evaluation
 35. Status _____ Date _____
 National Landmark
 National Register
 Landmark Certificate
 Kentucky Survey
 Local Landmark
 HABS/HAER
 36. Historic Theme architecture
 Primary architecture
 Secondary _____
 Other _____
 37. Endangered Yes No

16. Description Small Victorian, with decorative elements intact. 3-bay front has entry to right; door has transom. Windows are floor to ceiling 2/2 double-hung, with architrave trim. 2-bay raised porch has Ionic columns and lattice work. Small pointed-arch opening in front gable end. Small side porch to west has entrance door with transom. Cross-gable roof has modern asphalt shingles. Central brick chimney. Scalloped bargeboard present on all eaves. Frame addition at rear is one of many (over)
 (Continue on Back)

17. Single Pile _____ NA _____
 Double Pile
 18. Floor Plan T-plan
 19. Structural Fabric frame A. B.
 20. Decorative Fabric clapboard A. B.
 21. Roof Form & Material X-gable, asphalt shingle
 22. Foundation Material quarried stone
 23. Outbuildings
 24. Alterations Moved Wall Treatment Additions

38. ATTACH PHOTO
 Roll No. 2
 Picture No. 24 25
 Direction from S, from NW
 39. Prepared by: Lori A. Feldman
 40. Organization P--NKADD
 41. Date 12/83
 42. Revision Dates _____ 43. Staff Review _____

25. History William Lindsey owned the lot between 1878 and 1893. The house is present on the 1883 almanac map, and later Sanborn maps show the house with its 20th c. developments. Lindsey (over)
 26. Significance Good example of late 19th century small eclectic residence. Best example of such a house in Owenton, with all decorative elements and architectural integrity intact.
 27. Source of Information Owen County tax records; Betty Ligon; Pat Wolcott; T.A. Perry; 1883 almanac map; Sanborn maps

see photos 24 and 25

16 continued: present over the years; Sanborn maps show a variety of small frame additions, all falling within the general dimensions of present one. Porch is not present on 1903 Sanborn map (shows two small side porches instead), but was added before 1925 (per Sanborn map), probably c. 1910.

25 continued: along with E.E. Settle established the Owenton Herald in 1893, an early newspaper.