

Iowa Site Inventory

Office of Historic Preservation
Iowa State Historical Department
East 12th & Grand Avenue
Des Moines, Iowa 50319

Site Number 104
District Name _____
Map Reference # 104

Identification

- Site Name Round Barn, Pilot Grove Twp., Montgomery County
- Village/Town/City vic. Stennett Township Pilot Grove County Montgomery
- Street Address County Road H-20
- Legal Location 73 N 37 W 22 SE 1/4
Urban: subdivision block parcel subparcel
Rural: township range section 1/4 section of 1/4 section
- UTM Location: zone 15 easting 325,300 northing 4,552,390; Acreage less than one acre
- Owner(s) Name Roy and Phyllis Barr
- Owner(s) Address R. R. 2 Red Oak Iowa 51566
(Street address) (City) (State) (Zip)
- Use: Present Gen'l use barn Original Gen'l use barn

Description

- Date of Construction 1912 Architect/Builder _____
- Building Type:
 single-family dwelling industrial other institutional religious
 multiple-family dwelling educational public agricultural
 commercial
- Exterior Walls: clapboard stone brick board and batten shingles stucco
 other vertical sawed wood
- Structural System: wood frame with interlocking joints wood frame with light members (balloon frame)
 masonry load-bearing walls iron frame steel frame with curtain walls reinforced concrete
 other _____
- Condition: excellent good fair deteriorated
- Integrity: original site moved—if so, when? _____
 Notes on alterations, additions (with dates and architect, if known) and any other notable features of building and site:
See reverse side.
- Related Outbuildings and Property: barn other farm structures carriage house garage privy
 other _____
- Is the building endangered? no yes—if so, why? _____
- Surroundings of the building: open land woodland scattered outbuildings densely built-up commercial
 industrial residential other _____

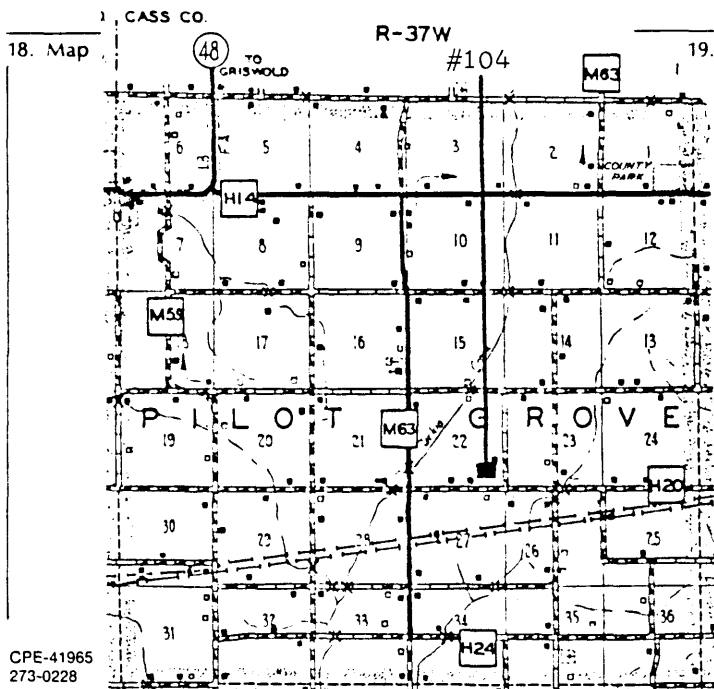

19. Photo Roll 1316 Frame 9 View _____

VBD: A circle 80' in diameter, based on center point of barn, excludes nearby detached sheds and buildings.

Significance (Indicate sources of information for all statements)

20. Architectural significance

- a. Key structure/individually may qualify for the National Register
- b. Contributing structure
- c. Not eligible/intrusion

N/A

Continuation of 14. Integrity.

Circular interior around central wood stave silo. Barn diameter 60'
Silo diameter 18' Wood shingles.

21. Historical Significance

Theme(s) True-Round; Illinois/Crouch type.

- a. Key structure/individually may qualify for the National Register
- b. Contributing structure
- c. Not eligible intrusion

The true-round form, wood frame construction, central silo, circular interior arrangement, and self-supporting single hip gambrel roof characterize this barn as an Illinois Agricultural Experiment Station / H.E. Crouch type round barn. A 1910 bulletin from the Illinois Ag. Exp. Station successfully promoted the round barn and is responsible, directly or indirectly, for influencing the design of many round barns throughout the midwest.

22. Sources (for primary and secondary sources, give complete facts of publication: author, title, place of publication, date, etc.):

Ray and Phyllis Barr, RR 2, Red Oak, IA 51566
Soike, Lowell J. Without Right Angles. Des Moines, Iowa: Iowa State Historical Department, Office of Historic Preservation, 1983.

Prepared by _____ Date _____

Address _____ Telephone _____

Organization _____

For Office of Historic Preservation Use Only

1. Office Information Sources on this Property

- County Resource File
- Windshield Survey
- National Register
- Grants-In-Aid: _____
- Determination of Eligibility

Review and Compliance Project:

- Other _____
- Other _____
- Other _____

2. Subject Traces

- a. _____
- b. _____
- c. _____
- d. _____
- e. _____

3. Photo Images _____

- _____
- _____
- _____
- _____
- _____