

HS no ATM
PH 0041483

NATIONAL REGISTER OF HISTORIC PLACES
INVENTORY - NOMINATION FORM

(Type all entries - complete applicable sections)

STATE:
Arizona

COUNTY:
Navajo

FOR NPS USE ONLY

ENTRY NUMBER	DATE
71.7.04.0009	7/14/71

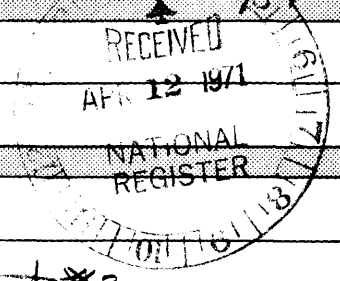

1. NAME

COMMON:
Flake Home

AND/OR HISTORIC:
James Madison Flake Home

2. LOCATION

STREET AND NUMBER:
SW corner of Stinson and Hunt Streets

CITY OR TOWN:
Snowflake Zip **85937**

STATE: **Arizona** CODE: **04** COUNTY: **Navajo** CODE: **017**

3. CLASSIFICATION

CATEGORY (Check One)	OWNERSHIP	STATUS	ACCESSIBLE TO THE PUBLIC
<input type="checkbox"/> District <input type="checkbox"/> Site <input type="checkbox"/> Object <input checked="" type="checkbox"/> Building <input type="checkbox"/> Structure	<input type="checkbox"/> Public <input checked="" type="checkbox"/> Private <input type="checkbox"/> Both	<input checked="" type="checkbox"/> Occupied <input type="checkbox"/> Unoccupied <input type="checkbox"/> Preservation work in progress <input type="checkbox"/> In Process <input type="checkbox"/> Being Considered	Yes: <input checked="" type="checkbox"/> Restricted <input type="checkbox"/> Unrestricted <input type="checkbox"/> No

PRESENT USE (Check One or More as Appropriate)

<input type="checkbox"/> Agricultural	<input type="checkbox"/> Government	<input type="checkbox"/> Park	<input type="checkbox"/> Transportation	<input type="checkbox"/> Comments
<input type="checkbox"/> Commercial	<input type="checkbox"/> Industrial	<input checked="" type="checkbox"/> Private Residence	<input type="checkbox"/> Other (Specify)	
<input type="checkbox"/> Educational	<input type="checkbox"/> Military	<input type="checkbox"/> Religious		
<input type="checkbox"/> Entertainment	<input type="checkbox"/> Museum	<input type="checkbox"/> Scientific		

4. OWNER OF PROPERTY

OWNER'S NAME:
Flake Family Estate

STREET AND NUMBER:
c/o Augusta Flake

CITY OR TOWN: **Snowflake** STATE: **Arizona** CODE: **04**

5. LOCATION OF LEGAL DESCRIPTION

COURTHOUSE, REGISTRY OF DEEDS, ETC.:
County Records, Courthouse

STREET AND NUMBER:

CITY OR TOWN: **Winslow** STATE: **Arizona** CODE: **04**

6. REPRESENTATION IN EXISTING SURVEYS

TITLE OF SURVEY:
Historic American Buildings Survey Inventory

DATE OF SURVEY: **1971** Federal State County Local

DEPOSITORY FOR SURVEY RECORDS:
Library of Congress

STREET AND NUMBER:

CITY OR TOWN: **Washington** STATE: **D. C.** CODE: **08**

SEE INSTRUCTIONS

STATE: Arizona
COUNTY: Navajo
ENTRY NUMBER: 71.7.04.0009
DATE: 7/14/71
FOR NPS USE ONLY

7. DESCRIPTION

CONDITION	(Check One)					
	<input type="checkbox"/> Excellent	<input checked="" type="checkbox"/> Good	<input type="checkbox"/> Fair	<input type="checkbox"/> Deteriorated	<input type="checkbox"/> Ruins	<input type="checkbox"/> Unexposed
	(Check One)			(Check One)		
	<input type="checkbox"/> Altered	<input checked="" type="checkbox"/> Unaltered		<input type="checkbox"/> Moved	<input checked="" type="checkbox"/> Original Site	

DESCRIBE THE PRESENT AND ORIGINAL (if known) PHYSICAL APPEARANCE

Description

Foundation sandstone

Walls are of locally made red brick. Common bond used. Windows are double hung with a single lite to each sash. Windows and doors have rounded arches of brick above them. Much elaborate brickwork below frieze and about windows. The suggestion of horse shoes is made by the brick ornamentation around the first floor windows.

The house faces east and is basically square in plan. A two story porch frames the main entry on the east facade. The porch columns of wood are solid and squarish with slight flat trimming of wood. The porch rises two stories to support a second story landing and room size "dormer" which projects from the main roof. Room dormer has hipped gable roof with wood shingle covering.

Cresting tops the ridge line.

Main roof is mansard with dormer windows. Tall wood cresting enclosed the top of main roof. Below cresting is a wide wood frieze. Below cornice of main roof is a simple wood frieze. Below frieze is elaborate brick detailing in "sawtooth" pattern. Main roof is wood shingle.

The gable portion of the room size dormer is trimmed with bargeboard. Within the pediment is a wood carving of a horse's head approximately life size.

SEE INSTRUCTIONS

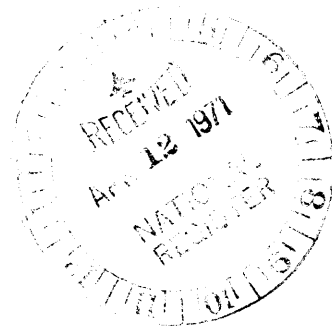

8. SIGNIFICANCE

PERIOD (Check One or More as Appropriate)

- | | | | |
|--|---------------------------------------|--|---------------------------------------|
| <input type="checkbox"/> Pre-Columbian | <input type="checkbox"/> 16th Century | <input type="checkbox"/> 18th Century | <input type="checkbox"/> 20th Century |
| <input type="checkbox"/> 15th Century | <input type="checkbox"/> 17th Century | <input checked="" type="checkbox"/> 19th Century | |

SPECIFIC DATE(S) (If Applicable and Known) **1896**

AREAS OF SIGNIFICANCE (Check One or More as Appropriate)

- | | | | |
|--|---|--|---|
| <input type="checkbox"/> Aboriginal | <input type="checkbox"/> Education | <input type="checkbox"/> Political | <input type="checkbox"/> Urban Planning |
| <input type="checkbox"/> Prehistoric | <input type="checkbox"/> Engineering | <input type="checkbox"/> Religion/Philosophy | <input checked="" type="checkbox"/> Other (Specify) |
| <input type="checkbox"/> Historic | <input type="checkbox"/> Industry | <input type="checkbox"/> Science | <u>Mormon Settlement</u> |
| <input type="checkbox"/> Agriculture | <input type="checkbox"/> Invention | <input type="checkbox"/> Sculpture | <u>in Arizona</u> |
| <input checked="" type="checkbox"/> Architecture | <input type="checkbox"/> Landscape Architecture | <input type="checkbox"/> Social/Humanitarian | _____ |
| <input type="checkbox"/> Art | <input type="checkbox"/> Literature | <input type="checkbox"/> Theater | _____ |
| <input type="checkbox"/> Commerce | <input type="checkbox"/> Military | <input type="checkbox"/> Transportation | _____ |
| <input type="checkbox"/> Communications | <input type="checkbox"/> Music | | _____ |
| <input type="checkbox"/> Conservation | | | _____ |

STATEMENT OF SIGNIFICANCE

The James M. Flake Home is one of the oldest original structures left to Snowflake; a small community established by the followers of the Church of Jesus Christ's Latter-Day Saints (Mormons). James Flake was the son of the community's founder, William J. Flake, who settled the area circa 1878. Previous to occupation by the Saints, the area was inhabited by a few Anglos and Mexicans who owned or worked scattered ranches. The arriving religious group bought up the land from the ranch owners and established Snowflake. The original site and the nominated Flake residence coincide. From this site the township was drawn up. The Saints were settling eastern Utah and Arizona from Salt Lake City as part of a program to establish LDS settlements, and, at the same time, rest stops for Mormon groups migrating from the Mid-West. The LDS movement became influential in Arizona's development. Today, many communities reflect the Saints's influence. A glance at the state map will also reveal the Mormon touch in naming such communities as St. David, St. Johns, St. Michael's and Snowflake. The Mormons also pioneered trails through Arizona in its length and breadth. A legendary example is the path of the Mormon Battalion. Snowflake is cited within Arizona's Interim Preservation Plan first edition, 1970, as a potential historic district. The Flake Home is a key structure within such a district.

SEE INSTRUCTIONS

9. MAJOR BIBLIOGRAPHICAL REFERENCES

1) Pictorial History of Snowflake - Levine
 2) Information supplied by daughter of J. M. Flake, Augusta

10. GEOGRAPHICAL DATA

LATITUDE AND LONGITUDE COORDINATES DEFINING A RECTANGLE LOCATING THE PROPERTY			O R	LATITUDE AND LONGITUDE COORDINATES DEFINING THE CENTER POINT OF A PROPERTY OF LESS THAN TEN ACRES		
CORNER	LATITUDE	LONGITUDE		LATITUDE	LONGITUDE	
	Degrees Minutes Seconds	Degrees Minutes Seconds		Degrees Minutes Seconds	Degrees Minutes Seconds	
NW	° ' "	° ' "		34 ° 30 ' 39 "	110 ° 04 ' 31 "	
NE	° ' "	° ' "				
SE	° ' "	° ' "				
SW	° ' "	° ' "				

APPROXIMATE ACREAGE OF NOMINATED PROPERTY: one

LIST ALL STATES AND COUNTIES FOR PROPERTIES OVERLAPPING STATE OR COUNTY BOUNDARIES

STATE:	CODE	COUNTY	CODE

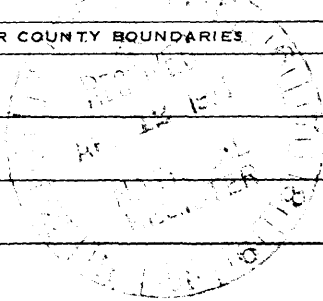

11. FORM PREPARED BY

NAME AND TITLE:
Robert Fink, Historic Sites Preservation Officer

ORGANIZATION: Arizona State Parks Board DATE: 3-24-71

STREET AND NUMBER:
1688 West Adams

CITY OR TOWN: Phoenix STATE: Arizona CODE: 04

12. STATE LIAISON OFFICER CERTIFICATION

NATIONAL REGISTER VERIFICATION

As the designated State Liaison Officer for the National Historic Preservation Act of 1966 (Public Law 89-665), I hereby nominate this property for inclusion in the National Register and certify that it has been evaluated according to the criteria and procedures set forth by the National Park Service. The recommended level of significance of this nomination is:

National State Local

Name Dennis McCarthy
 Title Direct, Arizona State Parks
 Date April 6, 1971

I hereby certify that this property is included in the National Register.

Ernest A. Connolly
 Chief, Office of Archeology and Historic Preservation

JUL 14 1971

Date _____

ATTEST:

William Pennington
 Keeper of The National Register

Date **MAY 27 1971**

SEE INSTRUCTIONS

NATIONAL REGISTER OF HISTORIC PLACES
INVENTORY - NOMINATION FORM

(Continuation Sheet)

STATE Arizona	
COUNTY Navajo	
FOR NPS USE ONLY	
ENTRY NUMBER	DATE

(Number all entries)

Map of Flake Home Locating longitude and latitude.
Scale and North Arrow as indicated.

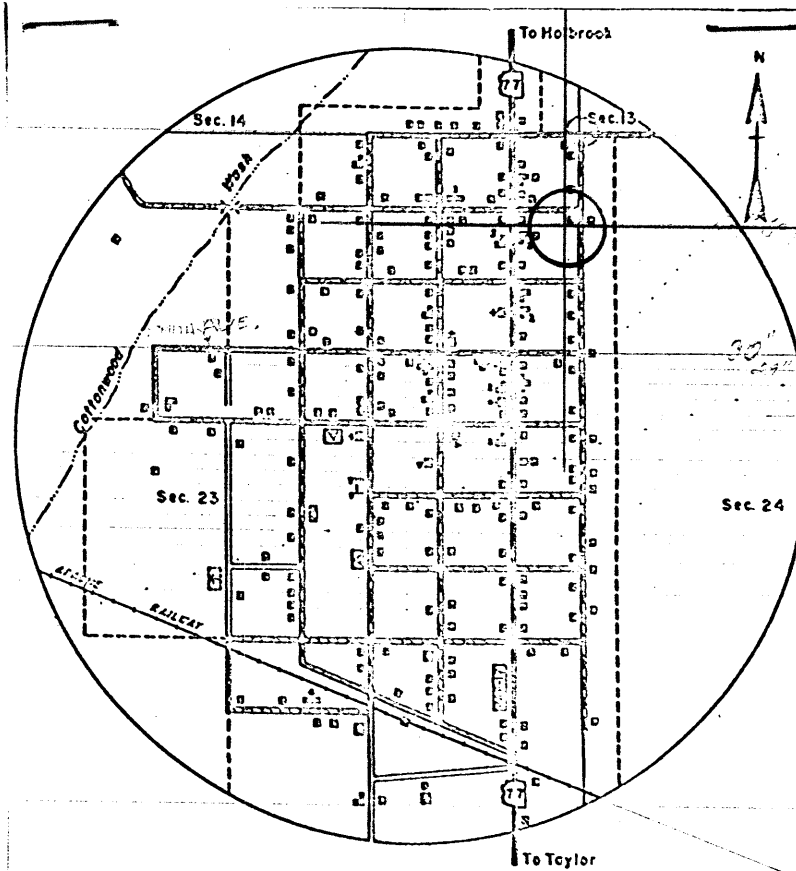

SNOWFLAKE, NAVAJO COUNTY
ARIZONA

T 13 N., R. 21 E.
SHEET 61
POP. 818

Longitude = 110°04'31"
Latitude = 34°30'39"

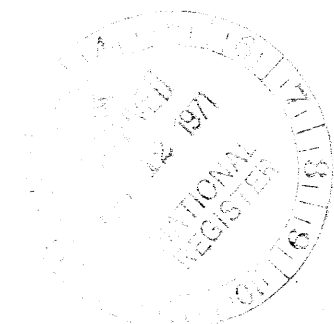
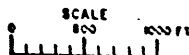

Form 10-301
(July 1969)

UNITED STATES DEPARTMENT OF THE INTERIOR
NATIONAL PARK SERVICE

**NATIONAL REGISTER OF HISTORIC PLACES
PROPERTY MAP FORM**

(Type all entries - attach to or enclose with map)

STATE Arizona	
COUNTY Navajo	
FOR NPS USE ONLY	
ENTRY NUMBER 71.7.04 0009	DATE 7/14/71

SEE INSTRUCTIONS

1. NAME			
COMMON: <u>Flake Home</u>			
AND/OR HISTORIC: <u>James M. Flake Home</u>			
2. LOCATION			
STREET AND NUMBER: <u>SW corner of Stinson and Hunt Streets</u>			
CITY OR TOWN: <u>Snowflake</u>			
STATE: <u>Arizona</u>	CODE <u>04</u>	COUNTY: <u>Navajo</u>	CODE <u>017</u>
3. MAP REFERENCE			
SOURCE: <u>Arizona Highway Department General Map</u>			
SCALE: <u>as noted</u>			
DATE: <u>1951</u>			
4. REQUIREMENTS			
TO BE INCLUDED ON ALL MAPS			
1. Property boundaries where required.			
2. North arrow.			
3. Latitude and longitude reference.			

