

NOMINATION PROPOSAL - FLORIDA

NATIONAL REGISTER OF HISTORIC PLACES

DIVISION OF ARCHIVES, HISTORY AND RECORDS MANAGEMENT - FLORIDA DEPARTMENT OF STATE

TYPE ALL ENTRIES -- COMPLETE ALL SECTIONS

1 NAME

HISTORIC Osceola Apartment Hotel (MSTR #6)

AND/OR COMMON Azure Villas

2 LOCATION

STREET & NUMBER 200 Azure Way

CITY, TOWN Miami Springs N/A VICINITY OF Miami

STATE Florida COUNTY Dade

2 CLASSIFICATION

CATEGORY	OWNERSHIP	STATUS	PRESENT USE
<input type="checkbox"/> DISTRICT	<input type="checkbox"/> PUBLIC	<input checked="" type="checkbox"/> OCCUPIED	<input type="checkbox"/> AGRICULTURE <input type="checkbox"/> MUSEUM
<input checked="" type="checkbox"/> BUILDING(S)	<input checked="" type="checkbox"/> PRIVATE	<input type="checkbox"/> UNOCCUPIED	<input type="checkbox"/> COMMERCIAL <input type="checkbox"/> PARK
<input type="checkbox"/> STRUCTURE	<input type="checkbox"/> BOTH	<input type="checkbox"/> WORK IN PROGRESS	<input type="checkbox"/> EDUCATIONAL <input type="checkbox"/> PRIVATE RESIDENCE
<input type="checkbox"/> SITE	PUBLIC ACQUISITION	ACCESSIBLE	<input type="checkbox"/> ENTERTAINMENT <input type="checkbox"/> RELIGIOUS
<input type="checkbox"/> OBJECT	<input type="checkbox"/> IN PROCESS	<input checked="" type="checkbox"/> YES: RESTRICTED	<input type="checkbox"/> GOVERNMENT <input type="checkbox"/> SCIENTIFIC
	<input type="checkbox"/> BEING CONSIDERED	<input type="checkbox"/> YES: UNRESTRICTED	<input type="checkbox"/> INDUSTRIAL <input type="checkbox"/> TRANSPORTATION
	N/A	<input type="checkbox"/> NO	<input checked="" type="checkbox"/> OTHER: Apartment

4 OWNER OF PROPERTY

NAME Dr. William J. and Lila Washuta

STREET & NUMBER P. O. Box 161687

CITY, TOWN Miami VICINITY OF STATE Florida ZIP CODE 33116

5 LOCATION OF LEGAL DESCRIPTION

COURTHOUSE, REGISTRY OF DEEDS, ETC. Dade County Courthouse

STREET & NUMBER 73 West Flagler Street

CITY, TOWN Miami STATE Florida ZIP CODE 33130

6 REPRESENTATION IN EXISTING SURVEYS

TITLE Dade County Historic Survey

DATE August 1981 FEDERAL STATE COUNTY LOCAL

DEPOSITORY FOR SURVEY RECORDS Florida Division of Archives, History and Records Management

CITY, TOWN Tallahassee STATE Florida

7 DESCRIPTION

CONDITION		CHECK ONE	CHECK ONE
<input type="checkbox"/> EXCELLENT	<input type="checkbox"/> DETERIORATED	<input type="checkbox"/> UNALTERED	<input checked="" type="checkbox"/> ORIGINAL SITE
<input checked="" type="checkbox"/> GOOD	<input type="checkbox"/> RUINS	<input checked="" type="checkbox"/> ALTERED	<input type="checkbox"/> MOVED. DATE _____
<input type="checkbox"/> FAIR	<input type="checkbox"/> UNEXPOSED		

DESCRIBE THE PRESENT AND ORIGINAL (IF KNOWN) PHYSICAL APPEARANCE

SUMMARY OF PRESENT AND ORIGINAL PHYSICAL APPEARANCE

The Osceola Apartment Hotel is a two-story Pueblo Revival apartment building constructed in early 1926 as a part of the Miami Springs development. The building is V-shaped in plan with a central interior courtyard. Construction is hollow clay tile with a rough-textured stucco exterior. The building is covered by a flat roof with an irregular parapet wall. Mission-inspired bellcote motifs enhance the parapet wall above the main entrance to the building and the central windows of the lateral wings. Fenestration is contemporary metal awnings. The main entry consists of a triple-arched opening with a pair of buttresses flanking the central portal. Each of the lateral wings contain two

TEXT SUPPORTING SUMMARY OF PRESENT AND ORIGINAL PHYSICAL APPEARANCE

entrance bays which project slightly from the main block of the building. The parapet wall of these bays is marked by a triple bellcote motif. A single-story projection is located at the termination of the two-story wings. The projections are part of the original building and reflect the influence of the Pueblo Revival style. A contemporary one-story rectangular building (non-contributing) encloses the V-shaped courtyard between the wings of the historic building.

8 SIGNIFICANCE

PERIOD		AREAS OF SIGNIFICANCE -- CHECK AND JUSTIFY BELOW			
<input type="checkbox"/> PREHISTORIC	<input type="checkbox"/> ARCHEOLOGY-PREHISTORIC	<input checked="" type="checkbox"/> COMMUNITY PLANNING	<input type="checkbox"/> LANDSCAPE ARCHITECTURE	<input type="checkbox"/> RELIGION	
<input type="checkbox"/> 1400-1499	<input type="checkbox"/> ARCHEOLOGY-HISTORIC	<input type="checkbox"/> CONSERVATION	<input type="checkbox"/> LAW	<input type="checkbox"/> SCIENCE	
<input type="checkbox"/> 1500-1599	<input type="checkbox"/> AGRICULTURE	<input type="checkbox"/> ECONOMICS	<input type="checkbox"/> LITERATURE	<input type="checkbox"/> SCULPTURE	
<input type="checkbox"/> 1600-1699	<input checked="" type="checkbox"/> ARCHITECTURE	<input type="checkbox"/> EDUCATION	<input type="checkbox"/> MILITARY	<input type="checkbox"/> SOCIAL/HUMANITARIAN	
<input type="checkbox"/> 1700-1799	<input type="checkbox"/> ART	<input type="checkbox"/> ENGINEERING	<input type="checkbox"/> MUSIC	<input type="checkbox"/> THEATER	
<input type="checkbox"/> 1800-1899	<input type="checkbox"/> COMMERCE	<input type="checkbox"/> EXPLORATION/SETTLEMENT	<input type="checkbox"/> PHILOSOPHY	<input type="checkbox"/> TRANSPORTATION	
<input checked="" type="checkbox"/> 1900-	<input type="checkbox"/> COMMUNICATIONS	<input type="checkbox"/> INDUSTRY	<input type="checkbox"/> POLITICS/GOVERNMENT	<input type="checkbox"/> OTHER (SPECIFY)	
		<input type="checkbox"/> INVENTION			

SPECIFIC DATES Circa 1926 BUILDER/ARCHITECT Curtiss & Bright, developers

SUMMARY OF STATEMENT OF SIGNIFICANCE

Constructed circa 1926, the Osceola Apartment Hotel is the only apartment building associated with the Miami Springs development. As do the other buildings included in the Miami Springs thematic group, the building reflects the influence of the Pueblo Revival style in its design and is particularly noteworthy architecturally for its undulating parapet and buttressing. Upon its completion, the Osceola was praised as one of the best appointed apartment houses in the state. Built for rental, the same residents occupied it each winter and some resided year round. The building served as a gathering point and place of shelter during the 1926 hurricane and also housed many of the builders of the Hotel Country Club.

TEXT SUPPORTING SUMMARY OF STATEMENT OF SIGNIFICANCE

In 1928 the building was owned by Mr. and Mrs. J.M. O'Conner who sold it back to the Curtiss and Bright Company. In 1936, Mr. Theodore G. Traver of Aiken, South Carolina bought the building. Mr. and Mrs. William Washuta of Miami have owned the Osceola since 1982. Although conclusive documentation is lacking, the architect of the building is thought to be Martin L. Hampton.

9 BIBLIOGRAPHICAL REFERENCES

See bibliography in cover nomination

10 GEOGRAPHICAL DATA

Site Size (Approx. Acreage of Property):

Less than 1 acre

UTM Coordinates:

1, 7 | 5, 71 | 6, 10 | 2, 8 | 5, 5 | 6, 50
ZONE EASTING NORTHING

Township	Range	Section
53	41	18-19

LOCATION SKETCH OR MAP

N

ATTACHED

VERBAL BOUNDARY DESCRIPTION

Country Club Estates Section 1, Block 81

LIST ALL STATES AND COUNTIES FOR PROPERTIES OVERLAPPING STATE OR COUNTY BOUNDARIES

STATE	CODE	COUNTY	CODE
N/A			

STATE	CODE	COUNTY	CODE
N/A			

11 FORM PREPARED BY

NAME / TITLE

Elise L. Brault-Hoessly/Michael Zimny

September 1985

ORGANIZATION

Metro-Dade County/Bureau of Historic Preservation

DATE

STREET & NUMBER

Division of Archives, History & Record Management

TELEPHONE

(904) 487-2333

CITY OR TOWN

Tallahassee

STATE

Florida

ZIP CODE

32301

AZURE

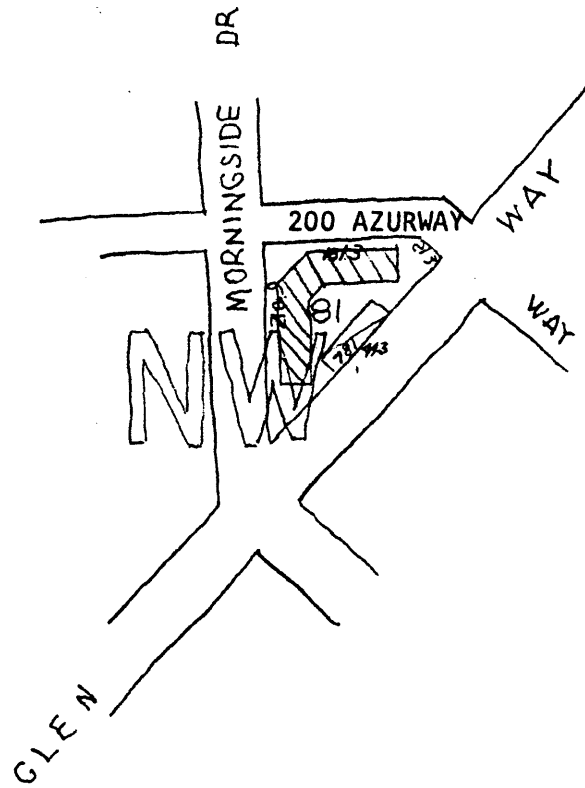

200 AZURWAY

HOPKINS LEGAL (1980)

VOLUME B PAGE 34

COUNTRY CLUB ESTATES SECTION 1, ALL BLOCK 81

AMEND 28-11.