

**United States Department of the Interior
National Park Service**

For NPS use only

**National Register of Historic Places
Inventory—Nomination Form**

received JUN 18 1984

date entered JUL 19 1984

See instructions in *How to Complete National Register Forms*
Type all entries—complete applicable sections

1. Name

historic President's Home, Northwestern State University

and or common Old President's Cottage

2. Location

street & number College Avenue, Northwestern State University N/A not for publication

city, town Natchitoches N/A vicinity of

state LA code 22 county Natchitoches Parish code 069

3. Classification

Category	Ownership	Status	Present Use
<input type="checkbox"/> district	<input checked="" type="checkbox"/> public	<input type="checkbox"/> occupied	<input type="checkbox"/> agriculture
<input checked="" type="checkbox"/> building(s)	<input type="checkbox"/> private	<input checked="" type="checkbox"/> unoccupied	<input type="checkbox"/> commercial
<input type="checkbox"/> structure	<input type="checkbox"/> both	<input type="checkbox"/> work in progress	<input type="checkbox"/> educational
<input type="checkbox"/> site	Public Acquisition	Accessible	<input type="checkbox"/> entertainment
<input type="checkbox"/> object	<u>N/A</u> in process	<input checked="" type="checkbox"/> yes: restricted	<input type="checkbox"/> government
	<u>N/A</u> being considered	<input type="checkbox"/> yes: unrestricted	<input type="checkbox"/> industrial
		<input type="checkbox"/> no	<input type="checkbox"/> military
			<input type="checkbox"/> museum
			<input type="checkbox"/> park
			<input type="checkbox"/> private residence
			<input type="checkbox"/> religious
			<input type="checkbox"/> scientific
			<input type="checkbox"/> transportation
			<input checked="" type="checkbox"/> other: unoccupied at present

4. Owner of Property

name Northwestern State University of Louisiana

street & number Office of the President 318-357-5701

city, town Natchitoches N/A vicinity of state LA 71497

5. Location of Legal Description

courthouse, registry of deeds, etc. Natchitoches Parish Courthouse

street & number Church St. (no specific address) Box 476

city, town Natchitoches state LA 71457

6. Representation in Existing Surveys

title LA Historic Sites Survey has this property been determined eligible? yes no

date 1984 federal state county local

depository for survey records LA State Historic Preservation Office

city, town Baton Rouge state LA

7. Description

Condition

excellent
 good
 fair

deteriorated
 ruins
 unexposed

Check one

unaltered
 altered

Check one

original site
 moved date N/A

Describe the present and original (if known) physical appearance

The President's Home (1927) is a rambling, two-story, brick and stucco, ersatz English manor house. It is located in a small clump of oak trees near the main entrance to the Northwestern State University campus. The house has not been altered considerably since construction and hence retains its National Register eligibility.

For the most part, the President's Home is only one room deep. It is entered via a Gothic gabled vestibule porch which leads to a central entrance and stair hall. To the east is a large parlor with a garden room beyond. To the west is a dining room with a kitchen and butler's pantry beyond. There is also a rear wing which leads to a porte-cochere.

The massing of the house is picturesque and irregular, but with horizontal lines. The exterior features an array of pointed gables, hip gables, Elizabethan multiflue chimneys, half-timbering, and cast-concrete ornamentation. Texture is added by small pane casement windows and polychromy slate shingles. Much of the blackened exterior woodwork is treated to resemble ancient adzed timbering.

The interior features paneled screens, Gothic octagonal columns, and Tudor arch mantels. The staircase has five newel posts, each of which is surmounted by a Jacobean terminus-shaped urn. The parlor features a double summer beam and joist ceiling with an unusual pastiche. The beams are cut with scalloped surfaces to exaggerate the look of old adze marks.

The only noteworthy change in the house since construction has been the installation of plywood paneling in some of the upstairs rooms. In our opinion, this change should be regarded as minor.

Adjacent to the kitchen is a contemporaneous hip-roofed brick garage. It is connected to the house by a low brick wall with ornamental gateposts. The garage is listed as a contributing element because it illustrates the use of dependencies in pretentious 1920's residences.

8. Significance

Period	Areas of Significance—Check and justify below			
<input type="checkbox"/> prehistoric	<input type="checkbox"/> archeology-prehistoric	<input type="checkbox"/> community planning	<input type="checkbox"/> landscape architecture	<input type="checkbox"/> religion
<input type="checkbox"/> 1400–1499	<input type="checkbox"/> archeology-historic	<input type="checkbox"/> conservation	<input type="checkbox"/> law	<input type="checkbox"/> science
<input type="checkbox"/> 1500–1599	<input type="checkbox"/> agriculture	<input type="checkbox"/> economics	<input type="checkbox"/> literature	<input type="checkbox"/> sculpture
<input type="checkbox"/> 1600–1699	<input checked="" type="checkbox"/> architecture	<input type="checkbox"/> education	<input type="checkbox"/> military	<input type="checkbox"/> social/ humanitarian
<input type="checkbox"/> 1700–1799	<input type="checkbox"/> art	<input type="checkbox"/> engineering	<input type="checkbox"/> music	<input type="checkbox"/> theater
<input type="checkbox"/> 1800–1899	<input type="checkbox"/> commerce	<input type="checkbox"/> exploration/settlement	<input type="checkbox"/> philosophy	<input type="checkbox"/> transportation
<input checked="" type="checkbox"/> 1900–	<input type="checkbox"/> communications	<input type="checkbox"/> industry	<input type="checkbox"/> politics/government	<input type="checkbox"/> other (specify)
		<input type="checkbox"/> invention		

Specific dates 1927 **Builder/Architect** Favrot and Livaudais (Architects)
Statement of Significance (in one paragraph) Criterion C Frank Bethune (Contractor)

The President's Home is locally significant in the area of architecture because it represents the work of an important architectural firm and because it is a landmark in the late-nineteenth/early-twentieth century architectural heritage of Natchitoches Parish.

Although no specific study has ever been done on the firm of Favrot and Livaudais, there is general agreement that it was a high style, competent, professional group of architects and that it was extremely prominent in the early-twentieth century. Practicing the historicism which was then in vogue, it grew to be perhaps the largest architectural firm in New Orleans, the state's largest, most cosmopolitan urban center. For many years Favrot and Livaudais and Emile Weil vied for business across Louisiana. It is an open question as to which of these firms ultimately had the larger practice, but there is no question that they were the two major architectural firms in early-twentieth century New Orleans. Favrot and Livaudais' best known works include the Hibernia Bank Building and the Cotton Exchange Building, both of which are landmarks in the New Orleans central business district. The firm also designed numerous public buildings, including courthouses, schools and libraries across the state.

Favrot and Livaudais is most noted for its neo-classical and Renaissance Revival buildings, styles from which it apparently seldom deviated. The President's Home is unusual, therefore, as an evocative essay in the English residential late-Gothic style. This can be seen in its irregular massing, picturesque composition, Gothic details, massive multiflue chimneys, half-timbering, multicolored slate roof, small paned windows, and blackened and artificially aged woodwork. It is an ersatz medieval manor house, an appropriate lodging for the president of a Jacobean and neo-Gothic campus.

The President's Home can also be seen as a landmark in Natchitoches Parish in a more general sense. Of the several hundred late-nineteenth/early-twentieth century buildings in the parish, most are fairly ordinary builder vernacular structures such as builder late-Italianate, builder Colonial Revival, bungalow, etc. There are also numerous humble frame buildings which do not feature any particular styling. The President's Home is conspicuous among this group because of its sophisticated and historically evocative design. It is one of very few buildings in the parish which represents the work of a high style academically trained architect. Unlike most of the contemporaneous buildings in the parish, which are essentially collections of standard manufactured details, the President's Home is consistently designed to portray a recognizable historical archetype—i.e., an English Gothic manor house. It is, therefore, one of the parish's best exemplars of the historicism which was the leading trend in American architecture during the late-nineteenth and early-twentieth centuries.

9. Major Bibliographical References

Historical sketch submitted by applicant. Copy in Register file, LA State Historic Preservation Office.
Historic Standing Structures Survey, Natchitoches Parish. On file in LA State Historic Preservation Office.
Personal communication with John Ferguson, former architectural historian with the New Orleans Historic District Landmarks Commission.

10. Geographical Data

Acreage of nominated property @ 1 1/2 acres

Quadrangle name Campti, LA

Quadrangle scale 1:62,500

UTM References

A

1	5	4	9	1	1	5	0	3	5	1	2	7	0	0
Zone			Easting					Northing						

B

Zone			Easting					Northing						

C

Zone			Easting					Northing						

D

Zone			Easting					Northing						

E

Zone			Easting					Northing						

F

Zone			Easting					Northing						

G

Zone			Easting					Northing						

H

Zone			Easting					Northing						

Verbal boundary description and justification

See Enclosed sketch map for description.

Justification: Boundary lines were drawn to discretely encompass the significant resource and its immediate surroundings. To have included all acreage under single ownership would have meant including the entire university campus.

List all states and counties for properties overlapping state or county boundaries

state	N/A	code	county	code
-------	-----	------	--------	------

state	code	county	code
-------	------	--------	------

11. Form Prepared By

ASSISTED BY: Maxine Southerland, Director

name/title National Register Staff

Center for History of Louisiana
Education, NSU
Natchitoches, LA 71497

organization Division of Historic Preservation
State of Louisiana

date March 1984

318-357-4396

street & number P. O. Box 44247

telephone 504-342-6682

city or town Baton Rouge

state LA 70804

12. State Historic Preservation Officer Certification

The evaluated significance of this property within the state is:

national state local

As the designated State Historic Preservation Officer for the National Historic Preservation Act of 1966 (Public Law 89-665), I hereby nominate this property for inclusion in the National Register and certify that it has been evaluated according to the criteria and procedures set forth by the National Park Service.

State Historic Preservation Officer signature

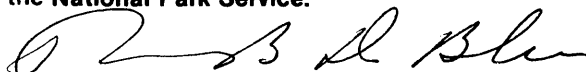

Robert B. DeBlieux

title State Historic Preservation Officer

date May 31, 1984

For NPS use only

I hereby certify that this property is included in the National Register

Entered in the
National Register

date

7/19/84

Keeper of the National Register

Attest:

date

Chief of Registration

PRESIDENT' S HOME, NATCHITOCHEs, LOUISIANA NATCHITOCHEs PARISH
NORTHWESTERN STATE UNIVERSITY

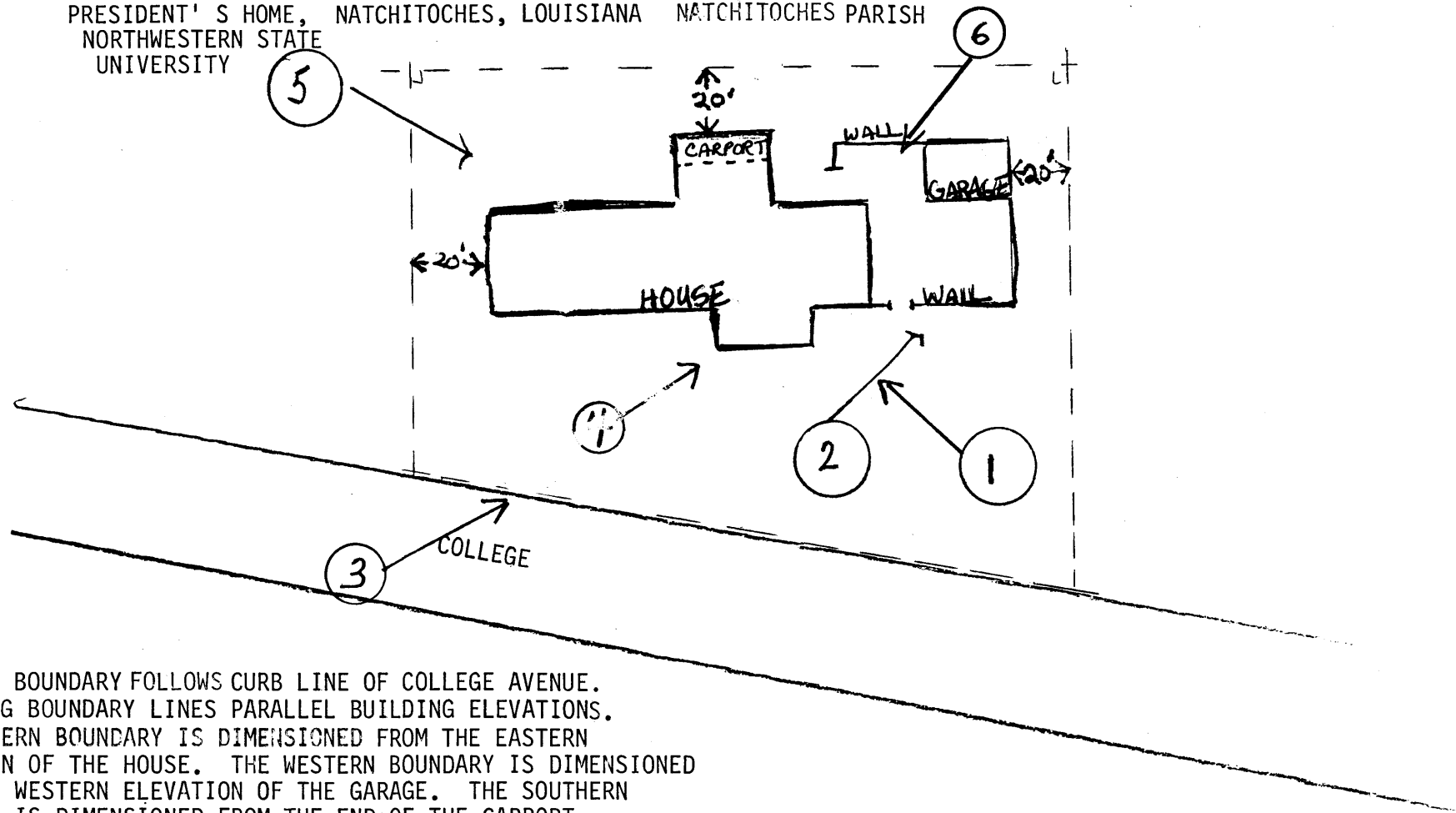

NORTHERN BOUNDARY FOLLOWS CURB LINE OF COLLEGE AVENUE.
REMAINING BOUNDARY LINES PARALLEL BUILDING ELEVATIONS.
THE EASTERN BOUNDARY IS DIMENSIONED FROM THE EASTERN
ELEVATION OF THE HOUSE. THE WESTERN BOUNDARY IS DIMENSIONED
FROM THE WESTERN ELEVATION OF THE GARAGE. THE SOUTHERN
BOUNDARY IS DIMENSIONED FROM THE END OF THE CARPORT.

NOT TO SCALE

----- boundary line

