

6. Function or Use

Historic Functions (enter categories from instructions)

INDUSTRY/ Manufacturing Facility

Current Functions (enter categories from instructions)

Industry/ Manufacturing Facility

7. Description

Architectural Classification
(enter categories from instructions)

Late 19th and 20th Century Revivals/
Classic Revivals

Materials (enter categories from instructions)

foundation Stone
walls Brick

roof Asphalt
other _____

Describe present and historic physical appearance.

8. Statement of Significance

Certifying official has considered the significance of this property in relation to other properties:

nationally statewide locally

Applicable National Register Criteria A B C D

Criteria Considerations (Exceptions) A B C D E F G

Areas of Significance (enter categories from instructions)

Industry

Period of Significance

1880-1940

Significant Dates

c. 1880, 1916,
1914-1929

Cultural Affiliation

N/A

Significant Person

N/A

Architect/Builder

N/A

State significance of property, and justify criteria, criteria considerations, and areas and periods of significance noted above.

9. Major Bibliographical References

Beers, D.G. and J. Lanagan. Map of Montgomery County, Kentucky.
Philadelphia: Beers and Lanagan, 1879.

Boyd, Carl B. and Hazel M. Boyd. A History of Mt. Sterling, Ky..
Mt. Sterling: privately printed, 1984.

Deed Books Montgomery County Courthouse.

Sanborn Insurance Maps for Mt. Sterling, Kentucky.

See continuation sheet

Previous documentation on file (NPS):

- preliminary determination of individual listing (36 CFR 67) has been requested
- previously listed in the National Register
- previously determined eligible by the National Register
- designated a National Historic Landmark
- recorded by Historic American Buildings Survey # _____
- recorded by Historic American Engineering Record # _____

Primary location of additional data:

- State historic preservation office
- Other State agency
- Federal agency
- Local government
- University
- Other

Specify repository:
Kentucky Heritage Council

10. Geographical Data

Acreeage of property .45 acre

UTM References

A
 Zone Easting Northing

C

B
 Zone Easting Northing

D

See continuation sheet

Verbal Boundary Description

See continuation sheet

Boundary Justification

See continuation sheet

11. Form Prepared By

name/title Helen Powell
 organization H. Powell & Co., Inc date 12/1/90
 street & number 2230 Idle Hour Center telephone (606) 266-5351
 city or town Lexington state Kentucky zip code 40502

United States Department of the Interior
National Park ServiceNational Register of Historic Places
Continuation SheetSection number 7 Page 1Monarch Milling Company
Mt. Sterling, Ky. MRA

Monarch Milling Company is an industrial complex in Mt. Sterling consisting of the Hay and Feed Building, flour mill, and grain elevator/ storage building. Originally the site consisted of the flour mill which was built circa 1880-1886. Over time, changes have occurred including the addition of the grain elevator/storage building in 1916 and the hay and feed building between 1914 and 1929.

Hay and Feed Building: MM-MS-262 (circa 1914-1929)

The hay and feed building also serves as the office for the mill. It is a two-story, brick building with four bays facing South Maysville Street and seven bays facing East Locust Street. The second floors of both facades are divided into bays by brick pilasters and contain a single rectangular window and wood cornice. On the corner is a single angled bay contained in an arched doorway with spaces for sidelights and transom around the single door.

On the first floor facing South Maysville Street, one bay contains single window capped with a flat hood molding and brackets, two double windows capped with the same hood molding and one doorway containing double-leaf doors, with a transom, and the hood molding. The first floor facing East Locust Street has one single and one doubled window with the same treatment as found on South Maysville, two vehicular entrances, and three unornamented utilitarian windows.

Most of the changes to the building have occurred around the window and doorway. Part of the transom has been filled in on the entry at the corner of South Maysville and Locust and the 2/2 glazing in the doubled windows on the S. Maysville side have been replaced with multiple panes.

Although the shed roof of what was an open breezeway joining the hay and feed building to the flour mill has been in place since 1929, the brick walls enclosing it have been added since 1940. The modern building to the south of the hay and feed building is not associated with the mill and was built after 1929.

Flour Mill: MM-MS-262 A (circa 1880-1886)

The flour mill was the first building built by the milling company on the site. It is a three-story, brick, flat-roofed building. Prior to 1940 the brick walls on the south and west sides were stuccoed with unpainted cement. The main block of the building has three bays separated by brick pilasters. Windows are 6/6 and are segmentally arched.

The entrance to the flour mill contains a double leaf door with a segmentally arched transom. Attached to the flour mill on the south side is a one-story, two-bay building with a flat roof which was labeled "office" on the 1886 Sanborn map. This part of

United States Department of the Interior
National Park ServiceNational Register of Historic Places
Continuation SheetSection number 7 Page 2Monarch Milling Company
Mt. Sterling, Ky. MRA

the building became the engine room in 1908 after a new office was added to the Locust Street frontage. East of the original office is a three-bay, one-story brick building which is also shown on the 1886 Sanborn map and houses the 60 horsepower coal-fired engine which ran the mill. A wood platform which is no longer standing connected the flour mill with the office.

The first floor on the East Locust Street frontage has a projection on the east side which covers two bays of the main block of the building and has 2/2 windows capped by stone lintels. It was added between 1895 and 1901 and is labeled as the office on the 1901 Sanborn map. The former office on the south side of the building became an oil room and storage.

Grain Elevator and Warehouse: MM-MS-262 B (circa 1886-1890)

South of the flour mill building is a metal clad building composed of a shed-roofed three story section and two-story gable-roofed section. The three-story section is labeled as grain elevator and the two story section as warehouse on the 1890 sanborn map.

Setting Evolution

In 1895, a metal covering was added to the north wall of the elevator and in 1914 the metal covering is shown on all of the walls of the elevator/ warehouse building.

South of this building and unconnected to was a frame flour, salt, and sugar warehouse which owned by the Trimble Brothers Wholesale Grocery. The Trimble Brothers warehouse was removed by 1914.

In 1886, the property between the flour mill and the corner of Maysville and Locust was occupied by one-story frame buildings housing a cobbler, blacksmith, and wood shop. These buildings remained on the corner until 1908 when the McDonald Brothers Coal and Feed Company built a frame complex on the corner. The coal and feed company was gone by 1914.

United States Department of the Interior
National Park Service

National Register of Historic Places
Continuation Sheet

Section number 8 Page 1

Monarch Milling Company
Mt. Sterling, Ky. MRA

The Monarch Milling Company located in Mt. Sterling Kentucky is significant under criterion A as the only extant example of the processing industries established in Mt. Sterling in the late nineteenth century. It is an example of the historic context Industry and Transportation in Mt. Sterling, 1870-1940. Processing industries rose in importance for Mt. Sterling after the town became the railhead of the Elizabethtown, Lexington, and Big Sandy Railroad in 1872. The complex is composed of three buildings and demonstrates how the industrial facility grew over a fifty year period while remaining a vital local business. The flour mill first appears on the Sanborn Insurance Maps in 1886 and the hay and feed building was in place by 1929.

The site is an example of the mill property type in the historical context Industry and Transportation in Mt. Sterling 1780-1940. It meets the property type's registration requirements because it possesses integrity of location through its relationship to the railroad. For integrity of design, the porch additions and changes to windows have not obscured the forms of the buildings and their relationship to one another. The change in exterior fabric through the addition of pressed metal, is an historic alteration and was made on many mills during the period.

In the 1880's the Mt. Sterling Roller Mills was established by Badger, Henry, and Co. on East Locust Street north of the railroad. By 1892, the firm's name was changed to Monarch Milling Company and the owner was C.H. Petry. The products made in the mill included Monarch, Crown, and Anchor flours. In 1906, the mill claimed to have the largest gasoline engines in the state running the grinding. In 1916, the mill began to use trucks for deliveries.

United States Department of the Interior
National Park Service

National Register of Historic Places
Continuation Sheet

Section number 10 Page 1

Monarch Milling Company
Mt. Sterling, Ky. MRA

Acreage of Property: .45 acre

UTM References

<u>Zone</u>	<u>Easting</u>	<u>Northing</u>
16	241920	4215800

Verbal Boundary

Starting at the southeast corner of the intersection of East locust and South Maysville, then 200 feet east along the south right of way of East Locust to a point; then south 150 feet to a point; then west 60 feet to a point; then north 90 feet to a point; then west 140 feet to a point in the east right of way of South Maysville; then north 60 feet along the east right of way of South Maysville to the point of beginning.

Boundary Justification

The boundary contains all of the historic elements which are associated with the mill site. The boundary excludes the parking lots and vacant lots to the west, north, and east. It excludes the modern building not associated with the mill to the south and the vacant lots east of the modern building. The boundary contains three contributing buildings.

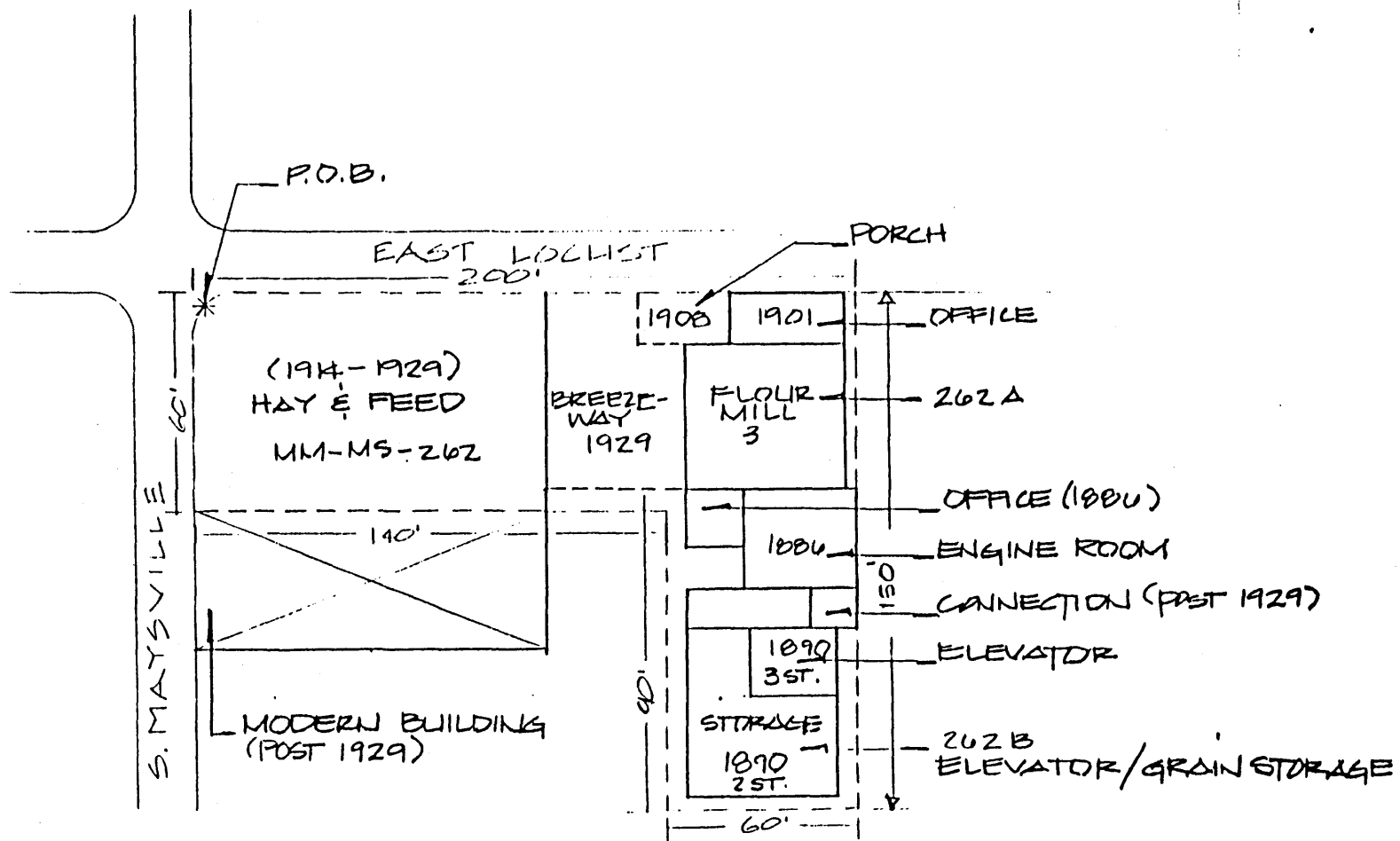

MONARCH MILL

1" = 50'

Mount Sterling, Kentucky, MRA

Montgomery Co.

United States Department of the Interior
National Park Service

**National Register of Historic Places
Continuation Sheet**

Monarch Milling Company
Mt. Sterling, Kentucky, MRA

Section number PHOTOS Page 1

For All Photos:

Property Location: Southeast corner of South Maysville and East Locust
Mount Sterling, Montgomery County, Kentucky
Photographer: Helen Powell
Negative Location: Kentucky Heritage Council
Frankfort, Kentucky
Date Taken: 1990

Photo No.

- 1 North and west facades of Hay and Feed Portion,
view to southeast
- 2 Three-story portion is ca. 1880 flour mill; in front is 1901
office; view to southeast
- 3 From left to right: 1890 storage building; 1890 elevator; 1886
engine room; three-story flour mill; view to northwest