

PH0012335

NATIONAL REGISTER OF HISTORIC PLACES  
INVENTORY - NOMINATION FORM

(Type all entries - complete applicable sections)

STATE: Florida	
COUNTY: Leon	
FOR NPS USE ONLY	
ENTRY NUMBER	DATE
JUN 30 1972	

42  
175

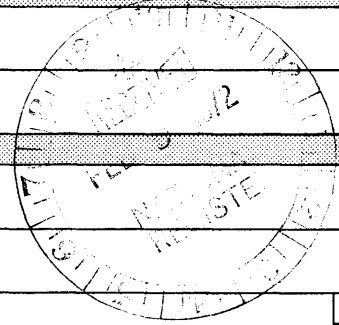

**1. NAME**

COMMON:  
Goodwood

AND/OR HISTORIC:  
The Old Croom Mansion

**2. LOCATION**

STREET AND NUMBER:  
1500 Miccosukee Road

CITY OR TOWN:  
Tallahassee

STATE: Florida      CODE: 12      COUNTY: Leon      CODE: 073

**3. CLASSIFICATION**

CATEGORY (Check One)	OWNERSHIP	STATUS	ACCESSIBLE TO THE PUBLIC
<input type="checkbox"/> District <input checked="" type="checkbox"/> Building <input type="checkbox"/> Site <input type="checkbox"/> Structure <input type="checkbox"/> Object	<input type="checkbox"/> Public <input checked="" type="checkbox"/> Private <input type="checkbox"/> Both	Public Acquisition: <input type="checkbox"/> In Process <input type="checkbox"/> Being Considered	<input checked="" type="checkbox"/> Occupied <input type="checkbox"/> Unoccupied <input type="checkbox"/> Preservation work in progress
PRESENT USE (Check One or More as Appropriate)			
<input type="checkbox"/> Agricultural <input type="checkbox"/> Commercial <input type="checkbox"/> Educational <input type="checkbox"/> Entertainment	<input type="checkbox"/> Government <input type="checkbox"/> Industrial <input type="checkbox"/> Military <input type="checkbox"/> Museum	<input type="checkbox"/> Park <input checked="" type="checkbox"/> Private Residence <input type="checkbox"/> Religious <input type="checkbox"/> Scientific	<input type="checkbox"/> Transportation <input type="checkbox"/> Other (Specify) _____ _____ _____

**4. OWNER OF PROPERTY**

OWNER'S NAME:  
Mr. & Mrs. Thomas Hood

STREET AND NUMBER:  
1500 Miccosukee Road

CITY OR TOWN: Tallahassee      STATE: Florida      CODE: 12

**5. LOCATION OF LEGAL DESCRIPTION**

COURTHOUSE, REGISTRY OF DEEDS, ETC.:  
Leon County Courthouse

STREET AND NUMBER:  
Monroe Street

CITY OR TOWN: Tallahassee      STATE: Florida      CODE: 12

**6. REPRESENTATION IN EXISTING SURVEYS**

TITLE OF SURVEY: 1) Fla. Historic Sites Survey 1940 2) HABS 1935 #19  
3) Tallahassee Historic Bldg Survey

DATE OF SURVEY: 2  Federal 1&3  State     County     Local

DEPOSITORY FOR SURVEY RECORDS:  
1&3 Department of State, Div. Archives, History & Records Mgt.  
2 Library of Congress

STREET AND NUMBER:  
1&3 Tallahassee 2 Washington

CITY OR TOWN: Tallahassee      STATE: 1&3 Fla, 2 D.C.      CODE:

STATE: Florida

COUNTY: Leon

ENTRY NUMBER: JUN 30 1972

FOR NPS USE ONLY

DATE:

SEE INSTRUCTIONS

S E E I N S T R U C T I O N S

7. DESCRIPTION

CONDITION

(Check One)  
 Excellent  Good  Fair  Deteriorated  Ruins  Unexposed

(Check One)  Altered  Unaltered (Check One)  Moved  Original Site

DESCRIBE THE PRESENT AND ORIGINAL (if known) PHYSICAL APPEARANCE

The plantation estate known as Goodwood is located on a tract of land which was originally part of the Lafayette grant. Supposedly completed in 1839, the house was begun in 1834 for Bryan H. Croom by architect George Anderson. The house is constructed on massive but simple lines, built in Georgian style, and of square design. On the grounds of this estate were once found a private race track, formal English gardens, bridle paths, and winding carriage drives.

Numerous out-buildings surround the principal structure at Goodwood. Among these are included seven guest cottages--modern stucco buildings which replaced the original wooden structures. A barn replaced the original carriage house during extensive reconstruction work completed in 1913 by the owner, Mrs. Fannie Tiers who also is responsible for replacement of the original tower on the house, as well as numerous other alterations. The carriage house, a frame structure, once was surrounded by three stables. One of the stables was later converted to living quarters for servants. A water tower, approximately 65 feet high, and a carriage house containing a large electric clock make up the remaining outlying buildings found on the estate. Acreage of the property including only the house and outlying buildings is estimated at 9 acres; while the estate in its entirety covers a total of 150 acres.

Reconstruction on the original mansion was begun in 1912 and said to have been completed in 1913. Among the alterations made were removal of iron grille work and replacement with columns to support the front porch; an addition to the back of the house for use as a kitchen; replacement of the original cupola with one in octagonal shape which resembles the one at Mount Vernon; and numerous structural changes such as removal of some doors leading outside. The original kitchen was situated northwest of the mansion, and this building now serves as an additional cottage.

The two-story house includes a basement and attic. The exterior is constructed of brick covered with cement stucco to simulate stonework. Exterior walls are two feet thick, and in some cases, three feet thick. Hand hewn timber which was used in the construction adds interest to the house. "The main portion of the house is approximately 55 feet square, with exterior bearing walls and two longitudinal interior bearing partitions which form a central hall on the ground floor and define circulation space on the second and third floors. On the ground floor, living spaces were planned as formal reception room and parlor on one side of the central hallway, and dining room and library on the other." The facade consists of a veranda which extends across the front and columns which rise one story. The entrance is flanked by three columns on each side. Above

NATIONAL REGISTER OF HISTORIC PLACES  
INVENTORY - NOMINATION FORM

(Continuation Sheet)

STATE Florida	
COUNTY Leon	
FOR NPS USE ONLY	
ENTRY NUMBER	DATE
JUN 30 1972	

(Number all entries)

7. Description

the paneled central door, with one window on either side, is a rectangular transom. The door, of heart pine, contains rectangular lights and features silver hinges. The house also features a spindle-type balustrade across the entire front at both levels. A centrally located pavilion with double doors and half-moon transom at the second level terminates in a classic pediment and fan light. A modillioned cornice encircles the house below the roof line, and is repeated inside the pediment.

The building has a hip roof, with the ridge cut off to form a flat deck which is surrounded by a balustrade. Atop the deck is found the octagonal cupola added by Mrs. Tiers.

A central entrance hall which measures approximately 50 feet in length is a notable feature of the house. The elliptical shaped staircase which is made of rosewood is located at one side of the hall, and with rooms located on each side of the central hallway, the floor plan is symmetrical. The stair extends from the first floor to the attic and is both curved and straight. It contains niches supposedly for the placement of candles, was made by English craftsmen.

Frescoed ceilings in the downstairs rooms were the work of European artists, and remain in remarkably good condition today. The second floor consists of a central hall and five bedrooms, with bathrooms which were later additions. Each room contains an Italian marble fireplace.

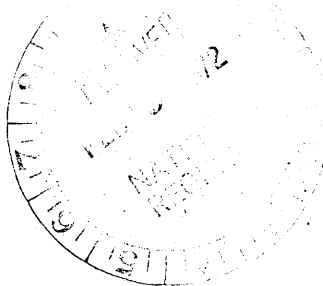

**SIGNIFICANCE**

PERIOD (Check One or More as Appropriate)

- Pre-Columbian |  16th Century |  18th Century |  20th Century  
 15th Century |  17th Century |  19th Century

SPECIFIC DATE(S) (If Applicable and Known) **1834-1839**

AREAS OF SIGNIFICANCE (Check One or More as Appropriate)

- |  |   |  |  |
|--|---|--|--|
| <input type="checkbox"/> Aboriginal              | <input type="checkbox"/> Education              | <input type="checkbox"/> Political           | <input type="checkbox"/> Urban Planning  |
| <input type="checkbox"/> Prehistoric             | <input type="checkbox"/> Engineering            | <input type="checkbox"/> Religion/Philosophy | <input type="checkbox"/> Other (Specify) |
| <input type="checkbox"/> Historic                | <input type="checkbox"/> Industry               | <input type="checkbox"/> Science             | _____                                    |
| <input type="checkbox"/> Agriculture             | <input type="checkbox"/> Invention              | <input type="checkbox"/> Sculpture           | _____                                    |
| <input checked="" type="checkbox"/> Architecture | <input type="checkbox"/> Landscape Architecture | <input type="checkbox"/> Social/Humanitarian | _____                                    |
| <input type="checkbox"/> Art                     | <input type="checkbox"/> Literature             | <input type="checkbox"/> Theater             | _____                                    |
| <input type="checkbox"/> Commerce                | <input type="checkbox"/> Military               | <input type="checkbox"/> Transportation      | _____                                    |
| <input type="checkbox"/> Communications          | <input type="checkbox"/> Music                  |  | _____                                    |
| <input type="checkbox"/> Conservation            |   |  | _____                                    |

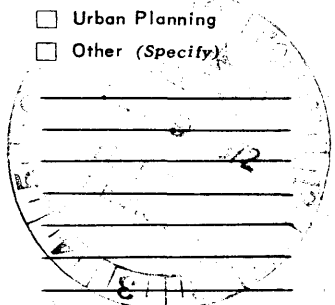

STATEMENT OF SIGNIFICANCE

SEE INSTRUCTIONS

The land on which Goodwood stands is a part of the township granted to General Lafayette in appreciation of his assistance to the United States during the Revolutionary War. In 1834, the land granted to Lafayette was sold by his heirs and was purchased by Hardy Bryan Croom. Croom's brother, Bryan H. Croom also purchased extensively in the Leon County, and Gadsden County areas. The estate known as Goodwood was parceled into sections 20, 27, 28 and 29 of township 1N, range 1E--the Lafayette Township. Because of indecision related to a permanent settlement on the property, one brother and his family went north and on return were drowned. The surviving brother, Bryan H. Croom became involved in a lengthy lawsuit in which another relative challenged Bryan's claim to the estate. Apparently during the legal entanglements which spanned a twenty year period, Bryan occupied the house at Goodwood. The litigation was finally settled in 1858 and Miss Henrietta Smith was declared the legal heir of the property. (The Croom-Smith-Armistead suit as filed in Supreme Court records is a significant legal action since from this litigation came the "first-impression" decision which determines the survivorship-rights in event of a common disaster at sea.)

The house was sold by Miss Smith to Arvah Hopkins. The house then passed on to a Dr. W.L. Arrowsmith, a man of mystery and an Englishman whose adventures add an air of excitement to the history of the house. It was Arrowsmith who supposedly added many furnishings and objects of artistic interest which came from Europe. After Arrowsmith died, the house was sold to a Mrs. Fanny Tiers, supposedly one of the richest women in the world at that time (1911). Mrs. Tiers made many of the changes noted at Goodwood today. In 1924-1925 the house was again sold--this time to Senator and Mrs. W.C. Hodges. Mrs. Hodges remarried, after her husband died and continues to occupy Goodwood with her husband, Thomas Hood.

The estate itself was designed in many ways as a self-sustaining village. The family had only to step outside the front door of the house for various forms of entertainment.

9. MAJOR BIBLIOGRAPHICAL REFERENCES

(See Attached Sheet)

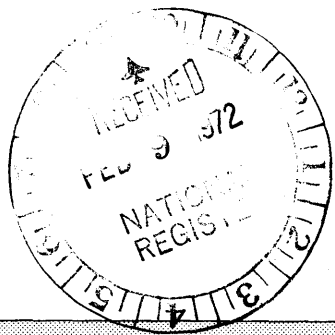

10. GEOGRAPHICAL DATA

LATITUDE AND LONGITUDE COORDINATES DEFINING A RECTANGLE LOCATING THE PROPERTY			O R	LATITUDE AND LONGITUDE COORDINATES DEFINING THE CENTER POINT OF A PROPERTY OF LESS THAN TEN ACRES		
CORNER	LATITUDE	LONGITUDE		LATITUDE	LONGITUDE	
	Degrees Minutes Seconds	Degrees Minutes Seconds		Degrees Minutes Seconds	Degrees Minutes Seconds	
NW	° ' "	° ' "		84 ° 15 ' 28 "	30 ° 27 ' 29 "	
NE	° ' "	° ' "				
SE	° ' "	° ' "				
SW	° ' "	° ' "				

APPROXIMATE ACREAGE OF NOMINATED PROPERTY: **9 acres**

LIST ALL STATES AND COUNTIES FOR PROPERTIES OVERLAPPING STATE OR COUNTY BOUNDARIES

STATE:	CODE	COUNTY	CODE
STATE:	CODE	COUNTY:	CODE
STATE:	CODE	COUNTY:	CODE
STATE:	CODE	COUNTY:	CODE

11. FORM PREPARED BY

NAME AND TITLE:  
**Mary K. Evans, Historic Sites Specialist**

ORGANIZATION: **Division of Archives, History & Records Mgt.** DATE: **8/16/71**

STREET AND NUMBER:  
**Department of State - The Capitol**

CITY OR TOWN: **Tallahassee** STATE: **Florida** CODE: **12**

12. STATE LIAISON OFFICER CERTIFICATION

As the designated State Liaison Officer for the National Historic Preservation Act of 1966 (Public Law 89-665), I hereby nominate this property for inclusion in the National Register and certify that it has been evaluated according to the criteria and procedures set forth by the National Park Service. The recommended level of significance of this nomination is:

National  State  Local

Name: *Robert W. Williams*

Title: \_\_\_\_\_

Date: \_\_\_\_\_

NATIONAL REGISTER VERIFICATION

I hereby certify that this property is included in the National Register.

*Robert M. Utley*  
Chief, Office of Archeology and Historic Preservation

Date: 6/30/72

ATTEST:  
*William H. Huntz*  
Keeper of The National Register

Date: \_\_\_\_\_

SEE INSTRUCTIONS

**NATIONAL REGISTER OF HISTORIC PLACES  
INVENTORY - NOMINATION FORM**

(Continuation Sheet)

STATE Florida	
COUNTY Leon	
FOR NPS USE ONLY	
ENTRY NUMBER	DATE
	JUN 30 1972

(Number all entries)

8. Significance

A private race track was a part of the estate's attractions; formal English gardens were in abundance on the estate; bridle paths and winding carriage drives made up some of the other features.

Due to the hospitality of the Hodges, the house became a haven for legislators during their stay in Tallahassee. Senator and Mrs. Hodges welcomed their guests frequently and warmly and the house has continued to maintain an air of grand hospitality up to the present time.

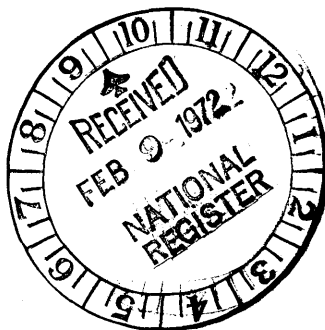

NATIONAL REGISTER OF HISTORIC PLACES  
INVENTORY - NOMINATION FORM

(Continuation Sheet)

STATE Florida	
COUNTY Leon	
FOR NPS USE ONLY	
ENTRY NUMBER	DATE
	JUN 30 1972

(Number all entries)

9. Bibliography

- Close, Bernard W. "Leon County Homes and Buildings." (Florida State University Clippings) Letters to the Custodian of Goodwood, July 19, 1939.
- Dodd, Dorothy. "The Steamboats Home and Pulaska," Paper read before Tallahassee Historical Society, Tallahassee, Florida May, 1953.
- "Goodwood--An Architect's Viewpoint," Tallahassee Democrat, September 22, 1946; August 7, 1966.
- Henry, Evelyn Whitfield. "Old Houses of Tallahassee," Tallahassee Historical Society Annual, I (February, 1934).
- Leon County Records, Leon County Courthouse, Tallahassee, Florida. Office of the Clerk of the Circuit Court. (Subgroup: deeds).
- Leon County Records, Leon County Courthouse, Tallahassee, Florida. Office of the Tax Assessor.
- Pratt, Dorothy and Richard. A Guide to Early American Homes, South. New York: McGraw-Hill Book Co., Inc., 1956.
- St. Petersburg Morning News (Florida), January 24, 1926.
- Tallahassee, Florida. Personal interview (by Mary K. Evans) with Mr. and Mrs. Thomas Hood. September and November, 1971.

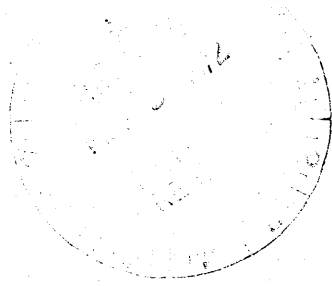

Form 10-301  
(July 1969)

UNITED STATES DEPARTMENT OF THE INTERIOR  
NATIONAL PARK SERVICE

## NATIONAL REGISTER OF HISTORIC PLACES

### PROPERTY MAP FORM

(Type all entries - attach to or enclose with map)

STATE Florida	
COUNTY Leon	
FOR NPS USE ONLY	
ENTRY NUMBER	DATE
JUN 30 1972	

SEE INSTRUCTIONS

<b>1. NAME</b>			
COMMON: Goodwood			
AND/OR HISTORIC: The Old Croom Mansion			
<b>2. LOCATION</b>			
STREET AND NUMBER: 1500 Miccosukee Road			
CITY OR TOWN: Tallahassee			
STATE:	CODE	COUNTY:	CODE
Florida	12	Leon	073
<b>3. MAP REFERENCE</b>			
SOURCE: Tallahassee Quadrangle			
SCALE: 1:62500			
DATE: 1940			
<b>4. REQUIREMENTS</b>			
TO BE INCLUDED ON ALL MAPS			
1. Property boundaries where required.			
2. North arrow.			
3. Latitude and longitude reference.			





THOMASVILLE (JUNC. U.S. 19-44) 30 MI.  
BRADFORDVILLE 5 MI.

BAINBRIDGE (JUNC. U.S. 44) 39 MI.  
HAVANA 10 MI.

# FLORIDA TALLAHASSEE QUADRANGLE 15-MINUTE SERIES

4145 11 SW  
(BRADFORDVILLE  
1:24,000)

753 754 755 759 760 761 2 070 000 FEET R. 1 E. 84° 15' 30" 30'

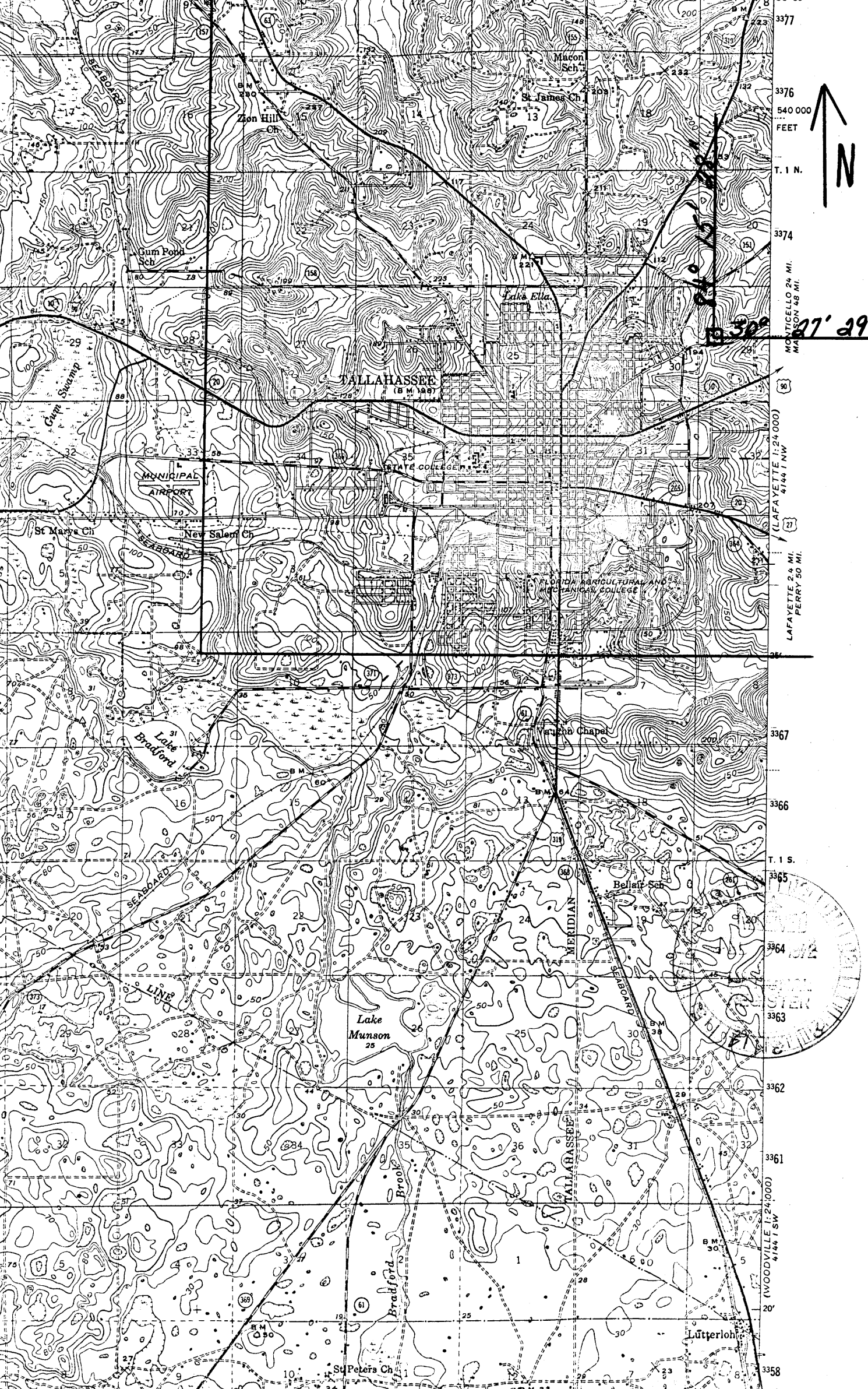

540 000  
FEET  
T. 1 N.  
3374  
3377

(LAFAYETTE 1:24,000)  
4144 1 NW

LAFAYETTE 24 MI.  
PERRY 50 MI.

T. 1 S.

3367  
3366  
3365  
3364  
3363

3362  
3361

(WOODVILLE 1:24,000)  
4144 1 SW

3358

27' 29"

