

**United States Department of the Interior  
Heritage Conservation and Recreation Service**

**National Register of Historic Places  
Inventory—Nomination Form**

See instructions in *How to Complete National Register Forms*  
Type all entries—complete applicable sections

**1. Name**

historic Goethe House

and/or common Goethe, C. M., House

**2. Location**

street & number 3731 T Street \_\_\_ not for publication

city, town Sacramento \_\_\_ vicinity of congressional district 3rd

state California code 06 county Sacramento code 067

**3. Classification**

Category	Ownership	Status	Present Use	
<input type="checkbox"/> district	<input checked="" type="checkbox"/> public	<input checked="" type="checkbox"/> occupied	<input type="checkbox"/> agriculture	<input type="checkbox"/> museum
<input checked="" type="checkbox"/> building(s)	<input type="checkbox"/> private	<input type="checkbox"/> unoccupied	<input type="checkbox"/> commercial	<input type="checkbox"/> park
<input type="checkbox"/> structure	<input type="checkbox"/> both	<input type="checkbox"/> work in progress	<input type="checkbox"/> educational	<input type="checkbox"/> private residence
<input type="checkbox"/> site	<b>Public Acquisition</b>	<b>Accessible</b>	<input type="checkbox"/> entertainment	<input type="checkbox"/> religious
<input type="checkbox"/> object	<input type="checkbox"/> in process	<input type="checkbox"/> yes: restricted	<input type="checkbox"/> government	<input type="checkbox"/> scientific
	<input type="checkbox"/> being considered	<input checked="" type="checkbox"/> yes: unrestricted	<input type="checkbox"/> industrial	<input type="checkbox"/> transportation
		<input type="checkbox"/> no	<input type="checkbox"/> military	<input checked="" type="checkbox"/> other: Non-profit

**4. Owner of Property**

name California State University, Sacramento, Foundation

street & number 6000 J Street

city, town Sacramento \_\_\_ vicinity of state California 95819

**5. Location of Legal Description**

courthouse, registry of deeds, etc. Sacramento County Recorder's Office

street & number 901 G Street

city, town Sacramento state California

**6. Representation in Existing Surveys**

title None has this property been determined eligible? \_\_\_ yes  no

date \_\_\_ federal \_\_\_ state \_\_\_ county \_\_\_ local

depository for survey records

city, town state

---

## 7. Description

---

**Condition**

excellent  
 good  
 fair

deteriorated  
 ruins  
 unexposed

**Check one**

unaltered  
 altered

**Check one**

original site  
 moved      date \_\_\_\_\_

---

**Describe the present and original (if known) physical appearance**

The Goethe House is a fine example of a Mediterranean Revival residence. The two-story, stucco-exterior house contains a basement and attic, and is capped with a red-tiled, low-pitched, hipped roof. The six thousand square foot house is ell-shaped, with the main living area on the horizontal axis, parallel to the street, while the kitchen and garage are on the vertical axis, perpendicular to the street.

The front elevation is dominated by the richly embellished entryway. The balconet, centered on the second story of the facade, has a wrought iron railing. The French doors that open onto the balconet are surrounded by low-relief, cast-cement panels. On each side of the balconet is a small window with a wrought iron window grill. Balancing off the second story are two larger windows that are each capped and divided into three parts by embellished cast-cement panels.

The first story of the front elevation contains a carved teakwood door that is enclosed by two spiral-shaped and two square columns, each of which have Corinthian-like capitals. The entryway is topped with an embellished low-relief cement panel. The large windows flanking the entryway each have a small wrought iron railing around the base. Each window is divided by a small pillar; cast-cement panels are located above each window.

The east end of the building contains one of three chimneys. The second story of the east side contains six windows of different sizes, and a French door that opens onto the roof of the sun porch. The three sides of the sun porch are surrounded with windows, which are capped with embellished cement panels. The sun porch also has a French door that opens to the outside.

At the rear, a dormer window is directly above the large bay window on the second story. The second story also contains a sleeping porch that extends over a small porch on the ground floor. The French door in the porch opens into the library. The first story also has a large picture window, directly below the bay window, which is capped by embellished cement panels and flanked by French doors.

The west side has two chimneys, one in the kitchen and the other between the screen porch and the dining room. The second story contains ten windows of different sizes, with the window over the garage capped by a cement panel. The French door on the second story opens onto the roof of the screen porch, which is identical to the sun porch on the east elevation. The former screen porch on the south side of the west elevation is now enclosed on three sides by windows and has a French door that opens to the outside. Next to the screen porch is a large window that is next to another French door. The only outside entrance to the basement is on this side. The two-car garage is on the north end of the west side.

The Goethe House exhibits some features that are typical of a Julia Morgan house. The entry hall allows for the passage into the library, kitchen, dining room, living room, and upstairs, without passing through another room. Miss Morgan, striving to incorporate the outdoors with the interior, designed the Goethe House to include several porches and rooms with views or openings to the gardens.

Teakwood was used in the house's construction, with the stairway, doors, and interior trim built with teak. A sculptured wooden panel is located over the mantel in the living room.

FHR-8-300A  
(11/78)

UNITED STATES DEPARTMENT OF THE INTERIOR  
HERITAGE CONSERVATION AND RECREATION SERVICE

**NATIONAL REGISTER OF HISTORIC PLACES  
INVENTORY -- NOMINATION FORM**

FOR HCRS USE ONLY  
RECEIVED JAN 20 1982  
DATE ENTERED FEB 19 1982

CONTINUATION SHEET

ITEM NUMBER

7

PAGE

1

---

In 1975 the second story was slightly modified to create office space, while in 1979 an interior stairway was built from the garage to the second story. Neither of these modifications detract from the architectural significance of the house.

## 8. Significance

Period	Areas of Significance—Check and Justify below			
<input type="checkbox"/> prehistoric	<input type="checkbox"/> archeology-prehistoric	<input type="checkbox"/> community planning	<input type="checkbox"/> landscape architecture	<input type="checkbox"/> religion
<input type="checkbox"/> 1400–1499	<input type="checkbox"/> archeology-historic	<input type="checkbox"/> conservation	<input type="checkbox"/> law	<input type="checkbox"/> science
<input type="checkbox"/> 1500–1599	<input type="checkbox"/> agriculture	<input type="checkbox"/> economics	<input type="checkbox"/> literature	<input type="checkbox"/> sculpture
<input type="checkbox"/> 1600–1699	<input checked="" type="checkbox"/> architecture	<input type="checkbox"/> education	<input type="checkbox"/> military	<input type="checkbox"/> social/
<input type="checkbox"/> 1700–1799	<input type="checkbox"/> art	<input type="checkbox"/> engineering	<input type="checkbox"/> music	<input type="checkbox"/> humanitarian
<input type="checkbox"/> 1800–1899	<input type="checkbox"/> commerce	<input type="checkbox"/> exploration/settlement	<input type="checkbox"/> philosophy	<input type="checkbox"/> theater
<input checked="" type="checkbox"/> 1900–	<input type="checkbox"/> communications	<input type="checkbox"/> industry	<input type="checkbox"/> politics/government	<input type="checkbox"/> transportation
		<input type="checkbox"/> invention		<input type="checkbox"/> other (specify)

Specific dates 1924

Builder/Architect Julia Morgan

### Statement of Significance (In one paragraph)

The Goethe House is a sophisticated interpretation of California's Mediterranean Revival residential architecture of the 1920s, executed by a master architect, Julia Morgan. It was built for Charles M. and Mary Glide Goethe, who were prominent figures in Sacramento's more recent history.

Julia Morgan was born in San Francisco, in 1872, to a middle-class family. Excelling in her schoolwork and ambitious for a career, she enrolled in the University of California, Berkeley. After graduating from Berkeley with a degree in civil engineering, she studied at the Ecole des Beaux-Arts in Paris, and became the first woman to graduate from that institute.

After returning to California, she worked for John Galen Howard on a Phoebe Hearst commission and, in 1905, she opened her own office. As her reputation grew, so did the number of commissions, and her office soon became one of the more prestigious architectural firms on the West Coast.

Not only did she complete an extraordinary number of commissions, Miss Morgan was also a brilliant design innovator. Her early works contributed to the development of the emerging Bay Area Shingle Style. Miss Morgan also worked in the popular Mediterranean Revival styles of the 1920s. At the same time, she was experimenting with reinforced concrete, and soon became a leading West Coast expert on cement construction.

Her training at the Beaux-Arts and her experience with cement prepared her for her largest commission, San Simeon. But, while she was working on the San Simeon commission, she also designed YWCAs in Berkeley, San Francisco, Oakland, San Jose, Long Beach, Honolulu, Utah, and Tokyo.

One of the reasons for her popularity was her close rapport with her clients. Because she had a genuine interest and concern for their needs and desires, she had the ability to plan a house or building that suited her clients exactly.

With the coming of World War II, the wartime shortage of labor and material brought institutional work almost to a halt. Miss Morgan, now in her seventies, began to phase out her practice, only working occasionally for Hearst. She died in the Bay Area in 1957. During her career, she designed nearly 1,500 buildings, both public and private. Among her most famous works are the Berkeley Women's City Club, St. John's Presbyterian Church in Berkeley, the Hearst Memorial Gymnasium for Women (with Bernard Maybeck) at the University of California in Berkeley, the YWCA's Asilomar Conference Center in Pacific Grove, and her most famous work -- William Randolph Hearst's San Simeon estate. The Goethe House is a well-preserved example of her residential architecture, and is one of only two buildings in Sacramento which have been documented as her work. The other known Morgan design is the Sacramento Public Market of 1923, commissioned by Mrs. Lizzie Glide of San Francisco, who had formerly resided in Sacramento. It is known that Julia Morgan designed at least one other building in Sacramento, a residential structure for the Glide family, although the exact building and location have not been determined at this time.

## 9. Major Bibliographical References

Blumenson, John J. and G. Identifying American Architecture: A Pictorial Guide to Styles and Terms, 1600-1945. Nashville, American Association for State and Local History, 1977

(See continuation sheet)

## 10. Geographical Data

Acree of nominated property 1.04 acres (45,250 sq. ft.)

Quadrangle name Sacramento, East, California

Quadrangle scale 1:24000 (7.5)

UMT References

A 

1	0
---	---

6	3	4	2	2	5
---	---	---	---	---	---

4	2	6	8	7	7	5
---	---	---	---	---	---	---

  
Zone Easting Northing

B 

--	--

--	--	--	--

--	--	--	--	--	--

  
Zone Easting Northing

C 

--	--

--	--	--	--

--	--	--	--	--	--

D 

--	--

--	--	--	--

--	--	--	--	--	--

E 

--	--

--	--	--	--

--	--	--	--	--	--

F 

--	--

--	--	--	--

--	--	--	--	--	--

G 

--	--

--	--	--	--

--	--	--	--	--	--

H 

--	--

--	--	--	--

--	--	--	--	--	--

### Verbal boundary description and justification

The nominated property occupies lots 3, 4, 5, 6, and 7 of the Elmhurst tract in the city and is approximately 180' x 250' in size.

### List all states and counties for properties overlapping state or county boundaries

state code county code

state code county code

## 11. Form Prepared By

name/title Paul R. Howard

organization

date

street & number 2218 K Street, #4

telephone (916) 442-8917

city or town Sacramento

state California 95816

## 12. State Historic Preservation Officer Certification

The evaluated significance of this property within the state is:

national  state  local

As the designated State Historic Preservation Officer for the National Historic Preservation Act of 1966 (Public Law 89-665), I hereby nominate this property for inclusion in the National Register and certify that it has been evaluated according to the criteria and procedures set forth by the Heritage Conservation and Recreation Service.

State Historic Preservation Officer signature

*K. M. Ellen*

title SHPO

date 12-22-81

For HCERS use only

I hereby certify that this property is included in the National Register

Keeper of the National Register

Attest:

Chief of Registration

*Shelore Bayers*

2/19/82

*Paul R. Howard*

**NATIONAL REGISTER OF HISTORIC PLACES  
INVENTORY -- NOMINATION FORM**

FOR HCRS USE ONLY  
RECEIVED JAN 20 1982  
DATE ENTERED FEB 19 1982

CONTINUATION SHEET

ITEM NUMBER 8 PAGE 1

Charles Mattias Goethe was born in Sacramento on March 28, 1875, the son of a local insurance man, land agent, and mortgage broker, and the grandson of Sacramento's first German Lutheran minister. After graduating from Sacramento High School in 1891, Goethe worked in his father's business as a clerk and bookkeeper, and later as the vice president. Having gained valuable experience in his father's business, Goethe opened his own office in 1912, after his father retired.

In 1903 Goethe married Mary Glide, the daughter of Henry and Lizzie Glide, at the time one of California's wealthiest families. Mary Glide Goethe's inheritance in time contributed substantially to the Goethe estate.

Goethe's business expanded and prospered in the 1920s due to his investments in real estate, especially in the Elmhurst subdivision. The subsequent sale of the land provided Goethe with the working capital for still more lucrative investments. It was at this time, in 1924, that the Goethe House was built. The selection of Julia Morgan as the architect was due largely to her association with the Glide family. Lizzie Glide was a close friend of Phoebe Apperson Hearst, an important patron of Julia Morgan. Mrs. Glide commissioned Miss Morgan to design open-structure public markets in San Francisco and Sacramento, and several homes for the Glide family. The design of the Goethe House by such a noted architect in Sacramento's fashionable new Elmhurst subdivision was a reflection of Charles and Mary Goethe's rising social and economic stature in the community. After the stock market crash in 1929, Goethe invested heavily in blue chip stocks that were available at extremely low prices, and once the market began to recover, his fortune increased substantially.

With his financial interests, Goethe also participated in civic activities. Among other projects he helped plan playgrounds and the community's park system and, also, founded the Sacramento Council of Churches. He was also interested in the conservation of natural resources, and actively participated in the Audubon Society and the Sierra Club. In addition, he made important contributions to establish Sacramento State College (now California State University, Sacramento) on its present location.

Mary Goethe's death in 1946 was a great shock to Goethe. In an attempt to fill the void left by her death, Goethe turned to philanthropy. During his lifetime, it has been estimated, he gave away between \$400,000 and \$500,000 to groups and individuals.

With his death in 1966, his entire estate, valued at \$24 million, was bequeathed to individuals or organizations. One of the largest beneficiaries was California State University, Sacramento, which received \$500,000, his home on T Street, and his personal library and papers. Several other organizations, among them the Save-the-Redwoods League, the University of the Pacific, the Sacramento Chamber of Commerce, and the American Institute for the Advancement of Science, also received a portion of Goethe's estate.

In recognition of Goethe's contributions, a Sacramento junior high school, a Sacramento County park, and the arboretum at California State University, Sacramento, have been named in his honor.

**NATIONAL REGISTER OF HISTORIC PLACES  
INVENTORY -- NOMINATION FORM**

FOR HCRS USE ONLY  
RECEIVED JAN 20 1982  
DATE ENTERED FEB 19 1982

CONTINUATION SHEET

ITEM NUMBER 9

PAGE 1

Boutelle, Sara. "The Long-distance Dreamer Who Altered the Leek of California." California Monthly. Vol. 86, No. 6, April 1976, p. 12-14.

Ellersieck Astrid E. "An Extraordinary Life." Pasadena Heritage. Summer 1978, p. 6-7.

The Oakland Museum. Architectural Drawings by Julia Morgan: Beaux-Arts Assignments and Other Buildings. January, 1976.

Richey, Elinor. Eminent Women of the West. Berkeley, Calif., Howell-North Books, 1975. p. 237-263.

Reiss, Suzanne B., ed. The Work of Walter Steilberg and Julia Morgan. 2 vols. Berkeley, University of California, Berkeley, 1976.

Samuelson, Robert E. Architecture: Columbus. Columbus, Ohio, Warner P. Simpson Company, 1976.

Scharlach, Bernice. "Julia Morgan's Buildings Grow Old Gracefully." California Historical Courier. Vol. 27, No. 3, April 1975. p. 8.

Schauer, Andrew. Charles Matthias Goethe: 1875-1966. Sacramento, Foundation of California State University, Sacramento, 1976.

POR. CITY & NEW HELVETIA RANCHO

Bk. 8

Bk. 10

Bk. 14

THE GOETHE HOUSE  
SACRAMENTO, CALIFORNIA

▨ : NOMINATED PROPERTY

Bk. 8

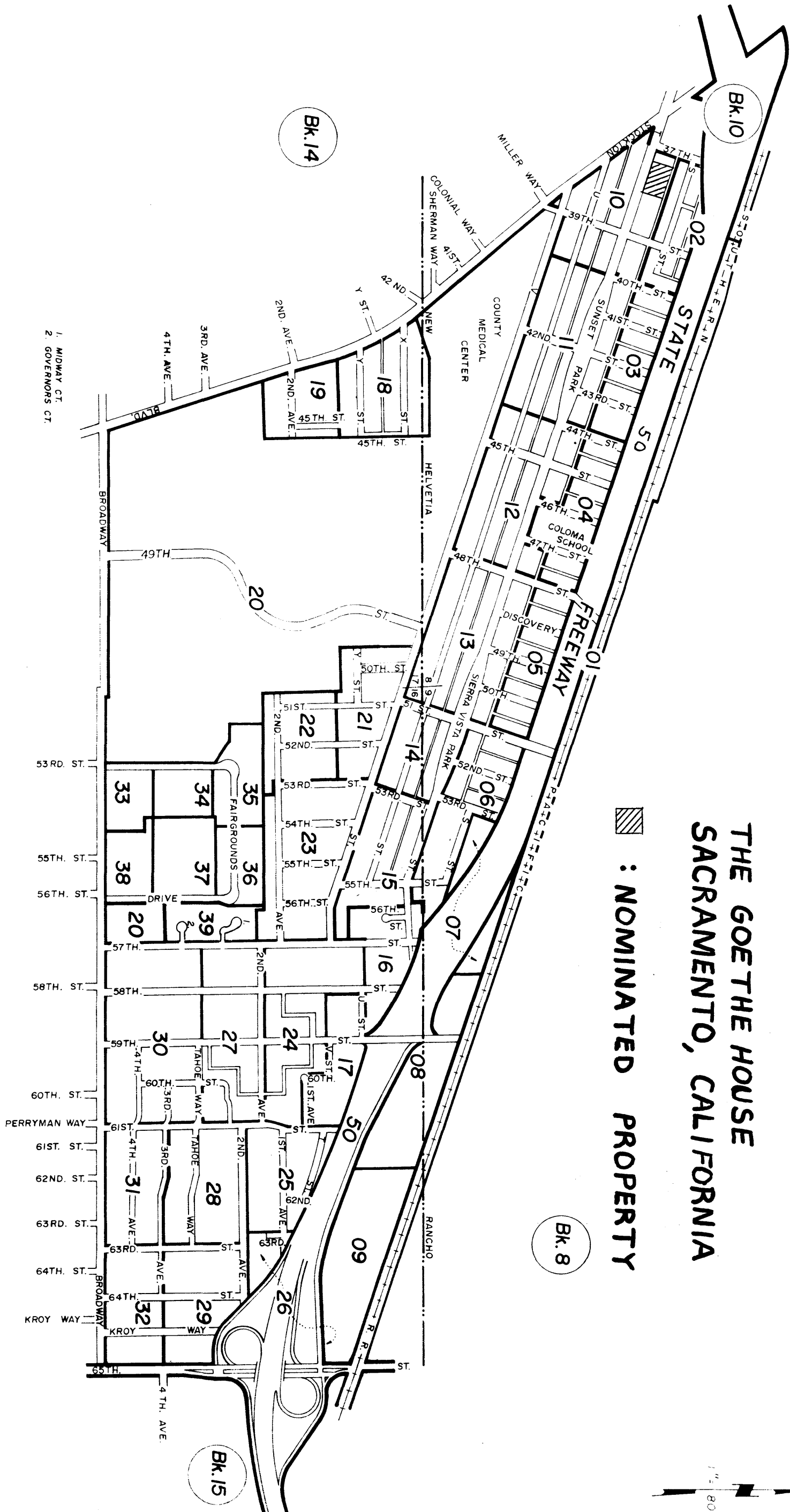

Bk. 15

Bk. 15

INDEX

BOOK 11

Assessor's Maps  
County of Sacramento, Calif.