



Historic Sites Survey

Inventory No. 15

ARCHITECTURAL DESCRIPTION: The Tait-Taylor House is a one-and-a-half-story, gable/hip-roofed Queen Anne house on a residential corner lot facing north. The steeply-pitched hipped roof is interrupted by a steeply-pitched gable projection which features decorative paneling and a wheel window. Less steeply-pitched gabled pavilions are located at the northeast and southwest corners. A shallow hip-roofed four-bay porch with turned posts, balusters and pierced brackets shields the main entrance which is a single-leaf door surmounted by a transom. The remaining fenestration on the first story consists of triple hung floor-to-ceiling windows and four-over-four double-hung sash windows. The north (front) pavilion has a highly-ornamented gable, featuring wooden latticework and three corbeled brackets which surmount two square one-light windows. This decorative motif is also in the gable of the west pavilion. The front pavilion also features a flat-roofed, square-cut bay window with four-over-four double-hung sash components highlighted by applied and indented panels. The Tait-Taylor House of Como is identical to the Hall-Henderson House of Sardis and was constructed in 1892 (Sanborn

(continued)

ALTERATIONS:

None

OUTBUILDINGS:

None extant

LANDSCAPE FEATURES: Set back on major highway secluded by masses of trees.

NAME: Tait-Taylor House
 STREET NO: Oak Avenue
 TOWN/VIC: Como
 COUNTY: Panola
 BLOCK/LOT: See Verbal Boundary Description
 PRESENT OWNER: Mr. Monroe Taylor
 ADDRESS P. O. Box 87, Como, Mississippi 38619
 PRESENT USE: Residence
 FORMER USE: Residence
 DATE: 1892
 STYLE: Vernacular Queen Anne
 ARCH/BUILDER: Andrew Johnson
 SOURCE OF DATE: "Como: Its Memories and Dreams,"
 Mrs. David Cowart
 ENVIRONMENT: On major highway leading to Como
 LEVEL OF SIGNIFICANCE
 NEIGHBORHOOD
 LOCAL
 STATE
 NATIONAL

STATEMENT OF SIGNIFICANCE: Along with the Hall-Henderson House, the Tait-Taylor House is a transitional Johnson building, coming between the L-shaped cottages of the 1880s and the predominantly two-story Queen Anne/Colonial Revival houses of the 1900s. The Tait-Taylor House retains many of Johnson's finest design features: the square-cut bay window, ornamented gables, and gallery details.

PHOTOS

NEG. #

SITE OR AREA PLAN WITH NORTH ARROW AND SHAPE OF STRUCTURE:

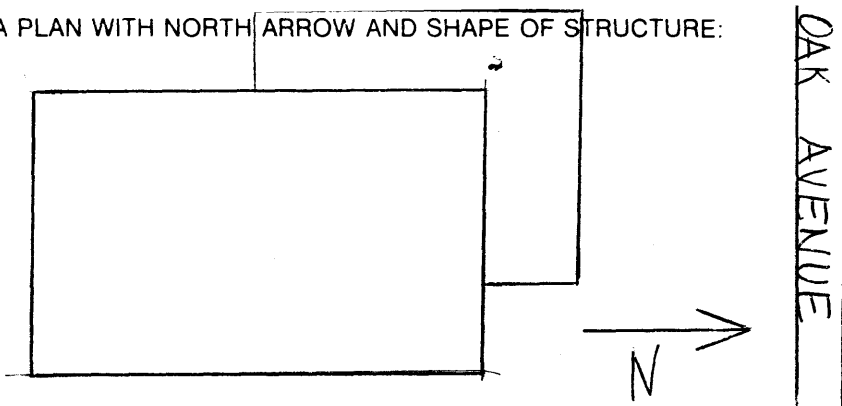

CONTINUATION:

ARCHITECTURAL DESCRIPTION

Maps). Another identical residence was constructed in Longtown (Panola County) for J. F. Goodwin. The Goodwin House was destroyed later by fire. Stylistic traits of Andrew Johnson's 1890s work are the square-cornered wrap-around porches, the square-cut bay windows with applied and indented panels and the decorative gables.

PHYSICAL CONDITION:

Good

THREATS:

None

VERBAL BOUNDARY DESCRIPTION:

Walter S. Davis Survey of March 8, 1888, Town of Como
 Fraction Lot 5 and Res Block 12

ACREAGE: less than one

JTM REF:

A	1 16	2 3 0 1 9 1 0	3 8 2 2 4 1 0
	ZONE EASTING		NORTHING
C			
B			
	ZONE EASTING		NORTHING
D			

FORM PREPARED BY:

DATE

P. Ana Gordon, Historian
 Mississippi Department of Archives and History

Jan. 1983