

ARCHITECTURAL / HISTORICAL SURVEY

DAVENPORT, IOWA

The Architects Office
 Wehner, Nowysz, Potts, Schull and Pfiffner
 201 day building, Iowa city, Iowa 52240

DAVENPORT COMMUNITY DEVELOPMENT DEPARTMENT
 IOWA DIVISION OF HISTORIC PRESERVATION

SITE # 82-10- 3-W2236 MAP # 2

HIST. DIST. _____

NAME Alden Bryan House (H) C

ADDRESS 2236 W. Third Street

LEGAL DES. J.M.F. Hall's Add. 2 6
SUB-DIVISION BLOCK PARCEL SUB-PARCEL

UTM 4 15 [699250] [4599300] ACREAGE 1 ZONE R-4D
EASTING NORTHING

OWNER Alice M. Cameron

2236 W. Third St., Davenport, IA

TITLE H. 52802
(IF DIFF)



SITE SHEET

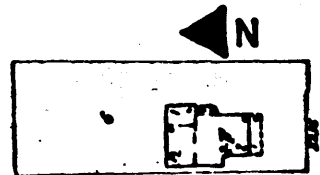

DESCRIPTION

FORM 2 story, 3-bay front-gable with rear wing, polygonal side bay and full length porch CONST. DATE c. 1875

MATERIALS Wood frame on stone foundation ARCH STYLE Vernac. Greek Revival

FENESTRATION 2/2 D.H.S. in simple, molded surrounds

DIST. FEATURES Porch

ALTERATIONS Window on 2nd floor front reworked; porch railing replaced

SITE & RELATED STR. Large flat lot

STATEMENT

This is one of the better-preserved wood frame examples of the "McClelland" or "German" house type found throughout the older sections of Davenport. Retention of original clapboards, window detail and porch posts and brackets is not an unimportant factor, since many of the remaining frame examples of this type have lost such elements.

ARCHITECTURE

SOURCES

SIGNIFICANCE

H
I
S
T
O
R
Y

DESCRIPTION

This house was probably built around 1870 by Alden P. Bryan. Unclear street address information in City Directories from the period make it difficult to determine precisely. Bryan was an employee of the Chicago, Rock Island and Pacific Railroad and, intermittantly, a farmer. Herman Balschmitter bought the property in 1876 and may have resided here or in an adjacent house. It is possible that Balschmitter erected the house. Balschmitter worked as a tailor and later as a photographer.

SOURCES

City Directories, 1861-62, 1863, 1866, 1867, 1868-69, 1870-71, 1873, 1874-75, 1876.

ARCHITECTURAL HISTORIAN: Martha Bowers | HISTORIAN: MARLYS SVENDSEN - ROESLER | SURVEY COMP. 1981

EVALUATION

ARCHITECTURAL

I. ARCH. EVALUATION Good
II. ENVIR. STATURE Tissue
III. INT. OF CONTEXT Good
IV. INT. OF FABRIC Excellent

LEVEL OF SIGNIFICANCE:
 NAT. STATE LOCAL N. ELIG.

HISTORICAL

I. THEME(S) OF SIGNIFICANCE:
A. PRIMARY _____
B. SECONDARY _____

II. LEVEL OF SIGNIFICANCE:
 NAT. STATE LOCAL

III. NR.H.P.
ELIGIBLE NOT ELIGIBLE

HISTORIC DISTRICT CLASSIFICATION

FOR DIVISION OF HISTORIC PRESERVATION USE ONLY

1. DATE RECEIVED _____

2. DATE OF STAFF EVALUATION _____

	A. ARCHITECTURAL	B. HISTORICAL
ELIGIBLE FOR N.R.H.P.	<input type="checkbox"/>	<input type="checkbox"/>
NOT ELIGIBLE FOR N.R.H.P.	<input type="checkbox"/>	<input type="checkbox"/>

3. N.R.H.P. ACTION

A. STATE REVIEW COMM.	APP. <input type="checkbox"/>	DISAPP. <input type="checkbox"/>	TABLED <input type="checkbox"/>	DATE _____
B. FEDERAL REVIEW	APP. <input type="checkbox"/>	DISAPP. <input type="checkbox"/>	TABLED <input type="checkbox"/>	DATE _____

4. D.H.P. SOURCES

<input type="checkbox"/> COUNTY RESOURCES	<input type="checkbox"/> DET. OF ELIGIBILITY
<input type="checkbox"/> W'SHIELD SURVEY	<input type="checkbox"/> R. & C. _____
<input type="checkbox"/> NRHP	<input checked="" type="checkbox"/> DAVENPORT A/H SURVEY
<input type="checkbox"/> GRANT _____	<input type="checkbox"/> _____

5. SUBJECT TRACES _____

6. PHOTO
1600-7