

**United States Department of the Interior
National Park Service**

For NPS use only

**National Register of Historic Places
Inventory—Nomination Form**

received **SEP 23 1986**

date entered **OCT 23 1986**

See instructions in *How to Complete National Register Forms*
Type all entries—complete applicable sections

1. Name

historic Owen Chapel Church of Christ

and/or common same

2. Location

street & number 1101 Franklin Road N/A not for publication

city, town Brentwood N/A vicinity of

state Tennessee code 047 county Williamson code 187

3. Classification

Category	Ownership	Status	Present Use
<input type="checkbox"/> district	<input type="checkbox"/> public	<input checked="" type="checkbox"/> occupied	<input type="checkbox"/> agriculture
<input checked="" type="checkbox"/> building(s)	<input checked="" type="checkbox"/> private	<input type="checkbox"/> unoccupied	<input type="checkbox"/> commercial
<input type="checkbox"/> structure	<input type="checkbox"/> both	<input type="checkbox"/> work in progress	<input type="checkbox"/> educational
<input type="checkbox"/> site	Public Acquisition	Accessible	<input type="checkbox"/> entertainment
<input type="checkbox"/> object	<input checked="" type="checkbox"/> in process	<input checked="" type="checkbox"/> yes: restricted	<input type="checkbox"/> government
	<input type="checkbox"/> being considered	<input type="checkbox"/> yes: unrestricted	<input type="checkbox"/> industrial
		<input type="checkbox"/> no	<input type="checkbox"/> military
			<input type="checkbox"/> museum
			<input type="checkbox"/> park
			<input type="checkbox"/> private residence
			<input checked="" type="checkbox"/> religious
			<input type="checkbox"/> scientific
			<input type="checkbox"/> transportation
			<input type="checkbox"/> other:

4. Owner of Property

name Owen Chapel Church of Christ, c/o Dr. Douglas Davis

street & number 1101 Franklin Road

city, town Brentwood N/A vicinity of state Tennessee 37027

5. Location of Legal Description

courthouse, registry of deeds, etc. Williamson County Courthouse

street & number Courthouse Square

city, town Franklin state Tennessee

6. Representation in Existing Surveys See Continuation Sheet

title Williamson County Survey has this property been determined eligible? yes no

date 1982 federal state county local

depository for survey records Tennessee Historical Commission

city, town Nashville state Tennessee 37219-5237

7. Description

Condition		Check one	Check one
<input type="checkbox"/> excellent	<input type="checkbox"/> deteriorated	<input type="checkbox"/> unaltered	<input checked="" type="checkbox"/> original site
<input checked="" type="checkbox"/> good	<input type="checkbox"/> ruins	<input checked="" type="checkbox"/> altered	<input type="checkbox"/> moved date _____
<input type="checkbox"/> fair	<input type="checkbox"/> unexposed		

Describe the present and original (if known) physical appearance

Set on a grassy lot dotted with trees and located at the edge of a modern subdivision, Owen Chapel Church of Christ is a simple Greek Revival building that has been remarkably unaltered since its construction in 1860. A semi-circular paved drive on the east and a paved parking lot on the north avoid the older trees and are designed to allow several younger trees to grow within the paved area. Along the north property line stands a stone fence lined with trees that appears contemporary to the church.

Owen Chapel Church of Christ is a one story rectangular brick building, three bricks thick, laid in common bond. It rests on a rough-coursed limestone block foundation. The gable roof, sheathed in standing seam tin, runs perpendicular to the entrance creating a temple plan for the building. All openings are narrow and rectangular with molded, wooden lintels.

The principal (east) facade is divided into three recessed brick panels. Although the central panel is blind, the flanking panels have separate narrow entrances positioned to be closer to the center of the facade. The entrances have single leaf doors with round-arched moldings and are topped with fixed two light transoms. Stone stoops lead to each entrance. The gable end is plain common bond brick pierced by a round decorative vent.

Both the north and south elevations have three recessed brick panels under a plain brick entablature. Centered in each panel is a 6/6/6 triple hung sash window surmounted by wide cornice lintels. Narrow louvered shutters, with their original hardware, are attached to each window.

Only on the rear (west) elevation have substantial alterations occurred. A one-story addition was constructed in the rear about 1965. No wider than the original building itself, this concrete block addition is unobtrusively attached. A doorway was cut into the interior of the church for access.

The roof and truss system were imported from Liverpool, England. Most of the standing seam tin roof is original, although part was replaced with similar material after wind damage in the early 1970s. The interior of Owen Chapel Church of Christ has undergone few recent alterations. Six early twentieth century hanging glass lights replaced the original coal oil wall sconces. Gas stoves are positioned where the original pot bellied stoves were located; evidence of flues still exist. The floor is now covered with tile and carpeting but the original plaster walls, simple molded window trim, and divided pews are visible. The pulpit is embellished with molded wood trim similar to that on the entrances. Four Sunday school rooms are located in the modern addition which is reached by two doors that were once windows.

There are no outbuildings associated with the church.

8. Significance

Period	Areas of Significance—Check and justify below			
<input type="checkbox"/> prehistoric	<input type="checkbox"/> archeology-prehistoric	<input type="checkbox"/> community planning	<input type="checkbox"/> landscape architecture	<input type="checkbox"/> religion
<input type="checkbox"/> 1400–1499	<input type="checkbox"/> archeology-historic	<input type="checkbox"/> conservation	<input type="checkbox"/> law	<input type="checkbox"/> science
<input type="checkbox"/> 1500–1599	<input checked="" type="checkbox"/> agriculture	<input type="checkbox"/> economics	<input type="checkbox"/> literature	<input type="checkbox"/> sculpture
<input type="checkbox"/> 1600–1699	<input checked="" type="checkbox"/> architecture	<input type="checkbox"/> education	<input type="checkbox"/> military	<input type="checkbox"/> social/ humanitarian
<input type="checkbox"/> 1700–1799	<input type="checkbox"/> art	<input type="checkbox"/> engineering	<input type="checkbox"/> music	<input type="checkbox"/> theater
<input checked="" type="checkbox"/> 1800–1899	<input type="checkbox"/> commerce	<input type="checkbox"/> exploration/settlement	<input type="checkbox"/> philosophy	<input type="checkbox"/> transportation
<input type="checkbox"/> 1900–	<input type="checkbox"/> communications	<input type="checkbox"/> industry	<input type="checkbox"/> politics/government	<input type="checkbox"/> other (specify)
		<input type="checkbox"/> invention		

Specific dates c.1860 Builder/Architect Unknown

Statement of Significance (in one paragraph)

Owen Chapel Church of Christ is being nominated under National Register criterion C for its architectural significance in Brentwood (pop. 9,608), Williamson County, Tennessee. It is an unusually well preserved example of vernacular Greek Revival ecclesiastical architecture. The symmetrical proportions, temple facade, triple hung sash windows, and transomed entrances are the prominent exterior design features. The interior still retains its simple wood trim and original pews. Overall, the church retains a high degree of integrity.

The congregation was founded in 1859 by Tolbert Fanning. Known as the Euclid Church, they met in the Euclid Schoolhouse, a log structure. James C. Owen gave the land for the church and helped erect the building in 1860. The roof and truss system were brought from Liverpool, England, but the brick was made from clay on William Owen's property. The building was repaired after a tornado struck it in 1869.

Owen Chapel Church of Christ is one of the earliest Churches of Christ in Middle Tennessee, a center for that denomination during the nineteenth century. Several of the most important men in the history of religion in Tennessee, as well as the denominational history, were ministers there. The list includes David Lipscomb, who was a gifted writer and speaker, as well as editor of the Gospel Advocate (a church periodical still published) and one of the founders of Nashville Bible College, now David Lipscomb College. Another founder of the college, E.A. Elam, also served at this church. Other Owen Chapel ministers, H. Leo Boles and S.P. Pittman, later became presidents of David Lipscomb College. The most famous radio preacher of his era, Hall L. Calhoun was among the famous ministers of this church.

Although it lacks much of the characteristic ornamentation of the style, Owen Chapel Church of Christ evokes the chief principals of Greek Revival architecture. The traditional portico was never used on this building; instead, the recessed brick panels on the principal facade echo the recesses between columns on a portico. Similarly, the recessed brick panels on the north and south facades echo the colonnade found on more elaborate Greek Revival buildings.

The stark simplicity of the church reflects the conservative belief of the Church of Christ as well as the architectural style. Separated entrances open to a common sanctuary with divided pews to keep male and female members from mingling during the services. The plainness of decoration shows in the nearly unaltered interior.

9. Major Bibliographical References

See Continuation Sheet

10. Geographical Data

Acreage of nominated property 1.4 acres
Quadrangle name Oak Hill, Tennessee

Quadrangle scale 1:24,000

UTM References

A

1	6	5	1	6	1	8	0	3	9	8	3	7	7	0
Zone		Easting				Northing								

B

Zone		Easting				Northing								

C

Zone		Easting				Northing								

D

Zone		Easting				Northing								

E

Zone		Easting				Northing								

F

Zone		Easting				Northing								

G

Zone		Easting				Northing								

H

Zone		Easting				Northing								

Verbal boundary description and justification

See Continuation Sheet

List all states and counties for properties overlapping state or county boundaries

state N/A code N/A county N/A code N/A

state N/A code N/A county N/A code N/A

11. Form Prepared By

name/title Janice E. Nolan/Staff Historian

organization Tennessee Department of Transportation date November 1982

street & number 505 Deaderick Street telephone 615/741-5363

city or town Nashville state Tennessee 37219

12. State Historic Preservation Officer Certification

The evaluated significance of this property within the state is:

national state local

As the designated State Historic Preservation Officer for the National Historic Preservation Act of 1966 (Public Law 89-665), I hereby nominate this property for inclusion in the National Register and certify that it has been evaluated according to the criteria and procedures set forth by the National Park Service.

Deputy State Historic Preservation Officer signature Herbert L. Hoyer

title Executive Director, Tennessee Historical Commission date 9/19/86

For NPS use only

I hereby certify that this property is included in the National Register

Sheloree Byers
Keeper of the National Register

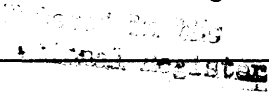

date 10-23-86

Attest:

Chief of Registration

date

**United States Department of the Interior
National Park Service**

**National Register of Historic Places
Inventory—Nomination Form**

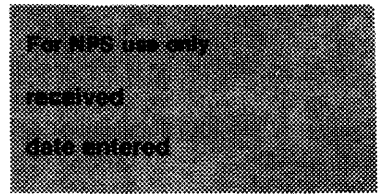

Continuation sheet Owen Chapel Church of Christ Item number 6

Page 2

REPRESENTATION IN EXISTING SURVEYS

DOT/FHWA requested a determination of eligibility on the Owen Chapel Church of Christ in November, 1982. The property was determined eligible by the Keeper of the National Register on November 22, 1982.

**United States Department of the Interior
National Park Service**

**National Register of Historic Places
Inventory—Nomination Form**

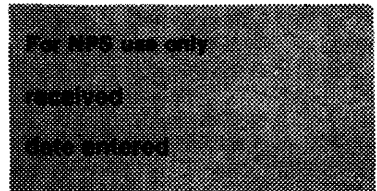

Continuation sheet Owen Chapel Church of Christ Item number 9

Page 2

MAJOR BIBLIOGRAPHICAL REFERENCES

Sources:

Bowman, Virginia. Historic Williamson County: Old Homes and Sites.
Nashville: Blue and Gray, 1971.

Hooper, Dr. Robert. David Lipscomb College. Interview, 26 April 1982.

Richard, Samuel L. Owen Chapel Church of Christ. Interview, 27 April 1982.

Waterfield Goodwin Associates Architects. "Owen Chapel Church of Christ Inspection Report." April, 1986.

**United States Department of the Interior
National Park Service**

**National Register of Historic Places
Inventory—Nomination Form**

For NPS use only
received
date entered

Continuation sheet Owen Chapel Church of Christ Item number 10

Page 2

VERBAL BOUNDARY DESCRIPTION AND JUSTIFICATION

The nominated property is rectangular in shape and 1.4 acres in size. It is bounded on the north by Jackson Lane, on the east by Franklin Road (TN6), and on the south and west by adjacent property lines. (See tax map). This includes sufficient land to protect the architectural integrity and historic setting of the nominated property.

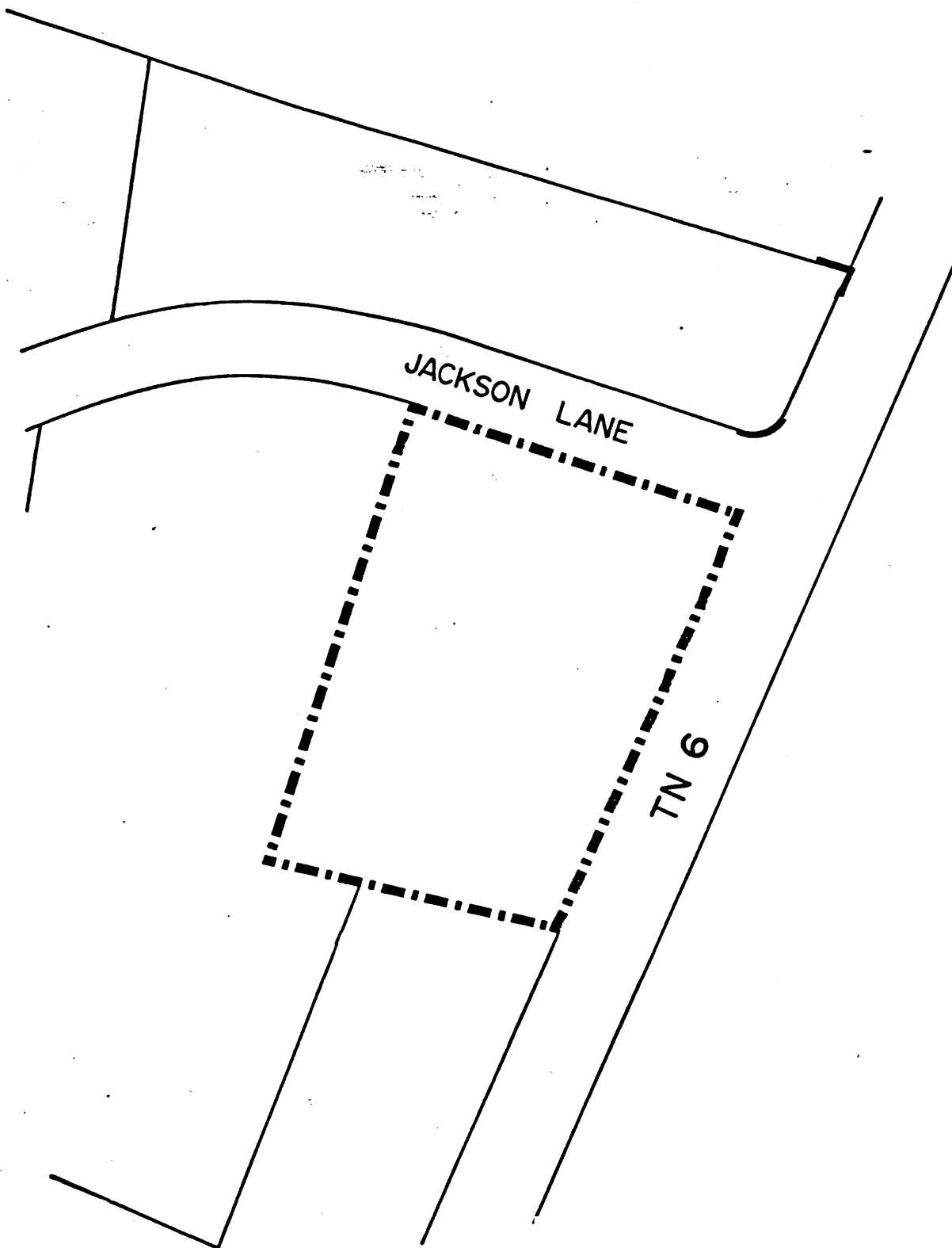

Owen Chapel Church of Christ
1101 Franklin Road
Brentwood, Williamson County, Tennessee

TAX MAP 1" = 100'