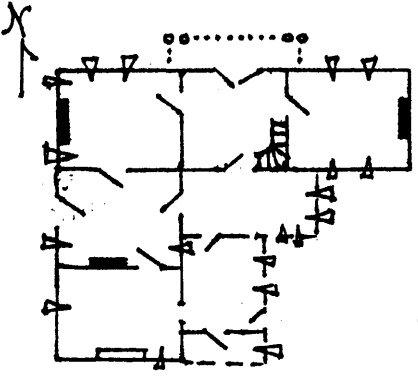
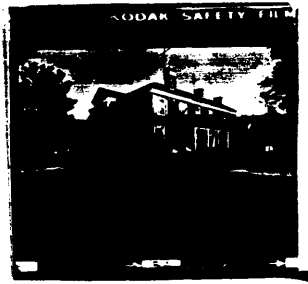

KENTUCKY HISTORIC RESOURCES INVENTORY

Site No. WS-15

1. Historic Name(s) <b>George Conner House</b> Original Owner		22. ADD/County <b>Lincoln Trail/Wash</b> <span style="border: 1px solid black; padding: 2px;">115</span>		
2. Present Name <b>As above</b>		23. U.S.G.S. Quadrant (15'/75') <b>Maud</b> <span style="border: 1px solid black; padding: 2px;">9.9</span> G.I.S. Mod.		
3. Location <b>Fredericktown</b>		24. UTM Reference <span style="border: 1px solid black; padding: 2px;">16</span> <span style="border: 1px solid black; padding: 2px;">645,880</span> <span style="border: 1px solid black; padding: 2px;">4,180,240</span>		
4. Owner's Name <b>Mr. and Mrs. Sam Nally</b>		25. Coordinate Accuracy <span style="border: 1px solid black; padding: 2px;">  </span>		
5. Owner's Address <b>Route 2, Springfield, Ky 40069</b>		26. Prehistoric Site Historic Site <input type="checkbox"/> Object <input type="checkbox"/> <b>Building</b> <input checked="" type="checkbox"/> Structure <input type="checkbox"/> Other <input type="checkbox"/>		
6. Open to Public Yes <input type="checkbox"/> No <input checked="" type="checkbox"/>	7. Visible from road Yes <input checked="" type="checkbox"/> No <input type="checkbox"/>	8. Ownership Private <input checked="" type="checkbox"/> <span style="border: 1px solid black; padding: 2px;">X</span> Local <input type="checkbox"/> State <input type="checkbox"/> Federal <input type="checkbox"/>		
9. Local Contact/Organization <b>owner</b>		27. National Register District Name: <b>N/A</b> <span style="border: 1px solid black; padding: 2px;">  </span>		
10. Site Plan with North Arrow 	11. Architect <b>unknown</b>		28. Significance Evaluation <b>NR</b> <span style="border: 1px solid black; padding: 2px;">N</span>	
	12. Builder <b>unknown</b>		29. Status National Landmark <input type="checkbox"/> Date _____ National Register <input type="checkbox"/> Landmark Certificate <input type="checkbox"/> Kentucky Survey <input type="checkbox"/> Local Landmark <input type="checkbox"/> HABS/HAER <input type="checkbox"/>	
	13. Date <b>(* 1820) c.1842</b> <span style="border: 1px solid black; padding: 2px;">3</span> B. <input type="checkbox"/>		30. Historic Theme Primary <b>Architecture</b> <span style="border: 1px solid black; padding: 2px;">C</span> Secondary _____ Other _____	
	14. Style A. <b>Greek Rev.</b> <span style="border: 1px solid black; padding: 2px;">C</span> B. <input type="checkbox"/>		31. Endangered Yes <input type="checkbox"/> No <input checked="" type="checkbox"/>	
	15. Original Use <b>Sing. fam. res.</b> <span style="border: 1px solid black; padding: 2px;">A</span>		32. Preservation Project Status <span style="border: 1px solid black; padding: 2px;">  </span>	
	16. Present use <b>as above</b>		Actual Cost in \$1,000s <span style="border: 1px solid black; padding: 2px;">  </span>	
17. Condition <b>Excellent</b> <span style="border: 1px solid black; padding: 2px;">A</span>		33. ATTACH PHOTO 		
18. Description <b>5 bay, 2 story, brick w/ell; jack arches; double pedimented portico; internal end chimneys; transom, corner and sidelights on both floors; central spiral stair w/open string; turned balusters; double doors; doorways in hall have pilasters w/heavy cornice mold; shouldered architraves down and up; mantels are heavy Grk. (over)</b> (Continue on Back)		No. Stories <b>2</b> <span style="border: 1px solid black; padding: 2px;">C</span> Single Pile <input checked="" type="checkbox"/> NA <input type="checkbox"/> Double Pile <input type="checkbox"/> Floor Plan <b>Sing. p. cent.pas.</b> <span style="border: 1px solid black; padding: 2px;">I</span> Structural Fabric <b>Brick/frame</b> A <span style="border: 1px solid black; padding: 2px;">C</span> B <span style="border: 1px solid black; padding: 2px;">D</span> Decorative Fabric <b>Eng. bond -sides</b> A <span style="border: 1px solid black; padding: 2px;">F</span> <b>common bond-front</b> <span style="border: 1px solid black; padding: 2px;">E</span> Roof Form <b>Hip</b>		
19. History <b>See attached and over.</b>		Roll No. <b>26; 27</b> Picture No. <b>30A-34A, 44A; 1A-5A</b> Direction _____		
20. Significance <b>This property is eligible under criterion C. It is one of two L-form houses in county (see Ws-5). The plan is (over)</b>		34. Prepared by: <b>Joe DeSpain</b>		
21. Source of Information <b>*Owner</b>		35. Organization <b>Green Co. Hist. Soc., Inc.</b>		
		36. Date <b>10 May 1983</b>		
		37. Revision Dates <b>1/87</b> 38. Staff Review _____		

DESCRIPTION: (cont.) Rev. w/3" shelves: paneled window aprons in 1st rm. in ell; former stair in rm., now removed; fireplace closed in kitchen on ell; 18' X 18' rms. w/12' ceilings

Outbuilding--smokehouse, brick w/5/1 Eng. bond: gable end: brick cornice.

HISTORY: (cont.) The owner reports that when she took the paper off the walls, she found written in large letters, "Wind your watch sir." Possibly it was a reminder to travelers to keep watches wound.

Oral history reports that some Civil War troops came through, the officers came to the house and asked Mrs. Connors to fix a meal for them, which she did. The officers allegedly stacked their guns in the hall next to a stairway. The soldiers slaughtered the Connors' hogs and cattle and ate. The following morning they went on to the battle of Perryville.

SIGNIFICANCE: (cont.) a development of the popular single-pile center-passage plan. The well-preserved house exhibits fine detailing from the antebellum period.

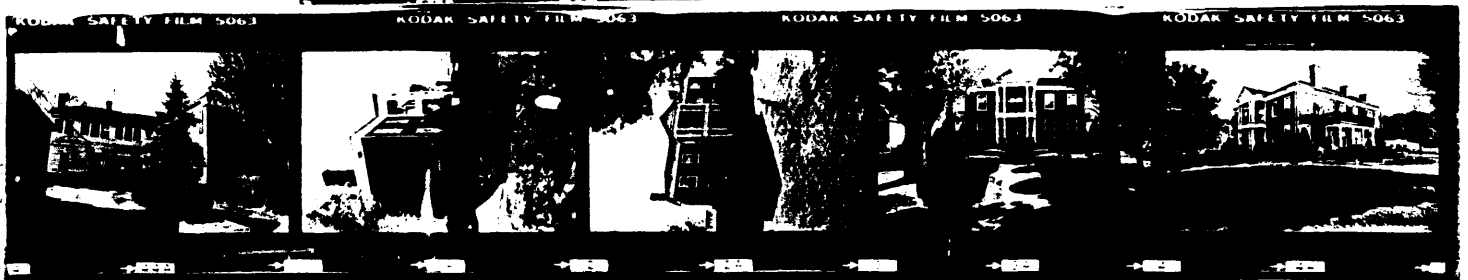
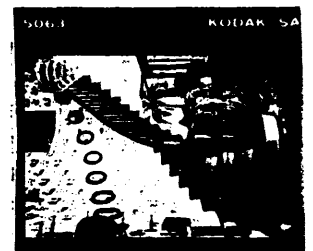

KENTUCKY HISTORIC RESOURCE INVENTORY SUPPLEMENT  
BOUNDARY AND LOCATION INFORMATION

Historic Property Name George Conner House Site # WS-15  
Multiple Resource/Thematic Nomination Title Washington County Multiple Resource Area

U.T.M. Coordinates - List multiple UTM's if property is ten or more acres.

A. 16 645880 4180240 D. \_\_\_\_\_  
B. \_\_\_\_\_ E. \_\_\_\_\_  
C. \_\_\_\_\_ F. \_\_\_\_\_

Verbal Boundary Description Acreege less than 1 acre

Beginning at point A where the private drive joins Old U.S. 150, 125 feet west along north side of drive to point B, following drive, north 125 feet along east side of drive to point C where drive meets south side of road, then southeast 125 feet to curve in highway at point D, thence 75 feet south along west side of old U.S. 150 to point of origin. The boundaries were chosen to encompass the house and domestic-related space as enclosed by a drive and the highway. One contributing brick smokehouse is included.

The nominated area contains two contributing buildings.

Sketch of Site Plan (Showing outbuildings, structures, landscape features and the site boundary as described above.)

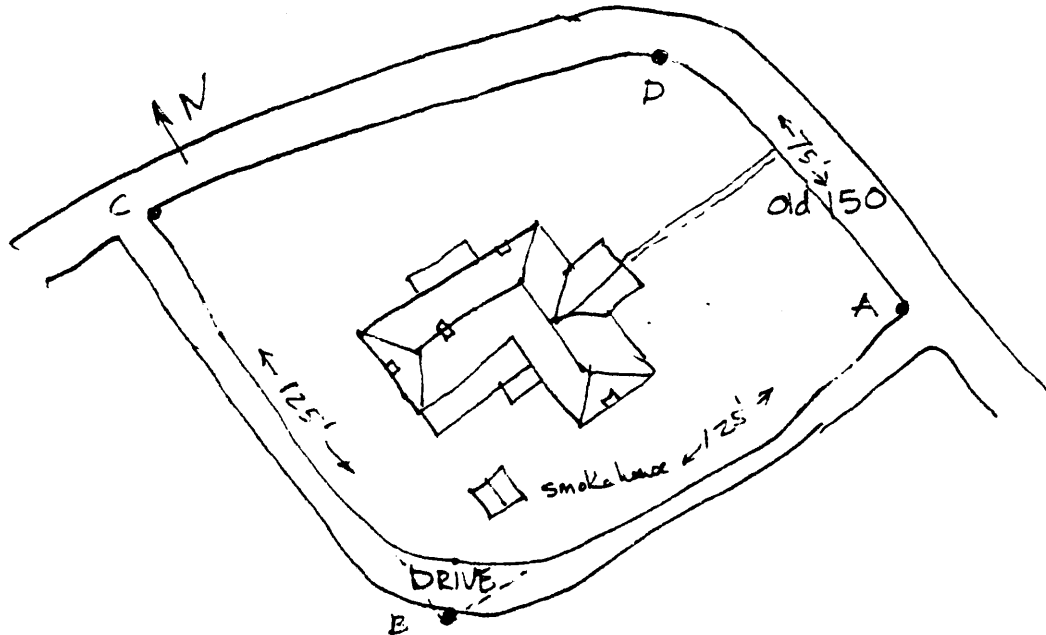

Official Courthouse Property Reference:

Washington County Courthouse, Springfield, Kentucky