

MISSISSIPPI HISTORIC BRIDGE SURVEY

OCT 03 1988

1. Name of Bridge: Shubuta Bridge

2. Location

Code 023

County Clarke USGS Quadrangle Shubuta

Town/vicinity Shubuta vicinity

UTM coordinates:

Zone 16 Easting 340425 Northing 3525635

Acreage less than one Owner Clarke County

Verbal boundary description:

Includes the 18 by 16 ft. bridge spanning the Chickasawhay River east of Shubuta on the county road in Section 10, Township 10 North, Range 7 West.

3. Description

Number of spans 1 Length overall 160 ft. (48.8m)

Span types:

(1) Camelback through truss length 160 ft. (48.8m)

(2) _____ length _____

(3) _____ length _____

Truss span components:

Top chords 2 channel beams and 1 plate

End posts 2 channel beams and 1 plate

Bottom chords 2 rectilinear eye-bars

Hip verticals 2 rectilinear eye-bars

Intermediate posts 4 angle bars laced together to form a composite I-beam

Diagonals see diagram

Counters see diagram

Connections pins

Piers concrete-filled metal caissons

Condition fair

Date of construction 1909

Builder Austin Brothers Bridge Contractors, Atlanta, Ga.

Source plaque on bridge

4. Location of Legal Description

Courthouse, Office of the Chancery Clerk
Registry of Deeds, etc.: Clarke County Courthouse
Street & Number: South Archusa
City, Town: Quitman State: Mississippi

Profile Sketch

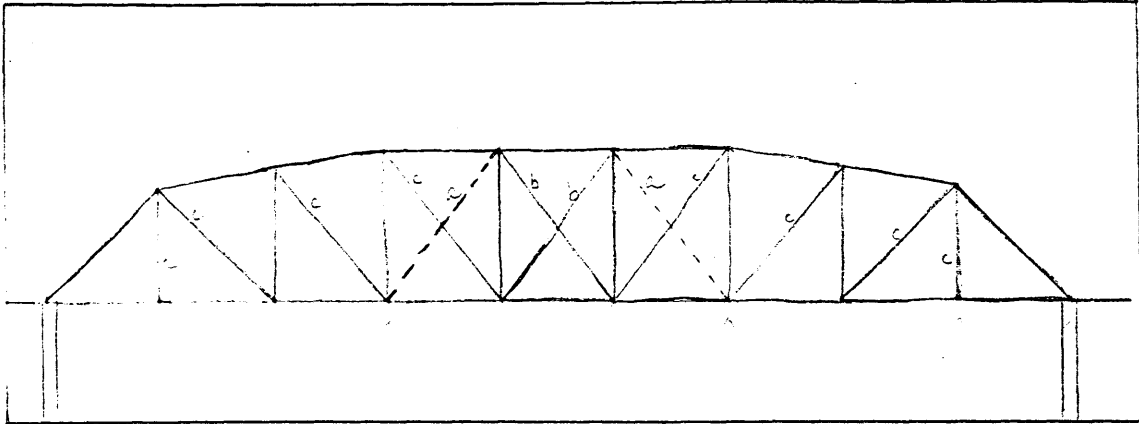

- a - 1 cylindrical eye-bar
- b - 2 cylindrical eye-bars
- c - 2 rectilinear eye-bars

5. Significance

Level of significance:

Local ____; State x ; National ____

Statement of significance:

This bridge consists of one camelback through truss span, which was a commonly used type of truss in early 20th century Mississippi. This bridge is significant in that it embodies "the distinctive characteristics of a type, period, or method of construction."

6. Form prepared by:

Jack D. Elliott, Jr.
Historical Archaeologist
Division of Historic Preservation
Mississippi Department of Archives and History
P.O. Box 571
Jackson, Mississippi 39205