

KENTUCKY HISTORIC RESOURCES INVENTORY

Site No. Bb-131

1. Historic Name(s) <u>James, Eales, house</u>		22. ADD/County <u>Burgess / Bourbon</u>	
Original Owner <u>James Eales?</u>		23. U.S.G.S. Quadrant (15'/75') <u>Shawhan V.C.</u>	
2. Present Name <u>(Riarrbank Farm) Jim Mellere farm</u> <u>James Eales house</u>		24. UTM Reference <u>16 738080 4244140</u>	
3. Location <u>1 mi past end of unnamed public road (in S. Harrison) off SW side Cook Rd, on E side Licking R.</u>		Zone Easting Northing	
4. Owner's Name <u>John D. King</u>		25. Coordinate Accuracy <input type="checkbox"/>	
5. Owner's Address <u>Waksatchee, Texas</u>		26. Prehistoric Site Object Historic Site Structure Building <input checked="" type="checkbox"/> Other	
6. Open to Public Yes <input type="checkbox"/> No <input checked="" type="checkbox"/>	7. Visible from road Yes <input type="checkbox"/> No <input checked="" type="checkbox"/>	8. Ownership Private <input checked="" type="checkbox"/> Local <input type="checkbox"/> State <input type="checkbox"/> Federal <input type="checkbox"/>	
9. Local Contact/Organization <u>Jimmy Jordan, farm manager</u> <u>Route 1, Cynthia, Ky. 41031</u>		27. National Register District Name: <input type="checkbox"/>	
10. Site Plan with North Arrow <u>We attached boundary form</u>		28. Significance Evaluation <input type="checkbox"/>	
11. Architect		29. Status National Landmark <input type="checkbox"/> Date _____ National Register <input type="checkbox"/> Landmark Certificate <input type="checkbox"/> Kentucky Survey <input type="checkbox"/> Local Landmark <input type="checkbox"/> HABS/HAER <input type="checkbox"/>	
12. Builder		30. Historic Theme Primary <u>architecture</u> <input type="checkbox"/> <u>C</u> Secondary <u>settlement</u> <input type="checkbox"/> <u>R</u> Other <input type="checkbox"/>	
13. Date <u>log 1790's?</u> <u>stone 1827?</u> A. <input type="checkbox"/> B. <input checked="" type="checkbox"/>		31. Endangered Yes <input type="checkbox"/> No <input checked="" type="checkbox"/>	
14. Style A. <u>Federal</u> <input checked="" type="checkbox"/> <u>B</u> B. <input type="checkbox"/>		32. Preservation Project Status <input type="checkbox"/>	
15. Original Use <u>residence</u> <input checked="" type="checkbox"/> <u>a</u>		Actual Cost in \$1,000s <input type="checkbox"/>	
16. Present use <u>residence</u>		33. ATTACH PHOTO <u>in attached envelope</u>	
17. Condition <u>excellent</u> <input checked="" type="checkbox"/> <u>a</u>		Roll No. _____ Picture No. _____ Direction _____	
18. Description <u>3 bay, 1 3/4 story log house</u> <u>with 3 bay 2 story dry stone</u> <u>wing connected by enclosed</u> <u>"dog trot." Log house has</u> <u>stone chimney on W. end;</u> <u>former barn stair in</u> <u>NW corner beside fireplace;</u> <u>3 stone ashlar arch in</u> <u>fireplace w shelf mantel;</u> <u>(Continue on Back) (over)</u>		34. Prepared by: <u>C.M. Wooley</u>	
19. History <u>Not determined</u> <u>Earliest known owner was James Eales</u> <u>(b. 1789, d. 1853) who bought land in 1827.</u> <u>Cemetery has names: Eales, Cleaver,</u> <u>Sharpe, Downing, David, Wilson</u>		35. Organization _____	
20. Significance <u>Very good early log and stone</u> <u>house in good condition, beautiful</u> <u>setting.</u>		36. Date <u>1982</u>	
21. Source of Information <u>18 inspection</u> <u>19 Mrs. W.F. Whitley</u>		37. Revision Dates _____ 38. Staff Review _____	

18. Look:

Small windows 2nd floor due to low roof line; hewn joists, pegged rafters, no collars, stone foundation.

Very good quarried stone wing has 7 stone pousseirs w.o. pegs; vertically tooled square edge stone door sill and steps w.o. nailing (common to S.R. period). Three bays 1st floor, 2 on 2nd; on rear 1 window up, 1 door down. Frames are not pegged and have unique shaped trim: 8 panel front door, pegged; panelled returns - exterior of front door, interior at windows. Pit sawn joists, interior beaded board doors, shelf mantel like in log section. Exterior stone chimney East.



Entrance to 2nd floor of stone wing is from a panelled corner stair in NW corner of "dog trot" (indicates stone house post-dates log house); pit sawn joists here also.

House is in process of renovation - interior walls studded out to hold insulation, bathrooms & closets added in dog trot, new shake roof, modern heating, plumbing, wiring. Presently exposed are nailing blocks for chair rail, pegged hearth cradle, pit saw marks on joists, large timber lintels on inside above window openings to support interior side of double walls. Seems to have been a single room plan (w. 1 chimney); no visible evidence of a partition wall or stair.

One story frame ell on rear.

House located on slight rise in broad valley of Licking River at the ford at Townsend Creek. In pasture, 200 ft in front of house, is large stone-walled cemetery; wall has stone stile. A log dependency W of house is gone. Spring in valley NW of house. Frame outbuilding in rear yard (photos 6, 7)

B. Coat. (p. 3):

with root cellar underneath. Up lane
E of house is a barn, part of which has (photo 8)
log framing. House is at end of long
beautiful driveway 1 mile from end of
road, on large well-tended horse farm.

VERBAL BOUNDARY DESCRIPTION & JUSTIFICATION

Beginning at A at the fence corner in the SE corner of the yard, thence with fence 140 ft W to B, thence 190 ft N to C, thence leaving fence at right angle 140 ft E to D at the fence, thence S 190 ft to the beginning containing the log house, stone house, and root cellar - about 2/3 acre.

They also showed the location of the log house & stone house.

SKETCH MAP OF SITE SHOWING BOUNDARIES AND KEY BUILDINGS AND FEATURES WITH NORTH ARROW.

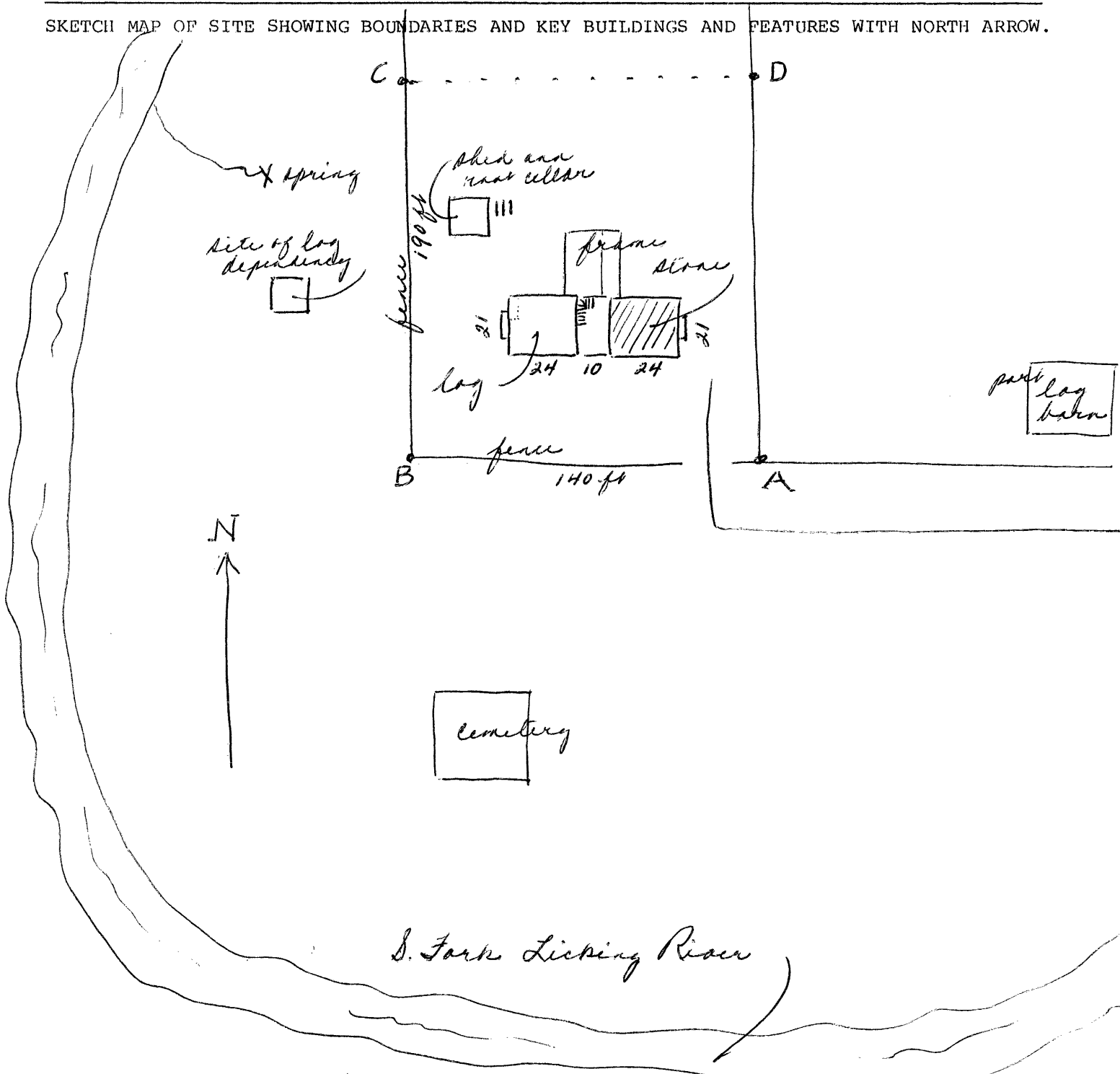

KENTUCKY HISTORIC RESOURCES INVENTORY

Site No. Bb-131

1. Historic Name(s) <u>James, Eales, house</u>		22. ADD/County <u>Burgess / Bourbon</u>	
Original Owner <u>James Eales?</u>		23. U.S.G.S. Quadrant (15'/75') <u>Shawhan V.C.</u> G.I.S. Mod. <input type="checkbox"/>	
2. Present Name <u>(Riarrbank Farm) Jim Mellere farm</u> <u>James Eales house</u>		24. UTM Reference <u>16 738080 4244140</u>	
3. Location <u>1 mi past end of unnamed public road (in S. Harrison) off SW side Cook Rd, on E side Licking R.</u>		Zone Easting Northing	
4. Owner's Name <u>John D. King</u>		25. Coordinate Accuracy <input type="checkbox"/>	
5. Owner's Address <u>Waksatchee, Texas</u>		26. Prehistoric Site Object Historic Site Structure Building <input checked="" type="checkbox"/> Other	
6. Open to Public Yes <input type="checkbox"/> No <input checked="" type="checkbox"/>	7. Visible from road Yes <input type="checkbox"/> No <input checked="" type="checkbox"/>	27. National Register District Name: <input type="checkbox"/>	
8. Ownership Private <input checked="" type="checkbox"/> Local <input type="checkbox"/> State <input type="checkbox"/> Federal <input type="checkbox"/>		28. Significance Evaluation <input type="checkbox"/>	
9. Local Contact/Organization <u>Jimmy Jordan, farm manager</u> <u>Route 1, Cynthia, Ky. 41031</u>		29. Status Date National Landmark <input type="checkbox"/> National Register <input type="checkbox"/> Landmark Certificate <input type="checkbox"/> Kentucky Survey <input type="checkbox"/> Local Landmark <input type="checkbox"/> HABS/HAER <input type="checkbox"/>	
10. Site Plan with North Arrow <u>We attached boundary forms</u>		30. Historic Theme Primary <u>architecture</u> <input type="checkbox"/> <u>C</u> Secondary <u>settlement</u> <input type="checkbox"/> <u>R</u> Other <input type="checkbox"/>	
11. Architect		31. Endangered Yes <input type="checkbox"/> No <input checked="" type="checkbox"/>	
12. Builder		32. Preservation Project Status <input type="checkbox"/>	
13. Date <u>log 1790's?</u> <u>stone 1827?</u> A. <input type="checkbox"/> B. <input checked="" type="checkbox"/>		Actual Cost in \$1,000s <input type="checkbox"/>	
14. Style A. <u>Federal</u> <input checked="" type="checkbox"/> B. <input type="checkbox"/>		33. ATTACH PHOTO <u>in attached envelope</u>	
15. Original Use <u>residence</u> <input checked="" type="checkbox"/>			
16. Present use <u>residence</u>			
17. Condition <u>excellent</u> <input checked="" type="checkbox"/>			
18. Description <u>3 bay, 1 3/4 story log house with 3 bay 2 story dry stone wing connected by enclosed "dog trot." Log house has stone chimney on W. end; former barn stair in NW corner beside fireplace; 3 stone ashlar arch in fireplace w shelf mantel;</u> (Continue on Back) (over)		No. Stories <u>2</u> <input checked="" type="checkbox"/> Single Pile <input checked="" type="checkbox"/> NA <input type="checkbox"/> Double Pile <input type="checkbox"/> Floor Plan <u>stone; single cell</u> <input checked="" type="checkbox"/> Structural Fabric <u>log/stone</u> A. <input checked="" type="checkbox"/> B. <input checked="" type="checkbox"/> Decorative Fabric <u>duplex notched logs</u> A. <input checked="" type="checkbox"/> <u>massive</u> B. <input checked="" type="checkbox"/> Roof Form <u>gable</u>	
19. History <u>Not Substantiated</u> <u>Earliest known owner was James Eales (b. 1789, d. 1853) who bought land in 1827. Cemetery has names: Eales, Cleaver, Sharpe, Downing, David, Wilson</u>		Roll No. _____ Picture No. _____ Direction _____	
20. Significance <u>Very good early log and stone house in good condition, beautiful setting.</u>		34. Prepared by: <u>C. M. Wooley</u>	
21. Source of Information <u>18 inspection</u> <u>19 Mrs. W. H. Whitley</u>		35. Organization _____	
		36. Date <u>1982</u>	
		37. Revision Dates _____ 38. Staff Review _____	

18. Look:

Small windows 2nd floor due to low roof line; hewn joists, pegged rafters, no collars, stone foundation.

Very good quarried stone wing has 7 stone pousseirs w.o. pegs; vertically tooled square edge stone door sill and steps w.o. nailing (common to S.R. period). Three bays 1st floor, 2 on 2nd; on rear 1 window up, 1 door down. Frames are not pegged and have unique shaped trim: 8 panel front door, pegged; panelled returns - exterior of front door, interior at windows. Pit sawn joists, interior beaded board doors, shelf mantel like in log section. Exterior stone chimney East.

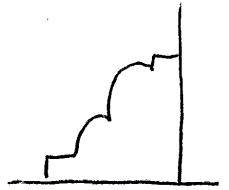

Entrance to 2nd floor of stone wing is from a panelled corner stair in NW corner of "dog trot" (indicates stone house post-dates log house); pit sawn joists here also.

House is in process of renovation - interior walls studded out to hold insulation, bathrooms & closets added in dog trot, new shake roof, modern heating, plumbing, wiring. Presently exposed are nailing blocks for chair rail, pegged hearth cradle, pit saw marks on joists, large timber lintels on inside above window openings to support interior side of double walls. Seems to have been a single room plan (w. 1 chimney); no visible evidence of a partition wall or stair.

One story frame ell on rear.

House located on slight rise in broad valley of Licking River at the ford at Townsend Creek. In pasture, 200 ft in front of house, is large stone-walled cemetery; wall has stone stile. A log dependency W of house is gone. Spring in valley NW of house. Frame outbuilding in rear yard (photos 6, 7)

B. cont. (p. 3):

with root cellar underneath. Up lane
E of house is a barn, part of which has (photo 8)
log framing. House is at end of long
beautiful driveway 1 mile from end of
road, on large well-tended horse farm.

VERBAL BOUNDARY DESCRIPTION & JUSTIFICATION

Beginning at A at the fence corner in the SE corner of the yard, thence with fence 140 ft W to B, thence 190 ft N to C, thence leaving fence at right angle 140 ft E to D at the fence, thence S 190 ft to the beginning containing the log house, Stone house, and root cellar - about 2/3 acre.

They also showed the location of the log house & stone house.

SKETCH MAP OF SITE SHOWING BOUNDARIES AND KEY BUILDINGS AND FEATURES WITH NORTH ARROW.

