

HISTORIC PRESERVATION UNIT
 DEPARTMENT of CULTURE & HISTORY
 SCIENCE & CULTURE CENTER
 CHARLESTON, WEST VIRGINIA 25305

FILE No: PH
 Theme(s):
 Neg No(s):
 USGS Quad:
 UTM Ref: 17 451 750 43/46 560

DISTRICT. SITE. BUILDING. STRUCTURE. OBJECT

1. NAME(S), historic/common: R. Wild House / Case House

(Downtown Parkersburg MAR)

2. LOCATION, street/road: 710 Ann St. (S corner of
TAX MAP - LOT # 8th & Ann Sts)

90-1 city/town: Parkersburg, WV 26101
 (incorporated/unincorporated)

3. USE/FUNCTION, present: residential

(public/private, restricted)

original: residential

4. OWNER/ADDRESS, present: Mary A. & Ruth A. Case
address above

(public/private)

original: R. Wild

5. PHOTO/SKETCH OF: 8112-R3-F11-13

7. PLAN (include approx. dimensions):



6. LOCALE/ENVIRONMENT (map):

8. ACREAGE (approx):

42' x 90'

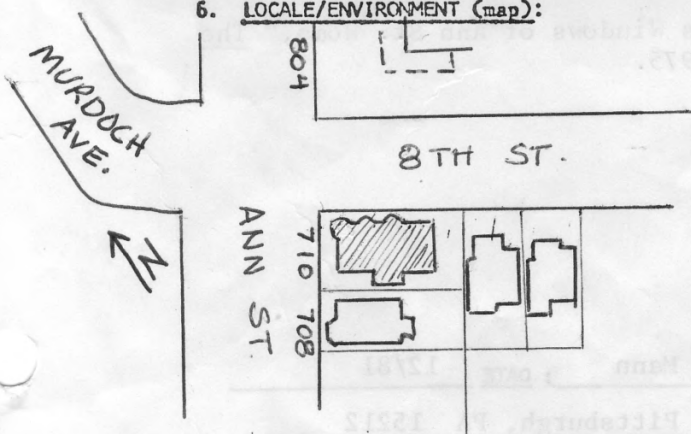

COUNTY: Wood
 Survey Region: _____
 Planning District: _____

9. DESCRIPTION (clarify as appropriate): See attached

a. Exterior Fabric

stone _____
 brick X _____
 concrete _____
 stucco _____
 weatherboard _____
 clapboard _____
 board & batten _____
 shingle on gable _____
 other _____

b. Structural System

masonry X _____
 frame _____
 log _____
 metal _____
 other _____
 foundation stone _____

c. Roofing Material

wood _____
 metal _____
 slate _____
 tile _____
 asphalt _____
 composition X _____
 other _____

d. Associated Structures (use/type):

outbuildings _____

 dependencies _____

 other _____

e. Integrity (include dates):

original site/relocated _____
 alterations removal of tower
 roof _____

 additions porch at E corner

f. Condition:

excellent _____
 good X _____
 fair _____
 deteriorated _____
 abandoned _____

g. Threats:

10. SIGNIFICANCE (use additional sheet if necessary):

a. Architect/Builder/Engineer:

b. Style/Period: Queen Anne

c. Date(s): c.1901

This house was built in c.1901 by R. Wild, who operated a bakery in the 200 block of Ann St. The George Case family moved into the house in 1908 and has occupied it ever since. Case owned the Case Manufacturing Co., also in the 200 block of Ann St. The house is notable for its finely crafted stained glass windows portraying two scenes of Cupid, two from Shakespeare, one of children frolicking, one of a woman cooking, and one of Queen Louise of Prussia (c.1800-1810).

11. BIBLIOGRAPHY:

"History Comes Alive in Stained Glass Windows of Ann St. Home," The Parkersburg News, Sunday, March 9, 1975.

12. FORM PREPARED BY Eliza Smith, Christina Mann ; DATE 12/81

a. Address Allegheny Square West, Pittsburgh, PA 15212

b. Organization Landmarks Planning, Inc.

R. Wild House/ Case House
710 Ann St. (S corner of 8th & Ann Sts.)
90-1

This 2½ story Queen Anne house on a corner lot has a characteristically picturesque plan and silhouette. Its multigabled roof is pierced by 3 tall chimneys; the gable ends are shingled and contain various window configurations, mostly d/s (diamond panes/1). A 3 story polygonal tower, now flat roofed, dominates the N corner. Most of the 1st and 2nd story windows are d/s (1/1); on the NE side they are curved to conform to 2 rounded projecting bays. The porch across the NW side is 3 bays with a hip and intersecting gable roof on paired, slender wooden columns. The balustrade below is stone. The doorway is contained in a broad rounded arch and is flanked by 2 elliptical stained glass windows; above the doorway is a pair of arched windows set in a similar arch. A one story enclosed porch is at the E corner.



R. Wild (1907) Case House
110 Ann St. (corner of 6th & Ann St.)
30-1

This 2 1/2 story Queen Anne house on a corner lot has a characteristically picturesque plan and elevation. Its mansard roof is pierced by 3 tall chimneys; the gable ends are angled and contain various window configurations, mostly bays (diamond gables). A 3 story polygonal tower, now flat roofed, dominates the W corner. Most of the 1st and 2nd story windows are bays (1 1/2); on the NE side they are curved to conform to a rounded projecting bay. The porch across the NW side is 3 bays with a hip and intersecting gable roof on paired, slender wooden columns. The balustrade below is stone. The doorway is contained in a broad rounded arch and is flanked by 2 elliptical stained glass windows; above the doorway is a pair of arched windows set in a similar arch. A one story enclosed porch is at the E corner.

8112-R3-F13

8112-R3-F12