

FORM A - AREA

JAN 02 1990

Area Letter Form numbers in this Area

WN-J	see description
------	-----------------

MASSACHUSETTS HISTORICAL COMMISSION
80 BOYLSTON STREET, BOSTON, MA 02116

Town Newton (West Newton)

Name of Area (if any) West Newton Village

Center Historic District

Present Use commercial, institutional

General Date or Period 1830s-1930s

General Condition good

Acreage 470,638 sq.ft./ c10.8 acres

Recorded by Candace Jenkins/Susan Abele

Organization Newton Historical Comm.

Date 1/1987; rev. 5/1988

Photos (3"x3" or 3"x5" black & white) Indicate on back of each photo street addresses for buildings shown. Staple to left side of form.

Sketch Map. Draw a general map of the area indicating properties within it. Number each property for which individual inventory forms have been completed. Label streets including route numbers, if any. Indicate north. (Attach a separate sheet if space here is not sufficient).

see attached map

UTM REFERENCE A 19 / 316 260 / 4690 660
B 19 / 316 580 / 4690 910
C 19 / 316 720 / 4690 900
D 19 / 316 740 / 4690 710
E 19 / 316 530 / 4690 600

USGS QUADRANGLE NEWTON

SCALE 1:25000

NATIONAL REGISTER CRITERIA STATEMENT (if applicable)

The West Newton Village Center Historic District possesses integrity of location, design, setting, materials, workmanship, feeling and association. West Newton is the most intact and second largest of Newton's village centers preserving an extensive collection of late 19th and early 20th century commercial and institutional buildings. As such it is a significant illustration of both the city's rapid growth and the expanded services offered in the village by the turn-of-the-century. Significance is also derived from the diverse architectural character of the district which ranges from multi-story 19th century commercial buildings to the streamlined one story blocks popularized in the 20th century; and from small-scale, village-oriented institutional buildings like the library to the imposing Court House/Police Station complex which serves the entire city. The district meets criteria A & C of the NRHP.

ARCHITECTURAL SIGNIFICANCE Describe important architectural features and evaluate in terms of other areas within the community.

The West Newton Village Center Historic District forms a linear corridor along Washington Street, stretching from Lucas Court at the western end to Davis Court at the eastern end, and encompassing the major intersection of Washington and Watertown Streets. It is bordered by railroad tracks and the Massachusetts Turnpike to the south, the Turnpike overpass to the west, residential areas to the north, and less compact/historically cohesive commercial strip development to the east. Excepting Newton Centre, the village of West Newton is the city's largest village center. Further, it is by far the most intact, preserving an extensive collection of late 19th and early 20th century commercial and institutional buildings. The commercial blocks often retain their original storefronts, and the institutional buildings represent a full range of types including church, school, library, police station and courthouse. (see cont. sheet)

HISTORICAL SIGNIFICANCE Explain historical importance of area and how the area relates to the development of other areas of the community.

The building of Newton's second meeting house in 1764 and the separation of the town into an east and west parish in 1778, fixed the location of Newton's fifth village center, which came to be known as West Newton. Improvements to Washington Street, an early east-west route through the town, and the arrival of the railroad in 1834 stimulated development, and were among the factors which lead to the re-location of the town hall from Newton Centre to West Newton in 1849. West Newton remained the site of town and city government until 1932, continuing to develop and building a strong commercial center. The area still retains several nineteenth century structures, namely the Davis Hotel (1831; NR 9/4/86) and Robinson's Block (1875). However today, the buildings in the West Newton Village Centre Historic District are predominantly twentieth century and the commercial focus has broadened from local supply and service oriented business to community-wide business organizations.

(see cont. sheet)

BIBLIOGRAPHY and/or REFERENCES

INVENTORY FORM CONTINUATION SHEET

MASSACHUSETTS HISTORICAL COMMISSION
Office of the Secretary, Boston

p. 1 01 2

Community: Newton (West Newton)	Form No: WN-J
Property Name: West Newton Village Center H.D.	

Indicate each item on inventory form which is being continued below.

ARCHITECTURAL SIGNIFICANCE (cont.)

Individual buildings in the West Newton Village Center Historic District are described below beginning on the north side of Washington Street at Lucas court, and thence proceeding in a loop around the village.

1391-87 Washington Street, dating from 1926 and designed by Schein and Levine, is a one story, cast stone faced commercial block with five storefronts defined by rope moldings; a dentilated cornice trims the parapet. It remains fairly intact except for display windows and transoms.

1385-89 Washington Street, is a one story block sheathed with vinyl shakes; a building permit has not been located so it is uncertain whether or not they cover an older structure.

1381 Washington Street, was previously surveyed as #3541 and is a totally altered, aluminum sided house from the 1860s.

1371-79 Washington Street, wrapping around the corner of Elm Street, dates from 1929, and was designed by Harty & Brown. It is a one story, cast stone faced commercial block distinguished primarily by its leaf molded parapet.

115-19 Elm Street, was previously surveyed as #3540 and is a three story, red brick, Romanesque Revival structure dating from the 1890s.

107-11 Elm Street, at the corner of Border Street, is a small former gas station built in 1938 for the Shell Union Oil Company. It is cast stone faced with Moderne detailing. A rough-faced concrete block auto body shop, probably dating from the same period, also stands on the property.

1357-69 Washington Street, on the northeast corner of Elm Street, was designed in 1927 by George Nelson Jacobs. It is a two story, Classical Revival style block with a rounded corner at the street intersection. It is distinguished by fluted Corinthian pilasters carrying a parapet with a dentilated cornice. The entry to the upper floor at the eastern end is emblazoned with the initials BR for its developer, Bennett Rockman.

Staple to Inventory form at bottom

INVENTORY FORM CONTINUATION SHEET

MASSACHUSETTS HISTORICAL COMMISSION
Office of the Secretary, Boston

Community: Newton (West Newton)	Form No: WN-J
Property Name: West Newton Village Center H.D.	

Indicate each item on inventory form which is being continued below.

Architectural Significance (cont.)

1345-55 Washington Street, was designed in 1940 by Krokyn and Brown. It consists of five cast stone faced storefronts divided by zigurat inspired piers which break through the roofline and give the block a distinctive silhouette. The storefront at #1355 has been badly altered with vinyl shakes, so that it does not appear to be part of the block. This Moderne style block stands at the corner of Cherry Street

On the opposite corner of Washington and Cherry Streets is a small park which is the site of the **Old Town Hall**.

1321 Washington Street, is the Newton Police Headquarters, designed in 1931 by James H. Ritchie & Associates. It is a two story, brick with cast stone trim structure in the Classical Revival style. A projecting three bay frontispiece contains the entry with its severe surround consisting of Corinthian pilasters and entablature with lintel shelf. The building is further trimmed with brick quoins, a full entablature and a parapet with balusters. A terrace with balustrade sets the structure off from the street.

1309 Washington Street, is the Newton Courthouse, also designed in 1931 by James Ritchie & Associates. Like the neighboring Police Headquarters, it is a two story, brick building with cast stone trim. A projecting frontispiece contains a recessed double-leaf entry set behind two Corinthian columns which rise two stories to support the building's entablature which reads: DISTRICT COURT OF NEWTON. Above the entablature is a parapet with balusters.

1291-1301 Washington Street/527-33 Waltham Street, was designed in 1927 by George Nelson Jacobs. It is a one story block faced with buff brick in the parapet and with storefronts defined by cable moldings. The Waltham Street section incorporates the West Newton Post Office.

995 Watertown Street-Robinson Block, is a three story brick High Victorian Gothic style structure, previously surveyed as #3113, and dating from 1875.

955-63 Watertown Street is a one story Classical Revivals style block dating from c1930, but with new storefronts.

INVENTORY FORM CONTINUATION SHEET

MASSACHUSETTS HISTORICAL COMMISSION
Office of the Secretary, Boston

Community: Newton (West Newton)	Form No: WN-J
Property Name: West Newton Village Center H.D.	

Indicate each item on inventory form which is being continued below.

Architectural Significance (cont.)

979 Watertown Street, is a later 20th century gas station, which has recently been rebuilt.

1274-84 Washington Street, is a one story block with a wood frame parapet whose storefronts have recently been rehabilitated; it appears to have been constructed before 1912.

1265-69 Washington Street- Davis Hotel, is a two story, red brick Greek Revival style structure built in 1831, and previously surveyed as #3069. It was individually listed in the National Register on 9-4-86.

1251 Washington Street-Cate Funeral Home, is a small, two story, three bay, brick Classical Revival style structure with a pedimented double-leaf entry and paired brick pilasters at its corners. Although the date of the building is uncertain, its present front dates from 1926, and was designed by Lewis H. Bacon.

1239-47 Washington Street, is a one story, cast stone faced block with classical detail, whose storefronts have been bricked in; it appears to date from the 1920s.

1235 Washington Street, on the east side of Davis Court, is a red brick, Colonial Revival style gas station built in 1930 for the Atlantic refining Company. It is a good example of its fast disappearing type. It is presently not in use.

1 Chestnut Street, is the easternmost of the older commercial blocks on the south side of Washington Street. Now the Bay Bank Middlesex, it was designed in 1932 as the Newton Trust company by James H. Ritchie to harmonize with the existing and adjacent West Newton Memorial Library. It is a free standing, red brick Colonial Revival style structure which rises one story to a gable roof with end chimneys.

25 Chestnut Street, adjacent to the bank, is the former West Newton Memorial Library, now the Barry Price Rehabilitation Center. It resembles the bank in its one story, five bay, gable roof form, and in its red brick construction, but its details are Tudor Revival. It is a 1 1/2 story rectangular plan brick structure enclosed by a slate roof with exposed rafters. Its symmetrical five bay facade is framed by decorative buttresses, and is centered on the projecting entry porch with a prominent half-timbered gable. Paired windows are set in rusticated cast stone surrounds.

INVENTORY FORM CONTINUATION SHEET

MASSACHUSETTS HISTORICAL COMMISSION
Office of the Secretary, Boston

Community: Newton (West Newton)	Form No: WN-J
Property Name: West Newton Village Center H.D.	

Indicate each item on inventory form which is being continued below.

Architectural Significance (cont.)

1274-84 Washington Street, is a rather ordinary one story, red brick faced block with cast stone panels in its parapet. It is distinguished by multi-pane transoms which remain intact throughout the block, which in general is more intact than others. It dates from 1915.

1286-1294 Washington Street, is a well detailed cast stone faced block designed by Krokyn and Brown in 1927. It is distinguished by rope moldings around storefronts with handsome marbelized transoms, and a parapet with egg and dart moldings. Like the adjacent block, this one is quite intact, with some of the stores even retaining original wood paneled doors.

1296-1308 Washington Street was designed as a an identical extension of the above block by the same architect, but ten years later. This block incorporates the aluminum faced West Newton Theater.

1314 Washington Street, at the corner of Highland Street, is the West Newton Savings Bank. Built in 1915, this brick and limestone structure was enlarged in 1935 and again in 1959, to create the harmonious whole that exists today. It is a three bay, Classical Revival style building with the entry occupying the central bay and arched windows with keystones in the outer bays which are defined by paired pilasters. The building is surmounted by a heavy dentilated cornice and a parapet. The quality of its materials - limestone and buff brick laid up in Flemish bond - is unusual.

1326 Washington Street, is the Unitarian Church of 1905-06, designed in the Gothic Revival style by Cram & Ferguson, and previously surveyed as #3117.

492 Waltham Street, the Davis School of 1922 has the honor of being the first municipal school constructed in this fast-growing decade, and also, of being designed by the noted Boston firm - Hartwell and Richardson. It is a nine bay structure with five central window bays, flanked by identical entry bays, and completed by blank (except for raised brick panels) end bays. The entry bays are largely faced with cast stone. The entries are double-leaf and headed by transoms as well as modillioned lintel shelves on carved consoles. The buildings' parapet is accented with panel brick work. The major alteration to the building is the recent replacement of its multi-pane sash with 1/1. Although this change is unfortunate, the original window sizes were at least maintained.

Staple to Inventory form at bottom

INVENTORY FORM CONTINUATION SHEET

MASSACHUSETTS HISTORICAL COMMISSION
Office of the Secretary, Boston

Community: Newton (West Newton)	Form No: WN-J
Property Name: West Newton Village Center H.D.	

Indicate each item on inventory form which is being continued below.

Architectural Significance (cont.)

Verbal Boundary Description and Justification: The West Newton Village Center Historic District is located in the center of the village of West Newton. It includes a total of 22 commercial blocks, 5 institutional buildings and 1 vacant lot that are roughly bounded by Lucas Court (E), Washington Street (S), Davis Court (W) and Watertown and Washington Streets (N); the Davis School on Waltham Street extends the northern boundary slightly. Boundaries are the lot lines of these properties as shown on the attached Engineering Map. The boundaries are drawn to include the core of the village center where intact, historic commercial and institutional buildings are concentrated. The Massachusetts Turnpike, which resulted in the 1960s demolition of historic structures, forms an effective barrier on the south. The Route 16 overpass and Turnpike interchange forms a similar boundary on the west. The northern boundary has been drawn to exclude residential areas while the eastern boundary has been drawn to exclude increasing numbers of modern commercial buildings

HISTORICAL SIGNIFICANCE (cont.)

After the turn-of-the century two large new churches replaced earlier structures and several new commercial structures set the style for West Newton's twentieth century development. A new Unitarian Church (1905-6) was constructed at the corner of Highland Street and ten years later, the Second Church (WN-0124) moved out of the center to a prominent site on Highland Street, overlooking the village. In 1915, the West Newton Savings Bank built a new building on Washington Street opposite the City Hall. Although it was about one third the size of the present structure, its Classical Revival style and limestone and brick construction represented a change from the two and three story, nineteenth century brick and woodframe commercial structures along Washington Street. (The bank was enlarged in 1935 and again in 1959 to bring it to its present size.) The first of a series of one story commercial blocks was also built in 1915 at **1274-1284 Washington Street**. This block of seven stores was located next to the old Unitarian Church, then known as Players Hall, which in 1916 became the home of the newly formed Christian Science Church in Newton.

West Newton lost many of its 19th century structures in the 20s and 30s as one story brick and cast stone commercial blocks replaced older residential and commercial

INVENTORY FORM CONTINUATION SHEET

MASSACHUSETTS HISTORICAL COMMISSION
Office of the Secretary, Boston

Community: Newton (West Newton)	Form No: WN-J
Property Name: West Newton Village Center H.D.	

Indicate each item on inventory form which is being continued below.

Historical Significance (cont.)

structures. Between Elm Street and Lucas Court three new blocks were built and store fronts were added to residential structures. Reuben Kaplan of Chelsea was granted a permit in 1926 to build five brick stores at **1391-1397 Washington Street**. The architects were Schein and Levine of Boston. Although there are no permits on record for the adjacent block at **1401-1407** or the store fronts at **1381-1387**, they appear on the 1929 Atlas. The corner block of five stores at **1371-79 Washington Street** replaced the Central Block (#3540), built in 1894, which was moved back on the lot and now stands, somewhat altered, at **115-119 Elm Street**. The new block was designed by architects Harty & Brown and built 1929. Although the owner of record is listed as Adina Rich of Brighton, (probably the wife of the builder Patrick Rich), this building appears to be the first of a series built by the Kenmore Realty Trust and Newton resident Bennett Rockman.

In 1927 permits were granted to Bennett Rockman and/or Kenmore Realty to build five brick stores at **1286-1294 Washington Street**, a two story building with seven stores and offices at **1357-69 Washington Street**, and a one story block at **1291-1301 Washington Street**. In each case the architect was George Nelson Jacobs, and the builder Patrick Rich. A new post office, at **525 Waltham Street**, was incorporated in the third building which wrapped around the corner of Waltham Street. The layout of the Post Office at that time was done according to a standard plan, #1192.

The biggest change in West Newton and in the block between Waltham and Cherry Streets was caused by demolition of the old city hall, the old Second Church building, and the Peirce School. When Newton voted to become a city in 1873, there was considerable discussion about the need for a new City Hall, but cautious Newtonites made do. The old town hall was refurbished by architect George F. Meacham and the building served as Newton's City Hall until 1932. The adjacent Second Church building was taken over as an annex after the new church on Highland Street was constructed in 1915 and the old Peirce Grammar School building served as the Police Station and Court House. Prior to construction of the present Police Station, **1321 Washington Street** and Court House, **1309 Washington Street**, both of which were designed by James H. Ritchie and Associates, the City Hall annex was demolished and the old Police Station moved to that site. It was finally demolished after the new Police Station and Court House were constructed in 1931. The old City Hall came down after completion of the new City Hall in Newton Centre and today, a park at the corner of Washington and Cherry Streets marks its original location.

Staple to Inventory form at bottom

INVENTORY FORM CONTINUATION SHEET

MASSACHUSETTS HISTORICAL COMMISSION
Office of the Secretary, Boston

Community: Newton (West Newton)	Form No: WN-J
Property Name: West Newton Village Center H.D.	

Indicate each item on inventory form which is being continued below.

Historical Significance (cont.)

James H. Ritchie also designed the Newton Trust Company office, **1 Chestnut Street** at the corner of Chestnut and Washington Street. The one story brick structure, which opened in 1933, was intended to harmonize with the adjacent West Newton Memorial Library, designed by Edward B. Stratton and built in 1925.

The **West Newton Memorial Library, 25 Chestnut Street**, was the first of five new branch libraries to be built by citizen subscription between 1926 and 1939 and given to the City of Newton. The plan was conceived by members of the Community Service Club of West Newton, which, aided by the West Newton Neighborhood House and the Men's Club of West Newton, raised over \$60,000 to build the library. The building was designed by Edward B. Stratton, who was responsible for a variety of buildings in Newton including the Newton Highlands Woman's Club (NH-D) and the block of stores adjacent to the old Strong Block in Waban. Dedication of the library was held on September 29, 1926.

Memorial tablets were inscribed in loving memory of devoted citizens and of men who gave their lives in World War I. In this decade, financial constraints caused the library to close and in 1984 the building was leased to the Barry Price Rehabilitation Center. The branch library is currently housed in the former **Davis School, 492 Waltham Street**, which was closed in 1979 and is now the home of Newton Community Service Centers, Inc.

The Davis School, built in 1922 replaced an earlier Davis School which had become severely overcrowded. The architects were Hartwell and Richardson, who were also responsible for several other schools in Newton including the Hyde School in Newton Highlands (1895, Area B - NR:9-4-86) and the Emerson School (1905) in Newton Upper Falls, as well as the Central Congregational Church (NR: 9-4-86) and the Masonic Hall (1896, DOE), both in Newtonville. The school was named for Seth Davis, a prominent 19th century resident of West Newton, who among other things ran a private academy. Davis lived at nearby 32 Eden Avenue (NR: 9-4-86) and was also the owner of the Davis Hotel which is discussed elsewhere.

In 1937, a permit was granted to Kenmore Realty for the construction of six stores and a brick theater at **1296-1308 Washington Street**. These stores were designed by Krokyn and Brown of Boston. The theater, with its entrance on Washington Street, was set back on the site of the old Unitarian church building, then known as the Players Hall. In 1940 Kenmore Realty was granted a permit to build another five store block at **1345-55**

Staple to Inventory form at bottom

INVENTORY FORM CONTINUATION SHEET

MASSACHUSETTS HISTORICAL COMMISSION
Office of the Secretary, Boston

D. O. O. 1 9

Community: Newton (West NEWton)	Form No: WN-J
Property Name: West Newton Village Center H.D.	

Indicate each item on inventory form which is being continued below.

Historical Significance (cont.)

Washington Street. Architects for this project were also Krokyn and Brown. These stores were located on the site of the Odd Fellows Hall, one of the last major nineteenth century blocks in West Newton. The only similar structure which remains today is the Robinson Block (#3113) at the intersection of Watertown and Washington Streets, which was partially restored in 1986.

The Davis Hotel, **1265-69 Washington Street** (#3069), built in 1831, anchors a small strip of commercial structures on Washington Street at the east end of the commercial center. The store fronts between 1265 and 1269 which incorporate the Davis Hotel are nineteenth century structures which have been altered a number of times. There is no building permit for the adjacent block at **1274-84 Washington Street**, although photographs show that it is on the site before 1912. Permission was granted in 1932 to operate a gas station at the rear of this building. The new station, **978 Watertown Street**, was located in a building, which had housed several other earlier businesses. It was altered by architect Clifford J. White, who made a "new front" for the new gas station. Louis Fabian Bachrach and his heirs owned this complex of buildings for many years.

The Cate Funeral Home at **1251 Washington Street**, which was established in 1861, is probably the oldest business in West Newton. Although there is no permit for the original building, a permit was granted in 1926 to build new brick front on the existing office. Lewis H. Bacon, architect for the Strong Block in Waban (NR 9/4/86) and the former Fire Station at 2044 Beacon Street, was responsible for the new facade. Alterations made in 1959 by architect Albert Kreider included a new interior chapel and new entrance on the right. Next to the Cate Funeral Home, the block at **1239-47 Washington Street** on the corner of Davis Court appears on the 1929 Atlas. Although there is no original building permit, it was probably built in 1926 by the G & S Paper Company of Newton.

The Atlantic Refining Co was granted a permit in 1930 to build a gas station at **1235 Washington Street**. It is one of two small original station buildings dating from the 30s. The other was built in 1938 for the Shell Union Oil Company at **107-11 Elm Street**. The Washington Street station is now vacant and the Elm Street station has been converted to another use. Other gas station sites in the West Newton commercial center were also granted in the 20s and 30s, but they have all been rebuilt.

Staple to Inventory form at bottom

INVENTORY FORM CONTINUATION SHEET

MASSACHUSETTS HISTORICAL COMMISSION
Office of the Secretary, Boston

Community: Newton (West Newton)	Form No: WN-J
Property Name: West Newton Village Center H.D.	

Indicate each item on inventory form which is being continued below.

Historical Significance (cont.)

The effect of the construction of Massachusetts Turnpike Extension was less severe in the West Newton Village Centre Historic District than in Newton Corner, Newtonville, or Auburndale since the railroad tracks and the Turnpike parallel the central area of development rather than cut through it. Lincoln Park, at the west end of the center was taken, along with two 19th century brick blocks located beyond Lucas Court. This area forms and over pass and interchange for the Turnpike, now providing an effective barrier to commercial expansion west-ward along Washington Street. The West Newton railroad station, which was located south of the tracks, between Highland and Chestnut Street was also destroyed to make way for the Turnpike, but the late 19th and 20th century fabric of the center on Washington Street remains intact.

BIBLIOGRAPHY/REFERENCES:

Building Department Records, City Atlases and Directories, Sanborn Atlases
Newton's Nineteenth Century Architecture: West Newton
Newton, Massachusetts 1688-1988

NEWTON, MASS. MULTIPLE RESOURCE AMENDMENT - 1988 - WEST NEWTON VILLAGE CENTER H. D.

<u>Street Address</u>		<u>SBL</u>	<u>Area(sf)</u>	<u>Historic Name</u>	<u>Form#</u>	<u>Date</u>	<u>Style</u>	<u>Status</u>
		31-16-16	6745	Vacant lot				
1	Chestnut St.	33-10-5	7160	Newton Trust Co.		1932	CR	c
25	Chestnut St.	33-10-6	28528	West Newton Branch Library	WN-0115	1925	Tudor	c
107 -11	Elm St.	33-15-30	3350	Shell Union Oil Station		1938	Moderne	c
115 -19	Elm St.	33-15-31	5771	Commercial/Apartments	3540	c.1890	RR	c
492	Waltham St.	31-16-3	62652	Davis School	WN-0128	1922	Panel Brick	c
527 -33	Waltham St.	33-11-13	12047	W. N. Post Office/Stores		1927	Commercial	c
	Washington St.			Park (see SBL 33-11-1)				
1235	Washington St.	31-6-18	7356	Atlantic Refining Co. Sta.		1930	CR	c
1239 -47	Washington St.	31-5-3	13408	Commercial Block		c.1920	Classical Rev.	c
1253	Washington St.	31-5-2	6245	Cate Funeral Home		1926	Classical Rev.	c
1265 -69	Washington St.			Davis Hotel (see SBL 31-5-1)	NR 9/86	1831	Greek Revival	
1274 -84	Washington St.	33-10-4	8246	Commercial Block		1915	Commercial	c
1286 -94	Washington St.	33-10-3	7959	Commercial Block		1927	Commercial	c
1296	Washington St.	33-10-2a	15701	West Newton Theater		1937	Commercial	c
1298 -1308	Washington St.	33-10-2	4790	Commercial Block		1937	Commercial	c
1309	Washington St.	33-11-14	13780	Newton District Court	WN-0131	1931	Classical Rev.	c
1314	Washington St.	33-10-1	17680	West Newton Savings Bank		1915+	Classical Rev.	c
1321	Washington St.	33-11-1	79724	Newton Police Headquarters	WN-0132	1931	Classical Rev.	c
1326	Washington St.	33-8-1	58432	First Unitarian Soc. of Newton	#3117	1905-6	Gothic Revival	c
1345 -55	Washington St.	33-12-1	12845	Commercial Block		1940	Moderne	nc
1357 -69	Washington St.	33-12-2	13006	Commercial Block		1927	Classical Rev.	c
1371 -79	Washington St.	33-15-32	4393	Commercial Block		1929	Commercial	c
1381	Washington St.	33-15-28	9224	Commercial Building	3541	c. 1860	n/a	nc
1385 -89	Washington St.	33-15-33	6134	Commercial Building		19th c.	n/a	nc
1391 -87	Washington St.	33-15-34	3803	Commercial Block		1926	Commercial	c
955 -63	Watertown St.	31-15-20	6635	Commercial Block		c1930	Classical Rev.	c
978	Watertown St.	31-5-1	13540	Commercial (incl. Davis Hotel)		c.1912	Commercial	c
979	Watertown St.	31-16-15	17376	Commercial Building		20th c.	Commercial	nc
989 -1003	Watertown St.	31-16-1	24108	Robinson's Block	#3113	1875	High Vic. Gothic	c

NEWTON, MASS. MULTIPLE RESOURCE AMENDMENT - 1988 - WEST NEWTON VILLAGE CENTER H. D.

Number of buildings	27	Sum of square feet in field "area"	
Number of contributing buildings	23	(Streets not included)	470638
Number of non-contributing buildings	4		
Number of structures	0	Number of vacant lots	1
Number of contributing structures	0		
Number of non-contributing structures	0		
Number of contributing objects	0		

EAGLE-A
Trojan Bond
NEWTON, MASS. 02459

United States Department of the Interior
National Park Service

National Register of Historic Places
Continuation Sheet

Section number _____ Page _____

Multiple Resource Area
Thematic Group

Name Newton MRA
State Middlesex County, MA

Nomination/Type of Review

Date/Signature

- 131. Old Chestnut Hill Historic District
(Boundary Increase) **Substantive Review**

Keeper [Signature] 02-16-90
Attest _____
- 132. Pine Ridge Road--Plainfield Street
Historic District **Entered in the
National Register**

Keeper [Signature] 2/16/90
Attest _____
- 133. Saco-Lowell Shope Housing Historic
District **Entered in the
National Register**

Keeper [Signature] 2/16/90
Attest _____
- 134. West Newton Village Center Historic
District **Entered in the
National Register**

Keeper [Signature] 2/16/90
Attest _____
- 135. Windsor Road Historic District
**Entered in the
National Register**

Keeper [Signature] 2/16/90
Attest _____
- 136. Agudas Achim Anshei Sfard Synagogue
**Entered in the
National Register**

Keeper [Signature] 2/16/90
Attest _____
- 137. Boston Edison Power Station
**Entered in the
National Register**

Keeper [Signature] 2/16/90
Attest _____
- 138. Bruner Mayall, House **Entered in the
National Register**

Keeper [Signature] 2/16/90
Attest _____
- 139. Childs, Mayor Edwin O., House
**Entered in the
National Register**

Keeper [Signature] 2/16/90
Attest _____
- 140. City Stable and Garage
**Entered in the
National Register**

Keeper [Signature] 2/16/90
Attest _____

UNITED STATES DEPARTMENT OF THE INTERIOR
NATIONAL PARK SERVICE

NATIONAL REGISTER OF HISTORIC PLACES
EVALUATION/RETURN SHEET

REQUESTED ACTION: NOMINATION

PROPERTY NAME: West Newton Village Center Historic District

MULTIPLE NAME: Newton MRA

STATE & COUNTY: MASSACHUSETTS, Middlesex

DATE RECEIVED: 1/02/90 DATE OF PENDING LIST: 1/18/90
DATE OF 16TH DAY: 2/02/90 DATE OF 45TH DAY: 2/16/90
DATE OF WEEKLY LIST:

REFERENCE NUMBER: 90000017

NOMINATOR: STATE

REASONS FOR REVIEW:

APPEAL: N DATA PROBLEM: N LANDSCAPE: N LESS THAN 50 YEARS: N
OTHER: N PDIL: N PERIOD: N PROGRAM UNAPPROVED: N
REQUEST: N SAMPLE: N SLR DRAFT: N NATIONAL: N

COMMENT WAIVER: N

ACCEPT RETURN REJECT 2/16/90 DATE

Entered in the
National Register

ABSTRACT/SUMMARY COMMENTS:

RECOM./CRITERIA _____
REVIEWER _____
DISCIPLINE _____
DATE _____

DOCUMENTATION see attached comments Y/N see attached SLR Y/N

CLASSIFICATION

count resource type

STATE/FEDERAL AGENCY CERTIFICATION

FUNCTION

historic current

DESCRIPTION

architectural classification
 materials
 descriptive text

SIGNIFICANCE

Period Areas of Significance--Check and justify below

Specific dates Builder/Architect
Statement of Significance (in one paragraph)

summary paragraph
 completeness
 clarity
 applicable criteria
 justification of areas checked
 relating significance to the resource
 context
 relationship of integrity to significance
 justification of exception
 other

BIBLIOGRAPHY

GEOGRAPHICAL DATA

acreage verbal boundary description
 UTM's boundary justification

ACCOMPANYING DOCUMENTATION/PRESENTATION

sketch maps USGS maps photographs presentation

OTHER COMMENTS

Questions concerning this nomination may be directed to

_____ Phone _____

Signed _____ Date _____



West Newton H.D. Village Center (1.13) Newton, MA-MRA

492 Waltham St.
Newton, MA

C. Jenkins

1/87

req. @ Jackson Homestead

87-4-11



West Newton Village Center H.D. Newton, MA-MRA

1 Chestnut St
Newton, MA

C. Jenkins

1/87

req. @ Jackson Homestead

WN-3

87/3-12



Capt. Marden's

SEA FOOD

FOOD SPIRITS

RESTAURANT

C
10

West Newton H.D. ^{Village Center Unit}

1357-69 Washington St
Newton, MA

Newton, MA-MRA

C. Jenkins

1/87

neg. @ Jackson Homestead

87-4-33



Village Center H.D.
West Newton H.D.
1321 Washington St -
Newton, MA

Newton, MA-MRA

C. Jenkins

1/87

neg. @ Jackson Homestead

87-4-34



Anco

1255

West Newton H.D. ^{46/1/87} ^{Case 14-11}
1235 Washington St.
Newton, MA

Newton, MA-MRA

C. Jenkins

1/87

req. @ Jackson Homeslead

87/3-11



Cooker
REAL ESTATE

HARDWARE

Sears & Roebuck

West Newton Historic District
Village Center (Hill)

Newton, MA-MRA

1274-94 Washington St
Newton, MA.

C. Jenkins

1/87

neg. @ Jackson Homestead

87/3-13

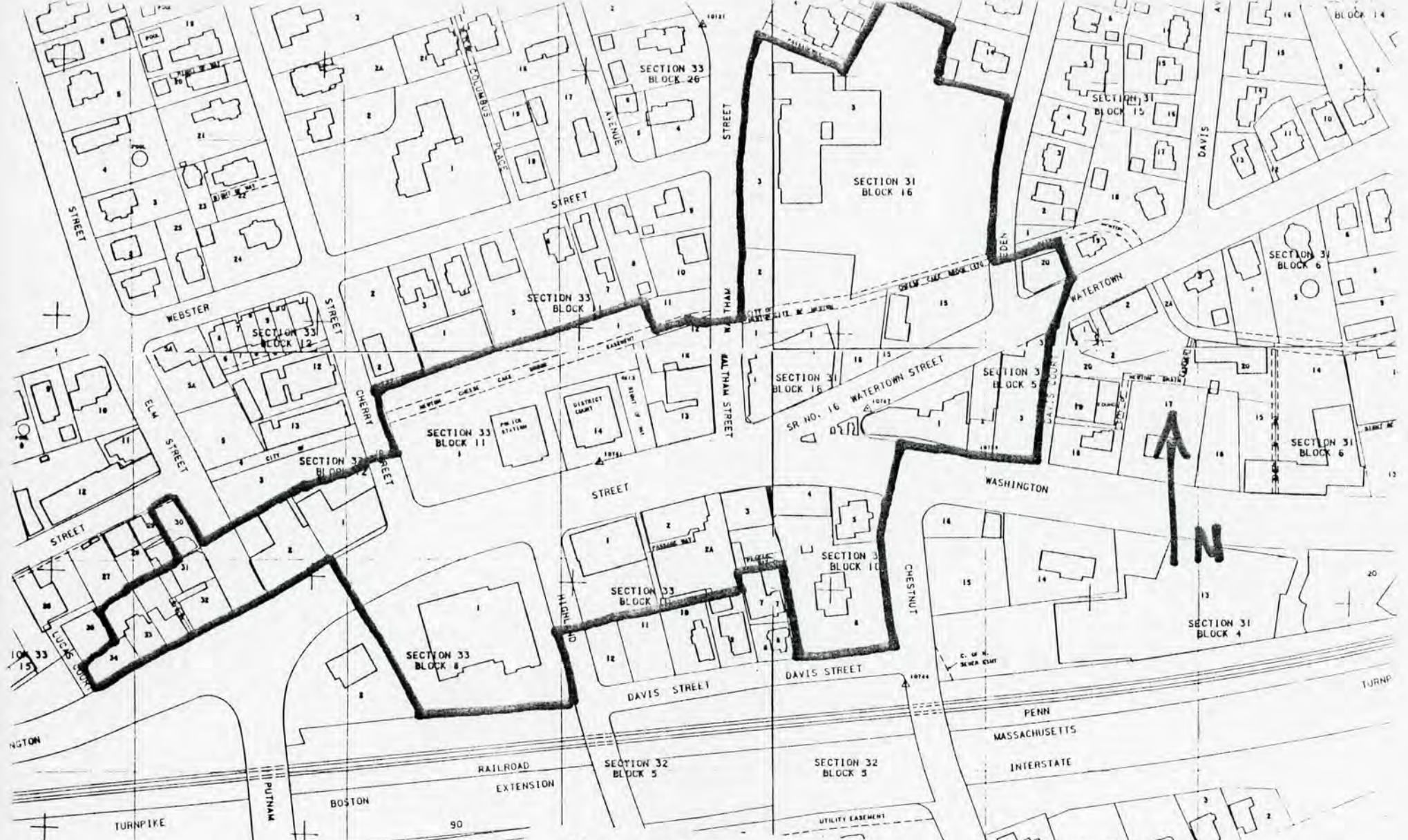

Newton, MA-MRA

West Newton Village Center
 Historic District
 Engineering Map 1979
 Scale: 1"=1000 Reduced 64%
 Page: 28, 29, 41, 42