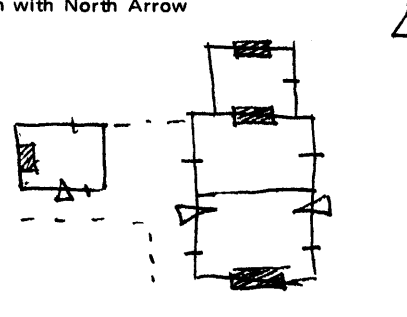

KENTUCKY HISTORIC RESOURCES INVENTORY

1. Historic Name (s) <u>FEDERAL HOUSE ON HICKMAN CREEK</u> <i>Muir</i>		22. ADD/County <u>Bluegrass/Jessamine</u>	
Original Owner		23. Zoning Classification <u>Magisterial District</u>	
Present Name		24. U.S.G. S. Quadrant (15'/75') <u>Valley View</u>	
3. Owner's Name <u>Ms. Hazel Johns</u>		25. UTM Reference <u>116</u> <u>719960</u> <u>4194120</u> Zone Easting Northing	
4. Owner's Address <u>102 Garden Park, Nicholasville, Ky. 40356</u>		26. Prehistoric Site <u>Building</u>	
5. Location <u>s. side Old Railroad Lane; 1 mi. w. from Logana</u>		Object Structure	
6. Open to Public Yes <input type="checkbox"/> No <input checked="" type="checkbox"/>	7. Visible from road Yes <input type="checkbox"/> No <input checked="" type="checkbox"/>	27. District Name: <u>Yes</u> <input checked="" type="checkbox"/> <u>No</u> <input type="checkbox"/>	
9. Local Contact/Organization		28. Significance Evaluation <u>National Register</u>	
8. Ownership Private <input type="checkbox"/> Local <input type="checkbox"/> State <input type="checkbox"/> Federal <input checked="" type="checkbox"/>		29. Status National Landmark <input type="checkbox"/> National Register <input type="checkbox"/> Landmark Certificate <input type="checkbox"/> Kentucky Survey <input type="checkbox"/> Local Landmark <input type="checkbox"/> HABS/HAER <input type="checkbox"/>	
10. Site Plan with North Arrow 		11. Architect	
12. Builder		13. Date <u>1st 1/3 19th century</u>	
14. Style <u>Federal</u>		15. Original Use <u>house</u>	
16. Present Use <u>house</u>		30. Theme Primary <u>architecture</u>	
17. Condition Interior <u>good</u> Exterior <u>good</u>		Secondary <input type="checkbox"/> Other <input type="checkbox"/>	
18. Description <u>2-story, 3 bay brick; 6 over 6 windows; hall-parlor plan; running key in cornice; crossette architrave at main door; Flemish bond, jack arches, closers, 3-course belt course; original brick kitchen on w and original brick wing on n.</u>		31. Endangered <u>No</u>	
19. History <u>1877 atlas - S. Muir</u>		32. <u>ATTACH PHOTO</u>	
20. Significance <u>Architecture: this house is a particularly good example of the combination locally of traditional elements (hall-parlor plan) and Federal features; it is one of the best examples of Federal style architecture in the county.</u>		Roll No. <u>10</u> Picture No. _____ Direction _____	
21. Source of Information		33. Tape No. _____ Negative No. _____	
		34. Prepared by: <u>NCP- KTG</u>	
		35. Organization <u>KHC</u>	
		36. Date <u>summer 1977</u>	
		37. Revision Dates _____ 38. Staff Review _____	

6/2/77

Federal house on Hickman Creek  
Multiple Resources of Jessamine Co., Ky.

UJM =	A.	16 720280	4194380	Valley View
	B.	16 719920	4193950	" "
	C.	16 719730	4194010	Little Hickman
	D.	16 719900	4194670	Valley View

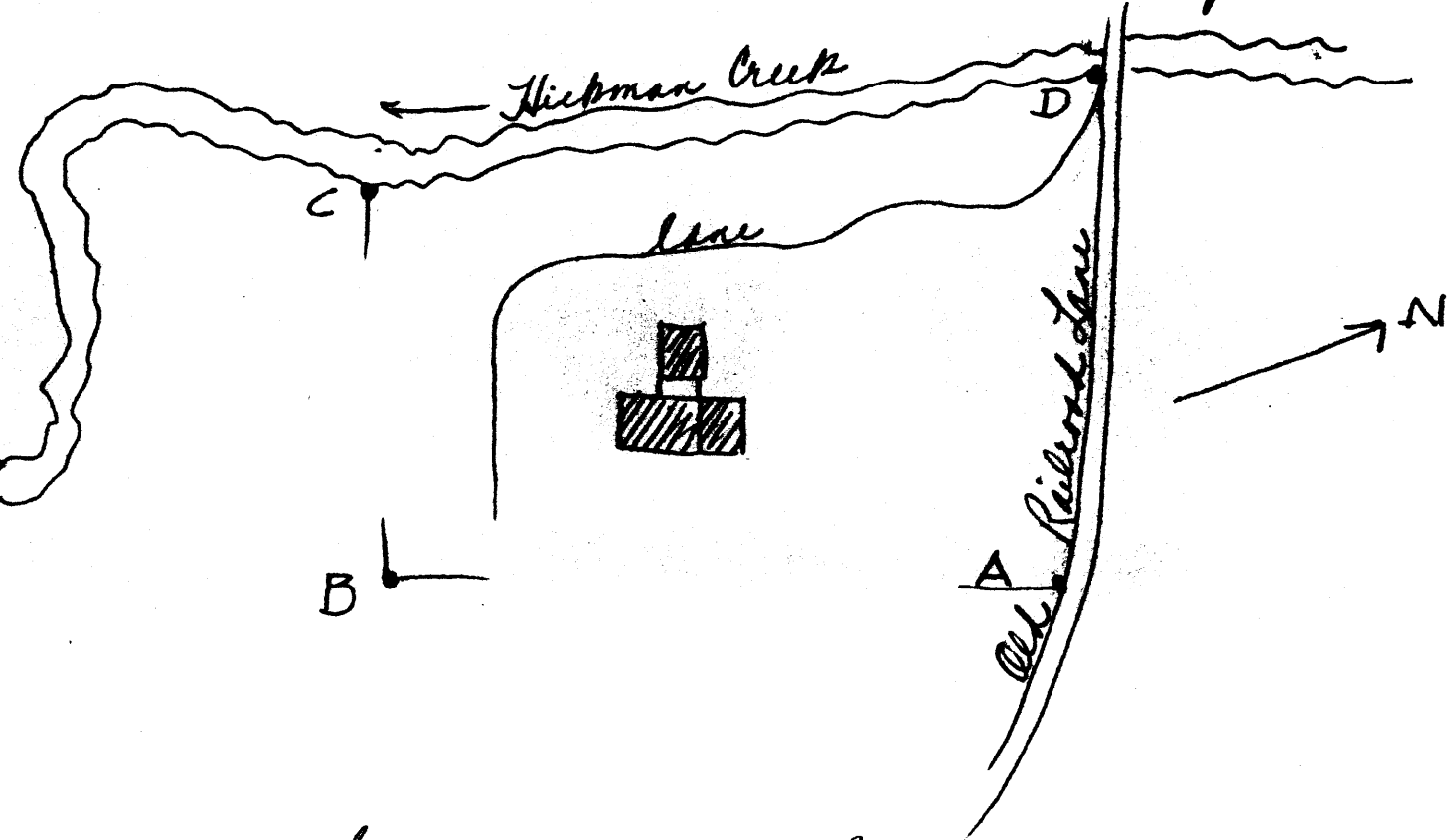

Site enclosed by A. B. C. D. as shown  
C-D is with Hickman Creek; B-A is with  
the Railroad Line. No other outbuildings  
survive. Includes ca. 36 acres