

Photos attached

STANDING STRUCTURES SURVEY

Site Number #4

I. ☒ PARISH Rapides

MUNICIPALITY N/A

☒ USGS QUAD Rapides, LA

Township 4N Range 2W Section 71

TYPE OF PROPERTY residence

NAME (common) (Brown House)

NAME (historic) Oxland

ADDRESS Hwy. 1202 on north side of
Bayou Rapides @ 6 miles from Alexandria ^{Vic.}

DATE OF CONSTRUCTION c.1825;c.1840

II. 1. Condition fair

2. Style Federal-Greek Revival

3. Floor Plan see below

4. Building Material wood frame

UTMs: 15/540310/3465680

III. Physical description of property and historic significance

Oxland is the largest of the Bayou Rapides houses. It consists of a c.1825 house with a central hall plan, two rooms deep, and a c.1840 side wing.

The older portion features Federal window and door surrounds, nine over nine windows, and two transitional Federal-Greek Revival mantels. The door and window surrounds with their molded fascia boards and corner blocks are significant because they are unique in the parish.

The c.1840 addition features plain corner blocks and unmolded fascia boards on the fenestration surrounds. It also has two aedicule style mantels and six over nine floor-length windows. It retains its original four bay gallery complete with Doric posts and entablature.

In the twentieth century the house received a new roof structure. (The old shape was retained.) The only visual evidence of the new roof is the dormer atop the original portion of the house and the bungalow brackets and rafter ends. The original house was also fitted with new rear windows and new gallery columns. Despite these alterations, Oxland's large c.1840 wing is little altered and stands as a good example of local Neo-Classical architecture.

IV. Recorded by N/A

Date _____

For _____

V. Sources consulted N/A (OVER)

In addition, the original part is noteworthy for its Federal woodwork, which remains intact. The new roof has had minimal visual impact and the dormer and bungalow brackets and rafter ends are easily removable. Although the columns on the original portion of the house have been lost, an original corner pilaster survives; so it would be possible to duplicate the original columns exactly.

To the rear of the house is a c.1930 shed which is considered a contributing element because as an outbuilding it helps establish Oxland's identity as a plantation house.

Bayou Rapides Thematic Nomination
Rapides Parish, LA

DEC 5 1994



NOT TO SCALE

Boundary Justification:

Boundaries were chosen to encompass the house, the bayou vista in front, and the immediate setting to the rear. They cut relatively closely around the sides and the rear in order to exclude nearby non-contributing elements.

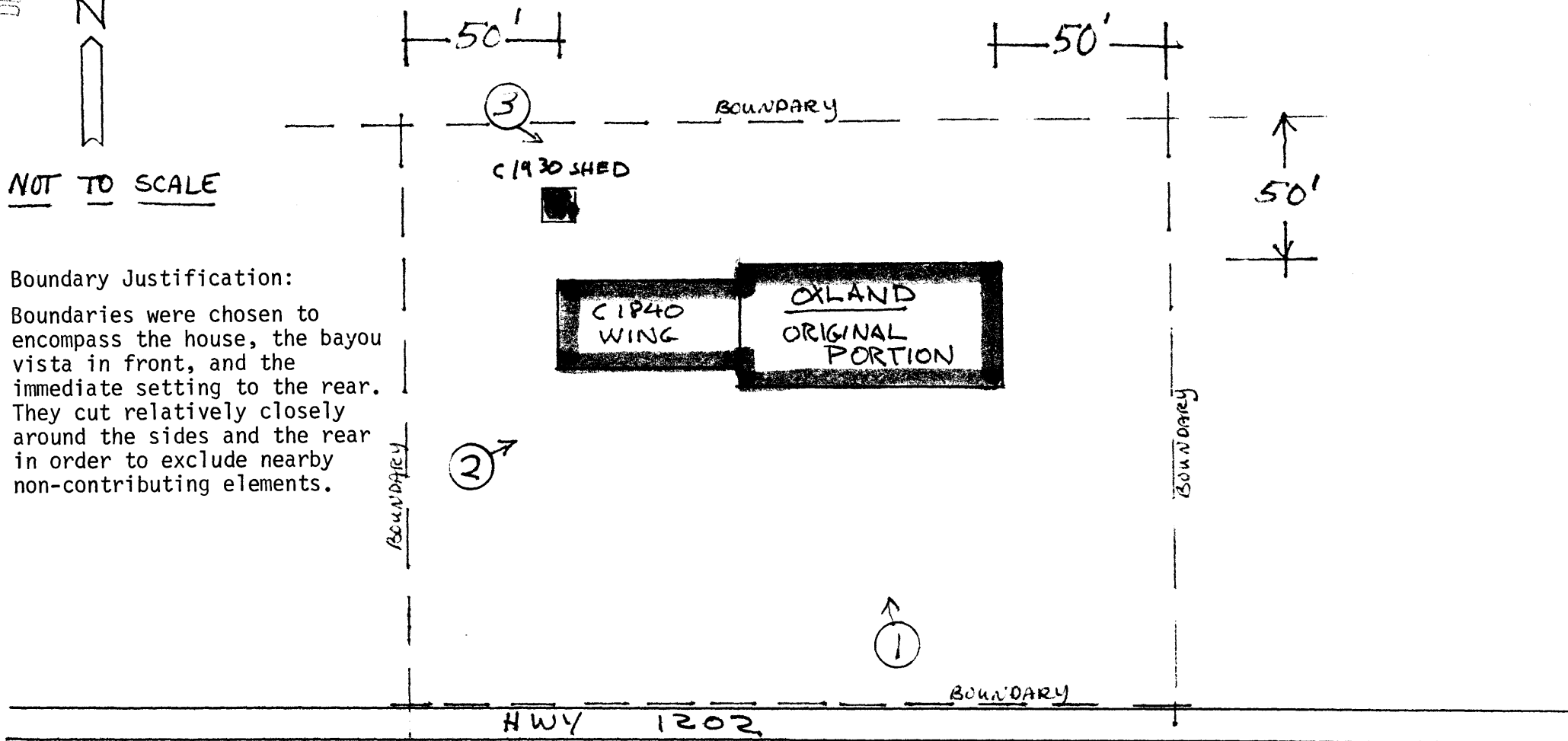

BOUNDARIES: South boundary runs along the north edge of Hwy 1202.
Others parallel house facades at distances shown.

APPROX. 1 ACRE