



Historic Sites Survey

Inventory No. 19

ARCHITECTURAL DESCRIPTION: The Walton-Howry House is a one-story, gable-roofed, L-shaped frame cottage on a residential lot facing west. The steeply-pitched gable roof is intersected by the gable of the front pavilion at the northwest corner which is distinguished by paired segmental-arch two-over-two-over-two windows surmounted by a richly molded entablature. The main entrance is a single-leaf door with a transom and sidelights. The remaining fenestration on the facade consists of two-over-two-over-two triple-hung floor-to-ceiling windows set in segmental-arch surrounds. A three-bay flat-roofed porch extends southward from the pavilion to the southwest end of the facade. The slender turned posts are flanked by pierced fan brackets and joined by an elaborate sawn balustrade. A long gallery, supported by turned posts with small carved brackets and slender turned balusters, extends eastward from the south elevation of the main block of the house and wraps around to the rear elevation. The house sits on four-foot high brick piers between which are walls of brick latticework. Each gable has a circular cast-iron ventilator. Interior highlights include wooden blinds for the windows. Everything ALTERATIONS: (continued)

Gallery on south elevation screened in, rear section of gallery (east elevation) enclosed. Small shed-roof addition to kitchen ell.

OUTBUILDINGS:

One-story, gable-roofed L-shaped storage shed and garage.

LANDSCAPE FEATURES:

Profusion of magnolia trees.

STATEMENT OF SIGNIFICANCE:

Built for Captain E. J. Walton in 1888 by Andrew Johnson, the Walton-Howry House illustrates the evolution and culmination of Johnson's distinctive L-shaped cottage plan.

NAME: Walton-Howry House
 STREET NO: 308 South Main Street
 TOWN/VIC: Sardis
 COUNTY: Panola
 BLOCK/LOT: See Verbal Boundary Description
 PRESENT OWNER: Ms. Sarah C. Price
 ADDRESS P. O. Drawer G, Sardis, Mississippi 38666
 PRESENT USE: Residence
 FORMER USE: Residence
 DATE: 1888
 STYLE: Vernacular Italianate cottage
 ARCH/BUILDER: Andrew Johnson
 SOURCE OF DATE: Southern Reporter, March 23, 1888
 ENVIRONMENT: and May, 1888
 Residential
 LEVEL OF SIGNIFICANCE
 NEIGHBORHOOD
 LOCAL
 STATE X
 NATIONAL

PHOTOS

NEG. #

SITE OR AREA PLAN WITH NORTH ARROW AND SHAPE OF STRUCTURE:

CONTINUATION:

ARCHITECTURAL DESCRIPTION

about this cottage--from the steeply-pitched gable roof with ventilators at the gable ends, to the segmental-arch windows, to the three-bay gallery with slender posts, intricate brackets and balustrade--marks this as typical Andrew Johnson cottage of the 1880s. Especially interesting are the paired windows of the pavilion, which produce the trompe l'oeil effect of a four-bay square-cut window of the Taylor-Falls House.

PHYSICAL CONDITION:

Excellent

THREATS:

None

VERBAL BOUNDARY DESCRIPTION:

R. W. Crump Survey of 1871, Town of Sardis
Res Block 6, Sec 35 T7 R7

ACREAGE: less than one

UTM REF:

A	1 6	2 3 2 0 5 0	3 8 1 3 7 5 0
	ZONE EASTING		NORTHING
C			
B			
	ZONE EASTING		NORTHING
D			

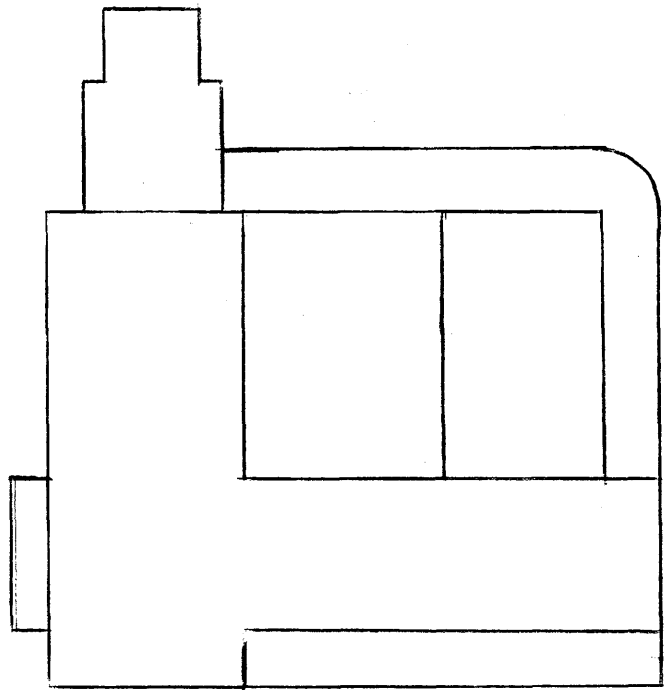

SOUTH MAIN



FORM PREPARED BY:

P. Ana Gordon, Historian
Mississippi Department of Archives and History

DATE

Jan. 1983