

United States Department of the Interior
National Park Service

National Register of Historic Places
Inventory—Nomination Form

For NPS use only

received **AUG 18 1983**
date entered

See instructions in *How to Complete National Register Forms*
Type all entries—complete applicable sections

1. Name

historic Wingate House (Bagents House)
and/or common same; also known as Bagents House

2. Location

street & number 800 S. 8th St. N/Anot for publication
city, town Leesville N/Avicinity of
state Louisiana code 22 county Vernon Parish code 115

3. Classification

Category	Ownership	Status	Present Use
<input type="checkbox"/> district	<input type="checkbox"/> public	<input checked="" type="checkbox"/> occupied	<input type="checkbox"/> agriculture
<input checked="" type="checkbox"/> building(s)	<input checked="" type="checkbox"/> private	<input type="checkbox"/> unoccupied	<input type="checkbox"/> commercial
<input type="checkbox"/> structure	<input type="checkbox"/> both	<input type="checkbox"/> work in progress	<input type="checkbox"/> educational
<input type="checkbox"/> site	Public Acquisition	Accessible	<input type="checkbox"/> entertainment
<input type="checkbox"/> object	<u>N/A</u> in process	<input checked="" type="checkbox"/> yes: restricted	<input type="checkbox"/> government
	<u>N/A</u> being considered	<input type="checkbox"/> yes: unrestricted	<input type="checkbox"/> industrial
		<input type="checkbox"/> no	<input type="checkbox"/> military
			<input type="checkbox"/> museum
			<input type="checkbox"/> park
			<input checked="" type="checkbox"/> private residence
			<input type="checkbox"/> religious
			<input type="checkbox"/> scientific
			<input type="checkbox"/> transportation
			<input type="checkbox"/> other:

4. Owner of Property

name Mr. and Mrs. H.P. Walle 318-238-1593
street & number Leesville Furniture Center, Inc., 303 East Texas Street
city, town Leesville N/Avicinity of state LA 71446

5. Location of Legal Description

courthouse, registry of deeds, etc. Vernon Parish Courthouse
street & number 201 South 3rd Street
city, town Leesville state LA 71446

6. Representation in Existing Surveys

title LA Historic Sites Survey has this property been determined eligible? yes no
date 1978 federal state county local
depository for survey records LA State Historic Preservation Office
city, town Baton Rouge state LA

7. Description

Condition		Check one	Check one	
<input checked="" type="checkbox"/> excellent	<input type="checkbox"/> deteriorated	<input type="checkbox"/> unaltered	<input checked="" type="checkbox"/> original site	
<input type="checkbox"/> good	<input type="checkbox"/> ruins	<input checked="" type="checkbox"/> altered	<input type="checkbox"/> moved	date <u>N/A</u>
<input type="checkbox"/> fair	<input type="checkbox"/> unexposed			

Describe the present and original (if known) physical appearance

The Wingate House (c. 1905) is a massive frame Queen Anne-Colonial Revival residence set on a suburban lot in the town of Leesville. The house has been little altered since construction.

The Wingate House can best be described as an essentially Queen Anne Revival structure with many Colonial Revival details.

Queen Anne Revival features include:

1. The house's asymmetrical, multi-gabled, turreted massing.
2. Its curving two-story veranda encompassing the corner turret.
3. Its imbricated shingles in the gables.
4. Its three protruding bays.
5. The plan. Despite the fact that there is no living hall, the central hall plan has features normally associated with the Queen Anne Revival in Louisiana. The main staircase is boldly three-dimensional in design with three runs of steps and three landings, one of which is set off in a protruding bay. In addition, the three major ground story spaces and the stair hall connect either by means of sliding doors or by columnar openings. This unifies the ground floor rooms in what borders upon an open floor plan.

Colonial Revival features include:

1. The use of classical columns on bases on the verandas and on some of the interior doorways.
2. The heavy, paneled pilasters which accent the corners of the house.
3. The rear kitchen door with its segmented pediment.
4. The extensive use of heavy bracketed cornices on the exterior.
5. The aforementioned protruding bay which contains one of the main stair landings has a Baroque bell shaped metal roof.
6. The use of aedicule motif frames on some of the gable windows.

There are no fireplaces in the house and apparently never were. When it was built, the house was fitted for central heating. In addition to the main stair, there is also a rear servant's stair in the kitchen wing. Most of the windows are one over one.

Assessment of Integrity:

Since construction the house has lost a single column capital and the kitchen has been modernized. In the opinion of the State Historic Preservation Office, these changes should be regarded as minor.

8. Significance

Period	Areas of Significance—Check and justify below			
<input type="checkbox"/> prehistoric	<input type="checkbox"/> archeology-prehistoric	<input type="checkbox"/> community planning	<input type="checkbox"/> landscape architecture	<input type="checkbox"/> religion
<input type="checkbox"/> 1400–1499	<input type="checkbox"/> archeology-historic	<input type="checkbox"/> conservation	<input type="checkbox"/> law	<input type="checkbox"/> science
<input type="checkbox"/> 1500–1599	<input type="checkbox"/> agriculture	<input type="checkbox"/> economics	<input type="checkbox"/> literature	<input type="checkbox"/> sculpture
<input type="checkbox"/> 1600–1699	<input checked="" type="checkbox"/> architecture	<input type="checkbox"/> education	<input type="checkbox"/> military	<input type="checkbox"/> social/ humanitarian
<input type="checkbox"/> 1700–1799	<input type="checkbox"/> art	<input type="checkbox"/> engineering	<input type="checkbox"/> music	<input type="checkbox"/> theater
<input type="checkbox"/> 1800–1899	<input type="checkbox"/> commerce	<input type="checkbox"/> exploration/settlement	<input type="checkbox"/> philosophy	<input type="checkbox"/> transportation
<input checked="" type="checkbox"/> 1900–	<input type="checkbox"/> communications	<input type="checkbox"/> industry	<input type="checkbox"/> politics/government	<input type="checkbox"/> other (specify)
		<input type="checkbox"/> invention		

Specific dates c. 1905 **Builder/Architect** Thomas C. Wingate

Statement of Significance (in one paragraph) Criterion C

The Wingate House is locally significant in the area of architecture as the finest late-nineteenth/ early-twentieth century period residence in Vernon Parish.

The Louisiana Comprehensive Historic Sites Survey has recorded a total of eighty-nine 50+ year old structures in Vernon Parish. Most of these are cabins or bungalows. A total of twenty-nine surveyed structures represent the fashionable residential styles of the late-nineteenth and early-twentieth centuries such as Queen Anne Revival, Eastlake, or Colonial Revival. Of these, the Wingate House is undoubtedly the finest. Eighteen of these more fashionable structures are relatively simple Queen Anne Revival cottages, two are relatively elaborately styled one-story Queen Anne cottages, and an additional five are large but plain two-story Queen Anne Revival houses. The parish survey identifies four pretentious two-story Queen Anne Revival residences, all of which have broad encompassing verandas. Of these, the Wingate House has the most elaborate massing, being the only one with a turret and the only one with a boldly undulating veranda. Moreover, all four of these structures date from the turn-of-the-century, but three feature ordinary manufactured Eastlake details. The Wingate House is the only one with well-developed Colonial Revival details, including colossal order Ionic columns. Hence, of the parish's four pretentious houses, the Wingate House was the most stylistically advanced in its day.

Historical Note:

The Wingate House was built for Senator Thomas Carol Wingate around 1905 and was purchased by John Bagents in 1918. Wingate represented Vernon Parish in the Louisiana Senate from 1904 to 1908 and from 1924 to 1940. In addition, he served for a very brief period in 1935 as lieutenant governor. Significance in the area of politics/government is not being claimed because all but four years of Wingate's political career dates from a period after he no longer had any association with the house. In any event, after investigating the matter thoroughly, the State Historic Preservation Office concluded that it would be very difficult to adequately assess Wingate's career because the subject has not yet received any scholarly study.

9. Major Bibliographical References

Louisiana Comprehensive Historic Sites Survey, Vernon Parish,
Membership in the Legislature of Louisiana, 1880-1980, Prepared by Louisiana Legislative
Council, February 1, 1979.

10. Geographical Data

Acreege of nominated property approximately 1 acre

Quadrangle name Leesville, LA

Quadrangle scale 1:24,000

UTM References

A

1	5	4	7	4	5	2	0	3	4	4	5	0	4	0
Zone		Easting				Northing								

B

Zone		Easting				Northing								

C

Zone		Easting				Northing								

D

Zone		Easting				Northing								

E

Zone		Easting				Northing								

F

Zone		Easting				Northing								

G

Zone		Easting				Northing								

H

Zone		Easting				Northing								

Verbal boundary description and justification

Please refer to enclosed sketch map.

List all states and counties for properties overlapping state or county boundaries

state N/A code county code

state code county code

11. Form Prepared By

name/title National Register Staff
Division of Historic Preservation

Assisted by owners and Eugene Kavanaugh,
Vernon Parish Tax Assessor

organization State of Louisiana

date June 1983

street & number P.O. Box 44247

telephone (504) 342-6682

city or town Baton Rouge

state LA 70804

12. State Historic Preservation Officer Certification

The evaluated significance of this property within the state is:

national state local

As the designated State Historic Preservation Officer for the National Historic Preservation Act of 1966 (Public Law 89-665), I hereby nominate this property for inclusion in the National Register and certify that it has been evaluated according to the criteria and procedures set forth by the National Park Service.

State Historic Preservation Officer signature

title State Historic Preservation Officer

Robert B. DeBlieux

date August 5, 1983

For NPS use only

I hereby certify that this property is included in the National Register

for Patrick W. Andrews

date 9/26/83

Keeper of the National Register

Attest:

date

Chief of Registration



Boundaries are
PARALLEL TO BUILDING
FACADES, DISTANCES
AS SHOWN. THE HOUSE
FACES SOUTH EIGHTH ST.

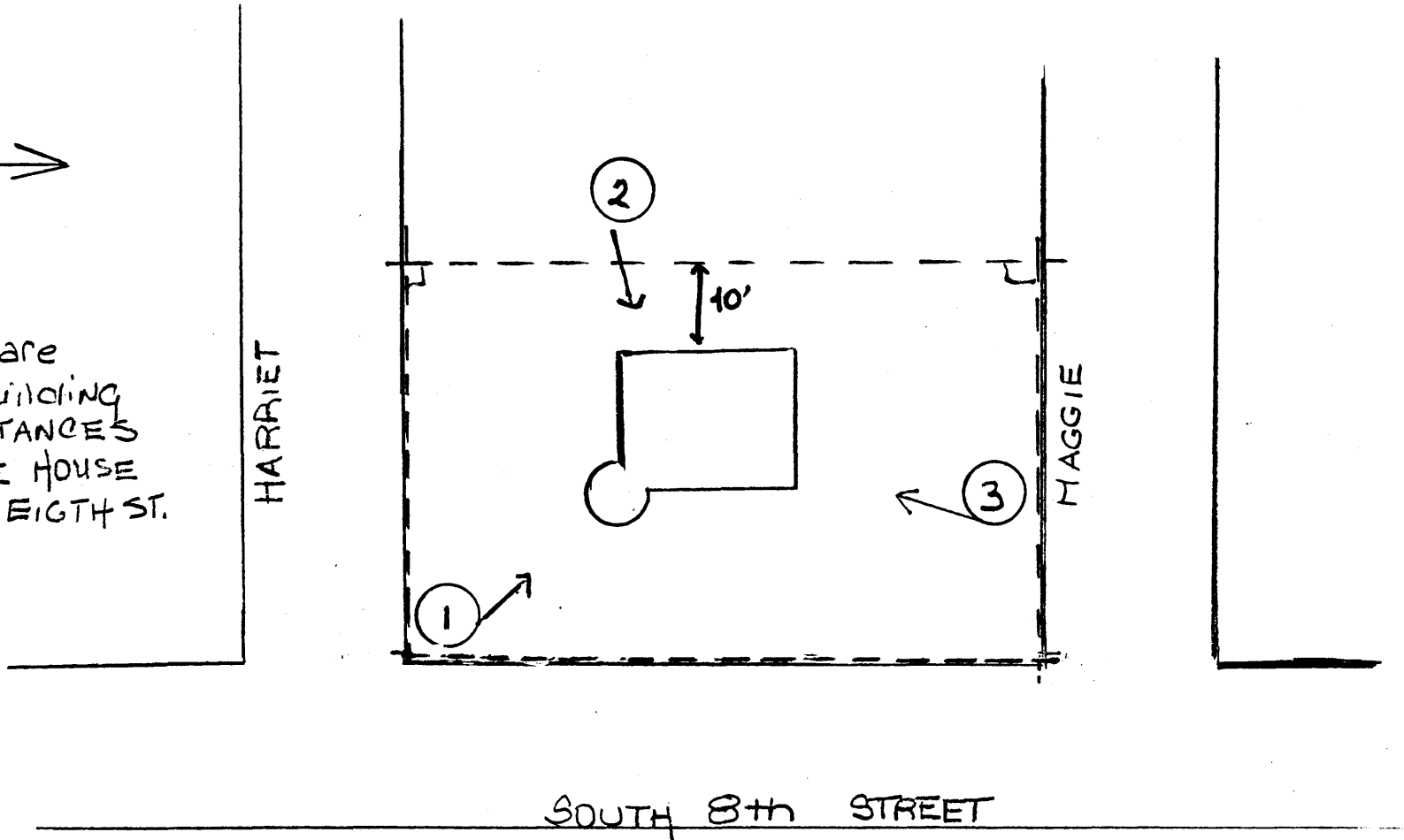

WINGATE HOUSE, LEESVILLE, VERNON PARISH