

United States Department of the Interior  
National Park Service

National Register of Historic Places  
Inventory—Nomination Form

For NPS use only  
received **MAR 2 1983**  
date entered

See instructions in *How to Complete National Register Forms*  
Type all entries—complete applicable sections

**1. Name**

historic N/A  
and/or common Riverlake

**2. Location**

street & number LA HWY 1 N/A not for publication  
city, town Oscar, *mic* X vicinity of  
state LA code 22 county Pointe Coupee Parish code 077

**3. Classification**

Category	Ownership	Status	Present Use
<input type="checkbox"/> district	<input type="checkbox"/> public	<input checked="" type="checkbox"/> occupied	<input type="checkbox"/> agriculture
<input checked="" type="checkbox"/> building(s)	<input checked="" type="checkbox"/> private	<input type="checkbox"/> unoccupied	<input type="checkbox"/> commercial
<input type="checkbox"/> structure	<input type="checkbox"/> both	<input type="checkbox"/> work in progress	<input type="checkbox"/> educational
<input type="checkbox"/> site	<b>Public Acquisition</b>	<b>Accessible</b>	<input type="checkbox"/> entertainment
<input type="checkbox"/> object	<u>N/A</u> in process	<input checked="" type="checkbox"/> yes: restricted	<input type="checkbox"/> government
	<u>N/A</u> being considered	<input type="checkbox"/> yes: unrestricted	<input type="checkbox"/> industrial
		<input type="checkbox"/> no	<input type="checkbox"/> military
			<input type="checkbox"/> museum
			<input type="checkbox"/> park
			<input checked="" type="checkbox"/> private residence
			<input type="checkbox"/> religious
			<input type="checkbox"/> scientific
			<input type="checkbox"/> transportation
			<input type="checkbox"/> other:

**4. Owner of Property**

name Mr. and Mrs. Gerald Caillet  
street & number P. O. Box 67 504-627-4175 (home)  
504-389-3680 (work)  
city, town Oscar N/A vicinity of state LA 70762

**5. Location of Legal Description**

courthouse, registry of deeds, etc. Pointe Coupee Parish Courthouse  
street & number Main Street (no specific street or mailing address)  
city, town New Roads state LA 70760

**6. Representation in Existing Surveys**

title LA Historic Sites Survey has this property been determined eligible?  yes  no  
date 1982  federal  state  county  local  
depository for survey records LA State Historic Preservation Office  
city, town Baton Rouge state LA

## 7. Description

Condition \_\_\_\_\_ excellent  (pigeonniers) \_\_\_\_\_ Check one \_\_\_\_\_ unaltered \_\_\_\_\_ Check one \_\_\_\_\_ original site  
\_\_\_\_\_ good \_\_\_\_\_ ruins \_\_\_\_\_ altered \_\_\_\_\_ moved date \_\_\_\_\_ N/A  
 fair (house) \_\_\_\_\_ unexposed

### Describe the present and original (if known) physical appearance

Riverlake is a large Creole raised plantation house which appears to have undergone three major periods of construction--c.1820, c.1840-45, c.1890. It is located in a rural setting on the west bank of False River about eight miles south of the town of New Roads. Also included in the nominated area are the house's two pigeonniers, which presumably date from c.1820. Despite the alterations the house has received and the deteriorated condition of the pigeonniers, the complex possesses enough integrity and importance to merit listing on the Register.

### THE PLANTATION HOUSE:

Riverlake began in about 1820 as a well detailed, two story, galleried structure with brick on the lower story and bousillage construction above. The house has strap hinges, rosehead nails, board and batten shutters, French doors, and interior doors consisting of three large raised panels. As originally built, the upper story was three rooms wide and one room deep, while the lower story consisted of numerous smaller rooms. The upper gallery on each side was originally open, while the area underneath contained small storage rooms with wooden bars on the windows. All beams and boards are beaded on the exposed surfaces.

In about 1840-45 the entire roof structure was replaced, the present dormers were added, and the present front and rear upper galleries with their enclosed sides and cabinets were built. Also at that time whatever columns were originally on the upper gallery were replaced with Greek Revival posts with molded capitals. (It is not known if the brick columns on the lower gallery date from this period or the earlier period.) All of the original mantels were replaced with Greek Revival aedicule motif mantels, and it appears that the present crown moldings and baseboards both inside and out date from this period as well. After the c.1840-45 renovation Riverlake resembled many late Creole plantation houses which, because they were built well after the colonial period, had Greek Revival details.

In the late-nineteenth century the following changes were made:

- (1) A two story rear kitchen wing was appended to the c.1840-45 rear gallery. A set of exterior gallery stairs was moved from the original house into the gallery of the new wing.
- (2) The Greek Revival columns on the upper front gallery were replaced with Eastlake columns and balustrades.
- (3) Most of the wall and ceiling surfaces on the upper part of the house were sheathed in three inch beaded boards.
- (4) Some of the side windows were replaced.
- (5) Two of the upstairs mantels were replaced with moderately elaborate Eastlake mantels. (Two c.1840-45 mantels remain in the house.)

In the early-twentieth century the following changes were made:

- (1) The French doors which opened onto the upper gallery were replaced with innocuous bungalow style glass doors.
- (2) The brick walls and columns of the lower portion of the house were covered in cement as were the lower gallery floors.

CONTINUED

**United States Department of the Interior  
Heritage Conservation and Recreation Service**

**National Register of Historic Places  
Inventory—Nomination Form**



Continuation sheet Riverlake

Item number 7

Page 2

## 7. Riverlake (continued)

## THE PIGEONNIERS:

The pigeonier to the east of the house is a square, two story structure with brick construction on the lower story and frame construction on the upper. It is surmounted by a hip roof with a finial. It is somewhat deteriorated but is more or less intact. The pigeonier to the west was identical when originally constructed, but has since lost its upper story.

Assessment of Integrity:

The House: Despite the alterations previously described, Riverlake still easily conveys its architectural identity as a Creole raised plantation house and hence its significance (see Item 8).

The Pigeonniers: Despite the aforementioned deterioration, the pigeonniers are still of outstanding architectural importance because they are such rare survivors (see Item 8). In any case, the east pigeonier retains all of its essential features. Moreover, it would be possible to reconstruct the upper part of the west pigeonier using the east pigeonier as a model.

# 8. Significance

Period	Areas of Significance—Check and justify below			
<input type="checkbox"/> prehistoric	<input type="checkbox"/> archeology-prehistoric	<input type="checkbox"/> community planning	<input type="checkbox"/> landscape architecture	<input type="checkbox"/> religion
<input type="checkbox"/> 1400-1499	<input type="checkbox"/> archeology-historic	<input type="checkbox"/> conservation	<input type="checkbox"/> law	<input type="checkbox"/> science
<input type="checkbox"/> 1500-1599	<input type="checkbox"/> agriculture	<input type="checkbox"/> economics	<input type="checkbox"/> literature	<input type="checkbox"/> sculpture
<input type="checkbox"/> 1600-1699	<input checked="" type="checkbox"/> architecture	<input type="checkbox"/> education	<input type="checkbox"/> military	<input type="checkbox"/> social/humanitarian
<input type="checkbox"/> 1700-1799	<input type="checkbox"/> art	<input type="checkbox"/> engineering	<input type="checkbox"/> music	<input type="checkbox"/> theater
<input checked="" type="checkbox"/> 1800-1899	<input type="checkbox"/> commerce	<input type="checkbox"/> exploration/settlement	<input type="checkbox"/> philosophy	<input type="checkbox"/> transportation
<input type="checkbox"/> 1900-	<input type="checkbox"/> communications	<input type="checkbox"/> industry	<input type="checkbox"/> politics/government	<input type="checkbox"/> other (specify)
		<input type="checkbox"/> invention		

Specific dates c.1820, c.1840-45, c.1890  
 Builder/Architect uncertain

Statement of Significance (in one paragraph) Criterion C

Riverlake is locally significant in the area of architecture as a landmark within the context of the architectural heritage of Pointe Coupee Parish. It stands as one of the parish's most important examples of the Creole architectural influence.

Riverlake is one of a select group of about six major Creole raised plantation houses which are Pointe Coupee Parish's largest and oldest historic structures. Taken as a whole, they are by far the most important and best known part of the parish's sizable patrimony.

Riverlake takes its place among this group because, although it has been somewhat modified over the years, its essential appearance dates from the period 1840-45 and it still emphatically conveys its Creole identity even to the casual observer. Its Creole features include:

- (1) Its hall-less, cabinet plan.
- (2) Its heavy hip "umbrella" roof complete with the customary pair of small dormers.
- (3) Its basic, two story, open galleried form.
- (4) Its bousillage and brick construction.
- (5) Its French door frames and board and batten shutters.
- (6) About half of its French doors.

In addition, Riverlake's identity as a Creole raised plantation house is significantly enhanced by the presence of the pigeonniers.

The house also retains a number of historic features which, though they are not specifically Creole, further establish its identity as an early house in Louisiana. These include:

- (1) The wooden bars in some of the downstairs windows.
- (2) The aforementioned crown moldings and baseboards.
- (3) The exposed beaded beams.
- (4) The c.1840 mantels.

Of the six major Creole raised plantation houses remaining in Pointe Coupee Parish, Riverlake is conspicuous because of its size, being a full five rooms wide as opposed to the usual three or four. In addition, it is one of only two examples which retain the original pigeonniers. The latter is particularly important because at one time almost every plantation in the parish had at least one pigeonier.

## 9. Major Bibliographical References

Historic Standing Structures Survey, Pointe Coupee Parish. Copy in LA State Historic Preservation Office.

Conveyance Records, Pointe Coupee Parish

## 10. Geographical Data

Acreeage of nominated property @ 1 acre

Quadrangle name New Roads, LA

Quadrangle scale 1=62500

### UTM References

A 

1	5	6	5	0	0	0	0	3	3	8	7	0	0	0
Zone	Easting				Northing									

B 

Zone	Easting				Northing									

C 

Zone	Easting				Northing									

D 

Zone	Easting				Northing									

E 

Zone	Easting				Northing									

F 

Zone	Easting				Northing									

G 

Zone	Easting				Northing									

H 

Zone	Easting				Northing									

### Verbal boundary description and justification

See attached sketch map.

### List all states and counties for properties overlapping state or county boundaries

state	code	county	code
N/A			

state	code	county	code
-------	------	--------	------

## 11. Form Prepared By

name/title National Register Staff Assisted by: Owner (Item 4)

Division of Historic Preservation

organization State of Louisiana date January 1983

street & number P. O. Box 44247 telephone 504-342-6682

city or town Baton Rouge state LA 70804

## 12. State Historic Preservation Officer Certification

The evaluated significance of this property within the state is:

national  state  local

As the designated State Historic Preservation Officer for the National Historic Preservation Act of 1966 (Public Law 89-665), I hereby nominate this property for inclusion in the National Register and certify that it has been evaluated according to the criteria and procedures set forth by the National Park Service.

State Historic Preservation Officer signature

*Robert B. DeBlieux*

title State Historic Preservation Officer date February 22, 1983

For NPS use only

I hereby certify that this property is included in the National Register

*Linda McClelland*  
for Keeper of the National Register

date 4/13/83

Attest: *Patrick Andrus*

for Chief of Registration

date 4/13/83

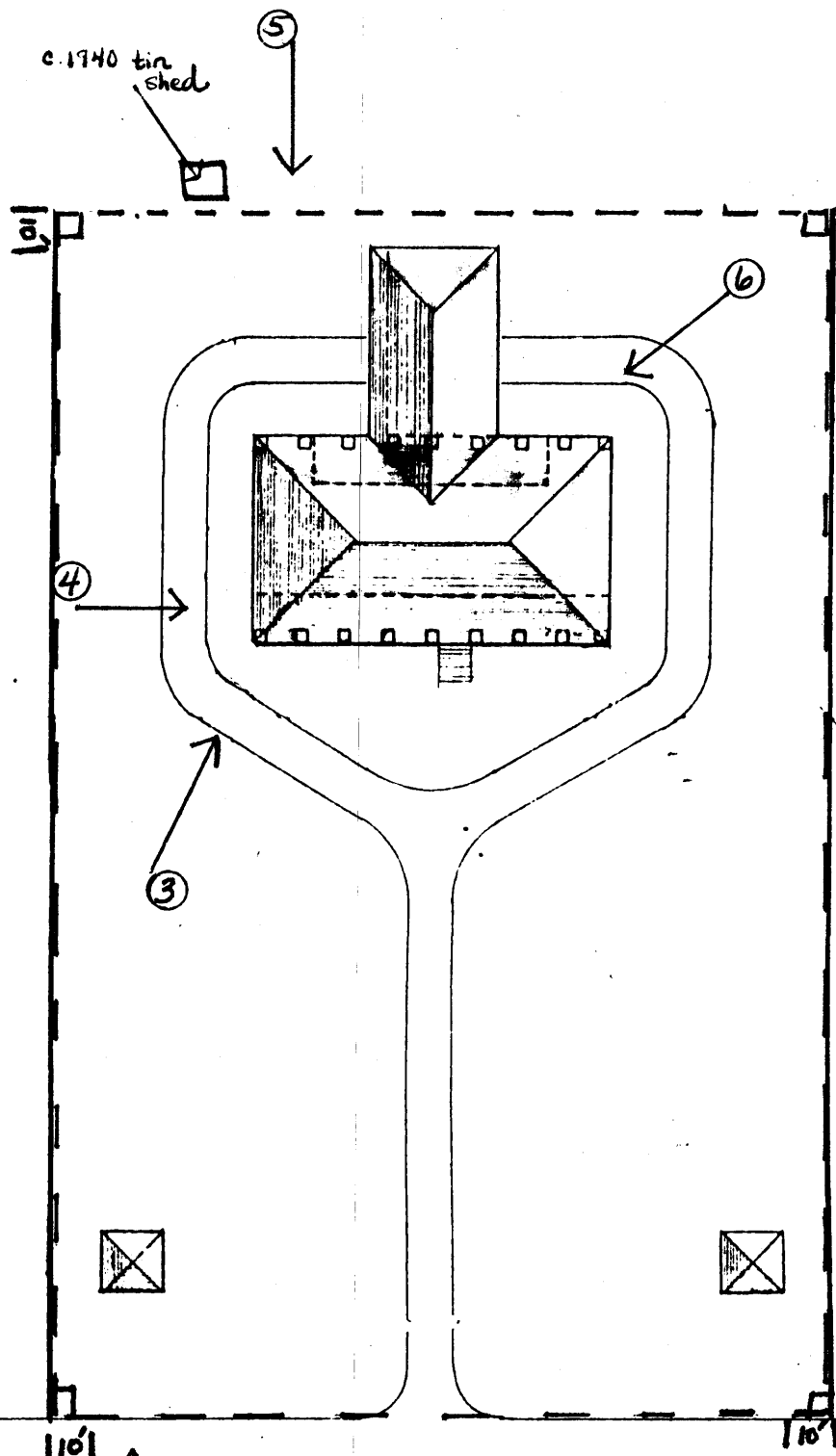

Riverlake Plantation House

Oscar vicinity, Pointe Coupee Parish, LA