

FORM B - BUILDING

MASSACHUSETTS HISTORICAL COMMISSION
80 BOYLSTON STREET
BOSTON, MA 02116

AREA	FORM NO.
	2091

Town Newton, Mass. MRA
NEWTON (Nonantum)

Address 23 Chapel Street

Historic Name _____

Evangelical Baptist Church

Use: Present church

Original church

DESCRIPTION

Date 1873

Source Newton Journal 10/18/1873

Style Gothic Revival

Architect Charles Edward Parker

Exterior Wall Fabric stone/brick

Outbuildings none

Major Alterations (with dates) _____

Rear section added 1900-1910

Condition Good

Moved no Date ---

Acreage 33,633 sq. ft. (less than 1 acre)

Setting Set on deep lot, close to
factory which provided both parish-
oners, and land for church building

Recorded by Kathlyn Hatch; Peter Stott

Organization Newton Historical Comm.

Date Feb. 1977; April 1986

Photo (3"x3" or 3"x5", black and white) Indicate address of property on back of photo. Staple to left side of form.

Sketch Map: Draw map showing property's location in relation to nearest cross streets and/or geographical features. Indicate all buildings between inventoried property and nearest intersection(s).
Indicate north

(SEE ATTACHED MAP)

UTM REFERENCE 19.318600.4692350

USGS QUADRANGLE NEWTON, MA

SCALE 1:25,000

NATIONAL REGISTER CRITERIA STATEMENT (if applicable)

As an important example of Victorian Gothic church architecture in Newton by a known Newton architect, and for its association with the development of the village of Nonantum, the Evangelical Baptist Church meets criteria A and C of the National Register of Historic Places.

ARCHITECTURAL SIGNIFICANCE Describe important architectural features and evaluate in terms of other buildings within the community.

The Evangelical Baptist Church (originally the North Evangelical Church) was built in 1873 at a cost of \$18,000. The structure is relatively uncomplicated in design and achieves its effect through the use of contrasting materials: Newton Centre stone laid in random pattern and accented with red and asphalt-dipped bricks. Its most distinctive architectural feature is the offset entrance tower, banded with courses of brick and capped by a heavy corbelled brick cornice and steep pyramidal roof.

The building's main block is front-gabled and features a steep nave roof flanked by shed-roofed side aisles. The rich surface decoration of the gable wall includes horizontal brick coursing, a round window, and a wide pointed arch outlined in brick that encompasses three smaller lancet

HISTORICAL SIGNIFICANCE Explain the role owners played in local or state history and how the building relates to the development of the community.

The North Evangelical Church was the outgrowth of the efforts of Samuel Lowry, the charitable donations and support of several old Newton Corner families (the Bacons, Trowbridges, Spears, and Bassetts), and of Thomas Dalby, the Nonantum manufacturer who donated the site. The church, at first associated with the Eliot Church in Newton Corner, is located just north of the Dalby knitting mill on Chapel Street.

Born in Ireland about 1841, Lowry came to Newton in 1859 and lived with his uncle on Richardson Street, being a clerk in Turnbull's dry goods store at the corner of Washington & Winter streets (now at or near the site of Filene's). He early became interested in the people of North Village, which was then a lawless and turbulent settlement of factory operatives, Lowry's obituary explains. He began by starting a Sunday School, conducted on the Watertown side of the river, near the Aetna mills. From these meetings grew the permanent Sunday school for Nonantum children. The school grew into a formally organized congregation, and in 1862 a small chapel was erected on the site of the present church. Lowry was formally ordained as pastor in 1867 and served until his death in 1884. A fire in June 1872 destroyed the chapel, and the present church was constructed the following year. The church was dedicated October 16, 1873.

After Lowry's death, the congregation changed to the Baptist denomination.

BIBLIOGRAPHY and/or REFERENCES

Newton Graphic Publishing Co., Beautiful Newton (c.1917), pp. 93-4.

M.F. Sweetser, King's Handbook of Newton (1889), pp.157-158.

Newton Journal 18 October 1873

"Charles Edward Parker," Boston Evening Transcript 28 October 1890, p. 5.

"Rev. S. E. Lowry," Newton Graphic 8 March 1884, p. 1.

Architects File, Fine Arts Division, Boston Public Library.

INVENTORY FORM CONTINUATION SHEET

MASSACHUSETTS HISTORICAL COMMISSION
Office of the Secretary, Boston

Community: Newton, Mass. MRA	Form No: 2091
Property Name: Evangelical Baptist Church	

Indicate each item on inventory form which is being continued below.

ARCHITECTURAL SIGNIFICANCE, cont.

arches. Both the facade and entrance tower have pier buttresses, and most windows, including those of the bellfry, are Gothic-arched.

The building's external appearance has been modified very little since it was first built. The main block was expanded beyond the side (south) entrance between 1900-1910, and a hip-roofed rear structure, connected by a short wing, was apparently added at this time. Both alterations blend well with the original design.

The building's architect was Charles Edward Parker (1826-1890), of Auburndale, who donated his services. Born in Keene, New Hampshire, Parker had developed a substantial reputation by the time he designed the North Village church. In the late 1850s he designed three buildings for Amherst College, and later town and city halls in Easthampton and Chicopee. In Newton he designed the Auburndale Congregational Church (1857), the first Eliot Church at Newton Corner (1859), and the 1881 chapel of the Church of the Messiah in Auburndale.

Staple to Inventory form at bottom

United States Department of the Interior
National Park Service

National Register of Historic Places
Inventory—Nomination Form

For NPS use only

received 7/23/86

date entered

Continuation sheet

Item number

Page

Multiple Resource Area
Thematic Group

4

Name Newton MRA
State Middlesex County, MA

Nomination/Type of Review

Date/Signature

41. Dupee Estate

Entered in the
National Register for KeeperMelrose Byers 9/4/86

Attest

42. Elliott, Charles D., House

Entered in the
National Register for KeeperMelrose Byers 9/4/86

Attest

43. Eminence, The

Entered in the
National Register for KeeperMelrose Byers 9/4/86

Attest

44. Estabrook, Rufus, House

Entered in the
National Register for KeeperMelrose Byers 9/4/86

Attest

45. Evangelical Baptist
ChurchEntered in the
National Register for KeeperMelrose Byers 9/4/86

Attest

46. Farquhar, Samuel, House

Entered in the
National Register for KeeperMelrose Byers 9/4/86

Attest

47. Fenno, John A., House

Entered in the
National Register for KeeperMelrose Byers 9/4/86

Attest

48. First Unitarian Church

Entered in the
National Register for KeeperMelrose Byers 9/4/86

Attest

49. Fuller, Capt. Edward,
FarmEntered in the
National Register for KeeperMelrose Byers 9/4/86

Attest

50. Gane, Henry, House

Entered in the
National Register for KeeperMelrose Byers 9/4/86

Attest

NATIONAL REGISTER OF HISTORIC PLACES
EVALUATION/RETURN SHEET

Evangelical Baptist Church (Newton MRA)
Middlesex County
MASSACHUSETTS

Working No. JUL 23 1986
Fed. Reg. Date: 2/3/87
Date Due: 8/21/86 - 8/6/86
Action: ACCEPT 9-4-86
 RETURN
 REJECT
Federal Agency: _____

Entered in the
National Register

- resubmission
- nomination by person or local government
- owner objection
- appeal

Substantive Review: sample request appeal NR decision

Reviewer's comments:

Recom./Criteria _____
Reviewer _____
Discipline _____
Date _____
_____ see continuation sheet

Nomination returned for: _____ technical corrections cited below
_____ substantive reasons discussed below

1. Name

2. Location

3. Classification

Category	Ownership	Status	Present Use
	Public Acquisition	Accessible	

4. Owner of Property

5. Location of Legal Description

6. Representation in Existing Surveys

Has this property been determined eligible? yes no

7. Description

Condition	Check one	Check one
<input type="checkbox"/> excellent	<input type="checkbox"/> deteriorated	<input type="checkbox"/> original site
<input type="checkbox"/> good	<input type="checkbox"/> ruins	<input type="checkbox"/> moved date _____
<input type="checkbox"/> fair	<input type="checkbox"/> unexposed	
	<input type="checkbox"/> unaltered	
	<input type="checkbox"/> altered	

Describe the present and original (if known) physical appearance

- summary paragraph
- completeness
- clarity
- alterations/integrity
- dates
- boundary selection

8. Significance

Period _____ Areas of Significance—Check and justify below _____

Specific dates _____ Builder/Architect _____

Statement of Significance (*in one paragraph*) _____

- summary paragraph
- completeness
- clarity
- applicable criteria
- justification of areas checked
- relating significance to the resource
- context
- relationship of integrity to significance
- justification of exception
- other

9. Major Bibliographical References

10. Geographical Data

Acreage of nominated property _____

Quadrangle name _____

UTM References _____

Verbal boundary description and justification _____

11. Form Prepared By

12. State Historic Preservation Officer Certification

The evaluated significance of this property within the state is:

____ national ____ state ____ local

State Historic Preservation Officer signature _____

title _____

date _____

13. Other

- Maps
- Photographs
- Other

Questions concerning this nomination may be directed to _____

Signed _____ Date _____ Phone: _____



Newton, Mass. MRA
23 Chapel St., Nonantum
(Evangelical Baptist Church)
Inv. #2091

Newton, Mass. MRA



1986-7/29

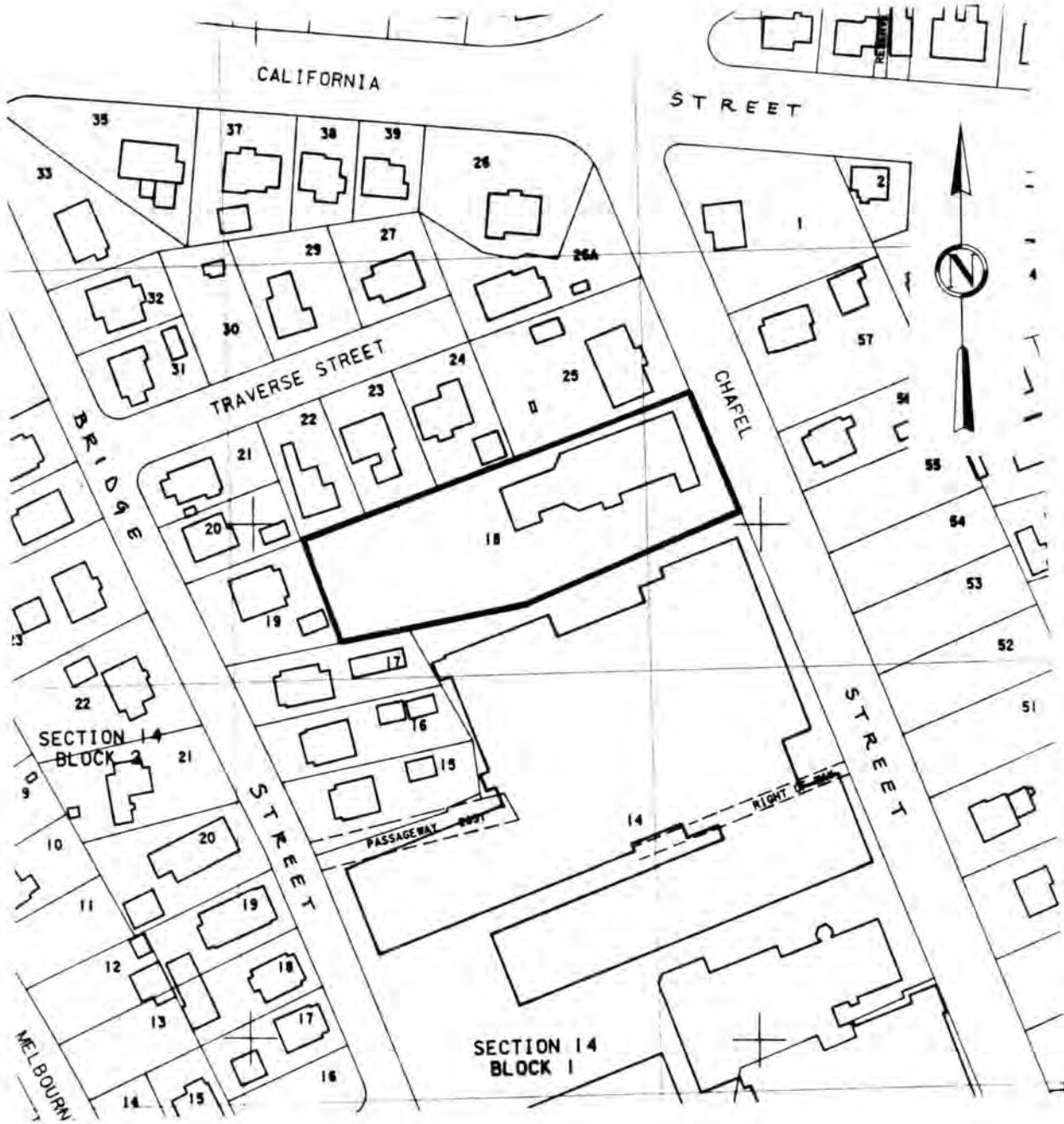

City of Newton Assessor's Maps. Sheet 9
 Metric Series, 1979
 Scale: UTM grid line interval = 100 meters (328 feet)

Newton, Mass. MRA
 23 Chapel St., Nonantum
 (Evangelical Baptist Church)
 14-1-18