

**NATIONAL REGISTER OF HISTORIC PLACES  
INVENTORY - NOMINATION FORM**

(Type all entries - complete applicable sections)

STATE: Minnesota	
COUNTY: Blue Earth	
FOR NPS USE ONLY	
ENTRY NUMBER 718.27.0003	DATE 8/26/71

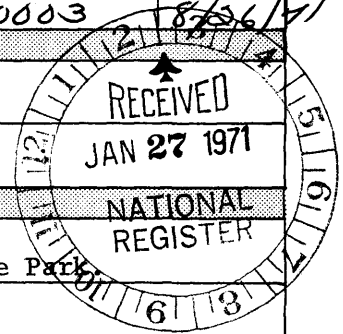

**1. NAME**

COMMON:  
Seppman Mill

AND/OR HISTORIC:

**2. LOCATION**

STREET AND NUMBER:  
Section 18, T 108 N, R 27 W, near Mankato in Minneopa State Park

CITY OR TOWN:  
Mankato

STATE: Minnesota CODE: 22 COUNTY: Blue Earth CODE: 013

**3. CLASSIFICATION**

CATEGORY (Check One)	OWNERSHIP	STATUS	ACCESSIBLE TO THE PUBLIC
<input type="checkbox"/> District <input type="checkbox"/> Site <input type="checkbox"/> Object	<input checked="" type="checkbox"/> Public <input type="checkbox"/> Private <input type="checkbox"/> Both	<input type="checkbox"/> Occupied <input type="checkbox"/> Unoccupied <input checked="" type="checkbox"/> Preservation work in progress	Yes: <input checked="" type="checkbox"/> Restricted <input type="checkbox"/> Unrestricted <input type="checkbox"/> No

PRESENT USE (Check One or More as Appropriate)

<input type="checkbox"/> Agricultural	<input checked="" type="checkbox"/> Government	<input checked="" type="checkbox"/> Park	<input type="checkbox"/> Transportation	<input type="checkbox"/> Comments
<input type="checkbox"/> Commercial	<input type="checkbox"/> Industrial	<input type="checkbox"/> Private Residence	<input type="checkbox"/> Other (Specify)	
<input type="checkbox"/> Educational	<input type="checkbox"/> Military	<input type="checkbox"/> Religious		
<input type="checkbox"/> Entertainment	<input type="checkbox"/> Museum	<input type="checkbox"/> Scientific		

**4. OWNER OF PROPERTY**

OWNER'S NAME:  
State of Minnesota, Division of Parks and Recreation

STREET AND NUMBER:  
Centennial Office Building

CITY OR TOWN: St. Paul STATE: Minnesota CODE: 22

**5. LOCATION OF LEGAL DESCRIPTION**

COURTHOUSE, REGISTRY OF DEEDS, ETC.:  
Blue Earth County Courthouse

STREET AND NUMBER:

CITY OR TOWN: Mankato STATE: Minnesota CODE: 22

**6. REPRESENTATION IN EXISTING SURVEYS**

TITLE OF SURVEY:  
Minnesota State Register of Historic Sites

DATE OF SURVEY: 1969  Federal  State  County  Local

DEPOSITORY FOR SURVEY RECORDS:  
Minnesota Historical Society

STREET AND NUMBER:  
690 Cedar Street

CITY OR TOWN: St. Paul STATE: Minnesota CODE: 22

SEE INSTRUCTIONS

STATE: Minnesota

COUNTY: Blue Earth

ENTRY NUMBER: 718.27.0003

DATE: 8/26/71

FOR NPS USE ONLY

7. DESCRIPTION

CONDITION	(Check One)					
	<input type="checkbox"/> Excellent	<input type="checkbox"/> Good	<input checked="" type="checkbox"/> Fair	<input type="checkbox"/> Deteriorated	<input type="checkbox"/> Ruins	<input type="checkbox"/> Unexposed
	(Check One)			(Check One)		
	<input checked="" type="checkbox"/> Altered	<input type="checkbox"/> Unaltered	<input type="checkbox"/> Moved	<input checked="" type="checkbox"/> Original Site		

DESCRIBE THE PRESENT AND ORIGINAL (if known) PHYSICAL APPEARANCE

High on a hill overlooking the Minnesota River Valley stands one of the most picturesque mills remaining in Minnesota today. The mill is circular in construction and measures 30' in diameter at the bottom and 20' in diameter at the top. The structure stands 36' high. The roof was dome-shaped and hung on a center shaft. It was fitted on a track with rollers so that it could be moved in order to place the arms of the wheel in the proper position to best catch the wind. The arms of the mill were wooden frames covered with canvas, each 35' long making the total span, including the diameter of the hub, 75'.

The mill was constructed of stone found on the Seppman farm and the outline of each stone was originally painted black. Nearly all the machinery was hand made, the cap and wheels being of hand-hewn hard maple.

The mill is presently being restored by the Division of State Parks. Most of the original equipment is stored on the ground floor of the mill and will be used in the restoration.



SEE INSTRUCTIONS

**5. SIGNIFICANCE**

PERIOD (Check One or More as Appropriate)

- |  |                                       |  |                                       |
|--|---------------------------------------|--|---------------------------------------|
| <input type="checkbox"/> Pre-Columbian | <input type="checkbox"/> 16th Century | <input type="checkbox"/> 18th Century            | <input type="checkbox"/> 20th Century |
| <input type="checkbox"/> 15th Century  | <input type="checkbox"/> 17th Century | <input checked="" type="checkbox"/> 19th Century |                                       |

SPECIFIC DATE(S) (If Applicable and Known) Completed in 1863

AREAS OF SIGNIFICANCE (Check One or More as Appropriate)

- |  |   |  |  |
|--|---|--|--|
| <input type="checkbox"/> Aboriginal              | <input type="checkbox"/> Education              | <input type="checkbox"/> Political           | <input type="checkbox"/> Urban Planning  |
| <input type="checkbox"/> Prehistoric             | <input type="checkbox"/> Engineering            | <input type="checkbox"/> Religion/Philosophy | <input type="checkbox"/> Other (Specify) |
| <input type="checkbox"/> Historic                | <input checked="" type="checkbox"/> Industry    | <input type="checkbox"/> Science             | _____                                    |
| <input checked="" type="checkbox"/> Agriculture  | <input type="checkbox"/> Invention              | <input type="checkbox"/> Sculpture           | _____                                    |
| <input checked="" type="checkbox"/> Architecture | <input type="checkbox"/> Landscape Architecture | <input type="checkbox"/> Social/Humanitarian | _____                                    |
| <input type="checkbox"/> Art                     | <input type="checkbox"/> Literature             | <input type="checkbox"/> Theater             | _____                                    |
| <input checked="" type="checkbox"/> Commerce     | <input type="checkbox"/> Military               | <input type="checkbox"/> Transportation      | _____                                    |
| <input type="checkbox"/> Communications          | <input type="checkbox"/> Music                  |  | _____                                    |
| <input type="checkbox"/> Conservation            |   |  | _____                                    |

STATEMENT OF SIGNIFICANCE

Construction of the Seppman Mill was begun in 1862 by Louis Seppman and was completed the following year. Seppman, a native of Westphalia, Germany, settled in South Bend township, Blue Earth County in 1857. He was a stone mason by trade and familiar with the mills of his native land. One of the only wind-powered mills in Minnesota it served the area as a flour mill for 16 years and a feed mill for 10 years. In 1880 two of the arms were broken by high winds. The mill operated with the two remaining arms until they were damaged in 1890 by another storm.

The surviving Seppman relatives donated the mill to the Blue Earth County Historical Society in 1929. In 1933 it was incorporated into Minneopa State Park. Its unique design and beautiful surrounding countryside make it more than worthy of insured preservation in the future.

SEE INSTRUCTIONS

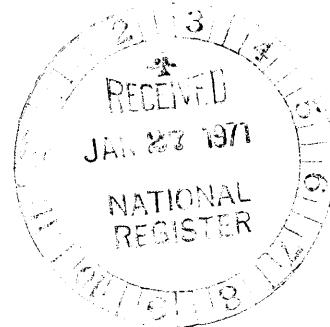

**9 MAJOR BIBLIOGRAPHICAL REFERENCES**

Hughes, Thomas, History of Blue Earth County, Chicago, 1909.  
 Hughes, Thomas, History of Minneopa State Park, St. Paul, 1932.  
 Thompson, H. E., "Northwestern Miller", September 19, 1934.

**10 GEOGRAPHICAL DATA**

LATITUDE AND LONGITUDE COORDINATES DEFINING A RECTANGLE LOCATING THE PROPERTY			OR	LATITUDE AND LONGITUDE COORDINATES DEFINING THE CENTER POINT OF A PROPERTY OF LESS THAN TEN ACRES		
CORNER	LATITUDE	LONGITUDE		LATITUDE	LONGITUDE	
	Degrees Minutes Seconds	Degrees Minutes Seconds		Degrees Minutes Seconds	Degrees Minutes Seconds	
NW	° ' "	° ' "		44 ° 09 ' 40 "	94 ° 05 ' 08 "	
NE	° ' "	° ' "				
SE	° ' "	° ' "				
SW	° ' "	° ' "				

APPROXIMATE ACREAGE OF NOMINATED PROPERTY: **3 acres**

LIST ALL STATES AND COUNTIES FOR PROPERTIES OVERLAPPING STATE OR COUNTY BOUNDARIES

STATE:	CODE	COUNTY	CODE

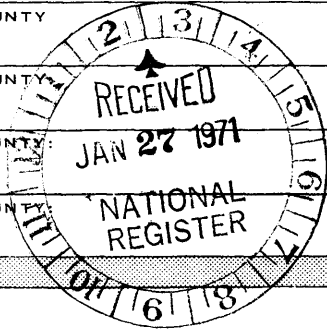

NO  
MIM  
CO

SEE INSTRUCTIONS

**11 FORM PREPARED BY**

NAME AND TITLE:  
**Thomas Bredeson, Survey and Planning**

ORGANIZATION: **Minnesota Historical Society**      DATE: **December 1, 1970**

STREET AND NUMBER:  
**Building 25, Fort Snelling**

CITY OR TOWN: **St. Paul**      STATE: **Minnesota 55111**      CODE: **22**

**12. STATE LIAISON OFFICER CERTIFICATION**      **NATIONAL REGISTER VERIFICATION**

As the designated State Liaison Officer for the National Historic Preservation Act of 1966 (Public Law 89-665), I hereby nominate this property for inclusion in the National Register and certify that it has been evaluated according to the criteria and procedures set forth by the National Park Service. The recommended level of significance of this nomination is:

National     State     Local

Name *Russell W. Fridley*

Title **Director, Minnesota Historical Society**

Date \_\_\_\_\_

I hereby certify that this property is included in the National Register.

*Ernest A. Connelly*  
 Chief, Office of Archeology and Historic Preservation

**AUG 26 1971**

Date \_\_\_\_\_

ATTEST:

*William J. Mustang*  
 Keeper of The National Register

**APR 8 1971**

Date \_\_\_\_\_

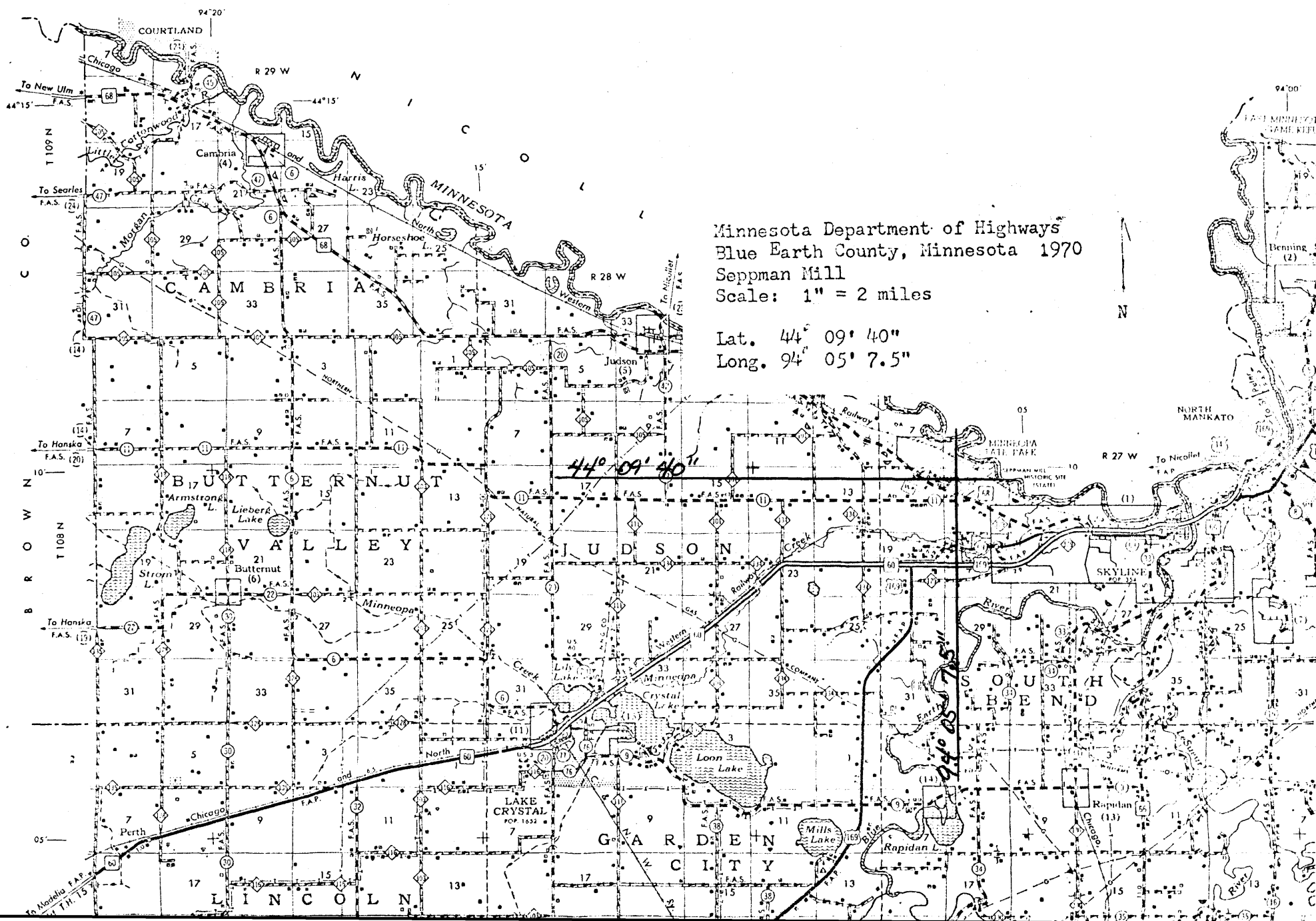

Minnesota Department of Highways  
 Blue Earth County, Minnesota 1970  
 Seppman Mill  
 Scale: 1" = 2 miles

Lat. 44° 09' 40"  
 Long. 94° 05' 7.5"

44° 09' 40"

94° 05' 7.5"

**NATIONAL REGISTER OF HISTORIC PLACES**

**PROPERTY MAP FORM**

(Type all entries - attach to or enclose with map)

STATE	Minnesota
COUNTY	Blue Earth
FOR NPS USE ONLY	
ENTRY NUMBER	71.8.27.0003
DATE	8/26/71

1. NAME		Seppman Mill	
COMMON:		Seppman Mill	
AND/OR HISTORIC:			
2. LOCATION			
STREET AND NUMBER:			
Section 18, T 108 N, R 27 W, near Mankato in Minneopa State Park.			
CITY OR TOWN:			
Mankato			
STATE:	MINNESOTA	CODE	56001
COUNTRY:	Blue Earth	CODE	22
CODE	013		
3. MAP REFERENCE			
SOURCE:			
Minnesota Department of Highways, Blue Earth County			
SCALE: 1" = 2 miles			
DATE: 1970			
4. REQUIREMENTS			
TO BE INCLUDED ON ALL MAPS			
1. Property boundaries where required.			
2. North arrow.			
3. Latitude and longitude reference.			

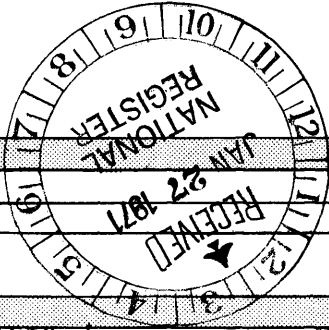

SEE INSTRUCTIONS

*MANKATO*

United States Department of the Interior  
National Park Service

# National Register of Historic Places Continuation Sheet

Section number \_\_\_\_\_ Page \_\_\_\_\_

---

ADDITIONAL INFORMATION

for Keeper Melvin Lynn  
11/19/89

United States Department of the Interior  
National Park Service

# National Register of Historic Places Continuation Sheet

Section number \_\_\_\_\_ Page \_\_\_\_\_

---

**Note: These changes apply to  
Swedish Evangelical Lutheran  
Bethlehem Church in Aitkin County,  
Minnesota.**

**REFERENCE NUMBER:** 82002928

**STATE:** MINNESOTA

**COUNTY:** Aitkin

**RESOURCE NAME (HISTORIC):** Bethlehem Lutheran Church

**CITY:**

**VICINITY OF:** Aitkin

**ADDRESS:** off Co. Hwy. 12

**CERTIFICATION DATE:**

**REMOVED DATE:**

**COMMENTS:**

*Nina M. Archabal*

\_\_\_\_\_  
Nina M. Archabal  
State Historic Preservation Officer

JUN 17 10AM  
\_\_\_\_\_  
Date