

National Register of Historic Places Registration Form

This form is for use in nominating or requesting determinations for individual properties and districts. See instructions in National Register Bulletin, *How to Complete the National Register of Historic Places Registration Form*. If any item does not apply to the property being documented, enter "N/A" for "not applicable." For functions, architectural classification, materials, and areas of significance, enter only categories and subcategories from the instructions.

1. Name of Property

Historic name Farmers and Merchants Bank
Other names/site number U.S. Post Office, Ethridge
Name of related multiple property listing N/A
(Enter "N/A" if property is not part of a multiple property listing)

2. Location

Street & Number: 213 Depot Street
City or town: Ethridge State: TN County: Lawrence
Not For Publication: N/A Vicinity: N/A Zip: 38456

3. State/Federal Agency Certification

As the designated authority under the National Historic Preservation Act, as amended,
I hereby certify that this nomination request for determination of eligibility meets the documentation standards for registering properties in the National Register of Historic Places and meets the procedural and professional requirements set forth in 36 CFR Part 60.

In my opinion, the property meets does not meet the National Register Criteria. I recommend that this property be considered significant at the following level(s) of significance:

national statewide local

Applicable National Register Criteria: A B C D

Claudia L. Spear 10/2/17
Signature of certifying official/Title: Deputy State Historic Preservation Officer, Tennessee Historical Commission Date
State or Federal agency/bureau or Tribal Government

In my opinion, the property meets does not meet the National Register criteria.
Signature of Commenting Official: _____ Date _____
Title: _____ State of Federal agency/bureau or Tribal Government

Farmers and Merchants Bank
 Name of Property

Lawrence County, TN
 County and State

4. National Park Service Certification

I hereby certify that this property is:

- entered in the National Register
- determined eligible for the National Register
- determined not eligible for the National Register
- removed from the National Register

other (explain) _____

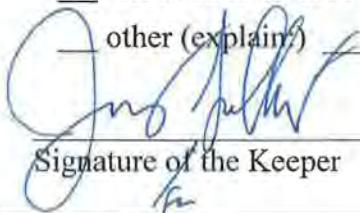
 Signature of the Keeper

11-13-2017
 Date of Action

5. Classification

Ownership of Property

(Check as many boxes as apply.)

- Private
- Public – Local
- Public – State
- Public – Federal

Category of Property

(Check only **one** box.)

- Building(s)
- District
- Site
- Structure
- Object

Number of Resources within Property

(Do not include previously listed resources in the count)

Contributing	Noncontributing	
1	0	buildings
0	0	sites
0	0	structures
0	0	objects
1	0	Total

Number of contributing resources previously listed in the National Register 0

Farmers and Merchants Bank
Name of Property

Lawrence County, TN
County and State

6. Function or Use

Historic Functions

(Enter categories from instructions)

COMMERCE/TRADE: financial institution

GOVERNMENT: post office

Current Functions

(Enter categories from instructions)

Work in progress

7. Description

Architectural Classification

(Enter categories from instructions.)

LATE 19TH AND EARLY 20TH CENTURY AMERICAN MOVEMENTS: Commercial Style

Materials: (enter categories from instructions.)

Principal exterior materials of the property: BRICK; WOOD; GLASS; METAL; CONCRETE

Narrative Description

The original Farmers and Merchants Bank was constructed in 1911 on lot 9 of Hudson's and Nixon's plot map in the Town of Ethridge (2014 population 465). This bank burned in 1926. The second and extant/current Farmers and Merchants Bank was constructed in 1927, it is a one-story, load bearing brick commercial structure with a flat roof. Structurally independent, the building is part of one of two small commercial blocks that make up downtown Etheridge and is attached to a ca 1950s commercial building that now houses Ethridge's town hall. Though modest in its Classical Revival style, its brick pilasters, cornice, and frieze reflect the grander Classical Revival styles seen in large towns and cities. An asphalt parking area is located in front of the building. Although vacant for some time, the building retains its historic integrity including original windows, interior floor plan, steel bank vault and setting as one of the most prominent buildings in downtown Ethridge.

The three-bay façade (north elevation) faces Depot Street and consists of a single glass and wood door, two single hung windows that flank the door each with matching lintels composed of blonde brick in a soldier course pattern, and blonde brick stringcourse that extends between facade windows and door. Above the door is a stone sign that reads "BANK." Each bay is divided by a brick pilaster that rest on a stone base. The pilasters extend to the cornice with a blond brick string course spanning across each pilaster. Each

Farmers and Merchants Bank
Name of Property

Lawrence County, TN
County and State

pilaster is capped with a blonde brick detail of three bricks in a soldier course. Above is a frieze composed of three courses of running bond bricks topped with a wood-metal cornice. The blond bricks are used to create four decorative elements in between the pilasters.

The east elevation faces the train tracks and features a tiered and capped parapet, 3 symmetrical 3-1 double hung windows with stone lintels and sills and a single entry wood door. The brick work is laid in a standard running pattern extending to foundation. The foundation is concrete.

The south (rear) elevation facing east is composed of one three over one double-hung window, stone sill like the east elevation. The standing seam metal roof has a gradual slope to the rear of the building. The roof is hidden behind a tiered and capped brick parapet. The roof rafters are exposed at rear elevation, as the roof slopes down at back of building, the foundation is concrete. A ca. 1930s, single bay addition with clapboard siding is present at the rear elevation features a sloping metal roof.

The west elevation is attached to the ca. 1950s commercial building.

The interior of the bank consists of one room for public use/banking with single bathroom in the southeast corner. The floor is concrete. Though presently painted, half of the ceiling retains its original copper ceiling, the back portion ceiling is drop down tile with a band of tin cove molding. The interior walls are plaster and brick, with a brick fireplace located on the south wall. The original vault located in southwest portion of the interior has been damaged with a square hole in the door. A restroom and office area are located in the south east portion of the building. The ca.1930s shed roofed addition contains a storage area and is currently only accessible from a wood door on the rear elevation.

Farmers and Merchants Bank
 Name of Property

Lawrence County, TN
 County and State

8. Statement of Significance

Applicable National Register Criteria
 (Mark "x" in one or more boxes for the criteria qualifying the property for National Register listing.)

Areas of Significance
 (Enter categories from instructions.)

COMMERCE

Period of Significance

1927-1955

Significant Dates

1927

Significant Person

(Complete only if Criterion B is marked above.)

N/A

Cultural Affiliation

N/A

Architect/Builder

UNKNOWN

- A Property is associated with events that have made a significant contribution to the broad patterns of our history.
- B Property is associated with the lives of persons significant in our past.
- C Property embodies the distinctive characteristics of a type, period, or method of construction or represents the work of a master, or possesses high artistic values, or represents a significant and distinguishable entity whose components lack individual distinction.
- D Property has yielded, or is likely to yield, information important in prehistory or history.

Criteria Considerations
 (Mark "x" in all the boxes that apply.)
 Property is:

- A Owned by a religious institution or used for religious purposes.
- B removed from its original location.
- C a birthplace or grave.
- D a cemetery.
- E a reconstructed building, object, or structure.
- F a commemorative property.
- G less than 50 years old or achieving significance within the past 50 years.

Farmers and Merchants Bank
Name of Property

Lawrence County, TN
County and State

Statement of Significance Summary Paragraph

The Farmers and Merchants Bank is eligible for listing in the National Register of Historic Places under Criterion A for significance in Commerce as it relates to the small railroad town of Ethridge, Macon County, Tennessee. The building's period of significance is from the date of construction in 1927 to when it began to was no longer used as a post office in the mid-1950s. The Farmers and Merchants Bank was the only bank in the community during the period of significance and supported the financial needs of local residents and businesses. After its closure Ethridge residents were forced to go into Lawrenceburg to do their personal and business banking. Although vacant for some time, the building retains its historic and architectural integrity including original windows, interior floor plan, and steel bank vault and setting as one of the most prominent buildings in downtown Ethridge. The building's overall design has not changed substantially over time and it still retains its historic and architectural integrity.

Narrative Statement of Significance

Ethridge (2014 population 465) is a town built by the railroad and timber industry is located in Northwest Lawrence County TN.¹ The first railroad serving Ethridge was the Columbia, Lawrenceburg, and Florence Railroad Company with fifteen miles of track completed by 1882. This line eventually became the property of the Louisville and Nashville Railroad (L&N). The Farmers and Merchants Bank established by Edward Walter Crews, a prominent real estate and immigration agent, contributed to the economic prosperity of Ethridge from 1900-1920s. As the only bank in Ethridge, it helped finance the timber, agricultural, and livestock industry which contributed to an economic boom from the turn of the century to 1920.

Early Ethridge History and Development

Initially settled in the 1880s with the Hudson Springs Railroad stop, the Town of Ethridge grew to be much more. The first town plot was designed and laid out by Y.M. Hudson and George Nixon.² From the turn of the century to 1930, Ethridge rode a wave of growth and economic vitality. As with many towns across America, the railroad was vital to its growth and economic development, Ethridge was no exception. . In the early 1880s, three railroad towns existed in close proximity to one another: Ethridge, Hudson, and Wayne Station. Travelers and residents alike were confused as to which station they were to disembark. Three quarters of a mile south of present day Ethridge sat a store and post office. Mr. Tucker, owner of the store called this area Ethridge in honor of Emerson Ethridge, a former Tennessee legislator and U.S. congressman from 1853-1861. In 1883 Tucker tried to recruit the railroad to construct a depot at his store; ultimately railroad officials chose a location with a more level terrain.³

¹Ethridge, TN Demographic profile 2014, Factfinder.census.gov/faces/nav/jsf/pages/community_facts.html(accessed April 25, 2017).

²Brian, Lloyd. Interview with various local residents. History of Ethridge, Tennessee. Lawrence County TN Archives.

³ Juniata Henson, Leighton, McCall, Ethridge: *A Homecoming 86 project*. (1986, 3).

Farmers and Merchants Bank
Name of Property

Lawrence County, TN
County and State

Colonel George Nixon, a surveyor from Lawrenceburg and Y.M. Hudson owned the land which they called Hudson. Railroad officials had different ideas and named the depot Wayne Station because it was located near the East-West road from Waynesboro to Campbellsville, and the mail stop for Waynesboro. People looking for Ethridge were confused and rode the train past Wayne Station and ended up in Lawrenceburg. This caused numerous problems and difficulties for travelers and local businessmen like Edward Walter Crews a.k.a E.W. Crews. As a prominent real estate and immigration agent, E.W.'s livelihood depended on newcomers to the area. He recruited immigrants from the north to come to Wayne Station-Ethridge. He advertised in numerous northern newspapers. "Don't go to Lawrenceburg, get off train at Wayne, I will always meet you there with my carriage."⁴ Frustrated at losing potential clients, E.W. convinced railroad officials to close the flag stop and change the name of the depot from Wayne Station to Ethridge in 1904. By this time Ethridge was thriving town centered around the railroad. Four passenger trains arrived daily, two headed north and two headed south. Businesses included millinery stores, drug stores, barbershops, grocers, general stores, livery stables, an ice cream parlor, a doctors office, law offices, and an undertaker. The obvious missing financial entity to contribute to the economic development of Ethridge was a bank.

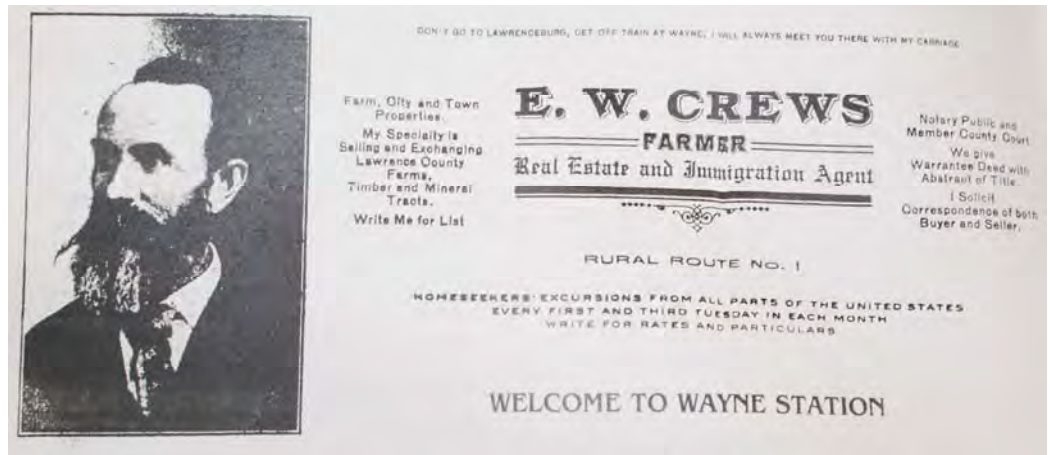

E.W. Crews, Ethridge real estate agent and town booster, from Henson, Juniata Henson and Leighton McCall, *Ethridge: A Homecoming 86 Project*. 1986.

Early on, the timber industry was the main economic generator for the town. Rich with virgin timber, four saw mills operated in and around Ethridge to keep up with demand. The first sawmill was W.W. Lumber Company, owned by George Williamson and S.A. Wilkinson.⁵ Oak and chestnut dyewood made up the bulk of processed lumber, though scrub timber was processed and shipped to Mount Pleasant for burning in the phosphate furnaces.

Twentieth Century Commerce in Ethridge

Eventually, agriculture would dominate as the main economic livelihood for Ethridge, more specifically cantaloupes. Cantaloupe became such an important commodity local farmers formed a cantaloupe association that existed from 1907-1913. The process of growing, harvesting, grading, crating, and shipping was controlled by the association.⁶ Ever-evolving agricultural demands resulted in the switch from growing cantaloupes to cotton in 1914, then from cotton to soybeans. No matter the crop the railroad was essential to Ethridge economic development. Once the railroad depot was established with regular schedules and increasing coverage areas, loading ramps and livestock pens were constructed. Hogs, cattle, and sheep were

⁴ Henson, Leighton, and McCall, 4.

⁵ Henson, Leighton, and McCall, 6.

⁶ Brian, 2.

Farmers and Merchants Bank
Name of Property

Lawrence County, TN
County and State

driven from surrounding areas to Ethridge for shipment to eastern and northern markets. Due to a lack of an organized road system and accessible roads to Nashville and Lawrenceburg, people relied on the railroad in Ethridge for trips to these cities. Two passenger trains made daily trips to Lawrenceburg, and to Nashville and back. This changed with the coming of the automobile, and its growing popularity and improvement in local roads created a challenge for the railroad.

Banking in Maury County and Ethridge

Having a successful and efficient railroad system is just one aspect of a thriving town, but a local bank is also an essential part of economic viability for a town. In 1910, E.W Crews obtained a charter from the State of Tennessee for Farmers and Merchants Bank of Ethridge. It was presented and filled in Lawrence County Court October 8, 1910.⁷ The first Farmers and Merchants Bank was located on the west side of Depot Street. By 1910, Farmers and Merchants Banks were established in neighboring Maury County. Farmers and Merchants Bank in Mount Pleasant and Columbia were part of the large and successful J.P. Brownlow and family financial empire that included financial institutions, general stores, farming and eventually the phosphate mining business in Mount Pleasant.

Banks were hit hard by the panic of 1893. The only Brownlow bank in Maury County that survived was Mount Pleasant Bank and Trust which J.P. rechartered in 1894 as the Farmers and Merchants bank along with the new Farmers and Merchants bank in Columbia.⁸ Though a prominent and economically successful man, E.W. Crews did not rise to the level of J.P. Brownlow's, however, Crew's business investments and ventures contributed to the economic development and community well-being of Ethridge.

Soon after obtaining the charter (October 27, 1910), for the bank and lot 9 on the Hudson and Nixon plot map, Crews sold 1/2 interest of the north wall of lot 9 to N.C. Felton and Nora E. Felton.⁹ Rural banks such as Farmers and Merchants of Ethridge were opened primarily in the late nineteenth and early twentieth centuries when cultivation and farming was at its peak. This prosperity was often reflected in the growth and development of banks in rural farming communities.

The role of a local bank is essential for small town success and overall community growth. While in operation, Farmers and Merchants Bank helped spur economic development by assisting with the financing hundreds of homes and providing capital for starting or expanding business and agricultural production. Such investments included Eugene Gant's, local inventor, who built a rope meter for measuring rope. Eugene hired approximately twenty men at his rope meter production factory. With the invention of the automobile and its rising popularity, Eugene invented the EMG automobile tire pump (US Patent # #1441339A). Next, he built a factory and employed fifty men. This factory later became the broom factory, now serves as automobile mechanic shop. The appearance of free air at gas stations and garages, and spare

⁷ Lawrence County Archives, deed book 29, 238.

⁸ Bob Duncan, *The first One Hundred Years of a TN Bank* (Tennessee: JM Press, 2009), 45.

⁹ Lawrence County Archives, deed book, 4, 209.

Farmers and Merchants Bank

Lawrence County, TN

Name of Property

County and State

tires put Eugene out of business. He closed the EMG factory and moved to Nashville.¹⁰ There he invented a method of removing caffeine from coffee (US Patent #1602576A).¹¹

World War I was a starting point when Ethridge residents began to find opportunities beyond the town limits. Factories for war production supplied Americans with good wage earning jobs. Many Ethridge residents relocated seeking better economic opportunities working in these factories. In addition, advancements in transportation allowed easier travel to distant places, or just to larger towns (in this case Lawrenceburg) for shopping and dining.¹² Improvements in automobile manufacturing particularly the assembly line, reduced the cost of production and brought the automobile to the masses. Increase in individual travel utilizing cars and trucks decreased the demand for railroad travel. As a railroad town, Ethridge relied on revenue from travelers who stopped to eat and shop.

By 1923, Farmers and Merchants Bank was the property of S.V. Baize and wife Mary Baize.¹³ E.W. Crews was no longer a resident of TN; he sold his assets in Lawrence County, and at some point settled in Prairie/Henry Indiana as listed on the 1930 census.¹⁴ From 1910 through 1926 Ethridge was devastated by fires that burned approximately thirty houses and ten businesses. In 1926, Farmers and Merchants Bank became one of the ten businesses damaged by fire, along with the destruction of the T.D. Fite Store, and the post office.¹⁵ Realizing the devastating loss of the only bank in town, Ethridge bank owners moved quickly to build a new Farmers and Merchants Bank.

Showing the prominence of the bank to the community, the new Farmers and Merchants Bank was constructed as a stand-alone building situated on the west side of the railroad opposite the depot.¹⁶ The

¹⁰ Henson, Leighton, and McCall, 9

¹¹ "Eugene Grant Rope Meter Patent," US Patent website, accessed May 3, 2017, <http://patft.uspto.gov/netacgi/nph-Parser?Sect1=PTO1&Sect2=HITOFF&d=PALL&p=1&u=%2Fnethtml%2FPTO%2Fsrchnum.htm&r=1&f=G&l=50&s1=1602576.PN.+A000000.PN.&OS=PN/1602576+OR+PN/A000000&RS=PN/1602576+OR+PN/A000000>.

¹² Henson, Leighton, and McCall, 16.

¹³ Lawrence County Archives, deed book 53, 243.

¹⁴ United States Census 1930, accessed April 13, 2017, https://familysearch.org/search/collection/results?count=20&query=%2Bgivenname%3AEdward~%20%2Bsurname%3ACrews~%20%2Bresidence_place%3AIndiana~%20%2Bgender%3AM%20%2Bbrace%3AWhite%20%2Bmarital_status%3AWidowed&collection_id=1810731

¹⁵ "Ethridge Has Disastrous Fire" , *Democratic Union* (Lawrenceburg, TN), Jun. 2, 1926.

¹⁶ "Ethridge Completes Rebuilding Program After Disastrous Fire". *Democratic Union* (Lawrenceburg, TN), Aug. 1926.

Farmers and Merchants Bank
Name of Property

Lawrence County, TN
County and State

building is located on the west side of the L&N. Railroad on the east portion of Lot 8 of the Hudson and Nixon plot.¹⁷ The 1936 USGS topographic map shows that even with advances in roads and State Route 6 (U.S 43) just a mile west of downtown Ethridge, the area surrounding the railroad depot remained the commercial core.

The coming of the Great Depression with the stock market crash of 1929 resulted in an economic catastrophe never experienced before and small town Ethridge was not exempt from its



Ethridge 1936 USGS Quadrangle that shows State Route 6 (eventually US 43) in relation to downtown Ethridge focused around railroad

From: <http://historicalmaps.arcgis.com/usgs/>

effects. By 1932, stock prices dropped to about twenty percent of the value they had in 1929. The declining value of assets put a financial strain on banks across the U.S. particularly banks holding stocks in their portfolios.¹⁸ Banks unable to recover closed their doors, many never to reopen. Just four years after the stock market crash eleven thousand out of twenty-five thousand banks failed nationwide.¹⁹ Farmers and Merchants Bank of Ethridge struggled during the lean years of the Great Depression. In addition, the bank was robbed in 1933.²⁰ However, Farmers and Merchants Bank remained open during the Great Depression showing its importance to local residents, who may have had to travel outside of their town to find work, but identified with a local Ethridge institution to do business during the unstable years of the Depression.

Though the bank may have survived the Great Depression, the town of Ethridge in many aspects did not. Businesses that survived the decline of the railroad did not survive this economic event. Ethridge became a residential town; people left in the morning for work and returned home to Ethridge in the evening. In 1946

¹⁷ Lawrence County Archives, deed book 89, 290.

¹⁸ David, Kennedy, *Freedom From Fear*, (New York: Oxford University Press, 2001), 239.

¹⁹ Kennedy, 297.

²⁰ Henson, Leighton, and McCall, 16.

Farmers and Merchants Bank
Name of Property

Lawrence County, TN
County and State

the bank was purchased by E.B. Richardson and Docia Richardson. The deed was witnessed by bank president W.L. Brian and E.C. Massey, cashier and the bank was thought to have closed by 1950.²¹ For a period during the early 1950s the former bank building served the residents of Ethridge as a post office.

The two most important buildings in a small community include a bank and a post office. These buildings are at the center of significant portion of the towns activities. The Farmers and Merchants Bank served as both with its vernacular version of the Classical Revival style popular for banks throughout the late nineteenth and early twentieth centuries. The architecture of the Farmers and Merchants bank represents the local history of a small agricultural rural community; in rebuilding after a fire, its owners could not afford finery such as a limestone or marble façade or interior finishes, but it could represent the solidity of banks in larger cities and towns through its simple, fire-resistant design.

The building is a vernacular adaptation of the Classical Revival architectural style. Diane Maddex, editor of *Built in the U.S.A.: American Buildings from Airports to Zoos* states, "Although banks occasionally sought new architectural expression, the traditional visual virtues of strength and security were retained."²² Maddex continues stating although "banks early adopted the canons of classical architecture as appropriate forms to house their functions, the less tangible attributes of strength, security, and stability characterize them as a distinguishable building type."²³ The Farmers and Merchants Bank is a local landmark representing the banking interests in a small agricultural town. The bank was built with quality materials and craftsmanship and is the only classical revival commercial building in the town. The building has experienced minor alterations on the exterior including the removal of the original front door, and no changes on the interior. Although the building requires rehabilitation, it retains its integrity.

Contained in the boundary of Lawrence County are numerous small towns and one city, Lawrenceburg the county seat. At present, there are two banks listed as contributing buildings in the Lawrenceburg Historic Commercial District (Listed 04 02 1992). However, there are no banks of comparative size to the Farmers and Merchants Bank in Ethridge listed on the National Register of Historic Places in Lawrence County or neighboring Maury County. Limited SHPO survey indicates there are no other comparable small town rural banks in Lawrence County.

At the closing of the post office, it is thought that the bank building remained vacant until 2010 when the City of Ethridge purchased the building from Sarah Evetts for ten dollars.²⁴ The bank building is now being utilized by City of Ethridge as storage. Future plans are to renovate the building for use by the city for governmental offices.

²¹ Lawrence County Archives, deed book 89, 290.

²² Diane, Maddex. ed. *Built in the U.S.A.: American Buildings from Airports to Zoos* (Washington. D.C.: Preservation Pres. National Trust for Historic Preservation, 1985),20.

²³ Maddex, 20.

²⁴ Lawrence County Archives, deed book 59, 491.

Farmers and Merchants Bank

 Name of Property

Lawrence County, TN

 County and State

Previous documentation on file (NPS):		Primary location of additional data:	
	preliminary determination of individual listing (36 CFR 67 has been requested)		State Historic Preservation Office
	previously listed in the National Register		Other State agency
	previously determined eligible by the National Register		Federal agency
	designated a National Historic Landmark		Local government
	recorded by Historic American Buildings Survey #		University
	recorded by Historic American Engineering Record #		Other
	recorded by Historic American Landscape Survey #	Name of repository:	
Historic Resources Survey Number (if assigned):			

Farmers and Merchants Bank
Name of Property

Lawrence County, TN
County and State

10. Geographical Data

Acreage of Property	Less than an acre	USGS Quadrangle	Ethridge, 51SE
----------------------------	----------------------	------------------------	----------------

Latitude/Longitude Coordinates

Datum if other than WGS84:
(enter coordinates to 6 decimal places)

1. Latitude: 35.319785 Longitude: -87.305284

Verbal Boundary Description

The Farmers and Merchants Bank sits on less than one acre of land on Depot Street, and is located on parcel 8 on the Lawrence County Tax Map no. 54H.

Boundary Justification

The nominated boundary includes the parcel of land historically associated with the bank.

Farmers and Merchants Bank
Name of Property

Lawrence County, TN
County and State

Location Map
USGS Quadrangle, Ethridge, 51SE

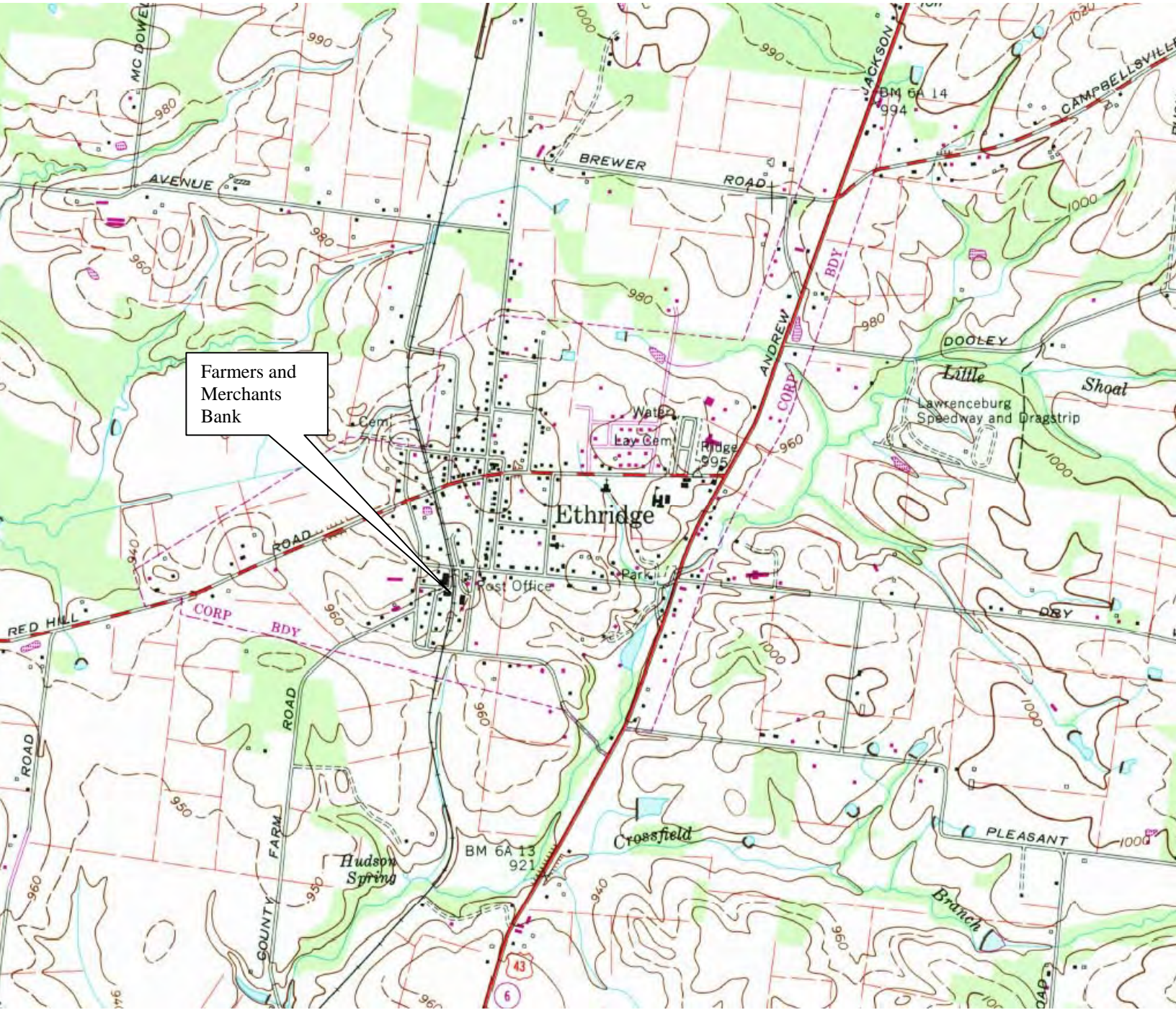

Farmers and Merchants Bank
Name of Property

Lawrence County, TN
County and State

National Register Boundary Map
Lawrence County Parcel 054H F 008.00



Date: August 31, 2017

1:1,128

Farmers and Merchants Bank
Name of Property

Lawrence County, TN
County and State

11. Form Prepared By

Name Teresa Prober, Historic Preservation Planner

Organization South Central Tennessee Development District

Street & Number 101 Sam Watkins Blvd Date _____

City or Town Mount Pleasant Telephone 931-797-0520

E-mail tprober@sctdd.org State TN Zip Code 38474

Paperwork Reduction Act Statement: This information is being collected for applications to the National Register of Historic Places to nominate properties for listing or determine eligibility for listing, to list properties, and to amend existing listings. Response to this request is required to obtain a benefit in accordance with the National Historic Preservation Act, as amended (16 U.S.C.460 et seq.).

Estimated Burden Statement: Public reporting burden for this form is estimated to average 100 hours per response including time for reviewing instructions, gathering and maintaining data, and completing and reviewing the form. Direct comments regarding this burden estimate or any aspect of this form to the Office of Planning and Performance Management, U.S. Dept. of the Interior, 1849 C. Street, NW, Washington, DC.

Farmers and Merchants Bank
Name of Property

Lawrence County, TN
County and State

Photo Log

Name of Property: Farmers and Merchants Bank
City or Vicinity: Ethridge
County: Lawrence State: TN
Photographer: Holly Barnett
Date Photographed: December 8, 2017

Façade or north elevation, facing west.
1 of 9.

Façade or north elevation detail, facing west.
2 of 9.

Southwest elevation, facing northeast.
3 of 9.

Rear elevation, facing northeast.
4 of 9.

Interior view, interior southwest wall facing north.
5 of 9.

Interior detail, ceiling front of building, facing north.
6 of 9.

Interior detail, fireplace rear of building facing west.
7 of 9.

Vault, facing southeast.
8 of 9.

Interior view, bathroom rear of building facing south.
9 of 9.

Farmers and Merchants Bank
Name of Property

Lawrence County, TN
County and State

Site and Floor Plan

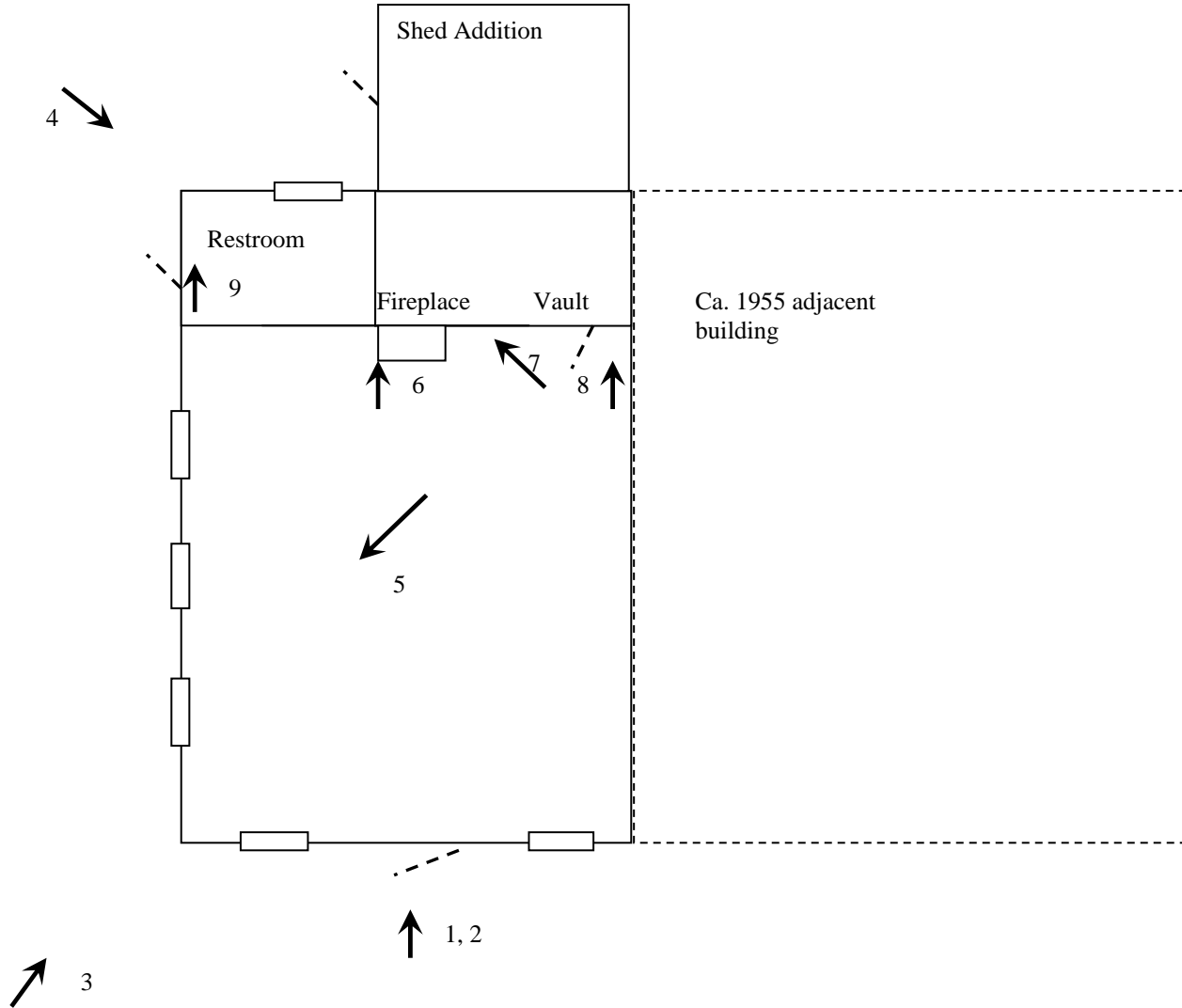

Not to Scale

United States Department of the Interior
National Park Service

National Register of Historic Places
Continuation Sheet

..... Name of Property
..... County and State
..... Name of multiple listing (if applicable)

Section number ____ Page 20

Property Owner:

(This information will not be submitted to the National Park Service, but will remain on file at the Tennessee Historical Commission)

Name	Mayor Robin Cobb, City of Ethridge		
Street & Number	215 Depot Street	Telephone	931 829-2150
City or Town	Ethridge	State/Zip	TN, 38456



BANK



















UNITED STATES DEPARTMENT OF THE INTERIOR
NATIONAL PARK SERVICE

NATIONAL REGISTER OF HISTORIC PLACES
EVALUATION/RETURN SHEET

Requested Action:

Property Name:

Multiple Name:

State & County:

Date Received: 10/4/2017 Date of Pending List: 11/13/2017 8:06:31 AM Date of 16th Day: 11/13/2017 Date of 45th Day: 11/20/2017 Date of Weekly List:

Reference number:

Nominator:

Reason For Review:

- | | | |
|---------------------------------------|--|---|
| <input type="checkbox"/> Appeal | <input type="checkbox"/> PDIL | <input checked="" type="checkbox"/> Text/Data Issue |
| <input type="checkbox"/> SHPO Request | <input type="checkbox"/> Landscape | <input type="checkbox"/> Photo |
| <input type="checkbox"/> Waiver | <input type="checkbox"/> National | <input type="checkbox"/> Map/Boundary |
| <input type="checkbox"/> Resubmission | <input type="checkbox"/> Mobile Resource | <input type="checkbox"/> Period |
| <input type="checkbox"/> Other | <input type="checkbox"/> TCP | <input type="checkbox"/> Less than 50 years |
| | <input type="checkbox"/> CLG | |

Accept Return Reject 11/13/2017 Date

Abstract/Summary Comments:

Recommendation/ Criteria:

Reviewer Jim Gabbert Discipline Historian

Telephone (202)354-2275 Date _____

DOCUMENTATION: see attached comments : No see attached SLR : **Yes**

If a nomination is returned to the nomination authority, the nomination is no longer under consideration by the National Park Service.



TENNESSEE HISTORICAL COMMISSION
STATE HISTORIC PRESERVATION OFFICE
2941 LEBANON PIKE
NASHVILLE, TENNESSEE 37243-0442
OFFICE: (615) 532-1550
E-mail: Claudette.Stager@tn.gov
(615) 770-1089



October 2, 2017

J. Paul Loether
Deputy Keeper and Chief,
National Park Service
National Register of Historic Places
1849 C Street, NW, Mail Stop 7228
Washington, DC 20240

National Register Nomination

- *Farmers and Merchants Bank, Maury County, Tennessee*

The enclosed disks contain the true and correct nomination for listing of the *Farmers and Merchants Bank* to the National Register of Historic Places. We received no comments.

If you have any questions or if more information is needed, please contact Holly Barnett at (615) 770-1098 or Holly.M.Barnett@tn.gov.

Sincerely,

Claudette Stager
Deputy State Historic Preservation Officer

CS:hb

Enclosures(2)