

UNITED STATES DEPARTMENT OF THE INTERIOR
NATIONAL PARK SERVICE

**NATIONAL REGISTER OF HISTORIC PLACES
INVENTORY -- NOMINATION FORM**

FOR NPS USE ONLY

RECEIVED JAN 29 1980

APR 16 1980

DATE ENTERED

SEE INSTRUCTIONS IN *HOW TO COMPLETE NATIONAL REGISTER FORMS*
TYPE ALL ENTRIES -- COMPLETE APPLICABLE SECTIONS

1 NAME

HISTORIC

Philips-Thompson Buildings

AND/OR COMMON

2 LOCATION

STREET & NUMBER

200-206 E. Fourth Street

___NOT FOR PUBLICATION

CITY, TOWN

Wilmington

CONGRESSIONAL DISTRICT

000

___ VICINITY OF

STATE

Delaware

CODE

10

COUNTY

New Castle

CODE

003

3 CLASSIFICATION

CATEGORY	OWNERSHIP	STATUS	PRESENT USE
<input type="checkbox"/> DISTRICT	<input type="checkbox"/> PUBLIC	<input checked="" type="checkbox"/> OCCUPIED	<input type="checkbox"/> AGRICULTURE <input type="checkbox"/> MUSEUM
<input checked="" type="checkbox"/> BUILDING(S)	<input checked="" type="checkbox"/> PRIVATE	<input type="checkbox"/> UNOCCUPIED	<input checked="" type="checkbox"/> COMMERCIAL <input type="checkbox"/> PARK
<input type="checkbox"/> STRUCTURE	<input type="checkbox"/> BOTH	<input type="checkbox"/> WORK IN PROGRESS	<input type="checkbox"/> EDUCATIONAL <input type="checkbox"/> PRIVATE RESIDENCE
<input type="checkbox"/> SITE	PUBLIC ACQUISITION	ACCESSIBLE	<input type="checkbox"/> ENTERTAINMENT <input type="checkbox"/> RELIGIOUS
<input type="checkbox"/> OBJECT	<input type="checkbox"/> IN PROCESS	<input type="checkbox"/> YES: RESTRICTED	<input type="checkbox"/> GOVERNMENT <input type="checkbox"/> SCIENTIFIC
	<input type="checkbox"/> BEING CONSIDERED	<input checked="" type="checkbox"/> YES: UNRESTRICTED	<input type="checkbox"/> INDUSTRIAL <input type="checkbox"/> TRANSPORTATION
		<input type="checkbox"/> NO	<input type="checkbox"/> MILITARY <input type="checkbox"/> OTHER:

4 OWNER OF PROPERTY

NAME

Mr. Clayton Liddell

STREET & NUMBER

2610 Calvary Road

CITY, TOWN

Bel Air

___ VICINITY OF

md.

STATE

Delaware

5 LOCATION OF LEGAL DESCRIPTION

COURTHOUSE.

REGISTRY OF DEEDS, ETC.

Recorder of Deeds

City/County Building

STREET & NUMBER

800 French Street

CITY, TOWN

Bel Air

STATE

Maryland

6 REPRESENTATION IN EXISTING SURVEYS

TITLE

Delaware Cultural Resource Survey

N-2003

DATE

August 1979

___FEDERAL STATE ___COUNTY ___LOCALDEPOSITORY FOR
SURVEY RECORDS

Hall of Records

CITY, TOWN

Dover

STATE

Delaware 19901

7 DESCRIPTION

CONDITION		CHECK ONE	CHECK ONE
<input type="checkbox"/> EXCELLENT	<input type="checkbox"/> DETERIORATED	X <input type="checkbox"/> UNALTERED	X <input type="checkbox"/> ORIGINAL SITE
X <input type="checkbox"/> GOOD	<input type="checkbox"/> RUINS	<input type="checkbox"/> ALTERED	<input type="checkbox"/> MOVED DATE _____
<input type="checkbox"/> FAIR	<input type="checkbox"/> UNEXPOSED		

DESCRIBE THE PRESENT AND ORIGINAL (IF KNOWN) PHYSICAL APPEARANCE

Located two blocks to the east of Wilmington's main commercial district on Market Street, the Philips-Thompson buildings form the corner of a row of commercial buildings bordering a four-lane street. The buildings face across 4th Street to several blocks of vacant land cleared for urban renewal which are now used as surface parking lots.

The two red brick buildings, laid in a common bond, are three stories tall and have a total of 12 bays across the facade. A row of square decorative terra cotta tiles divides the second and third stories on both the French Street and 4th Street elevations. A decorative corbelled brick cornice surrounds the roof line, which is topped with a carved wooden frieze. On the 4th Street side of both buildings, a central carved wooden sunburst surmounts the frieze, projecting out slightly. Double-hung two over two windows with ornate brick hood mouldings are evenly spaced on the elevations.

The first floor, or street level, has five recessed entrances with reeded moulding in the architrave around original double wooden doors. The doors all have recessed-panelled lower sections, and glass upper sections framed by an opening with chamfered sides. A multi-paned transom surmounts each of these entrances except one, which now holds an air conditioner. Frosted glass transoms are set above the large plate glass display windows.

On the store's interior, pressed tin decoration covers half of the ceiling over the main selling area. What is probably the original counter lines part of one wall of the store. The counter has three recessed panels on its front and angled shelves with windows to display flower bulbs. Ornatly-decorated iron radiators with floral designs and putti figures rest on the hardwood floors which cover the ground floor level. Opposite the sales counter is an original elevator which moves products to the second and third floor storage areas. Reeded wainscoting sheathes part of the interior side and rear walls where original storage bins are located.

The company offices still occupy one wall on the first floor. The offices are separated from the selling area by windows and doors. The original bill collection window still exists.

The buildings maintains its original character, with the exception of the corner located at 4th and French Streets, which has been altered by the addition of concrete blocks to strengthen the corner. New bricks have been added to the facade in several places.

8 SIGNIFICANCE

PERIOD	AREAS OF SIGNIFICANCE -- CHECK AND JUSTIFY BELOW			
<input type="checkbox"/> PREHISTORIC	<input type="checkbox"/> ARCHEOLOGY-PREHISTORIC	<input type="checkbox"/> COMMUNITY PLANNING	<input type="checkbox"/> LANDSCAPE ARCHITECTURE	<input type="checkbox"/> RELIGION
<input type="checkbox"/> 1400-1499	<input type="checkbox"/> ARCHEOLOGY-HISTORIC	<input type="checkbox"/> CONSERVATION	<input type="checkbox"/> LAW	<input type="checkbox"/> SCIENCE
<input type="checkbox"/> 1500-1599	<input type="checkbox"/> AGRICULTURE	<input type="checkbox"/> ECONOMICS	<input type="checkbox"/> LITERATURE	<input type="checkbox"/> SCULPTURE
<input type="checkbox"/> 1600-1699	<input checked="" type="checkbox"/> ARCHITECTURE	<input type="checkbox"/> EDUCATION	<input type="checkbox"/> MILITARY	<input type="checkbox"/> SOCIAL/HUMANITARIAN
<input type="checkbox"/> 1700-1799	<input type="checkbox"/> ART	<input type="checkbox"/> ENGINEERING	<input type="checkbox"/> MUSIC	<input type="checkbox"/> THEATER
<input checked="" type="checkbox"/> 1800-1899	<input checked="" type="checkbox"/> COMMERCE	<input type="checkbox"/> EXPLORATION/SETTLEMENT	<input type="checkbox"/> PHILOSOPHY	<input type="checkbox"/> TRANSPORTATION
<input checked="" type="checkbox"/> 1900-	<input type="checkbox"/> COMMUNICATIONS	<input type="checkbox"/> INDUSTRY	<input type="checkbox"/> POLITICS/GOVERNMENT	<input type="checkbox"/> OTHER (SPECIFY)
		<input type="checkbox"/> INVENTION		

SPECIFIC DATES c.1884

BUILDER/ARCHITECT Unknown

STATEMENT OF SIGNIFICANCE

The Philips-Thompson Building is significant as a fine example of late 19th century commercial architecture which survives intact, and which still houses the original farm supply business that it was built for.

In the Philips-Thompson Building can be seen many of the finer characteristics of 19th century commercial architecture. The exterior sports handsome brickwork in the various styles of hood moldings over the windows and the corbelled brick cornice. The sunburst decorations capping the central bays are unmatched in Wilmington commercial architecture. On the interior, the decorative tin ceiling and ornately-styled iron radiators are fine examples of the decoration that was found in some 19th century commercial buildings.

The building is also significant for the fact that it houses the only farm supply left in Wilmington. Although Wilmington was for years the wholesale farm supply center of this area, as the suburbs have grown to encompass a larger area, the farms have been pushed further away from the city. Most farm supply businesses have moved from the city to be near the farms. But the Philips-Thompson Company remains, the last of the old farm suppliers left in Wilmington.

The company was begun in 1878 as I. D. Philips, a flour, grain and mill store in Greenbank, Delaware. About 1885, the company relocated to 200 W. 4th Street. According to the 1900 Board of Trade Journal, the Philips Thompson Company was a manufacturers agent and shippers of flour, feed, salt, seeds, grain, hay, and straw. They were also dealers in anthracite coal, and the company maintained a storage warehouse and coalyard at 4th and Church Streets, now demolished. In a 1932 issue of Wilmington, the Chamber of Commerce magazine, a Philips-Thompson Company advertisement listed the company's territory as including the Delmarva Peninsula and southeastern Pennsylvania.

The buildings have simultaneously housed other businesses and organizations in additions to the Philips-Thompson Company. Currently, the Crowe Produce and Seafood Markets occupy 204 and 205 W. 4th Street, respectively. In the late 19th century, wholesale grocers and produce shops, as well as a carter, occupied portions of the buildings. Political and religious groups met in the building, probably upstairs. The Republican Invincible Club, formed in 1890, members of which were some of the most efficient ward and district leaders in Wilmington, had its first home in the Philips-Thompson Building. In 1889, the City Directory lists the reformed Methodist Church at that address, as well as the Knights of St. Lawrence and the Albert Bay Club.

9 MAJOR BIBLIOGRAPHICAL REFERENCES

City Directories of Wilmington
Board of Trade Journal, June, 1900
Wilmington, Chamber of Commerce Magazine, March, 1932
Smiley, F. T., History of Wilmington, 1894

UTM NOT VERIFIED

10 GEOGRAPHICAL DATA

ACREAGE NOT VERIFIED

ACREAGE OF NOMINATED PROPERTY 0.16

Quadrangle Name: Wilmington South
Quadrangle Scale: 1"=24,000'

UTM REFERENCES

A 18 | 452900 | 4398760
ZONE EASTING NORTHING

B [] | [] | []
ZONE EASTING NORTHING

C [] | [] | []
ZONE EASTING NORTHING

D [] | [] | []
ZONE EASTING NORTHING

VERBAL BOUNDARY DESCRIPTION

The nominated property occupies a city lot which measures approximately 93 feet by 78 feet.

LIST ALL STATES AND COUNTIES FOR PROPERTIES OVERLAPPING STATE OR COUNTY BOUNDARIES

STATE	CODE	COUNTY	CODE
STATE	CODE	COUNTY	CODE

11 FORM PREPARED BY

NAME / TITLE

Sara C. Ramsey, and Jean C. Athan

ORGANIZATION

Wilmington Department of Planning

DATE

November 19, 1979

STREET & NUMBER

800 French St. 7th Floor

TELEPHONE

302-571-4172

CITY OR TOWN

Wilmington,

STATE

Delaware 19801

12 STATE HISTORIC PRESERVATION OFFICER CERTIFICATION

THE EVALUATED SIGNIFICANCE OF THIS PROPERTY WITHIN THE STATE IS:

NATIONAL

STATE

LOCAL X

As the designated State Historic Preservation Officer for the National Historic Preservation Act of 1966 (Public Law 89-665), I hereby nominate this property for inclusion in the National Register and certify that it has been evaluated according to the criteria and procedures set forth by the National Park Service.

Deputy STATE HISTORIC PRESERVATION OFFICER SIGNATURE

Daniel P. Shuffeth

TITLE Chief, Bureau of Archaeology & Historic Preservation

DATE 1/21/80

FOR NPS USE ONLY

I HEREBY CERTIFY THAT THIS PROPERTY IS INCLUDED IN THE NATIONAL REGISTER

Anna Jane Saye
DIRECTOR, OFFICE OF ARCHAEOLOGY AND HISTORIC PRESERVATION
ATTEST: *Anna Jane Saye*
KEEPER OF THE NATIONAL REGISTER
Regional Coordinator

for DATE April 16, 1980
KEEPER OF THE NATIONAL REGISTER
DATE 4-16-80

FHR-8-300A
(11/78)

UNITED STATES DEPARTMENT OF THE INTERIOR
HERITAGE CONSERVATION AND RECREATION SERVICE

NATIONAL REGISTER OF HISTORIC PLACES INVENTORY -- NOMINATION FORM

FOR HCRS USE ONLY	
RECEIVED	JAN 29 1980
DATE ENTERED	JAN 15 1980

Philips-Thompson Buildings

CONTINUATION SHEET 1 ITEM NUMBER 8 PAGE 1

The Philips-Thompson Building is representative of a type of structure not found in modern day architecture - a building built for a mundane commercial use, but embellished with rich architectural features which transcend the structure's ordinary use. Too often modern day commercial architecture tends toward "utilitarian" boxes of sheet metal. The Philips-Thompson Building remains, a reminder of a time when commercial architecture was not only utilitarian but, gracious and even beautiful.

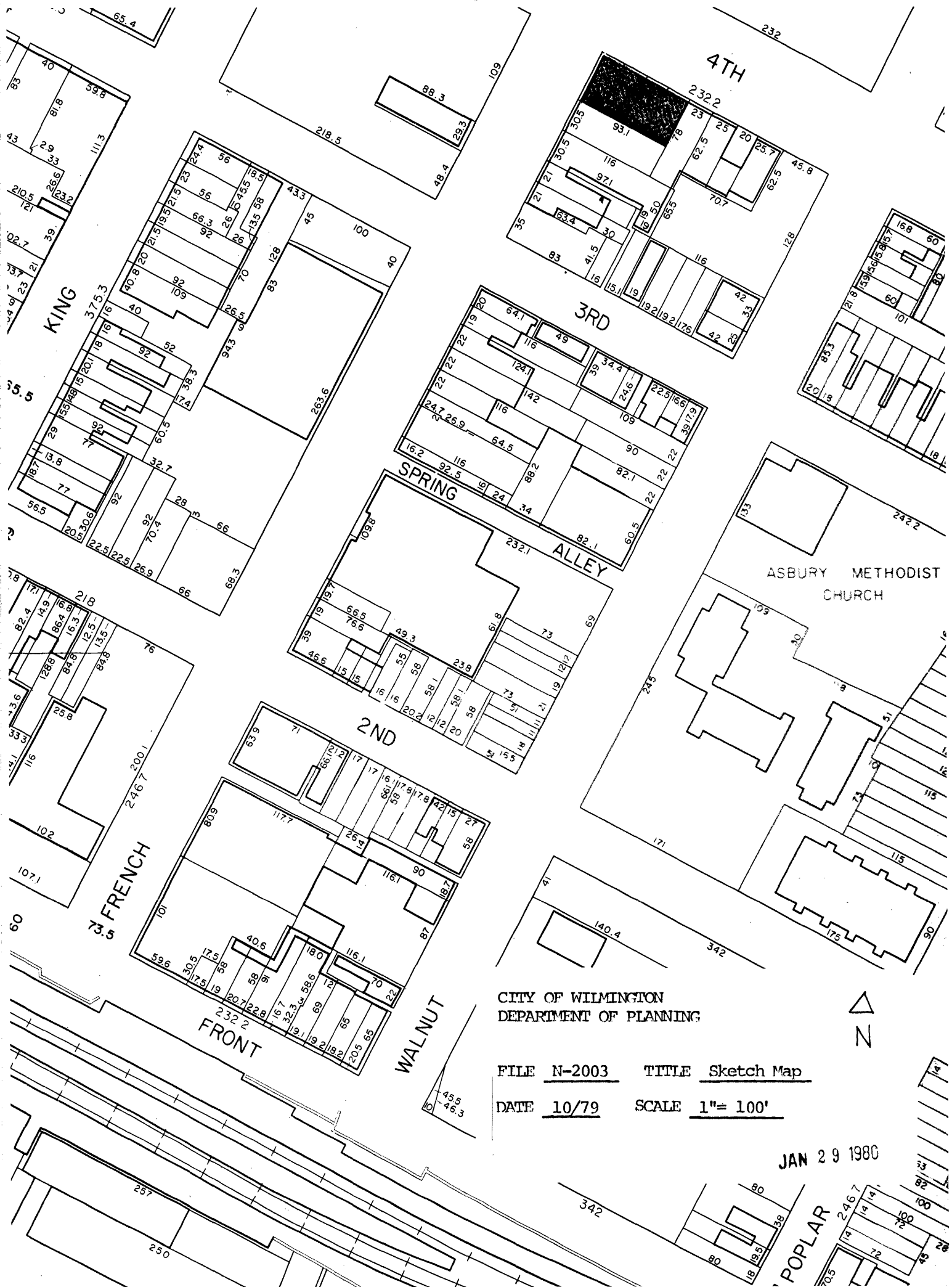

4TH

3RD

SPRING

ALLEY

2ND

FRENCH

FRONT

WALNUT

ASBURY METHODIST CHURCH

CITY OF WILMINGTON
DEPARTMENT OF PLANNING



FILE N-2003 TITLE Sketch Map

DATE 10/79 SCALE 1"= 100'

JAN 29 1980

POPLAR