

ARCHITECTURAL / HISTORICAL SURVEY

DAVENPORT, IOWA

The Architects Office

Wehner, Nowysz, Pottschiull and Pfiffner
901 day building, Iowa city, Iowa 52240

DAVENPORT COMMUNITY DEVELOPMENT DEPARTMENT
IOWA DIVISION OF HISTORIC PRESERVATION

SITE SHEET

ARCHITECTURE

SITE # 82-10- 4-W1332 MAP # 2

HIST. DIST. _____

NAME Fennern, Henry P. House (H) C

ADDRESS 1332 W. 4th Street

LEGAL DES. _____ (See continua-
~~78XXXX~~ tion sheet)
SUB-DIVISION BLOCK PARCEL SUB-PARCEL

UTM 15 7100790 45199480 ACRES -1 ZONE M-1
EASTING NORTHING

OWNER A. H. Patsch and wife
2802 Telegraph Rd., Davenport, IA 52804

TITLE H. _____
(IF DIFF) _____

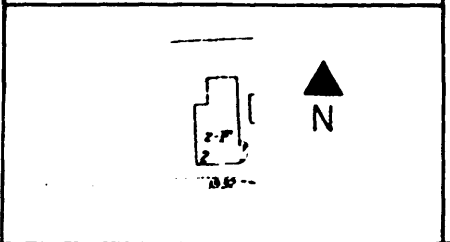
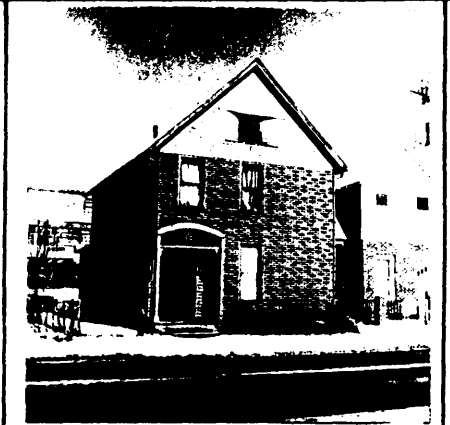

DESCRIPTION

FORM 2 story, front gable house, projecting window bay E. side CONST DATE 1902
MATERIALS Wood ARCH STYLE _____
FENESTRATION Rectangular in plain surrounds
DIST. FEATURES See below
ALTERATIONS Faced to eaves w/asbestos "brick"
SITE & RELATED STR. Small lot in residential area of similar structures

STATEMENT

Although resided, this little house displays two highly unusual decorative elements. The spindle screens at the corner, behind which is the deeply recessed entrance; and the gable end, with 3 types of shingles and a small window set in curved reveals strongly suggestive of the Eastern shingle style. With these features, and its fairly good condition, it is appropriate to recognize this house - and perhaps to encourage restoration.

SOURCES

SIGNIFICANCE

DESCRIPTION

This house was probably built in 1902 by Henry P. Fennern. Fennern was employed as a shipper by J. F. Kelly and Company, a wholesale grocer.

SOURCES

City Directories, 1900-01, 1902-03.
 Sanborn Fire Insurance Maps, 1892.

ARCHITECTURAL HISTORIAN Martha Bowers

HISTORIAN MARLYS SVENDSEN - ROESLER

SURVEY COMP 1981

EVALUATION

ARCHITECTURAL

I ARCH EVALUATION Fair
 II ENVIR STATURE Tissue
 III INT OF CONTEXT Good
 IV INT OF FABRIC Good

LEVEL OF SIGNIFICANCE
 NAT STATE LOCAL N ELIG

HISTORICAL

I THEME(S) OF SIGNIFICANCE
 A PRIMARY _____
 B SECONDARY _____

II LEVEL OF SIGNIFICANCE
 NAT STATE LOCAL

III NRHP
 ELIGIBLE NOT ELIGIBLE

HISTORIC DISTRICT CLASSIFICATION

A B C

FOR DIVISION OF HISTORIC PRESERVATION USE ONLY

1 DATE RECEIVED _____

2 DATE OF STAFF EVALUATION _____

	A ARCHITECTURAL	B HISTORICAL
ELIGIBLE FOR NRHP	<input type="checkbox"/>	<input type="checkbox"/>
NOT ELIGIBLE FOR NRHP	<input type="checkbox"/>	<input type="checkbox"/>

3 NRHP ACTION

A STATE REVIEW COMM	APP <input type="checkbox"/>	DISAPP <input type="checkbox"/>	TABLED <input type="checkbox"/>	DATE _____
B FEDERAL REVIEW	APP <input type="checkbox"/>	DISAPP <input type="checkbox"/>	TABLED <input type="checkbox"/>	DATE _____

4 OTHER SOURCES

<input type="checkbox"/> COUNTY RESOURCES	<input type="checkbox"/> DET OF ELIGIBILITY
<input type="checkbox"/> W SHIELD SURVEY	<input type="checkbox"/> P. B. C. _____
<input type="checkbox"/> NRHP	<input checked="" type="checkbox"/> DAVENPORT A/H SURVEY
<input type="checkbox"/> GRANT	<input type="checkbox"/> _____

5 SUBJECT FILE _____

6 PHOTO _____

1613-11

FEB 22 1977

ARCHITECTURAL/HISTORICAL SURVEY

DAVENPORT, IOWA

The Architects Office

Wehner, Nowysz, Pattschull and Pfiffner
201 day building iowa city iowa 52240

DAVENPORT COMMUNITY DEVELOPMENT DEPARTMENT
IOWA DIVISION OF HISTORIC PRESERVATION

82-10-4-W1332

Legal Description:

Part of Sec 34-78-3 beginning on N/L of 4th St. 129' E. of
E/L of Fillmore St.-N 72'-W32'-S 72 '-E 32' to Beginning.

CONTINUATION