

UNITED STATES DEPARTMENT OF THE INTERIOR
NATIONAL PARK SERVICE

FOR NPS USE ONLY
RECEIVED
MAY 31 1977
DATE ENTERED
DEC 2 1977

NATIONAL REGISTER OF HISTORIC PLACES INVENTORY -- NOMINATION FORM

SEE INSTRUCTIONS IN HOW TO COMPLETE NATIONAL REGISTER FORMS
TYPE ALL ENTRIES -- COMPLETE APPLICABLE SECTIONS

1 NAME

HISTORIC ****** Hadley Center Historic District
AND/OR COMMON Hadley Center Historic District

2 LOCATION

STREET & NUMBER Multiple- Middle and Russell Streets
CITY, TOWN Hadley VICINITY OF First
STATE Massachusetts CODE 01035 COUNTY Hampshire CODE 015

3 CLASSIFICATION

CATEGORY	OWNERSHIP	STATUS	PRESENT USE
<input checked="" type="checkbox"/> DISTRICT	<input type="checkbox"/> PUBLIC	<input checked="" type="checkbox"/> OCCUPIED	<input type="checkbox"/> AGRICULTURE <input checked="" type="checkbox"/> MUSEUM
<input type="checkbox"/> BUILDING(S)	<input type="checkbox"/> PRIVATE	<input type="checkbox"/> UNOCCUPIED	<input checked="" type="checkbox"/> COMMERCIAL <input type="checkbox"/> PARK
<input type="checkbox"/> STRUCTURE	<input checked="" type="checkbox"/> BOTH	<input type="checkbox"/> WORK IN PROGRESS	<input checked="" type="checkbox"/> EDUCATIONAL <input checked="" type="checkbox"/> PRIVATE RESIDENCE
<input type="checkbox"/> SITE	PUBLIC ACQUISITION	ACCESSIBLE	<input type="checkbox"/> ENTERTAINMENT <input checked="" type="checkbox"/> RELIGIOUS
<input type="checkbox"/> OBJECT	<input type="checkbox"/> IN PROCESS	<input checked="" type="checkbox"/> YES: RESTRICTED	<input checked="" type="checkbox"/> GOVERNMENT <input type="checkbox"/> SCIENTIFIC
	<input type="checkbox"/> BEING CONSIDERED	<input type="checkbox"/> YES: UNRESTRICTED	<input type="checkbox"/> INDUSTRIAL <input type="checkbox"/> TRANSPORTATION
		<input type="checkbox"/> NO	<input type="checkbox"/> MILITARY <input type="checkbox"/> OTHER:

4 OWNER OF PROPERTY

NAME Mutiple
STREET & NUMBER
CITY, TOWN Hadley VICINITY OF STATE Massachusetts 01035

5 LOCATION OF LEGAL DESCRIPTION

COURTHOUSE, REGISTRY OF DEEDS, ETC. Hampshire County Registry of Deeds
STREET & NUMBER 33 King Street
CITY, TOWN Northampton STATE Massachusetts 01060

6 REPRESENTATION IN EXISTING SURVEYS

TITLE Inventory of the Historic Assets of the Commonwealth
DATE 1976 FEDERAL STATE COUNTY LOCAL
DEPOSITORY FOR SURVEY RECORDS Massachusetts Historical Commission
CITY, TOWN Boston STATE Massachusetts 02108

7 DESCRIPTION

CONDITION		CHECK ONE	CHECK ONE
<input checked="" type="checkbox"/> EXCELLENT	<input type="checkbox"/> DETERIORATED	<input type="checkbox"/> UNALTERED	<input checked="" type="checkbox"/> ORIGINAL SITE
<input type="checkbox"/> GOOD	<input type="checkbox"/> RUINS	<input checked="" type="checkbox"/> ALTERED	2 <input checked="" type="checkbox"/> MOVED DATE 1841 and 1930
1 <input checked="" type="checkbox"/> FAIR	<input type="checkbox"/> UNEXPOSED		

DESCRIBE THE PRESENT AND ORIGINAL (IF KNOWN) PHYSICAL APPEARANCE

The Hadley Center Historic District is located in Hadley, at the intersection of the two main highways which bisect the town, Routes 9 and 47, locally known as Russell and Middle Streets. The district lies at the geographic center of the town and is the hub of town activity. It is comprised of 17 buildings, all of which face a 50 foot town owned Green. This area of maples and elms separates the sidewalk bordering the properties from the street and provides the district with a park-like quality. The area surrounding the district is primarily contemporary commercial structures.

The buildings within the district range in age from the late 18th century and early 19th century to a modern modified "Colonial" style. Public buildings include the Town Hall, Farm Museum, Goodwin Memorial Library, and the Russell School. The prominence of the Hadley Town Hall, the First Congregational Church, and the Farm Museum, and the harmonious styles of the other structures represent an early 19th century town center adapted to modern use.

HOOKER SCHOOL (#1) is located on the east side of Middle Street. The original building was designed by Karl Putnam of Northampton in 1921. It is a three story, hip roof structure. The exterior walls are of brick coursed in Flemish bond. Two brick string-courses run around the center of the building. Fenestration is six light casements in the basement, 12/12 double-hung on the first floor and 8/12 on the second. The basement windows are framed by their architraves alone; the first story windows have flat sandstone sills, and sandstone Welsh arch lintels; the second story window arches have a sandstone key.

The seven bay symmetrical facade faces west toward Middle Street. A three bay center section projects slightly. Eight stone steps lead to the center entrance, which consists of double wooden doors, each containing four lights. The doors are headed by a fanlight, and framed by flat stone pilasters which support a triangular pediment overhead. The triangularly pedimented cross gable over the center section contains a circular window with keystone ornaments on its compass points.

The side elevations are three bays deep. A single bay deep section projects from the rear elevation. The north and south elevations of this section each contain an open entry porch with a tall arched window with keystone overhead. A 1950 addition is attached at the rear of the building.

GOODWIN MEMORIAL LIBRARY (#2) stands at the northeast corner of Middle and Russell Streets. It was designed in the Georgian Revival style by Guy Kirkham of Springfield, and built in 1902. The two story, hip roof building is of red brick with granite trim. A triple stringcourse encircles the structure below the dentilled entablature. Nine light basement windows are exposed.

The three bay facade faces south toward Russell Street and has an Ionic order entrance portico. The portico has a wide molded entablature on the two sides with an arched opening interrupted by the gable returns at the facade. On either side of the portico is a 12/12 arched window with a granite sill and a compound arch with keystone overhead. Directly above the portico is a Palladian window within the intersecting gable.

UNITED STATES DEPARTMENT OF THE INTERIOR
NATIONAL PARK SERVICE

**NATIONAL REGISTER OF HISTORIC PLACES
INVENTORY -- NOMINATION FORM**

FOR NPS USE ONLY

RECEIVED MAY 31 1977

DATE ENTERED DEC 2 1977

CONTINUATION SHEET

ITEM NUMBER

PAGE

Hadley Center Historic District

7

1

The west elevation is five bays deep, and contains an entrance portico identical to that on the facade. It is flanked by two arched windows on either side, and headed by two 24 light double casement windows on the second story. These alternate with three plaster friezes, and are headed by a granite inscription identifying the library. The east elevation repeats the design of the west elevation, with a fifth arched window substituting for the entrance portico.

ST. JOHN THE APOSTLE CHURCH (#3) faces south toward Russell Street. It was designed by architects Toomey and Shea, and was constructed in 1902. The ridge roof structure rests on a brick foundation, and is sheathed in white asbestos shingles. A dentiled cornice runs beneath the overhanging eaves. Fenestration is round arched stained glass with keystone. The central tower on the facade contains the ridge roof Doric order entrance portico, supported by four flat Doric columns. Above the portico in the tower is a rose window. The two stage steeple is an octagonal belfry with eight arched louvered openings, separated by flat pilasters at each corner and topped by an octagonal spire with a gold cross.

The east and west elevations are four bays deep. A wing was added across the rear of the building in 1965.

HADLEY FARM MUSEUM (#4) was built by Charles Phelps of Hadley in 1782 as a barn for his large cattle and grain producing farm. The two story, ridge roof building was moved approximately two miles to its present site in 1930. At that time it was converted to a farming museum. The narrow clapboards, the 8/8 windows, and the gable end fanlights were added in 1930, as was the center doorway on the five bay deep north elevation. This entrance is a copy of one in Hadley's oldest house, built in 1713. It is a double panelled door with six lights, flanked by molded pilasters, headed by a molded dentilled entablature, and crowned by an open scroll pediment.

The east and west elevations are three bays wide and retain their original wide double doors with shingled overhang. The two 22 light horizontal windows directly above each of these doors are also original. A weathervane stands on the peak of the south gable end. The museum is open to the public at no charge.

HADLEY TOWN HALL (#5) is located at the southeast corner of the intersection of Russell and Middle Streets. This 1841 Greek Revival style structure was designed by Thomas Pratt of Northampton. The two story, ridge roof building has a wide entablature with a simple molded frieze. It rests on a concrete foundation. The three bays of the facade and the four bays of the side elevations are defined by wide, flat pilasters. The basement windows are exposed on the north and south elevations. On the first and second story fenestration is 8/8 with simple architrave and slightly projecting cornice.

UNITED STATES DEPARTMENT OF THE INTERIOR
NATIONAL PARK SERVICE

**NATIONAL REGISTER OF HISTORIC PLACES
INVENTORY -- NOMINATION FORM**

FOR NPS USE ONLY

RECEIVED MAY 31 1977

DATE ENTERED

DEC 8 1977

CONTINUATION SHEET

ITEM NUMBER

PAGE

Hadley Center Historic District

7

2

The facade faces west toward Middle Street. It is dominated by a deep Doric portico. The triangular pediment contains a circular louvered opening at the center. This pediment and the exterior wall below are sheathed in matched board. The center entrance is double four panel doors with six lights each, headed by two horizontal lights and a triangular pediment. Directly above this entrance is a double 8/8 window. The north and south elevations originally had four long windows each. These were replaced in 1902 by 8/8 on both floors with projecting cornices on the first floor. There are entrances on the eastern end of both the north and south elevations. These are wooden panel doors shielded by ridge roof porticos with flat Doric columns, wide molded entablatures and triangular pediments. The interior of the building was remodeled in 1902.

FIRST CONGREGATIONAL CHURCH (#6) assumes a prominent position next to the Town Hall on Middle Street. This third meetinghouse was built in 1804, and moved from West Street to its present location in 1841. It is a two story, ridge roof structure sheathed in clapboards. A dentilled cornice runs continuously around the building. Cornerboards are wide and plain. Fenestration is 20/20 with flat architraves. The facade faces west. The center entrance bay projects, and contains the main double six panel wooden doors headed by a fanlight. The doors are flanked by two pilasters at the corners, all supporting the wide, flat entablature of the projection. The doors are headed by a large Palladian window which is crowned by a dentilled triangular gable pediment. The north and south elevations of the projection each show a single door with fanlight, and a single second story window overhead. The projection is flanked by one bay on either side, with a first and second story window in each.

The side elevations are eight bays deep. The church steeple closely resembles those of the Bulfinch and Christopher Wren style. It is comprised of three stages. The square tower rises from the ridge of the facade projection. Just above the ridge of the roof of the main building, a plain band runs around the tower, topped by a clock face on each side. The entablature is plain, headed by an overhanging dentilled cornice. The belfry is in two stages; the first with four shallow arched openings, surrounded by a turned balustrade with pinnacles at each corner. The second stage is four arched, louvered openings flanked by narrow pilasters, and headed by molded, dentilled entablature, again with a turned balustrade at the base. The final stage is a hexagonal lantern with laticed balustrade with an urn at each corner. The lantern contains four louvered arched openings flanked by delicate pilasters, headed by an entablature with dentilled overhang, and crowned by four pinnacles around a hexagonal spire. This is topped by a large gilded weathervane imported from England in 1752. A modern addition harmonious in style was extended from the east (rear) elevation in 1964, it is used as a Christian Education annex.

UNITED STATES DEPARTMENT OF THE INTERIOR
NATIONAL PARK SERVICE

**NATIONAL REGISTER OF HISTORIC PLACES
INVENTORY -- NOMINATION FORM**

FOR NPS USE ONLY

RECEIVED MAY 31 1977

DATE ENTERED DEC 2 1977

CONTINUATION SHEET

ITEM NUMBER

PAGE

Hadley Center Historic District

7

3

DR. FRANK SMITH HOUSE (#7) also was designed by Guy Kirkham. It was built in 1903 in the Colonial Revival style, and stands south of the Church on Middle Street. It is a 2½ story, grey clapboard house with a brick chimney on the south end of the shingled ridge roof. Fenestration is 6/1.

The facade faces west. A four columned one story portico shelters the main entrance, which is flanked by two small casement windows. Directly above the portico is a triple 6/1 window. The northern and southern ends are three sided bays containing three windows on the first story, two on the second. A shingled ridge roof dormer lies at the center of the roof, with double 8/1 windows, headed by a triangular pediment. The south elevation has a three sided bay on the eastern end that repeats the style of those on the facade. The eastern end has a recent one story hip roof addition. There is a small barn to the east of the house.

FIRST CONGREGATIONAL CHURCH PARSONAGE (#8) was built in 1854 in the Greek Revival style. It is a two story, ridge roof, clapboard structure with a granite slab foundation. A wide entablature is continuous around the building. Wide pilasters define the corners. Fenestration is 6/6.

The five bay facade faces south. The center entrance porch has two columns supporting a wide entablature and flat roof. The west gable end faces the street and is three bays wide. It is dominated by a triangular pediment. Within the plain tympanum is a recessed triangular panel. A one story ell extends from the eastern elevation. The open shed roof porch on the ell is a later addition.

DELIA STALL HOUSE (#9) was built circa 1840. It is a simple 1½ story ridge roof clapboard house with a tall center chimney and granite slab foundation. Fenestration is varied with floor to ceiling windows on the first story facade, six light casement "eyebrows" on the second story facade, and small sash windows on the elevations. The windows are headed by flat cornices. The house has a plain entablature and corner boards.

The three bay facade faces west toward Middle Street. A ridge roof porch shelters the shuttered door. The porch is supported by two turned posts, and has a low balustrade on either side. The north and south elevations are one bay deep. Extending from the east elevation is a one story ell that may be older than the main house. There is a cellar beneath the ell only. It is framed largely of half sawn logs, and lined with rock.

UNITED STATES DEPARTMENT OF THE INTERIOR
NATIONAL PARK SERVICE

FOR NPS USE ONLY

RECEIVED MAY 31 1977

DATE ENTERED DEC 2 1977

**NATIONAL REGISTER OF HISTORIC PLACES
INVENTORY -- NOMINATION FORM**

CONTINUATION SHEET

ITEM NUMBER

PAGE

Hadley Center Historic District

7

4

DR. MAURICE KENNEDY HOUSE (#10) was built circa 1866. It is a two story, ridge roof structure sheathed in asbestos siding. Fenestration is 6/6.

The facade faces west toward Middle Street. Above the entrance is a ridge roof overhang supported by brackets. There are two windows in the gable, and open cornice returns.

Additions and modifications have been made in the form of the three sided full two story bay on the south elevation, an ell with dentilled cornice on the east elevation, and a one story, flat roof porch with a series of double windows on the south elevations of the ell.

THE WHITE-DUGGAN HOUSE (#11) is the oldest building in the Hadley Center Historic District. It is the southernmost property within the district, and faces west toward Middle Street. This simple house was built circa 1775. Although the exterior is now sheathed in beige asbestos siding, and all but the attic windows have been replaced, the existing overhang between the attic and second story, the closeness of the second story windows to the eaves, the symmetrical design, and the low foundation are evidence of the structure's age. Fenestration is 6/6.

The three bay facade has a center entrance headed by a wide architrave and projecting cornice. The side elevations are two bays deep. An ell extending from the rear elevation probably once contained a kitchen and shed. The interior shows scars of a central chimney removed some time ago.

ELIHU WARNER HOUSE (#12) on the west side of Middle Street was built in approximately 1820. The 2½ story white clapboard house has a large central chimney, and rests on a granite slab foundation. Fenestration is 2/2, headed by a wide molded cornice. A later addition was made in the form of the one story porch with turned balustrade, which runs continuously around the five bay wide south facade and three bay deep east elevation. Eight columns ornamented by delicate brackets support the wide porch entablature. The central two story facade with a Doric portico and a broken triangular pediment was a later addition to the building. It partially obscures a small fan window over the entrance. The east gable end elevation faces the street and is dominated by a triangular pediment containing a molded recessed panel and a triangular window inset at the center.

Outbuildings consist of a barn, carriage shed and hen house. Original interior features extant are a beehive oven in the central chimney, four open fireplaces, wide chestnut floorboards, wa inscoting and wall paneling, rope molding around the windows and mantelpieces. and a graceful central stairway.

UNITED STATES DEPARTMENT OF THE INTERIOR
NATIONAL PARK SERVICE

**NATIONAL REGISTER OF HISTORIC PLACES
INVENTORY -- NOMINATION FORM**

FOR NPS USE ONLY	
RECEIVED	MAY 31 1977
DATE ENTERED	DEC 2 1977

CONTINUATION SHEET

ITEM NUMBER

PAGE

Hadley Center Historic District

7

5

ALMIRA WADSWORTH HOUSE (#13) was built in 1892. The 2½ story clapboard, asymmetrical structure faces east toward Middle Street. The main section of the house is hip roofed with a large brick chimney. Intersecting ridge roof sections project from the southern end of the facade and from the western end of the north elevation. Fenestration is irregular with 6/1 double windows in the gables, and 4/4 or leaded glass over a single pane on the second story. On the facade is a hip roof, one story, three bay porch with balustrade. The porch covers the recessed north end entrance. A spindle screen trim ornaments the porch eaves. The overhanging gable pediment on the facade is decorated with scalloped shingles. There is a small hip roof garage sheathed in vertical boards northeast of the house.

JONATHAN MARSH HOUSE (#14) was built in approximately 1821 by Jonathan Marsh, a local carpenter who may have also built the Elihu Warner House (#12). The original floor plan and the exterior of the two structures were almost identical. The Jonathan Marsh House also faces south with the east gable end toward Middle Street. The 2½ story, ridge roof structure has a center chimney, is sheathed in clapboards, and has a wide, flat entablature. Fenestration is 2/2.

The five bay facade has a later one story portico with balustrade. Three columns support a wide molded entablature beneath the flat roof balustraded porch on the second story. A window to the right of the facade entrance has been replaced by an additional door. There is a door to the second story porch directly above the main entrance. The triangularly pedimented gable on the three bay deep east elevation has wide planked boards and a double 6/6 window. A one story ridge roof ell projects from the west elevation. Its recessed entrance is surrounded by a screened porch. A garage is attached to the ell, and a small apartment was added to the west elevation of the garage in 1972.

DWIGHT MARSH HOUSE (#15) was constructed in 1856 by Dwight Marsh and his father, Jonathan, who built #14. The two story, board and batten Gothic Revival cottage has a cruciform plan, The intersecting, steeply pitched ridge roof has three small chimneys, and a wide overhang with brackets. Fenestration is varied. Some of the first story windows are headed by hoods. There is a wooden console beneath each window. Certain windows contain old bull's eye glass.

The facade faces east toward Middle Street. On the north intersecting end the facade is a two bay Doric portico. The entablature is interrupted by pointed segmental arches between each column. The door is flanked by two floor to ceiling windows. A ridge roof dormer with wide overhang projects directly above the entrance portico.

UNITED STATES DEPARTMENT OF THE INTERIOR
NATIONAL PARK SERVICE

**NATIONAL REGISTER OF HISTORIC PLACES
INVENTORY -- NOMINATION FORM**

FOR NPS USE ONLY	
RECEIVED	MAY 31 1977
DATE ENTERED	DEC 2 1977

CONTINUATION SHEET

ITEM NUMBER

PAGE

Hadley Center Historic District

7

6

The interior of the house, which has been carefully restored, maintains a Gothic Revival overlay in the linen fold pattern over each door and window. There is a Gothic quatrefoil carving over one mantel.

Outbuildings include a wide planked carriage shed and barn with a louvered cupola. The barn was restored in 1933.

RUSSELL SCHOOL (#16) conspicuously occupies the southwestern corner of the intersection of Russell and Middle Streets. The red brick, hip roof building was designed by Charles E. Parks of Boston, and constructed in 1894. The massing of the building shows a Richardsonian influence. The exposed basement story is of granite block. The heavy brick and stone construction is relieved by white wooden trimwork. A wide molded entablature with dentilled cornice and bracketed eaves runs continuously around the building. A massive brick chimney rises above the original green slate roof. Fenestration is irregular, with small 6/2 double rectangular windows, tall 9/2 double windows, and 6/2 and 9/2 single windows being the most prominent. The basement windows are 3/3, some grouped in twos or threes. The outstanding windows are round arched, headed by a molded brick architrave.

The facade faces north toward Russell Street, and is dominated by a central square hipped roof tower. Six granite steps lead to a recessed arched entrance headed by two rows of soldier coursed brick ornament with a granite slab overhead. This arch is repeated on the first story east and west elevations of the tower. A brick string-course runs beneath the second story 9/2 double windows. A molded brick entablature defines the tower belfry, which contains a group of three open arches on each of its three sides. These are headed by soldier coursing. The east end of the facade is dominated by a wide arched window running a full two stories. The first story windows of the arch are group of three 6/1 headed by a wide entablature and projecting cornice, and a wide six panelled section which gives rise to a projecting molded lintel below another group of three 6/1 windows which are headed by twenty-nine lights within the arch itself.

The east elevation has a flat roofed one story entrance portico on the northern end. Six granite steps lead to the open porch, which has eight fluted Ionic columns supporting a massive entablature with dentilled cornice. The door is crowned by a group of four nine light casements, and is flanked by two 21 light casements. Directly above the portico are double 6/2 windows headed by a large fan. The southern end of the east elevation is occupied by a double full two story arched window. Both arches have double 9/2 windows on the first story headed by a wide entablature, projecting cornice, wide four panelled section, and a projecting molded lintel beneath double 6/2 windows. These are both headed by a fan in the arch.

UNITED STATES DEPARTMENT OF THE INTERIOR
NATIONAL PARK SERVICE

**NATIONAL REGISTER OF HISTORIC PLACES
INVENTORY -- NOMINATION FORM**

FOR NPS USE ONLY	
RECEIVED	MAY 31 1977
DATE ENTERED	DEC 2 1977

CONTINUATION SHEET

ITEM NUMBER

PAGE

Hadley Center Historic District

7

7

THE AMHERST SAVINGS BANK (#17) is a contemporary "Colonial" type building located on the northwestern corner of the intersection, facing south toward Russell Street. The one story, ridge roof, brick building was constructed in 1964. Fenestration is groups of three ten light casements. There is a south end chimney.

8 SIGNIFICANCE

PERIOD	AREAS OF SIGNIFICANCE -- CHECK AND JUSTIFY BELOW					
<input type="checkbox"/> PREHISTORIC	<input type="checkbox"/> ARCHEOLOGY-PREHISTORIC	<input type="checkbox"/> COMMUNITY PLANNING	<input type="checkbox"/> LANDSCAPE ARCHITECTURE	<input checked="" type="checkbox"/> RELIGION		
<input type="checkbox"/> 1400-1499	<input type="checkbox"/> ARCHEOLOGY-HISTORIC	<input type="checkbox"/> CONSERVATION	<input type="checkbox"/> LAW	<input type="checkbox"/> SCIENCE		
<input type="checkbox"/> 1500-1599	<input checked="" type="checkbox"/> AGRICULTURE	<input type="checkbox"/> ECONOMICS	<input type="checkbox"/> LITERATURE	<input type="checkbox"/> SCULPTURE		
<input type="checkbox"/> 1600-1699	<input checked="" type="checkbox"/> ARCHITECTURE	<input checked="" type="checkbox"/> EDUCATION	<input checked="" type="checkbox"/> MILITARY	<input checked="" type="checkbox"/> SOCIAL/HUMANITARIAN		
<input type="checkbox"/> 1700-1799	<input type="checkbox"/> ART	<input type="checkbox"/> ENGINEERING	<input type="checkbox"/> MUSIC	<input type="checkbox"/> THEATER		
<input checked="" type="checkbox"/> 1800-1899	<input checked="" type="checkbox"/> COMMERCE	<input type="checkbox"/> EXPLORATION/SETTLEMENT	<input type="checkbox"/> PHILOSOPHY	<input type="checkbox"/> TRANSPORTATION		
<input checked="" type="checkbox"/> 1900-	<input type="checkbox"/> COMMUNICATIONS	<input type="checkbox"/> INDUSTRY	<input checked="" type="checkbox"/> POLITICS/GOVERNMENT	<input type="checkbox"/> OTHER (SPECIFY)		
		<input type="checkbox"/> INVENTION				

SPECIFIC DATES Multiple

BUILDER/ARCHITECT Multiple

STATEMENT OF SIGNIFICANCE

The Hadley Center Historic District is significant as the core of the town's political, social, and religious life from the time it became the new town center in the 1840's until the present. The district is composed of architecturally relevant structures dating from the late 18th and early 19th century. The largely self-sustaining farmhouses of the past have given way to strictly residential homes, but the public buildings continue to serve their original purposes in the town center.

#9, #10, #11, Delia Stall, Dr. Maurice T. Kennedy, and White-Duggan Houses. Middle Street was divided into eight acre home lots in 1684 but it was 1713 before the first homes were built there. All this property seems to have belonged to various members of the White family for over 150 years. Nathaniel White was there in 1720. By 1829, Elijah White owned most of it including his homestead, #11. His daughter, Delia Stall owned #9 in 1845 and his nephew, James P. White owned #10 in 1866. His son, Samuel S. White owned #11. The Whites were early farmers owning outlying farm land and wood lots. #11, the White-Duggan house, is the oldest in the district and is an example of a very early farmhouse. An unusual feature of the ownership of #10 by James P. White was a homestead declaration signed in 1866, in which (he) "is a householder having a family and designs to hold said premises as a homestead for the benefit of himself, his said wife and family." This was the home and office of Hadley's last resident physician, Dr. Maurice T. Kennedy, until his death in 1966.

#4 The Hadley Farm Museum, once a local colonial barn built in 1782 and moved to its present site in 1930, is the property of the Farm Museum Association, a local non-profit institution. Extensive displays of early area farm and farmhouse equipment are on exhibit. Of particular importance are displays concerning the broom corn industry in which Hadley led the nation until the Civil War period. Students of all ages and visitors from many states and nations visit the museum annually.

#6 The First Congregational Church, was built in 1804 and moved to this site in 1841, and is the third meeting house since the founding of the town and church in 1659. It originally stood on West Street and its moving was the cause of "the Battle of the Streets." Besides serving its primary function, the building has been used at times for school, emergency, social and fraternal needs. An interesting feature of the interior is the old box pews. Both exterior and interior are in excellent condition and attract photographers and other visitors from distant points. There are distinct signs of Bulfinch and Wren influence in the spire, minarets, balustrades and cornices.

9 MAJOR BIBLIOGRAPHICAL REFERENCES

Hadley Assessors' Records, Town Hall, Hadley, 1810-1875.
 Judd, Sylvester, History of Hadley, Northampton, Metcalf and Co., 1863.
 Farm Museum Records, Library Records, First Congregational Church Records.
 Hoyt, Arthur W., Map of Hadley, 1830
 Walling, Henry F., Map of Hampshire County, New York, H. and C.T. Smith, 1860.
 Annual Reports of the Town of Hadley, Northampton, Metcalf Publishing Co., 1893-1909, 1920-21
 Dwyer, Margaret Clifford, Hopkins Academy, 1664-1964, Hadley, Hopkins Trustees, 1964.

10 GEOGRAPHICAL DATA

ACREAGE OF NOMINATED PROPERTY Approx. 15 acres

UTM REFERENCES

7A

1,8	6,9,8	5,2,0	4,6,9,0	5,9,0
ZONE	EASTING	NORTHING		

490
A-B

1,8	6,9,8	6,2,0	4,6,9,0	5,0,0
ZONE	EASTING	NORTHING		

 8C

1,8	6,9,8	7,2,0	4,6,9,0	2,8,0
ZONE	EASTING	NORTHING		

C-D

1,8	6,9,8	6,7,0	4,6,9,0	0,3,0
ZONE	EASTING	NORTHING		

 cont.

VERBAL BOUNDARY DESCRIPTION

Beginning at the northeastern corner of the rear property line of property #1, continuing westerly along the northern property line of property #1 across Middle Street, continuing southerly along Middle Street to the northern property line of property #17, continuing westerly along northern property line of property #17 to western property line of property #17, continuing southerly along western property line of property #17 across Russell St. to northern property line of property #16, continuing westerly along northern property line of property #16 to western property line of property #16, continuing southerly along

LIST ALL STATES AND COUNTIES FOR PROPERTIES OVERLAPPING STATE OR COUNTY BOUNDARIES (CONT.)

STATE	CODE	COUNTY	CODE
STATE	CODE	COUNTY	CODE

11 FORM PREPARED BY

NAME / TITLE Blaine Mallory and Joseph Orfaut, National Register Editor
 (Dorothy M. Russell, Hadley Historical Commission)

ORGANIZATION	DATE
<u>Massachusetts Historical Commission</u>	<u>March 29, 1977</u>
STREET & NUMBER	TELEPHONE
<u>294 Washington Street</u>	<u>617-727-8470</u>
CITY OR TOWN	STATE
<u>Boston</u>	<u>Massachusetts 02108</u>

12 STATE HISTORIC PRESERVATION OFFICER CERTIFICATION

THE EVALUATED SIGNIFICANCE OF THIS PROPERTY WITHIN THE STATE IS:

NATIONAL

STATE

LOCAL

As the designated State Historic Preservation Officer for the National Historic Preservation Act of 1966 (Public Law 89-665), I hereby nominate this property for inclusion in the National Register and certify that it has been evaluated according to the criteria and procedures set forth by the National Park Service.

STATE HISTORIC PRESERVATION OFFICER SIGNATURE

Elizabeth Reed Amador

TITLE Executive Director, Mass. Historical Commission

DATE 4/27/77

FOR NPS USE ONLY

I HEREBY CERTIFY THAT THIS PROPERTY IS INCLUDED IN THE NATIONAL REGISTER

ATTEST:

W. Smith
Charles A. ...

KEEPER OF THE NATIONAL REGISTER

DATE 12/2/77

DATE 11-30-77

UNITED STATES DEPARTMENT OF THE INTERIOR
NATIONAL PARK SERVICE

FOR NPS USE ONLY

RECEIVED MAY 31 1977

DATE ENTERED DEC 2 1977

**NATIONAL REGISTER OF HISTORIC PLACES
INVENTORY -- NOMINATION FORM**

CONTINUATION SHEET

ITEM NUMBER

PAGE

Hadley Center Historic District

8

1

#12 The Elihu Warner House, located on a lot deeded to him in 1795 was built in 1820 or earlier. The house is typical of the more successful local farmer who were able to build substantial homes. Fine chestnut plank floors, usable brick oven and four open fireplaces and fine original interior woodwork are prominent features. The house was operated as The Brick Oven Tea Room from about 1910-1930 and was later the home of Vernon D. Stiles, an esteemed elementary school principal from 1943 to 1972.

#14 The Jonathan Marsh House was built on virtually the same exterior and interior plans as the Elihu Warner house (#12). Jonathan Marsh was Elihu Warner's son-in-law and was a well known joiner who copied many of the features of the house next door which he built in 1821. The house was owned by Marsh descendants until 1972.

#5 The Hadley Town Hall has been the scene of town meetings and town offices since 1841. It was erected with revenue received as the town's share of a Federal distribution of surplus funds authorized by Congress for internal improvements. In former times, the building was used for social and sports events, church services and school needs. It was a refuge for flood victims in 1927 and 1936. Since 1968 the entire building has been devoted to town offices.

#8 The First Congregational Church Parsonage was built in 1844 soon after the Church was moved to its present site. It has served continuously as a hospitable home for many ministers and their families from the time of its construction to the present.

#15 The Dwight Marsh House was built by the son of Jonathan Marsh (#14) in 1856. The finely detailed interior shows that he inherited his father's skill and good taste. This home housed Hadley's first public library and was owned by Marshes until 1948.

Almira

#13 The Wadsworth House is the only house in the district built in the late nineteenth century. It is on the former Jonathan Marsh property (#14). From 1908 to 1928 it was a tea room, Bide-a-Wee, which catered to a clientele of girls from Mt. Holyoke and Smith College.

#16 Russell School, built in 1894, was the fourth home of Hopkins Academy, Hadley's high school, founded in 1664. It was built on the site of the homestead of Edward Stebbins and replaced an earlier Hopkins Academy building. Construction was financed by the town aided by the Hopkins Trustees who leased the second floor for the Academy. The lower floor held elementary and grammar grades. After removal of Hopkins Academy students to another building in 1909, Russell School housed only the elementary grades. Since 1954 only grades 5 and 6 have been located there. It was called Russell School because of its location on Russell Street and in honor of Hadley's first minister, Rev. John Russell. The outward appearance has changed very little since its construction.

UNITED STATES DEPARTMENT OF THE INTERIOR
NATIONAL PARK SERVICE

**NATIONAL REGISTER OF HISTORIC PLACES
INVENTORY -- NOMINATION FORM**

FOR NPS USE ONLY	
RECEIVED	MAY 31 1977
DATE ENTERED	DEC 2 1977

CONTINUATION SHEET

ITEM NUMBER

PAGE

Hadley Center Historic District

8

2

#2 Goodwin Memorial Library was named in honor of William Goodwin, one of the first settlers, who in 1664, was instrumental in securing funds for the establishment of Hopkins Academy, Hadley's High School. Before building, consideration was given to requesting Carnegie funds, but the proud town decided to finance it by public subscription. In 1901 John Dwight offered up to \$400 if he could be matched by Hadley people. This was promptly done. It was John Dwight who suggested the library be named after his ancestor, Elder William Goodwin. Tablets honoring and listing first settlers and soldiers of the Revolution, the Civil War and World War I are a part of the interior. The first floor serves as the town library. The second floor is devoted to memorabilia from many generations of Hadley citizens and is now in the care of the Hadley Historical Society which meets there.

#3 St. John the Apostle Church, one of the smallest in the Springfield diocese, is Hadley's first Catholic church and was established in 1902. Catholics who arrived as early as the mid nineteenth century attended services in private homes or in Northampton. The church, as well as the library, were built on the site of the Kellogg homestead where this prominent family had lived for three generations.

#7 The Smith House was the home and office of Hadley's family doctor, Dr. Frank H. Smith. He was a public spirited man who was active in promoting the welfare of the town's civic, church, educational and library needs. The house, built in 1903, was designed by the architect of the nearby Goodwin Memorial Library.

#1 Hooker School was built and enlarged to accommodate the children from seven out-lying neighborhood schools which had been closed. The town's children in grades K-4 now attend this school which was named for Hadley's native son of Civil War fame. General Joseph Hooker.

UNITED STATES DEPARTMENT OF THE INTERIOR
NATIONAL PARK SERVICE

**NATIONAL REGISTER OF HISTORIC PLACES
INVENTORY -- NOMINATION FORM**

FOR NPS USE ONLY	
RECEIVED	MAY 31 1977
DATE ENTERED	DEC 2 1977

CONTINUATION SHEET

ITEM NUMBER

10

PAGE

1

Verbal Boundary Description:

western property lines of properties #16, #15, #14, #13, #12 to southern property line of property #12, continuing easterly along southern property line of property #12 across Middle Street to eastern property line of property #11, continuing northerly along eastern property lines of properties #10, #9, #8, #7, #4 to Russell Street, continuing westerly along northern property line of property #4, thence northerly across Russell Street, continuing northerly along eastern property lines of properties #3 and #1 to starting point.

UTM References:

~~D~~ 18/698 480/4690 020

~~E~~ 18/698 440/4690 360

UNITED STATES DEPARTMENT OF THE INTERIOR
NATIONAL PARK SERVICE

**NATIONAL REGISTER OF HISTORIC PLACES
INVENTORY -- NOMINATION FORM**

FOR NPS USE ONLY
MAY 31 1977
RECEIVED
DATE ENTERED DEC 2 1977

CONTINUATION SHEET

ITEM NUMBER

PAGE

Key to Sketch Map:

- #1 Hooker School (1921 and 1950) 48 Middle Street
- #2 Goodwin Memorial Library (1902) 50 Middle Street
- #3 St. John the Apostle Church (1902) Russell Street
- #4 Hadley Farm Museum (1782, moved 1930) Russell Street
- #5 Hadley Town Hall (1841) 52 Middle Street
- #6 First Congregational Church (1804, moved 1841) 54 Middle Street
- #7 Dr. Frank H. Smith House (1903) 56 Middle Street
- #8 First Congregational Church Parsonage (1854) 58 Middle Street
- #9 Delia Stall House (c. 1840) 60 Middle Street
- #10 Dr. Maurice T. Kennedy House (c. 1866) 64 Middle Street
- #11 White-Duggan House (1775-1817) 70 Middle Street
- #12 Elihu Warner House (1820) 65 Middle Street
- #13 Almira Wadsworth House (1892) 63 Middle Street
- #14 Jonathan Marsh House (1821) 61 Middle Street
- #15 Dwight Marsh House (1856) 59 Middle Street
- #16 Russell School (1894) 57 Middle Street
- #17 Hadley Office of Amherst Savings Bank (1964) 140 Russell Street

PROPERTY OWNER LISTING
HADLEY CENTER HISTORIC DISTRICT
HADLEY, HAMPSHIRE COUNTY, MASSACHUSETTS

3/77 MASSACHUSETTS HISTORICAL COMMISSION

Hadley Historical Commission

HADLEY, MASSACHUSETTS

Settled in 1659

September 23, 1976

Chairman
MAC GRESS

Vice Chairmen
ESTHER M. BARSTOW
DOROTHY M. RUSSELL

Secretary
MARGARET C. DWYER

Treasurer
JOHN W. CLOUGH

Mr. Joseph R. Orfant
National Register Editor
Massachusetts Historical Commission
294 Washington Street
Boston, Massachusetts 02108

Re: Hadley Center Historic District

Dear Mr. Orfant:

The following names and addresses are submitted in accordance with your request of 15 September.

#1	Hooker School)	Town of Hadley
#2	Goodwin Memorial Library)	Town Hall, Selectmen's Offi.
#5	Hadley Town Hall)	Hadley, Massachusetts 01035
#16	Russell School)	
#6	First Congregational Church)	Mr. Melvin Partridge
#8	First Congregational Church)	Ch. Board of Trustees
	Parsonage)	First Congregational Church
			8 Sylvia Heights
			Hadley, Massachusetts 01035
#3	St. John the Apostle Church		Roman Catholic Bishop of
			Springfield
			% Rev. John B. Hughes
			Middle Street
			Hadley, Massachusetts 01035
#4	Hadley Farm Museum		Mr. Earle Parsons
			Ch. Board of Trustees
			Farm Museum Association
			143 Mill Valley Road
			Hadley, Massachusetts 01035
#7	Dr. Frank H. Smith House		Dr. Elinor V. D. Smith
			56 Middle Street
			Hadley, Massachusetts 01035
#9	Delia Stall House		Mr. George Boisvert
			60 Middle Street
			Hadley, Massachusetts 01035

#10 Dr. Maurice T. Kennedy House

Mrs. Susan M. Kennedy
64 Middle Street
Hadley, Massachusetts 01035

#11 White- Duggan House

Mr. Thomas L. Niedbala
70 Middle Street
Hadley, Massachusetts 01035

#12 Elihu Warner House

Mr. John H. Allen
65 Middle Street
Hadley, Massachusetts 01035

#13 Almira Wadsworth House

Mrs. Agnes Drozdal
63 Middle Street
Hadley, Massachusetts 01035

#14 Jonathan Marsh House

Mr. Richard & Thomas Niedbala
103 Russell Street
Hadley, Massachusetts 01035

#15 Dwight Marsh House

Mrs. Marjorie Sullivan
59 Middle Street
Hadley, Massachusetts 01035

#17 Hadley Office of Amherst
Savings Bank

Mr. R. Donald Shipman
95 Hockanum Road
Hadley, Massachusetts 01035

Please call on me if I can be of any further help.

Sincerely

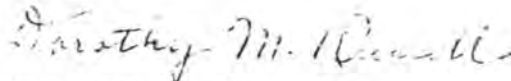

Dorothy M. Russell

DMR/mcd

Property Hadley Center Historic District 7700185
 State Mass. Working Number 5.31.77.888 Hampshire
TECHNICAL Nothing incorrect **CONTROL**
 Photos 10 pl
 Maps 2 6.2.77
HISTORIAN

THERE ARE NO PHOTOS DEPICTING WEST SIDE OF MIDDLE STREET, HOWEVER, THE BLDGS. ARE ADEQUATELY DESCRIBED. **ARCHITECTURAL HISTORIAN**
ACCEPT
H Brito 11/17/77

Discussed Amherst Savings Bank with Blaine Malloy. She said they included in '60's building to have a 4 corners on N.R. to have a complete boundary on that end of district's boundary changes require review board approval. 11.28.77 Brabham **ARCHEOLOGIST**

- It would be nice to have more photos. However - a quick enough info. to accept VBO. A little awkward but acceptable. **OTHER**
accept -
Brabham
11.22.77
HAER

Inventory _____
 Review _____

See Brabham's comments. Amherst Savings Bank is 1964 brick one story structure without architectural merit. But to exclude some that this bldg would require excessive state effort. Boundary is rational as it includes 4 corners of intersection which is probably historic **REVIEW UNIT CHIEF**
Accept
Lebovich
11/28/77

BRANCH CHIEF

Hump
11/30/77

KEEPER
Wm
12/2/77

National Register Write-up _____ Send-back _____ Entered DEC 2 1977
 Federal Register Entry 2.7.78 Re-submit _____

INT:2106-74



POE DEC 2 1977

Hadley Center Historic District

Hadley, Massachusetts

1975

John W. Clough

3 Maplewood Terrace, Hadley, Mass. 01035

Photo #1010

Middle Street looking southeast toward:

l. to r. #5 Town Hall, #6 First Congregational Church, #7 Smith House.

escape A
Looking southeast - Middle St.
l. to r. # 5 Town Hall, #6 First Congregational
Church # 7 Smith House

PROPERTY OF THE NATIONAL REGISTER



POE DEC 2 1977

Hadley Center Historic District

Hadley, Massachusetts

1975

John W. Clough

3 Maplewood Terrace, Hadley, Mass. 01035

Photo #2 of 10 Hampshire County

Middle Street looking northwest toward:

1. to r. #2 Goodwin Memorial Library,

#5 Town Hall, #6 First Congregational Church, #7 Smith House.

MAY 31 1977

scape B

thwest: Middle Street

l. to r.: (behind route sign, # 2 Goodwin Memorial Library,
5 Town Hall # 6 First Congregational Church,
7 Smith House

PROPERTY OF THE NATIONAL REGISTER



Hadley Center Historic District
Hadley, Massachusetts
1975

John W. Clough
3 Maplewood Terrace, Hadley, Mass. 01035
Photo #3 *410*
Looking east from Middle Street toward
#1 Hooker School.

DEC 2 1977

MAY 31 1977

Hampshire County

to #1

*at: Middle Street
Hooker School*

PROPERTY OF THE NATIONAL REGISTER



Hadley Center Historic District
Hadley, Massachusetts

1975

John W. Clough

3 Maplewood Terrace, Hadley, Mass. 01035

Photo #4 *8/10*

Looking east from Middle Street toward
#2 Goodwin Memorial Library.

DEC 2 1977

MAY 31 1977

Hampshire County

2

*Looking east: Middle Street
Goodwin Memorial Library, portion
of St. John's Church in background*

PROPERTY OF THE NATIONAL REGISTER



Hadley Center Historic District
Hadley, Massachusetts *Hampshire County*
1975
John W. Clough
3 Maplewood Terrace, Hadley, Mass. 01035
Photo #5 *H10*
Looking north from Russell Street toward
#3 St. John the Apostle Church.

DC
DEC 2 1977

MAY 31 1977

*h: Russell Street
Apostle Church
(portion of library on left)*

PROPERTY OF THE NATIONAL REGISTER



FARM
MUSEUM
FREE
HOURS 10:00-4:30
SUNDAYS 1:30-4:30
CLOSED MONDAYS
MAY 1-OCT. 12

Hadley Center Historic District
Hadley, Massachusetts
1975

Hampshire County

John W. Clough
3 Maplewood Terrace, Hadley, Mass. 01035

MAY 31 1977

Photo #6 *of 10*

Looking east from Russell Street toward
#4 Hadley Farm Museum.

DOE
DEC 2 1977

4
ast: Russell Street

Hadley Farm Museum

PROPERTY OF THE NATIONAL REGISTER



Hadley Center Historic District
Hadley, Massachusetts
1975
John W. Clough
3 Maplewood Terrace, Hadley, Mass. 01035
Photo #7410
Looking east from Middle Street toward
#5 Hadley Town Hall.

MAY 31 1977

to # 5
east: Middle Street
Hadley Town Hall (portion of
Farm Museum in background)

PROPERTY OF THE NATIONAL REGISTER



Hadley Center Historic District
Hadley, Massachusetts
1975
John W. Clough *Hampshire County*
3 Maplewood Terrace, Hadley, Mass. 01035
Photo #8 *810*
Looking east from Middle Street toward
#6 First Congregational Church.

DOE
DEC 2 1977

MAY 31 1977

*Middle Street
Congregational Church*

PROPERTY OF THE NATIONAL REGISTER



Hadley Center Historic District
Hadley, Massachusetts
1975
John W. Clough *Hampshire County*
3 Maplewood Terrace, Hadley, Mass. 01035
Photo #90/10
Looking west from Middle Street toward
#16 Russell School.

DOE
DEC 2 1977

MAY 31 1977

*to # 13
west; Middle St.
Russell School, # 16*

PROPERTY OF THE NATIONAL REGISTER



HADLEY
OFFICE



AMHERST
SAVINGS
BANK

AMHERST SAVINGS BANK

Hadley Center Historic District
Hadley, Massachusetts *Hampshire County*
1975
John W. Clough
3 Maplewood Terrace, Hadley, Mass. 01035
Photo #10 *of 10*
Looking north from Russell Street
toward #17 Hadley Office Amherst
Savings Bank. *DOE* **MAY 31 1977**

DEC 2 1977

14

th : Russell Street

Amherst Savings Bank, # 17

PROPERTY OF THE NATIONAL REGISTER

Hadley Center Historic District
Hadley, Massachusetts
UTM Coordinates:
18/698 520/4690 590 485
18/698 620/4690 500 485
18/698 720/4690 280
18/698 670/4690 030
18/698 480/4690 020
18/698 440/4690 360



Mapped, edited, and published by the Geological Survey
Control by USGS, USC&GS, and Massachusetts Geodetic Survey
Topography by planetable surveys 1935. Revised 1964
Polyconic projection. 1927 North American datum
10,000-foot grid based on Massachusetts coordinate system,
mainland zone
1000-metre Universal Transverse Mercator grid ticks,
zone 18, shown in blue
Red tint indicates areas in which only landmark buildings are shown

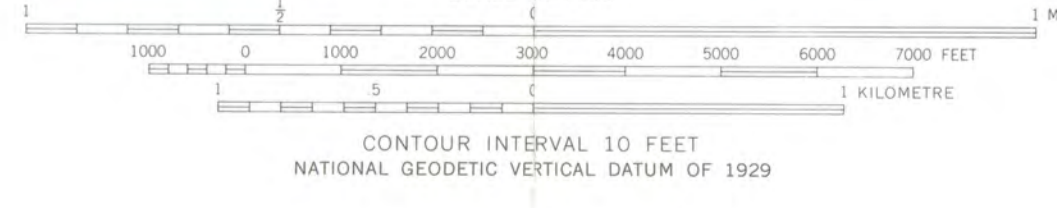
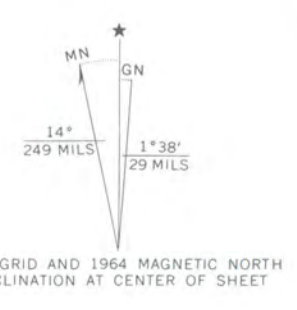

THIS MAP COMPLIES WITH NATIONAL MAP ACCURACY STANDARDS
FOR SALE BY U.S. GEOLOGICAL SURVEY, RESTON, VIRGINIA 22092
A FOLDER DESCRIBING TOPOGRAPHIC MAPS AND SYMBOLS IS AVAILABLE ON REQUEST

MT. HOLYOKE, MASS.
N4215-W7230/7
1964
AMS 6468 I SE-SERIES V81



HADLEY CENTER HISTORIC DISTRICT

Hadley, MA
Quad - Mt Holyoke
Scale 1:25000
map # 1 of 2

- UTM References:
- A 18/699950/4692120
 - B 18/699930/4691980
 - C 18/699650/4691950
 - D 18/699700/4690820
 - E 18/700000/4690350
 - F 18/699900/4689770
 - G 18/699620/4689280
 - H 18/699110/4688720
 - I 18/698900/4688530
 - J 18/698560/4688330
 - K 18/697550/4688100
 - L 18/696190/4687670
 - M 18/696000/4687120
 - N 18/697220/4691160
 - O 18/698360/4691540
 - P 18/698640/4692370
 - Q 18/699230/4692370
 - R 18/699290/4692070

UNITED STATES
DEPARTMENT OF THE INTERIOR
GEOLOGICAL SURVEY

COMMONWEALTH OF MASSACHUSETTS
DEPARTMENT OF PUBLIC WORKS

MT. HOLYOKE QUADRANGLE
MASSACHUSETTS
7.5 MINUTE SERIES (TOPOGRAPHIC)



Maped, edited, and published by the Geological Survey
Control by USGS, USC&GS, and Massachusetts Geodetic Survey
Topography by planetable surveys 1935. Revised 1964
Polyconic projection. 1927 North American datum
10,000-foot grid based on Massachusetts coordinate system,
mainland zone
1000-meter Universal Transverse Mercator grid,
zone 18
Red tint indicates areas in which only landmark buildings are shown
There may be private inholdings within the boundaries of
the National or State reservations shown on this map
Revisions shown in purple compiled from aerial photographs
taken 1976 and other source data. This information
not field checked. Map edited 1979

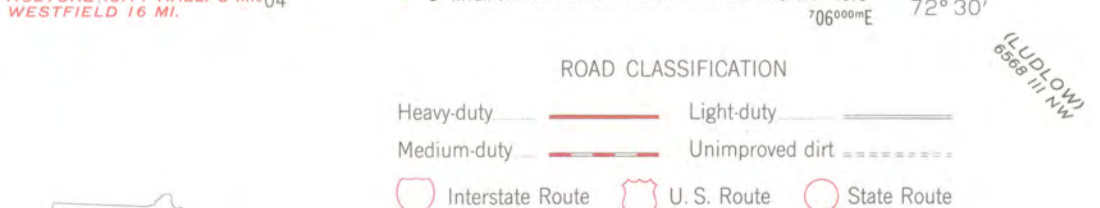
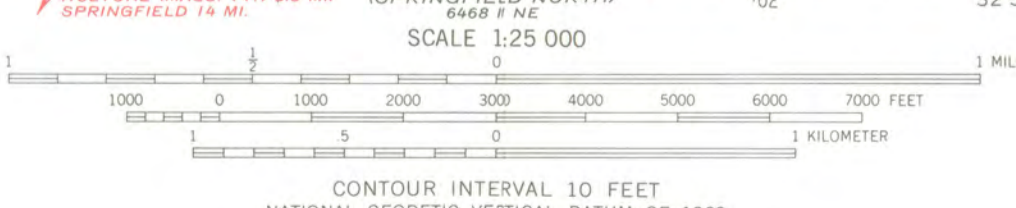
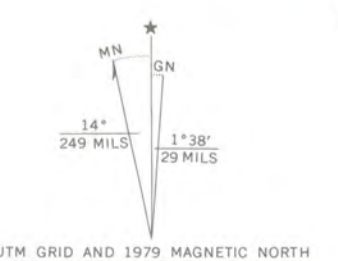

THIS MAP COMPLIES WITH NATIONAL MAP ACCURACY STANDARDS
FOR SALE BY U.S. GEOLOGICAL SURVEY, RESTON, VIRGINIA 22092
A FOLDER DESCRIBING TOPOGRAPHIC MAPS AND SYMBOLS IS AVAILABLE ON REQUEST

MT. HOLYOKE, MASS.
N4215—W7230/7.5
1964
PHOTOREVISED 1979
AMS 6468 1 SE—SERIES V814

NORTH



Center of Hadley Historic District
Hadley, Massachusetts
Sketch Map
Scale: 1" = 100'



RUSSELL STREET

(ROUTE 9)

MIDDLE STREET (ROUTE 47)

17

1964

1
1921 ✓

2
1902 ✓

3
1902 ✓

16

1894

15

1856

14

1821

13

1892

12

1820

5

1841

4

1782
MOVED 1930

6

1804
MOVED 1841

BARN

7

1903

8

1854

9

1840

10

1866

11

1775

DEC 2 1977

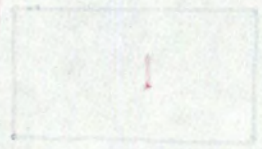

(ROUTE 4)

ROUSSELL STREET

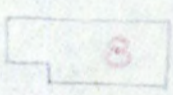

HAMILTON
SUPPLIERS

MIDDLE STREET (ROUTE 4)

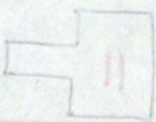
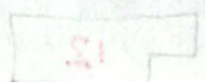



FOUNDED 1659

First Congregational Church

HADLEY, MASS.

54 Middle Street
August 12, 1977



Dr. William J. Murtagh
Keeper of the National Register
National Park Service
Department of the Interior
Washington, D.C. 20240

Dear Sir,

I refer to your letter of July 14, 1977 in reference to the nomination of The First Congregational Church of Hadley, Mass. for listing in the National Register.

I believe that all pertinent and required information regarding this structure has been recorded and forwarded by our local Historical Commission on the application sent to Boston. As Chairman of the Board of Trustees of this Church, I might say that the Trustees, as well as the Church members, are vitally interested in having the Church listed in the National Register

The Church members are also vitally interested in properly maintaining the church which is such a fine example of New England church architecture. Since the church is centrally located its facilities are constantly used by many organizations such as the Grange, girl scouts, Brownies, a local Mens' Club, etc.

Early in February of this year we nearly lost this church as the result of a fire which started in a coat rack and possibly the result of live pipe ashes in a coat pocket. Prompt action on the part of several men present resulted in quickly extinguishing the blaze and saved the church from more extensive damage and possibly total loss. Shortly after, the church members lost no time in approving and having installed a sophisticated fire alarm system with a direct connection to the Fire Department.

Sincerely yours,

John W. Clough
John W. Clough, Chairman

Board of Trustees
First Congregational Church
Hadley, Mass. 01035

ENTRIES IN THE NATIONAL REGISTER

STATE MASSACHUSETTS

Date Entered DEC 2 1977

<u>Name</u>	<u>Location</u>
Castle Hill	Ipswich vicinity Essex County
Hadley Center Historic District	Hadley Hampshire County
Sherburne, Warren E., House	Lexington Middlesex County

Also Notified

Hon. Edward W. Brooke
Hon. Edward M. Kennedy
Hon. Michael J. Harrington
Hon. Silvio O. Conte
Hon. Paul Tsongas

Regional Director, North Atlantic Region

State Historic Preservation Officer
Mrs. Elizabeth R. Amadon
Executive Director, Massachusetts
Historical Commission
294 Washington Street
Boston, Massachusetts 02108

880

Mott/js

12/12/77

NATIONAL REGISTER DATA SHEET

① NAME as it appears on federal register: **Hadley Center Historic District** ② OTHER NAMES: _____
 ③ date of entry: **DEC 2 1977** ④ county code: **15**

⑤ LOCATION street & number: **Middle and Russell Sts** city / town: **Hadley** vicinity of: _____ state: **MA** county: **Hampshire** ⑥ NPS REGION: **NA**

⑦ OWNER PRIVATE STATE MUNICIPAL COUNTY MULTIPLE FEDERAL (agency name) _____ ⑧ ADMINISTRATOR: _____

⑨ EXISTING SURVEYS HABS HAER NHL ⑩ FUNDED? YES NO ⑪ CONGRESS. DISTRICT: **1st** ⑫ SOURCE of NOMINATION: STATE FEDERAL _____
 if state who prepared form? _____

⑬ WITHIN NATIONAL REGISTER HISTORIC DISTRICT? YES, NAME: _____ NO ⑭ WITHIN NATIONAL HISTORIC LANDMARK? YES, NAME: _____ NO ⑮ ACREAGE: _____
 LOCAL PRIVATE ORGANIZATION

⑯ CONDITION deteriorated altered original site ⑰ features: SUBSTANTIALLY INTACT-1 SUBSTANTIALLY INTACT-2 SUBSTANTIALLY INTACT-3
 excellent ruins unaltered moved INTERIOR NOT INTACT-0 NOT INTACT-0 EXTERIOR NOT INTACT-0 NOT INTACT-0 ENVIRONS NOT INTACT-0
 good unexposed reconstructed unknown INTERIOR UNKNOWN-4 UNKNOWN-5 EXTERIOR UNKNOWN-5 UNKNOWN-5 ENVIRONS UNKNOWN-6
 fair unexcavated excavated INTERIOR NOT APPLICABLE-7 EXTERIOR NOT APPLICABLE-8 ENVIRONS NOT APPLICABLE-9

⑱ ACCESS YES-Restricted YES-Unrestricted No Access Unknown ⑲ ADAPTIVE USE YES NO ⑳ SAVED? YES NO ㉑ IS PROPERTY A HISTORIC DISTRICT? yes no

㉒ AREAS OF SIGNIFICANCE: ENGINEERING-11 LANDSCAPE ARCH.-13 POLITICS/GOV.-21 RECREATION-28
 ARCHEOLOGY-prehistoric-2 COMMERCE-6 ENTERTAINMENT-26 LAW-16 RELIGION-22 SETTLEMENT-29
 ARCHEOLOGY-historic-1 COMMUNICATIONS-7 EXPLORATION-17 LITERATURE-17 SCIENCE-23 URBAN PLANNING-31
 AGRICULTURE-1 CONSERVATION-8 HEALTH-27 MILITARY-18 SOCIAL/HUMANITARIAN-24 OTHER (SPECIFY) _____
 ARCHITECTURE-4 ECONOMICS-3 INDUSTRY-13 MUSIC-19 SOCIAL/CULTURAL-30
 ART-5 EDUCATION-10 INVENTION-14 PHILOSOPHY-20 TRANSPORTATION-25

㉓ CLAIMS: explain
 'first'
 'oldest'
 'only'

㉔ functions WHEN HISTORICALLY SIGNIFICANT: _____ CURRENTLY: _____ ㉕ dates of initial construction: _____ major alterations: _____ historic events: _____ ㉖ ETHNIC GROUP ASSOCIATION: _____

㉗ architectural style(s): _____ ㉘ architect: _____ ㉙ master builder: _____ ㉚ engineer: _____

㉛ landscape architect / garden designer: _____ ㉜ interior decorator: _____ ㉝ artist: _____ ㉞ artisan: _____ ㉟ builder/contractor: _____

㊱ NAMES give role & date
 PERSONAL: _____
 EVENTS: _____
 INSTITUTIONAL: _____

㊲ NATIONAL REGISTER WRITE-UP

reviewers initials: _____ date: _____

IF ADDITIONAL SPACE NEEDED, NUMBER & PUT ON REVERSE